

# WINEGARD® Sensor™ HV

## ANTENNATEK® TO WINEGARD™ RETRO-FIT GUIDE

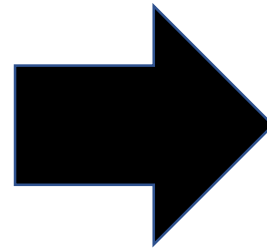

**Coast to Coast RV Services**

Phone: 02 9645 7600

Fax: 02 9645 7688

Email Technical: [technical@coastrv.com.au](mailto:technical@coastrv.com.au)

Email Warranty: [warranty@coastrv.com.au](mailto:warranty@coastrv.com.au)

# Retro-fit a Winegard HV Mast to Antennatek Base

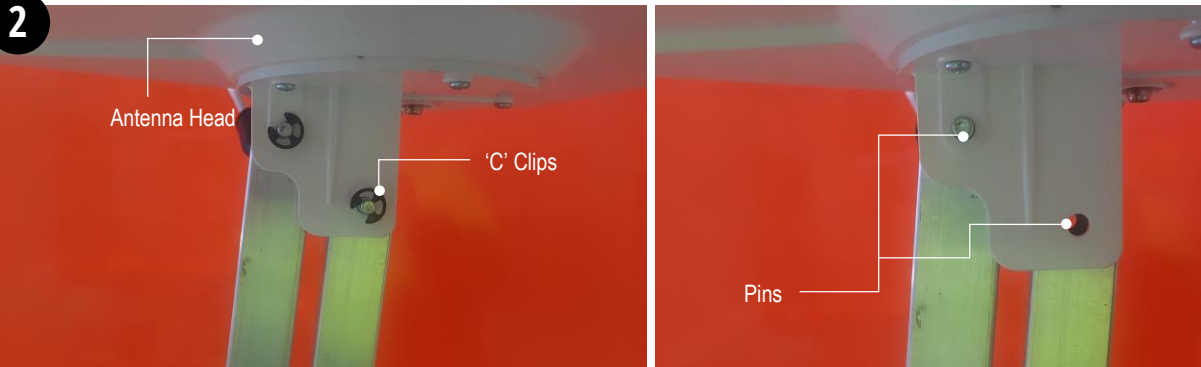
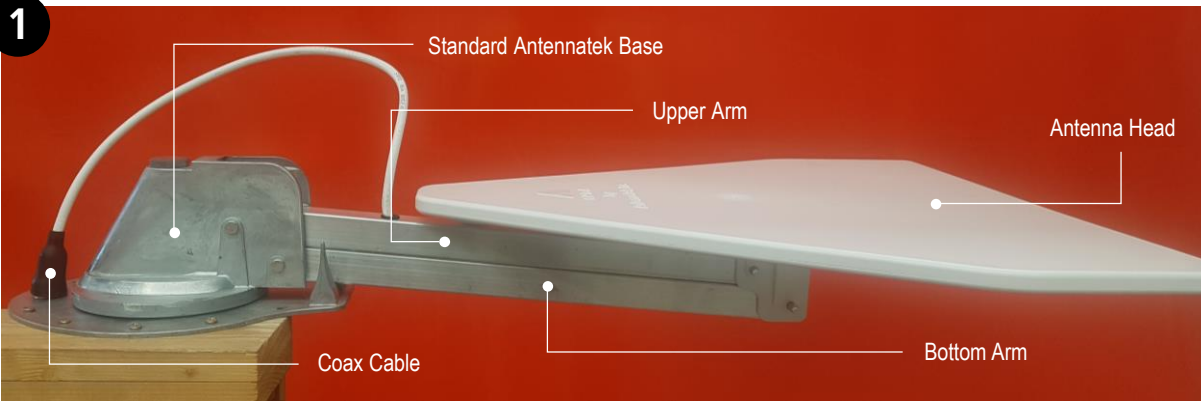

First, you will need to take off the Antennatek Head.

To do so, simply remove the 'C' Clips from where the **Antenna Head** joins the **Arms** and then remove the **Pins** with the appropriate tools. Slide the Antennatek Head off the arms.

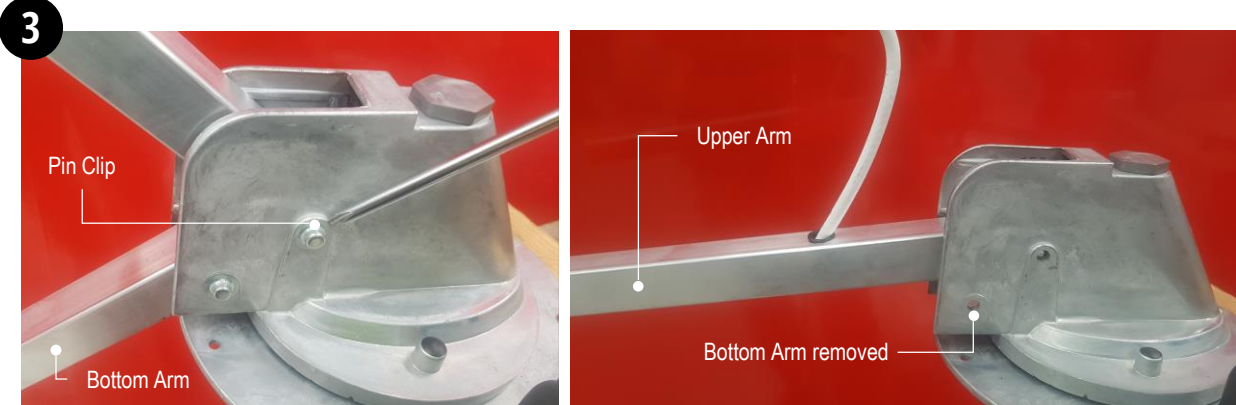

Next, you will need to remove the Arms from the Antennatek Base.

Remove the **Pin Clip** holding the Antenna arms on the **Base**. Do not damage the Pin Clip as they will be re-used. Detach the Upper Arm along with its attached gear from the base and set aside. Then remove the second pin from the Bottom Arm and detach the arm from the base.

**4** **OPTIONAL:** This is only if you want to re-use the existing Coax Cable as it will need to be cut out of the Upper Arm. If you are going to use your own new coax cable then this step can be ignored.

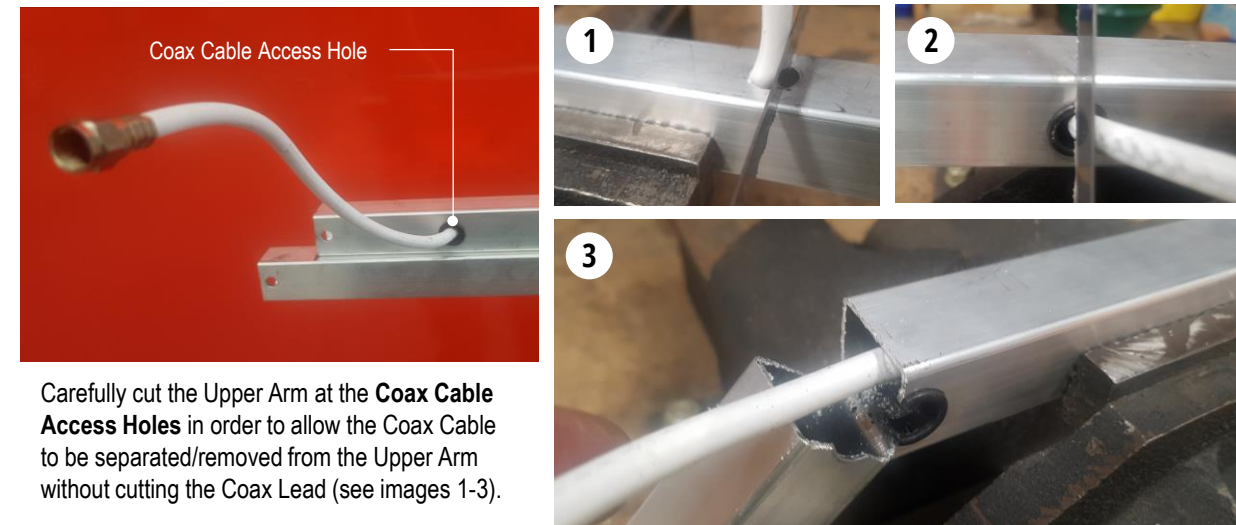

Carefully cut the Upper Arm at the **Coax Cable Access Holes** in order to allow the Coax Cable to be separated/removed from the Upper Arm without cutting the Coax Lead (see images 1-3).

You will need to cut through the Antennatek Arm at both coax cable access holes.

Slide Coax Cable from access hole so it sits out, and remove.

5



Next you will need to attach the Winegard Mast to the Antennatek Base.

To do this, first remove the **Gear** that is attached to the Antennatek **Upper Arm** as this gear will be reused (You will not be using the gear supplied with the Winegard unit).



Fit the Antennatek **Gear** to the **Winegard HV Mast**. The Gear can only fit in one direction on the Mast due to locating slot.

The Winegard Mast is slightly larger than the Antennatek Upper Arm's tube, so the Gear will need to be packed securely to the Winegard Mast's tube by either gluing with desired glue/epoxy or tape/plastic shims in order to fit the Gear into tube with a snug fit.



6

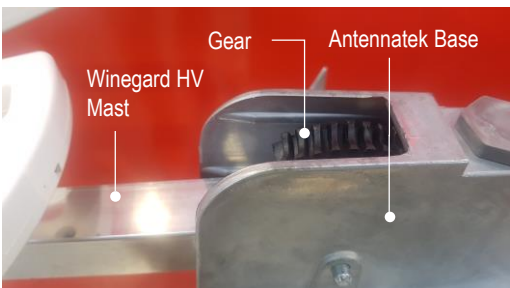

Place the **Gear** and **Winegard HV Mast** back into the **Antennatek Base** horizontally, ensuring that it slides in easily – no excessive force should be necessary.



Refit the **Pin** to secure the HV Mast to the base and secure with previously removed clips. In the case that you damage or lose a clip or pin, you can use the one removed from the discarded lower arm.

7



Now the Mast has been retro-fitted to the Antennatek Base, test mast operation with the crank handle to bring it to an upright position. Keep it upright to make routing the Coax Cable much easier.



8



To install the **Coax Cable**:  
Run the Cable and secure as per the Winegard HV instructions and secure to the Antennatek Base in place of the old one.  
Test the unit to ensure it has full 360° movement that doesn't put excessive stress on the Coax Cable.  
If there is excessive stress on it, you will need to re-route the cable to give it more freedom and less risk damage.



**WINEGARD**

**[www.winegard.com](http://www.winegard.com)**

Winegard Company • 3000 Kirkwood Street • Burlington, IA 52601  
800-288-8094 • Fax 319-754-0787 • [www.winegard.com](http://www.winegard.com) • Printed in U.S.A.  
©2012 Winegard Company Rev2 2/12 2452255

Winegard is a registered trademark of Winegard Company.  
All trademarks are property of their respective owners.

2452255