

INSTRUCTION SHEET

Snap Frame Installation on Wall

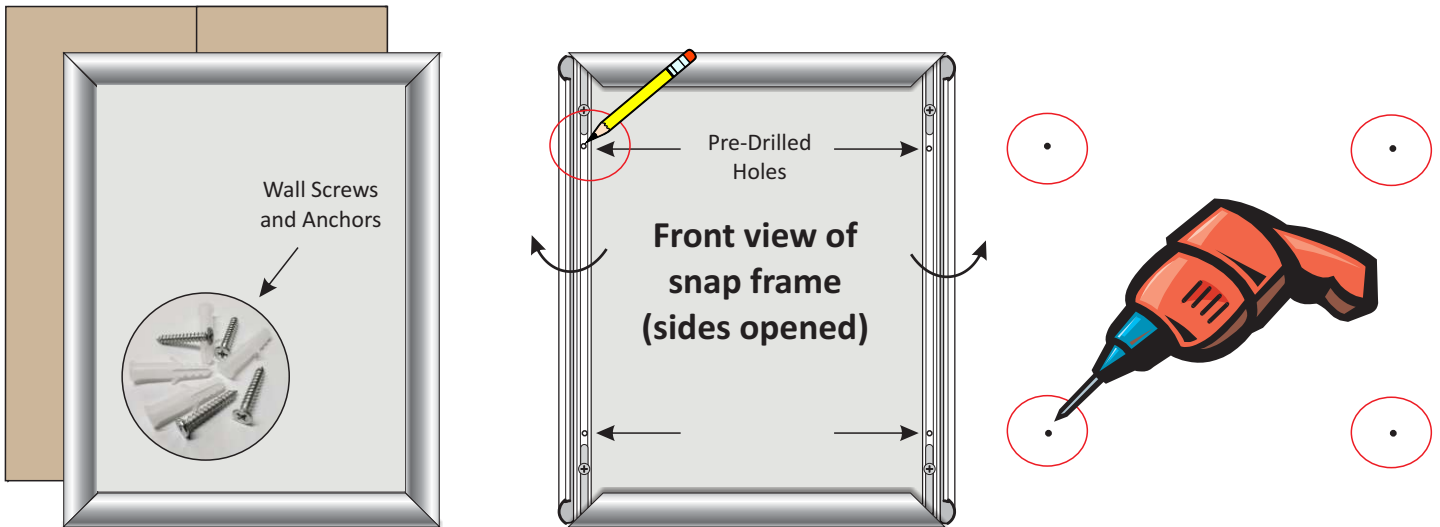

1. Open the box and take out the snap frame and bag of wall screws and anchors. Locate blank wall to hang snap frame.
2. Open left and right sides of frame and locate the pre-drilled holes. With a pencil mark the holes (on to the wall) on both the left and right sides of frame.
3. With the pencil marks as a guide drill into the wall where you marked the left and right holes.
4. Push the white plastic wall anchor into the wall. Position frame and with the provided screw feed through the hole and match up to the wall anchor. Using a screwdriver tighten the screw.
5. Repeat till both sides are secured to the wall. Insert poster and snap all four sides of the frame closed.



Z:INSTRUCTION SHEETS/snap frame installation on wall 01122022.pdf



27 Ontario Rd., WALKERTON, ON N0G 2V0
1-888-953-1111
sales@coxsigns.com

Online *Sign* SHOP.ca



Unit 3, 291 Lorne Ave. E. STRATFORD, ON N5A 6S4
519-272-0333
signsontime@coxsigns.com