

Use Zone: 86' x 33'



Age Group: 2-12



ADA Access: Yes



Occupancy: 52-56



Free Shipping!

COMPONENTS: Double Straight Slide / Paddle Balk Panel / Right Turn Slide / Bones Bridge / Window Panel (Above) / Bench Panel (Below) / Spiral Slide / Ocean Wave Slide / Gear Panel / Suspension Bridge / Pod Climber / Ship's Wheel / Transfer Station / Snake Challenge Ladder / Net Climber / Tic-Tac-Toe Panel / Left Turn Slide / Arch Bridge

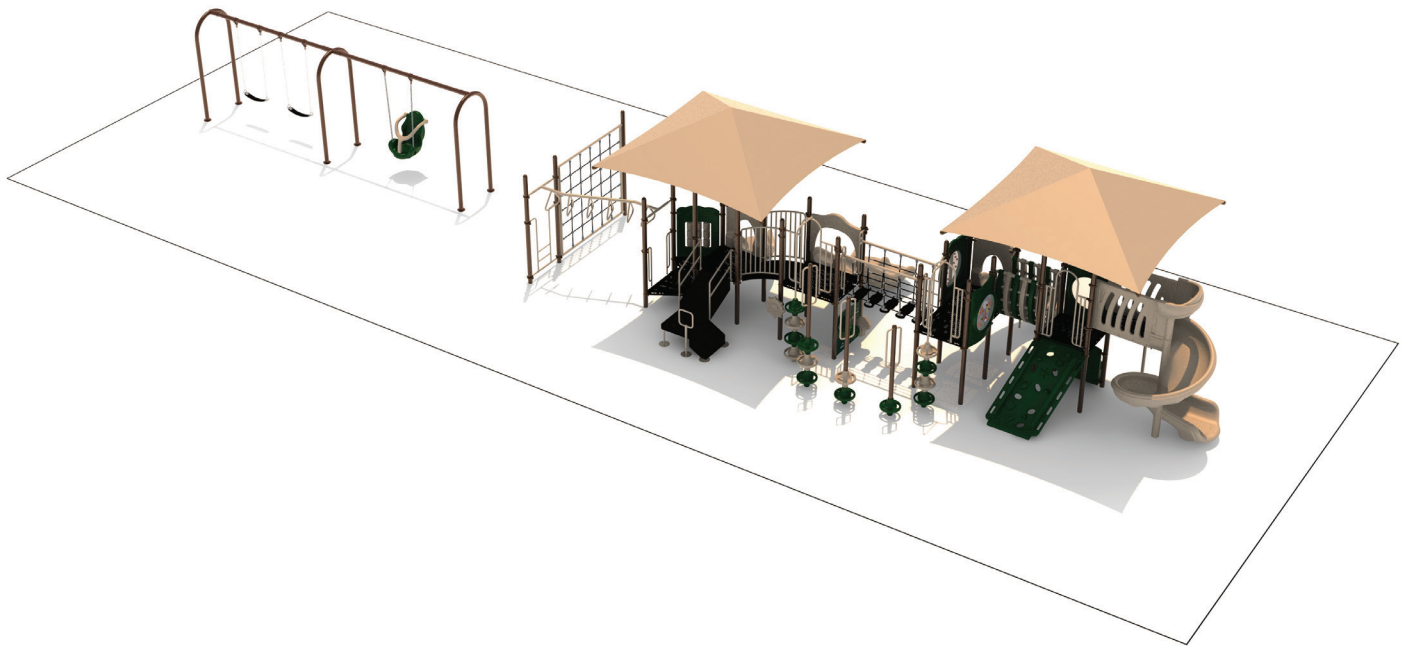

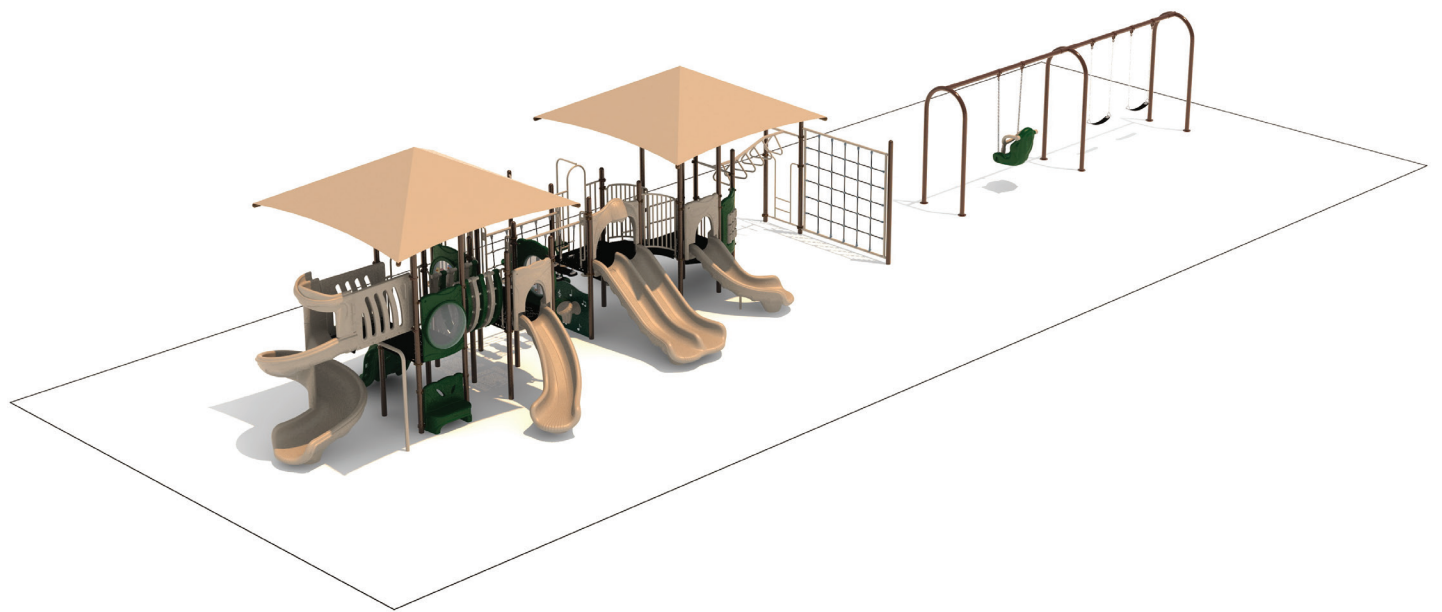

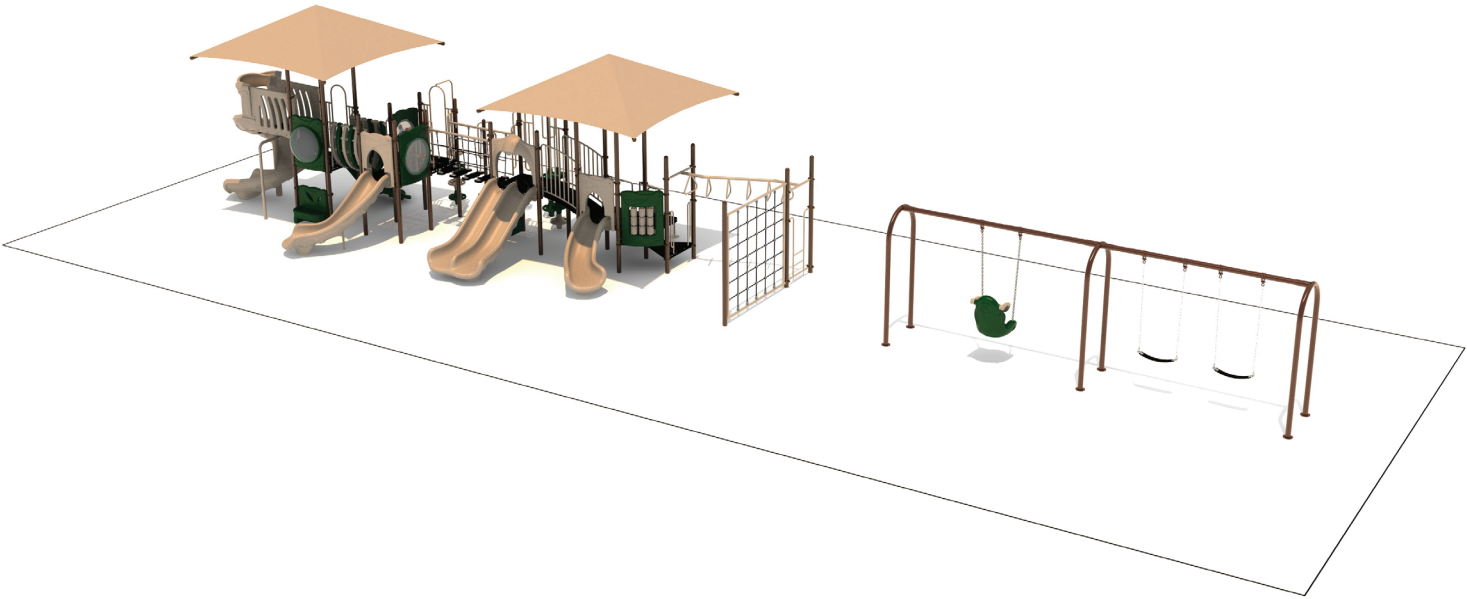

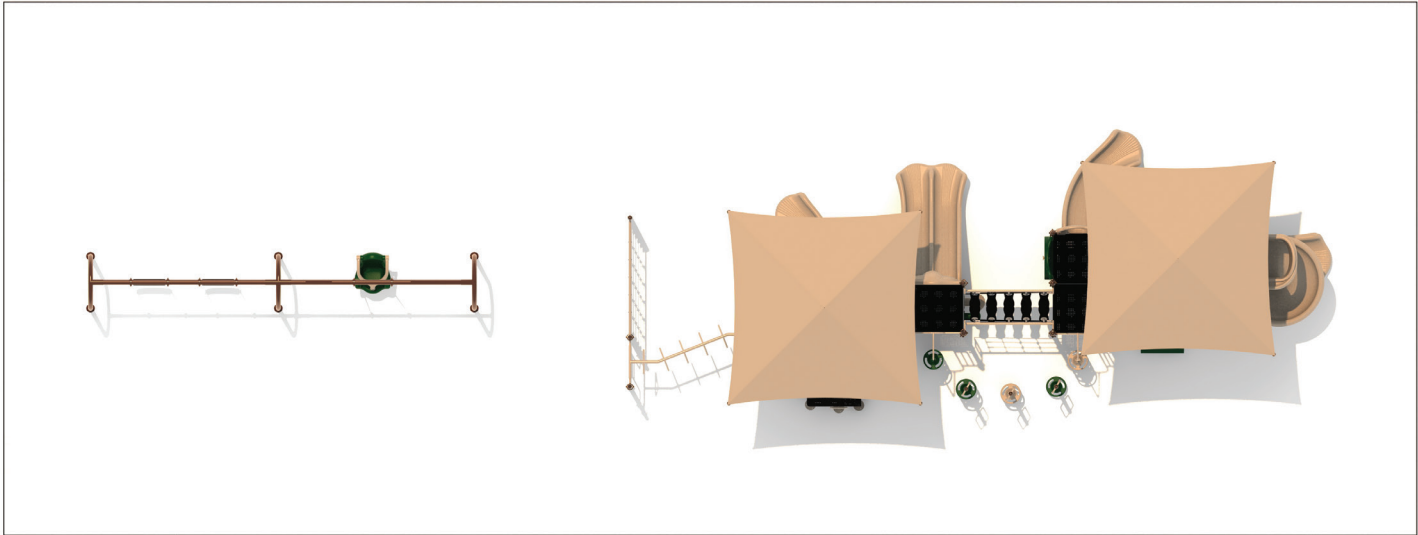

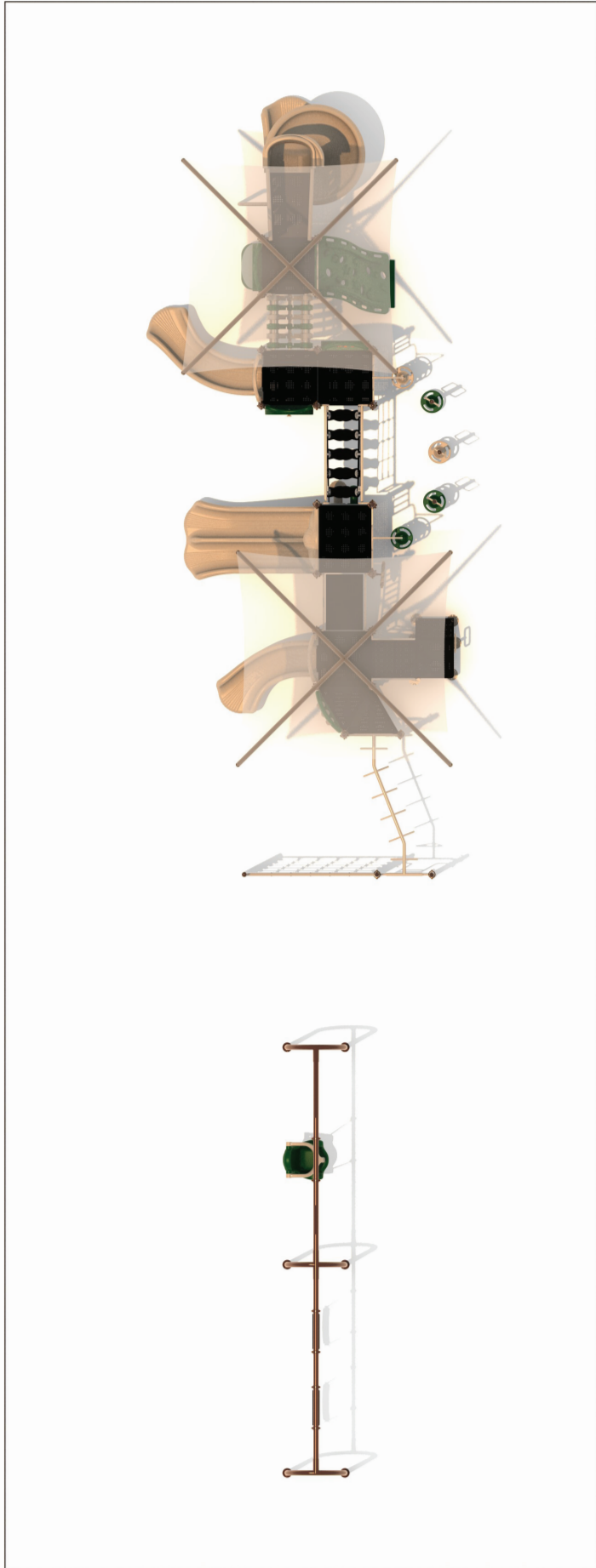

Compliance:
 This play structure has been designed to meet the safety requirements established in:
 - 2010 ADA Standard
 - ASTM F1487
 - CPSC Pub #325
 when the play structure is installed over a properly maintained surfacing material which is in compliance with:
 - ASTM F1292
 - ASTM F1951
 and is appropriate for the highest designated play surface of the structure.

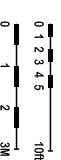
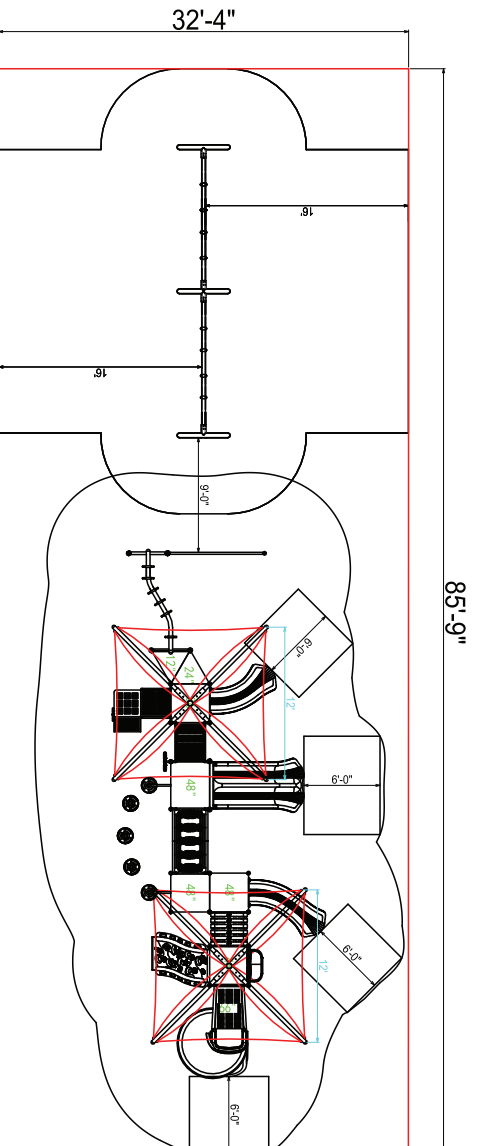

Drawing No.: KP-31305 ASF-350802 Date: 18-03-2022 Scale: To Fit	Structure Size: 41'-9"X16'-10"X15'-8" Recommended Use Zone: 85'-9"X32'-4" Surface Area: 2838 Sq Ft	HDPS: 84" Age Group: 2-12 Capacity: 52-56 Weight: 5139 lbs	Creative Recreational Systems, Inc
--	--	---	---