



Use Zone: 113' x 50'



ADA Access: Yes



Age Group: 5-12



Occupancy: 64-68



Free Shipping!

COMPONENTS: Transfer Station / Talk Tube / D-shape Challenge Ladder / Maze Panel / Tic-Tac-Toe Panel / Triple Sectional Slide / Guardrail / Arch Bridge / Spiral Slide / Rise Inter Steps / Wave Slide / Leaf Climber / Net Climber / Double Slide Desk / Vertical Rock Climber / Four Leaf Roof / Gear Panel (Above) / Racing Game Panel (Below)



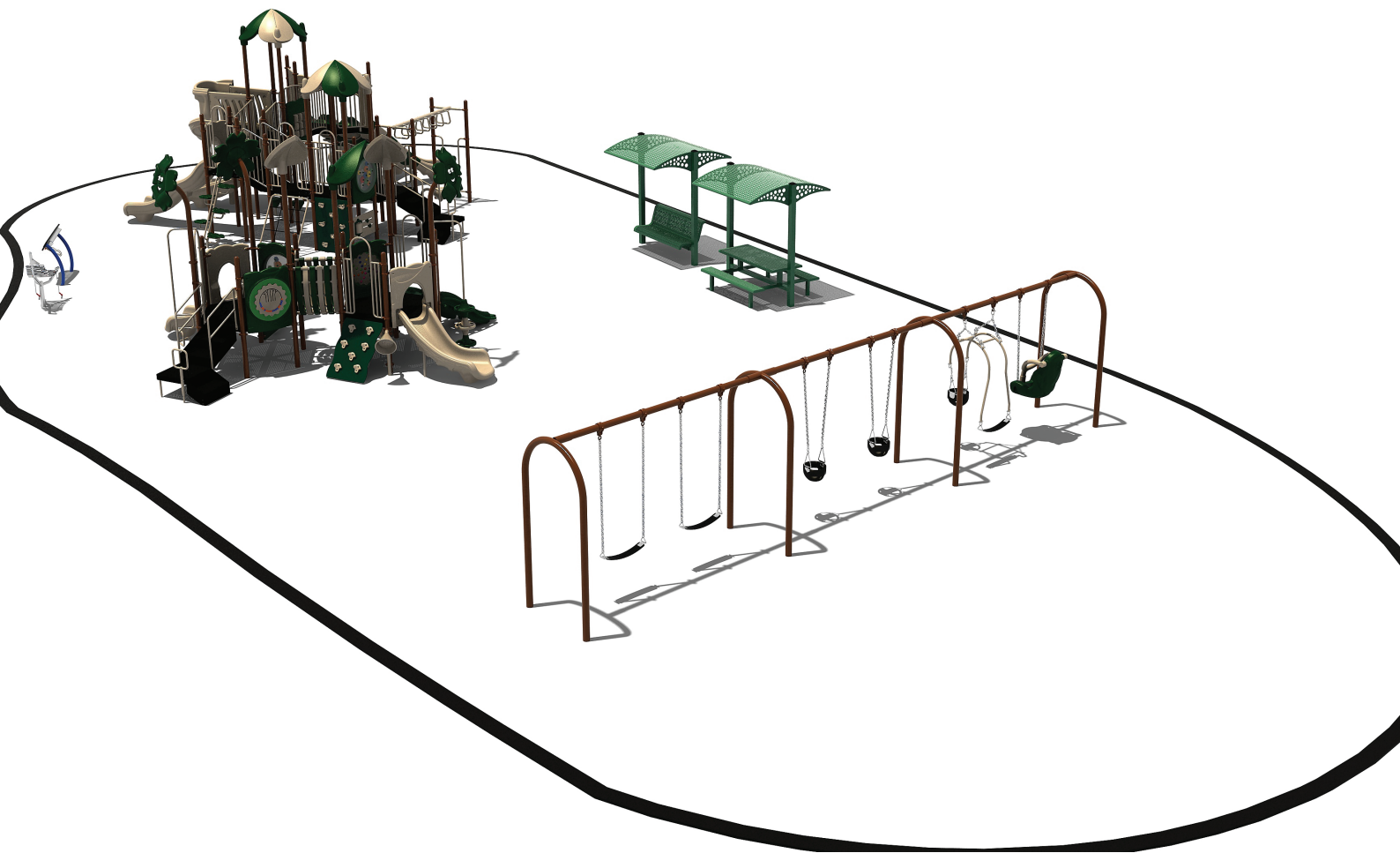



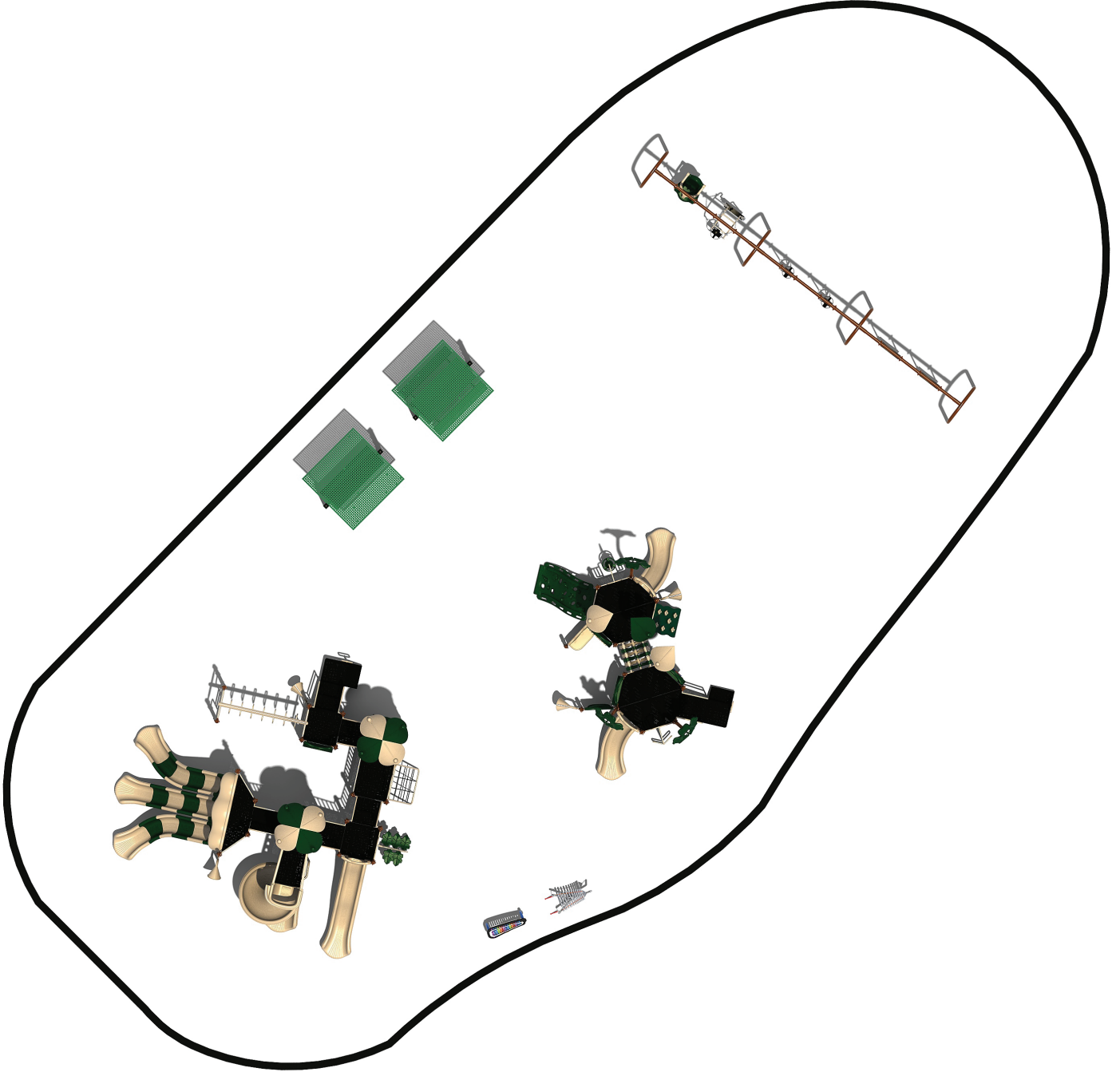

110'-0"

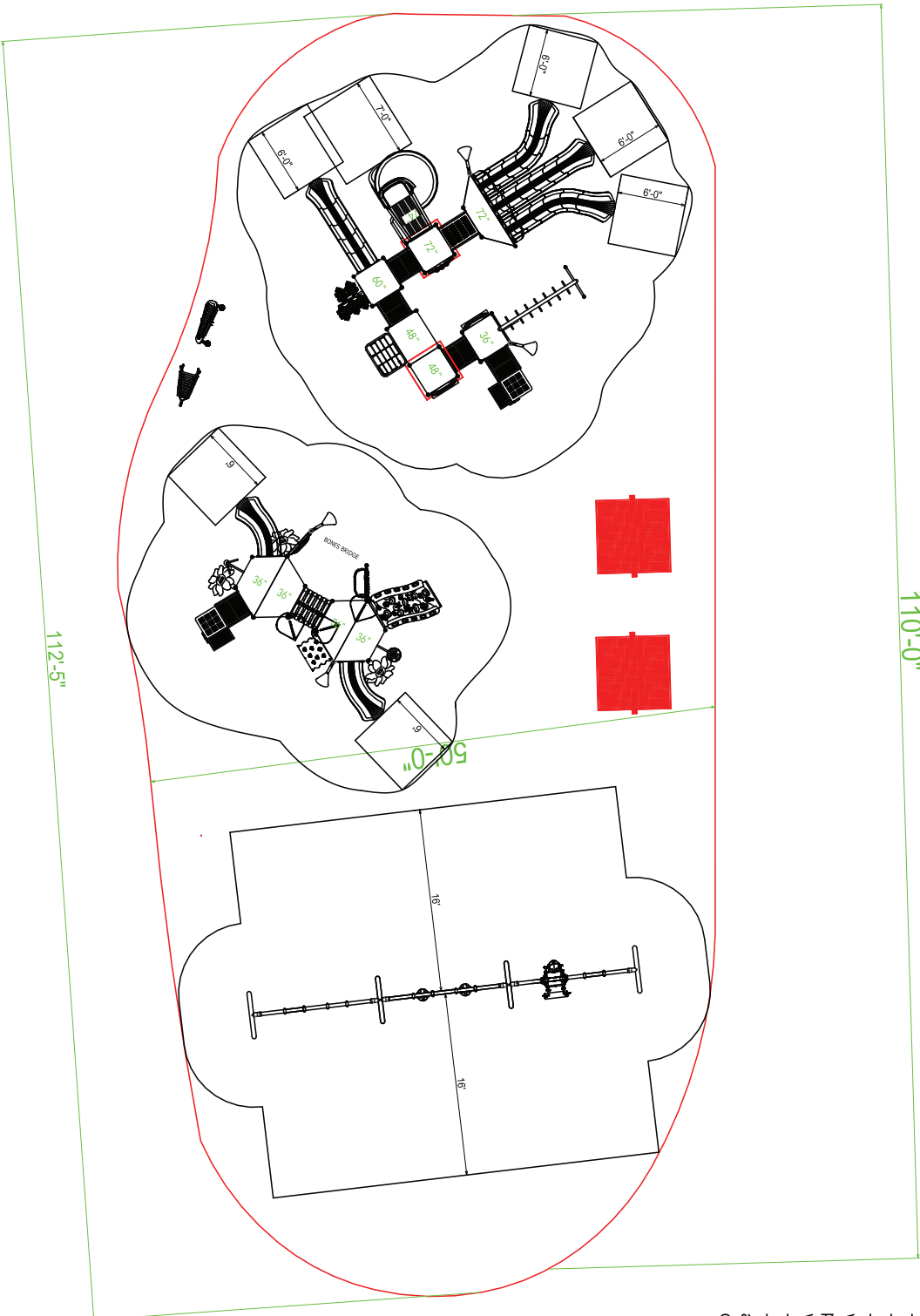

Compliance:
 This play structure has been designed to meet the safety requirements established in:
 - 2010 ADA Standard
 - ASTM F1487
 - CPSC Pub #325
 when the play structure is installed over a properly maintained surfacing material which is in compliance with:
 - ASTM F1292
 - ASTM F1951
 and is appropriate for the highest designated play surface of the structure.



Drawing No: KP-22022 KP-39456 Date: 27-10-2022 Scale: To Fit	ASF-350803	Structure Size: 25'-1"X26'-8"X15'-10" Recommended Use Zone: 112'-5"X50'-0" Surface Area: 5650 Sq Ft	HDPS: 7 Age Group: 5-12 Capacity: 64-68 Weight: 9058 lbs	Creative Recreational Systems, Inc
--	------------	---	---	---