



Use Zone: 71' x 40'



Age Group: 5-12



Occupancy: 48-52



Free Shipping!

**COMPONENTS:** Rock Climber / Fireman's Pole / Interdeck Steps / Double Straight Slide / Insect Panel / Rise Inter Step / Transfer Station / Invert Arch Climber / Wheel Challenge Ladder / Frog Pod Challenge Ladder / Invert Arch Challenge Ladder / Pod Step / Double Parallel Bar / Net Climber / Zig-Zag Challenge Ladder / Arch Rock Climber



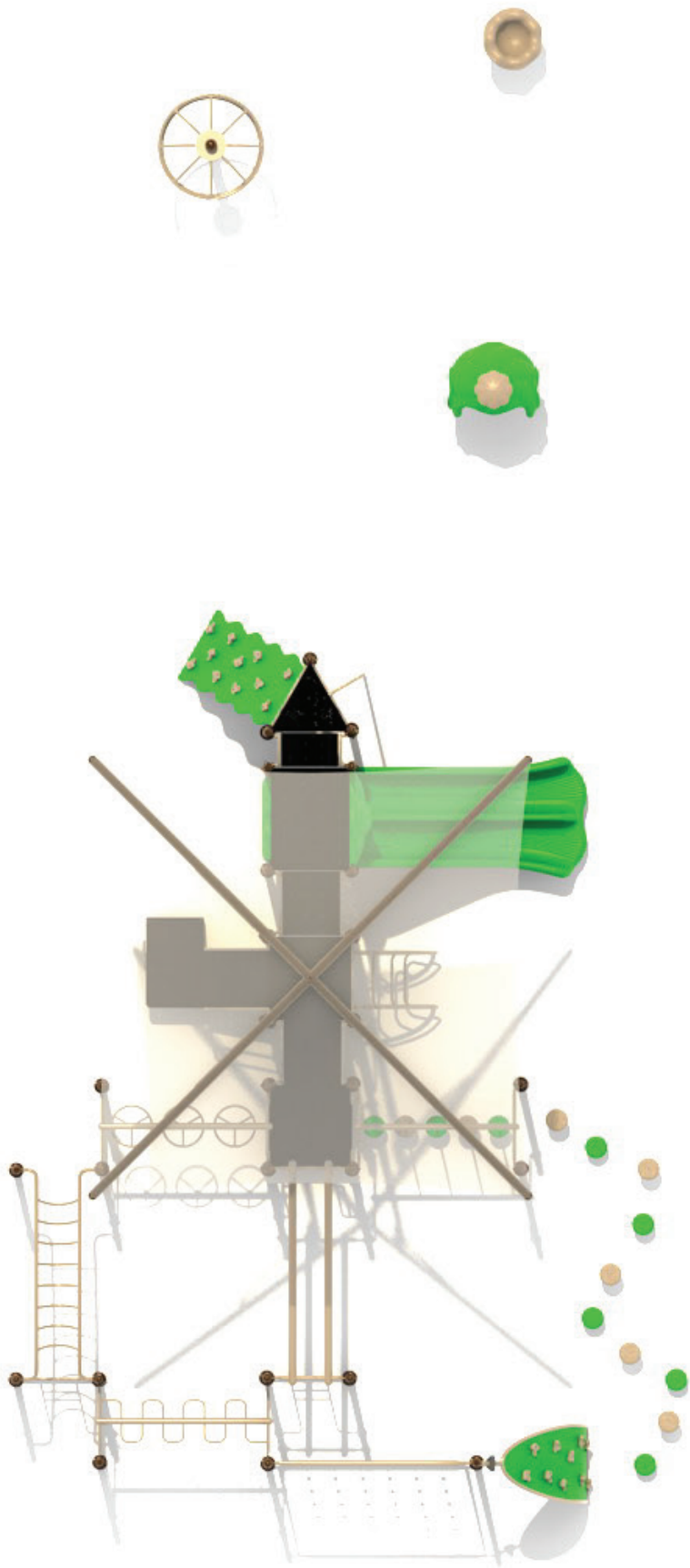

**Compliance:**  
 This play structure has been designed to meet the safety requirements established in:

- 2010 ADA Standard
- ASTM F1487
- CPSC Pub #325

when the play structure is installed over a properly maintained surfacing material which is in compliance with:

- ASTM F1292
- ASTM F1951

and is appropriate for the highest designated play surface of the structure.

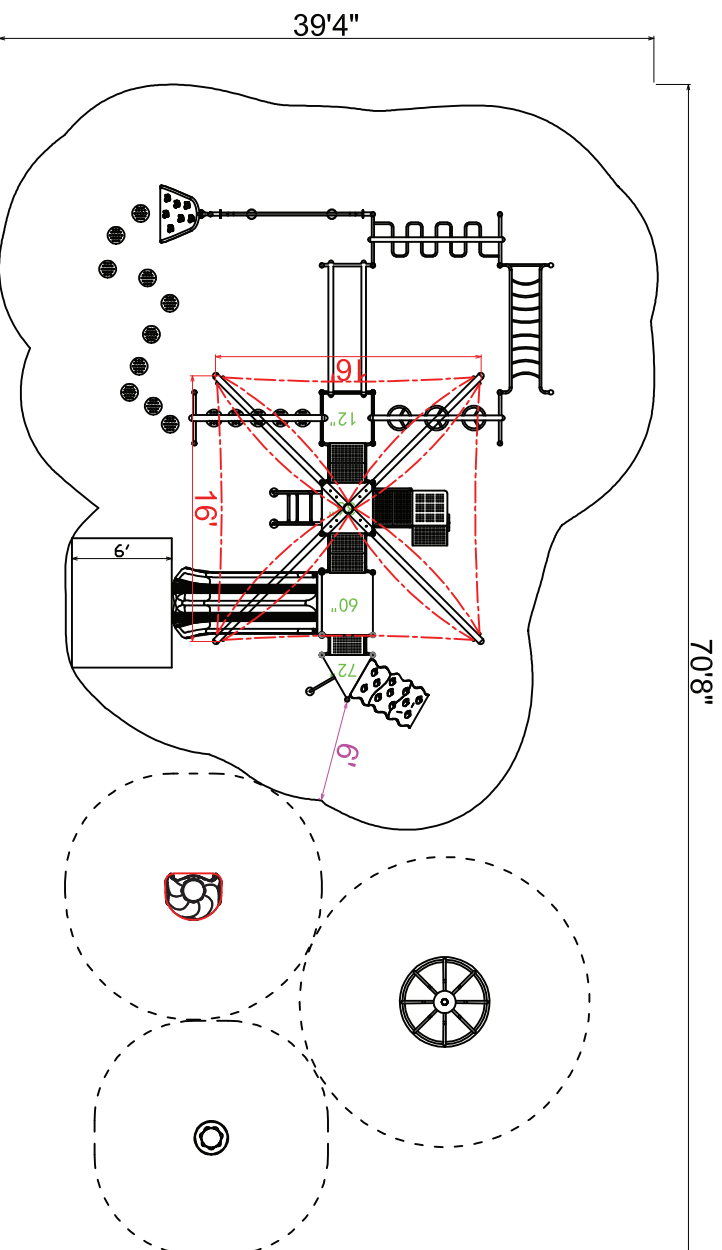

**Greenlee County**  
**KP-32735**

Drawing No.: KP-32735 FS-1604  
 FS-1606 FS-1603

Date: 02-04-2020

Scale: To Fit

Structure Size: 27'-4" x 32'-8" x 14'-6"

Recommended Use Zone:

39'-4" x 44'-9"

Surface Area:

HDPs: 7'

Age Group: 5-12

Capacity: 48-52

**Creative  
 Recreational  
 Systems**