



# Yellowstone

User Manual Version 1.0





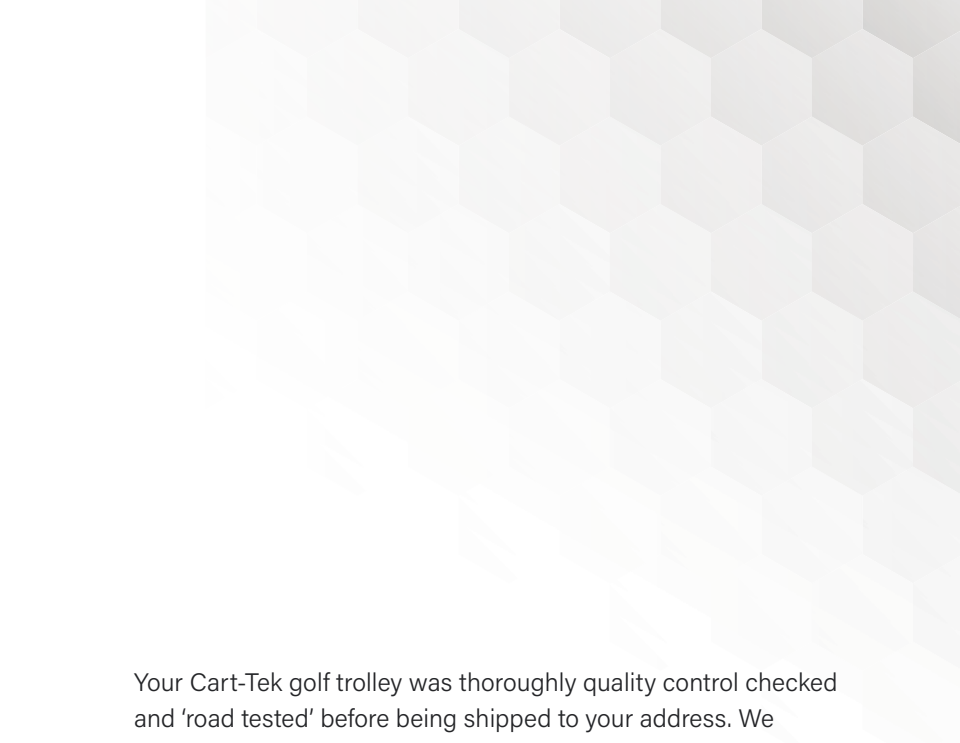

Your Cart-Tek golf trolley was thoroughly quality control checked and 'road tested' before being shipped to your address. We do everything possible to assure that your trolley is in perfect working order upon arrival.

Should you have any questions about the performance of your trolley, please contact us at:

**USA:**

Online: [Carttek.com](http://Carttek.com)

Phone: 541-633-4308

Email: [Sales@CartTek.com](mailto:Sales@CartTek.com)

**Canada:**

Online: [JPSMGolf.com](http://JPSMGolf.com)

Toll free: 1-855-839-1600

Email: [Support@JPSMGolf.com](mailto:Support@JPSMGolf.com)

For current version of this manual:

<http://www.carttek.com/golf-cart-resources/cart-tek-manuals/>

If you've purchased your caddy through a third party, be sure to register for your full warranty at:

<https://www.carttek.com/register>

# TABLE OF CONTENTS

---

INTRODUCTION .....	5
COMPONENT IDENTIFICATION .....	6
INITIAL ASSEMBLY INSTRUCTIONS.....	8
PRECAUTIONS & IMPORTANT CARE INFORMATION.....	10
BATTERY MAINTENANCE .....	12
POWERING YOUR YELLOWSTONE .....	13
PUTTING YOUR TROLLEY INTO MANUAL MODE .....	14
REMOTE TRANSMITTER .....	15
REMOTE CONTROL MODE.....	16
ALIGNMENT SYSTEM .....	17
PROGRAMMING YOUR CADDY .....	18
TROUBLESHOOTING GUIDE .....	22
IMPORTANT CUSTOMER CARE INFORMATION .....	26

# INTRODUCTION

---

Thank you for purchasing the Cart-Tek Yellowstone golf trolley. **Please read this manual carefully before use.** After unpacking, please keep the carton and all internal sections in safe storage. In the unlikely possibility that you need to return the whole unit due to a defective component, you will need to repack the unit in the original manner to ensure safe and secure transit. Remove all components from carton and check that the following are included in the package:

- Main trolley components
  - Handle assembly
  - Axle assembly
  - Front wheel frame
- Optional remote control
- Drive wheels
- Lithium battery in a neoprene battery bag
- Anti-tip wheel
- Battery charger
- Accessories
- Tool Kit

Contents of this manual cover assembling the trolley, operating instructions, maintenance, and troubleshooting. Please note that our design and manufacturing policy is aimed at continuous improvement, this can result in changes without notice to the specifications contained on our websites and in this manual. We know you are eager to get on the course, but **PLEASE READ** the entire manual before starting.

## »»» QUICK TIP

After unpacking the caddy and while reading this manual, charge the battery while you assemble the unit. Plug battery into charger and charger into power source. The battery may be delivered with a charge but should be placed on the charger before using for the first time to ensure full charge of battery.

# COMPONENT IDENTIFICATION







# INITIAL ASSEMBLY INSTRUCTIONS

---

1. Remove components from packaging and verify you have the following:

- Front wheel assembly
- Axle assembly
- Handle Assembly
- Anti-Tip Wheel
- Remote Control
- Battery Charger
- Accessories if included
- Tool Kit

2. Install the front wheel assembly into the axle assembly. Align bolt holes, and install bolts as shown below:

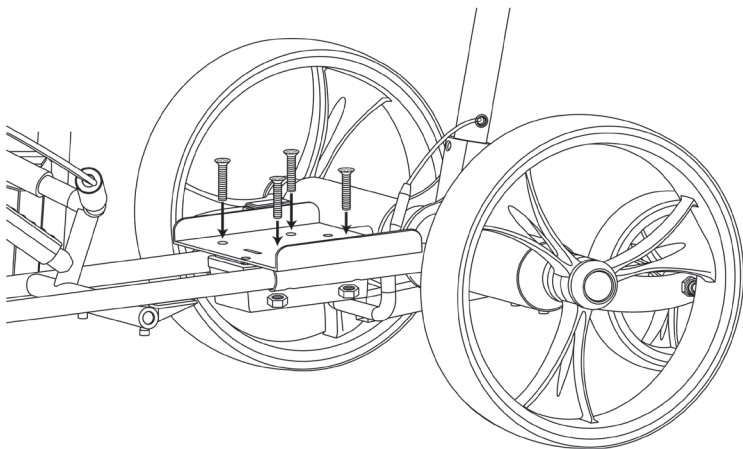

3. Install the 2 large drive wheels. The wheels are unidirectional. Wheel hubs are marked "L" for left, and "R" for right as oriented behind the cart. Depress knob on the inside wheel hub and slide wheel onto axle. Fully insert wheel onto drive collar, with the four pins fully engaged. (For "free wheel" mode, depress and pull wheel out 1/4th of an inch, releasing pins and making sure wheels snaps into groove on axle.)



4. Install Handle assembly onto axle as shown below. Slide nylon end of the handle into it's location, aligning the through holes. Install pivot bolt as shown. Press the two halves of the connector together to complete the data line. You should hear a slight click.

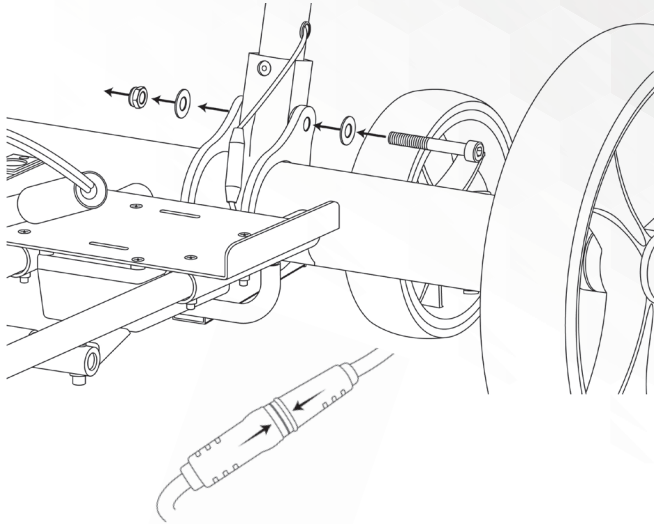

5. Install rear anti-tip wheel. Under axle pull out the anti-tip wheel lock pin and slide anti-tip wheel in frame until locked.
6. Lift handle from lower caddy frame. You may need to lightly hold down lower frame with your foot.
7. Lift upper handle and extend handle fully to desired position. Lock into position with black locking knob located behind the upper bag rest.
8. Place battery in tray. Insert battery cable into battery port, making sure to align pins.
9. Load golf bag onto caddy bottom first. Balance weight of golf bag equally 'side to side'. Secure golf bag with bungees.
10. Securing your golf bag on the cart locks the cart in the "open" position. It is important that both top and bottom bag straps are tight, and your bag is firmly secured in the bag rests. If the bungees are loose, and your golf bag is rotating in the bag rest, you can tie a knot in the bungee to shorten the length, and make it tighter.

# PRECAUTIONS & IMPORTANT CARE INFORMATION

---

1. A normal cart bag will result in best caddy performance, where lightweight stand or carry bags may not work well for you. For best performance heavy cart bags are preferred. If you use a carry bag or stand bag you will need to add weight. (See # 5 below)
2. Consider the all-around weight distribution of your golf bag. Ensure the bag is balanced evenly side-to-side. Uneven weight distribution may lead to "tracking errors" i.e. too much weight on the right side will cause caddy to veer to the left.
3. The front wheel must stay grounded during play. The only exception is on steep inclines. Your Yellowstone should only tip onto the rear wheel when on extreme inclines (Over 25° inclines).
4. It is best to use manual/trolley mode on steep inclines where caddy will tip back, and the front wheel comes off the ground. Avoid steering the caddy with the remote control if the front wheel is not touching the ground.
5. If you are having issues keeping the front wheel down on the ground, consider adding weight to your golf bag, towards the front of the caddie. We usually recommend carrying extra golf balls, a bottle of water, etc to increase the weight over the front wheel.
6. Do not pull the cart backwards while riding in a power cart.



---

**IMPORTANT TIP.** Do not use the 'parking brake' button when going down steep inclines. For best control of caddy, use the 'reverse' arrow to decrease speed. If you need to stop your caddy on a steep incline, turn the caddy perpendicular (across) the hill and press the Park button.

7. Periodically spray the front and anti-tip wheel bearings with a silicone based lubricant.
8. Replace remote batteries if you experience missed commands. A set of fresh AAA batteries will last approximately 10-20 rounds of golf depending on course.

# BATTERY MAINTENANCE

---

- The LED on the charger will be solid green when NOT charging. The LED on the charger will be solid red when charging.
- Following a complete charging cycle, the LED is solid green.
- Unplug battery from caddy and charger when not in use.
- Always recharge battery after every golf outing. Never leave the battery in an uncharged state.
- During periods of inactivity/storage, charge your battery ever 60-90 days. Do not leave the charger connected to the battery for more than 1-2 days. Disconnect the battery once it is charged.

# POWERING YOUR YELLOWSTONE

---

1. Place your battery into the battery tray.
2. Plug battery cable into the caddy.
3. The Yellowstone should now have a solid blue LED. Your caddy is now On and in "ready" mode.



# PUTTING YOUR TROLLEY INTO MANUAL MODE

---

- With your cart in ready mode (solid blue status LED), turn speed dial back to zero – counter clockwise. There will be a hard stop at Zero.
- Press and release the start/stop button to engage trolley mode.
- Rotate speed dial clockwise to increase the speed of caddy.
- Rotate speed dial counter-clockwise to decrease the speed of the caddy.
- In manual mode there are three ways to stop your caddy.
  - » Turn the speed dial backwards, to zero.
  - » Push the On/Off button on the end of the handle.
  - » Push one of the “Stop” buttons on the remote control.
- To resume use in manual mode, either press the on/off switch to resume the currently set speed, or turn the speed dial back to zero and then turn the speed dial clockwise to the desired speed.

# REMOTE TRANSMITTER

- To turn the remote On: Press and release both the left and right turn buttons (blue) at the same time. The remote LED will flash blue 3 times indicating the remote has turned on.
- To turn the remote OFF: Press and hold Park button until remote LED flashes red 3 times.

If the remote has no button presses in 30 minutes, it automatically turns off to conserve battery life.





# REMOTE CONTROL MODE

---

- When the BLUE LED light on the caddy is solid you are ready for remote control transmission. Ready mode is long/short cadence flash. Same as when 1st plugged in. Light goes solid after using the remote.
- Turn the remote on by pressing and releasing the left and right turn buttons (blue) at the same time. The remote will flash blue 3 times.
- Push the directional buttons to move the caddy.
- When stopped, press and holding either the Left or Right turn, the caddy will turn on itself.
- While caddy is moving forward, a quick push of 'left' or 'right' arrow button will adjust the caddy's direction.
- To increase the speed. Press the 'forward' button. To decrease speed, press the 'reverse' button.
- To stop the caddy on level ground, use the 'Stop' Button.
- To park the caddy on an incline, hit the Stop button, turn caddy across the hill, and then hit the Park button to activate the electronic parking brake.
- The range of the transmitter is 100 yards depending on environmental conditions. The cart will stop when it is outside of the remote transmitters range.
- We recommend you operate your caddy within 10-20 yards for best control and visibility.
- For your protection the caddy has a 120 second hibernation timer. If no buttons are pressed within 120 seconds the caddy will stop. Simply give the caddy another go command, and the caddy shall resume movement down the fairway.

# ALIGNMENT SYSTEM

---

If you have issues with your trolley not going straight, you may have to adjust the tracking. Keep in mind that the cart will drift slightly depending on if you have steep side slopes, rough terrain, or uneven weight in your golf bag. On a perfectly flat fairway, a normal tolerance of drift is 2 feet (left or right) over a 50-foot run.

## To adjust your tracking first:

- VERIFY both wheels are fully engaged in the drive collars.
- VERIFY the weight on the golf bag is equal from Left to Right.  
Example: If you have more weight on the right side of the bag, your cart may drift to the left.
- VERIFY all connecting hardware on the Front Wheel assembly is tight
- If your golf bag is balanced, connections are tight, and your cart is still drifting, Reset the caddie to factory settings (Page 20).
- Next, try electronically adjusting tracking (Page 19)
- If you are not able to correct tracking after all the above steps, you may need to adjust the front wheel:

## To fine-tune the front wheel:

- Loosen both ends of the axle cap nuts (A).
- If the cart tracks to the LEFT move the left side of the axle forward via the adjustment nuts (B). This pushes the wheel back to the right. Tighten the Adjustment nuts (B) and Axle nuts (A) and test. *We recommend starting with a quarter-turn of the adjustment nuts first.* If the cart tracks to the RIGHT, move the left side of the axle rearward via the adjustment nuts (B). This pushes the wheel back to the left. *We recommend starting with a quarter-turn of the adjustment nuts first.*
- Tighten the Adjustment nuts (B) and Axle Cap Nuts (A).
- Test your results. You may need to repeat steps 1 and 2.

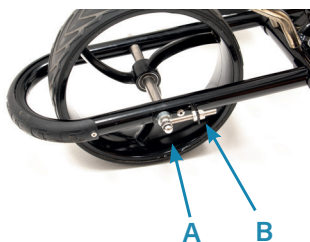

# PROGRAMMING YOUR CADDY

---

The caddy electronics may be customized for your personal preferences. All programing customization is done via the remote transmitter. Using "Program Mode" you can adjust the electronics to:

- Tracking issues- If a caddy veers off to one side, read all tracking information under 'Precautions' on page 10 and 'Troubleshooting' on page 19, before using electronic tracking adjustment.
- Adjust 'Turning Force'- Depending on your course, flatter golf courses require less turning force that hilly or undulated golf courses.
- Reset Caddy back to original Factory Settings- This is useful if your caddy accidently gets programed or you program it and you do not like the new settings.

## »»» QUICK TIP

When first using your caddy, practice in a large open area. Take the time to practice the difference between a single touch of a key and a prolonged push especially with left and right functions. Also get comfortable with the coast and parking brake buttons. Practice turning the caddy perpendicular to hills when parking on an incline.

**For the instructions below that say “go into program mode”, follow these instructions:**

Press both speed 1 and speed 2 (green buttons) until blue LED double flashes to get into programming mode. The cart will move forward at a slow speed at this time.

*If the cart does not move, repeat as your caddy is not yet in program mode.*

### **Store personal speeds**

*(NO need to go into program mode)*

- In remote mode, achieve your desired speed with the up and down buttons. Press and hold the number you want to set (i.e. #1) until the LED turns solid blue. Without releasing the button, press and hold the glide stop button until the blue LED turns off. The cart will come to a stop first, and then the LED on the remote will turn off.
  - Button is now set to new speed.
- 

### **Adjust Tracking**

*i.e. Caddy trails off to one side or the other on flat ground*

- Electronically adjust tracking only after adjusting bag weight. (Instructions for front wheel axle adjustment are in the troubleshooting section, “my caddy does not track in a straight line”, later in this manual).
- **Go into Program Mode.**
- To adjust the caddy to the left, press ‘left’ button once. Or to adjust the caddy to the right, press the ‘right’ button once. Two button presses adjusts the tracking about one foot to either side, in a 25-foot run.

*continued...*

- To save the setting, push the 'Parking Brake' button.
  - Test the caddy to see if you need further adjustment. Repeat as needed.
- 

### Adjust turning force

*You can increase or decrease the speed at which the caddy turns.*

- **Go into Program Mode.** *(two green buttons)*
  - Press the reverse button to stop the caddy.
  - Press forward to increase turning force or reverse to decrease the force. Press and hold the button until your LED becomes solid then turns off for an incremental adjustment.
    - » To test if your force is correct, press left or right. Repeat adjustments or save the turning force adjustments by pressing Park.
- 

### Return all Programing back to Original Factory Settings.

- **Go into Program Mode.** *(two green buttons)* Press reverse to stop the cart.
- Press numbers 1, 2, 3, 4, Parking Brake. Your caddy should now be at facotry settings.
- If you're cart doesn't seem to be reseting to factory settings: First, program speed 4 to a slow speed. Perform the factory reset proceedure. If the preset speed 4 returns to the fast speed, then your caddie has reset.

### Matching a “New Remote Transmitter” to your caddy.

*Should you need to replace your remote transmitter, you will need to pair (match) it to your Yellowstone. (NO need to go into program mode.)*

- Plug battery into caddy, press and hold the on/off button for 3 seconds. Make sure you have a steady flashing blue LED.
- Turn the remote on (Press 2 blue buttons).
- Press and hold speeds 3 & 4 until the both the red and blue LED's are illuminated. You can release speeds 3 and 4. You should notice the Status LED on the cart rapidly flashing (~3x/second) for a few seconds. When the carts status LED returns to a normal stead flash, the remote is paired with the cart.
- Power on the cart by holding the On/Off button until you achieve a long/short cadence flash.
- Test all remote buttons.



# TROUBLESHOOTING GUIDE

---

*My caddy will not show any indicator LED on the handle.*

1. Ensure Caddy Battery is fully engaged in the battery port.
  2. Have a full charge on the Caddy Battery. The battery should read 29.3 Volts +/- .2V
- 

*My caddy is turned on (solid BLUE LED), but my remote will not work.*

1. Verify your remote is turned on – flashing LED on remote when buttons are pressed.
2. Try restarting the caddy by disconnecting the battery for 5 seconds (blue LED on Cart has turned off), then powering the caddy back on. Test remote again.
3. Ensure that the remote has a flashing Blue LED when pressing a function button. If not, replace batteries in remote, and turn remote on again.
4. Pair remote transmitter to caddy cart receiver. Follow the directions in the manual: Matching a New Remote Transmitter to your Cart (Page 21).



***My caddy Battery Charger isn't switching over from Red to Green.***

1. Ensure both the battery and wall charger are fully plugged in.
  2. A fully depleted battery may take upwards of 6 hours to charge.
- 

***My caddy will not make 18 holes.***

1. Verify that your charger is charging fully. Your battery should read 29.3 volts.
  2. Ensure both the battery and wall charger are fully plugged in, when charging.
- 

***My caddy has erratic steering (i.e. Spins to the right/left, goes forward/backwards when pressing right/left).***

1. Ensure both wheels are fully engaged into the drive collars, located on the axles.
- 

***My caddy will not move, what can I do?***

If your caddy experiences some kind of failure on the course and you cannot get it running, you can put the caddy in "free wheel" mode.

1. Press the lock button on the inside wheel hub and pull each wheel out of the drive collar and lock the wheels into the free wheel groove on the axle.
2. In free wheel mode, you should not pull the caddy backwards for more than 5 feet.

*My caddy does not track in a straight line.*

1. Ensure both wheels are fully engaged into the drive collars located on the axles.
2. Balance golf bag evenly on your caddy side to side.
3. Reset your caddy to factory settings by following the instructions in the manual or check out our video reprogram your Yellowstone remote.
4. For slight drift, please adjust cart using "Adjust Tracking" procedure on page 13.
5. If caddy still does not go in a straight line, manually adjust tracking on the front wheel.
6. All carts are tested to see how they track for straightness with a balanced weight on the front bag rest. If your caddy is going off track more than 2 feet in 50 feet, the easiest first thing to do is to check the weight distribution of your bag. How is it sitting on the caddy, is it sitting evenly with the weight evenly distributed between left and right sides? If the weight distribution does not solve your issue, you may need to fine-tune the tracking by adjusting the front wheel axle. To fine-tune the front wheel, slightly adjust the front wheel axle.



Loosen both ends of the axle cap nuts (A) about a 1/2 of a turn. If the cart tracks to the left move the left side of the axle forward via the adjustment nuts (B) (spin both nuts counter clockwise). If your cart tracks to the right, spin both nuts (B) clockwise. Test the tracking after each adjustment. It should only take a few minor adjustments.

### ***My caddy stops unexpectedly during a round.***

1. The Yellowstone remote is equipped with a 120 second timer that stops the caddy if you do not press additional buttons, within that time period.
2. Check indicator LED's on end of caddy handle.
  - No light – Make sure your battery is connected to the caddy receptacle.
  - Rapid flashing BLUE LED is an overload high current warning. Stop and Allow caddy to cool down. This can be caused by too much weight on your caddy or trying to climb too steep of hill.
  - Flashing BLUE LED is standby mode, you have temporarily lost and regained power. Check battery cable/connections.
  - Very Slow Flashing BLUE LED is low voltage warning. Stop, do not use the battery, and recharge battery.
3. Ensure the AAA batteries in the transmitter are fresh. New AAA's should read at 1.65 volts.
4. Due to on board electronics, there might be environmental interferences causing your caddy to stop. These may include, but are not limited to: microwaves, cell towers, high voltage electrical power lines, et cetera. If the caddy always stops at the same place every time you play, then it is likely environmental interference.

If troubleshooting did not help you solve your problem, please do not hesitate to check our website, call or e-mail Cart Tek directly to speak with one of our qualified technicians.

# IMPORTANT CUSTOMER CARE INFORMATION

---

1. Never spray caddy down with flowing water. Instead, simply wipe down the cart with a wet/damp cloth.
2. For best performance, cart bags are preferred. If you use a carry bag or a stand bag, you may need to add weight to your bag.
3. Your golf bag should be secure in the upper and lower bag rests, with bungees tight. The bag should not move around on the caddie.
4. Consider the all-around weight distribution of your golf bag. Ensure the bag is balanced evenly side-to-side. Uneven weight distribution may lead to tracking errors. If there is too much weight on right side, the caddy will veer to the left.
5. The cart is designed to be operated remotely when the front wheel is on the ground. If you're going up a steep incline, the caddy may tip back, onto the anti-tip wheel. If the front wheel is tipping off the ground, it is suggested to use the caddy in trolley mode up that hill.
6. If you are having issues keeping the front wheel down on the ground, consider carrying extra bottles of water, extra golf balls, etc to keep weight over the front wheel.
7. Do not use the brake button when going down steep inclines. For best control of cart use the reverse arrow to decrease speed. If you need to stop your cart on a decline, turn the cart perpendicular (across) to the hill and use the parking brake.
8. Periodically spray the front and anti-tip wheel bearings with silicone based lubricant (not WD-40)
9. Do keep a set of fresh unopened AAA batteries and a Philips screwdriver in your golf bag for your remote. Replace remote batteries if you experience missed commands.





**FOR WARRANTY, SPARE PARTS AND ACCESSORIES**

*For trolleys purchased in the USA*

**Cart Tek Golf Carts**

150 SE Logsdan St.

Bend, OR

97702

**Email:** [Sales@CartTek.com](mailto:Sales@CartTek.com)

**Website:** <http://www.CartTek.com>

1-541-633-4308 or toll free 1-866-356-2278

*For trolleys purchased in Canada*

**JPSMGolf**

1064 Salk Road

Units 15+16

Pickering, Ontario

L1W 4B5

**Email:** [Support@JPSMGolf.com](mailto:Support@JPSMGolf.com)

**Website:** <http://JPSMGolf.com>

1-905-839-1600 or toll free 1-855-839-1600