

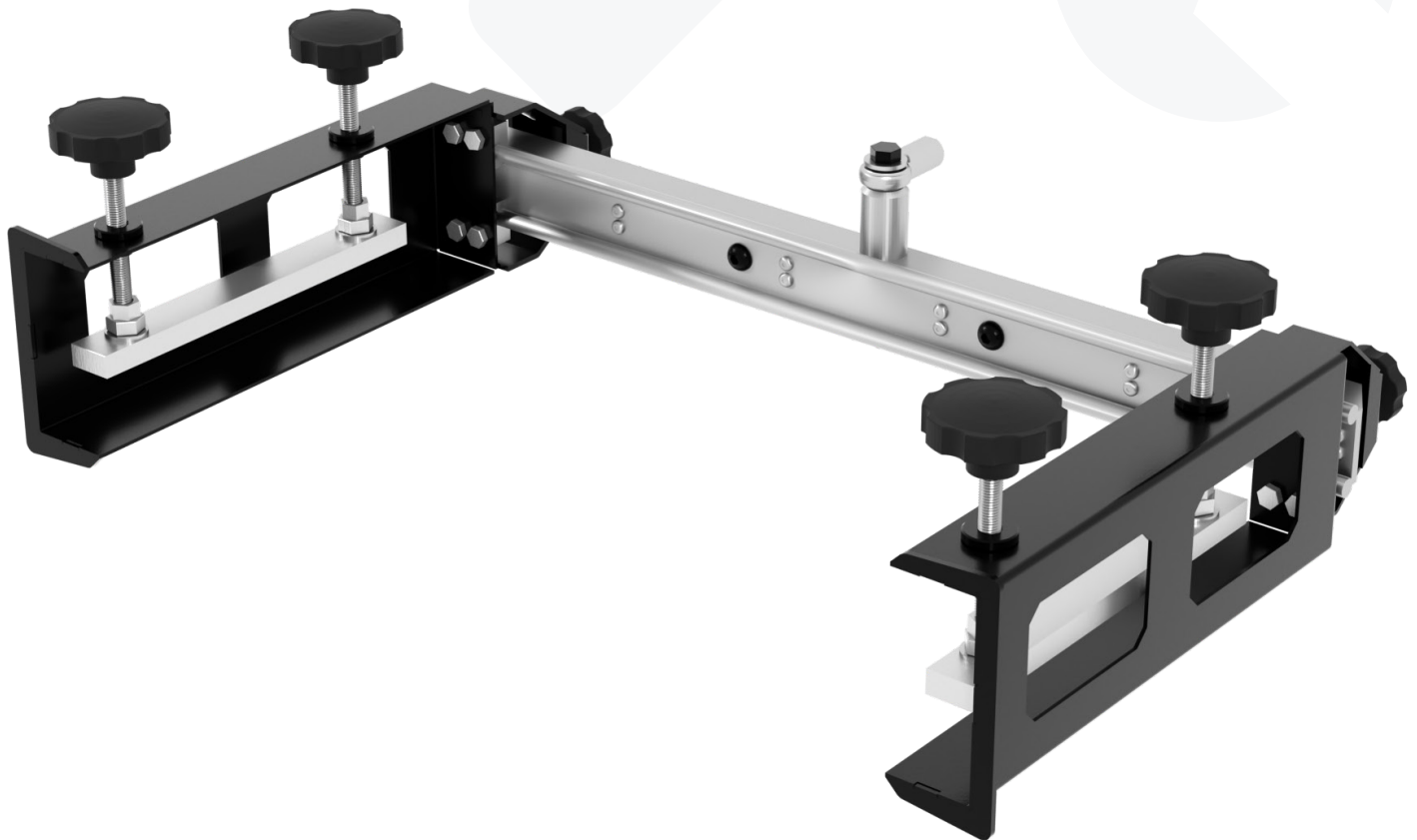

**Assembly Instructions**

*Riley Hopkins*<sup>®</sup>

**SIDE CLAMP FOR 300 SERIES**





## Tools Required:

- One 9/16" wrench
- One 10mm wrench

What's in the box

Tag	ITEM	Qty.
1	SIDE CLAMP CROSS BAR WITH HARDWARE	1 PER UNIT
2	SIDE CLAMP MAIN BODY ( RIGHT HAND SHOWN )	2 PER COLOR
3	EXTENDED OFF-CONTACT BRACKETS ( 8 COLOR ONLY )	2 PER STATION
4	EXTENDED TILT KNOB ( 8 COLOR ONLY )	1 PER COLOR

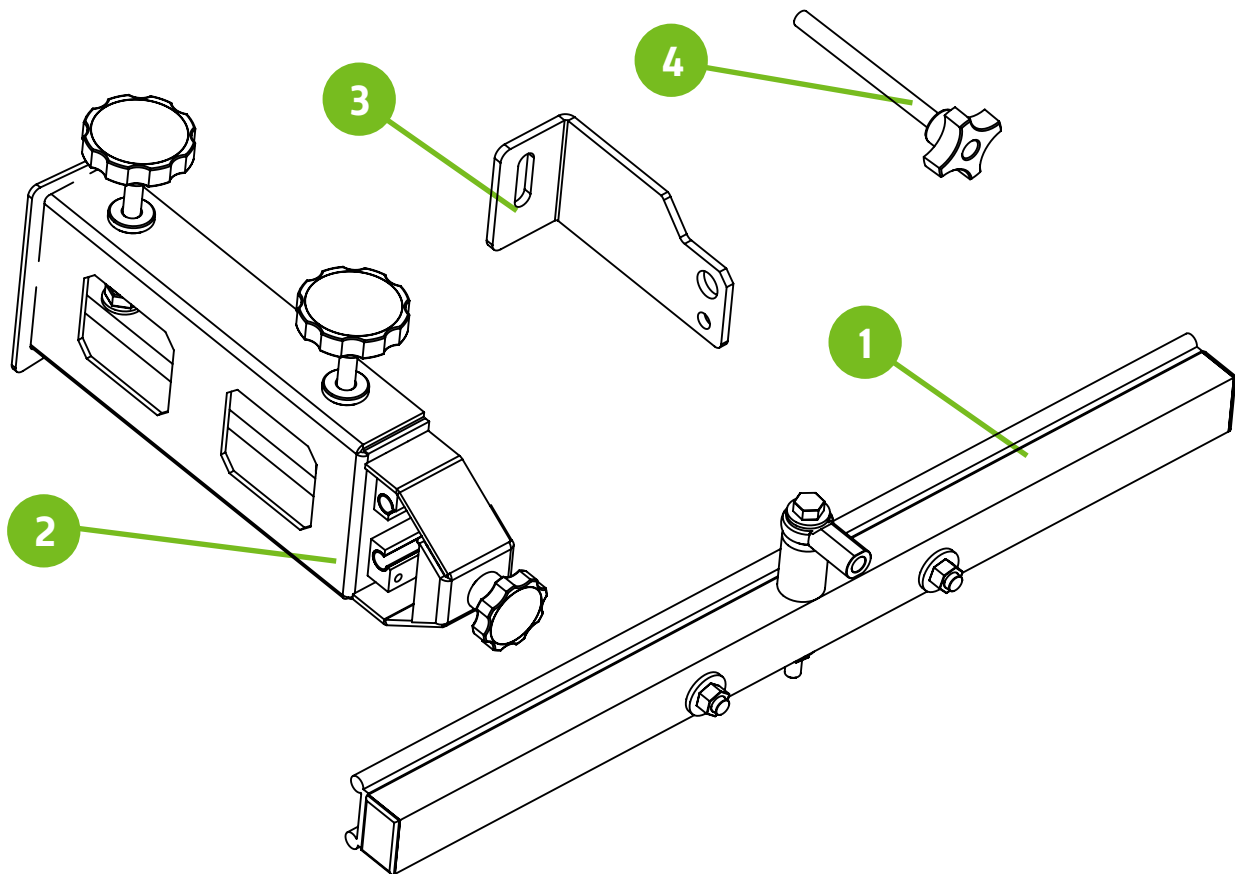

## STEP 1

If you have a 4 or 6 color press, skip this step.

Replace the tilts knob assembly (1) with the extended version. Unlock from the rod end with two 9/16" wrenches. Re-lock the new knob assembly to the rod end.

Replace the off-contact brackets (2) with the extended versions.

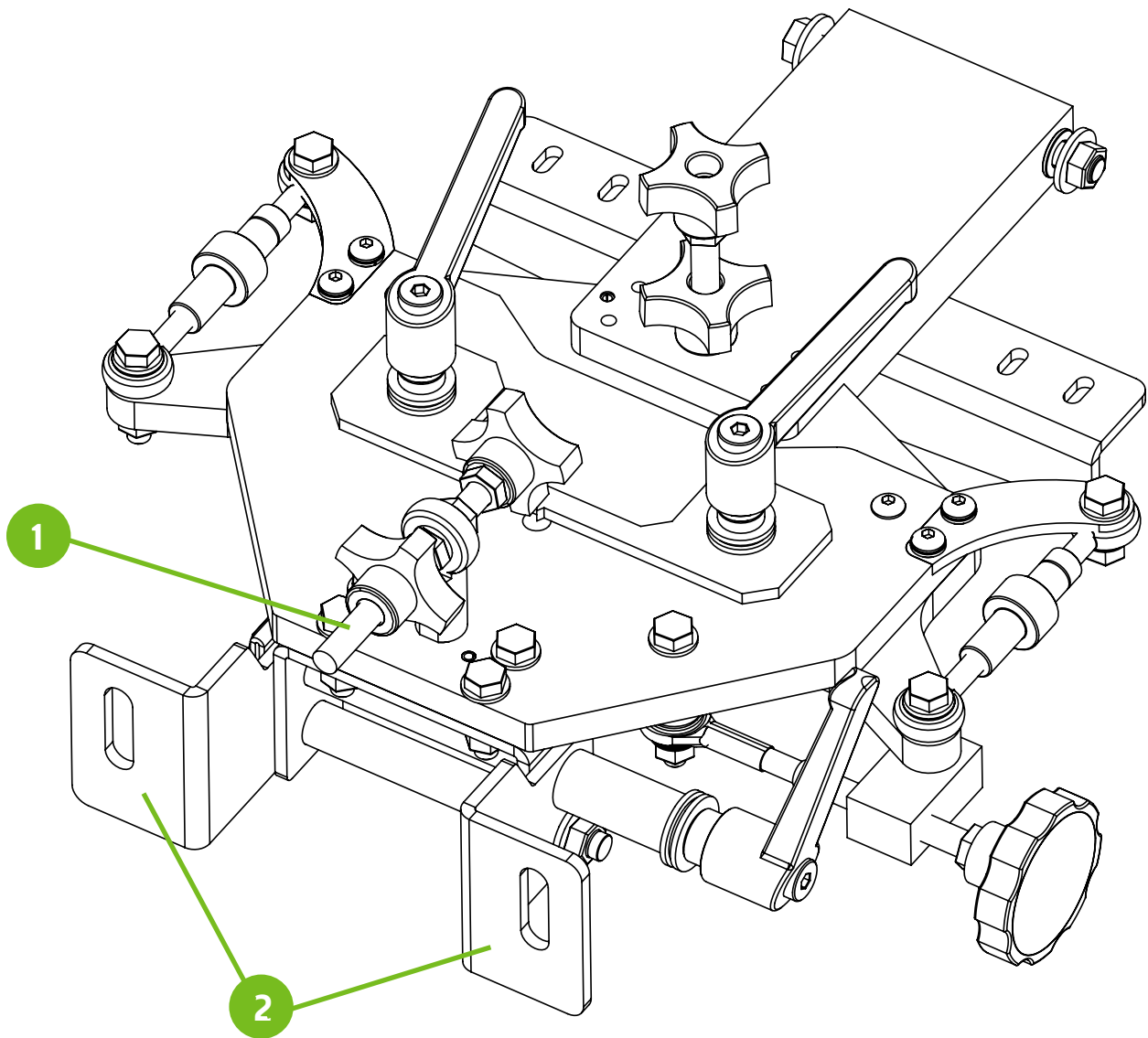

## STEP 2 - Side clamp cross bar installation.

Insert the threaded tilt knob (1) into the female rod end on the print head assembly. Thread into rod ends until cross bar makes flat contact with tilt brackets. Tighten hardware at this time. See image key below.

### Image key:

1. Tilt knob assembly with locking jam knob
2. 3/8" fixed mounting bolts
3. 3/8" hardened washers
4. 3/8" hex nuts

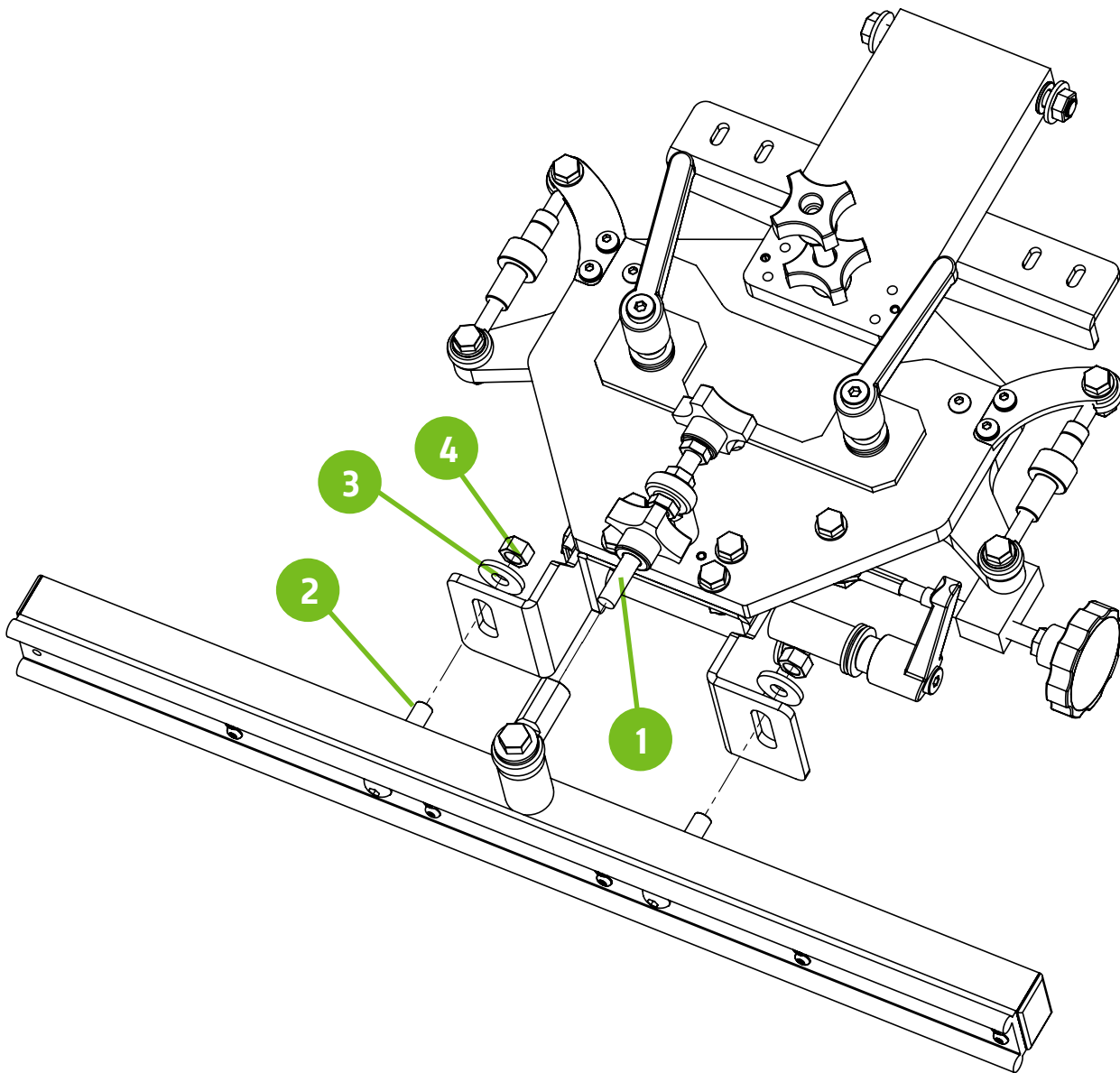

## STEP 2 - Side clamp body installation

Insert side clamp body assemblies onto the sliding rail assemblies **(1)**. Do not use force to install. If there are challenges installing body, loosen hardware slightly on sliding pillow blocks **(2)**.

A 10 mm wrench is required for this step. Re-tighten hardware once installed on slider assembly. To hold clamp body in place on slider bar, lock down the knob **(3)**.

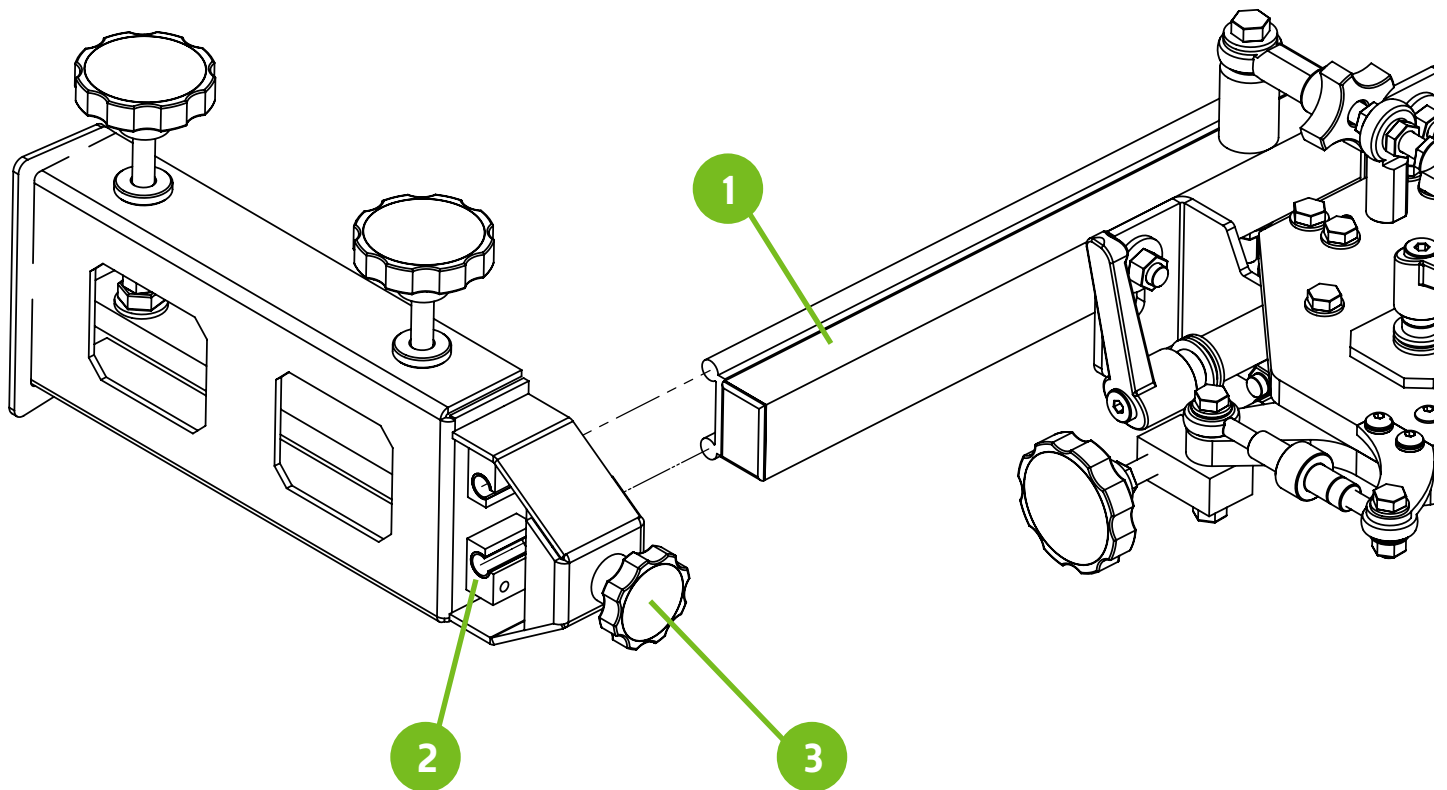

## STEP 2 - Side clamp cross bar installation.

Level the screen clamping heads to the pallets. This one-time setting will work for the vast majority of printing jobs. Future adjustment may be required to accommodate “custom” platens that are much higher than standard.

### Image key:

1. Ensure the print head arm is level with the print station.
2. Make sure registration gate setting will allow for height adjustment and still lock in place.
3. Lock down a flat board in screen clamp to set them level to the platens.
4. Use a 9/16” wrench to adjust the hardware in the slotted off-contact brackets.
5. **DONOT** adjust this factory set off-contact riser.

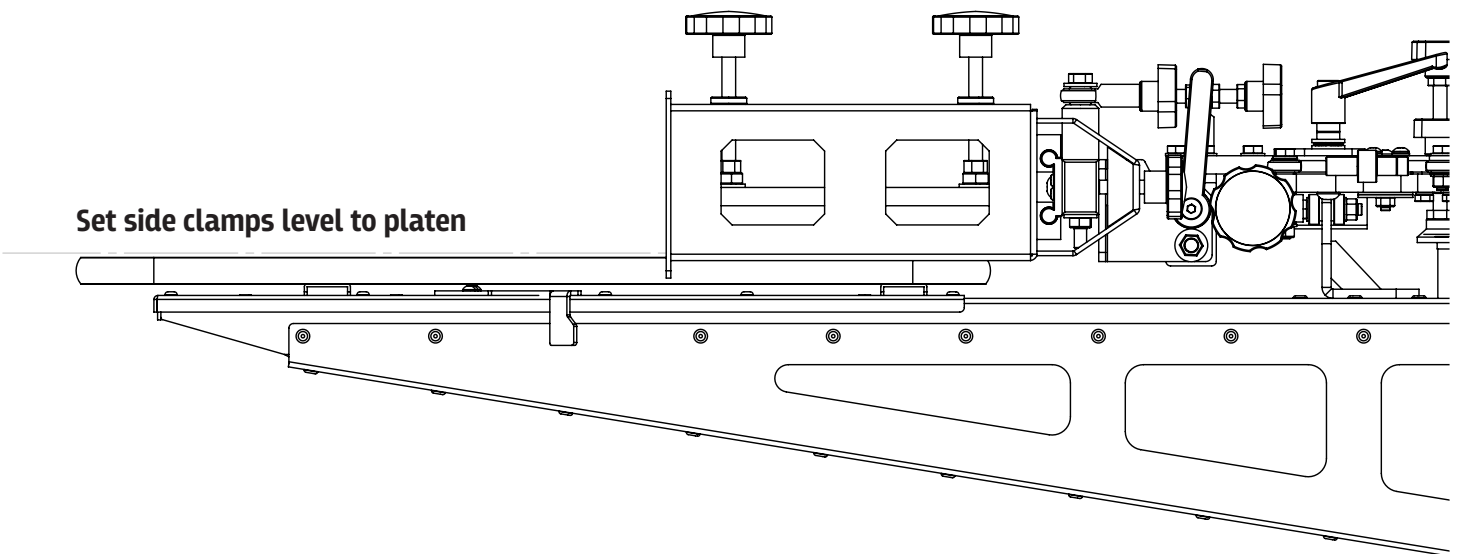

*Riley Hopkins*<sup>®</sup>