

## Nexus 120 Sounder Beacon (DC)

The Nexus 120 is a very high output sounder beacon designed for fire and industrial applications. Connections are made to the base during the initial wiring phase which results in faster and more reliable installation. In addition, the head is fixed by quarter turn fasteners enabling faster installation and accurate seal compression for weatherproofing. IP66 as standard means that Nexus can be installed in almost any location. The Nexus Sounder Beacon is available with a high efficiency LED or xenon beacon. The combination of powerful sounder and high output beacon ensures a very effective audio-visual signal. 105dB and 110dB units, as well as AC variants, are also available.

### Features

- High sound output 120dB (typical)
- Three alarm stages
- 5J xenon or high efficiency LED beacon option
- Quarter turn fasteners for ease of installation
- First-fix, wire to base technology
- IP66 rated
- Volume control for greater flexibility - 20dB
- Low in-rush current (LED only)
- Static/flashing mode (LED only)
- 64 tones
- Separate connections for sounder & beacon

### Lens Colour Options



**Applications** - Fire alarm; conveyors; process control alarm; cranes; moving machinery; general signalling; marine

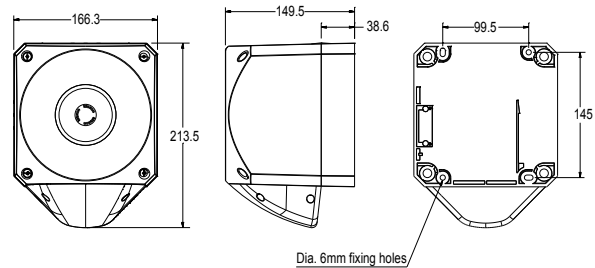

## Specifications

| Part No. | Lens Colour | Beacon Type  | Audibility at 1m | Tones | Voltage   | Sounder Current | Beacon Current |
|----------|-------------|--------------|------------------|-------|-----------|-----------------|----------------|
| PNC-0003 | Red lens    | Xenon beacon | Up to 120dB (A)  | 64    | 10-60V DC | 120-550mA       | 330mA@24V DC   |
| PNC-0004 | Amber lens  | Xenon beacon | Up to 120dB (A)  | 64    | 10-60V DC | 120-550mA       | 330mA@24V DC   |
| PNC-0022 | Clear lens  | Xenon beacon | Up to 120dB (A)  | 64    | 10-60V DC | 120-550mA       | 330mA@24V DC   |
| PNC-0057 | Blue lens   | Xenon beacon | Up to 120dB (A)  | 64    | 10-60V DC | 120-550mA       | 330mA@24V DC   |
| PNC-0055 | Green lens  | Xenon beacon | Up to 120dB (A)  | 64    | 10-60V DC | 120-550mA       | 330mA@24V DC   |
| PNC-0035 | Red lens    | LED beacon   | Up to 120dB (A)  | 64    | 10-60V DC | 120-550mA       | 18mA/65mA**    |
| PNC-0039 | Amber lens  | LED beacon   | Up to 120dB (A)  | 64    | 10-60V DC | 120-550mA       | 18mA/65mA**    |
| PNC-0059 | Clear lens  | LED beacon   | Up to 120dB (A)  | 64    | 10-60V DC | 120-550mA       | 18mA/65mA**    |
| PNC-0061 | Blue lens   | LED beacon   | Up to 120dB (A)  | 64    | 10-60V DC | 120-550mA       | 18mA/65mA**    |
| PNC-0060 | Green lens  | LED beacon   | Up to 120dB (A)  | 64    | 10-60V DC | 120-550mA       | 18mA/65mA**    |

\*\* Flashing/Static current consumption figures.

IP Rating: IP66    Operating Temp: -25°C to + 70°C    Cable Entries: 5  
Weight: 2kg    Compliance: EN54-3 Type B

**klaxon**  
Signalling Solutions