

370HK3WD24BB, 370HK3WD24RG, 370HK3WD30BB, 370HK3WD30RG,
370HK3WD36BB, 370HK3WD36RG

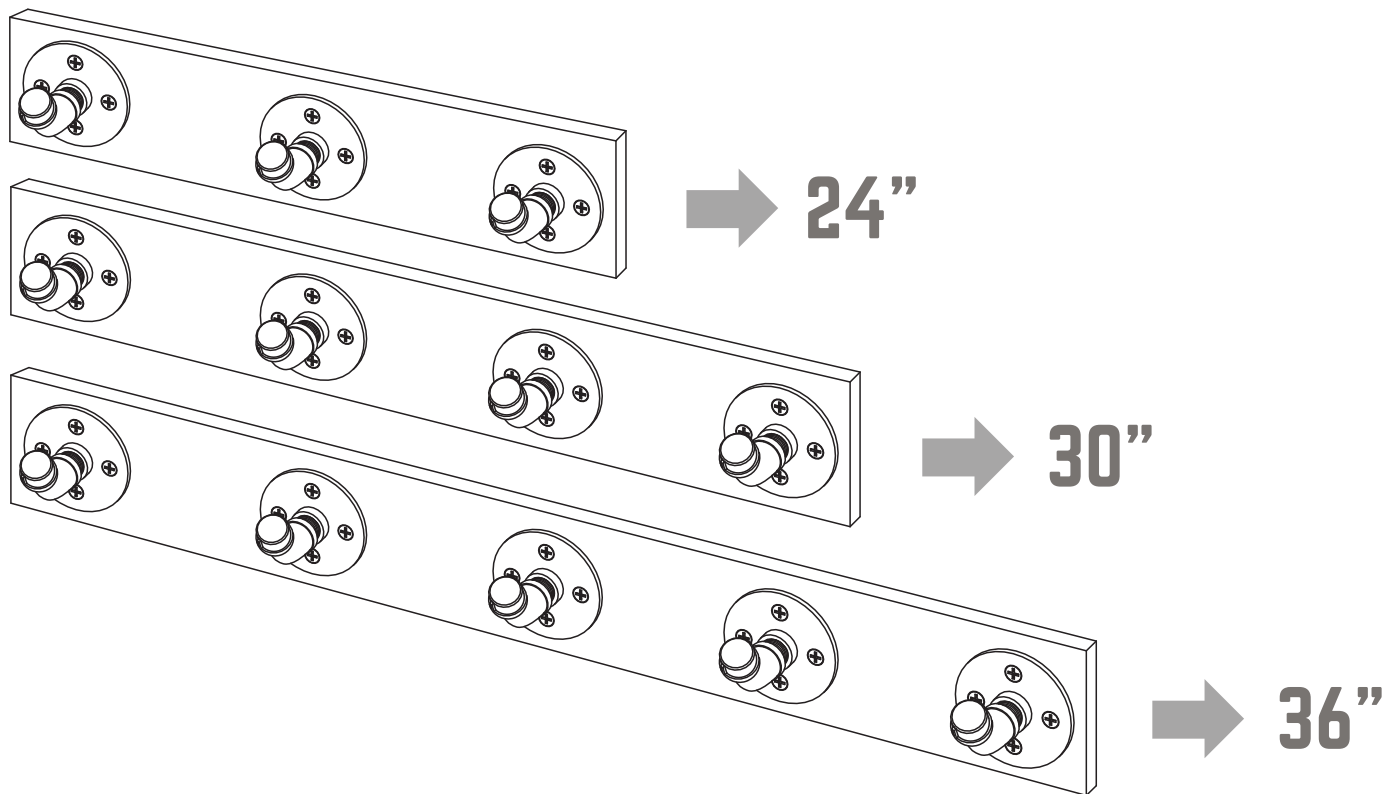

WALL-MOUNTED RACK WITH HOOKS 24", 30" OR 36"

NEED HELP OR ADVICE PUTTING THIS KIT TOGETHER? MISSING PIECES?
EMAIL US AT [SUPPORT@PIPE-DECOR.COM](mailto:support@pipe-decor.com) FOR ANY QUESTIONS



HOW TO PREVENT PIPE CORROSION

PIPE DECOR industrial-grade black pipes and fittings are coated with a rust-preventive oil during manufacturing. For best results, **SEAL THE PIPES TO AVOID ANY RUSTING** after cleaning the kit.

CLEAN AND SEAL INSTRUCTIONS:

CLEAN: Recommended supplies: regular degreasing dish soap, washcloths, gloves (optional)
1. Wash your pipes and fittings with warm water and dish soap until the oil is completely removed.
2. Wipe the pipes with a dry washcloth and wait until the pipes are completely dry.

IMPORTANT: THE PIPES MUST BE COMPLETELY DRY BEFORE YOU START THE SEALING PROCESS.

SEAL:

IF USING POLYURETHANE SPRAY: Spray each dry pipe and fitting with a polyurethane matte or satin finishing spray and let it dry before assembling the kit.

IF USING FINISHING WAX: Coat each dry pipe with a finishing wax. Wait for 20 minutes, then polish the pipe with a dry washcloth by wiping them down. Faster wiping will result in a shinier finish.

ID: 23746

PII370HKWD - 120308

370HK3WD24BB, 370HK3WD24RG, 370HK3WD30BB, 370HK3WD30RG,
370HK3WD36BB, 370HK3WD36RG

RESTORE PIPE DECOR®

WALL-MOUNTED RACK WITH HOOKS 24", 30" OR 36"

RACK WITH 3 HOOKS

PART	DESCRIPTION	QTY
A	1/2" FLANGE	3
B	1/2" CAP	3
C	1/2" CLOSE NIPPLE	3
D	1/2" 90° ELBOW	3
E	SCREWS / ANCHORS	3
F	WOOD SCREWS	12
G	24" WOOD PIECE	1

RACK WITH 4 HOOKS

PART	DESCRIPTION	QTY
A	1/2" FLANGE	4
B	1/2" CAP	4
C	1/2" CLOSE NIPPLE	4
D	1/2" 90° ELBOW	4
E	SCREWS / ANCHORS	4
F	WOOD SCREWS	16
G	30" WOOD PIECE	1

RACK WITH 5 HOOKS

PART	DESCRIPTION	QTY
A	1/2" FLANGE	5
B	1/2" CAP	5
C	1/2" CLOSE NIPPLE	5
D	1/2" 90° ELBOW	5
E	SCREWS / ANCHORS	4
F	WOOD SCREWS	20
G	36" WOOD PIECE	1

EASY INSTALLATION: TOOLS AND MATERIAL NEEDED FOR INSTALLATION



Wall Mounting Template Sheet



STEP 1 | Align and tape the wall mounting template to the wood piece

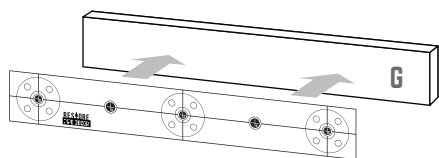

STEP 2 | Using a screw over poke holes in template at the marked crosshairs based on desired wall mounting option:

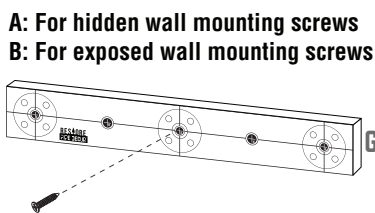

STEP 3 | Remove template from the wood piece

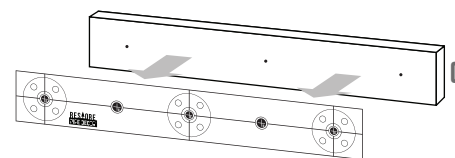

STEP 4 | Attach flanges to wood in previously marked holes using short wood screws.

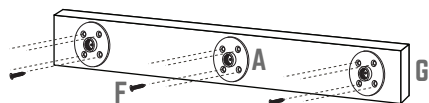

STEP 5 | Align the wood piece at desired wall location (using a level to keep it horizontal), then draw a line on the wall with a pencil to mark where the top of the wood is. Drill pilot holes on the marked holes using electric drill.

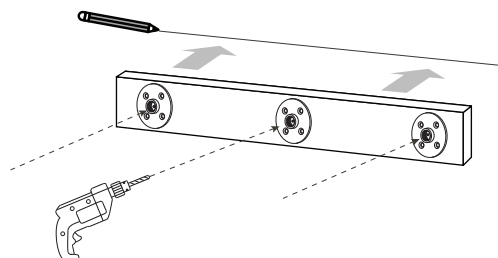

STEP 6 (IF NO WALL STUD IS PRESENT)

Remove the wood piece, drill pilot holes in the marked holes from step 5 to the wall using 1/4" drill bit. Then insert anchor fully into pilot hole using hammer and Phillips screwdriver as needed.

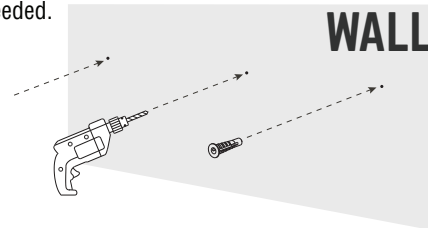

STEP 7 | Align top of wood with the marked line on the wall and tighten the included long screws with screwdriver.

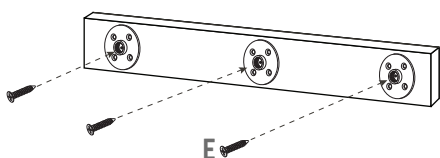

STEP 8 | Attach Cap, 90° Elbow and Close Nipple together to the flange.

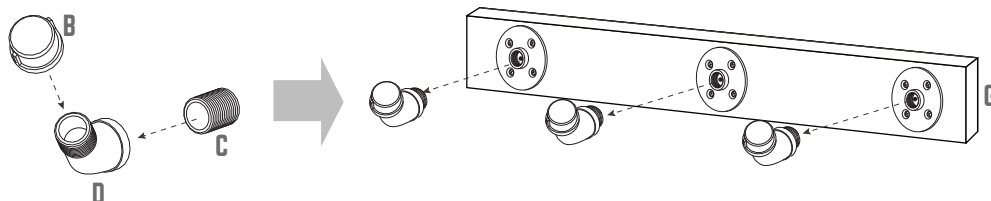

ID: 23746

PII370HKWD - 120308