

FOREWORD

This handbook contains information on the Triumph America and Speedmaster motorcycles. Always store this owner's handbook with the motorcycle.

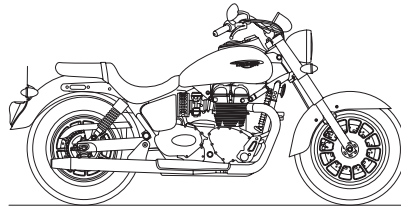
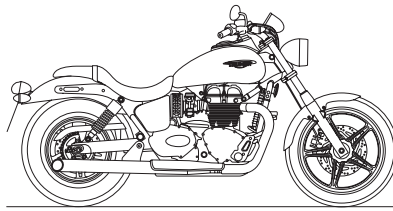

Warnings, Cautions and Notes

Throughout this owner's handbook particularly important information is presented in the following form:

Warning

This warning symbol identifies special instructions or procedures, which, if not correctly followed, could result in personal injury, or loss of life.

Caution

This caution symbol identifies special instructions or procedures, which, if not strictly observed, could result in damage to, or destruction of, equipment.

Note:

- **This note symbol indicates points of particular interest for more efficient and convenient operation.**

Foreword

Warning Labels

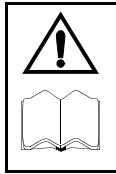

At certain areas of the motorcycle, the symbol (left) can be seen. The symbol means 'CAUTION: REFER TO THE HANDBOOK' and will be followed by a pictorial representation of the subject

concerned.

Never attempt to ride the motorcycle or make any adjustments without reference to the relevant instructions contained in this handbook.

See pages 10 to 11 for the location of all labels bearing this symbol. Where necessary, this symbol will also appear on the pages containing the relevant information.

Maintenance

To ensure a long, safe and trouble free life for your motorcycle, maintenance should always be carried out by an authorised Triumph dealer.

Only an authorised Triumph dealer will have the necessary knowledge, equipment and skills to maintain your Triumph motorcycle correctly.

To locate your nearest Triumph dealer, visit the Triumph web site at www.triumph.co.uk or telephone the authorised distributor in your country. Their address is given in the service record book that accompanies this handbook.

Noise Control System

Tampering With the Noise Control System is Prohibited.

Owners are warned that the law may prohibit:

- a) The removal or rendering inoperative by any person other than for purposes of maintenance, repair or replacement, of any device or element of design incorporated into any new vehicle for the purpose of noise control prior to its sale or delivery to the ultimate purchaser or while it is in use and,
- b) the use of the vehicle after such device or element of design has been removed or rendered inoperative by any person.

Foreword

Owner's Handbook

Thank you for choosing a Triumph motorcycle. This motorcycle is the product of Triumph's use of proven engineering, exhaustive testing, and continuous striving for superior reliability, safety and performance.

Please read this owner's handbook before riding in order to become thoroughly familiar with the correct operation of your motorcycle's controls, its features, capabilities and limitations.

This handbook includes safe riding tips, but does not contain all the techniques and skills necessary to ride a motorcycle safely. Triumph strongly recommends that all riders undertake the necessary training to ensure safe operation of this motorcycle.

This handbook is also available from your local dealer in:

- Dutch;
- French;
- German;
- Italian;
- Japanese;
- Spanish;
- Swedish.

Warning

This owner's handbook, and all other instructions that are supplied with your motorcycle, should be considered a permanent part of your motorcycle and should remain with it even if your motorcycle is subsequently sold.

All riders must read this owner's handbook and all other instructions which are supplied with your motorcycle, before riding, in order to become thoroughly familiar with the correct operation of your motorcycle's controls, its features, capabilities and limitations.

Do not lend your motorcycle to others as riding when not familiar with your motorcycle's controls, features, capabilities and limitations can lead to an accident.

Talk to Triumph

Our relationship with you does not end with the purchase of your Triumph. Your feedback on the buying and ownership experience is very important in helping us develop our products and services for you. Please help us by ensuring your dealership has your E-mail address and registers this with us. You will then receive an online customer satisfaction survey invitation to your E-mail address where you can give us this feedback.

Your Triumph Team.

Foreword

Information

The information contained in this publication is based on the latest information available at the time of printing. Triumph reserves the right to make changes at any time without prior notice, or obligation.

Not to be reproduced wholly or in part without the written permission of Triumph Motorcycles Limited.

© Copyright 07.2010 Triumph Motorcycles Limited, Hinckley, Leicestershire, England.

Publication part number 3856501 issue 4.

Table of Contents

This handbook contains a number of different sections. The table of contents below will help you find the beginning of each section where, in the case of the major sections, a further table of contents will help you find the specific subject required.

| | |
|--|----|
| Foreword..... | 1 |
| Warning Labels..... | 10 |
| Parts Identification..... | 12 |
| Serial Numbers..... | 15 |
| General Information..... | 17 |
| How to Ride the Motorcycle..... | 37 |
| Accessories, Loading and Passengers..... | 47 |
| Maintenance and Adjustment..... | 51 |
| Storage..... | 93 |
| Specifications..... | 95 |

Foreword - Safety First

FOREWORD - SAFETY FIRST

The Motorcycle

 **Warning**

This motorcycle is designed for on-road use only. It is not suitable for off-road use. Off-road operation could lead to loss of control of the motorcycle resulting in an accident causing injury or loss of life.

 **Warning**

This motorcycle is not designed to tow a trailer or be fitted with a sidecar. Fitting a sidecar and/or a trailer may result in loss of control and an accident.

 **Warning**

This motorcycle is designed for use as a two-wheeled vehicle capable of carrying a rider on his/her own, or a rider and one passenger (subject to a passenger seat being fitted).

The total weight of the rider, and any passenger, accessories and luggage must not exceed the maximum load limit of 200 kg (440 lbs).

Fuel and Exhaust Fumes

 **Warning**

PETROL IS HIGHLY FLAMMABLE:

Always turn off the engine when refuelling.

Do not refuel or open the fuel filler cap while smoking or in the vicinity of any open (naked) flame.

Take care not to spill any petrol on the engine, exhaust pipes or silencers when refuelling.

If petrol is swallowed, inhaled or allowed to get into the eyes, seek immediate medical attention.

Spillage on the skin should be immediately washed off with soap and water and clothing contaminated with petrol should immediately be removed.

Burns and other serious skin conditions may result from contact with petrol.

 **Warning**

Never start your engine or let it run for any length of time in a closed area. The exhaust fumes are poisonous and may cause loss of consciousness and death within a short time. Always operate your motorcycle in the open-air or in an area with adequate ventilation.

Foreword - Safety First

Riding

Warning

Never ride the motorcycle when fatigued or under the influence of alcohol or other drugs.

Riding when under the influence of alcohol or other drugs is illegal.

Riding when fatigued or under the influence of alcohol or other drugs reduces the rider's ability to maintain control of the motorcycle and may lead to loss of control and an accident.

Warning

All riders must be licenced to operate the motorcycle. Operation of the motorcycle without a licence is illegal and could lead to prosecution.

Operation of the motorcycle without formal training in the correct riding techniques that are necessary to become licenced is dangerous and may lead to loss of motorcycle control and an accident.

Warning

Always ride defensively and wear the protective equipment mentioned elsewhere in this foreword. Remember, in an accident, a motorcycle does not give the same impact protection as a car.

Warning

This Triumph motorcycle should be operated within the legal speed limits for the particular road travelled.

Operating a motorcycle at high speeds can be potentially dangerous since the time available to react to given traffic situations is greatly reduced as road speed increases.

Always reduce speed in potentially hazardous driving conditions such as bad weather or heavy traffic.

Warning

Continually observe and react to changes in road surface, traffic and wind conditions. All two-wheeled vehicles are subject to external forces which may cause an accident. These forces include but are not limited to:

- Wind draft from passing vehicles;
- Potholes, uneven or damaged road surfaces;
- Bad weather;
- Rider error.

Always operate the motorcycle at moderate speed and away from heavy traffic until you have become thoroughly familiar with its handling and operating characteristics. Never exceed the legal speed limit.

Foreword - Safety First

Helmet and Clothing

Warning

When riding the motorcycle, both rider and passenger must always wear a motorcycle helmet, eye protection, gloves, boots, trousers (close fitting around the knee and ankle) and a brightly coloured jacket. Brightly coloured clothing will considerably increase a rider's (or passenger's) visibility to other operators of road vehicles. Although full protection is not possible, wearing correct protective clothing can reduce the risk of injury when riding.

Warning

A helmet is one of the most important pieces of riding gear as it offers protection against head injuries. You and your passenger's helmet should be carefully chosen and should fit you or your passenger's head comfortably and securely. A brightly coloured helmet will increase a rider's (or passenger's) visibility to other operators of road vehicles.

An open face helmet offers some protection in an accident though a full face helmet will offer more.

Always wear a visor or approved goggles to help vision and to protect your eyes.



cbma

Handlebars and Footrests

Warning

The rider must maintain control of the vehicle by keeping hands on the handlebars at all times.

The handling and stability of a motorcycle will be adversely affected if the rider removes his hands from the handlebars, resulting in loss of control or an accident.

Warning

Footrests provided must always be used by rider and passenger during operation of the vehicle.

By using the footrests, both rider and passenger will reduce the risk of inadvertent contact with any motorcycle components and will also reduce the risk of injury from entrapment of clothing.

Foreword - Safety First

Parking

Warning

Always turn off the engine and remove the ignition key before leaving the motorcycle unattended. By removing the key, the risk of use of the motorcycle by unauthorised or untrained persons is reduced.

When parking the motorcycle, always remember the following:

The engine and exhaust system will be hot after riding. DO NOT park where pedestrians, animals and/or children are likely to touch the motorcycle.

Do not park on soft ground or on a steeply inclined surface. Parking under these conditions may cause the motorcycle to fall over.

For further details, please refer to the 'How to Ride the Motorcycle' section of this owner's handbook.

Parts and Accessories

Warning

Owners should be aware that the only approved parts, accessories and conversions for any Triumph motorcycle are those which carry official Triumph approval and are fitted to the motorcycle by an authorised dealer.

In particular, it is extremely hazardous to fit or replace parts or accessories whose fitting requires the dismantling of, or addition to, either the electrical or fuel systems and any such modification could cause a safety hazard.

The fitting of any non-approved parts, accessories or conversions may adversely affect the handling, stability or other aspect of the motorcycle operation that may result in an accident causing injury or death.

Triumph does not accept any liability whatsoever for defects caused by the fitting of non-approved parts, accessories or conversions or the fitting of any approved parts, accessories or conversions by non-approved personnel.

Foreword - Safety First

Maintenance/Equipment

Warning

Consult your authorised Triumph dealer whenever there is doubt as to the correct or safe operation of this Triumph motorcycle.

Remember that continued operation of an incorrectly performing motorcycle may aggravate a fault and may also compromise safety.

Warning

Ensure all equipment that is required by law is installed and functioning correctly.

The removal or alteration of the motorcycle's lights, silencers, emission or noise control systems can violate the law.

Incorrect or improper modification may adversely affect the handling, stability or other aspect of the motorcycle operation, which may result in an accident causing injury or death.

Warning

Use of a motorcycle with bank angle indicators worn beyond the maximum limit (when 10 mm or more of the radiused tip of either front footrest is worn away) will allow the motorcycle to be banked to an unsafe angle.

Banking to an unsafe angle may cause instability, loss of control and an accident causing injury or death.

Warning

If the motorcycle is involved in an accident, collision or fall, it must be taken to an authorised Triumph dealer for inspection and repair. Any accident can cause damage to the motorcycle that, if not correctly repaired, may cause a second accident that may result in injury or death.

Warning Labels

WARNING LABELS

Warning Label Locations - America and Speedmaster

The labels detailed on this and the following pages draw your attention to important safety information in this handbook. Before riding, ensure that all riders have understood and complied with all the information to which these labels relate.

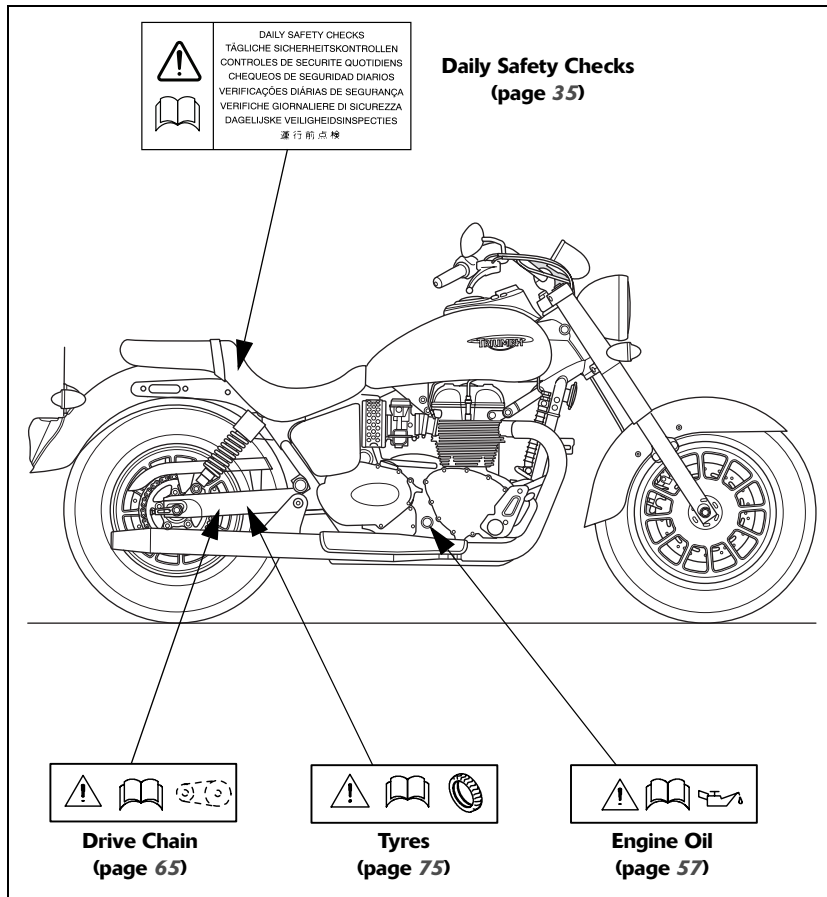

**Warning Label Locations - America and Speedmaster
(continued)**

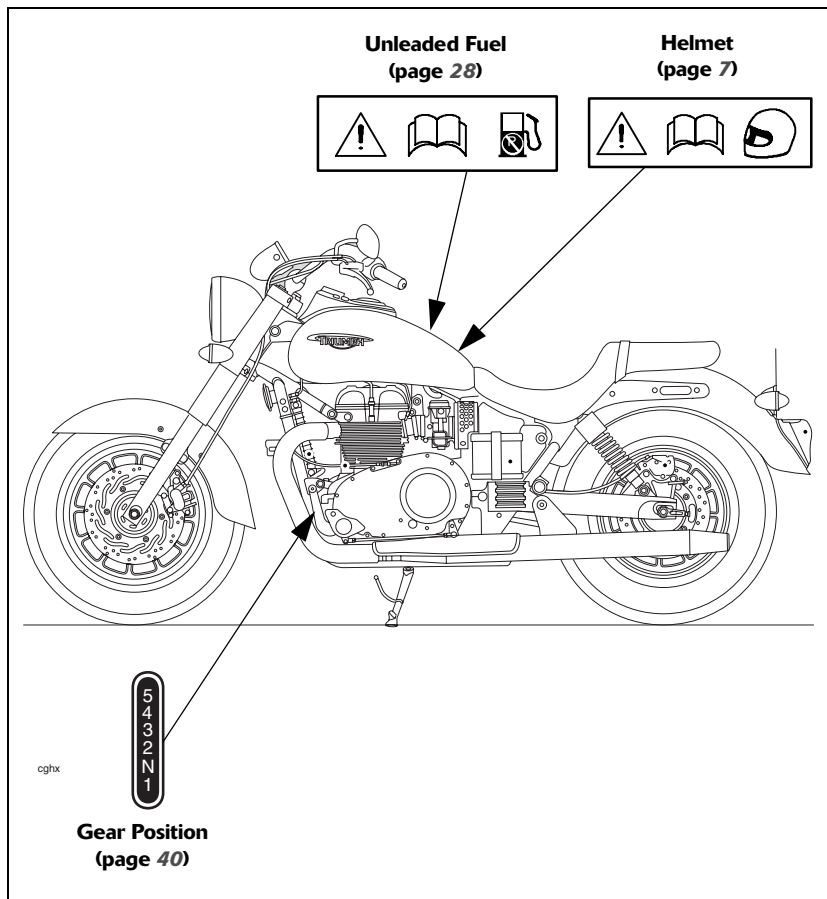

Parts Identification

PARTS IDENTIFICATION

Parts Identification - America and Speedmaster

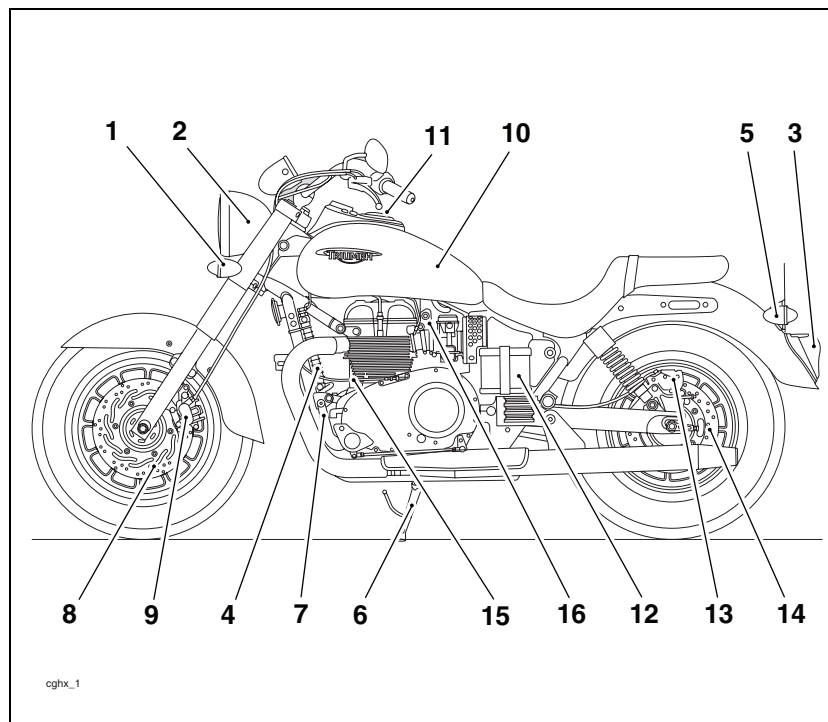

- 1. Front indicator
- 2. Headlight
- 3. Rear light
- 4. Oil cooler
- 5. Rear indicator
- 6. Side stand
- 7. Gear change pedal
- 8. Front brake disc

- 9. Front brake caliper
- 10. Fuel tank
- 11. Fuel filler cap
- 12. Battery
- 13. Rear brake caliper
- 14. Rear brake disc
- 15. Clutch cable
- 16. Choke control

Parts Identification

Parts Identification - America and Speedmaster (continued)

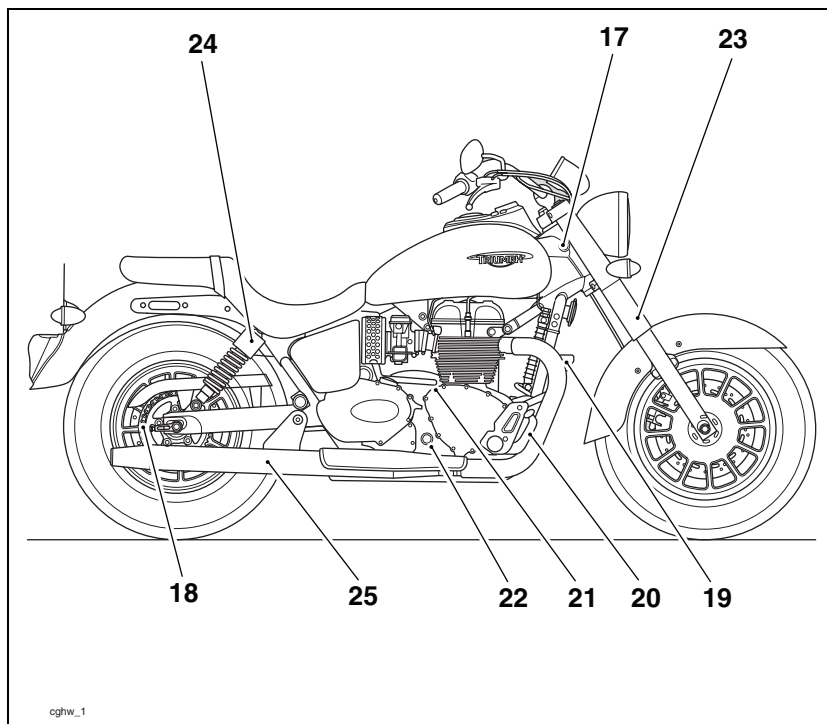

17. Steering lock

18. Drive chain

19. Rear brake fluid reservoir

20. Rear brake pedal

21. Oil filler plug

22. Oil level sight glass

23. Front fork

24. Rear suspension unit

25. Silencer

Parts Identification

Parts Identification - America and Speedmaster (continued)

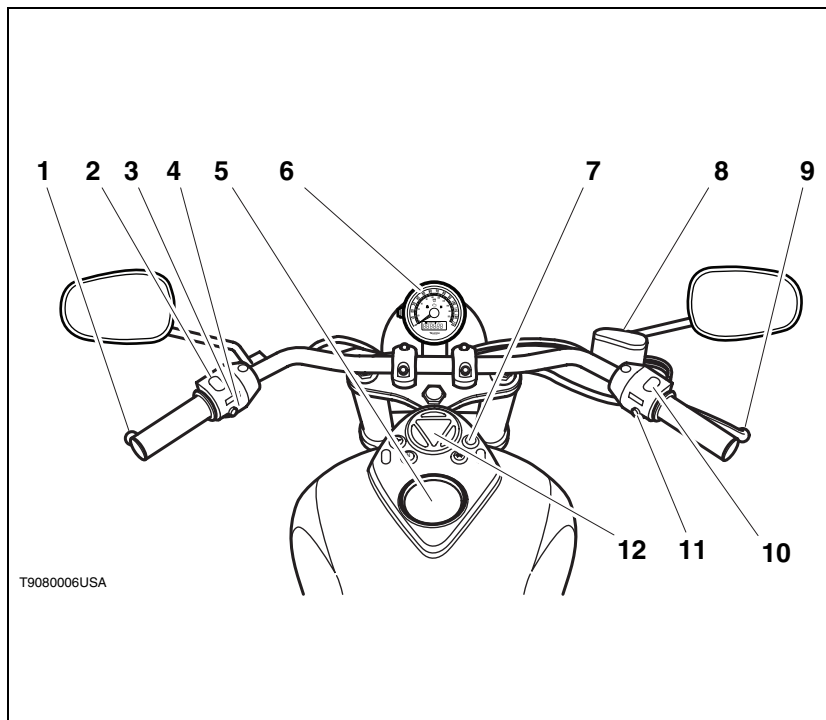

T9080006USA

- | | |
|-------------------------------|-----------------------------------|
| 1. Clutch lever | 7. Warning lights |
| 2. Headlight dip switch | 8. Front brake fluid reservoir |
| 3. Direction indicator switch | 9. Front brake lever |
| 4. Horn button | 10. Engine stop switch |
| 5. Fuel filler | 11. Starter button |
| 6. Speedometer | 12. Tachometer (Speedmaster only) |

SERIAL NUMBERS

Vehicle Identification Number (VIN)

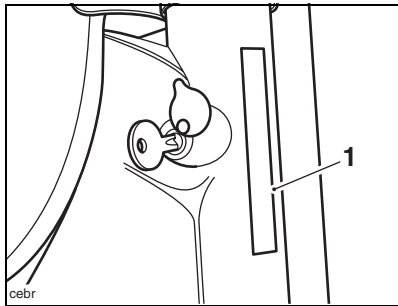

1. VIN number stamping

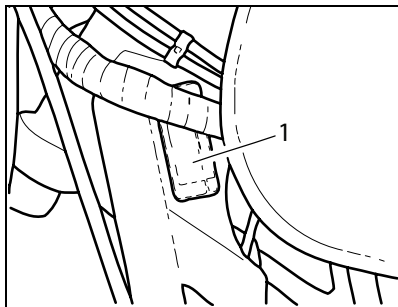

1. VIN plate location

The vehicle identification number is stamped into the steering head.

It is also displayed on a plate, riveted to the frame, immediately behind the steering head on the left hand side of the motorcycle.

Engine Serial Number

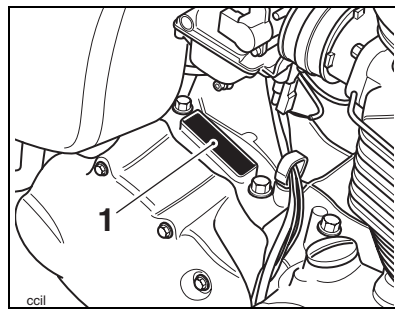

1. Engine serial number

The engine serial number is stamped on the crankcase, immediately above the drive chain sprocket cover.

Record the vehicle identification number in the space below.

Record the engine serial number in the space below.

Serial Numbers

This page intentionally left blank

GENERAL INFORMATION

Table of Contents

| | |
|--|----|
| Instruments | 19 |
| America and Speedmaster | 19 |
| Speedometer | 20 |
| Odometer/Trip Meter | 20 |
| Trip Meter Reset | 20 |
| Clock Adjustment | 21 |
| Tachometer (Speedmaster only) | 21 |
| Warning Lights | 22 |
| Direction Indicators | 22 |
| High Beam | 22 |
| Neutral | 22 |
| Engine Management System Malfunction Indicator Light | 22 |
| Low Fuel | 22 |
| Low Oil Pressure | 23 |
| Ignition Key | 23 |
| Ignition Switch | 24 |
| Switch Location | 24 |
| Switch Operation | 24 |
| Ignition Switch Positions | 24 |
| Steering Lock Key | 25 |
| Steering Lock | 25 |
| Right Handlebar Switches | 26 |
| Engine Stop Switch | 26 |
| Starter Button | 26 |
| Left Handlebar Switches | 27 |
| Headlight Dip Switch | 27 |
| Direction Indicator Switch | 27 |
| Horn Button | 27 |

General Information

| | |
|---|----|
| Brake and Clutch Lever Adjusters | 27 |
| Fuel | 28 |
| Fuel Grade | 28 |
| Refuelling | 29 |
| Fuel Tank Cap | 29 |
| Filling the Fuel Tank | 30 |
| Side Cover: Right Hand Side Cover | 31 |
| Seat | 31 |
| Seat Care | 31 |
| Seat | 31 |
| Stand | 32 |
| Side Stand | 32 |
| Owner's Handbook | 33 |
| Handbook Storage | 33 |
| Running-In | 34 |
| Safe Operation | 35 |
| Daily Safety Checks | 35 |

General Information

Instruments

America and Speedmaster

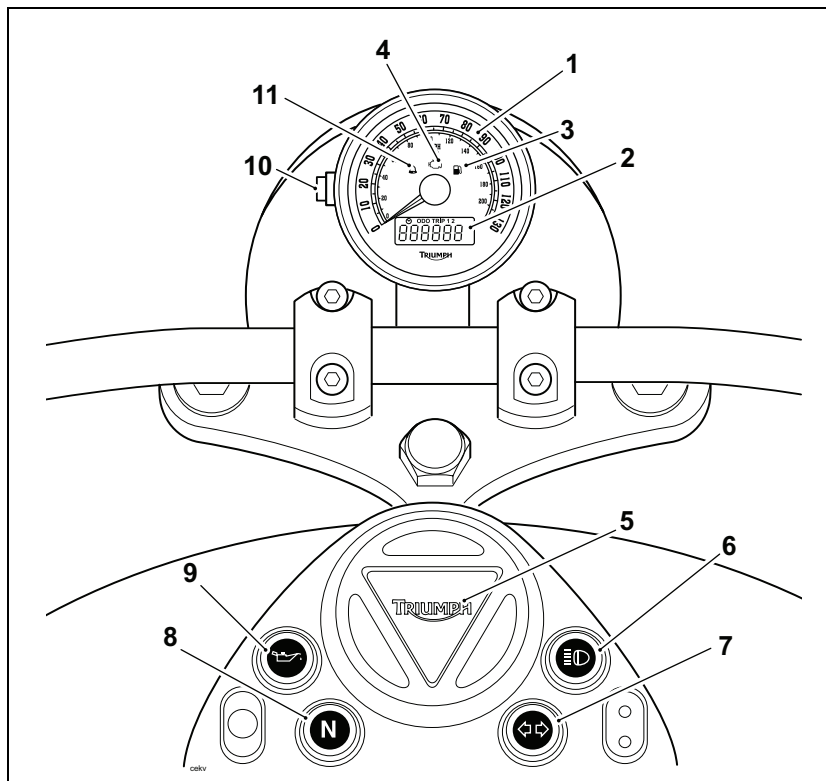

1. Speedometer
2. Odometer
3. Low fuel level indicator light
4. Engine management malfunction indicator light (MIL)
5. Tachometer location (Speedmaster only)
6. High beam indicator light
7. Direction indicator light
8. Neutral indicator light
9. Low oil pressure warning light
10. Reset button
11. Alarm status indicator light (alarm is an accessory fit)

General Information

Speedometer

The speedometer indicates the road speed of the motorcycle.

Odometer/Trip Meter

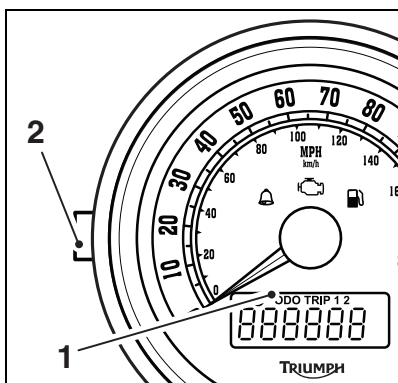

1. Odometer/trip meter/clock display
2. Reset button

The odometer shows the total distance that the motorcycle has travelled.

There are two trip meters. Either trip meter shows the distance that the motorcycle has travelled since the meter on display was last reset to zero.

Warning

Do not attempt to switch between odometer and trip meter display modes or reset the trip meter with the motorcycle in motion as this may lead to loss of motorcycle control and an accident.

To switch between the odometer and trip meter display modes, press and release the reset button until the desired display is visible. The display will scroll through in the order:

- Odometer
- Trip meter 1
- Trip meter 2
- Clock

Trip Meter Reset

To reset either of the trip meters, select and display the trip meter to be zeroed then press the reset button for 2 seconds. After 2 seconds, the trip meter on display will reset to zero.

General Information

Clock Adjustment

Warning

Do not attempt to adjust the clock with the motorcycle in motion as this may lead to loss of motorcycle control and an accident.

To set the clock, turn the ignition to the ON position. Press and release the reset button until the clock is visible in the display screen.

Press and hold the reset button for 4 seconds. After 4 seconds either 24 Hr or 12 Hr will be shown flashing. Press and release the reset button to select the desired clock display. When the correct display is shown, do not touch the reset button until the clock is shown with the hour display flashing.

To reset the hour display, ensure that the hour display is still flashing. Press the reset button to change the setting. Each individual button press will change the setting by one digit. If the button is held, the display will continuously scroll through in single digit increments.

When the correct hour display is shown, do not touch the reset button for 6 seconds. The minutes display will begin to flash automatically. The minutes display is adjusted in the same way as for the hours.

Once both hours and minutes are correctly set, do not touch the reset button for 6 seconds and the display will cease to flash automatically.

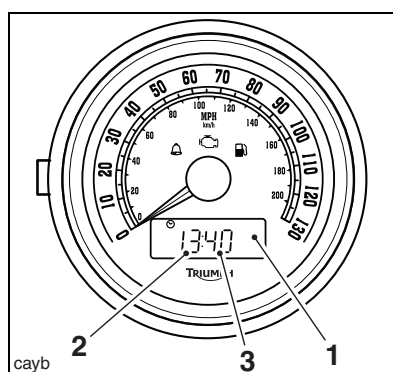

1. Clock display
2. Hours read-out
3. Minutes read-out

Tachometer (Speedmaster only)

The tachometer shows the engine speed in revolutions per minute - rpm (r/min). On the right side of the tachometer face is the 'red zone'. Engine rpm (r/min) in the red zone is above maximum recommended engine speed and is also above the range for best performance.

Caution

Never allow engine rpm to enter the 'red zone' as severe engine damage may result.

General Information

Warning Lights



Direction Indicators

When the direction indicators are switched on, the direction indicator warning light will flash on and off at the same speed.



High Beam

When the headlights are switched on and the headlight dip switch is set to 'high beam', the high beam warning light will illuminate.



Neutral

The neutral warning light indicates when the transmission is in neutral (no gear selected). The warning light will illuminate when the transmission is in neutral with the ignition switch in the ON position.



Engine Management System Malfunction Indicator Light

The malfunction indicator light for the engine management system illuminates when the ignition is switched on (to indicate that it is working) but should not become illuminated when the engine is running.

If the malfunction indicator light becomes illuminated when the engine is running, this indicates that a fault has occurred in one or more of the systems controlled by the engine management system. In such circumstances, the engine management system will switch to 'limp-home' mode so that the journey may be completed, if the fault is not so severe that the engine will not run.

Warning

Reduce speed and do not continue to ride for longer than is necessary with the malfunction indicator light illuminated. The fault may adversely affect engine performance, exhaust emissions and fuel consumption. Reduced engine performance could cause a dangerous riding condition, leading to loss of control and an accident. Contact an authorised Triumph dealer as soon as possible to have the fault checked and rectified.

Note:

- **If the malfunction indicator light flashes when the ignition is switched on, contact an authorised Triumph dealer as soon as possible to have the situation rectified. In these circumstances the engine will not start.**



Low Fuel

The low fuel indicator will illuminate when there is approximately 3.5 litres of fuel remaining in the tank.

General Information

Low Oil Pressure

The low oil pressure warning light becomes illuminated whenever the oil pressure is dangerously low (or the ignition switch is in the ON position with the engine not running). When the engine is running, the light will remain off when sufficient oil pressure is present.

When starting the motorcycle, check that the light comes on when the ignition is in the ON position, but goes out as soon as the engine starts.

Caution

Stop the engine immediately if the low oil pressure warning light illuminates. Do not restart the engine until the fault has been rectified.

Severe engine damage will result from running the engine when the low oil pressure warning light is illuminated.

Ignition Key

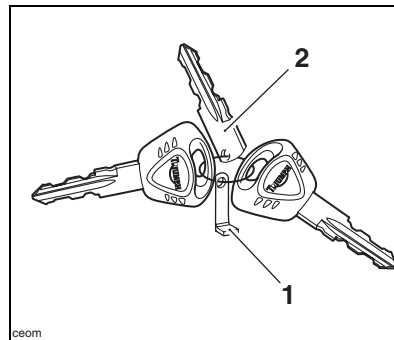

1. Key number tag

2. Spare key blade

The ignition key operates the ignition switch only. A different key operates the steering lock.

When the motorcycle is delivered from the factory, two ignition keys are supplied together with a small tag bearing the key number, and a spare key blade for use with Triumph accessory alarm. Make a note of the key number and store the spare key, key blade and key number tag in a safe place away from the motorcycle.

Your authorised Triumph dealer can supply a replacement key cut from details of the key number or can cut a new key using the original as a master.

Caution

Do not store the spare key with the motorcycle as this will reduce all aspects of security.

General Information

Ignition Switch

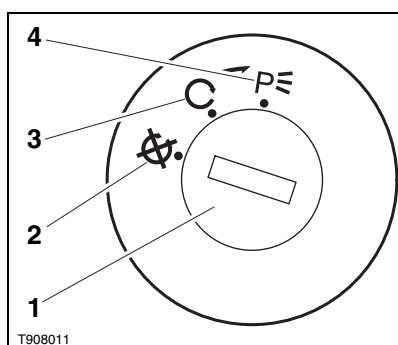

1. Ignition switch
2. OFF position
3. ON position
4. P (PARK) position

Switch Location

The switch is located on the left hand side of the motorcycle, at the rear of the side cover.

Switch Operation

This is a three position, key operated switch. The key can be removed from the switch only when it is in the OFF or P (PARK) positions.

To turn the switch from OFF to ON, insert the key and turn the key clockwise to the ON position.

To turn the switch from ON to PARK, push the key barrel further into the lock and turn clockwise to the PARK position. Use the PARK position only when temporarily leaving the motorcycle in a situation where the position lights must remain on.

To turn the key back to OFF, turn the key anti-clockwise.

Ignition Switch Positions

| | |
|--|--|
| | Engine off. All electrical circuits off. |
| | Engine on. All electrical equipment can be used. |
| | Engine off. Tail, side and licence plate lights on, all other electrical circuits cut off. |

Warning

For reasons of security and safety, always turn the ignition to the OFF or PARK position and remove the key when leaving the motorcycle unattended.

Any unauthorised use of the motorcycle may cause injury to the user, other road users and pedestrians and may also cause damage to the motorcycle.

Note:

- **Do not leave the ignition switch in the P position for long periods as this will cause the battery to discharge.**

General Information

Steering Lock Key

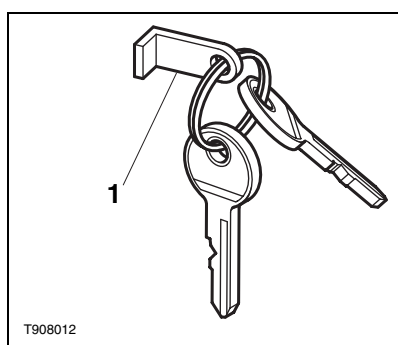

1. Steering lock key tag

The steering lock key operates the steering lock only. A different key operates the ignition switch.

When the motorcycle is delivered from the factory, two steering lock keys are supplied together with a small tag bearing the key number. Make a note of the key number and store the spare key and key number tag in a safe place away from the motorcycle.

Your authorised Triumph dealer can supply a replacement key cut from details of the key number or can cut a new key using the original as a master.

Caution

Do not store the spare key with the motorcycle as this will reduce all aspects of security.

Steering Lock

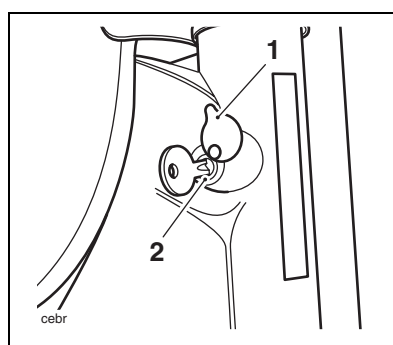

1. Steering lock cover

2. Steering lock

This is a two position, key operated lock. The key can be removed in either the engaged or disengaged positions.

To engage the lock, insert the key and push the complete lock inwards while turning anti-clockwise. At the same time turn the handlebars fully left until the lock engages (at which point the lock will turn and move inwards).

To disengage the steering lock, insert the key, turn the handlebars slightly to relieve any weight on the lock and turn the key further anti-clockwise until the lock springs outwards. Remove the key.

Warning

Always disengage the steering lock before riding as, with the steering lock engaged, it will not be possible to turn the handlebars or steer the motorcycle.

Riding without motorcycle steering control will lead to loss of control and an accident.

General Information

Right Handlebar Switches

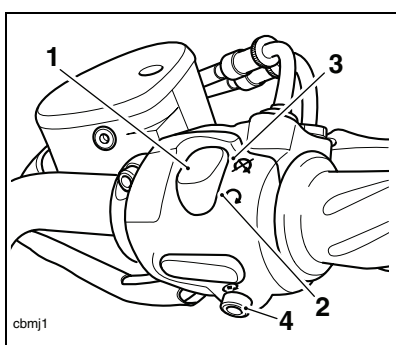

1. Engine stop switch
2. RUN position
3. STOP position
4. Starter button



Engine Stop Switch

In addition to the ignition switch being turned to the ON position, the engine stop switch must be in the RUN position for the motorcycle to operate.

The engine stop switch is for emergency use. If an emergency arises which requires the engine to be stopped, move the engine stop switch to the STOP position.

Note:

- **Although the engine stop switch stops the engine, it does not turn off all the electrical circuits. Ordinarily, the ignition switch should be used to stop the engine.**

Caution

Do not leave the ignition switch in the ON position unless the engine is running as this may cause damage to electrical components and the battery.



Starter Button

The starter button operates the electric starter. For the starter to operate, the clutch lever must be pulled to the handlebar.

Note:

- **Even if the clutch lever is pulled to the handlebar, the starter will not operate if the side stand is down and a gear is engaged.**
- **Light switches are no longer fitted to any Triumph model. Instead, the head and tail lights automatically come on when the ignition is in the ON position.**

General Information

Left Handlebar Switches

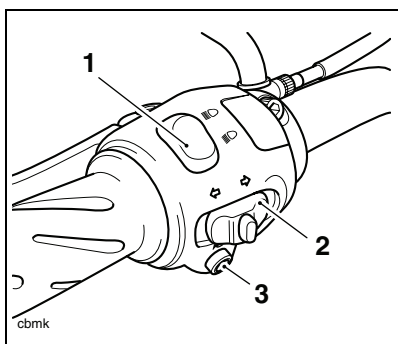

1. Headlight dip switch
2. Direction indicator switch
3. Horn button



Headlight Dip Switch

High or low beam can be selected with the headlight dip switch. To select high beam, push the switch forward. To select low beam, push the switch rearwards. When the high beam is turned on, the high beam warning light will illuminate.



Direction Indicator Switch

When the indicator switch is pushed to the left or the right and released, the corresponding indicator flashes. To turn off the indicators, push and release the button in the centre of the switch.



Horn Button

When the horn button is pushed, with the ignition switch turned to the ON position, the horn will sound.

Brake and Clutch Lever Adjusters

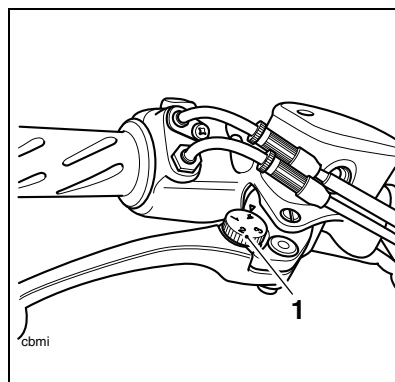

1. Lever adjuster wheel

An adjuster is fitted to the front brake and clutch levers on both models. The adjusters allow the distance from the handlebar to the lever to be changed to one of four positions, to suit the span of the operator's hands.

To adjust a lever, push the lever forward and turn the adjuster wheel to align one of the numbered positions with the triangular mark on the lever pivot (seen aligned with position 4 above).

The distance from the hand grip to the released lever is shortest when set to number four and longest when set to number one.

General Information

Warning

Do not attempt to adjust the levers with the motorcycle in motion as this may lead to loss of control and an accident.

After adjusting the levers, operate the motorcycle in an area free from traffic to gain familiarity with the new lever settings. Do not loan your motorcycle to anyone as they may change the lever settings from the one you are familiar with possibly causing loss of control or an accident.

Fuel



Fuel Grade

Your Triumph engine is designed to use unleaded fuel and will give optimum performance if the correct grade of fuel is used. Always use unleaded fuel with an octane rating of 91 RON minimum.

Caution

In many countries, the exhaust systems for these models are fitted with catalytic converters to help reduce exhaust emission levels. The catalytic converters can be permanently damaged if the motorcycle is allowed to run out of fuel or if the fuel level is allowed to get very low. Always ensure you have adequate fuel for your journey.

Caution

The use of leaded petrol is illegal in some countries, states or territories. Use of leaded fuel will damage the catalytic converter.

General Information

Refuelling

Warning

To help reduce hazards associated with fuel handling, always observe the following fuel safety instructions:

Petrol (fuel) is highly flammable and can be explosive under certain conditions. When refuelling, turn the ignition switch to the OFF position.

Do not smoke.

Do not use a mobile telephone.

Make sure the refuelling area is well ventilated and free from any source of flame or sparks. This includes any appliance with a pilot light.

Never fill the tank such that the fuel level rises into the filler neck. Heat from sunlight or other sources may cause the fuel to expand and overflow creating a fire hazard.

After refuelling always check that the fuel filler cap is correctly closed.

Because petrol (fuel) is highly flammable, any fuel leak or spillage, or any failure to observe the safety advice given above will lead to a fire hazard which could cause damage to property, injury to persons or death.

Fuel Tank Cap

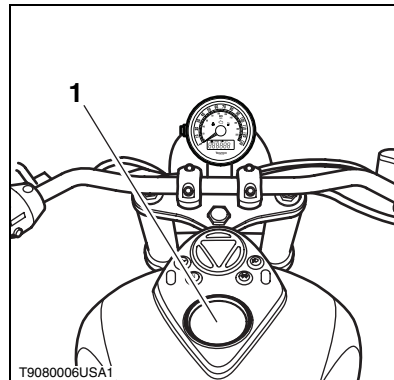

1. Fuel tank cap

To open the fuel tank cap, rotate the cap anti-clockwise and lift clear of the tank filler neck. To close the cap, align the cap to the tank filler neck and rotate the cap clockwise until the cap seals against the filler neck. In the fully closed position, a ratchet mechanism prevents over-tightening of the cap by allowing the outer part of the cap to turn independently of the internal part.

General Information

Filling the Fuel Tank

Avoid filling the tank in rainy or dusty conditions where airborne material can contaminate the fuel.

Caution

Contaminated fuel may cause damage to fuel system components.

Fill the fuel tank slowly to help prevent spillage. Do not fill the tank to a level above the bottom of the filler neck. This will ensure there is enough air space to allow for fuel expansion if the fuel inside the tank expands through absorption of heat from the engine or from direct sunlight.

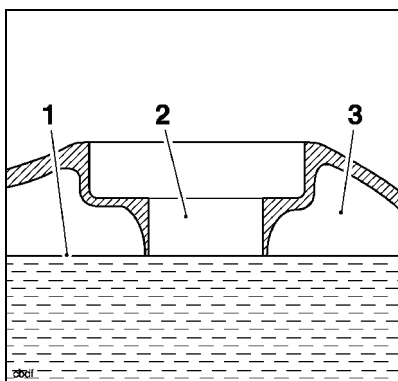

1. Fuel level
2. Filler neck
3. Air space

After refuelling always check that the fuel filler cap is correctly closed and locked.

Warning

Overfilling the tank can lead to fuel spillage.

If petrol (fuel) is spilled, thoroughly wipe off the spilled fuel immediately and dispose of the cleaning cloth safely.

Take care not to spill any petrol (fuel) on the engine, exhaust pipes, tyres or any other part of the motorcycle.

Because petrol (fuel) is highly flammable, any fuel leak or spillage, or any failure to observe the safety advice given above will lead to a fire hazard which could cause damage to property, injury to persons or death.

Petrol (fuel) spilled near to or on the tyres will reduce the tyre's ability to grip the road. This will result in a dangerous riding condition causing loss of motorcycle control and an accident.

General Information

Side Cover: Right Hand Side Cover

Under normal circumstances, it is not necessary to remove the right hand side cover from the America and Speedmaster models, except for major service or repair work, which must be carried out by an authorised Triumph dealer.

Seat

Seat Care

To prevent damage to the seat cover, care must be taken not to drop or lean the seat against any surface which may damage the seat or seat cover.

Caution

To prevent damage to the seat or seat cover, care must be taken not to drop the seat. Do not lean the seat against the motorcycle or any surface which may damage the seat or seat cover. Instead, place the seat, with the seat cover facing upwards, on a clean, flat surface which is covered with a soft cloth.

Do not place any item on the seat which may cause damage or staining to the seat cover.

Seat

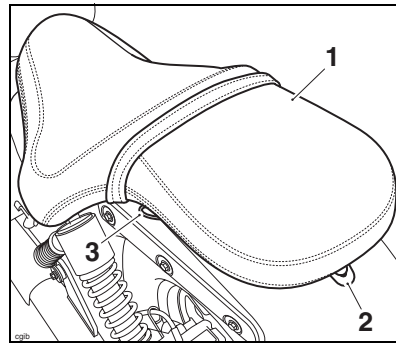

1. Seat
2. Fastener
3. Lock release

General Information

The seat can be removed to gain access to the owner's handbook. An Allen key, located inside the fuse-box cover, is provided to allow removal of the seat fastener.

To remove the fuse cover and locate the Allen key, gently pull on the lower edge of the fuse cover to release it from its locating grommet. Once free of the grommet, continue to raise the lower edge until the upper edge can be detached from its locating slot.

Remove the fixing from the rear of the seat.

Pull the lock release outwards to release the centre of the seat then raise the seat from the rear and detach the front edge from the fuel tank.

To refit, locate the seat to the frame ensuring the locating tongue is correctly positioned beneath the fuel tank bridge. Press firmly down to engage the centre of the seat in the seat lock.

Finally, tighten the seat fastener to **10 Nm**, store the Allen key in the space provided and refit the fuse cover.

Stand

Side Stand

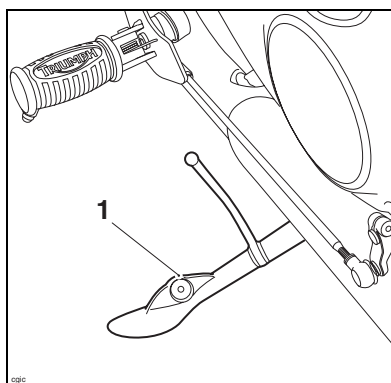

1. Side stand

The motorcycle is equipped with a side stand on which the motorcycle can be parked. Whenever the stand is used, before riding, always ensure that the stand is fully up after first sitting on the motorcycle.

For instructions on safe parking, refer to the 'How to Ride the Motorcycle' section.

Warning

The motorcycle is fitted with an interlock system to prevent it from being ridden with the side stand in the down position.

Never attempt to ride with the side stand down or interfere with the interlock mechanism as this will cause a dangerous riding condition leading to loss of motorcycle control and an accident.

General Information

Note:

- **When using the side stand, always turn the handlebars fully to the left and leave the motorcycle in first gear.**

Owner's Handbook

Handbook Storage

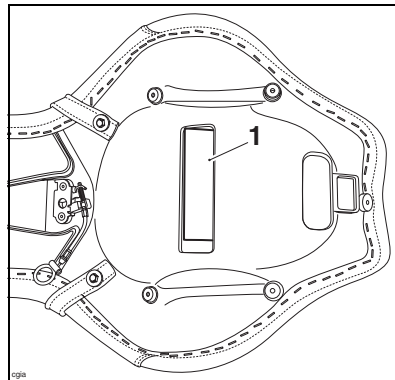

1. Owner's handbook storage

The motorcycle owner's handbook is stored in a pocket beneath the seat.

To access the handbook, remove and invert the seat. The handbook may be slid rearwards to remove it from the space beneath the seat.

To store the handbook, place it back in the space beneath the seat, then refit the seat as described under 'seat refit' (see page 37).

General Information

Running-In

Running-in is the name given to the process that occurs during the first hours of a new vehicle's operation.

In particular, internal friction in the engine will be higher when components are new. Later on, when continued operation of the engine has ensured that the components have 'bedded in', this internal friction will be greatly reduced.

A period of careful running-in will ensure lower exhaust emissions, and will optimise performance, fuel economy and longevity of the engine and other motorcycle components.

During the first 500 miles (800 kilometres):

- Do not use full throttle.
- Avoid high engine speeds at all times.
- Avoid riding at one constant engine speed, whether fast or slow, for a long period of time.
- Avoid aggressive starts, stops, and rapid accelerations, except in an emergency.
- Do not ride at speeds greater than 3/4 of maximum engine speed.

From 500 to 1000 miles (800 to 1500 kilometres):

- Engine speed can gradually be increased to the rev limit for short periods.

Both during and after running-in has been completed:

- Do not over-rev the engine when cold.
- Do not let the engine labour. Always downshift before the engine begins to 'struggle'.
- Do not ride with engine speeds unnecessarily high. Changing up a gear helps reduce fuel consumption, reduces noise and helps to protect the environment.

General Information

Safe Operation

Daily Safety Checks



Check the following items each day before you ride. The time required is minimal, and these checks will help ensure a safe, reliable ride.

If any irregularities are found during these checks, refer to the Maintenance and Adjustment section or see your authorised Triumph dealer for the action required to return the motorcycle to a safe operating condition.

|  Warning |
|---|
| Failure to perform these checks every day before you ride, or operation of the motorcycle with faults noted in any of the areas below, may result in serious motorcycle damage, loss of motorcycle control and an accident. |

Check:

Fuel: Adequate supply in tank, no fuel leaks (page 30).

Engine Oil: Correct level on sight glass. Add correct specification oil as required (page 57).

Tyres/Wheels: Correct inflation pressures (when cold). Tread depth/wear (min 2.0 mm tread depth), tyre/wheel damage, punctures etc. (page 99).

Drive Chain: Check drive chain for correct adjustment and lubrication (page 65).

Nuts, Bolts, Fasteners: Visually check that steering and suspension components, axles, and all controls are properly tightened or fastened. Inspect all areas for loose/damaged fixings.

Steering Action: Smooth but not loose from lock to lock. No binding of any of the control cables (page 72).

Brakes: Pull the brake lever and push the brake pedal to check for correct resistance. Investigate any lever/pedal where the travel is excessive before meeting resistance, or if either control feels spongy in operation (page 69).

Brake Pads: There should be more than 1.5 mm of friction material remaining on all the pads (page 69).

Brake Fluid Levels: No brake fluid leakage. Brake fluid levels must be between the MAX and MIN marks on both reservoirs (page 70).

Front Forks: Smooth action. No fork oil leakage (page 74).

Throttle: Throttle grip free play 2 - 3 mm. Ensure that the throttle grip returns to the idle position without sticking (page 61).

Clutch: Smooth operation and correct cable free play (page 63).

Electrical Equipment: All lights and horn function correctly (page 27).

Engine Stop: Stop switch turns the engine off (page 26/38).

Stand: Returns to the fully up position by spring tension. Return springs not weak or damaged (page 32).

General Information

This page intentionally left blank

How to Ride the Motorcycle

HOW TO RIDE THE MOTORCYCLE

Table of Contents

| | |
|--|----|
| To Stop the Engine..... | 38 |
| To Start the Engine..... | 38 |
| Moving Off/Changing Gears..... | 40 |
| Braking..... | 41 |
| Parking..... | 43 |
| Considerations for High-Speed Operation..... | 44 |
| General..... | 44 |
| Steering..... | 44 |
| Luggage..... | 44 |
| Brakes..... | 45 |
| Tyres..... | 45 |
| Fuel..... | 45 |
| Engine Oil..... | 45 |
| Electrical Equipment..... | 45 |
| Miscellaneous..... | 45 |

How to Ride the Motorcycle

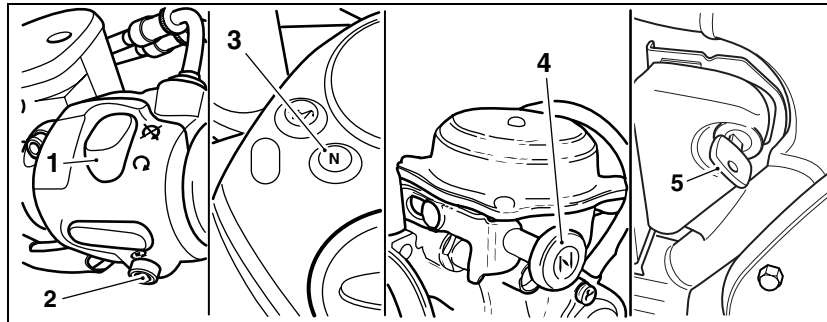

1. Engine stop switch
2. Starter button
3. Neutral indicator light
4. Choke
5. Ignition switch

To Stop the Engine

- Close the throttle completely.
- Select neutral.
- Turn the ignition switch off.
- Select first gear.
- Support the motorcycle on a firm and level surface with the side stand.
- Withdraw the ignition key from the ignition switch.
- Engage the steering lock (see page 25).

Caution

The engine should normally be stopped by turning the ignition switch to the OFF position. The engine stop switch is for emergency use only. Do not leave the ignition switched on with the engine stopped. Electrical damage may result.

To Start the Engine

- Release the steering lock.
- Check that the engine stop switch is in the RUN position.
- Insert the ignition key and turn the ignition switch to the ON position.
- Ensure that the transmission is in neutral.
- Pull the clutch lever fully into the handlebar.
- If the engine is cold, pull out the choke, noting the following: Above 25°C air temperature, pull out the choke to the first position. Below 25°C air temperature, pull out the choke fully.
- If the engine is partly warm, pull out the choke to the first position.
- Leaving the throttle completely closed, push the starter button until the engine starts.
- Release the clutch lever slowly.
- During warm-up, gradually push the choke in a little at a time as necessary to prevent the engine from racing or stalling.

How to Ride the Motorcycle

- When the engine is sufficiently warm to idle without the choke, push the choke knob fully in.
- If the engine is hot, ensure that the choke is pushed fully in.

Warning

Never start the engine or run the engine in a confined area. Exhaust fumes are poisonous and can rapidly cause loss of consciousness and death within a short time.

Always operate your motorcycle in the open-air or in an area with adequate ventilation.

Caution

This Triumph motorcycle is air cooled and consequently requires air-flow over the cylinders and head to maintain correct engine operating temperature. Extended periods of idling or prolonged rides at very slow speeds, such as in very slow moving or stationary traffic, may overheat the engine resulting in severe damage.

Caution

Do not operate the starter continuously for more than 5 seconds as the starter motor will overheat and battery power will drop. Wait 15 seconds between each operation of the starter to allow for cooling and recovery of battery power.

Caution

The low oil pressure warning light should go out as soon as the engine starts.

If the low oil pressure warning light stays on after starting the engine, stop the engine immediately and investigate the cause.

Running the engine with low oil pressure will cause severe engine damage.

Note:

- **The motorcycle is equipped with starter lockout switches. The switches prevent the electric starter from operating when the transmission is not in neutral with the side stand down.**
- **If the side stand is extended whilst the engine is running, and the transmission is not in neutral then the engine will stop regardless of clutch position.**

How to Ride the Motorcycle

Moving Off/Changing Gears

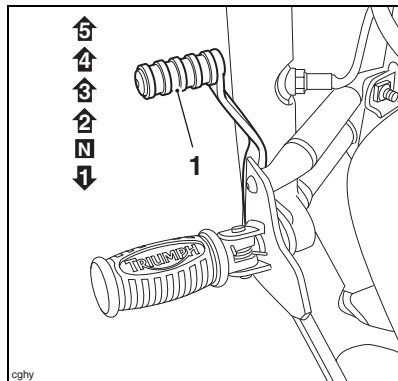

1. Gear change pedal

- Pull in the clutch lever and select first gear. Open the throttle slightly and let out the clutch lever slowly. As the clutch starts to engage, open the throttle a little more, allowing enough engine speed to avoid stalling.
- Close the throttle while pulling in the clutch lever. Change into the next higher or lower gear. Open the throttle part way, while releasing the clutch lever. Always use the clutch when changing gear.

Warning

Take care to avoid opening the throttle too far or too fast in any of the lower gears as this can lead to the front wheel lifting from the ground ('pulling a wheelie') and the rear tyre breaking traction (wheel spin).

Always open the throttle cautiously, particularly if you are unfamiliar with the motorcycle as a 'wheelie' or loss of traction will cause loss of motorcycle control and an accident.

Note:

- **The gear change mechanism is the 'positive stop' type. This means that, for each movement of the gear change pedal, you can only select each gear, one after the other, in ascending or descending order.**

Warning

Do not change to a lower gear at speeds which will cause excessive engine rpm (r/min.). This can lock the rear wheel causing loss of control and an accident. Engine damage may also be caused. Changing down should only be at moderate engine speeds for each gear.

How to Ride the Motorcycle

Braking

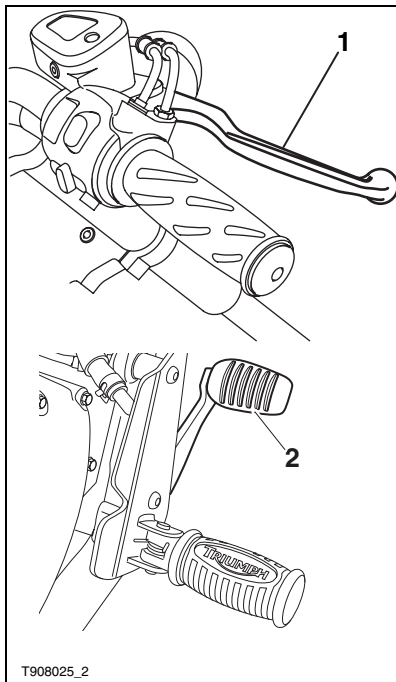

1. Front brake lever
2. Rear brake pedal

Warning

WHEN BRAKING, OBSERVE THE FOLLOWING:

Close the throttle completely, leaving the clutch engaged to allow the engine to help slow down the motorcycle.

Change down one gear at a time such that the transmission is in first gear when the motorcycle comes to a complete stop.

When stopping, always apply both brakes at the same time. Normally the front brake should be applied a little more than the rear.

Change down or fully disengage the clutch as necessary to keep the engine from stalling.

Never lock the brakes, as this may cause loss of control of the motorcycle and an accident.

Warning

For emergency braking, disregard down changing, and concentrate on applying the front and rear brakes as hard as possible without skidding. Riders should practice emergency braking in a traffic-free area.

Triumph strongly recommend that all riders take a course of instruction which includes advice on safe brake operation. Incorrect brake technique could result in loss of control and an accident.

How to Ride the Motorcycle

Warning

For your safety, always exercise extreme caution when braking, accelerating or turning as any incautious action can cause loss of control and an accident. Independent use of the front or rear brakes reduces overall braking performance. Extreme braking may cause either wheel to lock, reducing control of the motorcycle and causing an accident.

When possible, reduce speed or brake before entering a turn as closing the throttle or braking in mid-turn may cause wheel slip leading to loss of control and an accident.

When riding in wet or rainy conditions, or on loose surfaces, the ability to manoeuvre and stop will be reduced. All of your actions should be smooth under these conditions. Sudden acceleration, braking or turning may cause loss of control and an accident.

Warning

When descending a long, steep gradient, use engine braking by down changing and use the brakes intermittently. Continuous brake application can overheat the brakes and reduce their effectiveness.

Riding with your foot on the brake pedal or your hands on the brake lever may actuate the brake light, giving a false indication to other drivers. It may also overheat the brake, reducing braking effectiveness.

Do not coast with the engine switched off, and do not tow the motorcycle. The transmission is pressure-lubricated only when the engine is running. Inadequate lubrication may cause damage or seizure of the transmission which can lead to sudden loss of motorcycle control and an accident.

How to Ride the Motorcycle

Parking

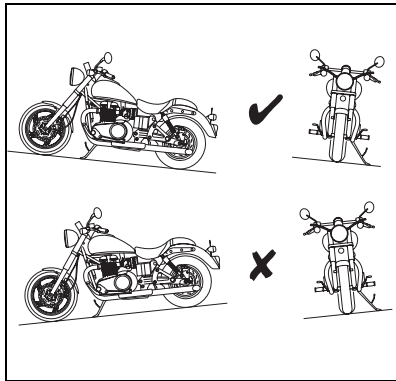

Select neutral and turn the ignition switch to the OFF position.

Lock the steering to help prevent theft.

Always park on a firm, level surface to prevent the motorcycle from falling.

When parking on a hill, always park facing uphill to prevent the motorcycle from rolling off the stand.

On a lateral (sideways) incline, always park such that the incline naturally pushes the motorcycle towards the side stand.

Do not park on a lateral (sideways) incline of greater than 6° and never park facing downhill.

Note:

- **When parking near traffic at night, or when parking in a location where parking lights are required by law, leave the tail, licence plate and position lights on by turning the ignition switch to P (PARK).**
- **Do not leave the switch in the P position for long periods as this will discharge the battery.**

Warning

Do not park on a soft or on a steeply inclined surface. Parking under these conditions may cause the motorcycle to fall over causing damage to property and personal injury.

Warning

Petrol is extremely flammable and can be explosive under certain conditions. If parking inside a garage or other structure, be sure it is well ventilated and the motorcycle is not close to any source of flame or sparks. This includes any appliance with a pilot light.

Failure to follow the above advice may cause a fire resulting in damage to property or personal injury.

Warning

The engine and exhaust system will be hot after riding. DO NOT park where pedestrians and children are likely to touch the motorcycle.

Touching any part of the engine or exhaust system when hot may cause unprotected skin to become burnt.

How to Ride the Motorcycle

Considerations for High-Speed Operation

Warning

This Triumph motorcycle should be operated within the legal speed limits for the particular road travelled. Operating a motorcycle at high speeds can be potentially dangerous since the time available to react to given traffic situations is greatly reduced as road speed increases. Always reduce speed in consideration of weather and traffic conditions.

Warning

Only operate this Triumph motorcycle at high speed in closed-course on-road competition or on closed-course racetracks. High-speed operation should only then be attempted by riders who have been instructed in the techniques necessary for high-speed riding and are familiar with the motorcycle's characteristics in all conditions.

High-speed operation in any other circumstances is dangerous and will lead to loss of motorcycle control and an accident.

Warning

The handling characteristics of a motorcycle at high speed may vary from those you are familiar with at legal road speeds. Do not attempt high-speed operation unless you have received sufficient training and have the required skills as a serious accident may result from incorrect operation.

Warning

The items listed are extremely important and must never be neglected. A problem which may not be noticed at normal operating speeds may be greatly exaggerated at high speeds.

General

Ensure the motorcycle has been maintained according to the scheduled maintenance chart.

Steering

Check that the handlebar turns smoothly without excessive free play or tight spots. Ensure that the control cables do not restrict the steering in any way.

Luggage

Make certain that any luggage containers are closed, locked and securely fitted to the motorcycle.

How to Ride the Motorcycle

Brakes

Check that the front and rear brakes are functioning properly.

Tyres

High-speed operation is hard on tyres, and good tyres are crucial for riding safely. Examine their overall condition, inflate to the correct pressure (when the tyres are cold), and check the wheel balance. Securely fit the valve caps after checking tyre pressures. Observe the information given in the Maintenance and Specification sections on tyre checking and tyre safety.

Fuel

Have sufficient fuel for the higher consumption experienced during high-speed operation.

Engine Oil

Make certain that the oil level is correct. Ensure that the correct grade and type of oil is used when topping up.

Electrical Equipment

Make certain that the headlight, rear/brake light, indicators, horn etc., all work properly.

Miscellaneous

Make certain that all fixings are tight and that all safety related parts are in good condition.



Caution

The exhaust system is fitted with a catalytic converter to help reduce exhaust emission levels. The catalytic converter can be permanently damaged if the motorcycle is allowed to run out of fuel or if the fuel level is allowed to get very low. Always ensure you have adequate fuel for your journey.

How to Ride the Motorcycle

This page intentionally left blank

Accessories and Loading

ACCESSORIES AND LOADING

The addition of accessories and carriage of additional weight can affect the motorcycle's handling characteristics causing changes in stability and necessitating a reduction in speed. The following information has been prepared as a guide to the potential hazards of adding accessories to a motorcycle and carrying passengers and additional loads.

Warning

Incorrect loading may result in an unsafe riding condition leading to an accident.

Always ensure any loads carried are evenly distributed on both sides of the motorcycle. Ensure that the load is correctly secured such that it will not move around while the motorcycle is in motion.

Always check the load security regularly (though not while the motorcycle is in motion) and ensure that the load does not extend beyond the rear of the motorcycle.

Never exceed the maximum vehicle loading weight of 200 kg (440 lbs).

This maximum loading weight is made up from the combined weight of the rider, passenger and any load carried.

Warning

Do not install accessories or carry luggage that impairs the control of the motorcycle. Make sure that you have not adversely affected the visibility or operation of any lighting component, changed road clearance or banking capability (i.e. lean angle), control operation, wheel travel, front fork movement, or any other aspect of the motorcycle's operation.

Warning

Never ride an accessory equipped motorcycle, or a motorcycle carrying a payload of any kind, at speeds above 80 mph (130 km/h). In either/both of these conditions, speeds in excess of 80 mph (130 km/h) should not be attempted even where the legal speed limit permits this.

The presence of accessories and/or payload will cause changes in the stability and handling of the motorcycle.

Failure to allow for changes in motorcycle stability may lead to loss of control or an accident.

Remember that the 80 mph (130 km/h) absolute limit will be reduced by the fitting of non-approved accessories, incorrect loading, worn tyres, overall motorcycle condition and poor road or weather conditions.

Accessories and Loading

Warning

This motorcycle must not be operated above the legal road speed limit except in authorised closed-course conditions.

Warning

Only operate this Triumph motorcycle at high speed in closed-course on-road competition or on closed-course racetracks. High-speed operation should only then be attempted by riders who have been instructed in the techniques necessary for high-speed riding and are familiar with the motorcycle's characteristics in all conditions.

High-speed operation in any other circumstances is dangerous and will lead to loss of motorcycle control and an accident.

Warning

The handling and braking capabilities of a motorcycle will be affected by the presence of a passenger. The rider must make allowances for these changes when operating the motorcycle with a passenger and should not attempt such operation unless trained to do so and without becoming familiar and comfortable with the changes in motorcycle operating characteristics that this brings about.

Motorcycle operation without making allowances for the presence of a passenger could lead to loss of motorcycle control and an accident.

Warning

Your passenger should be instructed that he or she can cause loss of motorcycle control by making sudden movements or by adopting an incorrect seated position.

The rider should instruct the passenger as follows:

- It is important that the passenger sits still while the motorcycle is in motion and does not interfere with the operation of the motorcycle.
- To keep his or her feet on the passenger footrests and to firmly hold onto the seat strap or the rider's waist or hips.
- Advise the passenger to lean with the rider when travelling around corners and not to lean unless the rider does so.

Warning

Do not carry animals on your motorcycle. An animal could make sudden and unpredictable movements that could lead to loss of motorcycle control and an accident.

Accessories and Loading

Warning

Do not carry a passenger unless he or she is tall enough to reach the footrests provided.

A passenger who is not tall enough to reach the footrests will be unable to sit securely on the motorcycle and may cause instability leading to loss of control and an accident.

Warning

Never attempt to store any items between the frame and the steering equipment. This can restrict the steering and will cause loss of control leading to an accident.

Weight attached to the handlebar or front fork will increase the mass of the steering assembly and can result in loss of steering control leading to an accident.

Warning

If the passenger seat is used to carry small objects, they must not exceed 5 kg in weight, must not impair control of the motorcycle, must be securely attached and must not extend beyond the rear or sides of the motorcycle.

Carriage of objects in excess of 5 kg in weight, that are insecure, impair control or extend beyond the rear or sides of the motorcycle may lead to loss of motorcycle control and an accident.

Even if small objects are correctly loaded onto the rear seat, the maximum speed of the motorcycle must be reduced to 80 mph (130 km/h).

Accessories and Loading

This page intentionally left blank

Maintenance and Adjustment

MAINTENANCE AND ADJUSTMENT

Table of Contents

| | |
|---|----|
| Scheduled Maintenance | 53 |
| Recording Scheduled Maintenance | 56 |
| Engine Oil | 57 |
| Oil Level Inspection | 58 |
| Oil and Oil Filter Change | 58 |
| Disposal of Used Engine Oil and Oil Filters | 60 |
| Oil Specification and Grade | 60 |
| Throttle Grip | 61 |
| Inspection | 61 |
| Adjustment | 62 |
| Clutch | 63 |
| Inspection | 64 |
| Adjustment | 64 |
| Drive Chain | 65 |
| Chain Lubrication | 65 |
| Chain Free-Movement | 66 |
| Chain Wear Inspection | 67 |
| Brakes | 69 |
| Brake Pad Wear Inspection | 69 |
| Breaking-in New Brake Pads and Discs | 69 |
| Brake Pad Wear Compensation | 69 |
| Brake Light Switches | 70 |
| Brake Fluid | 70 |
| Front Brake Fluid Level Inspection and Adjustment | 71 |
| Rear Brake Fluid Level Inspection and Adjustment | 71 |
| Steering/Wheel Bearings | 72 |
| Steering Inspection | 72 |
| Wheel Bearings Inspection | 73 |
| Front Suspension | 74 |
| Front Fork Inspection | 74 |
| Suspension Setting | 74 |

Maintenance and Adjustment

| | |
|---|----|
| Rear Suspension Adjustment | 74 |
| Suggested Suspension Settings | 75 |
| Tyres | 75 |
| Tyre Inflation Pressures | 76 |
| Tyre Wear | 76 |
| Minimum Recommended Tread Depth | 76 |
| Tyre Replacement | 77 |
| Battery | 79 |
| Battery Disposal | 79 |
| Battery Removal | 80 |
| Battery Maintenance | 80 |
| Battery Discharge | 81 |
| Battery Discharge During Storage and Infrequent Use of the Motorcycle | 81 |
| Battery Charging | 82 |
| Battery Installation | 83 |
| Fuses | 83 |
| Fuse Location | 83 |
| Fuse Replacement | 84 |
| Fuse Identification | 84 |
| Headlight | 85 |
| Headlight Adjustment | 85 |
| Headlight/Position Light Bulb Replacement | 86 |
| Rear Light/Licence Plate Light | 87 |
| Bulb Replacement | 87 |
| Direction Indicator Lights | 87 |
| Bulb Replacement | 87 |
| Cleaning | 88 |
| Preparation for Washing | 88 |
| Where to be Careful | 88 |
| Seat Care | 89 |
| After Washing | 89 |
| Unpainted Aluminium Items | 89 |
| Cleaning of Exhaust System | 90 |
| Accessory Windscreen Cleaning | 91 |

Maintenance and Adjustment

Scheduled Maintenance

To maintain the motorcycle in a safe and reliable condition, the maintenance and adjustments outlined in this section must be carried out as specified in the schedule of daily checks, and also in line with the scheduled maintenance chart. The information that follows describes the procedures to follow when carrying out the daily checks and some simple maintenance and adjustment items.

Warning

Special tools, knowledge and training are required in order to correctly carry out the maintenance items listed in the scheduled maintenance chart. Only an authorised Triumph dealer will have this knowledge and equipment.

Since incorrect or neglected maintenance can lead to a dangerous riding condition, always have an authorised Triumph dealer carry out the scheduled maintenance of this motorcycle.

Maintenance and Adjustment

| Operation Description | Odometer Reading in Miles (Kms) or Time Period, whichever comes first | | | | | |
|--|---|-------------------------|-----------------------------|-------------------------------|-------------------------------|-------------------------------|
| | | First Service | A Service | B Service | C Service | D Service |
| | Every | 500 (800) 1 month | 6,000 (10,000) 1 year | 12,000 (20,000) 2 years | 18,000 (30,000) 3 years | 24,000 (40,000) 4 years |
| Engine and oil cooler - check for leaks | Day | • | • | • | • | • |
| Engine oil - renew | - | • | • | • | • | • |
| Engine oil filter - renew | - | • | • | • | • | • |
| Valve clearances - check/adjust | - | | | • | | • |
| Air cleaner element - renew | - | | | • | | • |
| Spark plugs - check | - | | • | | • | |
| Spark plugs - renew | - | | | • | | • |
| Autoscan - carry out a full Autoscan using the Triumph diagnostic tool | - | • | | • | | • |
| Engine ECM - check for stored DTCs | | | • | | • | |
| Fuel filter - renew | - | | | • | | • |
| Fuel system - check for leaks, chafing etc. | Day | • | • | • | • | • |
| Throttle cables - check/adjust | Day | • | • | • | • | • |
| Lights, instruments and electrical systems - check | Day | • | • | • | • | • |
| Steering - check for free operation | Day | • | • | • | • | • |
| Headstock bearings - check/adjust | - | • | • | • | • | • |
| Headstock bearings - lubricate | - | | | • | | • |
| Forks - check for leaks/smooth operation | Day | • | • | • | • | • |
| Fork oil - renew | - | | | | | • |
| Brake fluid levels - check | Day | • | • | • | • | • |

Maintenance and Adjustment

| Operation Description | Odometer Reading in Miles (Kms) or Time Period, whichever comes first | | | | | |
|--|---|-------------------------|-----------------------------|-------------------------------|-------------------------------|-------------------------------|
| | | First Service | A Service | B Service | C Service | D Service |
| | Every | 500 (800) 1 month | 6,000 (10,000) 1 year | 12,000 (20,000) 2 years | 18,000 (30,000) 3 years | 24,000 (40,000) 4 years |
| Brake calipers, check for fluid leaks and seized pistons | - | • | • | • | • | • |
| Brake master cylinders - check for fluid leaks | - | • | • | • | • | • |
| Brake fluid - renew | Every 2 years | | | | | |
| Brake light - check operation | Day | • | • | • | • | • |
| Brake pads - check wear levels | Day | • | • | • | • | • |
| Drive chain - lubricate | Every 200 miles (300 kms) | | | | | |
| Drive chain - wear check | Every 500 miles (800 kms) | | | | | |
| Drive chain slack - check/adjust | Day | • | • | • | • | • |
| Fasteners - inspect visually for security | Day | • | • | • | • | • |
| Wheels - inspect for damage | Day | • | • | • | • | • |
| Wheel bearings - check for wear/smooth operation | - | • | • | • | • | • |
| Tyre wear/tyre damage - check | Day | • | • | • | • | • |
| Tyre pressures - check/adjust | Day | • | • | • | • | • |
| Clutch cable - check/adjust | Day | • | • | • | • | • |
| Fuel and evaporative* hoses - renew | - | | | | | • |
| Secondary air injection system - check/clean | - | | | • | | • |

* Evaporative hoses on California models only

Maintenance and Adjustment

Warning

All maintenance is vitally important and must not be neglected. Incorrect maintenance or adjustment may cause one or more parts of the motorcycle to malfunction. A malfunctioning motorcycle is dangerous and may lead to an accident.

Weather, terrain and geographical location affects maintenance. The maintenance schedule should be adjusted to match the particular environment in which the vehicle is used and the demands of the individual owner.

Since incorrect or neglected maintenance can lead to a dangerous riding condition, always have an authorised Triumph dealer carry out the scheduled maintenance of this motorcycle.

Triumph Motorcycles cannot accept any responsibility for damage or injury resulting from incorrect maintenance or improper adjustment carried out by the owner.

Recording Scheduled Maintenance

Scheduled Service

**6000 Miles
10,000 Kms or
1 Year whichever comes first.**

Dealer Stamp

Service carried out in accordance with the scheduled maintenance chart.

Date

Miles/Kms

Service Handbook Entry

Each time you visit your authorised Triumph dealer for scheduled servicing, always present your service handbook to the dealer's reception staff.

The service handbook is your record that the scheduled maintenance procedures have been carried out as required under the terms of the motorcycle warranty.

On collecting the motorcycle after servicing, always ensure that your service handbook has been stamped and the date of servicing and current odometer reading recorded.

This information will be needed in the event of a warranty claim and will also enhance the value of your motorcycle for future owners.

Maintenance and Adjustment

Engine Oil

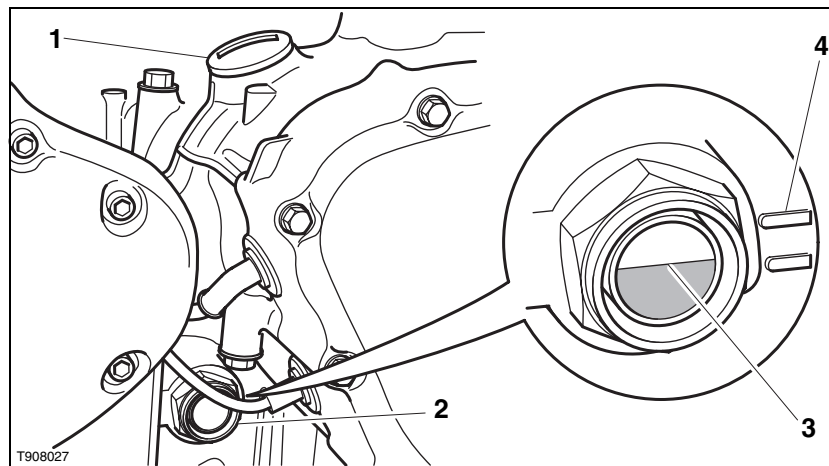

1. Filler
2. Sight glass
3. Oil level (correct level shown)
4. Crankcase oil level lines

In order for the engine, transmission, and clutch to function correctly, maintain the engine oil at the correct level, and change the oil and oil filter in accordance with scheduled maintenance requirements.

Warning

Motorcycle operation with insufficient, deteriorated, or contaminated engine oil will cause accelerated engine wear and may result in engine or transmission seizure. Seizure of the engine or transmission may lead to loss of control and an accident.

Maintenance and Adjustment

Oil Level Inspection

- Start the engine and run at idle for approximately five minutes.
- Stop the engine, then wait for at least three minutes to allow the oil to settle.
- Note the oil level visible in the sight glass.
- When correct, oil should be visible in the sight-glass at a point mid-way between the two horizontal lines marked on the crankcase.

Note:

- **The actual level is indicated when the motorcycle is level and upright, not on the side stand.**
- If it is necessary to top up the oil level, remove the filler plug and add oil, a little at a time, until the level registered in the sight glass is correct.

Warning

If the engine has recently been running, the exhaust system will be hot. Before working on or near the exhaust system, allow sufficient time for the exhaust system to cool as touching any part of a hot exhaust system could cause burn injuries.

- Once the correct level is reached, fit and fully tighten the filler plug.

Oil and Oil Filter Change

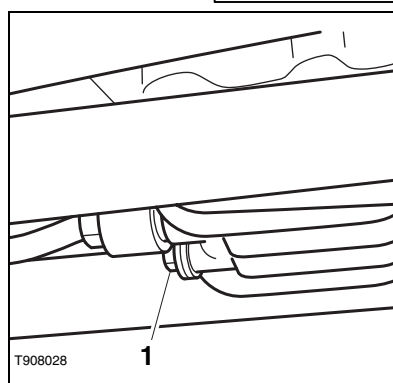
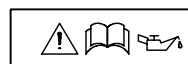

1. Oil drain plug

Warning

Prolonged or repeated contact with engine oil can lead to skin dryness, irritation and dermatitis. In addition, used engine oil contains potentially harmful contaminants which can cause cancer. Wear suitable clothing and avoid skin contact.

The engine oil and filter must be replaced in accordance with scheduled maintenance requirements.

- Warm up the engine thoroughly, and then stop the engine.
- Place an oil pan beneath the engine.
- Remove the engine drain plug.

Maintenance and Adjustment

Warning

The oil may be hot to the touch. Avoid contact with the hot oil by wearing suitable protective clothing, gloves, eye protection etc. Contact with hot oil may cause the skin to be scalded or burned.

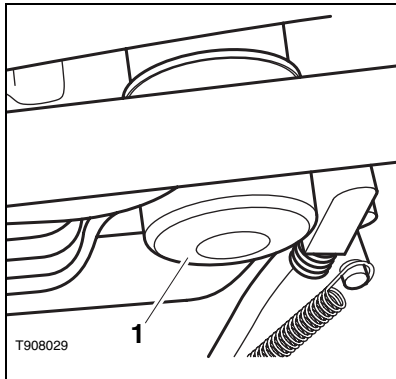

1. Oil filter

- Unscrew and remove the oil filter using the Triumph service tool T3880313. Dispose of the oil filter in an environmentally friendly way.
- Pre-fill the replacement oil filter with new engine oil.
- Apply a smear of clean engine oil to the sealing ring of the new oil filter. Fit the oil filter and tighten to **10 Nm**.
- After the oil has completely drained out, fit a new sealing washer to the drain plug. Fit and tighten the plug to **25 Nm**.

Warning

If the engine has recently been running, the exhaust system will be hot. Before working on or near the exhaust system, allow sufficient time for the exhaust system to cool as touching any part of a hot exhaust system could cause burn injuries.

- Remove the oil filler plug. Fill the engine with new oil of the type and grade listed in the Specification section, until oil begins to show in the sight glass. Do not overfill or exceed the capacities given in the Specification section.
- Start the engine and allow it to idle for a minimum of 30 seconds.

Caution

Raising the engine speed above idle, before the oil reaches all parts of the engine can cause engine damage or seizure. Only raise engine speed after running the engine for 30 seconds to allow the oil to circulate fully.

- Ensure that the oil pressure warning light extinguishes shortly after starting.

Maintenance and Adjustment

Caution

If the engine oil pressure is too low, the low oil pressure warning light will illuminate. If this warning light stays on when the engine is running, stop the engine immediately and investigate the cause. Running the engine with low oil pressure will cause engine damage.

- Stop the engine and re-check the oil level. Adjust if necessary.

Disposal of Used Engine Oil and Oil Filters

To protect the environment, do not pour oil on the ground, down sewers or drains, or into water courses. Do not place used oil filters in with general waste. If in doubt, contact your local authority.

Oil Specification and Grade

Caution

Triumph high performance engines are designed to use semi or fully synthetic 10W/40 or 15W/50 motorcycle engine oil which meets specification API SH or higher (i.e. SJ, SK or SL) AND JASO MA.

Do not add any chemical additives to the engine oil. The engine oil also lubricates the clutch and any additives could cause the clutch to slip.

Do not use mineral, vegetable, non-detergent oil, castor based oils or any oil not conforming to the required specification. The use of these oils may cause instant, severe engine damage.

Ensure no foreign matter enters the crankcase during an oil change or top-up.

Maintenance and Adjustment

Throttle Grip

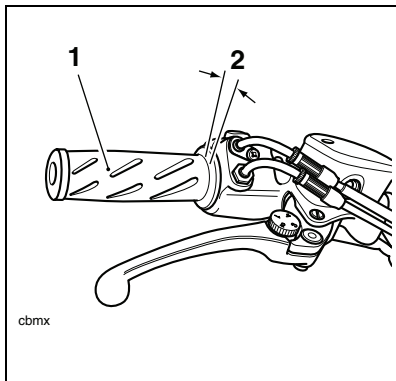

1. Throttle grip
2. 2 - 3 mm

Inspection

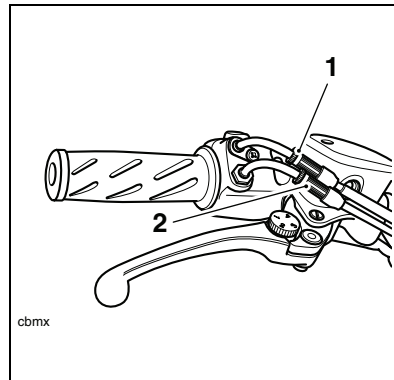

1. 'Opening' cable adjuster - twist grip end
2. 'Closing' cable

Warning

The throttle grip controls the throttle valves in the throttle bodies. If the throttle cables are incorrectly adjusted, either too tight or too loose, the throttle may be difficult to control and performance will be adversely affected.

Check the throttle grip free play in accordance with scheduled maintenance requirements and make adjustments as necessary.

Always be alert for changes in the 'feel' of the throttle and have the throttle system checked by an authorised Triumph dealer if any changes are detected. Changes can be due to wear in the mechanism, which could lead to a sticking throttle.

An incorrectly adjusted, sticking or stuck throttle will lead to loss of motorcycle control and an accident.

- Check that the throttle opens smoothly, without undue force and that it closes without sticking. Have your authorised Triumph dealer check the throttle system if a problem is detected or any doubt exists.
- Check that there is 2 - 3 mm throttle grip free play when lightly turning the throttle grip back and forth.
- If there is an incorrect amount of free play, Triumph recommends that you have adjustments made by an authorised Triumph dealer. However, in an emergency, throttle adjustments may be made as follows:

Maintenance and Adjustment

Adjustment

Warning

Use of the motorcycle with incorrectly adjusted, incorrectly routed, sticking or damaged throttle cables could interfere with the throttle function resulting in loss of control of the motorcycle and an accident.

To avoid incorrect adjustment, incorrect routing, or continued use of a sticking or damaged throttle, always have the throttle checked and adjusted by your authorised Triumph dealer.

Note:

- **Minor adjustments can be made using the adjusters near the twist grip end of the throttle. Where a correct setting cannot be achieved in this way, the adjusters at the throttle body end must be used. The 'opening' cable must be set first followed by the 'closing' cable.**
 - Remove the seat.
 - Disconnect the battery negative, (black) lead first.
 - Set the 'opening' cable adjuster at the twist grip end such that it has an equal amount of adjustment in each direction.
- Set the 'opening' cable adjuster at the throttle body end of the cable to give 2 - 3 mm of play at the twist grip. Tighten the locknut.

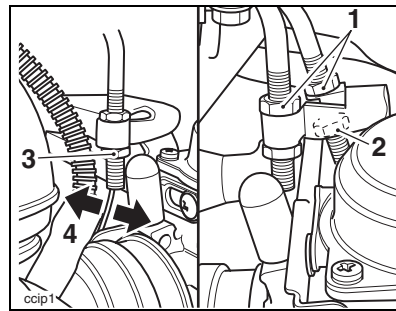

1. Locknuts

2. Opening cable adjuster

3. Closing cable adjuster

4. Closing cable - free play measurement point

- Make any minor adjustments as necessary to give 2 - 3 mm of play using the adjuster near the twist grip end of the cable. Tighten the locknut.
- With the throttle fully closed, ensure that there is 2 - 3 mm of free play in the 'closing' cable. Adjust as for the 'opening' cable if necessary. Tighten the locknut.

Maintenance and Adjustment

Warning

Ensure that both the adjuster locknuts of both cables are tightened, as a loose locknut could result in a sticking throttle. An incorrectly adjusted, sticking or stuck throttle can lead to loss of motorcycle control and an accident.

- Reconnect the battery, positive (red) lead first.
- Refit the seat.
- Check that the throttle opens smoothly, without undue force and that it closes without sticking.
- Ride carefully to your nearest authorised Triumph dealer and have him check the throttle system thoroughly before riding again.

Clutch

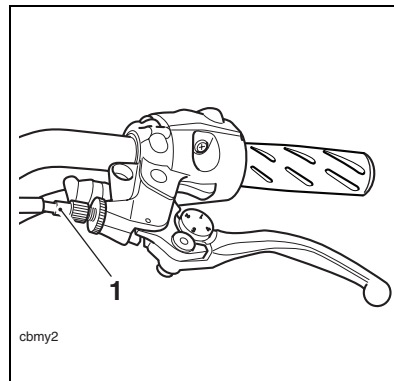

1. Clutch cable

The motorcycle is equipped with a cable-operated clutch.

If the clutch lever has excessive free play, the clutch may not disengage fully and could then cause the engine to stall and create difficulties when changing gear. Conversely, if the clutch lever has insufficient free play the clutch may not engage fully, causing clutch slip.

Clutch lever free play must be checked in accordance with scheduled maintenance requirements.

Maintenance and Adjustment

Inspection

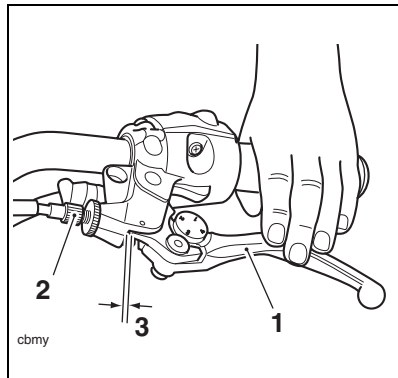

1. Lever
2. Adjuster (lever end)
3. 2 - 3 mm

- Check that there is 2 - 3 mm of clutch lever free play at the point shown in the diagram above.
- If there is an incorrect amount of free play, adjustments must be made.

Adjustment

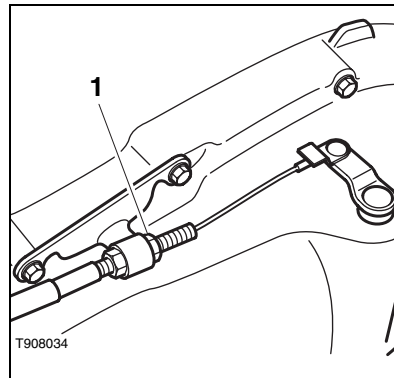

1. Adjuster (engine end)

- Loosen the knurled locknut at the lever end of the clutch cable and turn the adjuster sleeve until the correct amount of clutch lever free play is achieved.
- Tighten the knurled locknut at the clutch lever assembly.
- If the correct adjustment setting cannot be achieved using the lever adjuster, use the adjuster at the engine end of the cable.
- Loosen the adjuster locknut.
- Turn the outer cable adjuster to give 2 - 3 mm of free play at the clutch lever.
- Tighten the locknut.
- Use the lever adjuster to make minor adjustments as necessary.
- Ensure all locknuts are secured at both ends of the cable.

Maintenance and Adjustment

Drive Chain



For safety and to prevent excessive wear, the drive chain must be checked, adjusted, and lubricated in accordance with scheduled maintenance requirements. Checking, adjustment and lubrication must be carried out more frequently for extreme conditions such as dusty, wet, salty or heavily gritted roads.

If the chain is badly worn or incorrectly adjusted (either too loose or too tight) the chain could jump off the sprockets or break.

Warning

A loose or worn chain, or a chain that breaks or jumps off the sprockets could catch on the engine sprocket or lock the rear wheel.

A chain that catches on the engine sprocket will injure the rider and lead to loss of motorcycle control and an accident.

Similarly, locking the rear wheel will lead to loss of motorcycle control and an accident.

Chain Lubrication



Lubrication is necessary every 200 miles (300 kms) and also after riding in wet weather, on wet roads, or any time that the chain appears dry.

Use the special chain lubricant as recommended in the Specification section.

- Apply lubricant to the sides of the rollers. This will allow the oil to penetrate to the chain rollers and bushes. Also apply oil to the chain 'X' rings. Wipe off any excess oil.
- If the chain is especially dirty, clean first using paraffin and then apply lubricant as mentioned above.

Caution

Do not use a power 'jet' wash to clean the chain as this may cause damage to the chain components.

Maintenance and Adjustment

Chain Free-Movement

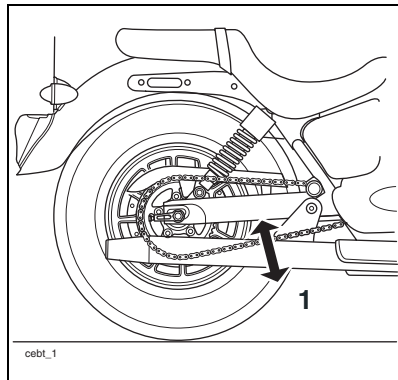

1. Maximum movement position

Inspection

- Place the motorcycle on a level surface and hold it in an upright position with no weight on it.
- Rotate the rear wheel by pushing the motorcycle to find the position where the chain is tightest, and measure the vertical movement of the chain midway between the sprockets.
- The vertical movement of the drive chain must be 35 - 45 mm.

Adjustment

- If the chain free-movement measurement is incorrect, adjustments must be made as follows:
- Loosen the wheel spindle nut.
- Moving both adjusters by an equal amount, turn the adjuster bolts clockwise to increase chain free-movement and anti-clockwise to reduce chain free-movement.

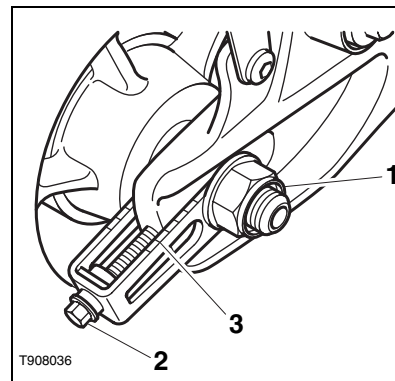

1. Rear wheel spindle nut

2. Adjusters

3. Wheel alignment markings

- When the correct amount of chain free-movement has been set, tighten the rear wheel spindle nut to **110 Nm**.
- Tighten the adjusters, anti-clockwise, to **2 Nm**.
- Ensure that the wheel alignment markings fall in the same position on both sides of the motorcycle. Adjust as necessary if incorrect.

Maintenance and Adjustment

- Rotate the rear wheel and repeat the chain adjustment check. Re-adjust if necessary.

Warning

Operation of the motorcycle with a loose wheel spindle may result in impaired stability and handling of the motorcycle. This impaired stability and handling may lead to loss of control or an accident.

- Check the rear brake effectiveness.

Chain Wear Inspection

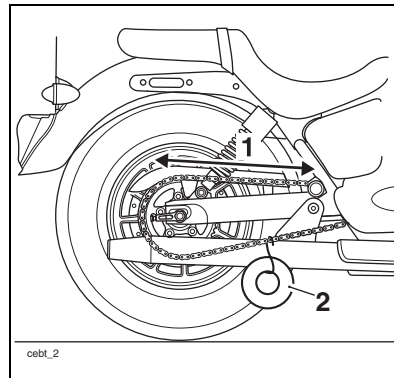

1. Measure across 20 links

2. Weight

- Remove the chain guard.
- Stretch the chain taut by hanging a 10 - 20 kg (20 - 40 lb) weight on the chain.
- Measure the length of 20 links on the straight part of the chain from pin centre of the 1st pin to the centre of the 21st pin. Since the chain may wear unevenly, take measurements at several places.
- If the length exceeds the maximum service limit of 321 mm, the chain must be replaced.
- Rotate the rear wheel and inspect the drive chain for damaged rollers, and loose pins and links.

Maintenance and Adjustment

- Also remove the sprocket cover and inspect the sprockets for unevenly or excessively worn or damaged teeth.

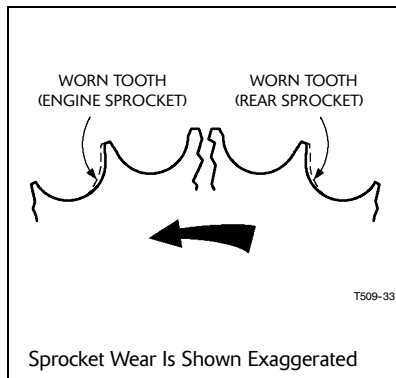

- If there is any irregularity, have the drive chain and sprockets replaced by an authorised Triumph dealer.
- Refit the chain guard and sprocket cover.

Caution

If the sprockets are found to be worn, always replace the sprockets and drive chain together.

Replacing worn sprockets without also replacing the chain will lead to premature wear of the new sprockets.

Warning

The use of non-approved chains may result in a broken chain or may cause the chain to jump off the sprockets. Either condition could lock the rear wheel, severely damaging the motorcycle and causing loss of control and an accident.

For safety, use a genuine Triumph supplied chain as specified in the Triumph parts catalogue.

Never neglect chain maintenance and always have chains installed by an authorised Triumph dealer.

Maintenance and Adjustment

Brakes

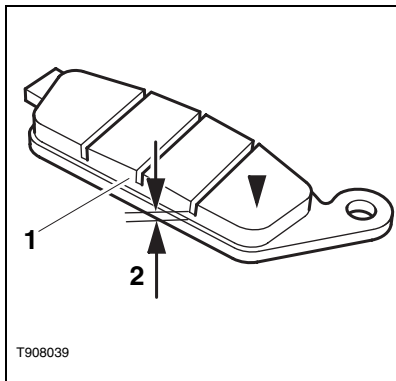

1. Lining material thickness
2. 1.5 mm (0.06 in) groove thickness

Brake Pad Wear Inspection

Brake pads must be inspected in accordance with the scheduled maintenance requirements and replaced if worn to, or beyond, the minimum service thickness.

If the lining thickness of any pad (front or rear brakes) is less than 1.5 mm (0.06 in), that is, if the pad has worn down to the bottom of the grooves, replace all the pads on the wheel.

Breaking-in New Brake Pads and Discs

After replacement brake discs and/or pads have been fitted to the motorcycle, we recommend a period of careful breaking-in that will optimise the performance and longevity of the discs and pads. The recommended distance for breaking-in new pads and discs is 200 miles (300 km).

After fitting new brake discs and/or pads avoid extreme braking, ride with caution and allow for greater braking distances during the breaking-in period.

Warning

Brake pads must always be replaced as a wheel set. At the front, where two calipers may be fitted on the same wheel, replace all the brake pads in both calipers.

Replacing individual pads will reduce braking efficiency and may cause loss of motorcycle control and an accident.

After replacement pads have been fitted, ride with extreme caution until the new pads have 'broken in'.

Brake Pad Wear Compensation

Disc and disc pad wear is automatically compensated for and has no effect on the brake lever or pedal action. There are no parts that require adjustment on the front and rear brakes.

Warning

If the brake lever or pedal feels soft when it is applied, or if the lever/pedal travel becomes excessive, there may be air in the brake lines or the brake may be defective.

It is dangerous to operate the motorcycle under such conditions and remedial action must be taken by your authorised Triumph dealer before riding.

Riding with defective brakes may lead to loss of motorcycle control and an accident.

Maintenance and Adjustment

Brake Light Switches

The brake light is activated independently by either the front or rear brake. If the brake light does not work when the front brake lever is pulled, or the rear brake pedal is pressed, ask your authorised Triumph dealer to investigate and rectify the fault.

Warning

Riding the motorcycle with defective brake lights is illegal and dangerous.

An accident causing injury to the rider and other road users may result from use of a motorcycle with defective brake lights.

Brake Fluid

Inspect the level of brake fluid in both reservoirs and change the brake fluid in accordance with scheduled maintenance requirements. At the front and rear, use only DOT 4 fluid.

The brake fluid must be changed if it becomes, or is suspected of having become contaminated with moisture or any other contaminants.

Warning

If the brake fluid in either reservoir has become, or is suspected of having become contaminated, consult your authorised Triumph dealer for advice, before riding. Contaminated brake fluid may cause the brakes to become defective. Riding with defective brakes may lead to loss of motorcycle control and an accident.

Warning

If there has been an appreciable drop in the level of fluid in either fluid reservoir, consult your authorised Triumph dealer before riding. Riding with depleted brake fluid levels or with a brake fluid leak is dangerous and will cause reduced brake performance potentially leading to loss of motorcycle control and an accident.

Warning

Brake fluid is hygroscopic which means it will absorb moisture from the air.

Any absorbed moisture will greatly reduce the boiling point of the brake fluid causing a reduction in braking efficiency.

Because of this, always replace brake fluid in accordance with the scheduled maintenance requirements.

Always use new brake fluid from a sealed container and never use fluid from an unsealed container or from one which has been previously opened.

Do not mix different brands or grades of brake fluid.

Check for fluid leakage around brake fittings, seals and joints and also check the brake hoses for splits, deterioration and damage.

Always rectify any faults before riding.

Failure to observe and act upon any of these items may cause a dangerous riding condition leading to loss of motorcycle control and an accident.

Maintenance and Adjustment

Front Brake Fluid Level Inspection and Adjustment

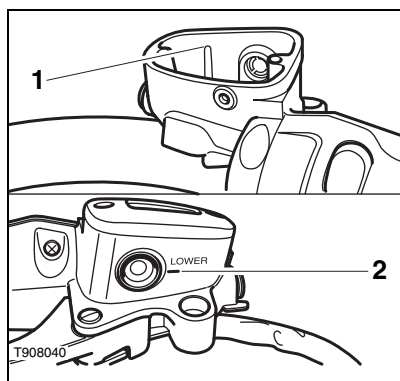

1. Upper level line, front brake
2. Lower level line, front brake

- To inspect the front fluid level, check the level of fluid visible in the window at the front of the reservoir body.
- The brake fluid level must be kept between the upper and lower level lines (reservoir held horizontal).
- To adjust the fluid level, release the cap screws and detach the cover noting the position of the sealing diaphragm.
- Fill the reservoir to the upper level line using new DOT 4 fluid from a sealed container.
- Refit the cover, ensuring that the diaphragm seal is correctly positioned between the cap and reservoir body.
- Tighten the cap retaining screws.

Rear Brake Fluid Level Inspection and Adjustment

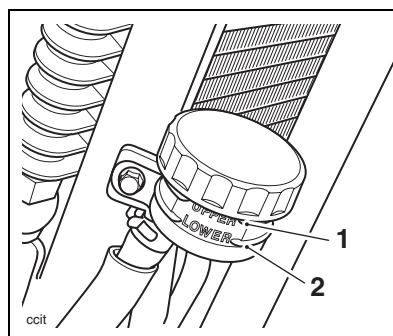

1. Upper level, rear brake
2. Lower level, rear brake

- The rear brake fluid level is visible from the front without removing the reservoir or cover.
- The brake fluid level in the rear reservoir must be kept between the upper and lower level lines.
- To adjust the rear brake fluid level, release the screw securing the reservoir to the frame and detach the reservoir cover.
- While holding the reservoir upright, remove the cover noting the position of the diaphragm inside.
- Fill the reservoir to the upper level line using DOT 4 fluid from a sealed container.
- Refit the reservoir cap ensuring that the diaphragm seal is correctly positioned between the cap and reservoir body.

Maintenance and Adjustment

- Locate the black reservoir cover, position the assembly to the frame and secure with the screw previously removed. Tighten the screw to **7 Nm**.

Steering/Wheel Bearings

Steering Inspection

Lubricate and inspect the condition of the headstock (steering) bearings in accordance with scheduled maintenance requirements.

Note:

- **Always inspect the wheel bearings at the same time as the steering bearings.**

Warning

To prevent risk of injury from the motorcycle falling during the inspection, ensure that the motorcycle is stabilised and secured on the support.

Do not exert extreme force against each wheel or rock each wheel vigorously as this may cause the motorcycle to become unstable or cause injury by falling from its support.

Ensure that the position of the support block will not cause damage to the oil lines or oil filter beneath the sump.

Maintenance and Adjustment

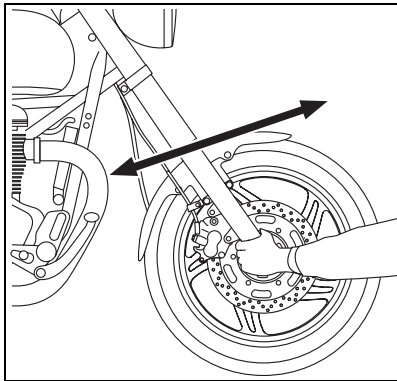

Inspecting the Steering for Free Play

Inspection

- Position the motorcycle on level ground, in an upright position.
- Raise the front wheel off the ground.
- Hold the lower end of the front forks and try to move them forward and backward.
- If any free play can be detected, ask your authorised Triumph dealer to inspect and rectify any faults before riding.

! Warning

Riding the motorcycle with incorrectly adjusted or defective steering bearings may cause loss of motorcycle control and an accident.

- Remove the support and place the motorcycle on the side stand.

Wheel Bearings Inspection

If the wheel bearings in the front or rear wheel allow play in the wheel hub, are noisy, or if the wheel does not turn smoothly, have your authorised Triumph dealer inspect the wheel bearings.

The wheel bearings must be inspected at the intervals specified in the scheduled maintenance chart.

- Position the motorcycle on level ground, in an upright position.
- Raise the front wheel off the ground.
- Gently rock the top of the front wheel from side to side.
- If any free play can be detected, ask your authorised Triumph dealer to inspect and rectify any faults before riding.
- Reposition the lifting device and repeat for the rear wheel.

! Warning

Operation with worn or damaged wheel bearings may cause impaired handling and instability leading to loss of motorcycle control and an accident. If in doubt, have the motorcycle inspected by an authorised Triumph dealer before riding.

- Remove the support and place the motorcycle on the side stand.

Maintenance and Adjustment

Front Suspension

Front Fork Inspection

- Examine each fork stanchion for any sign of damage, scratching of the slider surface, or for oil leaks.
- If any damage or leakage is found, consult an authorised Triumph dealer.

To check that the forks operate smoothly:

- Position the motorcycle on level ground.
- While holding the handlebars and applying the front brake, pump the forks up and down several times.

Note:

- **If roughness or excessive stiffness is detected, consult your authorised Triumph dealer.**

Warning

Riding the motorcycle with defective or damaged suspension can damage the motorcycle, cause loss of motorcycle control and an accident.

Suspension Setting

The America and Speedmaster models both have non-adjustable front suspension.

Warning

Never attempt to dismantle any part of the suspension units, as all units contain pressurised oil. Skin and eye damage can result from contact with the pressurised oil.

Rear Suspension Adjustment

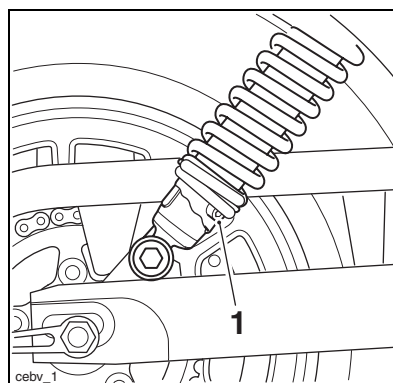

1. Rear suspension pre-load adjusters - all models

The standard rear suspension pre-load settings provide a comfortable ride and good handling characteristics for general, solo riding. The table (on the facing page) shows suggested settings for rear suspension pre-load under differing load conditions.

To change the rear suspension spring pre-load setting, insert a suitable tool into the hole provided in the adjuster ring.

Turn the adjuster ring clockwise to increase spring pre-load, and anti-clockwise to decrease spring pre-load.

Warning

Ensure that the adjusters are set to the same setting on both rear suspension units. Settings which vary from left to right may affect handling and stability resulting in loss of motorcycle control, and an accident.

Maintenance and Adjustment

Suggested Suspension Settings

Rear adjuster settings are counted from one with position one being with the adjuster turned fully anti-clockwise. There are five adjuster positions in total. Position one gives the minimum amount of spring pre-load.

| Loading Condition | Rear Adjuster Position |
|------------------------|------------------------|
| Solo Riding - Softer | 1 |
| Solo Riding - Standard | 2 |
| Solo Riding - Firmer | 3 |
| Rider and Passenger | 5 |

Note:

- The details given in the table are to be used as a guide only where the rider and passenger each weigh 90 kg or less. Setting requirements should be increased for heavier riders and passengers according to personal preferences.

Tyres

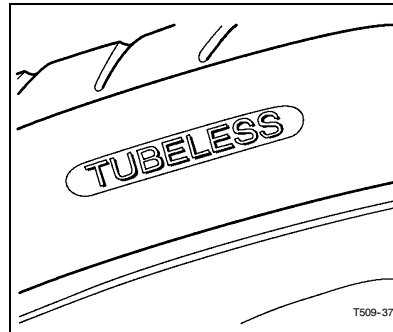

Typical Tyre Marking

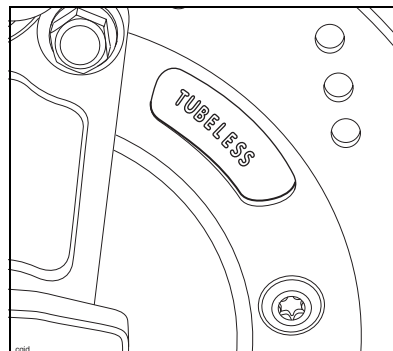

Typical Wheel Marking

Both models are equipped with tubeless tyres, valves and wheel rims. Use only tyres marked 'TUBELESS' and tubeless valves on rims marked 'SUITABLE FOR TUBELESS TYRES'.

Maintenance and Adjustment

Tyre Inflation Pressures

Correct tyre inflation pressures will provide maximum stability, rider comfort and tyre life. Always check tyre pressures before riding when the tyres are cold.

Check tyre pressures daily and adjust if necessary (see Specification section for correct inflation pressures). Alternatively, ask your authorised Triumph dealer to inspect your wheels and tyres.

Warning

Incorrect tyre inflation will cause abnormal tread wear and instability problems which may lead to loss of control and an accident.

Under-inflation may result in the tyre slipping on, or coming off the rim. Over-inflation will cause instability and accelerated tread wear.

Both conditions are dangerous as they may cause loss of control leading to an accident.

Tyre Wear



As the tyre tread wears down, the tyre becomes more susceptible to punctures. It is estimated that 90% of all tyre problems occur during the last 10% of tread life (90% worn). It is therefore not recommended to use tyres until they are worn to their minimum.

Minimum Recommended Tread Depth

In accordance with the periodic maintenance chart, measure the depth of the tread with a depth gauge, and replace any tyre that has worn to, or beyond, the minimum allowable tread depth specified in the table below:

| | |
|-------------------------|---|
| Under 130 km/h (80 mph) | 2 mm (0.08 in) |
| Over 130 km/h (80 mph) | Rear 3 mm (0.12 in) Front 2 mm (0.08 in) |

Warning

This motorcycle must not be operated above the legal road speed limit except in authorised closed-course conditions.

Warning

Only operate this Triumph motorcycle at high speed in closed-course on-road competition or on closed-course racetracks. High-speed operation should only then be attempted by riders who have been instructed in the techniques necessary for high-speed riding and are familiar with the motorcycle's characteristics in all conditions. High-speed operation in any other circumstances is dangerous and will lead to loss of motorcycle control and an accident.

Maintenance and Adjustment

Warning

Operation with excessively worn tyres is hazardous and will adversely affect traction, stability and handling which may lead to loss of control and an accident.

When tubeless tyres become punctured, leakage is often very slow. Always inspect tyres very closely for punctures. Check the tyres for cuts, embedded nails or other sharp objects. Operation with punctured or damaged tyres will adversely affect motorcycle stability and handling which may lead to loss of control or an accident.

Check the rims for dents or deformation. Operation with damaged or defective wheels or tyres is dangerous and loss of motorcycle control or an accident could result.

Always consult your authorised Triumph dealer for tyre replacement, or for a safety inspection of the tyres.

Tyre Replacement

All Triumph motorcycles are carefully and extensively tested in a range of riding conditions to ensure that the most effective tyre combinations are approved for use on each model. It is essential that approved tyres, fitted in approved combinations, are used when purchasing replacement items. The use of non-approved tyres, or approved tyres in non-approved combinations, may lead to motorcycle instability, loss of control and an accident. See the Specification section for details of approved tyre combinations. Always have tyres fitted and balanced by your authorised Triumph dealer who has the

necessary training and skills to ensure safe, effective fitment.

Warning

If a tyre sustains a puncture, the tyre must be replaced. Failure to replace a punctured tyre, or operation with a repaired tyre can lead to instability, loss of motorcycle control or an accident.

Warning

Do not install tube-type tyres on tubeless rims. The bead will not seat and the tyres could slip on the rims, causing rapid tyre deflation that may result in a loss of vehicle control and an accident. Never install an inner tube inside a tubeless tyre. This will cause friction inside the tyre and the resulting heat build-up may cause the tube to burst resulting in rapid tyre deflation, loss of vehicle control and an accident.

Warning

If tyre damage is suspected, such as after striking the kerb, ask your authorised Triumph dealer to inspect the tyre both internally and externally. Remember, tyre damage may not always be visible from the outside. Operation of the motorcycle with damaged tyres could lead to loss of control and an accident.

Maintenance and Adjustment

Warning

When replacement tyres are required, consult your authorised Triumph dealer who will arrange for the tyres to be selected, in a correct combination, from the approved list and fitted according to the tyre manufacturer's instructions.

When tyres are replaced, allow time for the tyres to seat to the rim (approximately 24 hours). During this seating period, ride cautiously as an incorrectly seated tyre could cause loss of control or an accident.

Initially, the new tyres will not produce the same handling characteristics as the worn tyres and the rider must allow adequate riding distance (approximately 100 miles) to become accustomed to the new handling characteristics.

24 hours after fitting, the tyre pressures must be checked and adjusted, and the tyres examined for correct seating. Rectification must be carried out as necessary.

The same checks and adjustments must also be carried out when 100 miles have been travelled after fitting.

Use of a motorcycle with incorrectly seated tyres, incorrectly adjusted tyre pressures, or when not accustomed to its handling characteristics may lead to loss of control and an accident.

Warning

Tyres that have been used on a rolling road dynamometer may become damaged. In some cases, the damage may not be visible on the external surface of the tyre. Tyres must be replaced after such use as continued use of a damaged tyre may lead to instability, loss of control and an accident.

Warning

Accurate wheel balance is necessary for safe, stable handling of the motorcycle. Do not remove or change any wheel balance weights. Incorrect wheel balance may cause instability leading to loss of control and an accident.

When wheel balancing is required, such as after tyre or inner tube replacement, see your authorised Triumph dealer.

Only use self-adhesive weights. Clip on weights may damage the wheel and tyre resulting in tyre deflation, loss of motorcycle control and an accident.

Maintenance and Adjustment

Battery



Warning

Under some circumstances, the battery can give off explosive gases; keep sparks, flames and cigarettes away. Provide adequate ventilation when charging or using the battery in an enclosed space.

The battery contains sulphuric acid (battery acid). Contact with skin or eyes may cause severe burns. Wear protective clothing and a face shield.

If battery acid gets on your skin, flush with water immediately.

If battery acid gets in your eyes, flush with water for at least 15 minutes and SEEK MEDICAL ATTENTION IMMEDIATELY.

If battery acid is swallowed, drink large quantities of water and SEEK MEDICAL ATTENTION IMMEDIATELY.

KEEP BATTERY ACID OUT OF THE REACH OF CHILDREN.

Warning

The battery contains harmful materials. Always keep children away from the battery whether or not it is fitted in the motorcycle.

Do not jump start the battery, touch the battery cables together or reverse the polarity of the cables as any of these actions may cause a spark which would ignite battery gases causing a risk of personal injury.

Battery Disposal

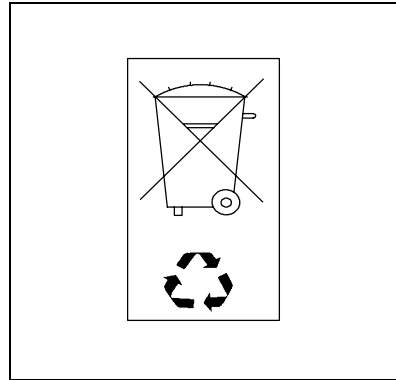

Should the battery ever require replacement, the original battery must be handed to a recycling agent who will ensure that the dangerous substances from which the battery is manufactured do not pollute the environment.

Maintenance and Adjustment

Battery Removal

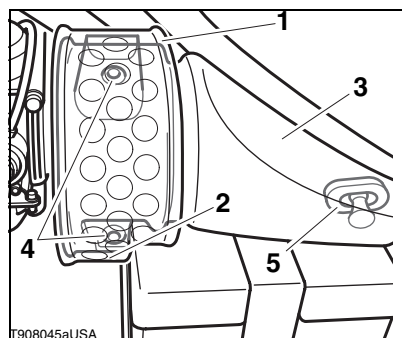

1. Airbox finisher
2. Airbox finisher fixing
3. Airbox cover
4. Airbox cover fixings
5. Stud and grommet location

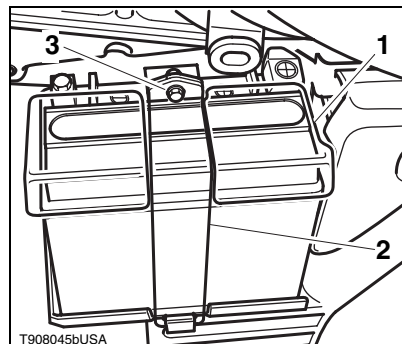

1. Battery cover
2. Battery cover strap
3. Battery cover strap fixing

- Release the screw securing the airbox finisher to the airbox cover. Remove the finisher.
- Release the screws securing the airbox cover to the airbox.

- Ease the cover outwards from the motorcycle releasing a stud, located at the rear of the cover, from its grommet.
- Remove the fixing from the battery cover strap.
- Detach the strap from its lower hinge and remove the battery cover.
- Disconnect the battery leads, negative (black) lead first.

Warning

Ensure that the battery terminals do not touch any part of the motorcycle as this may cause a short circuit or spark which would ignite battery gases causing a risk of personal injury and damage to the motorcycle.

- Tilt the battery outward from the top to remove it from the battery tray.

Battery Maintenance

Clean the battery using a clean, dry cloth. Be sure that the cable connections are clean.

Warning

The battery acid is corrosive and poisonous and will cause damage to unprotected skin. Never swallow battery acid or allow it to come into contact with the skin. To prevent injury, always wear eye and skin protection when handling the battery.

Maintenance and Adjustment

The battery is a sealed type and will not require any maintenance other than checking the Voltage and routine recharging, such as during storage.

It is not possible to adjust the battery acid level in the battery; the sealing strip must not be removed.

Battery Discharge

**Caution**

The charge level in the battery must be maintained to maximise battery life.

Failure to maintain the battery charge level could cause serious internal damage to the battery.

Under normal conditions, the motorcycle charging system will keep the battery fully charged. However, if the motorcycle is unused, the battery will gradually discharge due to a normal process called self discharge; the clock, engine control module (ECM) memory, high ambient temperatures, or the addition of electrical security systems or other electrical accessories will all increase this rate of battery discharge. Disconnecting the battery from the motorcycle during storage will reduce the rate of discharge.

Battery Discharge During Storage and Infrequent Use of the Motorcycle

During storage or infrequent use of the motorcycle, inspect the battery Voltage weekly using a digital multimeter. Follow the manufacturer's instructions supplied with the meter. Should the battery Voltage fall below 12.7 Volts, the battery should be charged (see page 82).

Allowing a battery to discharge or leaving it discharged for even a short period of time causes sulphation of the lead plates. Sulphation is a normal part of the chemical reaction inside the battery, however over time the sulphate can crystallise on the plates making recovery difficult or impossible. This permanent damage is not covered by the motorcycle warranty, as it is not due to a manufacturing defect.

Keeping the battery fully charged reduces the likelihood of it freezing in cold conditions. Allowing a battery to freeze will cause serious internal damage to the battery.

Maintenance and Adjustment

Battery Charging

For help with selecting a battery charger, checking the battery Voltage or battery charging, contact your local authorised Triumph dealer.

For extended periods of storage (beyond two weeks) the battery should be removed from the motorcycle and kept charged using a Triumph approved maintenance charger.

Similarly, should the battery charge fall to a level where it will not start the motorcycle, remove the battery from the motorcycle before charging.

Warning

The battery gives off explosive gases; keep sparks, flames and cigarettes away. Provide adequate ventilation when charging or using the battery in an enclosed space.

The battery contains sulphuric acid (battery acid). Contact with skin or eyes may cause severe burns. Wear protective clothing and a face shield.

If battery acid gets on your skin, flush with water immediately.

If battery acid gets in your eyes, flush with water for at least 15 minutes and **SEEK MEDICAL ATTENTION IMMEDIATELY.**

If battery acid is swallowed, drink large quantities of water and **SEEK MEDICAL ATTENTION IMMEDIATELY.**

KEEP BATTERY ACID OUT OF THE REACH OF CHILDREN.

Caution

Do not use an automotive quick charger as it may overcharge and damage the battery.

Should the battery Voltage fall below 12.7 Volts, the battery should be charged using a Triumph approved battery charger. Always remove the battery from the motorcycle and follow the instructions supplied with the battery charger.

Maintenance and Adjustment

Battery Installation

- Ensure the Engine Control Module (ECM) and its rubber cover are correctly located behind the battery.
- Place the battery onto the battery tray taking care not to touch the terminals to the motorcycle.
- Reconnect the battery leads, positive (red) lead first.
- Ensure the negative battery lead is installed to the rear of battery terminal as shown below.

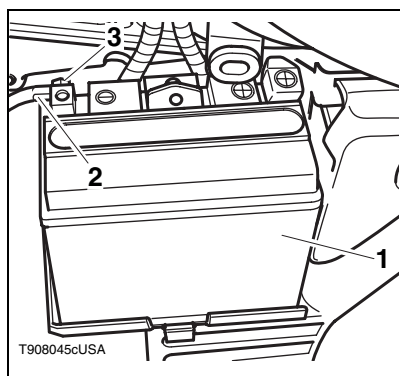

1. Battery
2. Negative lead
3. Negative terminal fixing

- Apply a light coat of grease to the terminals to prevent corrosion.
- Cover the positive terminal with the protective cap.
- Fit the battery cover and assemble the battery strap. Tighten the battery strap fixing to **9 Nm**.
- Assemble the airbox cover and finisher, tightening all fixings to **3 Nm**. Ensure the airbox cover stud is correctly located.

Fuses

Fuse Location

To access the fuses, ease the ignition switch finisher outwards from the bottom. Once free of its retaining grommet, hinge the cover upwards and detach from the slot in the bracket.

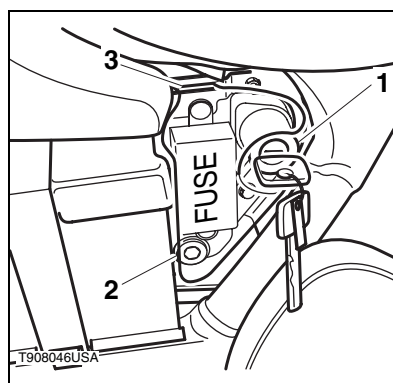

1. Ignition switch cover
2. Retaining grommet
3. Bracket slot

Maintenance and Adjustment

Fuse Replacement

If a fuse fails during operation, inspect the electrical system to determine the cause, and then replace it with a new fuse of the same (correct) current rating.

Warning

Always replace blown fuses with new ones of the correct current rating (as specified on the fuse box cover) and never use a fuse of higher rating.

Use of an incorrectly rated fuse could lead to an electrical problem, resulting in motorcycle damage, loss of motorcycle control and an accident.

Fuse Identification

The fuses can be identified by a number moulded into the fusebox housing, adjacent to each fuse, as shown below. These numbers correspond to the numbers given in the table overleaf. Fuses without an identification number are spare, and should be replaced if used.

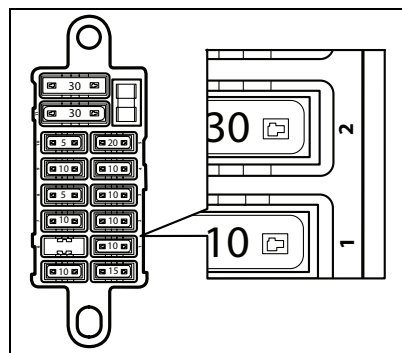

Fuse Identification

A blown fuse is indicated when all of the systems protected by that fuse become inoperative. When checking for a blown fuse, use the table below to establish which fuse has blown.

| Fuse No. | Circuits Protected | Fuse Rating (Amp.) |
|----------|---|--------------------|
| 1 | Accessory Lights | 10 |
| 2 | Alarm, GPS | 10 |
| 3 | Accessory Socket, Diagnostic Connector | 10 |
| 4 | Ignition Switch Main Feed, Instrumentation Illumination | 10 |
| 5 | Engine Management System | 20 |
| 6 | Not Used | - |
| 7 | Direction Indicators, Brake Light, Horn | 10 |
| 8 | Position Light, Instrumentation Illumination | 5 |
| 9 | Dip/Main Beam | 10 |
| 10 | Position Lights | 5 |
| 11 | Main Battery Fuse | 30 |

Note:

- Only 30, 20 and 10 Amp. spare fuses are provided in the fuse box. A spare 5 Amp. fuse must also be carried on the motorcycle.

Maintenance and Adjustment

Headlight

! Warning

Adjust road speed to suit the visibility and weather conditions in which the motorcycle is being operated.

Ensure that the beam is adjusted to illuminate the road surface sufficiently far ahead, but without dazzling oncoming traffic. An incorrectly adjusted headlight may impair visibility causing loss of motorcycle control and an accident.

! Warning

Never attempt to adjust the headlight beam when the motorcycle is in motion.

Any attempt to adjust the headlight beam when the motorcycle is in motion may result in loss of control and an accident.

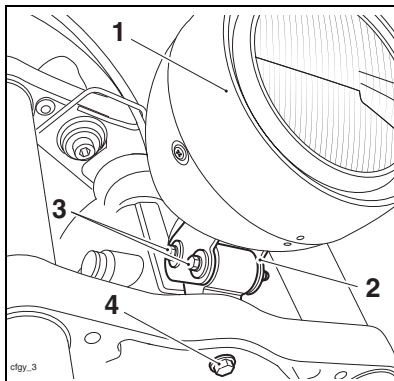

1. Headlight
2. Headlight bracket
3. Pinch-bolt (vertical setting)
4. Bracket fixing (horizontal setting)

Headlight Adjustment

Horizontal Adjustment

Switch the headlight dipped beam on.

Slacken the headlight mounting bracket fixing.

Adjust the horizontal position of the headlight and mounting bracket to give the required beam setting.

Tighten the bracket fixing to **35 Nm**.

Re-check the headlight beam setting.

Switch the headlight off when the beam setting is satisfactorily set.

Vertical Adjustment

Switch the headlight dipped beam on.

For America slacken the lower pinch-bolt: for Speedmaster slacken the upper pinch-bolt.

Adjust the position of the headlight to give the required beam setting.

Tighten the bracket pinch-bolt to **12 Nm**.

Re-check the headlight beam setting.

Switch the headlight off when the beam setting is satisfactorily set.

Maintenance and Adjustment

Headlight/Position Light Bulb Replacement

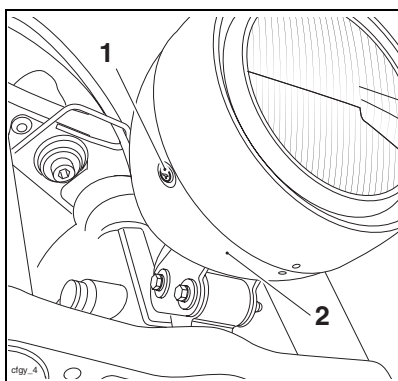

1. Headlight rim screws
2. Headlight bowl

- Disconnect the battery, negative (black) lead first.
- Remove the headlight rim screws.
- Detach the headlight and rim assembly from the headlight bowl.
- While supporting the light unit, disconnect the multi-pin electrical connector from the headlight bulb and the two spade connectors from the position light.
- Remove the rubber dust cover.
- Unhook the headlight bulb's wire retainer.
- The headlight bulb can now be removed.
- To remove the position light bulb, detach the bulb holder from the headlight body and release the bulb.

- Installation is the reversal of removal.

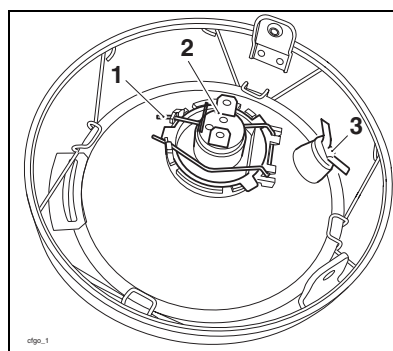

1. Wire retainer
2. Headlight bulb
3. Position light

Warning

Do not reconnect the battery until the assembly process has been completed. Premature battery reconnection could result in ignition of the battery gases causing risk of injury.

Warning

The bulbs become hot during use. Always allow sufficient time for the bulbs to cool before handling. Avoid touching the glass part of the bulb. If the glass is touched or gets dirty, clean with alcohol before re-use.

Caution

When reconnecting the battery, connect the positive (red) lead first.

Maintenance and Adjustment

Rear Light/Licence Plate Light

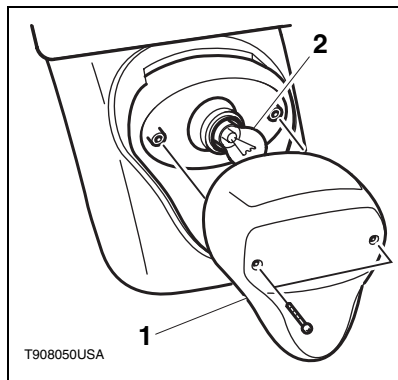

1. Rear light lens screws, America shown
2. Bulb

Bulb Replacement

- Release the screws securing the rear light lens.
- Remove the lens.
- The bulb is a bayonet type. To remove the bulb, gently press inwards and twist anti-clockwise.
- Installation is the reversal of removal.

Direction Indicator Lights

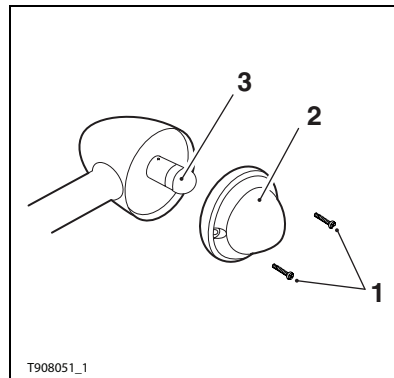

1. Indicator lens screws
2. Lens
3. Bulb

Bulb Replacement

- The lens on each indicator light is held in place by screws.
- Release the screws and remove the lens to gain access to the bulb for replacement.

Maintenance and Adjustment

Cleaning

Frequent, regular cleaning is an essential part of the maintenance of your motorcycle. If regularly cleaned, the appearance will be preserved for many years. Cleaning with cold water containing an automotive cleaner is essential at all times but particularly so after exposure to sea breezes, sea water, dusty or muddy roads and in winter when roads are treated for ice and snow. Do not use household detergent as the use of such products will lead to premature corrosion.

Although, under the terms of your motorcycle warranty, cover is provided against the corrosion of certain items, the owner is expected to observe this reasonable advice which will safeguard against corrosion and enhance the appearance of the motorcycle.

Preparation for Washing

Before washing, precautions must be taken to keep water off the following places:

- Rear opening of the exhausts: Cover with a plastic bag secured with rubber bands.
- Clutch and brake levers, switch housings on the handlebar: Cover with plastic bags.
- Ignition switch and steering lock: Cover the keyholes with tape.

Remove any items of jewellery such as rings, watches, zips or belt buckles, which may scratch or otherwise damage painted or polished surfaces.

Use separate cleaning sponges or cleaning cloths for washing painted/polished surfaces and chassis areas. Chassis areas (such as wheels and under mudguards) will be exposed to more abrasive road grime and dust, which may then scratch painted or polished surfaces, if the same sponges or cleaning cloths are used.

Where to be Careful

Avoid spraying water with any great force near the following places:

- Instruments;
- Brake cylinders and brake calipers;
- Under the fuel tank;
- Drive chain and headstock bearings.

Caution

Do not spray any water at all under the rider's seat. The engine air intake duct is fitted under the seat and any water sprayed in this area could enter the airbox and engine, causing damage to both items.

Caution

Use of high-pressure spray washers is not recommended. When using pressure washers, water may be forced into bearings and other components causing premature wear from corrosion and loss of lubrication.

Maintenance and Adjustment

Note:

- **Use of soaps that are highly alkaline will leave a residue on painted surfaces, and may also cause water spotting. Always use a low alkaline soap to aid the cleaning process.**

Seat Care

Caution

Use of chemicals or high-pressure spray washers is not recommended for cleaning the seat. When using chemicals or pressure washers the seat cover may get damaged.

To help maintain its appearance, clean the seat using a sponge or cleaning cloth with soap and water.

After Washing

- Remove the rubber bands, plastic bags and tape, and clear the air intakes.
- Lubricate the pivots, bolts and nuts.
- Test the brakes before motorcycle operation.
- Start the engine and run it for 5 minutes. Ensure adequate ventilation for the exhaust fumes.
- Use a dry cloth to absorb water residue. Do not allow water to stand on the machine as this will lead to corrosion.

Warning

Never wax or lubricate the brake discs. Loss of braking power and an accident could result. Clean the disc with a proprietary brand of oil-free brake disc cleaner.

Unpainted Aluminium Items

- Items such as brake and clutch levers, wheels, engine covers, top and bottom yokes on some models must be correctly cleaned to preserve their appearance. Please contact your dealer if you are unsure which components on your motorcycle are unpainted aluminium parts.
- Use a proprietary brand of aluminium cleaner which does not contain abrasive or caustic elements.
- Clean aluminium items regularly, in particular after use in inclement weather, where the components must be hand washed and dried each time the machine is used.
- Warranty claims due to inadequate maintenance will not be allowed.

Maintenance and Adjustment

Cleaning of Exhaust System

All parts of the exhaust system of your motorcycle must be cleaned regularly to avoid a deterioration of its appearance.

Note:

- **The exhaust system must be cool before washing to prevent water spotting.**

Washing

- Prepare a mixture of cold water and mild automotive cleaner. Do not use a high alkaline content soap as commonly found at commercial car washes because it leaves a residue.
- Wash the exhaust system with a soft cloth. Do not use an abrasive scouring pad or steel wool. They will damage the finish.
- Rinse the exhaust system thoroughly.
- Ensure no soap or water enters the exhausts.

Drying

- Dry the exhaust system completely with a soft cloth. Do not run the engine to dry the system or spotting will occur.

Protecting

- When the exhaust system is dry, rub 'Motorex 645 Clean and Protect' into the surface.

Caution

The use of products containing silicone will cause discolouration of the chrome and must not be used. Similarly, the use of abrasive cleaners and polishes will damage the system and must not be used.

- It is recommended that regular protection be applied to the system as this will both protect and enhance the system's appearance.

Maintenance and Adjustment

Accessory Windscreen Cleaning



Clean the windscreen with a solution of mild soap or detergent and lukewarm water. After cleaning, rinse well and then dry with a soft, lint free cloth.

Caution

Products such as window cleaning fluids, insect remover, rain repellent, scouring compound, petrol or strong solvents such as alcohol, acetone, carbon tetrachloride, etc. will damage the windscreen. Never allow these products to contact the windscreen.

If the transparency of the windscreen is reduced by scratches or oxidation which cannot be removed, the windscreen must be replaced.

Warning

Never attempt to clean the windscreen while the motorcycle is in motion as releasing the handlebars may cause loss of vehicle control and an accident.

Operation of the motorcycle with a damaged or scratched windscreen will reduce the rider's forward vision. Any such reduction in forward vision is dangerous and may lead to an accident causing injury or death.

Caution

Corrosive chemicals such as battery acid will damage the windscreen. Never allow corrosive chemicals to contact the windscreen.

Maintenance and Adjustment

This page intentionally left blank

STORAGE

Preparation for Storage

Clean the entire vehicle thoroughly.

Fill the fuel tank with the correct grade of unleaded fuel and add a fuel stabiliser (if available), following the fuel stabiliser manufacturer's instructions.

Warning

Petrol (fuel) is extremely flammable and can be explosive under certain conditions. Turn the ignition switch off. Do not smoke. Make sure the area is well ventilated and free from any source of flame or sparks; this includes any appliance with a pilot light.

Remove the spark plug from each cylinder and put several drops (5 ml) of engine oil into each cylinder. Cover the spark plug holes with a piece of cloth or rag. With the engine stop switch in the RUN position, push the starter button for a few seconds to coat the cylinder walls with oil. Install the spark plugs, tightening to **20 Nm**.

Change the engine oil and filter (see page 58).

Check and if necessary correct the tyre pressures (see page 99).

Set the motorcycle on a stand so that both wheels are raised off the ground. (If this cannot be done, put boards under the front and rear wheels to keep dampness away from the tyres.)

Spray rust inhibiting oil (there are a host of products on the market and your dealer will be able to offer you local advice) on all unpainted metal surfaces to prevent rusting. Prevent oil from getting on rubber parts, brake discs or in the brake calipers.

Lubricate and if necessary adjust the drive chain (see page 65).

Remove the battery, and store it where it will not be exposed to direct sunlight, moisture, or freezing temperatures. During storage it should be given a slow charge (one ampere or less) about once every two weeks (see page 80).

Preparation after Storage

Install the battery (if removed) (see page 83).

If the motorcycle has been stored for more than four months, change the engine oil (see page 58).

Check all the points listed in the Daily Safety Checks section (see page 35).

Before starting the engine, remove the spark plugs from each cylinder.

Put the side stand down.

Crank the engine on the starter motor several times until the oil pressure light goes out.

Replace the spark plugs, tightening to **20 Nm**, and start the engine.

Check and if necessary correct the tyre pressures (see page 99).

Check the brakes for correct operation.

Test ride the motorcycle at low speeds.

Storage

This page intentionally left blank

Specifications

SPECIFICATIONS

| | America | Speedmaster |
|------------------------------------|---|---|
| Performance | | |
| Maximum Power | 61 PS @ 6,800 rpm | 61 PS @ 6,800 rpm |
| Maximum Torque..... | 72.4 Nm @ 3,300 rpm | 72.4 Nm @ 3,300 rpm |
| Dimensions | | |
| Overall Length | 2,387 mm | 2,367 mm |
| Overall Width | 920 mm | 895 mm |
| Overall Height..... | 1,175 mm | 1,170 mm |
| Wheelbase..... | 1,610 mm | 1,600 mm |
| Seat Height | 690 mm | 690 mm |
| Wet Weight | 226 kg | 229 kg |
| Maximum Payload | 200 kg | 200 kg |
| (rider, passenger and accessories) | | |
| Engine | | |
| Type..... | Air cooled parallel twin cylinder 270° firing angle | Air cooled parallel twin cylinder 270° firing angle |
| Displacement..... | 865 cc | 865 cc |
| Bore x Stroke | 90 x 68 mm | 90 x 68 mm |
| Compression Ratio | 9.2:1 | 9.2:1 |
| Cylinder Numbering..... | Left to Right | Left to Right |
| Sequence..... | 1-2 | 1-2 |
| Firing Order | 1-2 | 1-2 |
| Starting System..... | Electric Starter | Electric Starter |

Specifications

| | America | Speedmaster |
|------------------------------------|------------|-------------|
| Lubrication | | |
| Lubrication System | Wet-sump | Wet-sump |
| Engine Oil Capacity Guidelines | | |
| (dry fill) | 4.5 litres | 4.5 litres |
| (oil and filter changes) | 3.8 litres | 3.8 litres |
| (oil change only) | 3.3 litres | 3.3 litres |

Note: Always refer to sight glass marking for correct level.

Specifications

All Models

Fuel System

| | |
|--------------------|--------------------------------------|
| Type..... | Sequential electronic fuel injection |
| Fuel Pump..... | Submerged electric |
| Fuel Pressure..... | 3.0 bar |

Fuel

| | |
|--------------------|---------------------------|
| Type..... | Unleaded (91 RON minimum) |
| Tank Capacity..... | 19.5 litres |

Emissions Control Equipment

| | |
|-----------|--|
| Type..... | Twin catalysts with pulsed secondary air injection |
|-----------|--|

Ignition

| | |
|----------------------|--------------------|
| Ignition System..... | Digital electronic |
| Spark Plug..... | NGK DPR8EA-9 |
| Gap..... | 0.8 - 0.9 mm |

Specifications

| | America | Speedmaster |
|---------------------------|---------------------------------------|---------------------------------------|
| Transmission | | |
| Transmission Type | 5 Speed, Constant Mesh | 5 Speed, Constant Mesh |
| Clutch Type | Wet, Multi-Plate | Wet, Multi-Plate |
| Primary Drive | Gear | Gear |
| Final Drive | Chain DID 525 VM2 112 Link Endless | Chain DID 525 VM2 112 Link Endless |
| Primary Drive Ratio | 1.74:1 (62/108) | 1.74:1 (62/108) |
| Final Drive Ratio | 2.333:1 (18/42) | 2.333:1 (18/42) |
| Gear Ratio | | |
| 1st | 2.73:1 (41/15) | 2.73:1 (41/15) |
| 2nd | 1.95:1 (37/19) | 1.95:1 (37/19) |
| 3rd | 1.55:1 (34/22) | 1.55:1 (34/22) |
| 4th | 1.29:1 (31/24) | 1.29:1 (31/24) |
| 5th | 1.07:1 (29/27) | 1.07:1 (29/27) |

Specifications

| | America | Speedmaster |
|------------------------------|----------------------------------|----------------------------------|
| Tyres | | |
| Tyre Pressures (Cold) | | |
| Front | 30 lb/in ² (2.00 bar) | 36 lb/in ² (2.50 bar) |
| Rear | 42 lb/in ² (2.90 bar) | 42 lb/in ² (2.90 bar) |
| Option 1 | | |
| Front | Metzeler ME880 130/90 - 16 | Metzeler ME880 100/90 - 19 |
| Rear | Metzeler ME880 170/80B - 15 | Metzeler ME880 170/80B - 15 |
| Option 2 | | |
| Front | N/A | N/A |
| Rear | N/A | N/A |

 **Warning**

Use recommended tyre options **ONLY** in the combinations given. Do not mix tyres from different manufacturers or mix different specification tyres from the same manufacturers.

Specifications

All Models

Electrical Equipment

| | |
|------------------------------------|--------------------------------------|
| Battery | 12 V 10 Ah |
| Alternator | 24 A @ 2,000 rpm 26 A @ 4,000 rpm |
| Headlight | 12 V 60/55 W Halogen H4 |
| Tail/Brake Light | 12 V 5/21 W |
| Directional Indicator Lights | 12 V 21 W |

Frame

| | |
|-------------|--------|
| Rake | 33.3° |
| Trail | 153 mm |

Tightening Torques

| | |
|-----------------------|-------|
| Oil Filter | 10 Nm |
| Sump Drain Plug | 25 Nm |
| Spark Plug | 20 Nm |

Fluids and Lubricants

Engine Oil

| | |
|--|--|
| Semi or fully synthetic 10W/40 or 10W/50 motorcycle engine oil which meets specification API SH (or higher) and JASO MA, such as Castrol Power 1 Racing 4T 10W-40 (fully synthetic) | Semi or fully synthetic 10W/40 or 10W/50 motorcycle engine oil which meets specification API SH (or higher) and JASO MA, such as Castrol Power 1 Racing 4T 10W-40 (fully synthetic) |
| Brake Fluid | DOT 4 Brake and Clutch Fluid |
| Bearings and Pivots | Grease to NLGI 2 specification |
| Drive Chain | Chain spray suitable for O-ring chains |

INDEX

A

Accessories and Loading 47

B

Battery 79
 Disposal 79
 Maintenance 80
 Removal - America and
 Speedmaster 80
 Brakes 69
 Brake and Clutch Lever Adjusters .. 27
 Brake Fluid 70
 Brake Light Switches 70
 Brake Pad Wear Compensation 69
 Brake Pad Wear Inspection 69
 Braking 41
 Front Brake Fluid Level 71
 Rear Brake Fluid Level 71

C

Chain Lubrication 65
 Cleaning 88
 After Washing 89
 Exhaust System 90
 Preparation for Washing 88
 Unpainted Aluminium Items 89
 Where to be Careful 88
 Clutch 63
 Adjustment 64
 Inspection 64

D

Daily Safety Checks 35
 Direction Indicator Lights 87
 Bulb Replacement 87
 Drive Chain 65
 Adjustment 66
 Chain Free-movement 66

Chain Wear Inspection 67
 Inspection 66

E

Engine
 Engine Stop Switch 26
 Serial Number 15
 To Start The Engine 38
 To Stop The Engine 38
 Engine Oil 57
 Disposal of Used Engine Oil 60
 Level Inspection 58
 Oil and Oil Filter Change 58
 Oil Specification and Grade 60

F

Filling The Fuel Tank 30
 Front Suspension 74
 Fuel 28, 97
 Filling The Fuel Tank 30
 Fuel Grade 28
 Fuel System 97
 Fuel Tank Cap 29
 Refuelling 29
 Fuses 83
 Fuse Identification 84
 Fuse Location 83
 Fuse Replacement 84

G

Gears
 Moving Off/Changing Gears 40

H

Headlight 85
 Adjustment 85
 Position Light Bulb Replacement ... 86
 High Speed Operation 44

Index

| | | | |
|--------------------------------------|-----------|---------------------------------------|------------|
| I | | Parts and Accessories | 8 |
| Ignition | 97 | Riding | 6 |
| Key | 23 | The Motorcycle | 5 |
| Steering Lock | 25 | Scheduled Maintenance | 53 |
| Steering Lock Key | 25 | Side Cover | 31 |
| Switch | 24 | Specifications | 95 |
| Instruments | | Dimensions | 95 |
| Clock | 21 | Electrical Equipment | 100 |
| Odometer | 20 | Emissions Control Equipment | 97 |
| Speedometer | 20 | Engine | 95 |
| Tachometer | 21 | Fluids and Lubricants | 100 |
| Warning Lights | 22 | Frame | 100 |
| L | | Fuel | 97 |
| Left Handlebar Switches | 27 | Fuel System | 97 |
| Direction Indicator Switch | 27 | Ignition | 97 |
| Headlight Dip Switch | 27 | Lubrication | 96 |
| Horn Button | 27 | Performance | 95 |
| O | | Tightening Torques | 100 |
| Owner's Handbook | 33 | Stand | 32 |
| P | | Steering/Wheel Bearings | |
| Parking | 43 | Wheel Bearings Inspection | 73 |
| Parts Identification | 12 | Storage | 93 |
| R | | Preparation after Storage | 93 |
| Rear Light | 87 | Preparation for Storage | 93 |
| Bulb Replacement | 87 | Suspension | |
| Right Handlebar Switches | 26 | Front Fork Inspection | 74 |
| Engine Stop Switch | 26 | Front Suspension Adjustment | 74 |
| Starter Button | 26 | Rear Suspension Adjustment | 74 |
| Running-In | 34 | Suggested Settings | 75 |
| S | | Suspension Setting | 74 |
| Safe Operation | 35 | T | |
| Safety First | 5 | Throttle | |
| Fuel and Exhaust Fumes | 5 | Adjustment | 62 |
| Handlebars and Footrests | 7 | Inspection | 61 |
| Helmet and Clothing | 7 | Throttle Grip | 61 |
| Maintenance/Equipment | 9 | Throttle Grip | 61 |
| Parking | 8 | Tyres | 75 |
| | | Minimum Recommended | |
| | | Tread Depth | 76 |
| | | Tyre Inflation Pressures | 76 |
| | | Tyre Pressures | 99 |

Index

| | | | |
|--|----|------------------------------------|----|
| Tyre Replacement | 77 | Warnings | 1 |
| Tyre Wear | 76 | Information | 3 |
| V | | Maintenance | 2 |
| Vehicle Identification Number (V.I.N.) | 15 | Owner's Handbook | 3 |
| W | | Warning Label Location - | |
| Warning Labels | 2 | America and Speedmaster | 10 |
| Warning Lights | | Warning Lights | 22 |
| Direction Indicators | 22 | Warnings, Cautions and Notes | 1 |
| High Beam | 22 | | |
| Low Oil Pressure | 23 | | |
| Neutral | 22 | | |

Index

This page intentionally left blank