



T5 Circular

22W/830 C-T5 1CT

Philips T5 Circular lamps are ultra-slim with improved color rendering, higher efficacy, and longer life. T5 HO circular lamps offer extraordinary light output.

Product data

• General Characteristics

Base	2GX13
Bulb	C-T5 [C-T 16 mm]
Life to 10% fail Preheat EL,3h	8000 hr
Rated Avg. Life	12000 hr
LSF HF Preheat	99 %
2000h Rated,3h	
LSF HF Preheat	99 %
4000h Rated,3h	
LSF HF Preheat	96 %
6000h Rated,3h	
LSF HF Preheat	89 %
8000h Rated,3h	
LSF HF Preheat	50 %
12000h Rated,3h	
LSF HF Preheat	10 %
16000h Rated,3h	
LSF HF Preheat	1 %
20000h Rated,3h	

• Light Technical Characteristics

Color Code	830 [CCT of 3000K]
Color Rendering Index	85 Ra8
Color Designation	Warm White
Color Temperature	3000 K
Luminous Flux EL	1800 Lm
25°C, Rated	
Luminous Flux EL	1800 Lm
25°C, Nominal	
Lum Efficacy Rated	82 Lm/W
HF 25°C	
LLMF HF 2000h	91 %
Rated	

LLMF HF 4000h	87 %
Rated	
LLMF HF 6000h	84 %
Rated	
LLMF HF 8000h	81 %
Rated	
LLMF HF 12000h	77 %
Rated	
LLMF HF 16000h	74 %
Rated	
LLMF HF 20000h	72 %
Rated	
Design Temperature	35 C
Chromaticity Coordinate X	440 -
Chromaticity Coordinate Y	403 -

• Electrical Characteristics

Watts	22 W
Lamp Wattage EL	22.3 W
25°C, Rated	
Lamp Wattage EL	22 W
25°C, Nominal	
Lamp Voltage EL	75 V
25°C	
Lamp Current EL	0.300 A
25°C	
Dimmable	Yes

• Environmental Characteristics

Energy Efficiency Label (EEL)	A
Mercury (Hg) Content	2.5 mg

T5 Circular

• Measuring Conditions

Calibration Current	0.300 A
HF Generator Rated Voltage	150 V
Resistor	250 ohm

• Product Dimensions

Diameter D	14 (min), 18 (max) mm
Overall Width E	220 (min), 230 (max) mm
Inner Width I	187 (min), 197 (max) mm

• Product Data

Product number	166017
Full product name	MASTER TL5 Circular 22W/830 1CT
Short product name	MASTER TL5 Circular 22W/830 1CT/10
Pieces per Sku	1
eop_pck_cfg	10
Skus/Case	10
Bar code on pack	8711500640956
Bar code on case	8711500640963
Logistics code(s)	927965083013
tpd_ilcos_cd	FSCH-22/30/1B-L/P-2GX13-16
eop_net_weight_pp	45.000 gr

Dimensional drawing

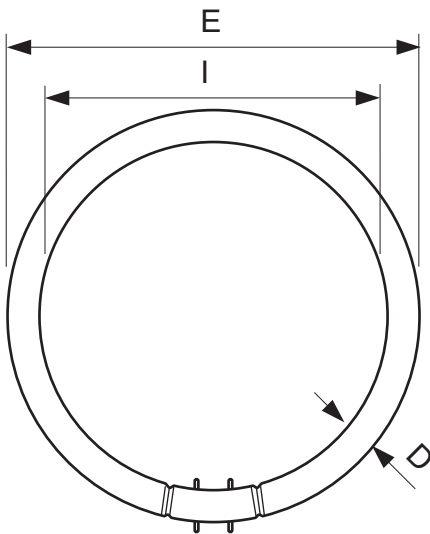

22W/830 C-T5 1CT

Product	D (Min)	D (Max)	E (Min)	E (Max)	I (Min)	I (Max)
TL5-C 22W/830	14	18	220	230	187	197

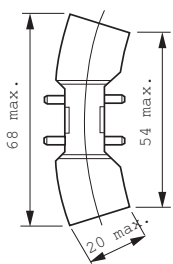

2GX13

Photometric data

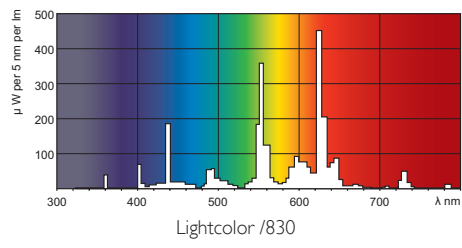
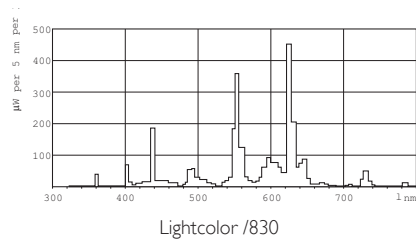

© 2013 Koninklijke Philips Electronics N.V.
All rights reserved.

Specifications are subject to change without notice. Trademarks are the property of Koninklijke Philips Electronics N.V. or their respective owners.

www.philips.com/lighting

2013, April 30
data subject to change