

LTS-31

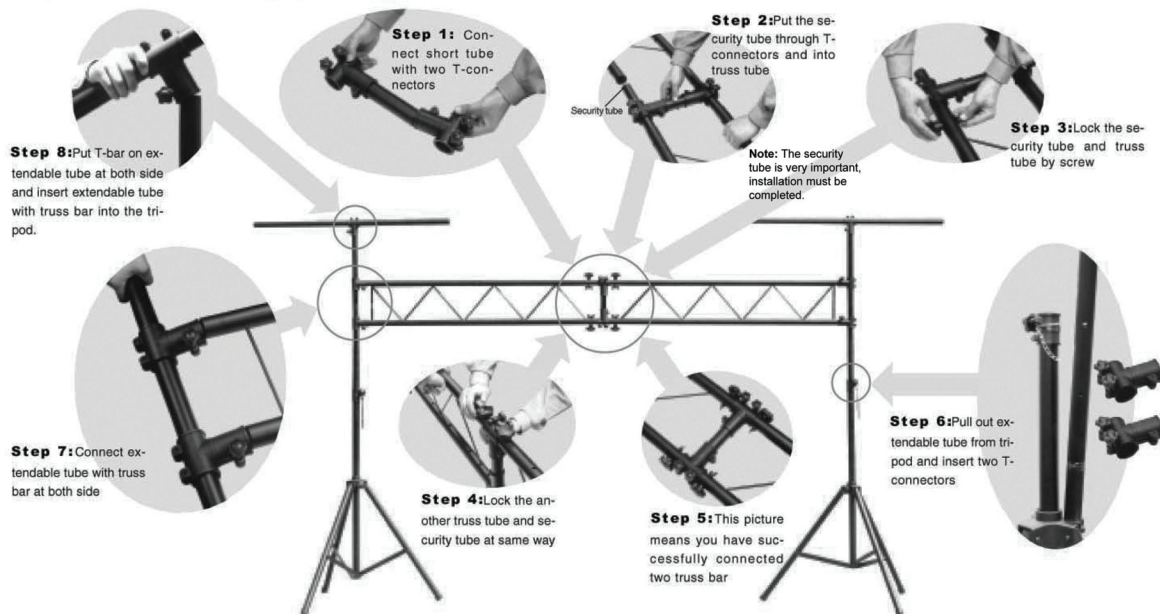

ASSEMBLY MANUAL

Complete Portable Trussing System



This trussing system offers easy set-up and high stability. It comes complete with two tripods that telescope to nine feet featuring two locking grooved pins. Also included are two T-bars and two five foot truss that securely lock together to create 10 feet of trussing span, or they can be used separately. This trussing system is excellent for mobile DJs, bands, and rentals. Never overtighten any of the connectors.

CAUTION: Make sure the trussing system is at the desired height before hanging lights and/or fixtures.

Specifications:

Weight: 24Kg

Load Capacity: 100Kg GUARANTEED

Technical Specifications

Maximum Load: 100 Kg / 220 lbs

Extends: 2.75 m / 9 ft

Spans: 3.05 m / 10 ft

Weight: 24 Kg / 53 lbs

Optima Lighting Inc.

54-15 35th Street
Long Island City, NY 11101-3233
United States

Phone: 718-433-2344

Fax: 718-361-2193

sales@OptimaLighting.com

www.OptimaLighting.com