

PHILIPS UHP F-9308-750-0 (XL-2400)

REPLACEMENT LAMP FOR SONY® HD LCD PROJECTION TELEVISION

USER INSTRUCTIONS

CAUTION:

- Do not attempt to remove the lamp immediately after use; doing so can cause serious burns. Prior to removing lamp, switch off the power supply to the television and wait approximately 60 minutes or more to allow for complete lamp cooling.
- Avoid touching the glass portion(s) of the lamp with bare hands; fingerprints, dirt and dust may cause early lamp failure and/or image obscurity. It is recommended that gloves be worn when replacing the lamp.
- When transporting the replacement lamp, use the box that is provided to avoid breakage.

WARNING:

- To avoid overheating and/or fire, ensure that the replacement lamp is mounted securely.
- Hg - LAMP CONTAINS MERCURY, Manage in Accord with Disposal Laws. See: www.lamprecycle.org or 1-877-977-0755.

REPLACING THE LAMP

1 Switch off power to the television and wait about two minutes until the cooling fan stops. Unplug the power cord from the wall outlet. **Allow the television to cool for at least 1 hour.**

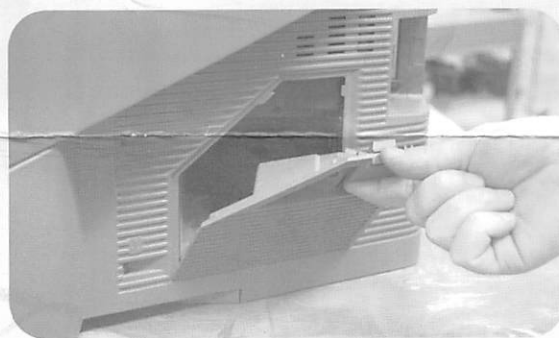
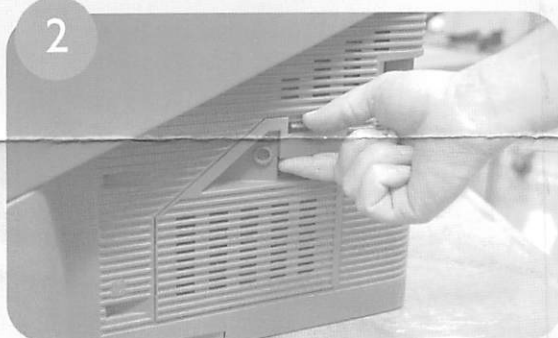

Remove the outside lamp cover.

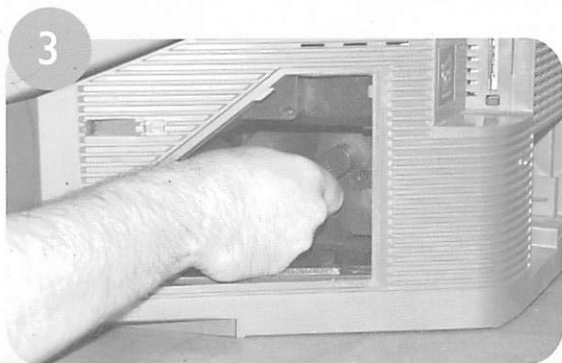

Remove the lamp door. Turn the knob counterclockwise to the OPEN position and pull out the door.



Remove the lamp unit from the television by hooking a finger through the loop of the lamp handle and pulling it upwards; pull the lamp straight out.

Note: To avoid injury, exercise caution when removing the lamp unit and do not place your hand in the lamp storage area.

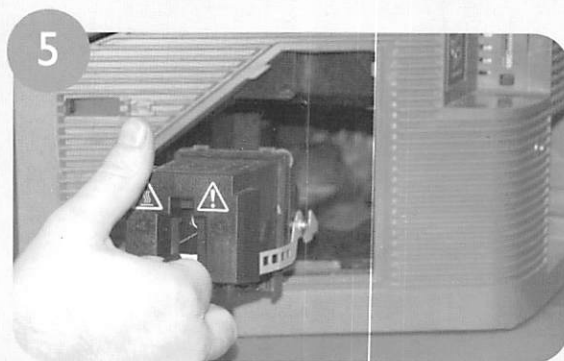

Insert the new lamp unit, paying attention to the orientation and direction of insertion. Ensure that the new unit is mounted securely. If the lamp is not reattached securely, the self-diagnostic function may be triggered and the POWER/STANDBY indicator will flash three times.

Note: To avoid shortened lamp life and/or reduced picture quality, do not touch the glass portion of the new lamp.

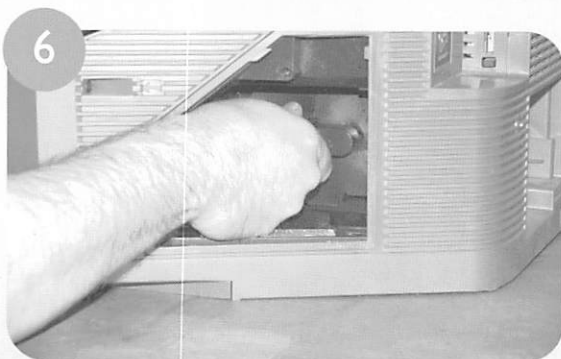

Reinstall the lamp door. Secure the door by turning the knob clockwise back to the CLOSE position.



Replace the outside lamp cover. Plug the power cord back into the wall outlet and turn on the power.

[Models KDF-42E2000 (US model only), KDF-46E2000, KDF-50E2000 and KDF-55E2000: Select the Lamp Replacement option (MENU > Settings > Setup menu) and follow the on-screen procedure.]