

sunlite®

INSTALLATION INSTRUCTIONS

LED SLIM DOWNLIGHT FIXTURES | ROUND & SQUARE TYPE

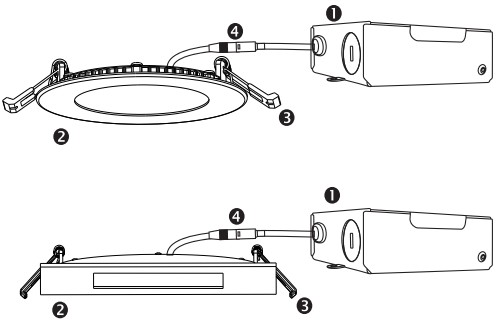

WARNING: Avoid fire or electric shock. Follow installation instructions carefully. Risk of fire or electric shock. LED Retrofit Kit installation requires knowledge of luminaires electrical systems. If not qualified, do not attempt installation. Contact a qualified electrician.

Install this kit only in luminaires that have the construction features and dimensions shown in the photographs and/or drawings and where the input rating of the retrofit kit does not exceed the input rating of the luminaire. Wear rubber-soled shoes and work on a sturdy ladder. Ground fixture to avoid potential electrical shock. Do not make or alter any open holes in an enclosure of wiring or electrical components during kit installation. To prevent wiring damage or abrasion, do not expose wiring to edges of sheet metal or other sharp objects.

CAUTION: Turn off the power at fuse or circuit breaker box before installation and maintenance to avoid electric shock. This retrofit should be used on 120-Volt fused circuits. Fixture must be installed according to National Electric Code and local building codes. If you are unsure about wiring consult a qualified electrician. **THIS FIXTURE BODY IS ONE PIECE, DO NOT DISASSEMBLE OR MAKE ALTERATIONS.** Not to be used for emergency lighting. Suitable for wet locations.

This device complies with part 15 of the FCC Rules. Operation is subject to the following two conditions: (1) this device may not cause harmful interference, and (2) this device must accept any interference received, including that may cause undesired operation.

Retain these instructions for future maintenance reference.

PARTS LIST / LISTE DES COMPOSANTS

- 1 Junction box / Boîte de jonction
- 2 Light panel / Panneau d'éclairage
- 3 Spring clips / Agrafe-ressort
- 4 Connector / Connecteur

DIMMABLE

The lamp may not be compatible with all dimmers. Go to www.Sunlite.com/Dimmers to find dimmer compatibility information



Installation

Fig. 1

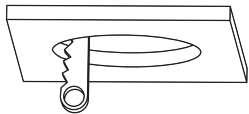

Hole Diameter	Round/Square
4", 11W	4-1/4" (108mm)
6", 14W	6-1/4" (158mm)
8", 18W	8-1/4" (210mm)

Fig. 2

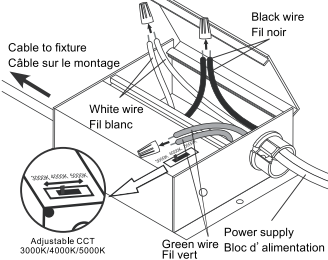

Fig. 3

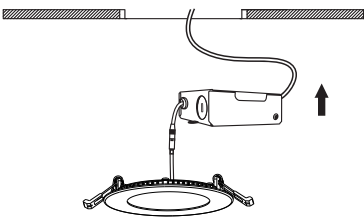
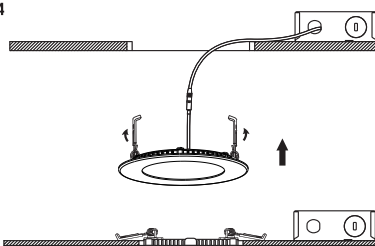

Fig. 4



- STEP 1.** Make sure the power is turned off at the source to the junction box.
- STEP 2.** Determine the location for installation and cut ceiling hole in accordance with cut-hole dimensions. Refer to Hole Diameter table for appropriate size. (Fig.1)
- STEP 3.** Open the junction box cover and remove the appropriate knockout(s) on the side panel. (Fig.2)
- STEP 4.** Insert the electrical supply cable through the knockout and secure with a cable connector (sold separately).
- STEP 5.** Using quick-connect push-in terminals, connect the ground wire to the green wire terminal; black wire to black wire terminal; white wire to white wire terminal. (Fig.2)
- STEP 6.** Place all wiring and connections back in to the box and close the cover. connect the driver to the light panel.
- STEP 7.** Insert junction box through the mounting hole. (Fig. 3).
- STEP 8.** Push spring-loaded clips on the fixture upwards and insert fixture base in to the mounting hole. Release the clips and fixture will be pulled flush to the ceiling. (Fig. 4).

Sunshine Lighting Company

744 Clinton Street Brooklyn, NY 11231, USA

T. 718.768.7000

F. 718.768.0970

www.sunlite.com