

# sunlite®

## INSTALLATION INSTRUCTIONS

LED MINI PANEL FIXTURES

**Please read and understand this entire manual before attempting to assemble, operate or install the product.**

**WARNING:** Avoid fire or electric shock. Follow installation instructions carefully. Risk of fire or electric shock. LED Retrofit Kit installation requires knowledge of luminaires electrical systems. If not qualified, do not attempt installation. Contact a qualified electrician.

Install this kit only in luminaires that have the construction features and dimensions shown in the photographs and/or drawings and where the input rating of the retrofit kit does not exceed the input rating of the luminaire. Wear rubber-soled shoes and work on a sturdy ladder. Ground fixture to avoid potential electrical shock. Do not make or alter any open holes in an enclosure of wiring or electrical components during kit installation. To prevent wiring damage or abrasion, do not expose wiring to edges of sheet metal or other sharp objects.



**CAUTION:** Turn off the power at fuse or circuit breaker box before installation and maintenance to avoid electric shock. This retrofit should be used on 120-Volt fused circuits. Fixture must be installed according to National Electric Code and local building codes. If you are unsure about wiring consult a qualified electrician. **THIS FIXTURE BODY IS ONE PIECE, DO NOT DISASSEMBLE OR MAKE ALTERATIONS.** Not to be used for emergency lighting. Suitable for wet locations.

**This device complies with part 15 of the FCC Rules. Operation is subject to the following two conditions: (1) this device may not cause harmful interference, and (2) this device must accept any interference received, including that may cause undesired operation.**

Retain these instructions for future maintenance reference.

## Installation

**DIMMABLE**

The lamp may not be compatible with all dimmers.  
Go to [www.Sunlite.com/Dimmers](http://www.Sunlite.com/Dimmers) to find dimmer compatibility information.

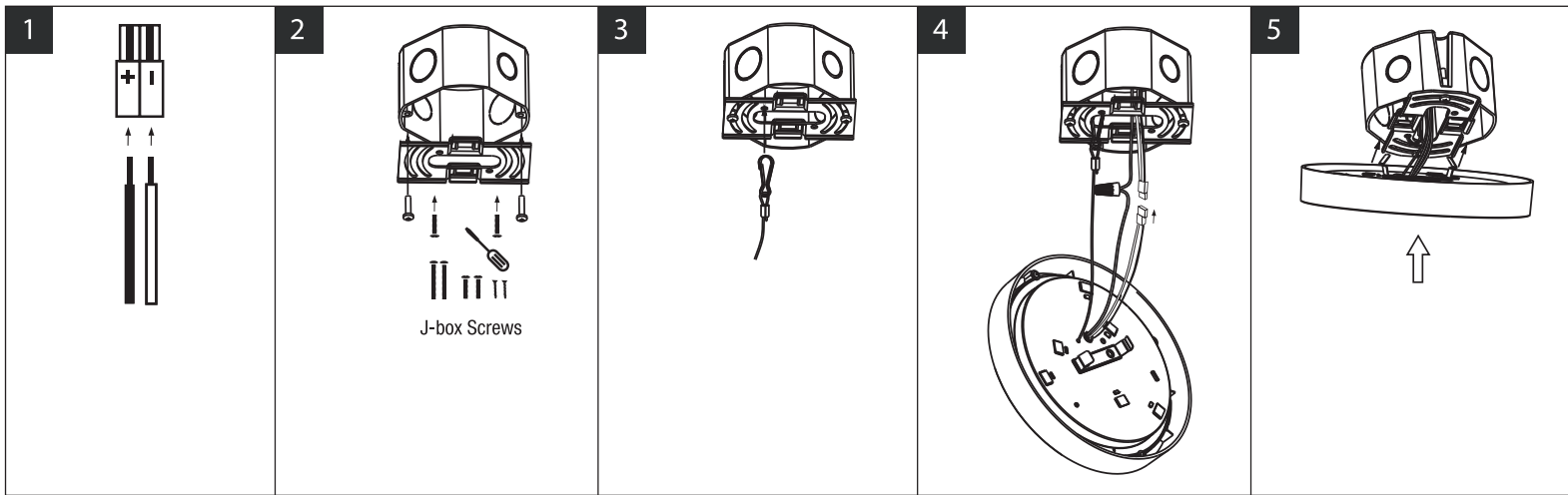

**STEP 1.** Make sure the power is turned off at the source to the junction box.

**STEP 2.** Insert the supply wires from the junction box into the LED adapter (Fig. 1). Insert the black wire into the side marked (+) and the white into the side marked (-). Ensure that both wires are securely fastened.

*Note: If existing junction box wiring does not allow for the use of the LED adapter, remove the adapter from the downlight and wire directly using provided wire nuts.*

**STEP 3.** Attach the mounting bracket to the junction box using two of the provided screws (Fig. 2).

*Note: The flat side of the mounting bracket should be facing down once installed.*

**STEP 4.** Attach the safety clip to one of the holes in the mounting bracket (Fig. 3).

**STEP 5.** Connect the end of the LED adapter coming out of the junction box to the downlight and wire the grounds together using the provided wire nut (Fig. 4).

**STEP 6.** Push downlight up into the mounting bracket until it clicks into place (Fig. 5). Make sure all wires are carefully tucked inside the junction box and downlight is flush with ceiling surface.

**STEP 7.** Restore power at the source.

**Sunshine Lighting Company**

744 Clinton Street Brooklyn, NY 11231, USA

T. 718.768.7000

F. 718.768.0970

[www.sunlite.com](http://www.sunlite.com)