

Installation instructions

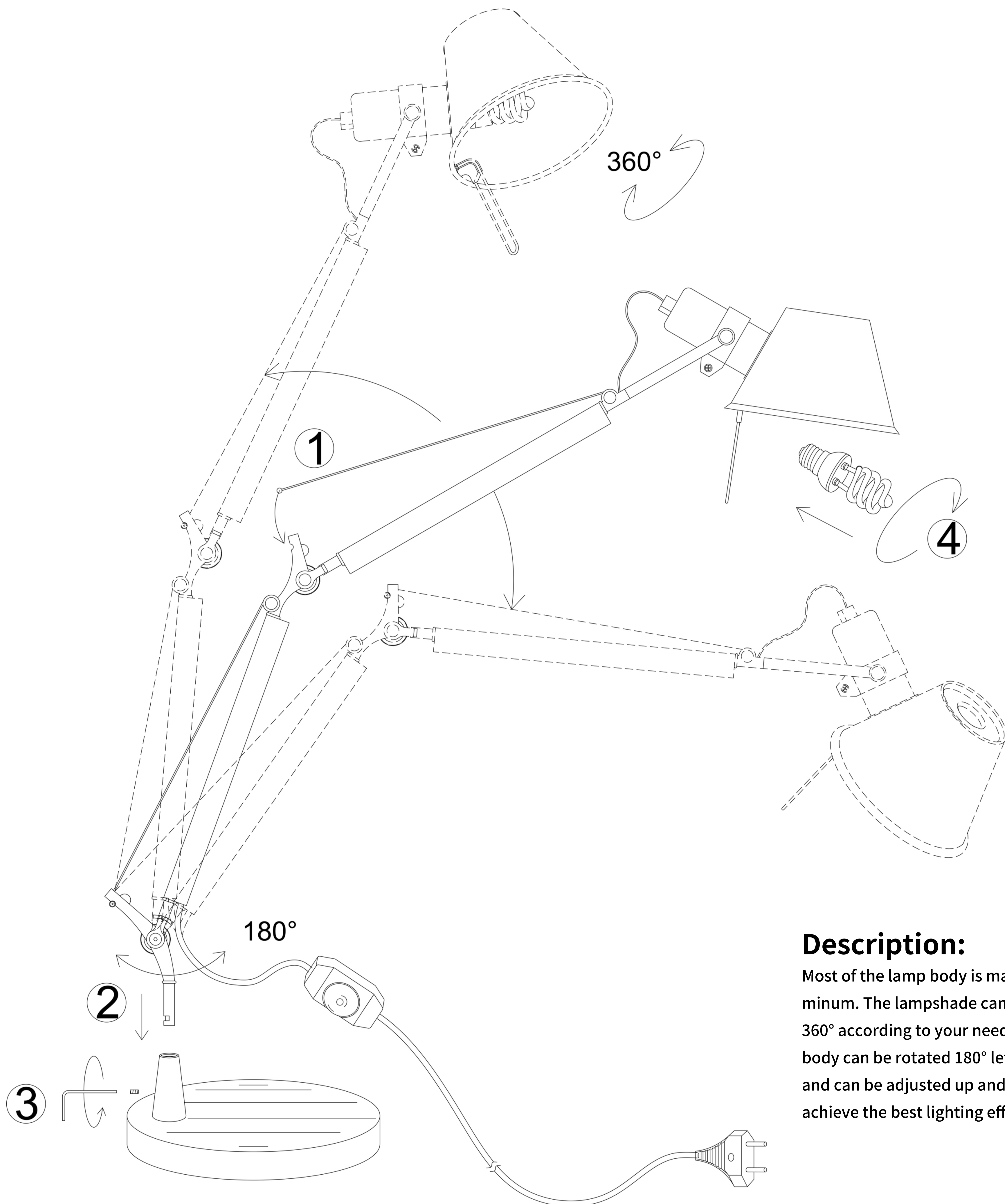

Description:

Most of the lamp body is made of aluminum. The lampshade can be rotated 360° according to your needs. The lamp body can be rotated 180° left and right, and can be adjusted up and down to achieve the best lighting effect.

Installation steps

1. Insert the lamp body into the hole in the conical part;
2. Use a hexagonal wrench to twist the Allen screw into the side teeth of the conical part, lock it tightly, and then rotate it back 180° (half circle) in the opposite direction;
3. Rotate the E27 ≤ 40W energy-saving light source into the lamp holder.