



DRIVE SHP305 - 70/180W

70 - 180 watt, IP66 LED street luminaire, IK08 rated

Application

A decorative, streamline exterior commercial solution

Design Specifications

- Stylish die-cast aluminium body, durable powder coated finish
- Integral constant current non-dimmable LED driver as standard, CCT 5000K, optional 4000K
- Asymmetrical light distribution (TYPE II) fitted, 0%upward light ratio, clear tempered glass diffuser
- Standard 3G.ANSI C.136.31-2010 Ø 60 pole mounting bracket, 800 mm 3 core rubber flex
- Optional constant current dimmable LED driver with 3 IN 1 dimming LED driver (1-10V DC, PWM signal & resistance)
- Lens option (refer to Photometric data below) SHP305A75/P (standard), SHP305A45/P (option), optional PE cell configurations available

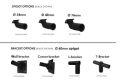
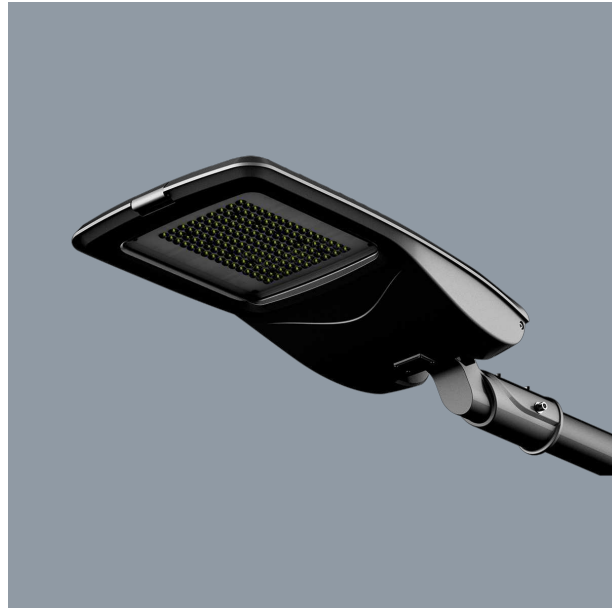







Performance

- Dimmable - **OPTIONAL**
- Dimmer Type - **1-10V DC**
- In Built Sensor - **OPTIONAL**



Technical Specification

Product	Model No.	Input Voltage (V/AC)	Power (W)	Lumens (lm)	CCT (K)	CRI
	SHP305/70NDL/BK	240	70	9100	5000	70
	SHP305/90NDL/BK	240	90	11700	5000	70
	SHP305/90CWL/BK	240	90	10800	4000	70
	SHP305/120NDL/BK	240	120	15600	5000	70
	SHP305/150NDL/BK	240	150	19500	5000	70
	SHP305/180NDL/BK	240	180	23400	5000	70

Body Colour	Mass (kg)	Length (mm)	Width (mm)	Height (mm)
BLACK	8.8	763	352	167
BLACK	9	763	352	167
BLACK	9	763	352	167
BLACK	9.2	763	352	167
BLACK	9.5	763	352	167
BLACK	9.6	763	352	167

Due to continued product and technology enhancements, data sourced from sal.net.au shall not form part of any contract and or technical performance guarantee unless expressly confirmed in writing by SAL at the time of order. Products are sold in accordance with [SAL Terms and Conditions of sale](#) and all images shown are for illustration purposes only and may vary from the actual colour or finish. Unless specifically stated, all IP ratings nominated for Interior products are from "below the ceiling".

Dimensions

SHP305

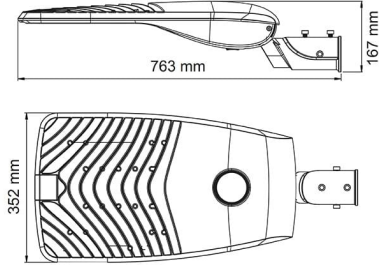

SHP305/6WB/BK WALL

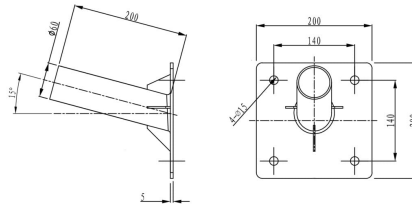

Photometric Data

Unit: cd C0/C180 — C90/C270

SHP305/70NDL at 5000K
with SHP305A75/P

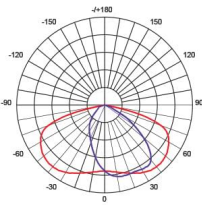

SHP305/180NDL at 5000K
with SHP305A45/P

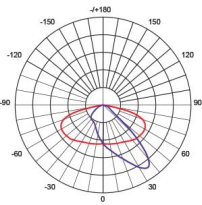

BENTO S9601 SQUARE PROFILE IP44 LED DOWNLIGHT.

PRODUCT INFO GUIDE

BLADE LED BATTEN SL9707TC LOW PROFILE WIDE BODY

35W

PRODUCT INFO GUIDE

BLADE LED BATTEN SL9709TC LOW PROFILE WIDE BODY

50W

PRODUCT INFO GUIDE

BRIGHTSTAR ECO SE7159 LED FLOODLIGHTS

PRODUCT INFO GUIDE

THE VERSATILE CANOPY LED SHP205

PRODUCT INFO GUIDE

COOPER III

PRODUCT INFO GUIDE

COOLUM PLUS S9167TC

PRODUCT INFO GUIDE

COOPER II

PRODUCT INFO GUIDE

ECOLINE XV SL9731TC/DP

PRODUCT INFO GUIDE

ECOLINE SL9738 LED WIDE DIFFUSED BATTEN

PRODUCT INFO GUIDE

EMERGENCY EXIT SELK1500EX2

PRODUCT INFO GUIDE

THE NEW QUICK CONNECT ES5107

PRODUCT INFO GUIDE

STREAMLINE LOW PROFILE FISBE SL2104TC

PRODUCT INFO GUIDE

THE NEW GIBALTAR SL9722 TC LED VANDAL PROOF BATTEN

PRODUCT INFO GUIDE

REMARK D LED DOWNLIGHTS

PRODUCT INFO GUIDE

COOLUM PLUS S9168TC

PRODUCT INFO GUIDE

SLIMLINE SEAMLESS TC LINKABLE SL9706

PRODUCT INFO GUIDE

PIXIE AMBIENCE SMART SOCKET

PRODUCT INFO GUIDE

STARPAD II SE7071 TC FLOODLIGHT

PRODUCT INFO GUIDE

THE NEW UFO SHB23MP150TC LED HIGH BAY

PRODUCT INFO GUIDE

WAVE SF S9065TC LED DOWNLIGHT

PRODUCT INFO GUIDE

WIDELINE SL9733TC/DP

PRODUCT INFO GUIDE

BISMARCK II S9794 LED PANEL

PRODUCT INFO GUIDE

UFO SHB23SE HIGH BAY

PRODUCT INFO GUIDE

COOLUM PLUS S9069TC

PRODUCT INFO GUIDE

ALTONA SQUARE OR ROUND LED WALL LUMINAIRES

PRODUCT INFO GUIDE

BRIGHT STAR LED FLOODLIGHT SE7159

PRODUCT INFO GUIDE

BUNKER 15 TC ROUND

PRODUCT INFO GUIDE

BUNKER 15 TC OVAL

PRODUCT INFO GUIDE



Scan me

**SAL YouTube
PRODUCT GUIDES,
MORE INFORMATION,
EASY TO FIND**