

# Versa Wall Light Installation Instructions



## Product Specifications

Model No.	HV3658T-BLK-RND	HV3658T-WHT-RND	HV3658T-BLK-SQ	HV3658T-WHT-SQ
Name	Versa			
Material	Aluminium			
Colour	Black	White	Black	White
IP Rating	IP65			
Protection Class	1 (240v Requires Earth) ⚡			
Input Voltage	240v AC			
Lamp Base	Built in LED			
Lamp Wattage	2x 3w		2x 3w	
Colour Temp	TRI Colour - 3000k, 4000k, 5500k			
Lumens	2x 220lm, 2x 230lm, 2x240lm			
CRI	> 80			
Wiring	Parallel			
Dimmable	No			
Warranty	3 Years Replacement*			

### HV3658-RND Dimensions

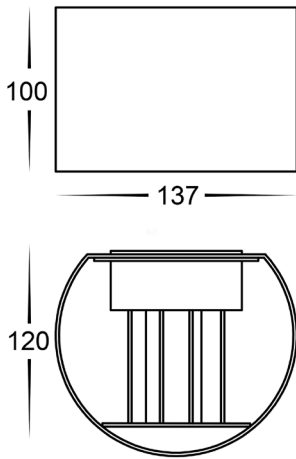

### HV3658-SQ Dimensions

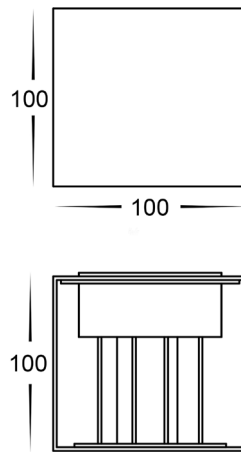

### Mounting Base Diagram

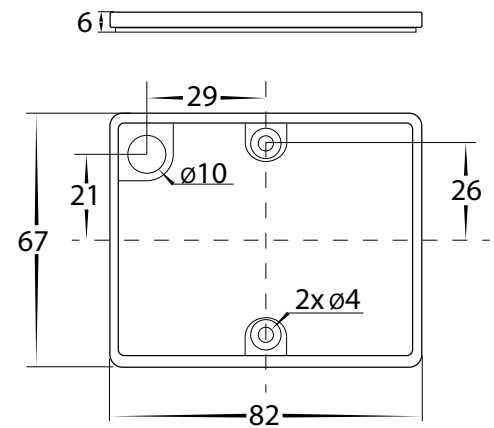

### Important Safety Issues:

- This product must be installed by a qualified electrician according to AS/NZS 3000.
- Ensure all electrical mains are disconnected before any installation.
- Modification of this product will void any warranty.
- Havit Lighting does not take responsibility for wrong installation, incorrect use, or use of installation material that does not belong to the system.
- Aluminium and 304SS fittings must not be installed within 5km of any salt water environments.
- All o-rings and seals must be in place correctly to maintain warranty
- This form may be updated at any time due to product improvements, please check online installation form for most current version.

### Steps for Installation:

1. Make sure that the electrical circuit is free of voltage (master switch off)
2. Remove base plate from fitting.
3. Loosen allen screws from side of fitting.
4. Install base plate to wall in desired location using appropriate screws for application.
5. Seal all holes including cable entry and around screws
6. Connect the cable - Use wire with earth; connect the earth first, then live and neutral wire.
7. Fitting is preset to 3000k, to change slide switch located inside base of fitting to desired colour temperature.
8. Reattach fitting to base plate making sure allen screws are tight to avoid any water penetration.
9. Apply silicon around edge of fitting to prevent any water from getting inside to electrical connections.
10. Adjust beam angle by moving adjustable parts located on top and bottom of fitting.
11. All connections must be carried out carefully, inspect all contacts before switching back on the electric circuit.

## Must be installed by a licensed electrician

### Contact Details:

143 Beauchamp Road  
Matraville NSW 2036  
Australia

Tel: 02 9381 8300  
Fax: 02 9666 8881  
Email: sales@havit.com.au  
Web: www.havit.com.au

### Warranty Terms & Conditions\*



### Additional Information

