







INDUSTRIAL PLUGS AND SOCKETS
16A - 125A

Industrial plugs and sockets 16A - 125A

| | | | |
|---------------------------|------|-----------|---|
| Plugs | Page | 20 |  |
| Angled plugs | Page | 24 |  |
| Wall mounted plugs | Page | 26 |  |
| Flanged plugs | Page | 32 |  |
| Phase inverters | Page | 40 |  |
| Accessories | Page | 44 |  |
| Connectors | Page | 46 |  |



Plugs

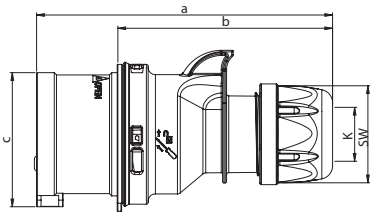

Shark Plug IP44

| | 16 Amp | | | 32 Amp | | |
|----------------------------------|----------------|------|------|---------|---------|---------|
| | 3 | 4 | 5 | 3 | 4 | 5 |
| a | 122 | 128 | 134 | 150 | 150 | 155 |
| b | 86 | 92 | 98 | 104 | 104 | 109 |
| c | 47 | 53 | 61 | 63 | 63 | 70 |
| K_cable Ø [mm] | 6-15 | 6-15 | 8-16 | 11,5-20 | 11,5-20 | 11,5-22 |
| Connection type: | Screw terminal | | | | | |
| Wire flexible [mm ²] | 1-2,5 | | | 2,5-6 | | |
| Contact screws [Ncm] | 100 Ncm | | | 110 Ncm | | |
| SW | 42 | 42 | 42 | 50 | 50 | 50 |
| Weight [g] | 109 | 128 | 151 | 181 | 201 | 232 |

- with screw terminals
- housing material: PA6
- contacts: brass
 - to order nickel-plated contacts please add a "v" e.g. 015-6v

IP44 splashproof

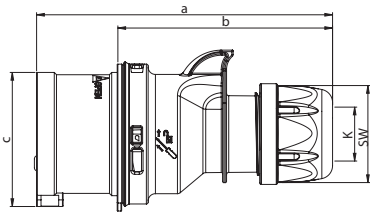

Turbo Shark Plug IP44

| | 16 Amp | | | 32 Amp | | |
|----------------------------------|--------------------|------|------|---------|---------|---------|
| | 3 | 4 | 5 | 3 | 4 | 5 |
| a | 122 | 128 | 134 | 150 | 150 | 155 |
| b | 86 | 92 | 98 | 104 | 104 | 109 |
| c | 47 | 53 | 61 | 63 | 63 | 70 |
| K_cable Ø [mm] | 6-15 | 6-15 | 8-16 | 11,5-20 | 11,5-20 | 11,5-22 |
| Connection type: | Screwless terminal | | | | | |
| Wire flexible [mm ²] | 1-2,5 | | | 2,5-6 | | |
| SW | 42 | 42 | 42 | 50 | 50 | 50 |
| Weight [g] | 111 | 132 | 156 | 186 | 206 | 241 |

- screwless connection technology
- housing material: PA6
- contacts: brass
 - to order nickel-plated contacts please add a "v" e.g. 015-6TTv

IP44 splashproof

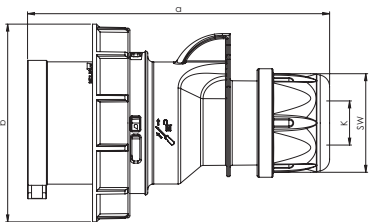

Shark Plug IP67

| | 16 Amp | | | 32 Amp | | |
|----------------------------------|----------------|------|------|---------|---------|---------|
| | 3 | 4 | 5 | 3 | 4 | 5 |
| a | 122 | 128 | 134 | 150 | 150 | 155 |
| b | 71 | 79 | 87 | 93 | 93 | 100 |
| K_cable Ø [mm] | 6-15 | 6-15 | 8-16 | 11,5-20 | 11,5-20 | 11,5-22 |
| Connection type: | Screw terminal | | | | | |
| Wire flexible [mm ²] | 1-2,5 | | | 2,5-6 | | |
| Contact screws [Ncm] | 100 Ncm | | | 110 Ncm | | |
| SW | 42 | 42 | 42 | 50 | 50 | 50 |
| Weight [g] | 130 | 154 | 183 | 223 | 242 | 276 |

- with screw terminals
- housing material: PA6
- contacts: brass
 - to order nickel-plated contacts please add a "v" e.g. 0152-6v

IP67 watertight

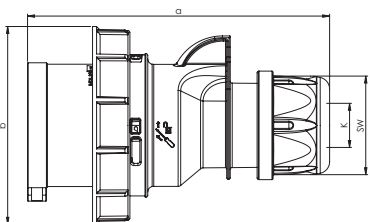

Turbo Shark Plug IP67

| | 16 Amp | | | 32 Amp | | |
|----------------------------------|--------------------|------|------|---------|---------|---------|
| | 3 | 4 | 5 | 3 | 4 | 5 |
| a | 122 | 128 | 134 | 150 | 150 | 155 |
| b | 71 | 79 | 87 | 93 | 93 | 100 |
| K_cable Ø [mm] | 6-15 | 6-15 | 8-16 | 11,5-20 | 11,5-20 | 11,5-22 |
| Connection type: | Screwless terminal | | | | | |
| Wire flexible [mm ²] | 1-2,5 | | | 2,5-6 | | |
| SW | 42 | 42 | 42 | 50 | 50 | 50 |
| Weight [g] | 132 | 157 | 188 | 227 | 246 | 285 |

- screwless connection technology
- contacts: brass
 - to order nickel-plated contacts please add a "v" e.g. 0152-6TTv

IP67 watertight

| Amp. | Poles | pack. unit | 110V~ | 230V~ | 400V~ | 500V~ | >50-500V~ | >50-500V~ |
|------|-------|------------|---------------|------------------------------|------------------------------|---------------|------------------|-----------------|
| | | | 50/60Hz 4h | 50/60Hz 3p=6h 4p+5p=9h | 50/60Hz 3p=9h 4p+5p=6h | 50/60Hz 7h | 100-300Hz 10h | 301-500Hz 2h |
| | | | Cat.No. | Cat.No. | Cat.No. | Cat.No. | Cat.No. | Cat.No. |
| 16 | 3 | 10 | 013-4 | 013-6 | 013-9 | 013-7 | 013-10 | 013-2 |
| 16 | 4 | 10 | 014-4 | 014-9 | 014-6 | 014-7 | 014-10 | 014-2 |
| 16 | 5 | 10 | 015-4 | 015-9 | 015-6 | 015-7 | 015-10 | 015-2 |
| 32 | 3 | 10 | 023-4 | 023-6 | 023-9 | 023-7 | 023-10 | 023-2 |
| 32 | 4 | 10 | 024-4 | 024-9 | 024-6 | 024-7 | 024-10 | 024-2 |
| 32 | 5 | 10 | 025-4 | 025-9 | 025-6 | 025-7 | 025-10 | 025-2 |



015-6

| | | | | | | | | |
|----|---|----|---------|----------------|----------------|--|--|--|
| 16 | 3 | 10 | 013-4TT | 013-6TT | 013-9TT | | | |
| 16 | 4 | 10 | 014-4TT | 014-9TT | 014-6TT | | | |
| 16 | 5 | 10 | 015-4TT | 015-9TT | 015-6TT | | | |
| 32 | 3 | 10 | 023-4TT | 023-6TT | 023-9TT | | | |
| 32 | 4 | 10 | 024-4TT | 024-9TT | 024-6TT | | | |
| 32 | 5 | 10 | 025-4TT | 025-9TT | 025-6TT | | | |



015-6TT

| | | | | | | | | |
|----|---|----|--------|---------------|---------------|--------|---------|--------|
| 16 | 3 | 10 | 0132-4 | 0132-6 | 0132-9 | 0132-7 | 0132-10 | 0132-2 |
| 16 | 4 | 10 | 0142-4 | 0142-9 | 0142-6 | 0142-7 | 0142-10 | 0142-2 |
| 16 | 5 | 10 | 0152-4 | 0152-9 | 0152-6 | 0152-7 | 0152-10 | 0152-2 |
| 32 | 3 | 10 | 0232-4 | 0232-6 | 0232-9 | 0232-7 | 0232-10 | 0232-2 |
| 32 | 4 | 10 | 0242-4 | 0242-9 | 0242-6 | 0242-7 | 0242-10 | 0242-2 |
| 32 | 5 | 10 | 0252-4 | 0252-9 | 0252-6 | 0252-7 | 0252-10 | 0252-2 |



0152-6

| | | | | | | | | |
|----|---|----|----------|-----------------|-----------------|--|--|--|
| 16 | 3 | 10 | 0132-4TT | 0132-6TT | 0132-9TT | | | |
| 16 | 4 | 10 | 0142-4TT | 0142-9TT | 0142-6TT | | | |
| 16 | 5 | 10 | 0152-4TT | 0152-9TT | 0152-6TT | | | |
| 32 | 3 | 10 | 0232-4TT | 0232-6TT | 0232-9TT | | | |
| 32 | 4 | 10 | 0242-4TT | 0242-9TT | 0242-6TT | | | |
| 32 | 5 | 10 | 0252-4TT | 0252-9TT | 0252-6TT | | | |



0152-6TT



Plugs

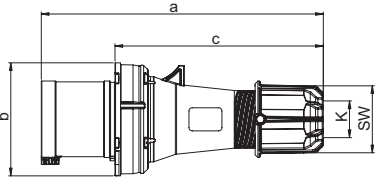

Power Twist Plug IP44

| | 63 Amp | | |
|----------------------------------|---------------------------|---------|---------|
| Poles | 3 | 4 | 5 |
| a | 257 | 257 | 257 |
| b | 102 | 102 | 102 |
| c | 190 | 190 | 190 |
| K_cable Ø [mm] | 14,5-36 | 14,5-36 | 14,5-36 |
| Connection type: | Contact frame with screws | | |
| Wire flexible [mm ²] | 6-16 | | |
| Contact screws [Ncm] | 200 Ncm | | |
| SW | 61 | 61 | 61 |
| Weight [g] | 530 | 572 | 621 |

- contact frame with screws
- housing material: PA6
- contacts: nickel-plated contacts with pilot contact (see page 10)

IP44 splashproof

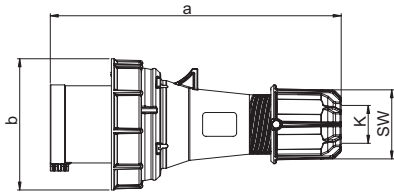

Power Twist Plug IP66/67

| | 63 Amp | | |
|----------------------------------|---------------------------|---------|---------|
| Poles | 3 | 4 | 5 |
| a | 257 | 257 | 257 |
| b | 114 | 114 | 114 |
| K_cable Ø [mm] | 14,5-36 | 14,5-36 | 14,5-36 |
| Connection type: | Contact frame with screws | | |
| Wire flexible [mm ²] | 6-16 | | |
| Contact screws [Ncm] | 200 Ncm | | |
| SW | 61 | 61 | 61 |
| Weight [g] | 570 | 617 | 666 |

- contact frame with screws
- housing material: PA6
- contacts: nickel-plated contacts with pilot contact (see page 10)

IP66/67 watertight

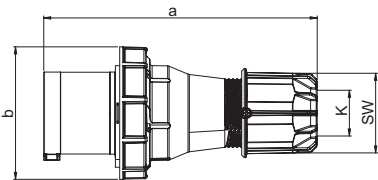

Power Twist Plug IP66/67

| | 125 Amp | | |
|----------------------------------|---------------------------|---------|---------|
| Poles | 3 | 4 | 5 |
| a | 270 | 270 | 270 |
| b | 131 | 131 | 131 |
| K_cable Ø [mm] | 22,5-50 | 22,5-50 | 22,5-50 |
| Connection type: | Contact frame with screws | | |
| Wire flexible [mm ²] | 16-50 | | |
| Contact screws [Ncm] | 450 Ncm | | |
| SW | 81 | 81 | 81 |
| Weight [g] | 956 | 1064 | 1169 |

- contact frame with hexagon socket screws
- housing material: PA6
- contacts: nickel-plated contacts with pilot contact (see page 10)

IP66/67 watertight

**POWER
TWIST**



■ ■ ■ **Safety**

■ ■ ■ **High impact resistance**

■ ■ ■ **Optimum grip**

■ ■ ■ **Large connection area**

■ ■ ■ **Time saving**

| Amp. | Poles | pack-unit | 110V~ | 230V~ | 400V~ | 500V~ | >50-500V~ | >50-500V~ |
|------|-------|-----------|---------------|------------------------------|------------------------------|---------------|------------------|-----------------|
| | | | 50/60Hz 4h | 50/60Hz 3p=6h 4p+5p=9h | 50/60Hz 3p=9h 4p+5p=6h | 50/60Hz 7h | 100-300Hz 10h | 301-500Hz 2h |
| | | | Cat.No. | Cat.No. | Cat.No. | Cat.No. | Cat.No. | Cat.No. |
| 63 | 3 | 2 | 0331-4 | 0331-6 | 0331-9 | 0331-7 | 0331-10 | 0331-2 |
| 63 | 4 | 2 | 0341-4 | 0341-9 | 0341-6 | 0341-7 | 0341-10 | 0341-2 |
| 63 | 5 | 2 | 0351-4 | 0351-9 | 0351-6 | 0351-7 | 0351-10 | 0351-2 |

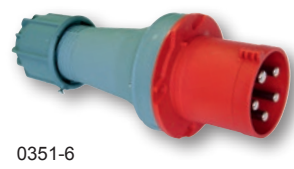

0351-6

| | | | | | | | | |
|----|---|---|-------|--------------|--------------|-------|--------|-------|
| 63 | 3 | 2 | 033-4 | 033-6 | 033-9 | 033-7 | 033-10 | 033-2 |
| 63 | 4 | 2 | 034-4 | 034-9 | 034-6 | 034-7 | 034-10 | 034-2 |
| 63 | 5 | 2 | 035-4 | 035-9 | 035-6 | 035-7 | 035-10 | 035-2 |



035-6

| | | | | | | | | |
|-----|---|---|-------|--------------|--------------|-------|--------|-------|
| 125 | 3 | 2 | 043-4 | 043-6 | 043-9 | 043-7 | 043-10 | 043-2 |
| 125 | 4 | 2 | 044-4 | 044-9 | 044-6 | 044-7 | 044-10 | 044-2 |
| 125 | 5 | 2 | 045-4 | 045-9 | 045-6 | 045-7 | 045-10 | 045-2 |



045-6

Time saving:

- Simple and fast insertion of the cable
- Strain-relief and sealing of the cable by tightening the cable gland
- All current cables for 63A from $\varnothing 14,5\text{mm}$ to $\varnothing 36\text{mm}$ for 125A from $\varnothing 22,5\text{mm}$ to $\varnothing 50\text{mm}$
- 100% Tightness of the cable

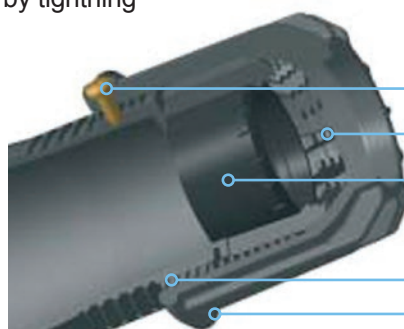

- **Safety screw**
locks the screw cap in position
- **Strain-relief**
for very high strain
- **Sealing**
protection degree IP66/IP67
- **Acme thread**
for high force
- **Cable gland nut**
optimum grip



Angled plugs

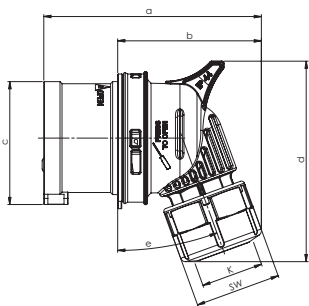

Twist Angled plug IP44

| | 16 Amp | | | 32 Amp | | |
|----------------------------------|----------------|------|------|---------|---------|---------|
| | 3 | 4 | 5 | 3 | 4 | 5 |
| Poles | 3 | 4 | 5 | 3 | 4 | 5 |
| a | 96 | 98 | 108 | 127 | 127 | 135 |
| b | 59 | 62 | 71 | 82 | 82 | 90 |
| c | 47 | 53 | 61 | 63 | 63 | 70 |
| d | 82 | 87 | 99 | 111 | 111 | 114 |
| e [°] | 15 | 15 | 20 | 25 | 25 | 25 |
| K_cable Ø [mm] | 6-15 | 6-15 | 8-16 | 11,5-20 | 11,5-20 | 11,5-22 |
| Connection type: | Screw terminal | | | | | |
| Wire flexible [mm ²] | 1-2,5 | | | 2,5-6 | | |
| Contact screws [Ncm] | 100 Ncm | | | 110 Ncm | | |
| SW | 38 | 38 | 42 | 50 | 50 | 50 |
| Weight [g] | 107 | 130 | 155 | 174 | 194 | 236 |

- with screw terminals
- housing material
16/3 16/4: PA6
16/5 32/3 32/4 32/5: PC/ABS
- contacts: brass
- to order nickel-plated contacts please add a "v" e.g. 8015-6v

IP44 splashproof

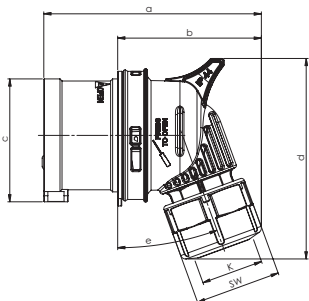

Turbo Twist Angled plug IP44

| | 16 Amp | | | 32 Amp | | |
|----------------------------------|--------------------|------|------|---------|---------|---------|
| | 3 | 4 | 5 | 3 | 4 | 5 |
| Poles | 3 | 4 | 5 | 3 | 4 | 5 |
| a | 96 | 98 | 108 | 127 | 127 | 135 |
| b | 59 | 62 | 71 | 82 | 82 | 90 |
| c | 47 | 53 | 61 | 63 | 63 | 70 |
| d | 82 | 87 | 99 | 111 | 111 | 114 |
| e [°] | 15 | 15 | 20 | 25 | 25 | 25 |
| K_cable Ø [mm] | 6-15 | 6-15 | 8-16 | 11,5-20 | 11,5-20 | 11,5-22 |
| Connection type: | Screwless terminal | | | | | |
| Wire flexible [mm ²] | 1-2,5 | | | 2,5-6 | | |
| SW | 38 | 38 | 42 | 50 | 50 | 50 |
| Weight [g] | 110 | 134 | 160 | 179 | 199 | 244 |

- screwless connection technology
- housing material
16/3 16/4: PA6
16/5 32/3 32/4 32/5: PC/ABS
- contacts: brass
- to order nickel-plated contacts please add a "v" e.g. 8015-6TTv

IP44 splashproof

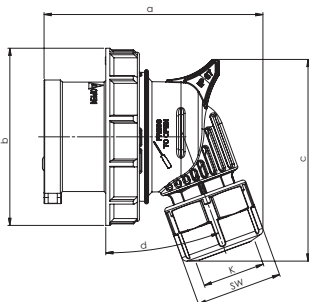

Twist Angled plug IP67

| | 16 Amp | | | 32 Amp | | |
|----------------------------------|----------------|------|------|---------|---------|---------|
| | 3 | 4 | 5 | 3 | 4 | 5 |
| Poles | 3 | 4 | 5 | 3 | 4 | 5 |
| a | 96 | 98 | 108 | 127 | 127 | 135 |
| b | 71 | 79 | 87 | 93 | 93 | 100 |
| c | 82 | 87 | 99 | 111 | 111 | 114 |
| d [°] | 15 | 15 | 20 | 25 | 25 | 25 |
| K_cable Ø [mm] | 6-15 | 6-15 | 8-16 | 11,5-20 | 11,5-20 | 11,5-22 |
| Connection type: | Screw terminal | | | | | |
| Wire flexible [mm ²] | 1-2,5 | | | 2,5-6 | | |
| Contact screws [Ncm] | 100 Ncm | | | 110 Ncm | | |
| SW | 38 | 38 | 42 | 50 | 50 | 50 |
| Weight [g] | 128 | 155 | 186 | 215 | 234 | 278 |

- with screw terminals
- housing material
16/3 16/4: PA6
16/5 32/3 32/4 32/5: PC/ABS
- contacts: brass
- to order nickel-plated contacts please add a "v" e.g. 80152-6v

IP67 watertight

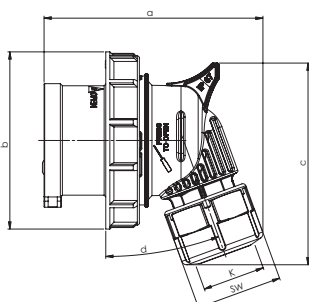

Turbo Twist Angled plug IP67

| | 16 Amp | | | 32 Amp | | |
|----------------------------------|--------------------|------|------|---------|---------|---------|
| | 3 | 4 | 5 | 3 | 4 | 5 |
| Poles | 3 | 4 | 5 | 3 | 4 | 5 |
| a | 96 | 98 | 108 | 127 | 127 | 135 |
| b | 71 | 79 | 87 | 93 | 93 | 100 |
| c | 82 | 87 | 99 | 111 | 111 | 114 |
| d [°] | 15 | 15 | 20 | 25 | 25 | 25 |
| K_cable Ø [mm] | 6-15 | 6-15 | 8-16 | 11,5-20 | 11,5-20 | 11,5-22 |
| Connection type: | Screwless terminal | | | | | |
| Wire flexible [mm ²] | 1-2,5 | | | 2,5-6 | | |
| SW | 38 | 38 | 42 | 50 | 50 | 50 |
| Weight [g] | 130 | 158 | 191 | 219 | 238 | 288 |

- screwless connection technology
- housing material
16/3 16/4: PA6
16/5 32/3 32/4 32/5: PC/ABS
- contacts: brass
- to order nickel-plated contacts please add a "v" e.g. 80152-6TTv

IP67 watertight

| Amp. | Poles | pack. unit | 110V~ | 230V~ | 400V~ | 500V~ | >50-500V~ | >50-500V~ |
|------|-------|------------|---------------|------------------------------|------------------------------|---------------|------------------|-----------------|
| | | | 50/60Hz 4h | 50/60Hz 3p=6h 4p+5p=9h | 50/60Hz 3p=9h 4p+5p=6h | 50/60Hz 7h | 100-300Hz 10h | 301-500Hz 2h |
| | | | Cat.No. | Cat.No. | Cat.No. | Cat.No. | Cat.No. | Cat.No. |
| 16 | 3 | 10 | 8013-4 | 8013-6 | 8013-9 | 8013-7 | 8013-10 | 8013-2 |
| 16 | 4 | 10 | 8014-4 | 8014-9 | 8014-6 | 8014-7 | 8014-10 | 8014-2 |
| 16 | 5 | 10 | 8015-4 | 8015-9 | 8015-6 | 8015-7 | 8015-10 | 8015-2 |
| 32 | 3 | 10 | 8023-4 | 8023-6 | 8023-9 | 8023-7 | 8023-10 | 8023-2 |
| 32 | 4 | 10 | 8024-4 | 8024-9 | 8024-6 | 8024-7 | 8024-10 | 8024-2 |
| 32 | 5 | 10 | 8025-4 | 8025-9 | 8025-6 | 8025-7 | 8025-10 | 8025-2 |



8013-6

| | | | | | | | | |
|----|---|----|----------|-----------------|-----------------|--|--|--|
| 16 | 3 | 10 | 8013-4TT | 8013-6TT | 8013-9TT | | | |
| 16 | 4 | 10 | 8014-4TT | 8014-9TT | 8014-6TT | | | |
| 16 | 5 | 10 | 8015-4TT | 8015-9TT | 8015-6TT | | | |
| 32 | 3 | 10 | 8023-4TT | 8023-6TT | 8023-9TT | | | |
| 32 | 4 | 10 | 8024-4TT | 8024-9TT | 8024-6TT | | | |
| 32 | 5 | 10 | 8025-4TT | 8025-9TT | 8025-6TT | | | |



8013-6TT

| | | | | | | | | |
|----|---|----|---------|----------------|----------------|---------|----------|---------|
| 16 | 3 | 10 | 80132-4 | 80132-6 | 80132-9 | 80132-7 | 80132-10 | 80132-2 |
| 16 | 4 | 10 | 80142-4 | 80142-9 | 80142-6 | 80142-7 | 80142-10 | 80142-2 |
| 16 | 5 | 10 | 80152-4 | 80152-9 | 80152-6 | 80152-7 | 80152-10 | 80152-2 |
| 32 | 3 | 10 | 80232-4 | 80232-6 | 80232-9 | 80232-7 | 80232-10 | 80232-2 |
| 32 | 4 | 10 | 80242-4 | 80242-9 | 80242-6 | 80242-7 | 80242-10 | 80242-2 |
| 32 | 5 | 10 | 80252-4 | 80252-9 | 80252-6 | 80252-7 | 80252-10 | 80252-2 |



80142-6

| | | | | | | | | |
|----|---|----|-----------|------------------|------------------|--|--|--|
| 16 | 3 | 10 | 80132-4TT | 80132-6TT | 80132-9TT | | | |
| 16 | 4 | 10 | 80142-4TT | 80142-9TT | 80142-6TT | | | |
| 16 | 5 | 10 | 80152-4TT | 80152-9TT | 80152-6TT | | | |
| 32 | 3 | 10 | 80232-4TT | 80232-6TT | 80232-9TT | | | |
| 32 | 4 | 10 | 80242-4TT | 80242-9TT | 80242-6TT | | | |
| 32 | 5 | 10 | 80252-4TT | 80252-9TT | 80252-6TT | | | |



example for connection



80142-6TT



Wall mounted plugs

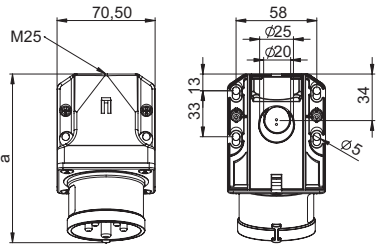

b=height
angle=15°

Wall mounted plug IP44

| | 16 Amp | | | 32 Amp | | |
|----------------------------------|---------|-----|-----|---------|-----|-----|
| Poles | 3 | 4 | 5 | 3 | 4 | 5 |
| a | 120 | 121 | 122 | 131 | 131 | 132 |
| b | 76 | 76 | 79 | 82 | 82 | 85 |
| M | 25 | 25 | 25 | 25 | 25 | 25 |
| Connection type: Screw terminal | | | | | | |
| Wire flexible [mm ²] | 1-2,5 | | | 2,5-6 | | |
| solid [mm ²] | 1-4 | | | 2,5-10 | | |
| Contact screws [Ncm] | 100 Ncm | | | 110 Ncm | | |
| Weight [g] | 173 | 188 | 205 | 212 | 232 | 253 |

- with screw terminals
- housing material: PA6
- contacts: brass
 - to order nickel-plated contacts please add a "v" e.g. 515-6v
- top and rear entry
- incl. threaded cable grommet

IP44 splashproof

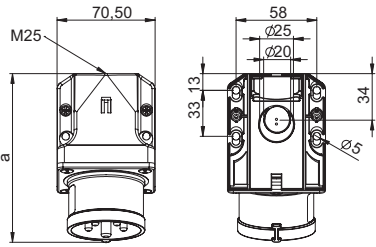

b=height
angle=15°

Turbo Twist Wall mounted plug IP44

| | 16 Amp | | | 32 Amp | | |
|-------------------------------------|--------|--|-----|--------|--|-----|
| Poles | 3 | | 5 | 4 | | 5 |
| a | 120 | | 122 | 131 | | 132 |
| b | 76 | | 79 | 82 | | 85 |
| M | 25 | | 25 | 25 | | 25 |
| Connection type: Screwless terminal | | | | | | |
| Wire flexible [mm ²] | 1-2,5 | | | 2,5-6 | | |
| solid [mm ²] | 1-4 | | | 2,5-10 | | |
| Weight [g] | 176 | | 209 | 238 | | 261 |

- screwless connection technology
- housing material: PA6
- contacts: brass
 - to order nickel-plated contacts please add a "v" e.g. 515-6TTv
- top and rear entry
- incl. threaded cable grommet

IP44 splashproof

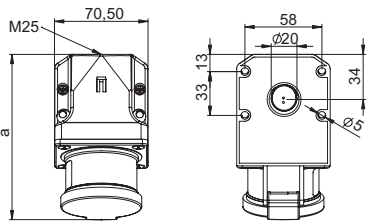

b=height
angle=15°

Wall mounted plug with lid IP44

| | 16 Amp | | | 32 Amp | | |
|----------------------------------|---------|-----|-----|---------|-----|-----|
| Poles | 3 | 4 | 5 | 3 | 4 | 5 |
| a | 127 | 128 | 128 | 137 | 137 | 140 |
| b | 92 | 94 | 97 | 99 | 99 | 104 |
| M | 25 | 25 | 25 | 25 | 25 | 25 |
| Connection type: Screw terminal | | | | | | |
| Wire flexible [mm ²] | 1-2,5 | | | 2,5-6 | | |
| solid [mm ²] | 1-4 | | | 2,5-10 | | |
| Contact screws [Ncm] | 100 Ncm | | | 110 Ncm | | |
| Weight [g] | 230 | 245 | 263 | 272 | 292 | 315 |

- with screw terminals
- with hinged lid and gasket, to increase protection
- housing material: PA6
- contacts: brass
 - to order nickel-plated contacts please add a "v" e.g. 515-6dv
- top and rear entry
- incl. threaded cable grommet

IP44 splashproof

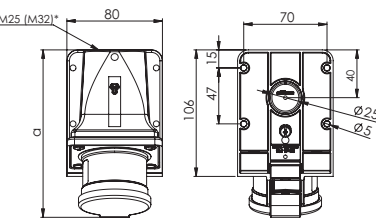

b=height
angle=15°

Wall mounted plug with lid IP44

| | 16 Amp | | | 32 Amp | | |
|----------------------------------|---------|--|-----|---------|--|-----|
| Pole s | | | 5 | | | 5 |
| a | | | 141 | | | 151 |
| b | | | 99 | | | 112 |
| M* | | | 25 | | | 25 |
| Connection type: Screw terminal | | | | | | |
| Wire flexible [mm ²] | 1-2,5 | | | 2,5-6 | | |
| solid [mm ²] | 1-4 | | | 2,5-10 | | |
| Contact screws [Ncm] | 100 Ncm | | | 110 Ncm | | |
| Weight [g] | | | 257 | | | 310 |

- with screw terminals
- **one-piece housing**
- with hinged lid and gasket, to increase protection
- housing material: PA6
- contacts: brass
 - to order nickel-plated contacts please add a "v" e.g. 515-6kdv
- top and rear entry
- incl. threaded cable grommet

IP44 splashproof

*M32 optional on request available

| Amp. | Poles | pack. unit | 110V~ | 230V~ | 400V~ | 500V~ | >50-500V~ | >50-500V~ |
|------|-------|------------|---------------|------------------------------|------------------------------|---------------|------------------|-----------------|
| | | | 50/60Hz 4h | 50/60Hz 3p=6h 4p+5p=9h | 50/60Hz 3p=9h 4p+5p=6h | 50/60Hz 7h | 100-300Hz 10h | 301-500Hz 2h |
| | | | Cat.No. | Cat.No. | Cat.No. | Cat.No. | Cat.No. | Cat.No. |
| 16 | 3 | 10 | 513-4 | 513-6 | 513-9 | 513-7 | 513-10 | 513-2 |
| 16 | 4 | 10 | 514-4 | 514-9 | 514-6 | 514-7 | 514-10 | 514-2 |
| 16 | 5 | 10 | 515-4 | 515-9 | 515-6 | 515-7 | 515-10 | 515-2 |
| 32 | 3 | 10 | 523-4 | 523-6 | 523-9 | 523-7 | 523-10 | 523-2 |
| 32 | 4 | 10 | 524-4 | 524-9 | 524-6 | 524-7 | 524-10 | 524-2 |
| 32 | 5 | 10 | 525-4 | 525-9 | 525-6 | 525-7 | 525-10 | 525-2 |



515-6

| | | | | | | | | |
|----|---|----|---------|----------------|----------------|--|--|--|
| 16 | 3 | 10 | 513-4TT | 513-6TT | 513-9TT | | | |
| 16 | 5 | 10 | 515-4TT | 515-9TT | 515-6TT | | | |
| 32 | 4 | 10 | 524-4TT | 524-9TT | 524-6TT | | | |
| 32 | 5 | 10 | 525-4TT | 525-9TT | 525-6TT | | | |



515-6TT

| | | | | | | | | |
|----|---|----|--------|---------------|---------------|--------|---------|--------|
| 16 | 3 | 10 | 513-4d | 513-6d | 513-9d | 513-7d | 513-10d | 513-2d |
| 16 | 4 | 10 | 514-4d | 514-9d | 514-6d | 514-7d | 514-10d | 514-2d |
| 16 | 5 | 10 | 515-4d | 515-9d | 515-6d | 515-7d | 515-10d | 515-2d |
| 32 | 3 | 10 | 523-4d | 523-6d | 523-9d | 523-7d | 523-10d | 523-2d |
| 32 | 4 | 10 | 524-4d | 524-9d | 524-6d | 524-7d | 524-10d | 524-2d |
| 32 | 5 | 10 | 525-4d | 525-9d | 525-6d | 525-7d | 525-10d | 525-2d |



515-6d

| | | | | | | | | |
|----|---|----|---------|---------|----------------|---------|----------|---------|
| 16 | 5 | 10 | 515-4kd | 515-9kd | 515-6kd | 515-7kd | 515-10kd | 515-2kd |
| 32 | 5 | 10 | 525-4kd | 525-9kd | 525-6kd | 525-7kd | 525-10kd | 525-2kd |



525-6kd



Wall mounted plugs

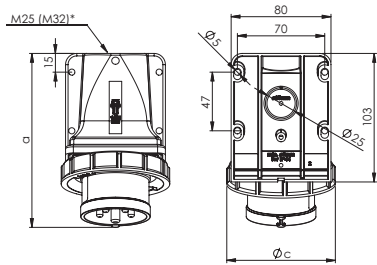

b=height
angle=15°

Wall mounted plug IP67

| Poles | 16 Amp | | | 32 Amp | | |
|----------------------------------|---------|-----|-----|---------|-----|-----|
| | 3 | 4 | 5 | 4 | 5 | |
| a | 136 | 138 | 140 | 150 | 153 | 152 |
| b | 99 | 94 | 100 | 104 | 104 | 102 |
| c | 71 | 79 | 87 | 93 | 93 | 102 |
| M | 25 | 25 | 25 | 25 | 25 | 25 |
| Connection type: Screw terminal | | | | | | |
| Wire flexible [mm ²] | 1-2,5 | | | 2,5-6 | | |
| solid [mm ²] | 1-4 | | | 2,5-10 | | |
| Contact screws [Ncm] | 100 Ncm | | | 110 Ncm | | |
| Weight [g] | 200 | 223 | 242 | 260 | 280 | 306 |

- with screw terminals
- housing material: PA6
- contacts: brass
 - to order nickel-plated contacts please add a „v“ e.g. 5152-6kv
- top, or rear entry
- incl. threaded bung

IP67 watertight

*M32 optional on request available

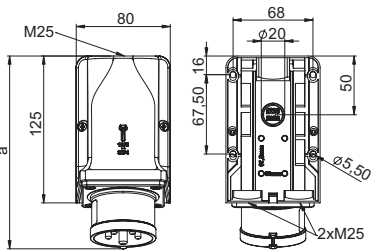

b=height
angle=15°

Wall mounted plug IP44

| Poles | 16 Amp | | | 32 Amp | | |
|----------------------------------|---------|------|------|---------|------|------|
| | 3 | 4 | 5 | 3 | 4 | 5 |
| a | 163 | 163 | 164 | 173 | 173 | 174 |
| b | 109 | 109 | 112 | 115 | 115 | 118 |
| M | 3x25 | 3x25 | 3x25 | 3x25 | 3x25 | 3x25 |
| Connection type: Screw terminal | | | | | | |
| Wire flexible [mm ²] | 1-2,5 | | | 2,5-6 | | |
| solid [mm ²] | 1-4 | | | 2,5-10 | | |
| Contact screws [Ncm] | 100 Ncm | | | 110 Ncm | | |
| Weight [g] | 263 | 278 | 295 | 302 | 322 | 341 |

- with screw terminals
- for wiring through
- housing material: PA6
- contacts: brass
 - to order nickel-plated contacts please add a "v" e.g. 9515-6v
- top, 2x bottom or rear entry
- incl. threaded cable grommet

IP44 splashproof

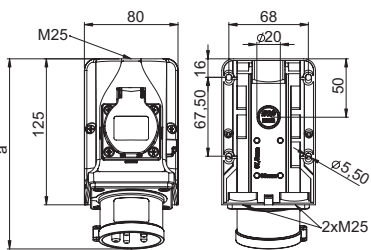

b=height
angle=15°

Wall mounted plug - COMBO IP44

| Poles | 16 Amp | | | 32 Amp | | |
|----------------------------------|---------|------|------|---------|------|------|
| | 3 | 4 | 5 | 3 | 4 | 5 |
| a | 162 | 162 | 163 | 172 | 172 | 173 |
| b | 117 | 117 | 117 | 117 | 117 | 118 |
| M | 3x25 | 3x25 | 3x25 | 3x25 | 3x25 | 3x25 |
| Connection type: Screw terminal | | | | | | |
| Wire flexible [mm ²] | 1-2,5 | | | 2,5-6 | | |
| solid [mm ²] | 1-4 | | | 2,5-10 | | |
| Contact screws CEE [Ncm] | 100 Ncm | | | 110 Ncm | | |
| Screw terminals [Ncm] | 120 Ncm | | | | | |
| Weight [g] | 367 | 382 | 399 | 422 | 442 | 463 |

- with screw terminals
- wall mounted plug with integrated safety socket acc. Austr./Germ. system
- connecting terminals up to 10mm²
- **ready wired**
- for plug 32A the safety socket is protected by fuse (10A slow)
- housing material: PA6
- contacts: brass
 - to order nickel-plated contacts please add a "v" e.g. 95215-6v
- top, 2x bottom or rear entry
- incl. threaded cable grommet
- special design with Belg./French socket outlet or non wired version are available on request

IP44 splashproof

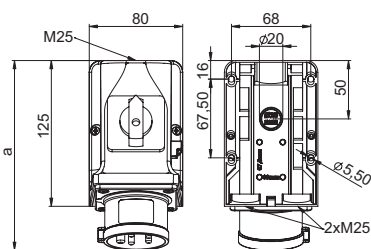

b=height
angle=15°

Wall mounted plug with switch IP44

| Poles | 16 Amp | 32 Amp |
|----------------------------------|--------|--------|
| | 5 | 5 |
| a | 163 | 173 |
| b | 128 | 128 |
| M | 3x25 | 3x25 |
| Connection type: Screw terminal | | |
| Wire flexible [mm ²] | 1-2,5 | 2,5-6 |
| solid [mm ²] | 1-4 | 2,5-10 |
| Weight [g] | 474 | 522 |

- with screw terminals
- wall mounting plug with integrated ON/OFF switch AC22A
- **prewired**
- housing material: PA6
- contacts: brass
 - to order nickel-plated contacts please add a "v" e.g. 75615-6v
- top, 2x bottom or rear entry
- incl. threaded cable grommet

IP44 splashproof

| Amp. | Poles | pack. unit | 110V~ | 230V~ | 400V~ | 500V~ | >50-500V~ | >50-500V~ |
|------|-------|------------|---------------|------------------------------|------------------------------|---------------|------------------|-----------------|
| | | | 50/60Hz 4h | 50/60Hz 3p=6h 4p+5p=9h | 50/60Hz 3p=9h 4p+5p=6h | 50/60Hz 7h | 100-300Hz 10h | 301-500Hz 2h |
| | | | Cat.No. | Cat.No. | Cat.No. | Cat.No. | Cat.No. | Cat.No. |
| 16 | 3 | 5 | 5132-4k | 5132-6k | 5132-9k | 5132-7k | 5132-10k | 5132-2k |
| 16 | 4 | 5 | 5142-4k | 5142-9k | 5142-6k | 5142-7k | 5142-10k | 5142-2k |
| 16 | 5 | 5 | 5152-4k | 5152-9k | 5152-6k | 5152-7k | 5152-10k | 5152-2k |
| 32 | 3 | 5 | 5232-4k | 5232-6k | 5232-9k | 5232-7k | 5232-10k | 5232-2k |
| 32 | 4 | 5 | 5242-4k | 5242-9k | 5242-6k | 5242-7k | 5242-10k | 5242-2k |
| 32 | 5 | 5 | 5252-4k | 5252-9k | 5252-6k | 5252-7k | 5252-10k | 5252-2k |



5252-6k



| | | | | | | | | |
|----|---|---|--------|---------------|---------------|--------|---------|--------|
| 16 | 3 | 5 | 9513-4 | 9513-6 | 9513-9 | 9513-7 | 9513-10 | 9513-2 |
| 16 | 4 | 5 | 9514-4 | 9514-9 | 9514-6 | 9514-7 | 9514-10 | 9514-2 |
| 16 | 5 | 5 | 9515-4 | 9515-9 | 9515-6 | 9515-7 | 9515-10 | 9515-2 |
| 32 | 3 | 5 | 9523-4 | 9523-6 | 9523-9 | 9523-7 | 9523-10 | 9523-2 |
| 32 | 4 | 5 | 9524-4 | 9524-9 | 9524-6 | 9524-7 | 9524-10 | 9524-2 |
| 32 | 5 | 5 | 9525-4 | 9525-9 | 9525-6 | 9525-7 | 9525-10 | 9525-2 |



9515-6

| | | | | | | | | |
|----|---|---|--|----------------|----------------|--|--|--|
| 16 | 3 | 5 | | 95213-6 | | | | |
| 16 | 4 | 5 | | 95214-9 | 95214-6 | | | |
| 16 | 5 | 5 | | | 95215-6 | | | |
| 32 | 3 | 5 | | 95223-6 | | | | |
| 32 | 4 | 5 | | 95224-9 | 95224-6 | | | |
| 32 | 5 | 5 | | | 95225-6 | | | |



95225-6



95215-6

| | | | | | | | | |
|----|---|---|--|--|--|--|--|----------------|
| 16 | 5 | 5 | | | | | | 75615-6 |
| 32 | 5 | 5 | | | | | | 75625-6 |



75615-6

Wall mounted plugs

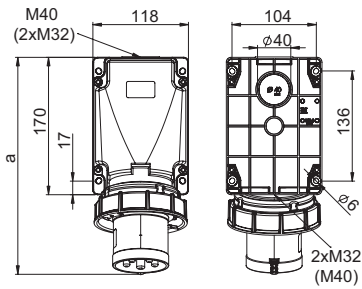

b=height
angle=15°

Power Twist Wall mounted plug IP66/67

| | 63 Amp | | |
|--|---------|-----|-----|
| | 3 | 4 | 5 |
| Poles | 3 | 4 | 5 |
| a | 271 | 271 | 271 |
| b | 175 | 175 | 175 |
| Connection type: Contact frame with screws | | | |
| Wire flexible [mm ²] | 6-16 | | |
| solid [mm ²] | 6-25 | | |
| Contact screws [Ncm] | 200 Ncm | | |
| Weight [g] | 812 | 864 | 914 |

- contact frame with screws
- housing material: PC/ABS
- contacts: nickel-plated contacts, with pilot contact (see page 10)
- top, bottom or rear entry
- housing can be rotated by 180°
- incl. threaded bung
- for waterproof cover and cable-glands see accessories page 51

IP66/67 watertight

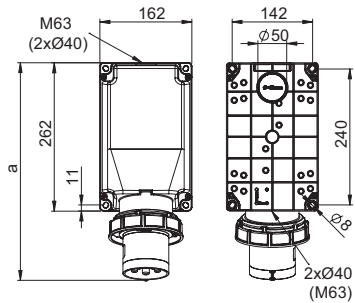

b=height
angle=15°

Power Twist Wall mounted plug IP66/67

| | 125 Amp | | |
|--|---------|------|------|
| | 3 | 4 | 5 |
| Poles | 3 | 4 | 5 |
| a | 387 | 387 | 387 |
| b | 209 | 209 | 209 |
| Connection type: Contact frame with screws | | | |
| Wire flexible [mm ²] | 16-50 | | |
| solid [mm ²] | 16-70 | | |
| Contact screws [Ncm] | 450 Ncm | | |
| Weight [g] | 1620 | 1725 | 1834 |

- contact frame with hexagon socket screws
- housing material: PC/ABS
- contacts: nickel-plated contacts, with pilot contact (see page 10)
- top, bottom or rear entry
- housing can be rotated by 180°
- incl. threaded bung
- for waterproof cover and cable-glands see accessories page 51

IP66/67 watertight

| Amp. | Poles | pack. unit | 110V~ | 230V~ | 400V~ | 500V~ | >50-500V~ | >50-500V~ |
|------|-------|------------|---------------|------------------------------|------------------------------|---------------|------------------|-----------------|
| | | | 50/60Hz 4h | 50/60Hz 3p=6h 4p+5p=9h | 50/60Hz 3p=9h 4p+5p=6h | 50/60Hz 7h | 100-300Hz 10h | 301-500Hz 2h |
| | | | Cat.No. | Cat.No. | Cat.No. | Cat.No. | Cat.No. | Cat.No. |
| 63 | 3 | 2 | 533-4 | 533-6 | 533-9 | 533-7 | 533-10 | 533-2 |
| 63 | 4 | 2 | 534-4 | 534-9 | 534-6 | 534-7 | 534-10 | 534-2 |
| 63 | 5 | 2 | 535-4 | 535-9 | 535-6 | 535-7 | 535-10 | 535-2 |



535-6

| | | | | | | | | |
|-----|---|---|-------|--------------|--------------|-------|--------|-------|
| 125 | 3 | 1 | 543-4 | 543-6 | 543-9 | 543-7 | 543-10 | 543-2 |
| 125 | 4 | 1 | 544-4 | 544-9 | 544-6 | 544-7 | 544-10 | 544-2 |
| 125 | 5 | 1 | 545-4 | 545-9 | 545-6 | 545-7 | 545-10 | 545-2 |



545-6

Accessories see page 51

POWER TWIST

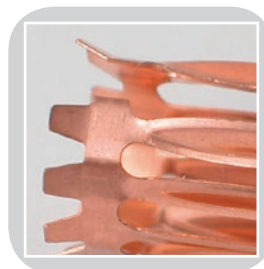

Flanged plugs

Connection types:

Screw terminal:
16/32A



Screwless terminal:
16/32A



Contact frame:
63/125*A



* 125A contact frame with hexagon socket screws

Screw terminal

- accessible from one direction
- screws captive and open
- screws with multi slot

Screwless terminal

- time saving
- screwless TT-terminal
- open contact terminals = ready for assembly
- fast cable installation simple closing and opening

Contact frame

- perfect clamping
- protection of the cables
- screws with multi slot (63A)
- hexagon socket screws (125A)

Locking device:

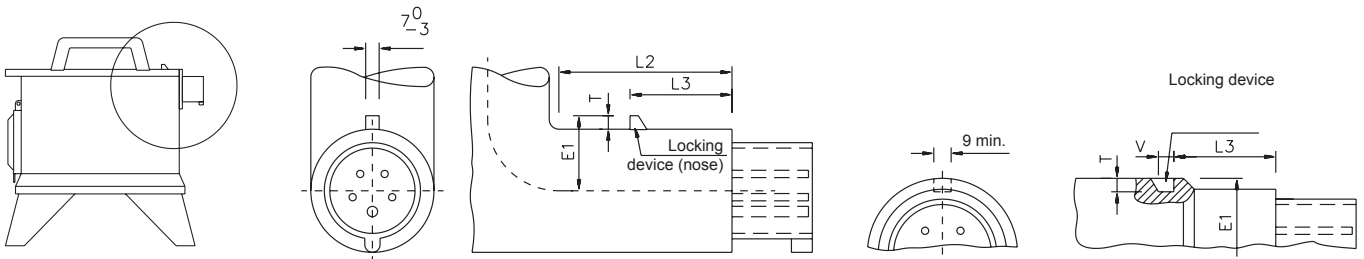

Positioning table (in mm):

| | | E1 | L2 | L3 (IP44) | L3 (IP67) | T | V |
|----|---|-------|------|-----------|-----------|----|----|
| 16 | 3 | 29-31 | ≥75 | 40-41 | 37-38 | ≥4 | ≥8 |
| 16 | 4 | 33-35 | ≥80 | 46-47 | 43-44 | ≥5 | ≥8 |
| 16 | 5 | 37-39 | ≥90 | 52-53 | 49-50 | ≥7 | ≥8 |
| 32 | 3 | 39-41 | ≥90 | 53-54 | 50-51 | ≥7 | ≥8 |
| 32 | 4 | 39-41 | ≥90 | 53-54 | 50-51 | ≥7 | ≥8 |
| 32 | 5 | 44-46 | ≥105 | 59-60 | 55,5-57 | ≥8 | ≥9 |

For correct use a locking device has to be provided (see illustration).

Flanged plugs straight

Dimensions:

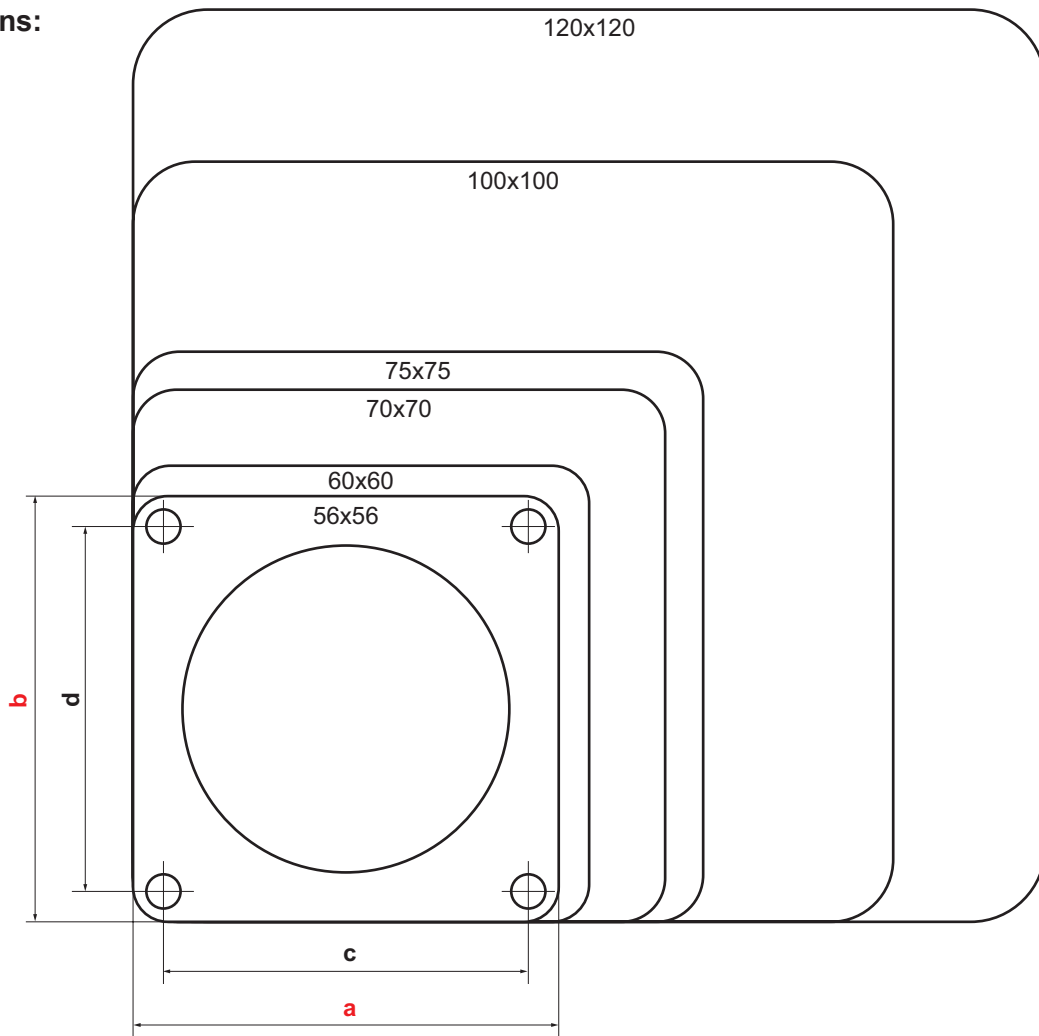

Versions:

| Flange | | Fixing center | | page | 16A | | | 32A | | | 63A | | | 125A | | |
|--------|-----|---------------|-----|-------|-------|------|-------|------|-------|-------|------|------|------|------|------|------|
| a | b | c | d | # | 3p | 4p | 5p | 3p | 4p | 5p | 3p | 4p | 5p | 3p | 4p | 5p |
| 56 | 56 | 48 | 48 | 34-35 | IP44* | IP44 | | | | | | | | | | |
| 60 | 60 | 50 | 50 | 34-35 | IP44* | IP44 | IP44* | | | | | | | | | |
| 70 | 70 | 56 | 56 | 34-35 | IP44* | IP44 | IP44* | IP44 | IP44* | IP44* | | | | | | |
| 75 | 75 | 60 | 60 | 36-37 | | | IP44* | | | IP44* | | | | | | |
| | | | | | IP67* | IP67 | IP67* | IP67 | IP67* | IP67* | | | | | | |
| 100 | 100 | 80 | 80 | 40-41 | | | | | | | IP44 | IP44 | IP44 | | | |
| | | | | | | | | | | | IP67 | IP67 | IP67 | | | |
| 120 | 120 | 100 | 100 | 40-41 | | | | | | | | | | IP67 | IP67 | IP67 |

* also available in screwless connection technology (TT) 



Flanged plugs

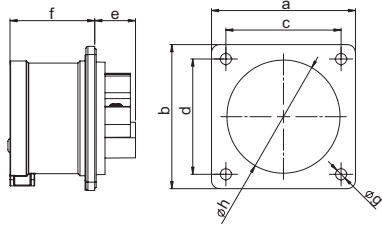

Flanged plug straight IP44

| | 16 Amp | | | 32 Amp | | |
|----------------------------------|----------------|-----|-----|---------|-----|-----|
| | 3 | 4 | 5 | 3 | 4 | 5 |
| Poles | 3 | 4 | 5 | 3 | 4 | 5 |
| Flange | | | | | | |
| a x b | 70 | 70 | 70 | 70 | 70 | 70 |
| Fixing center | | | | | | |
| c x d | 56 | 56 | 56 | 56 | 56 | 56 |
| e | 21 | 21 | 20 | 21 | 21 | 21 |
| f | 42 | 42 | 42 | 51 | 51 | 51 |
| g | 5,5 | 5,5 | 5,5 | 5,5 | 5,5 | 5,5 |
| h | 43 | 43 | 55 | 55 | 55 | 55 |
| Connection type: | Screw terminal | | | | | |
| Wire flexible [mm ²] | 1-2,5 | | | 2,5-6 | | |
| solid [mm ²] | 1-4 | | | 2,5-10 | | |
| Contact screws [Ncm] | 100 Ncm | | | 110 Ncm | | |
| Weight [g] | 86 | 101 | 118 | 125 | 145 | 165 |

- with screw terminals
- housing material: PA6
- contacts: brass
 - to order nickel-plated contacts please add a "v" e.g. 615-6v
- According to EN 60309: For correct use a locking device has to be provided (see page 32)

IP44 splashproof

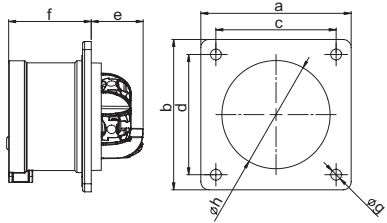

Turbo Twist Flanged plug straight IP44

| | 16 Amp | | 32 Amp | |
|----------------------------------|--------------------|-----|--------|-----|
| | 3 | 5 | 4 | 5 |
| Poles | 3 | 5 | 4 | 5 |
| Flange | | | | |
| a x b | 70 | 70 | 70 | 70 |
| Fixing center | | | | |
| c x d | 56 | 56 | 56 | 56 |
| e | 26 | 26 | 29 | 29 |
| f | 42 | 42 | 51 | 51 |
| g | 5,5 | 5,5 | 5,5 | 5,5 |
| h | 43 | 55 | 55 | 55 |
| Connection type: | Screwless terminal | | | |
| Wire flexible [mm ²] | 1-2,5 | | 2,5-6 | |
| solid [mm ²] | 1-4 | | 2,5-10 | |
| Weight [g] | 89 | 122 | 151 | 172 |

- screwless connection technology
- housing material: PA6
- contacts: brass
 - to order nickel-plated contacts please add a "v" e.g. 615-6TTv
- According to EN 60309: For correct use a locking device has to be provided (see page 32)

IP44 splashproof

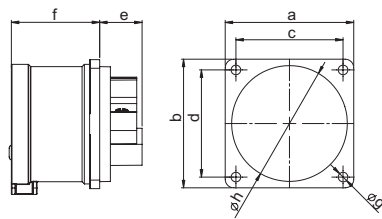

Flanged plug straight IP44

| | 16 Amp | | |
|----------------------------------|----------------|-----|-----|
| | 3 | 4 | 5 |
| Poles | 3 | 4 | 5 |
| Flange | | | |
| a x b | 60 | 60 | 60 |
| Fixing center | | | |
| c x d | 50 | 50 | 50 |
| e | 21 | 21 | 20 |
| f | 42 | 42 | 42 |
| g | 4,5 | 4,5 | 4,5 |
| h | 43 | 43 | 55 |
| Connection type: | Screw terminal | | |
| Wire flexible [mm ²] | 1-2,5 | | |
| solid [mm ²] | 1-4 | | |
| Contact screws [Ncm] | 100 Ncm | | |
| Weight [g] | 78 | 93 | 109 |

- with screw terminals
- housing material: PA6
- contacts: brass
 - to order nickel-plated contacts please add a "v" e.g. 615-6f6v
- According to EN 60309: For correct use a locking device has to be provided (see page 32)

IP44 splashproof

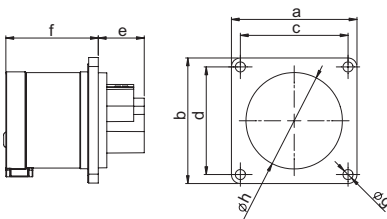

Flanged plug straight IP44

| | 16 Amp | |
|----------------------------------|----------------|-----|
| | 3 | 4 |
| Poles | 3 | 4 |
| Flange | | |
| a x b | 56 | 56 |
| Fixing center | | |
| c x d | 48 | 48 |
| e | 21 | 21 |
| f | 42 | 42 |
| g | 4,5 | 4,5 |
| h | 43 | 43 |
| Connection type: | Screw terminal | |
| Wire flexible [mm ²] | 1-2,5 | |
| solid [mm ²] | 1-4 | |
| Contact screws [Ncm] | 100 Ncm | |
| Weight [g] | 76 | 91 |

- with screw terminals
- housing material: PA6
- contacts: brass
 - to order nickel-plated contacts please add a "v" e.g. 615-6f3v
- According to EN 60309: For correct use a locking device has to be provided (see page 32)

IP44 splashproof

110V~

50/60Hz
4h

230V~

50/60Hz
3p=6h
4p+5p=9h

400V~

50/60Hz
3p=9h
4p+5p=6h

500V~

50/60Hz
7h

>50-500V~

100-300Hz
10h

>50-500V~

301-500Hz
2h

| Amp. | Poles | pack. unit | Cat.No. | Cat.No. | Cat.No. | Cat.No. | Cat.No. | Cat.No. | Cat.No. |
|---|-------|------------|---------|--------------|--------------|---------|---------|---------|---------|
| flange 70 x 70 - fixing center 56 x 56 | | | | | | | | | |
| 16 | 3 | 10 | 613-4 | 613-6 | 613-9 | 613-7 | 613-10 | 613-2 | |
| 16 | 4 | 10 | 614-4 | 614-9 | 614-6 | 614-7 | 614-10 | 614-2 | |
| 16 | 5 | 10 | 615-4 | 615-9 | 615-6 | 615-7 | 615-10 | 615-2 | |
| 32 | 3 | 10 | 623-4 | 623-6 | 623-9 | 623-7 | 623-10 | 623-2 | |
| 32 | 4 | 10 | 624-4 | 624-9 | 624-6 | 624-7 | 624-10 | 624-2 | |
| 32 | 5 | 10 | 625-4 | 625-9 | 625-6 | 625-7 | 625-10 | 625-2 | |



625-6

| Amp. | Poles | pack. unit | Cat.No. | Cat.No. | Cat.No. |
|---|-------|------------|---------|----------------|----------------|
| flange 70 x 70 - fixing center 56 x 56 | | | | | |
| 16 | 3 | 10 | 613-4TT | 613-6TT | 613-9TT |
| 16 | 5 | 10 | 615-4TT | 615-9TT | 615-6TT |
| 32 | 4 | 10 | 624-4TT | 624-9TT | 624-6TT |
| 32 | 5 | 10 | 625-4TT | 625-9TT | 625-6TT |



613-4TT

| Amp. | Poles | pack. unit | Cat.No. | Cat.No. | Cat.No. | Cat.No. | Cat.No. | Cat.No. | |
|---|-------|------------|---------|----------------|----------------|---------|----------|---------|--|
| flange 60 x 60 - fixing center 50 x 50 | | | | | | | | | |
| 16 | 3 | 10 | 613-4f6 | 613-6f6 | 613-9f6 | 613-7f6 | 613-10f6 | 613-2f6 | |
| 16 | 4 | 10 | 614-4f6 | 614-9f6 | 614-6f6 | 614-7f6 | 614-10f6 | 614-2f6 | |
| 16 | 5 | 10 | 615-4f6 | 615-9f6 | 615-6f6 | 615-7f6 | 615-10f6 | 615-2f6 | |



613-6f6

| Amp. | Poles | pack. unit | Cat.No. | Cat.No. | Cat.No. | Cat.No. | Cat.No. | |
|---|-------|------------|---------|----------------|----------------|---------|----------|---------|
| flange 56 x 56 - fixing center 48 x 48 | | | | | | | | |
| 16 | 3 | 10 | 613-4f3 | 613-6f3 | 613-9f3 | 613-7f3 | 613-10f3 | 613-2f3 |
| 16 | 4 | 10 | 614-4f3 | 614-9f3 | 614-6f3 | 614-7f3 | 614-10f3 | 614-2f3 |



614-6f3



Flanged plugs

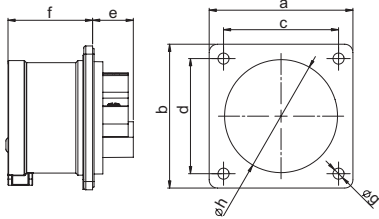

Flanged plug straight IP44

| | 16 Amp | | 32 Amp | |
|----------------------------------|----------------|--|---------|--|
| Poles | 5 | | 5 | |
| Flange | | | | |
| a x b | 75 | | 75 | |
| Fixing center | | | | |
| c x d | 60 | | 60 | |
| e | 20 | | 21 | |
| f | 42 | | 51 | |
| g | 5,5 | | 5,5 | |
| h | 55 | | 55 | |
| Connection type: | Screw terminal | | | |
| Wire flexible [mm ²] | 1-2,5 | | 2,5-6 | |
| solid [mm ²] | 1-4 | | 2,5-10 | |
| Contact screws [Ncm] | 100 Ncm | | 110 Ncm | |
| Weight [g] | 121 | | 170 | |

- with screw terminals
- housing material: PA6
- contacts: brass
 - to order nickel-plated contacts please add a "v" e.g. 615-6f7v
- According to EN 60309: For correct use a locking device has to be provided (see page 32)

IP44 splashproof

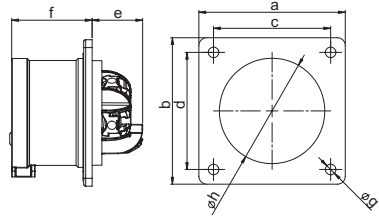

Turbo Twist Flanged plug straight IP44

| | 16 Amp | | 32 Amp | |
|----------------------------------|--------------------|--|--------|--|
| Poles | 5 | | 5 | |
| Flange | | | | |
| a x b | 75 | | 75 | |
| Fixing center | | | | |
| c x d | 60 | | 60 | |
| e | 26 | | 29 | |
| f | 42 | | 51 | |
| g | 5,5 | | 5,5 | |
| h | 55 | | 55 | |
| Connection type: | Screwless terminal | | | |
| Wire flexible [mm ²] | 1-2,5 | | 2,5-6 | |
| solid [mm ²] | 1-4 | | 2,5-10 | |
| Weight [g] | 126 | | 178 | |

- screwless connection technology
- housing material: PA6
- contacts: brass
 - to order nickel-plated contacts please add a "v" e.g. 615-6TTf7v
- According to EN 60309: For correct use a locking device has to be provided (see page 32)

IP44 splashproof

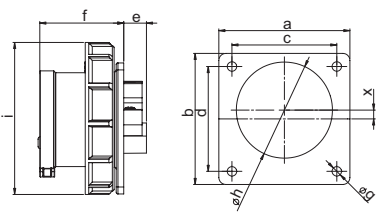

Flanged plug straight IP44

| | 16 Amp | | | 32 Amp | | |
|----------------------------------|----------------|-----|-----|---------|-----|-----|
| | 3 | 4 | 5 | 3 | 4 | 5 |
| Poles | | | | | | |
| Flange | | | | | | |
| a x b | 75 | 75 | 75 | 75 | 75 | 75 |
| Fixing center | | | | | | |
| c x d | 60 | 60 | 60 | 60 | 60 | 60 |
| e | 15 | 14 | 13 | 14 | 15 | 14 |
| f | 48 | 48 | 48 | 58 | 58 | 58 |
| g | 5,5 | 5,5 | 5,5 | 5,5 | 5,5 | 5,5 |
| h | 43 | 44 | 55 | 55 | 55 | 55 |
| i | 71 | 79 | 87 | 93 | 93 | 100 |
| x | 11,3 | 6 | 5 | 4,5 | 4,5 | 0 |
| Connection type: | Screw terminal | | | | | |
| Wire flexible [mm ²] | 1-2,5 | | | 2,5-6 | | |
| solid [mm ²] | 1-4 | | | 2,5-10 | | |
| Contact screws [Ncm] | 100 Ncm | | | 110 Ncm | | |
| Weight [g] | 109 | 131 | 150 | 167 | 188 | 214 |

- with screw terminals
- housing material: PA6
- contacts: brass
 - to order nickel-plated contacts please add a "v" e.g. 6152-6v
- According to EN 60309: For correct use a locking device has to be provided (see page 32)
- for 16A 3p till 32A 4p the plug is placed off centered for keeping the standards

IP67 watertight

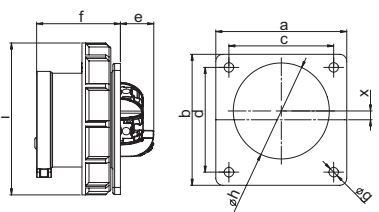

Turbo Twist Flanged plug straight IP44

| | 16 Amp | | 32 Amp | |
|----------------------------------|--------------------|-----|--------|-----|
| | 3 | 5 | 4 | 5 |
| Poles | | | | |
| Flange | | | | |
| a x b | 75 | 75 | 75 | 75 |
| Fixing center | | | | |
| c x d | 60 | 60 | 60 | 60 |
| e | 20 | 20 | 21 | 21 |
| f | 48 | 48 | 58 | 58 |
| g | 5,5 | 5,5 | 5,5 | 5,5 |
| h | 43 | 55 | 55 | 55 |
| i | 71 | 87 | 93 | 100 |
| x | 11,3 | 5 | 4,5 | 0 |
| Connection type: | Screwless terminal | | | |
| Wire flexible [mm ²] | 1-2,5 | | 2,5-6 | |
| solid [mm ²] | 1-4 | | 2,5-10 | |
| Weight [g] | 111 | 154 | 194 | 222 |

- screwless connection technology
- housing material: PA6
- contacts: brass
 - to order nickel-plated contacts please add a "v" e.g. 6152-6ttv
- According to EN 60309: For correct use a locking device has to be provided (see page 32)
- for 16A 3p, 16A 5p and 32A 4p the plug is placed off centered for keeping the standards

IP67 watertight

| Amp. | Poles | pack. unit | 110V~ 50/60Hz 4h | 230V~ 50/60Hz 3p=6h 4p+5p=9h | 400V~ 50/60Hz 3p=9h 4p+5p=6h | 500V~ 50/60Hz 7h | >50- 500V~ 100-300Hz 10h | >50- 500V~ 301-500Hz 2h |
|------|-------|------------|------------------------|---------------------------------------|---------------------------------------|------------------------|-----------------------------------|----------------------------------|
| | | | Cat.No. | Cat.No. | Cat.No. | Cat.No. | Cat.No. | Cat.No. |

| flange 75 x 75 - fixing center 60 x 60 | | | | | | | | |
|--|---|----|---------|---------|----------------|---------|----------|---------|
| 16 | 5 | 10 | 615-4f7 | 615-9f7 | 615-6f7 | 615-7f7 | 615-10f7 | 615-2f7 |
| 32 | 5 | 10 | 625-4f7 | 625-9f7 | 625-6f7 | 625-7f7 | 625-10f7 | 625-2f7 |



615-6f7

| flange 75 x 75 - fixing center 60 x 60 | | | | | |
|--|---|----|-----------|-----------|------------------|
| 16 | 5 | 10 | 615-4TTf7 | 615-9TTf7 | 615-6TTf7 |
| 32 | 5 | 10 | 625-4TTf7 | 625-9TTf7 | 625-6TTf7 |



615-6TTf7

| flange 75 x 75 - fixing center 60 x 60 | | | | | | | | | |
|--|---|----|--------|---------------|---------------|--------|---------|--------|--|
| 16 | 3 | 10 | 6132-4 | 6132-6 | 6132-9 | 6132-7 | 6132-10 | 6132-2 | |
| 16 | 4 | 10 | 6142-4 | 6142-9 | 6142-6 | 6142-7 | 6142-10 | 6142-2 | |
| 16 | 5 | 10 | 6152-4 | 6152-9 | 6152-6 | 6152-7 | 6152-10 | 6152-2 | |
| 32 | 3 | 10 | 6232-4 | 6232-6 | 6232-9 | 6232-7 | 6232-10 | 6232-2 | |
| 32 | 4 | 10 | 6242-4 | 6242-9 | 6242-6 | 6242-7 | 6242-10 | 6242-2 | |
| 32 | 5 | 10 | 6252-4 | 6252-9 | 6252-6 | 6252-7 | 6252-10 | 6252-2 | |



6152-6

| flange 75 x 75 - fixing center 60 x 60 | | | | | |
|--|---|----|----------|-----------------|-----------------|
| 16 | 3 | 10 | 6132-4TT | 6132-6TT | 6132-9TT |
| 16 | 5 | 10 | 6152-4TT | 6152-9TT | 6152-6TT |
| 32 | 4 | 10 | 6242-4TT | 6242-9TT | 6242-6TT |
| 32 | 5 | 10 | 6252-4TT | 6252-9TT | 6252-6TT |



6252-6TT



Flanged plugs

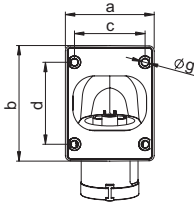
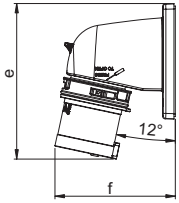

Twist Flanged plug angled IP44

| Poles | 16 Amp | | | 32 Amp | | |
|-------|--------|-----|-----|--------|-----|-----|
| | 3 | 4 | 5 | 3 | 4 | 5 |
| a | 66 | 66 | 90 | 90 | 90 | 90 |
| b | 86 | 86 | 100 | 100 | 100 | 100 |
| c | 53 | 53 | 77 | 77 | 77 | 77 |
| d | 61 | 61 | 85 | 85 | 85 | 85 |
| e | 116 | 117 | 153 | 163 | 163 | 164 |
| f | 90 | 93 | 98 | 100 | 100 | 103 |
| g | 5 | 5 | 5 | 5 | 5 | 5 |

| Connection type: | Screw terminal | | | | | |
|----------------------------------|----------------|-----|-----|---------|-----|-----|
| Wire flexible [mm ²] | 1-2,5 | | | 2,5-6 | | |
| solid [mm ²] | 1-4 | | | 2,5-10 | | |
| Contact screws [Ncm] | 100 Ncm | | | 110 Ncm | | |
| Weight [g] | 126 | 144 | 190 | 200 | 220 | 247 |

- with screw terminals
- housing material: PC/ABS
- contacts: brass
 - to order nickel-plated contacts please add a "v" e.g. 77715-6v

IP44 splashproof

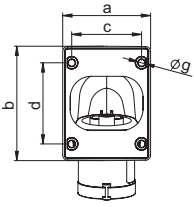
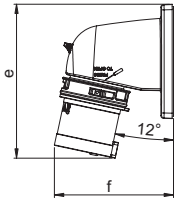

Turbo Twist Flanged plug angled IP44

| Poles | 16 Amp | | | 32 Amp | | |
|-------|--------|-----|-----|--------|-----|-----|
| | 3 | 4 | 5 | 3 | 4 | 5 |
| a | 66 | 66 | 90 | 90 | 90 | 90 |
| b | 86 | 86 | 100 | 100 | 100 | 100 |
| c | 53 | 53 | 77 | 77 | 77 | 77 |
| d | 61 | 61 | 85 | 85 | 85 | 85 |
| e | 116 | 117 | 153 | 163 | 163 | 164 |
| f | 90 | 93 | 98 | 100 | 100 | 103 |
| g | 5 | 5 | 5 | 5 | 5 | 5 |

| Connection type: | Screwless terminal | | | | | |
|----------------------------------|--------------------|-----|-----|--------|-----|-----|
| Wire flexible [mm ²] | 1-2,5 | | | 2,5-6 | | |
| solid [mm ²] | 1-4 | | | 2,5-10 | | |
| Weight [g] | 129 | 148 | 193 | 204 | 225 | 256 |

- screwless connection technology
- housing material: PC/ABS
- contacts: brass
 - to order nickel-plated contacts please add a "v" e.g. 77715-6TTv

IP44 splashproof

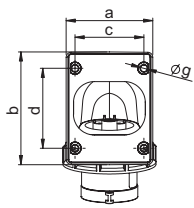
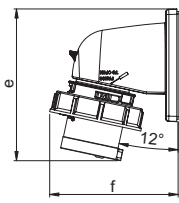

Twist Flanged plug angled IP67

| Poles | 16 Amp | | | 32 Amp | | |
|-------|--------|-----|-----|--------|-----|-----|
| | 3 | 4 | 5 | 3 | 4 | 5 |
| a | 66 | 66 | 90 | 90 | 90 | 90 |
| b | 86 | 86 | 100 | 100 | 100 | 100 |
| c | 53 | 53 | 77 | 77 | 77 | 77 |
| d | 61 | 61 | 85 | 85 | 85 | 85 |
| e | 116 | 117 | 153 | 163 | 163 | 164 |
| f | 99 | 103 | 107 | 110 | 110 | 114 |
| g | 5 | 5 | 5 | 5 | 5 | 5 |

| Connection type: | Screw terminal | | | | | |
|----------------------------------|----------------|-----|-----|---------|-----|-----|
| Wire flexible [mm ²] | 1-2,5 | | | 2,5-6 | | |
| solid [mm ²] | 1-4 | | | 2,5-10 | | |
| Contact screws [Ncm] | 100 Ncm | | | 110 Ncm | | |
| Weight [g] | 146 | 168 | 219 | 240 | 260 | 291 |

- with screw terminals
- housing material: PC/ABS
- contacts: brass
 - to order nickel-plated contacts please add a "v" e.g. 777152-6v

IP67 watertight

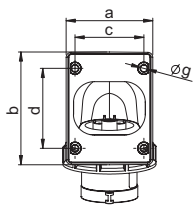
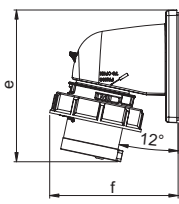

Turbo Twist Flanged plug angled IP67

| Poles | 16 Amp | | | 32 Amp | | |
|-------|--------|-----|-----|--------|-----|-----|
| | 3 | 4 | 5 | 3 | 4 | 5 |
| a | 66 | 66 | 90 | 90 | 90 | 90 |
| b | 86 | 86 | 100 | 100 | 100 | 100 |
| c | 53 | 53 | 77 | 77 | 77 | 77 |
| d | 61 | 61 | 85 | 85 | 85 | 85 |
| e | 116 | 117 | 153 | 163 | 163 | 164 |
| f | 99 | 103 | 107 | 110 | 110 | 114 |
| g | 5 | 5 | 5 | 5 | 5 | 5 |

| Connection type: | Screwless terminal | | | | | |
|----------------------------------|--------------------|-----|-----|--------|-----|-----|
| Wire flexible [mm ²] | 1-2,5 | | | 2,5-6 | | |
| solid [mm ²] | 1-4 | | | 2,5-10 | | |
| Weight [g] | 149 | 172 | 228 | 244 | 266 | 303 |

- screwless connection technology
- housing material: PC/ABS
- contacts: brass
 - to order nickel-plated contacts please add a "v" e.g. 777152-6TTv

IP67 watertight

| Amp. | Poles | pack. unit | 110V~ | 230V~ | 400V~ | 500V~ | >50-500V~ | >50-500V~ |
|------|-------|------------|---------------|------------------------------|------------------------------|---------------|------------------|-----------------|
| | | | 50/60Hz 4h | 50/60Hz 3p=6h 4p+5p=9h | 50/60Hz 3p=9h 4p+5p=6h | 50/60Hz 7h | 100-300Hz 10h | 301-500Hz 2h |
| | | | Cat.No. | Cat.No. | Cat.No. | Cat.No. | Cat.No. | Cat.No. |
| 16 | 3 | 10 | 77713-4 | 77713-6 | 77713-9 | 77713-7 | 77713-10 | 77713-2 |
| 16 | 4 | 10 | 77714-4 | 77714-9 | 77714-6 | 77714-7 | 77714-10 | 77714-2 |
| 16 | 5 | 10 | 77715-4 | 77715-9 | 77715-6 | 77715-7 | 77715-10 | 77715-2 |
| 32 | 3 | 5 | 77723-4 | 77723-6 | 77723-9 | 77723-7 | 77723-10 | 77723-2 |
| 32 | 4 | 5 | 77724-4 | 77724-9 | 77724-6 | 77724-7 | 77724-10 | 77724-2 |
| 32 | 5 | 5 | 77725-4 | 77725-9 | 77725-6 | 77725-7 | 77725-10 | 77725-2 |



77713-6

| | | | | | | | | |
|----|---|----|-----------|------------------|------------------|--|--|--|
| 16 | 3 | 10 | 77713-4TT | 77713-6TT | 77713-9TT | | | |
| 16 | 4 | 10 | 77714-4TT | 77714-9TT | 77714-6TT | | | |
| 16 | 5 | 10 | 77715-4TT | 77715-9TT | 77715-6TT | | | |
| 32 | 3 | 5 | 77723-4TT | 77723-6TT | 77723-9TT | | | |
| 32 | 4 | 5 | 77724-4TT | 77724-9TT | 77724-6TT | | | |
| 32 | 5 | 5 | 77725-4TT | 77725-9TT | 77725-6TT | | | |

TURBO
TWIST
click



77713-6TT

| | | | | | | | | |
|----|---|----|----------|-----------------|-----------------|----------|-----------|----------|
| 16 | 3 | 10 | 777132-4 | 777132-6 | 777132-9 | 777132-7 | 777132-10 | 777132-2 |
| 16 | 4 | 10 | 777142-4 | 777142-9 | 777142-6 | 777142-7 | 777142-10 | 777142-2 |
| 16 | 5 | 5 | 777152-4 | 777152-9 | 777152-6 | 777152-7 | 777152-10 | 777152-2 |
| 32 | 3 | 5 | 777232-4 | 777232-6 | 777232-9 | 777232-7 | 777232-10 | 777232-2 |
| 32 | 4 | 5 | 777242-4 | 777242-9 | 777242-6 | 777242-7 | 777242-10 | 777242-2 |
| 32 | 5 | 5 | 777252-4 | 777252-9 | 777252-6 | 777252-7 | 777252-10 | 777252-2 |



777132-6

| | | | | | | | | |
|----|---|----|------------|-------------------|-------------------|--|--|--|
| 16 | 3 | 10 | 777132-4TT | 777132-6TT | 777132-9TT | | | |
| 16 | 4 | 10 | 777142-4TT | 777142-9TT | 777142-6TT | | | |
| 16 | 5 | 5 | 777152-4TT | 777152-9TT | 777152-6TT | | | |
| 32 | 3 | 5 | 777232-4TT | 777232-6TT | 777232-9TT | | | |
| 32 | 4 | 5 | 777242-4TT | 777242-9TT | 777242-6TT | | | |
| 32 | 5 | 5 | 777252-4TT | 777252-9TT | 777252-6TT | | | |

TURBO
TWIST
click



777152-6TT

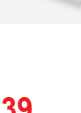

Flanged plugs

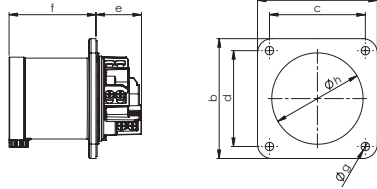

Power Twist Flanged plug straight IP44

| | 63 Amp | | |
|----------------------------------|---------------------------|-----|-----|
| | 3 | 4 | 5 |
| Poles | 3 | 4 | 5 |
| Flange | | | |
| a x b | 100 | 100 | 100 |
| Fixing center | | | |
| c x d | 80 | 80 | 80 |
| e | 39 | 39 | 39 |
| f | 73 | 73 | 73 |
| g | 7 | 7 | 7 |
| h | 77 | 77 | 77 |
| Connection type: | Contact frame with screws | | |
| Wire flexible [mm ²] | 6-16 | | |
| solid [mm ²] | 6-25 | | |
| Contact screws [Ncm] | 200 Ncm | | |
| Weight [g] | 328 | 378 | 427 |

- contact frame with screws
- housing material: PA6
- contacts: nickel-plated contacts, with pilot contact (see page 10)

IP44 splashproof

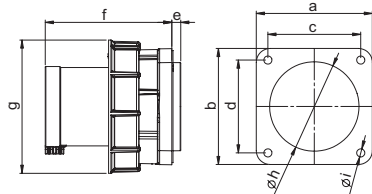

Power Twist Flanged plug straight IP66/67

| | 63 Amp | | |
|----------------------------------|---------------------------|-----|-----|
| | 3 | 4 | 5 |
| Poles | 3 | 4 | 5 |
| a | | | |
| b | 100 | 100 | 100 |
| c | | | |
| d | 80 | 80 | 80 |
| e | 8 | 8 | 8 |
| f | 109 | 109 | 109 |
| g | 115 | 115 | 115 |
| h | 77 | 77 | 77 |
| i | 7 | 7 | 7 |
| Connection type: | Contact frame with screws | | |
| Wire flexible [mm ²] | 6-16 | | |
| solid [mm ²] | 6-25 | | |
| Contact screws [Ncm] | 200 Ncm | | |
| Weight [g] | 479 | 531 | 570 |

- contact frame with screws
- housing material: PA6
- contacts: nickel-plated contacts, with pilot contact (see page 10)
- for waterproof cover see accessories on page 51

IP66/67 watertight

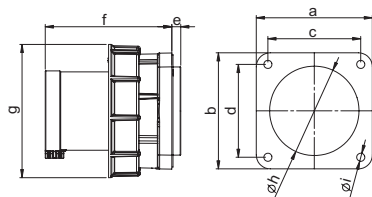

Power Twist Flanged plug straight IP66/67

| | 125 Amp | | |
|----------------------------------|---------------------------|-----|-----|
| | 3 | 4 | 5 |
| Poles | 3 | 4 | 5 |
| a | | | |
| b | 120 | 120 | 120 |
| c | | | |
| d | 100 | 100 | 100 |
| e | 13 | 13 | 13 |
| f | 118 | 118 | 118 |
| g | 131 | 131 | 131 |
| h | 95 | 95 | 95 |
| i | 7 | 7 | 7 |
| Connection type: | Contact frame with screws | | |
| Wire flexible [mm ²] | 16-50 | | |
| solid [mm ²] | 16-70 | | |
| Contact screws [Ncm] | 450 Ncm | | |
| Weight [g] | 786 | 891 | 998 |

- contact frame with hexagon socket screws
- housing material: PA6
- contacts: nickel-plated contacts, with pilot contact (see page 10)
- for waterproof cover see accessories on page 51

IP66/67 watertight

| Amp. | Poles | pack. unit | 110V~ | 230V~ | 400V~ | 500V~ | >50-500V~ | >50-500V~ |
|---|-------|------------|---------------|------------------------------|------------------------------|---------------|------------------|-----------------|
| | | | 50/60Hz 4h | 50/60Hz 3p=6h 4p+5p=9h | 50/60Hz 3p=9h 4p+5p=6h | 50/60Hz 7h | 100-300Hz 10h | 301-500Hz 2h |
| | | | Cat.No. | Cat.No. | Cat.No. | Cat.No. | Cat.No. | Cat.No. |
| flange 100 x 100 - fixing center 80 x 80 | | | | | | | | |
| 63 | 3 | 2 | 6331-4k | 6331-6k | 6331-9k | 6331-7k | 6331-10k | 6331-2k |
| 63 | 4 | 2 | 6341-4k | 6341-9k | 6341-6k | 6341-7k | 6341-10k | 6341-2k |
| 63 | 5 | 2 | 6351-4k | 6351-9k | 6351-6k | 6351-7k | 6351-10k | 6351-2k |



6351-6k

| Amp. | Poles | pack. unit | 110V~ | 230V~ | 400V~ | 500V~ | >50-500V~ | >50-500V~ |
|---|-------|------------|---------------|------------------------------|------------------------------|---------------|------------------|-----------------|
| | | | 50/60Hz 4h | 50/60Hz 3p=6h 4p+5p=9h | 50/60Hz 3p=9h 4p+5p=6h | 50/60Hz 7h | 100-300Hz 10h | 301-500Hz 2h |
| | | | Cat.No. | Cat.No. | Cat.No. | Cat.No. | Cat.No. | Cat.No. |
| flange 100 x 100 - fixing center 80 x 80 | | | | | | | | |
| 63 | 3 | 2 | 633-4 | 633-6 | 633-9 | 633-7 | 633-10 | 633-2 |
| 63 | 4 | 2 | 634-4 | 634-9 | 634-6 | 634-7 | 634-10 | 634-2 |
| 63 | 5 | 2 | 635-4 | 635-9 | 635-6 | 635-7 | 635-10 | 635-2 |



635-6

| Amp. | Poles | pack. unit | 110V~ | 230V~ | 400V~ | 500V~ | >50-500V~ | >50-500V~ |
|---|-------|------------|---------------|------------------------------|------------------------------|---------------|------------------|-----------------|
| | | | 50/60Hz 4h | 50/60Hz 3p=6h 4p+5p=9h | 50/60Hz 3p=9h 4p+5p=6h | 50/60Hz 7h | 100-300Hz 10h | 301-500Hz 2h |
| | | | Cat.No. | Cat.No. | Cat.No. | Cat.No. | Cat.No. | Cat.No. |
| flange 120 x 120 - fixing center 100 x 100 | | | | | | | | |
| 125 | 3 | 2 | 643-4 | 643-6 | 643-9 | 643-7 | 643-10 | 643-2 |
| 125 | 4 | 2 | 644-4 | 644-9 | 644-6 | 644-7 | 644-10 | 644-2 |
| 125 | 5 | 2 | 645-4 | 645-9 | 645-6 | 645-7 | 645-10 | 645-2 |



645-6



Flanged plugs

Power Twist Flanged plug sloping IP66/67

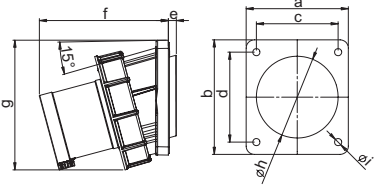

| | 63 Amp | | |
|----------------------------------|---------------------------|-----|-----|
| Poles | 3 | 4 | 5 |
| a | 100 | 100 | 100 |
| b | 112 | 112 | 112 |
| c | 80 | 80 | 80 |
| d | 88 | 88 | 88 |
| e | 8 | 8 | 8 |
| f | 127 | 127 | 127 |
| g | 127 | 127 | 127 |
| h | 80 | 80 | 80 |
| i | 7 | 7 | 7 |
| Connection type: | Contact frame with screws | | |
| Wire flexible [mm ²] | 6-16 | | |
| solid [mm ²] | 6-25 | | |
| Contact screws [Ncm] | 200 Ncm | | |
| Weight [g] | 515 | 566 | 608 |

- contact frame with screws
- housing material: PA6
- contacts: nickel-plated contacts, with pilot contact (see page 10)
- for waterproof cover see accessories on page 51

IP66/67 watertight

Power Twist Flanged plug sloping IP66/67

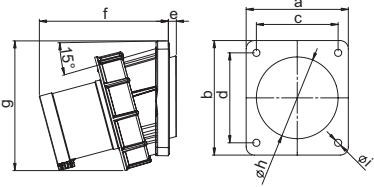

| | 125 Amp | | |
|----------------------------------|---------------------------|-----|------|
| Poles | 3 | 4 | 5 |
| a | 120 | 120 | 120 |
| b | 130 | 130 | 130 |
| c | 100 | 100 | 100 |
| d | 108 | 108 | 108 |
| e | 8 | 8 | 8 |
| f | 139 | 139 | 139 |
| g | 145 | 145 | 145 |
| h | 100 | 100 | 100 |
| i | 7 | 7 | 7 |
| Connection type: | Contact frame with screws | | |
| Wire flexible [mm ²] | 16-50 | | |
| solid [mm ²] | 16-70 | | |
| Contact screws [Ncm] | 450 Ncm | | |
| Weight [g] | 833 | 942 | 1044 |

- contact frame with hexagon socket screws
- housing material: PA6
- contacts: nickel-plated contacts, with pilot contact (see page 10)
- for waterproof cover see accessories on page 51

IP66/67 watertight

Power Twist Flanged plug IP66/67

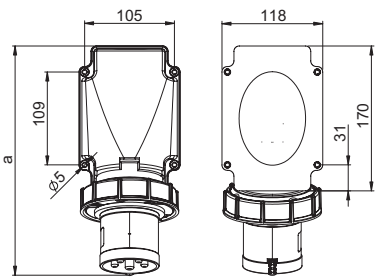

| | 63 Amp | | |
|----------------------------------|---------------------------|-----|-----|
| Poles | 3 | 4 | 5 |
| a | 271 | 271 | 271 |
| b | 124 | 124 | 124 |
| Connection type: | Contact frame with screws | | |
| Wire flexible [mm ²] | 6-16 | | |
| solid [mm ²] | 6-25 | | |
| Contact screws [Ncm] | 200 Ncm | | |
| Weight [g] | 653 | 704 | 746 |

- contact frame with screws
- housing material: PC/ABS
- contacts: nickel-plated contacts, with pilot contact (see page 10)
- for waterproof cover and cable-glands see accessories page 51
- rear entry
- incl. flange gasket

IP66/67 watertight

Power Twist Flanged plug compact IP66/67

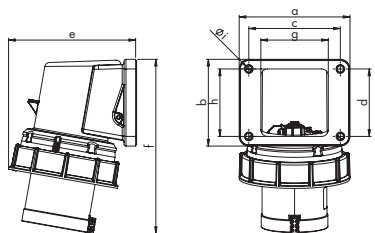

| | 63 Amp | | |
|----------------------------------|---------------------------|-----|-----|
| Poles | 3 | 4 | 5 |
| a | 116 | 116 | 116 |
| b | 91 | 91 | 91 |
| c | 95 | 95 | 95 |
| d | 70 | 70 | 70 |
| e | 132 | 132 | 132 |
| f | 181 | 181 | 181 |
| g | 70 | 70 | 70 |
| h | 70 | 70 | 70 |
| Øi | 6,5 | 6,5 | 6,5 |
| Connection type: | Contact frame with screws | | |
| Wire flexible [mm ²] | 6-16 | | |
| solid [mm ²] | 6-25 | | |
| Contact screws [Ncm] | 200 Ncm | | |
| Weight [g] | 547 | 598 | 640 |

- contact frame with screws
- housing material: PA6
- contacts: nickel-plated contacts, with pilot contact (see page 10)
- for waterproof cover and cable-glands see accessories page 51
- rear entry
- incl. flange gasket

IP66/67 watertight

110V~

50/60Hz
4h

230V~

50/60Hz
3p=6h
4p+5p=9h

400V~

50/60Hz
3p=9h
4p+5p=6h

500V~

50/60Hz
7h

>50-500V~

100-300Hz
10h

>50-500V~

301-500Hz
2h

Amp. Poles pack. unit

Cat.No.

Cat.No.

Cat.No.

Cat.No.

Cat.No.

Cat.No.

flange 100 x 112 - fixing center 80 x 88

| | | | | | | | | |
|----|---|---|-------|--------------|--------------|-------|--------|-------|
| 63 | 3 | 2 | 733-4 | 733-6 | 733-9 | 733-7 | 733-10 | 733-2 |
| 63 | 4 | 2 | 734-4 | 734-9 | 734-6 | 734-7 | 734-10 | 734-2 |
| 63 | 5 | 2 | 735-4 | 735-9 | 735-6 | 735-7 | 735-10 | 735-2 |



735-6

flange 120 x 130 - fixing center 100 x 108

| | | | | | | | | |
|-----|---|---|-------|--------------|--------------|-------|--------|-------|
| 125 | 3 | 2 | 743-4 | 743-6 | 743-9 | 743-7 | 743-10 | 743-2 |
| 125 | 4 | 2 | 744-4 | 744-9 | 744-6 | 744-7 | 744-10 | 744-2 |
| 125 | 5 | 2 | 745-4 | 745-9 | 745-6 | 745-7 | 745-10 | 745-2 |



745-6

H x W x D = 170 x 118 x 124

| | | | | | | | | |
|----|---|---|---------|----------------|----------------|---------|----------|---------|
| 63 | 3 | 2 | 77733-4 | 77733-6 | 77733-9 | 77733-7 | 77733-10 | 77733-2 |
| 63 | 4 | 2 | 77734-4 | 77734-9 | 77734-6 | 77734-7 | 77734-10 | 77734-2 |
| 63 | 5 | 2 | 77735-4 | 77735-9 | 77735-6 | 77735-7 | 77735-10 | 77735-2 |

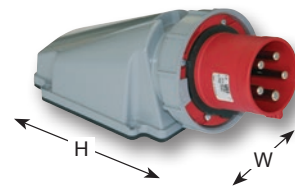

77735-6

flange 116 x 91 - fixing center 95 x 70

| | | | | | | | | |
|----|---|---|----------|-----------------|-----------------|----------|-----------|----------|
| 63 | 3 | 2 | 77733-4k | 77733-6k | 77733-9k | 77733-7k | 77733-10k | 77733-2k |
| 63 | 4 | 2 | 77734-4k | 77734-9k | 77734-6k | 77734-7k | 77734-10k | 77734-2k |
| 63 | 5 | 2 | 77735-4k | 77735-9k | 77735-6k | 77735-7k | 77735-10k | 77735-2k |



77735-6k



Phase inverters

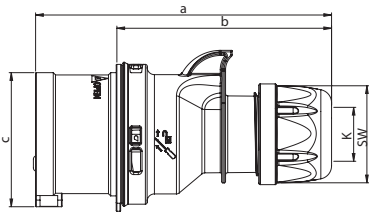

Shark Phase inverter plug IP44

| | 16 Amp | | 32 Amp | |
|---|----------------|------|---------|---------|
| Poles | 4 | 5 | 4 | 5 |
| a | 128 | 134 | 150 | 155 |
| b | 92 | 98 | 104 | 109 |
| c | 53 | 61 | 63 | 70 |
| K_cable Ø [mm] | 6-15 | 8-16 | 11,5-20 | 11,5-22 |
| Connection type: | Screw terminal | | | |
| Wire flexible class 5 or 6 [mm ²] | 1-2,5 | | 2,5-6 | |
| Contact screws [Ncm] | 100 Ncm | | 110 Ncm | |
| SW | 42 | 42 | 50 | 50 |
| Weight [g] | 131 | 154 | 204 | 236 |

- with screw terminals
- housing material: PA6
- contacts: nickel-plated contacts

IP44 splashproof

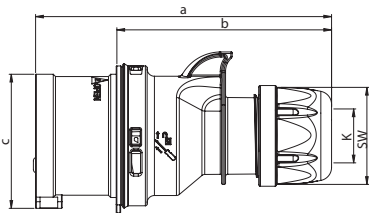

Turbo Shark Phase inverter plug IP44

| | 16 Amp | | 32 Amp | |
|---|---------------------------------------|------|---------|---------|
| Poles | 4 | 5 | 4 | 5 |
| a | 128 | 134 | 150 | 155 |
| b | 92 | 98 | 104 | 109 |
| c | 53 | 61 | 63 | 70 |
| K_cable Ø [mm] | 6-15 | 8-16 | 11,5-20 | 11,5-22 |
| Connection type: | Screw terminal and screwless terminal | | | |
| Wire flexible class 5 or 6 [mm ²] | 1-2,5 | | 2,5-6 | |
| Contact screws [Ncm] | 100 Ncm | | 110 Ncm | |
| SW | 42 | 42 | 50 | 50 |
| Weight [g] | 131 | 156 | 204 | 237 |

- L1, N, PE = screwless connection terminals
- L2, L3 = screw terminals
- housing material: PA6
- contacts: nickel-plated contacts

IP44 splashproof

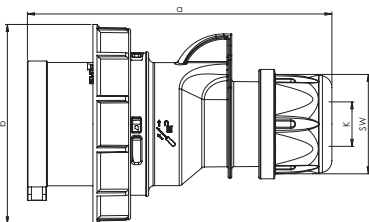

Shark Phase inverter plug IP67

| | 16 Amp | | 32 Amp | |
|---|----------------|------|---------|---------|
| Poles | 4 | 5 | 4 | 5 |
| a | 128 | 134 | 150 | 155 |
| b | 79 | 87 | 93 | 100 |
| c | 53 | 61 | 63 | 70 |
| K_cable Ø [mm] | 6-15 | 8-16 | 11,5-20 | 11,5-22 |
| Connection type: | Screw terminal | | | |
| Wire flexible class 5 or 6 [mm ²] | 1-2,5 | | 2,5-6 | |
| Contact screws [Ncm] | 100 Ncm | | 110 Ncm | |
| SW | 42 | 42 | 50 | 50 |
| Weight [g] | 153 | 183 | 245 | 280 |

- with screw terminals
- housing material: PA6
- contacts: nickel-plated contacts

IP67 watertight

230V~

50/60Hz
4p=9h

400V~

50/60Hz
4p+5p=6h

| Amp. | Poles | pack. unit |
|------|-------|------------|
| 16 | 4 | 10 |
| 16 | 5 | 10 |
| 32 | 4 | 10 |
| 32 | 5 | 10 |

| Cat.No. |
|---------|
| 7014-9 |
| 7024-9 |

| Cat.No. |
|---------------|
| 7014-6 |
| 7015-6 |
| 7024-6 |
| 7025-6 |



7015-6

| Amp. | Poles | pack. unit |
|------|-------|------------|
| 16 | 5 | 10 |
| 32 | 5 | 10 |

| Cat.No. |
|----------|
| 7015-6TT |
| 7025-6TT |

| Cat.No. |
|----------|
| 7015-6TT |
| 7025-6TT |



7015-6TT

| Amp. | Poles | pack. unit |
|------|-------|------------|
| 16 | 4 | 10 |
| 16 | 5 | 10 |
| 32 | 4 | 10 |
| 32 | 5 | 10 |

| Cat.No. |
|---------|
| 70142-9 |
| 70242-9 |

| Cat.No. |
|----------------|
| 70142-6 |
| 70152-6 |
| 70242-6 |
| 70252-6 |



70252-6

Functional principle: Phase inverter

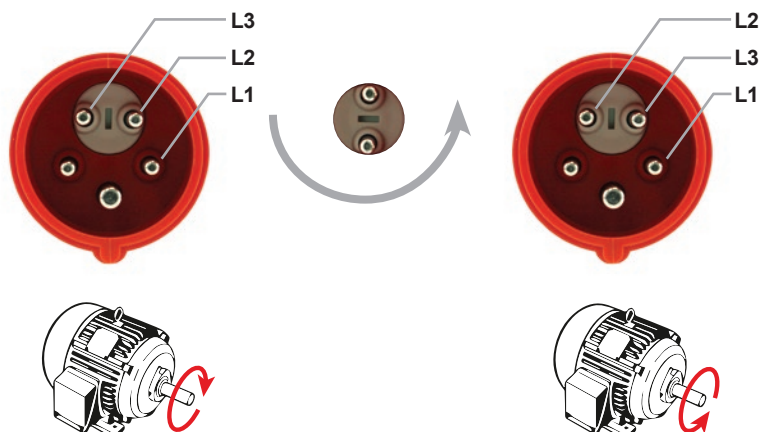

Phase inverters

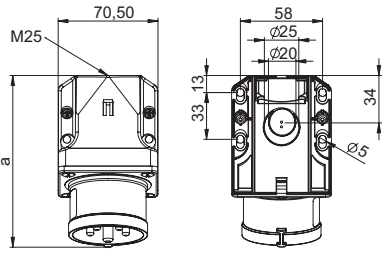

b=height
angle=15°

Phase inverter - Wall mounted plug IP44

| | 16 Amp | | 32 Amp | |
|----------------------------------|----------------|-----|---------|-----|
| Poles | | 5 | 4 | 5 |
| a | | 122 | 131 | 132 |
| b | | 79 | 85 | 85 |
| M | | 25 | 25 | 25 |
| Connection type: | Screw terminal | | | |
| Wire flexible class 5 or 6 [mm²] | 1-2,5 | | 2,5-6 | |
| Contact screws [Ncm] | 100 Ncm | | 110 Ncm | |
| Weight [g] | | 205 | 234 | 255 |

- with screw terminals
- housing material: PA6
- contacts: nickel-plated contacts
- top and rear entry
- incl. threaded cable grommet

IP44 splashproof

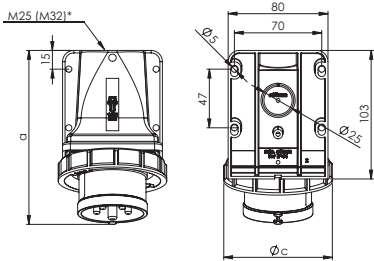

b=height
angle=15°

Phase inverter - Wall mounted plug IP67

| | 16 Amp | | 32 Amp | |
|----------------------------------|----------------|-----|---------|-----|
| Poles | | 5 | 4 | 5 |
| a | | 140 | 153 | 152 |
| b | | 100 | 104 | 102 |
| c | | 71 | 93 | 100 |
| M* | | 25 | 25 | 25 |
| Connection type: | Screw terminal | | | |
| Wire flexible class 5 or 6 [mm²] | 1-2,5 | | 2,5-6 | |
| Contact screws [Ncm] | 100 Ncm | | 110 Ncm | |
| Weight [g] | | 241 | 276 | 307 |

- with screw terminals
- housing material: PA6
- contacts: nickel-plated contacts
- top and rear entry
- incl. threaded bung

IP67 watertight

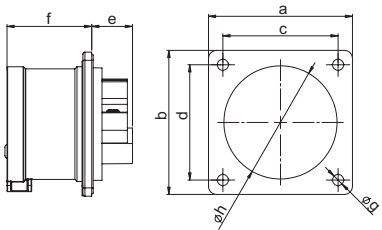

Phase inverter - Flanged plug straight IP44

| | 16 Amp | | 32 Amp | |
|----------------------------------|----------------|-----|---------|-----|
| Pole s | | 5 | 4 | 5 |
| Flange | | | | |
| a x b | | 70 | 70 | 70 |
| Fixing center | | | | |
| c x d | | 56 | 56 | 56 |
| e | | 20 | 21 | 21 |
| f | | 42 | 51 | 51 |
| g | | 5,5 | 5,5 | 5,5 |
| h | | 55 | 55 | 55 |
| Connection type: | Screw terminal | | | |
| Wire flexible class 5 or 6 [mm²] | 1-2,5 | | 2,5-6 | |
| Contact screws [Ncm] | 100 Ncm | | 110 Ncm | |
| Weight [g] | | 118 | 146 | 167 |

- with screw terminals
- housing material: PA6
- contacts: nickel-plated contacts
- According to EN 60309: For correct use a locking device has to be provided (see page 32)

IP44 splashproof

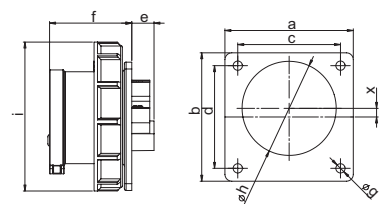

Phase inverter - Flanged plug straight IP67

| | 16 Amp | | 32 Amp | |
|----------------------------------|----------------|-----|---------|-----|
| Poles | | 5 | 4 | 5 |
| Flange | | | | |
| a x b | | 75 | 75 | 75 |
| Fixing Center | | | | |
| c x d | | 60 | 60 | 60 |
| e | | 13 | 15 | 14 |
| f | | 48 | 58 | 58 |
| g | | 5,5 | 5,5 | 5,5 |
| h | | 55 | 55 | 55 |
| h | | 87 | 93 | 100 |
| x | | 5 | 4,5 | 0 |
| Connection type: | Screw terminal | | | |
| Wire flexible class 5 or 6 [mm²] | 1-2,5 | | 2,5-6 | |
| Contact screws [Ncm] | 100 Ncm | | 110 Ncm | |
| Weight [g] | | 150 | 185 | 215 |

- with screw terminals
- housing material: PA6
- contacts: nickel-plated contacts
- According to EN 60309: For correct use a locking device has to be provided (see page 32)
- for 16A 5p and 32 5p the plug is placed off centered for keeping the standards

IP67 watertight

230V~

50/60Hz
4p=9h

400V~

50/60Hz
4p+5p=6h

| Amp. | Poles | pack. unit |
|------|-------|------------|
| 16 | 5 | 10 |
| 16 | 5 | 10 |
| 32 | 4 | 10 |
| 32 | 4 | 10 |
| 32 | 5 | 10 |
| 32 | 5 | 10 |

| Cat.No. | Cat.No. |
|---------|---------------|
| | 7715-6 |
| | 7715-6d |
| 7724-9 | 7724-6 |
| 7724-9d | 7724-6d |
| | 7725-6 |
| | 7725-6d |

with cap

with cap

with cap



7715-6

| | | |
|----|---|---|
| 16 | 5 | 5 |
| 32 | 4 | 5 |
| 32 | 5 | 5 |

| | |
|----------|-----------------|
| | 77152-6k |
| 77242-9k | 77242-6k |
| | 77252-6k |



77152-6k

| flange 70 x 70 - fixing center 56 x 56 | | |
|--|---|----|
| 16 | 5 | 10 |
| 32 | 4 | 10 |
| 32 | 5 | 10 |

| | |
|--------|---------------|
| | 8615-6 |
| 8624-9 | 8624-6 |
| | 8625-6 |



8624-6

| flange 75 x 75 - fixing center 60 x 60 | | |
|--|---|----|
| 16 | 5 | 10 |
| 32 | 4 | 10 |
| 32 | 5 | 10 |

| | |
|---------|----------------|
| | 86152-6 |
| 86242-9 | 86242-6 |
| | 86252-6 |



86152-6



Phase inverters

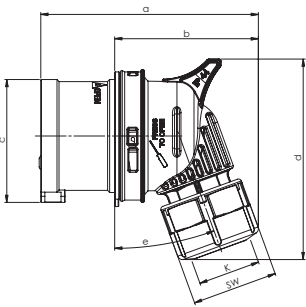

Twist Phase inverter - Angled plug IP44

| | 16 Amp | | 32 Amp | |
|---|----------------|------|---------|---------|
| | 4 | 5 | 4 | 5 |
| Poles | 4 | 5 | 4 | 5 |
| a | 98 | 108 | 127 | 135 |
| b | 62 | 71 | 82 | 90 |
| c | 53 | 61 | 63 | 70 |
| d | 87 | 99 | 111 | 114 |
| e [°] | 15 | 20 | 25 | 25 |
| K_cable Ø [mm] | 6-15 | 8-16 | 11,5-20 | 11,5-22 |
| Connection type: | Screw terminal | | | |
| Wire flexible class 5 or 6 [mm ²] | 1-2,5 | | 2,5-6 | |
| Contact screws [Ncm] | 100 Ncm | | 110 Ncm | |
| SW | 38 | 42 | 50 | 50 |
| Weight [g] | 128 | 150 | 181 | 237 |

- with screw terminals
- housing material
16/4: PA6
16/5, 32/4, 32/5: PC/ABS
- contacts: nickel-plated contacts

IP44 splashproof

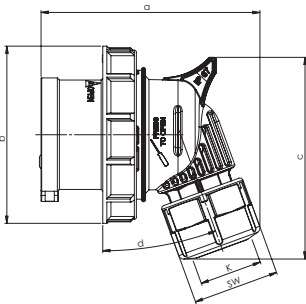

Twist Phase inverter - Angled plug IP67

| | 16 Amp | | 32 Amp | |
|---|----------------|------|---------|---------|
| | 4 | 5 | 4 | 5 |
| Poles | 4 | 5 | 4 | 5 |
| a | 98 | 108 | 127 | 135 |
| b | 62 | 71 | 93 | 90 |
| c | 53 | 61 | 111 | 70 |
| d [°] | 15 | 20 | 25 | 25 |
| K_cable Ø [mm] | 6-15 | 8-16 | 11,5-20 | 11,5-22 |
| Connection type: | Screw terminal | | | |
| Wire flexible class 5 or 6 [mm ²] | 1-2,5 | | 2,5-6 | |
| Contact screws [Ncm] | 100 Ncm | | 110 Ncm | |
| SW | 38 | 42 | 50 | 50 |
| Weight [g] | 152 | 180 | 188 | 281 |

- with screw terminals
- housing material
16/4: PA6
16/5, 32/4, 32/5: PC/ABS
- contacts: nickel-plated contacts

IP67 watertight

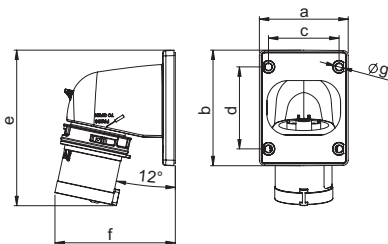

Twist Phase inverter - Flanged plug angled IP44

| | 16 Amp | | 32 Amp | |
|---|----------------|-----|---------|-----|
| | 4 | 5 | 4 | 5 |
| Poles | 4 | 5 | 4 | 5 |
| a | 66 | 90 | 90 | 90 |
| b | 86 | 100 | 100 | 100 |
| c | 53 | 77 | 77 | 77 |
| d | 61 | 85 | 85 | 85 |
| e | 117 | 153 | 163 | 164 |
| f | 93 | 98 | 100 | 103 |
| g | 5 | 5 | 5 | 5 |
| Connection type: | Screw terminal | | | |
| Wire flexible class 5 or 6 [mm ²] | 1-2,5 | | 2,5-6 | |
| Contact screws [Ncm] | 100 Ncm | | 110 Ncm | |
| Weight [g] | 147 | 190 | 222 | 249 |

- with screw terminals
- housing material: PC/ABS
- contacts: nickel-plated contacts

IP44 splashproof

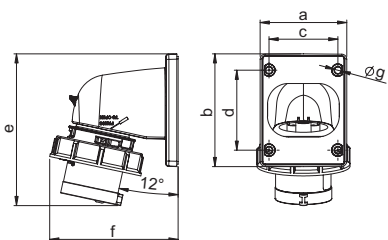

Twist Phase inverter - Flanged plug angled IP67

| | 16 Amp | | 32 Amp | |
|---|----------------|-----|---------|-----|
| | 4 | 5 | 4 | 5 |
| Poles | 4 | 5 | 4 | 5 |
| a | 66 | 90 | 90 | 90 |
| b | 86 | 100 | 100 | 100 |
| c | 53 | 77 | 77 | 77 |
| d | 61 | 85 | 85 | 85 |
| e | 117 | 153 | 163 | 164 |
| f | 103 | 107 | 110 | 114 |
| g | 5 | 5 | 5 | 5 |
| Connection type: | Screw terminal | | | |
| Wire flexible class 5 or 6 [mm ²] | 1-2,5 | | 2,5-6 | |
| Contact screws [Ncm] | 100 Ncm | | 110 Ncm | |
| Weight [g] | 171 | 225 | 261 | 297 |

- with screw terminals
- housing material: PC/ABS
- contacts: nickel-plated contacts

IP67 watertight

230V~

50/60Hz
4p=9h

400V~

50/60Hz
4p+5p=6h

| Amp. | Poles | pack. unit |
|------|-------|------------|
| 16 | 4 | 10 |
| 16 | 5 | 10 |
| 32 | 4 | 10 |
| 32 | 5 | 10 |

| Cat.No. | Cat.No. |
|---------|---------------|
| 7414-9 | 7414-6 |
| | 7415-6 |
| 7424-9 | 7424-6 |
| | 7425-6 |



7414-6



| | | |
|----|---|----|
| 16 | 4 | 10 |
| 16 | 5 | 10 |
| 32 | 4 | 10 |
| 32 | 5 | 10 |

| | |
|---------|----------------|
| 74142-9 | 74142-6 |
| | 74152-6 |
| | 74242-6 |
| | 74252-6 |



74142-6



| | | |
|----|---|----|
| 16 | 4 | 10 |
| 16 | 5 | 5 |
| 32 | 4 | 5 |
| 32 | 5 | 5 |

| | |
|---------|----------------|
| 77814-9 | 77814-6 |
| | 77815-6 |
| 77824-9 | 77824-6 |
| | 77825-6 |



77814-6



| | | |
|----|---|----|
| 16 | 4 | 10 |
| 16 | 5 | 5 |
| 32 | 4 | 5 |
| 32 | 5 | 5 |

| | |
|----------|----------|
| 778142-9 | 778142-6 |
| | 778152-6 |
| 778242-9 | 778242-6 |
| | 778252-6 |



778152-6



Accessories

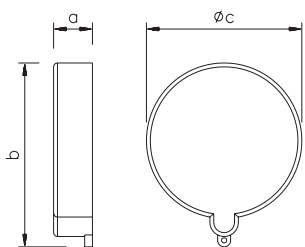

Cap 16 and 32A

| Poles | 16 Amp | | | 32 Amp | | |
|------------|--------|----|----|--------|----|----|
| | 3 | 4 | 5 | 3 | 4 | 5 |
| a | 15 | 15 | 15 | 15 | 15 | 15 |
| b | 56 | 63 | 71 | 71 | 71 | 79 |
| c | 48 | 54 | 61 | 61 | 61 | 67 |
| Weight [g] | 10 | 12 | 14 | 14 | 14 | 16 |

- for plugs and appliance plugs to protect contacts against dust
- material: TPE/PP

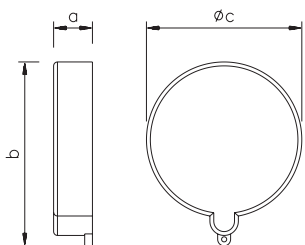

Cap 63 and 125A

| Poles | 63 Amp | | | 125 Amp | | |
|------------|--------|----|----|---------|----|----|
| | 3 | 4 | 5 | 3 | 4 | 5 |
| a | 21 | 21 | 21 | 21 | 21 | 21 |
| b | 82 | 82 | 82 | 93 | 93 | 93 |
| c | 73 | 73 | 73 | 86 | 86 | 86 |
| Weight [g] | 21 | 21 | 21 | 25 | 25 | 25 |

- for plugs and appliance plugs to protect contacts against dust
- material: TPE/PP

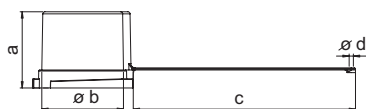

Water protection cap 63 and 125A

| Poles | 63 Amp | | | 125 Amp | | |
|------------|--------|-----|-----|---------|-----|-----|
| | 3 | 4 | 5 | 3 | 4 | 5 |
| a | 72 | 72 | 72 | 82 | 82 | 82 |
| b | 78 | 78 | 78 | 91 | 91 | 91 |
| c | 211 | 211 | 211 | 205 | 205 | 205 |
| d | 4 | 4 | 4 | 5 | 5 | 5 |
| Weight [g] | 75 | 75 | 75 | 98 | 98 | 98 |

- for plugs and appliance plugs
- material 63A: Polypropylen
- material 125A: Polyamide PA6

IP67 watertight

Special tool for plug- and connector cable gland nuts

Note: Consider rated torques - see page 14/15

Shark / TURBOSHARK 16/32A wrench open, L=215mm

711632

POWER TWIST 63/125A wrench open, L=313mm

7163125



| Amp. | Poles | pack unit | Cat.No. | | |
|------|-------|-----------|---------|--------|--------|
| 16 | 3 | | ts613g | | |
| 16 | 4 | | ts614g | | |
| 16 | 5 | | ts615g | | |
| 32 | 3 | | } | ts623g | |
| 32 | 4 | | | } | ts625g |
| 32 | 5 | | | | |



| | | | |
|-----|---|---|--------|
| 63 | 3 | } | ts635g |
| 63 | 4 | | |
| 63 | 5 | | |
| 125 | 3 | } | ts645g |
| 125 | 4 | | |
| 125 | 5 | | |



| | | | |
|-----|---|---|---------|
| 63 | 3 | } | ts7632g |
| 63 | 4 | | |
| 63 | 5 | | |
| 125 | 3 | } | ts1252g |
| 125 | 4 | | |
| 125 | 5 | | |



Cable gland IP68, black

Note: For entries without threads, marked by „Ø“, the appropriate lock nuts should be used!

| size | thread length | cable diameter | Cat.No. | pack unit |
|-----------|-------------------------------|----------------|-------------|-----------|
| M20 x 1,5 | 15 mm | 10-14 mm | 23201515120 | 50 |
| M25 x 1,5 | 15 mm | 13-18 mm | 23251515140 | 50 |
| M32 x 1,5 | 15 mm | 18-25 mm | 23321515200 | 25 |
| M40 x 1,5 | 18 mm | 22-32 mm | 23401518260 | 10 |
| M50 x 1,5 | 18 mm | 30-38 mm | 23501518310 | 5 |
| M63 x 1,5 | 18 mm | 34-44 mm | 23631518350 | 5 |
| M40 x 1,5 | Lock nut, brass nickel coated | | 264015009 | 50 |
| M50 x 1,5 | Lock nut, brass nickel coated | | 265015009 | 50 |



Connectors

Shark Connector IP44

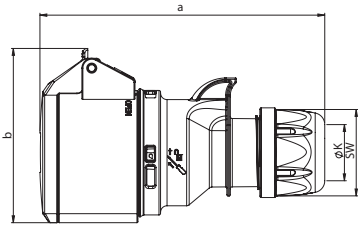

| | 16 Amp | | | 32 Amp | | |
|----------------------------------|----------------|------|------|---------|---------|---------|
| | 3 | 4 | 5 | 3 | 4 | 5 |
| Poles | 3 | 4 | 5 | 3 | 4 | 5 |
| a | 133 | 138 | 145 | 161 | 161 | 168 |
| b | 74 | 82 | 89 | 94 | 94 | 99 |
| K_cable Ø [mm] | 6-15 | 6-15 | 8-16 | 11,5-20 | 11,5-20 | 11,5-22 |
| Connection type: | Screw terminal | | | | | |
| Wire flexible [mm ²] | 1-2,5 | | | 2,5-6 | | |
| Contact screws [Ncm] | 100 Ncm | | | 110 Ncm | | |
| SW | 42 | 42 | 42 | 50 | 50 | 50 |
| Weight [g] | 134 | 161 | 188 | 228 | 244 | 270 |

- with screw terminals
- housing material: PA6
- contacts: brass
- to order nickel-plated contacts please add a "v" e.g. 215-6v

IP44 splashproof

Turbo Shark Connector IP44

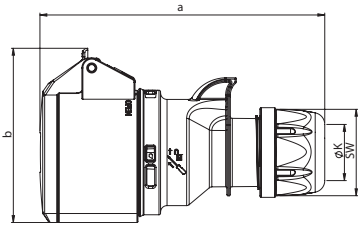

| | 16 Amp | | | 32 Amp | | |
|----------------------------------|--------------------|------|------|---------|---------|---------|
| | 3 | 4 | 5 | 3 | 4 | 5 |
| Poles | 3 | 4 | 5 | 3 | 4 | 5 |
| a | 133 | 138 | 145 | 161 | 161 | 168 |
| b | 74 | 82 | 89 | 94 | 94 | 99 |
| K_cable Ø [mm] | 6-15 | 6-15 | 8-16 | 11,5-20 | 11,5-20 | 11,5-22 |
| Connection type: | Screwless terminal | | | | | |
| Wire flexible [mm ²] | 1-2,5 | | | 2,5-6 | | |
| SW | 42 | 42 | 42 | 50 | 50 | 50 |
| Weight [g] | 136 | 161 | 193 | 228 | 243 | 271 |

- screwless connection technology
- housing material: PA6
- contacts: brass
- to order nickel-plated contacts please add a "v" e.g. 215-6TTv

IP44 splashproof

Shark Connector IP67

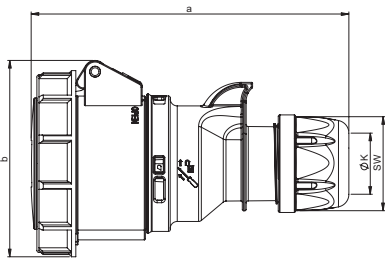

| | 16 Amp | | | 32 Amp | | |
|----------------------------------|----------------|------|------|---------|---------|---------|
| | 3 | 4 | 5 | 3 | 4 | 5 |
| Poles | 3 | 4 | 5 | 3 | 4 | 5 |
| a | 132 | 139 | 147 | 163 | 163 | 171 |
| b | 78 | 84 | 92 | 96 | 96 | 102 |
| K_cable Ø [mm] | 6-15 | 6-15 | 8-16 | 11,5-20 | 11,5-20 | 11,5-22 |
| Connection type: | Screw terminal | | | | | |
| Wire flexible [mm ²] | 1-2,5 | | | 2,5-6 | | |
| Contact screws [Ncm] | 100 Ncm | | | 110 Ncm | | |
| SW | 42 | 42 | 42 | 50 | 50 | 50 |
| Weight [g] | 155 | 186 | 227 | 275 | 292 | 338 |

- with screw terminals
- housing material: PA6
- contacts: brass
- to order nickel-plated contacts please add a "v" e.g. 2152-6v

IP67 watertight

Turbo Shark Connector IP67

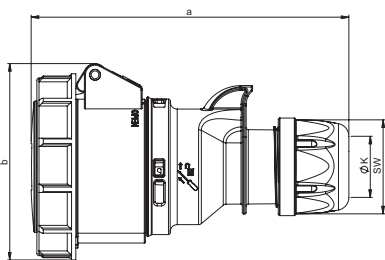

| | 16 Amp | | | 32 Amp | | |
|----------------------------------|--------------------|------|------|---------|---------|---------|
| | 3 | 4 | 5 | 3 | 4 | 5 |
| Poles | 3 | 4 | 5 | 3 | 4 | 5 |
| a | 132 | 139 | 147 | 163 | 163 | 171 |
| b | 78 | 84 | 92 | 96 | 96 | 102 |
| K_cable Ø [mm] | 6-15 | 6-15 | 8-16 | 11,5-20 | 11,5-20 | 11,5-22 |
| Connection type: | Screwless terminal | | | | | |
| Wire flexible [mm ²] | 1-2,5 | | | 2,5-6 | | |
| SW | 42 | 42 | 42 | 50 | 50 | 50 |
| Weight [g] | 157 | 187 | 231 | 275 | 291 | 339 |

- screwless connection technology
- housing material: PA6
- contacts: brass
- to order nickel-plated contacts please add a "v" e.g. 2152-6TTv

IP67 watertight

| Amp. | Poles | pack. unit | 110V~ | 230V~ | 400V~ | 500V~ | >50-500V~ | >50-500V~ |
|------|-------|------------|---------------|------------------------------|------------------------------|---------------|------------------|-----------------|
| | | | 50/60Hz 4h | 50/60Hz 3p=6h 4p+5p=9h | 50/60Hz 3p=9h 4p+5p=6h | 50/60Hz 7h | 100-300Hz 10h | 301-500Hz 2h |
| | | | Cat.No. | Cat.No. | Cat.No. | Cat.No. | Cat.No. | Cat.No. |
| 16 | 3 | 10 | 213-4 | 213-6 | 213-9 | 213-7 | 213-10 | 213-2 |
| 16 | 4 | 10 | 214-4 | 214-9 | 214-6 | 214-7 | 214-10 | 214-2 |
| 16 | 5 | 10 | 215-4 | 215-9 | 215-6 | 215-7 | 215-10 | 215-2 |
| 32 | 3 | 10 | 223-4 | 223-6 | 223-9 | 223-7 | 223-10 | 223-2 |
| 32 | 4 | 10 | 224-4 | 224-9 | 224-6 | 224-7 | 224-10 | 224-2 |
| 32 | 5 | 10 | 225-4 | 225-9 | 225-6 | 225-7 | 225-10 | 225-2 |



215-6

| | | | | | | | | |
|----|---|----|---------|----------------|----------------|--|--|--|
| 16 | 3 | 10 | 213-4TT | 213-6TT | 213-9TT | | | |
| 16 | 4 | 10 | 214-4TT | 214-9TT | 214-6TT | | | |
| 16 | 5 | 10 | 215-4TT | 215-9TT | 215-6TT | | | |
| 32 | 3 | 10 | 223-4TT | 223-6TT | 223-9TT | | | |
| 32 | 4 | 10 | 224-4TT | 224-9TT | 224-6TT | | | |
| 32 | 5 | 10 | 225-4TT | 225-9TT | 225-6TT | | | |



215-6TT

| | | | | | | | | |
|----|---|----|--------|---------------|---------------|--------|---------|--------|
| 16 | 3 | 10 | 2132-4 | 2132-6 | 2132-9 | 2132-7 | 2132-10 | 2132-2 |
| 16 | 4 | 10 | 2142-4 | 2142-9 | 2142-6 | 2142-7 | 2142-10 | 2142-2 |
| 16 | 5 | 10 | 2152-4 | 2152-9 | 2152-6 | 2152-7 | 2152-10 | 2152-2 |
| 32 | 3 | 10 | 2232-4 | 2232-6 | 2232-9 | 2232-7 | 2232-10 | 2232-2 |
| 32 | 4 | 10 | 2242-4 | 2242-9 | 2242-6 | 2242-7 | 2242-10 | 2242-2 |
| 32 | 5 | 10 | 2252-4 | 2252-9 | 2252-6 | 2252-7 | 2252-10 | 2252-2 |



2252-6

| | | | | | | | | |
|----|---|----|----------|-----------------|-----------------|--|--|--|
| 16 | 3 | 10 | 2132-4TT | 2132-6TT | 2132-9TT | | | |
| 16 | 4 | 10 | 2142-4TT | 2142-9TT | 2142-6TT | | | |
| 16 | 5 | 10 | 2152-4TT | 2152-9TT | 2152-6TT | | | |
| 32 | 3 | 10 | 2232-4TT | 2232-6TT | 2232-9TT | | | |
| 32 | 4 | 10 | 2242-4TT | 2242-9TT | 2242-6TT | | | |
| 32 | 5 | 10 | 2252-4TT | 2252-9TT | 2252-6TT | | | |



2252-6TT



Connectors

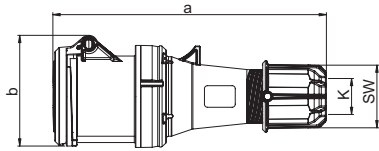

Power Twist Connector IP44

| | 63 Amp | | |
|----------------------------------|---------------------------|---------|---------|
| Poles | 3 | 4 | 5 |
| a | 269 | 269 | 269 |
| b | 107 | 107 | 107 |
| K_cable Ø [mm] | 14,5-36 | 14,5-36 | 14,5-36 |
| Connection type: | Contact frame with screws | | |
| Wire flexible [mm ²] | 6-16 | | |
| Contact screws [Ncm] | 200 Ncm | | |
| SW | 61 | 61 | 61 |
| Weight [g] | 624 | 664 | 720 |

- contact frame with screws
- housing material: PA6
- contacts: brass with lamellar contact CuBe
- to order with pilot contact please add a „5“ e.g. 23351-6 (see page 10)
- to order with pilot contact system (PCS) please add a „6“ e.g. 23361-6 (see page 10)

IP44 splashproof

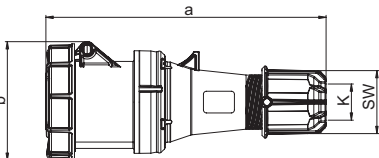

Power Twist Connector IP66/67

| | 63 Amp | | |
|----------------------------------|---------------------------|---------|---------|
| Pole | 3 | 4 | 5 |
| a | 269 | 269 | 269 |
| b | 114 | 114 | 114 |
| K_cable Ø [mm] | 14,5-36 | 14,5-36 | 14,5-36 |
| Connection type: | Contact frame with screws | | |
| Wire flexible [mm ²] | 6-16 | | |
| Contact screws [Ncm] | 200 Ncm | | |
| SW | 61 | 61 | 61 |
| Weight [g] | 669 | 710 | 768 |

- contact frame with screws
- housing material: PA6
- contacts: brass with lamellar contact CuBe
- to order with pilot contact please add a „5“ e.g. 2335-6 (see page 10)
- to order with pilot contact system (PCS) please add a „6“ e.g. 2336-6 (see page 10)

IP66/67 watertight

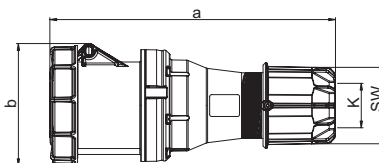

Power Twist Connector IP66/67

| | 125 Amp | | |
|----------------------------------|---------------------------|---------|---------|
| Pole | 3 | 4 | 5 |
| a | 287 | 287 | 287 |
| b | 124 | 124 | 124 |
| K_cable Ø [mm] | 22,5-50 | 22,5-50 | 22,5-50 |
| Connection type: | Contact frame with screws | | |
| Wire flexible [mm ²] | 16-50 | | |
| Contact screws [Ncm] | 450 Ncm | | |
| SW | 81 | 81 | 81 |
| Weight [g] | 1060 | 1167 | 1266 |

- contact frame with screws
- housing material: PA6
- contacts: brass with lamellar contact CuBe
- to order with pilot contact please add a „5“ e.g. 2435-6 (see page 10)
- to order with pilot contact system (PCS) please add a „6“ e.g. 2436-6 (see page 10)

IP66/67 watertight

**POWER
TWIST**



■ ■ ■ Safety

■ ■ ■ High impact resistance

■ ■ ■ Optimum grip

■ ■ ■ Large connection area

■ ■ ■ Time saving

| Amp. | Poles | pack. unit | 110V~ | 230V~ | 400V~ | 500V~ | >50-500V~ | >50-500V~ |
|------|-------|------------|---------------|------------------------------|------------------------------|---------------|------------------|-----------------|
| | | | 50/60Hz 4h | 50/60Hz 3p=6h 4p+5p=9h | 50/60Hz 3p=9h 4p+5p=6h | 50/60Hz 7h | 100-300Hz 10h | 301-500Hz 2h |
| | | | Cat.No. | Cat.No. | Cat.No. | Cat.No. | Cat.No. | Cat.No. |
| 63 | 3 | 2 | 2331-4 | 2331-6 | 2331-9 | 2331-7 | 2331-10 | 2331-2 |
| 63 | 4 | 2 | 2341-4 | 2341-9 | 2341-6 | 2341-7 | 2341-10 | 2341-2 |
| 63 | 5 | 2 | 2351-4 | 2351-9 | 2351-6 | 2351-7 | 2351-10 | 2351-2 |



2351-6

| | | | | | | | | |
|----|---|---|-------|--------------|--------------|-------|--------|-------|
| 63 | 3 | 2 | 233-4 | 233-6 | 233-9 | 233-7 | 233-10 | 233-2 |
| 63 | 4 | 2 | 234-4 | 234-9 | 234-6 | 234-7 | 234-10 | 234-2 |
| 63 | 5 | 2 | 235-4 | 235-9 | 235-6 | 235-7 | 235-10 | 235-2 |



235-6

| | | | | | | | | |
|-----|---|---|-------|--------------|--------------|-------|--------|-------|
| 125 | 3 | 2 | 243-4 | 243-6 | 243-9 | 243-7 | 243-10 | 243-2 |
| 125 | 4 | 2 | 244-4 | 244-9 | 244-6 | 244-7 | 244-10 | 244-2 |
| 125 | 5 | 2 | 245-4 | 245-9 | 245-6 | 245-7 | 245-10 | 245-2 |



245-6

One contact – for extreme environments

