

# LOEWER

## CrossMaster DD300S

DEBURRING AND EDGE ROUNDING MACHINE FOR SMALL PARTS UP TO 300MM IN WIDTH



FOR LASER-CUT, PLASMA-CUT AND PUNCHED SHEET METAL  
FOR FOILED, ZINC-PLATED AND 3D PARTS  
FOR STEEL, STAINLESS STEEL, ALUMINIUM

### Through-feed deburring and edge rounding of small parts

The CrossMaster DD300S is equipped with two disc units, one for deburring and one for edge rounding. The workpieces are placed on a high-friction feed belt. The disc tools are parallel to the workpiece and push the workpiece against the feed belt during operation. As a result, it is possible on a disc-only machine to process even very small workpieces starting from 20 x 20mm.

### Advantages

- Deburring and edge rounding in one pass
- Removal of higher burrs and spatter
- Uniform wearing of tools irrespective of size of workpiece or where it is placed on the feed belt
- Quick change of tools and easy setting when processing steel/stainless steel
- Processes very small parts from 20mm diameter
- Great variety of abrasive tools for different applications
- Low investment and operating costs

### Our tools

Different grinding tasks require different grinding tools..



The **SoftDisc** with surface conditioning abrasives is ideal for deburring aluminium or steel parts.



Our protected **CompactDisc** with ceramic abrasive removes high burrs and spatter on stainless steel.



The **MediumDisc** is the first choice for edge rounding and is available in different compressions and grit sizes.

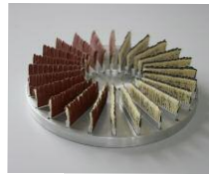

The **SmartFlexDisc** is very open and works well for edge rounding zinc-plated, foiled or 3D-parts.

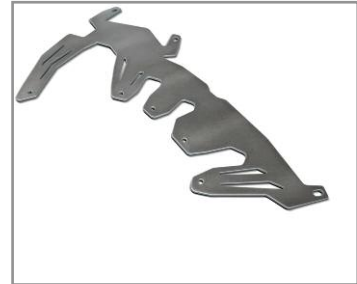

Aluminium



Steel



Stainless steel



Small parts

### Technical Details Crossmaster DD300S

Compared with our standard CrossMaster DD 300 the DD300S is equipped as standard with a complete machine enclosure, motorized height adjustment with electronical digital display for setting workpiece thickness as well with an extra long infeed table.

- 2 disc units from top each 1,5 kW with 750rpm, for disc diameter 400mm
- Max. working width (width of feed belt) 300mm, extra long infeed table
- Motorized height adjustment with electronical digital display 0,3 - 100mm
- Separate height adjustment of each disc to compensate for tool wear
- Variable feed speed using frequency inverter 1 - 6m/min
- Brush strip below feed belt for removing loose dust
- Spring-loaded hold down rollers for longer workpieces
- Dust extraction connection outlet, diameter 1 x 180mm
- 400V, 50Hz, 3P, CE

### Optional Extras

- Variable rpm of discs using two frequency inverters, each disc can be set separately
- Rotating cleaning brush under feed belt for dust removal
- Permanent magnet