

MYST TEAM 29/27.5

£5,199.99 / € 5,999.00

SARACEN



SPECS

FRAME	
SIZES	MD / LG
COLOUR	KHAKI GREEN
FRAME	24T/40T/3K TORAY UD CARBON BLEND / OPTIMISED FACTORY RACING SIZING / 203MM TRAVEL
FORK	FOX 40 FLOAT FACTORY / KASHIMA / 203MM TRAVEL
REAR-SHOCK	FOX DHX2 FACTORY
HEADSET	CUSTOM SARACEN HEADSET / 0MM OFFSET INSTALLED / 5MM OFFSET INCLUDED
COMPONENTS	
HANDLEBARS	PRO THARSIS 3FIVE / 800MM / 35MM
STEM	PRO THARSIS 3FIVE / 50MM / DIRECT MOUNT
GRIPS	ODI ELITE MOTION
SADDLE	SARACEN CUSTOM DH CRMO MTB
SEATPOST	PRO THARSIS / 30.9MM / 350MM
PEDALS	ALLOY MTB / SEALED BEARINGS / REPLACEABLE PINS
DRIVE TRAIN	
SHIFTERS	SHIMANO SAINT SL-M820 / RAPIDFIRE PLUS / 1X10 SPEED
REAR-DERAILLEUR	SHIMANO SAINT M820 SHADOW PLUS / 10 SPEED
CHAIN DEVICE	SHIMANO SAINT SM-CD50 / 36T / ISCG-05
CHAINSET	SHIMANO SAINT FC-M825 36T / 165MM
CHAIN	SHIMANO HG54
CASSETTE	SHIMANO DEORE CS-HG500 / 10 SPEED / 11-25T
BRAKES	SHIMANO M820 203/203MM
BRAKE-LEVERS	SHIMANO M820
WHEELS	
RIMS	DT SWISS FR560 / 32H / 29" FRONT / 27.5" REAR
HUBS	KT BOOST 20 X 110 SEALED BEARINGS 32H FRONT / KT 12 X 157 SEALED BEARING 32H REAR
SPOKES	DOUBLE-BUTTED STAINLESS STEEL
TYRES	ASSEGAI WT / 3C MAXXGRIP / DH / TR / 29 X 2.5 FRONT / 27.5 X 2.5 REAR

FEATURES

- 24T/40T/3K Toray UD carbon blend, CNC custom mullet links, signature TRL suspension design, custom headtube with adjustable front centre plus-minus 5mm, sleeved internal cable routing, integrated fork bump-stops, 12 x 157mm rear axle, 203mm travel
- Shock: Fox DHX2 Factory, LSC HSC LSR HSR Adjust, SLS Spring, 241 x 76
- Fork: Fox 40 Float Factory, Kashima, 203mm travel, HSC LSC HSR LSR adjust, 20TA x110 DH
- Drivetrain: Shimano Saint M820 10 Speed, 11-25T, Shimano Saint chain device
- Brakes: Shimano M820 calipers with M820 Saint levers
- Components: PRO Tharsis 3FIVE bar and direct mount stem, ODI grips, PRO Tharsis seatpost
- Tubeless ready

GEOMETRY

SIZE	MD	LG
SEAT TUBE (MM)	400	400
TOP TUBE (MM)	593	614
REACH (MM)	440	460
STACK (MM)	613	618
HEAD TUBE (MM)	90	95
HEAD ANGLE (°)	63.0	63.0
SEAT ANGLE (°)	76.0	76.0
CHAINSTAY (MM)	445 / 460	445 / 460
BOTTOM BRACKET DROP (MM)	23.0	23.0
WHEELBASE (MM)	1251	1274

The image above is for illustration purposes only. Saracen reserves the right to change spec, colour, features and price without prior warning.

MYST TEAM 29/27.5

EXPLODED DRAWING

SARACEN

 RECOMMENDED THREADLOCK: MEDIUM STRENGTH REMOVABLE ANAEROBIC THREADLOCKER

 RECOMMENDED GREASE: WATERPROOF GREASE (SUCH AS PARK TOOL POLYLUBE)

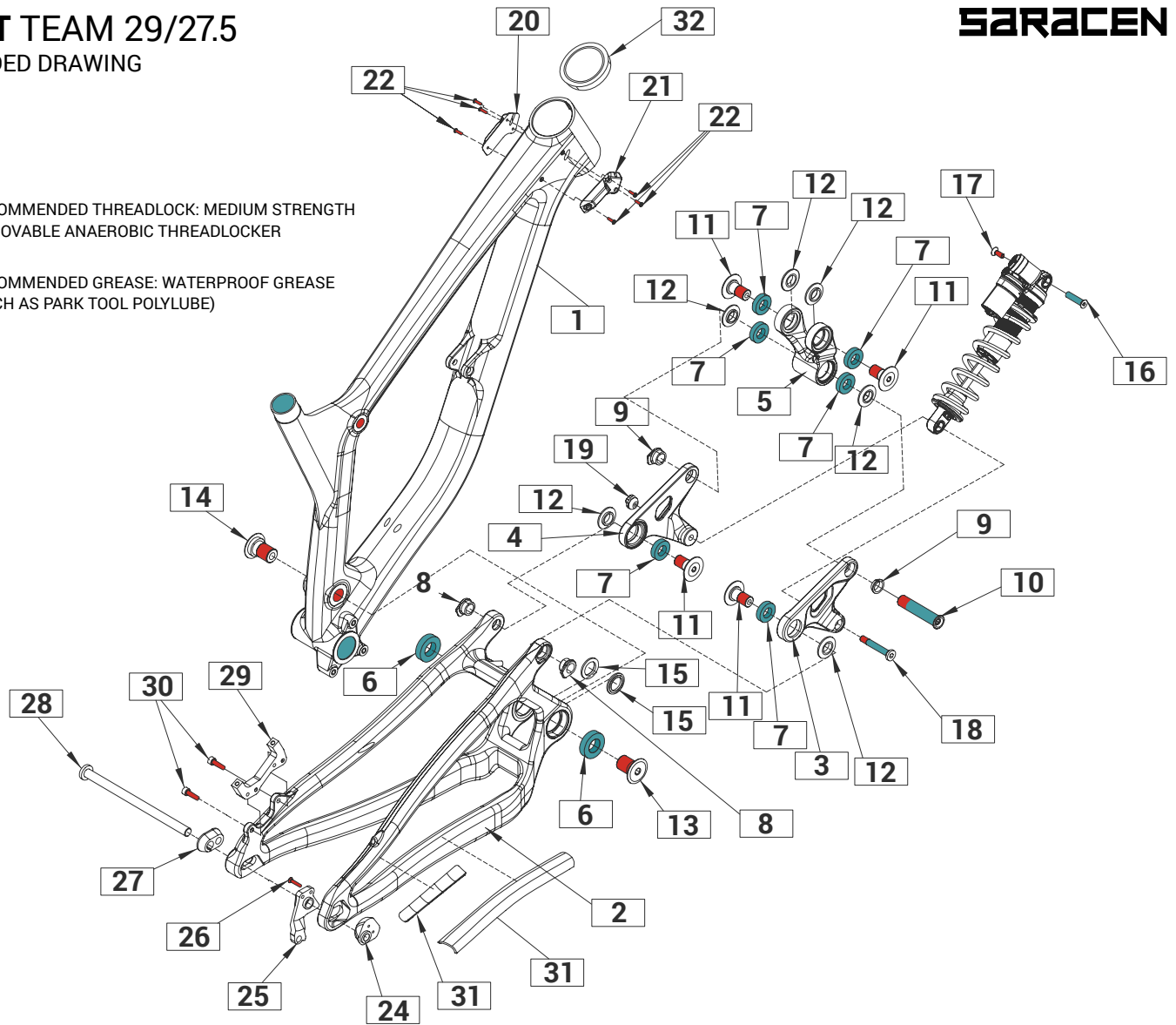

ITEM	PART NUMBER	DESCRIPTION	QTY NEEDED	TORQUE	NOTES
1	N/A	MYST 29 CARBON FRONT TRIANGLE	1	-	-
2	N/A	MYST 27.5 CARBON SWING ARM	1	-	-
3 & 4	RNSPR50022	MYST CARBON MULLET PUSH LINKS (PAIR)	1	-	PART NUMBER INCLUDES ITEM 3 & 4
5	RNS5268	MYST ROCKER LINK 2019 - 2021	1	-	-
6	N/A	MYST MAIN PIVOT BEARINGS 6904.RS	2	-	-
7	N/A	MYST LINKAGE BEARINGS 6902.RS	6	-	-
8	RNS5284	MYST SWING ARM INSERTS (PAIR)	2	-	-
9 & 10	RNS5226	MYST LINKAGE TO LINKAGE BOLT	1	24NM	PART NUMBER INCLUDES ITEM 9 & 10
11 & 12	RNS5225	MYST LINKAGE BOLTS (PAIR)	4	24NM	PART NUMBER INCLUDES ITEM 11 & 12
13 & 14 & 15	RNS5224	MYST MAIN AXLE BOLTS (PAIR)	1	36NM	PART NUMBER INCLUDES ITEM 13 & 14 & 15
16 & 17	RNS5172	MYST UPPER SHOCK BOLT	1	9NM	PART NUMBER INCLUDES ITEM 16 & 17
18 & 19	RNS5231	MYST LOWER SHOCK BOLT	1	15NM	PART NUMBER INCLUDES ITEM 18 & 19
20 & 21 & 22	RNS5232	MYST CARBON FORK BUMPER SET	1	5NM	PART NUMBER INCLUDES ITEM 20 & 21 & 22
24 & 26 & 27	RNS5278	MYST CARBON AXLE TAP / THREAD BLOCK	1	5NM	PART NUMBER INCLUDES ITEM 24 & 26 & 27
25	RNS4051	MYST CARBON HANGER DIRECT MOUNT	1	-	-
25	RNS4052	MYST CARBON HANGER NON-DIRECT MOUNT	1	-	-
28	RNS5277	MYST CARBON WHEEL AXLE	1	15NM	-
29	RNS5283	MYST REAR BRAKE MOUNT 2 POSITION	1	-	-
31	RNS5213	MYST CHAINSTAY PROTECTOR SET	1	-	-
32	RNS5221	MYST CARBON HEADSET 0MM OFFSET	1	-	-
32	RNS5222	MYST CARBON HEADSET 5MM OFFSET	1	-	-

MYST TEAM 29/27.5

TECHNICAL INFORMATION

SARACEN

MODEL	MYST TEAM
FRAME MATERIAL	CARBON
REAR TRAVEL	200MM
SHOCK LENGTH / STROKE	241MM X 76MM
SHOCK SAG	19.5MM
SAG EYE TO EYE	221MM
PIGGY BACK COMPATIBLE	YES
FRAME SHOCK BUSHING	22MM X 8MM
LINKAGE SHOCK BUSHING	22MM X 10MM
RECOMMENDED / MAX FORK LENGTH	601MM/ +20MM
OFFSET	50-58MM
RECOMMENDED / MAX FORK TRAVEL	29": DC 200MM
MAXIMUM TYRE	27.5" X 2.6"
BRAKE MOUNT TYPE	SARACEN MULTI ADAPTER
MAX REAR ROTOR	200MM
SEAT POST	30.9MM
SEAT COLLAR	34.9MM
BOTTOM BRACKET TYPE	BSA83
ISCG	05
CRANK CHAINLINE	SUPER BOOST
MAX CHAIN RING	38T
REAR HUB TYPE	12 X 157



FOX SUSPENSION

SETUP GUIDE

Fox DHX2 / 9.5 x 3.0

RIDER WEIGHT (LBS)	RIDER WEIGHT (KGS)	PRESSURE (PSI)	SAG (%)	SAG (MM)	LSR (CLICKS)	HSR (CLICKS)	LSC (CLICKS)	HSC (CLICKS)
90	41	250	25-30%	19-23MM	12-13	7-8	15-16	7-8
110	50	275	25-30%	19-23MM	11-12	7-8	15-16	7-8
130	59	300	25-30%	19-23MM	10-11	6-7	14-15	6-7
150	68	325	25-30%	19-23MM	9-10	6-7	14-15	6-7
170	77	350	25-30%	19-23MM	8-9	6-7	13-14	6-7
190	86	375	25-30%	19-23MM	7-8	6-7	13-14	6-7
210	95	400	25-30%	19-23MM	6-7	5-6	12-13	5-6
230	104	425	25-30%	19-23MM	6-7	5-6	12-13	5-6

NOTE: ALL CLICKS ARE FROM FULLY CLOSED POSITION

The image above is for illustration purposes only. Saracen reserves the right to change spec, colour, features and price without prior warning.