

MYST PRO 29

£3,799.99 / € 4,499.00

SARACEN



SPECS

FRAME	
SIZES	LG
COLOUR	MST RED
FRAME	24T/40T/3K TORAY UD CARBON BLEND / OPTIMISED FACTORY RACING SIZING / 203MM TRAVEL
FORK	ROCKSHOX BOXXER SELECT RC / 203MM TRAVEL
REAR-SHOCK	FOX DHX COIL
HEADSET	CUSTOM SARACEN HEADSET / 0MM OFFSET INSTALLED
COMPONENTS	
HANDLEBARS	RACEFACE ATLAS 35 / 820MM WIDE / 35MM
STEM	RACEFACE CHESTER 35 / DIRECT MOUNT
GRIPS	ODI ELITE MOTION
SADDLE	SARACEN CUSTOM DH CRMO MTB
SEATPOST	RACEFACE CHESTER / 30.9MM / 325MM
PEDALS	ALLOY MTB / SEALED BEARINGS / REPLACEABLE PINS
DRIVE TRAIN	
SHIFTERS	SHIMANO ZEE M640 RAPIDFIRE PLUS / 1X10 SPEED
REAR-DERAILLEUR	SHIMANO ZEE M640 SHADOW PLUS / 10 SPEED
CHAIN DEVICE	MRP G4 CS
CHAINSET	SHIMANO ZEE FC-M645 36T / 165MM
CHAIN	SHIMANO HG54
CASSETTE	SHIMANO DEORE CS-HG500 / 10 SPEED / 11-25T
BRAKES	SHIMANO M520 203/203MM
BRAKE-LEVERS	SHIMANO MT501
WHEELS	
RIMS	RACEFACE ARC / 32H / 29"
HUBS	FORMULA BOOST 20 X 110 SEALED BEARING 32H FRONT / KT 12 X 157 SEALED BEARING 32H REAR
SPOKES	DOUBLE-BUTTED STAINLESS STEEL
TYRES	MAXXIS DHR11 / MAXXGRIP / DH / TR / 29 X 2.4

FEATURES

- 24T/40T/3K Toray UD carbon blend, UD Carbon linkage, signature TRL suspension design, custom headtube with adjustable front centre plus-minus 5mm, sleeved internal cable routing, integrated fork bump-stops, 12 x 157mm rear axle, 203mm travel
- Shock: Fox DHX Coil, LSC, Rebound Adjust, 241 x 76
- Fork: Rockshox BoXXer Select RC, 203mm travel, DebonAir, 20 x 110, Maxle Stealth DH
- Drivetrain: Shimano Zee M640 10 Speed, 11-25T, MRP G4 CS chain device
- Brakes: Shimano M520 calipers with MT501 levers
- Components: Raceface Chester 35 bar and direct mount stem, ODI grips, Raceface seatpost
- Tubeless ready

GEOMETRY

SIZE	LG
SEAT TUBE (MM)	400
TOP TUBE (MM)	614
REACH (MM)	460
STACK (MM)	618
HEAD TUBE (MM)	95
HEAD ANGLE (°)	63.0
SEAT ANGLE (°)	76.0
CHAINSTAY (MM)	445 / 460
BOTTOM BRACKET DROP (MM)	23.0
WHEELBASE (MM)	1274

The image above is for illustration purposes only. Saracen reserves the right to change spec, colour, features and price without prior warning.

MYST PRO 29

EXPLODED DRAWING

SARACEN

 RECOMMENDED THREADLOCK: MEDIUM STRENGTH REMOVABLE ANAEROBIC THREADLOCKER

 RECOMMENDED GREASE: WATERPROOF GREASE (SUCH AS PARK TOOL POLYLUBE)

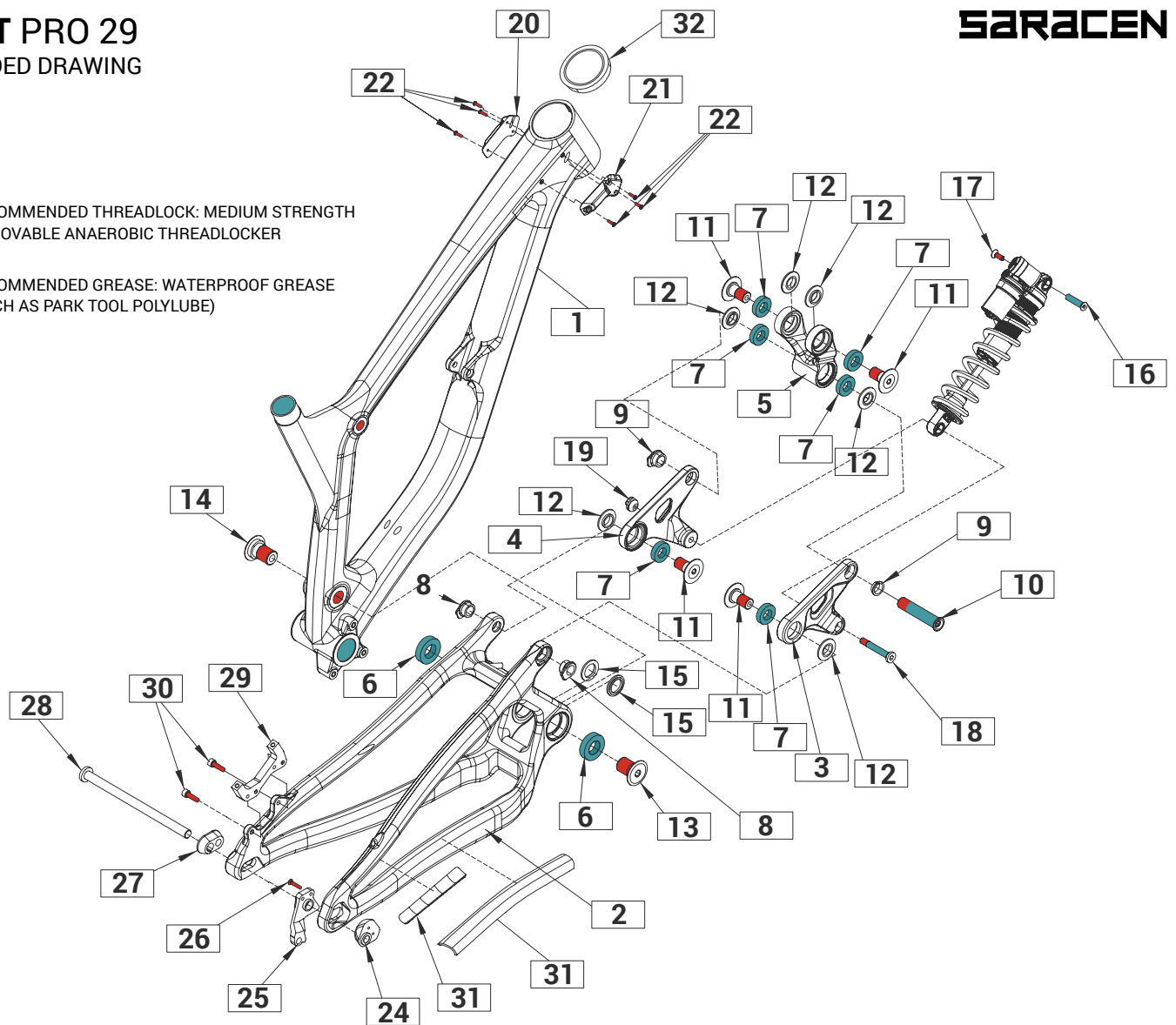

ITEM	PART NUMBER	DESCRIPTION	QTY NEEDED	TORQUE	NOTES
1	N/A	MYST 29 CARBON FRONT TRIANGLE	1	-	-
2	N/A	MYST 29 CARBON SWING ARM	1	-	-
3 & 4	RNS5280	MYST CARBON PUSH LINKS (PAIR)	1	-	PART NUMBER INCLUDES ITEM 3 & 4
5	RNS5268	MYST ROCKER LINK 2019 - 2021	1	-	-
6	N/A	MYST MAIN PIVOT BEARINGS 6904.RS	2	-	-
7	N/A	MYST LINKAGE BEARINGS 6902.RS	6	-	-
8	RNS5284	MYST SWING ARM INSERTS (PAIR)	2	-	-
9 & 10	RNS5226	MYST LINKAGE TO LINKAGE BOLT	1	24NM	PART NUMBER INCLUDES ITEM 9 & 10
11 & 12	RNS5225	MYST LINKAGE BOLTS (PAIR)	4	24NM	PART NUMBER INCLUDES ITEM 11 & 12
13 & 14 & 15	RNS5224	MYST MAIN AXLE BOLTS (PAIR)	1	36NM	PART NUMBER INCLUDES ITEM 13 & 14 & 15
16 & 17	RNS5172	MYST UPPER SHOCK BOLT	1	9NM	PART NUMBER INCLUDES ITEM 16 & 17
18 & 19	RNS5231	MYST LOWER SHOCK BOLT	1	15NM	PART NUMBER INCLUDES ITEM 18 & 19
20 & 21 & 22	RNS5232	MYST CARBON FORK BUMPER SET	1	5NM	PART NUMBER INCLUDES ITEM 20 & 21 & 22
24 & 26 & 27	RNS5278	MYST CARBON AXLE TAP / THREAD BLOCK	1	5NM	PART NUMBER INCLUDES ITEM 24 & 26 & 27
25	RNS4051	MYST CARBON HANGER DIRECT MOUNT	1	-	-
25	RNS4052	MYST CARBON HANGER NON-DIRECT MOUNT	1	-	-
28	RNS5277	MYST CARBON WHEEL AXLE	1	15NM	-
29	RNS5283	MYST REAR BRAKE MOUNT 2 POSITION	1	-	-
31	RNS5213	MYST CHAINSTAY PROTECTOR SET	1	-	-
32	RNS5221	MYST CARBON HEADSET 0MM OFFSET	1	-	-
32	RNS5222	MYST CARBON HEADSET 5MM OFFSET	1	-	-

MYST PRO 29

TECHNICAL INFORMATION

SARACEN

MODEL	MYST PRO
FRAME MATERIAL	CARBON
REAR TRAVEL	200 MM
SHOCK LENGTH / STROKE	241MM X 76MM
SHOCK SAG	19.5MM
SAG EYE TO EYE	221MM
PIGGY BACK COMPATIBLE	YES
FRAME SHOCK BUSHING	22MM X 8MM
LINKAGE SHOCK BUSHING	22MM X 10MM
RECOMMENDED / MAX FORK LENGTH	601MM / +20MM
OFFSET	50-58MM
RECOMMENDED / MAX FORK TRAVEL	29": DC 200MM
MAXIMUM TYRE	29" X 2.6"
BRAKE MOUNT TYPE	SARACEN MULTI ADAPTER
MAX REAR ROTOR	200MM
SEAT POST	30.9MM
SEAT COLLAR	34.9MM
BOTTOM BRACKET TYPE	BSA83
ISCG	05
CRANK CHAINLINE	SUPER BOOST
MAX CHAIN RING	38T
REAR HUB TYPE	12 X 157



FOX SUSPENSION

SETUP GUIDE

Fox DHX / 9.5 x 3.0

RIDER WEIGHT (LBS)	RIDER WEIGHT (KGS)	PRESSURE (PSI)	SAG (%)	SAG (MM)	LSR (CLICKS)	LSC (CLICKS)
90	41	250	25-30%	19-23MM	12-13	15-16
110	50	275	25-30%	19-23MM	11-12	15-16
130	59	300	25-30%	19-23MM	10-11	14-15
150	68	325	25-30%	19-23MM	9-10	14-15
170	77	350	25-30%	19-23MM	8-9	13-14
190	86	375	25-30%	19-23MM	7-8	13-14
210	95	400	25-30%	19-23MM	6-7	12-13
230	104	425	25-30%	19-23MM	6-7	12-13

NOTE: ALL CLICKS ARE FROM FULLY CLOSED POSITION

The image above is for illustration purposes only. Saracen reserves the right to change spec, colour, features and price without prior warning.