

ASSEMBLY INSTRUCTION

ITEM NO: 196H5099-17

BOOKSHELF (3A)

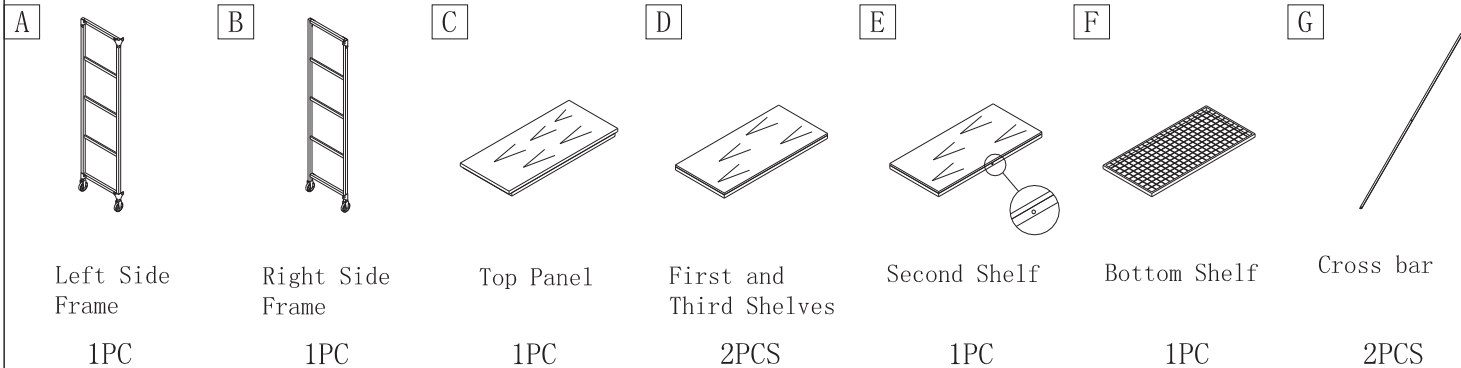

HARDARE LIST				
H		Bolt with Lock Washer and Flat Washer	1/4"X15mm	5pcs
I		Flat Head Bolt	1/4"X25mm	20pcs
J		L-Allen Key	4mm	1pc
K		Furniture Tipping Restraint		1pc

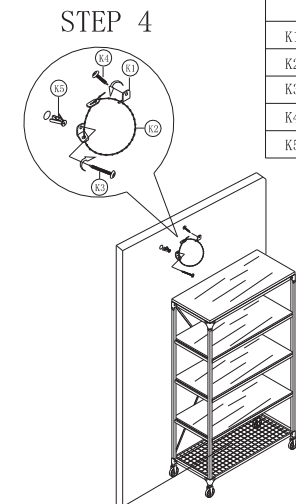
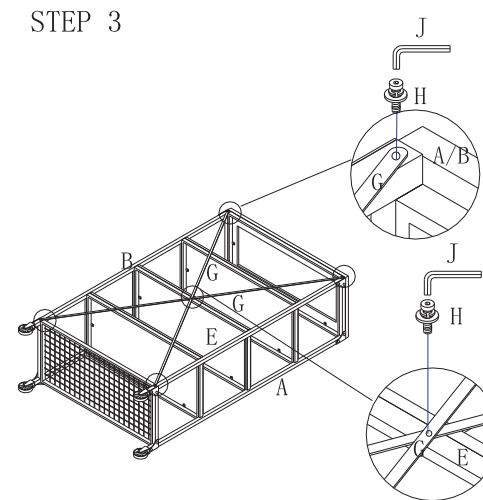
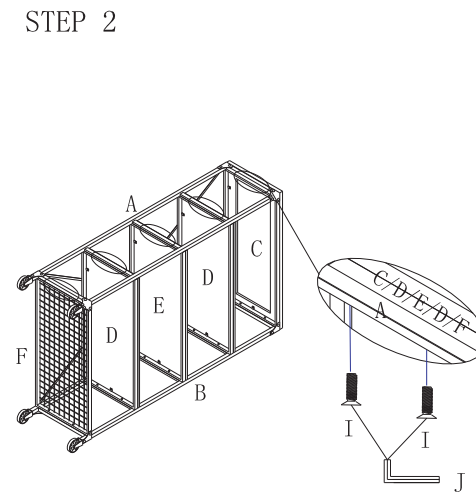
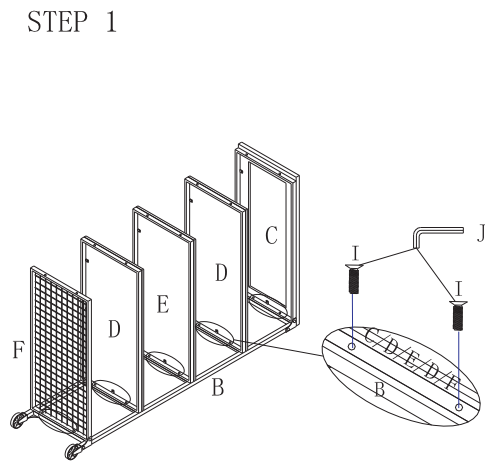

ANTI-TIPPING HARDWARE PACK			
K1	Bracket/Equerre		2PCS
K2	Tie wrap		1PC
K3	Long Screw		1PC
K4	Short Screw		1PC
K5	Corner pad		1PC

- (1) Place the right side frame on a smooth and even surface, attach all the shelves to the side frame and insert the bolts, do not fully tighten it.
- (2) Attach left side frame to the assembled right side frame, insert the bolts, do not fully tighten it.
- (3) Face down the assembled bookshelf, attach the cross bars to the rear of the unit, insert bolts and washers, tighten all the bolts with Allen Key.
- (4) Upright the bookshelf and adjust the bookshelf position against the wall, install the anti-tipping restrain to the unit.