

ASSEMBLY INSTRUCTION

Queen Headboard/King headboard

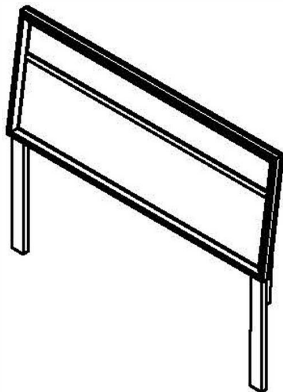

Thank you for purchasing this product. Please take time to read and follow the instructions below. Check that you have all parts and hardware before assembly. Parts apparently missing are often found in the packing materials. If you do not have all the parts listed, have your dealer contact us and they will be sent to you immediately.



It is recommended to install protective pads under all legs and support to avoid damage or scratches when placing furniture on a wood floor or other hard surface, and to limit indentation and prevent discoloration if placing on carpet.



Hardware may loosen over time. Periodically check to make sure all connections are tight. Retighten if necessary.

191B1444-1/191B1444K-1 PART LIST				HARDWARE LIST				
No	Sketch	Description	Quantity	No	Description	Size	Sketch	Quantity
A		Headboard	1	1	Allen Key	M4 x 60mm		1
B(L)		LSF Headboard Leg	1	2	Connection Bolt	M6-1.0 x 45mm		8
			-JCBC Bolt		Ø1/4" x 7/32" x 7/16" x 0.06"			
			-Spring Washer		Ø1/4" x 1/4" x 3/4" x 0.04"			
C(R)		RSF Headboard Leg	1	* ABOVE HARDWARE ARE PACKED IN 191B1444/K-1 FOR ASSEMBLY				

STEP 1

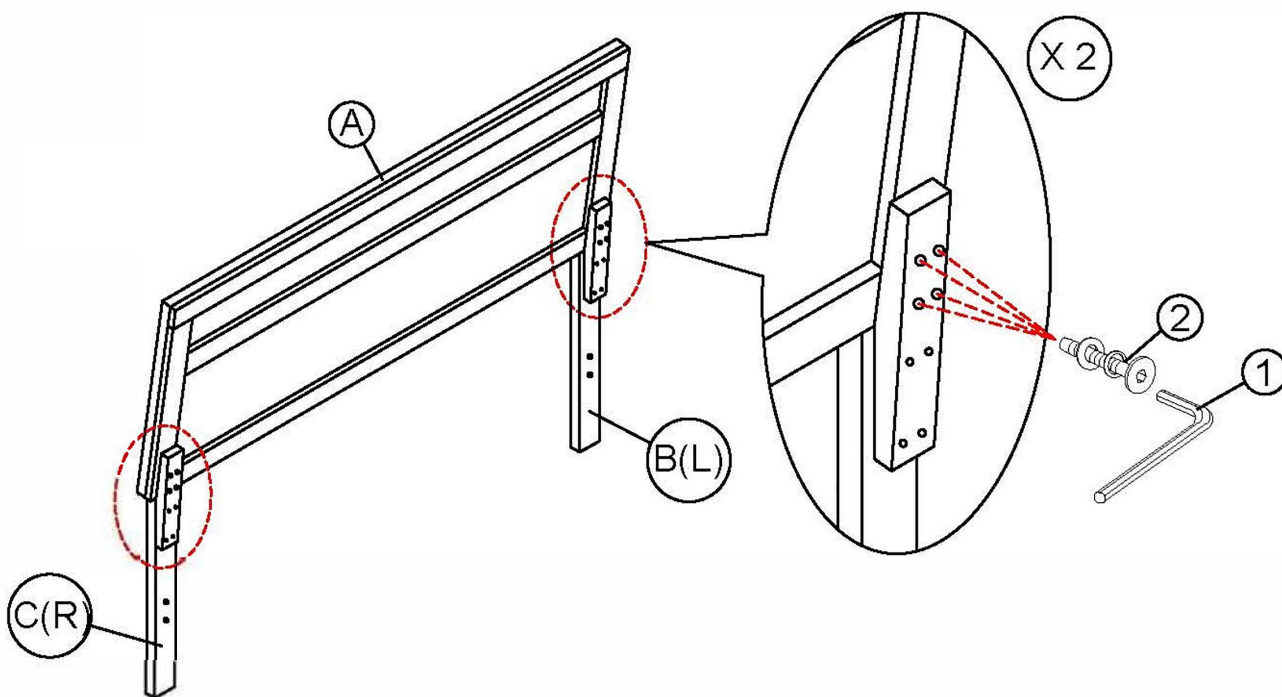

ASSEMBLY INSTRUCTION

Queen/ King Headboard

Queen/ King Footboard & Slats+ Support Legs

Queen / EK Side Rails

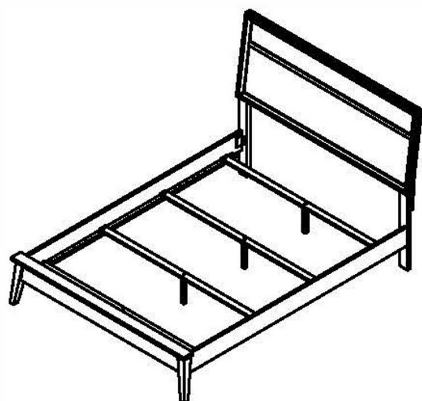

Thank you for purchasing this product. Please take time to read and follow the instructions below. Check that you have all parts and hardware before assembly. Parts apparently missing are often found in the packing materials. If you do not have all the parts listed, have your dealer contact us and they will be sent to you immediately.



It is recommended to install protective pads under all legs and support to avoid damage or scratches when placing furniture on a wood floor or other hard surface, and to limit indentation and prevent discoloration if placing on carpet.



Hardware may loosen over time. Periodically check to make sure all connections are tight. Re-tighten if necessary.

191B1444-1/191B1444K-1 PART LIST				HARDWARE LIST				
No	Sketch	Description	Quantity	No	Description	Size	Sketch	Quantity
A		Headboard	1	1	Allen Key	M4 x 60mm		1
191B1444-2/191B1444K-2 PART LIST				2	Connection Bolt -JCBC Bolt -Spring Washer -Flat Washer	M6-1.0 x 45mm Ø1/4" x 7/32" x 7/16" x 0.06" Ø1/4" x 1/4" x 3/4" x 0.04"		8
B		Footboard	1	3	Wood Dowel	M10 x 30mm		8
C		Queen Slat	4	4	Screw	M4 x 32mm		8
		EK Slat						
D		Queen Support Leg	4	* ABOVE HARDWARE ARE PACKED IN 191B1444-3 FOR ASSEMBLY				
		EK Support Leg	8					
191B1444-3 PART LIST								
No	Sketch	Description	Quantity					
E(L)		LSF Side Rail	1					
F(R)		RSF Side Rail	1					

STEP 1

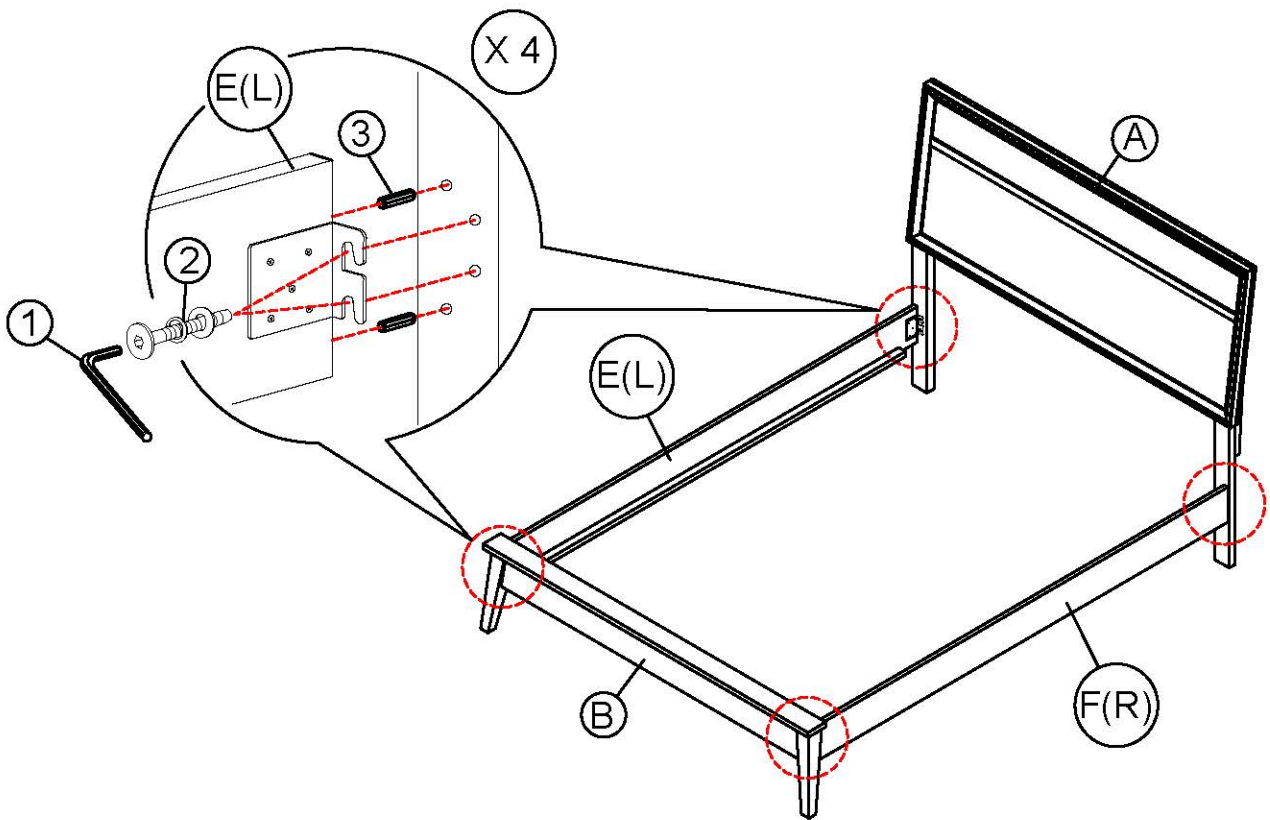

STEP 2

QUEEN BED ASSEMBLY

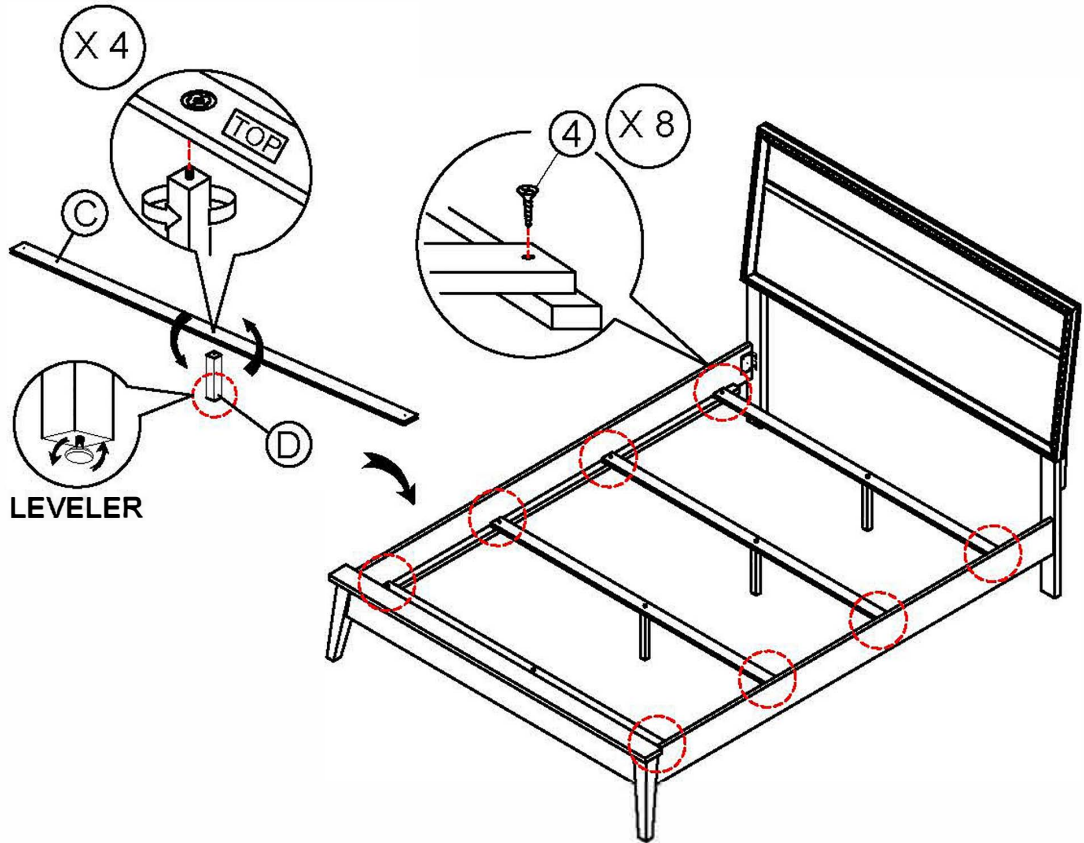

STEP 2

KING BED ASSEMBLY

