

● ●
TW STEEL



DAKAR EDITIONS

TW STEEL

TW Steel is a watch brand harmoniously combining both design and innovation. 'The Watch in Steel' leads the oversized market with style and quality guaranteed.

TW Steel values the most important relationship of all – the one with the consumer. To express this, we hereby give you all the information that you need to enjoy your TW Steel watch to the fullest.

MAINTENANCE

TW Steel uses the best materials and carries out strict controls before the watch leaves the factory. The way in which you wear or treat your TW Steel will determine whether the appearance of the watch is maintained in the future, or whether it will deteriorate. In order to enjoy wearing your TW Steel as long as possible, we include a number of tips: If the watch comes into contact with hard or corrosive materials, this can cause damage, which, if it occurs regularly, will become clearly visible in the form of scratches.

Your watch should be cleaned with a soft cotton cloth that is not impregnated with any cleaning material. Absolutely no cleaning materials should be used. It is advisable to regularly polish your watch with a soft cotton cloth. The watch is a precision mechanical instrument and should be treated as such. Adjusting the time or date, opening or closing the crown or crowncap, should not be done roughly, but carefully.

USE OF THE CROWN

To adjust the time or set the date, unscrew the crown by turning it anti-clockwise. After adjusting, screw the crown cap back by turning it clockwise.

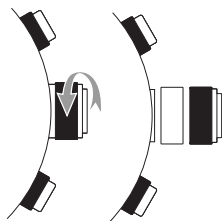

ADJUSTING THE TIME

Pull the crown out to the 2nd position. Turn the crown to set the hour and minute hands. After the time has been set, push the crown back to its normal position.

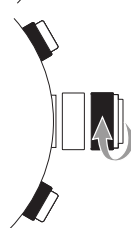

ADJUSTING THE DATE

Pull the crown out to the 1st position. Turn the crown clockwise to set the date. After the date has been set, push the crown back to its normal position.



USING THE CHRONOGRAPH

The chronograph is able to measure and display the time accurately to 1/20th of a second, up to a maximum of 59 minutes and 59 seconds. The chronograph can be started and stopped at any time by pressing button A. Pressing button B resets the chronograph. All hands will then return to their (0) position. If the chronograph second hand does not return to the (0) position after the chronograph has been reset or after the battery has been replaced, you should do the following. Pull the crown out to the 2nd position.

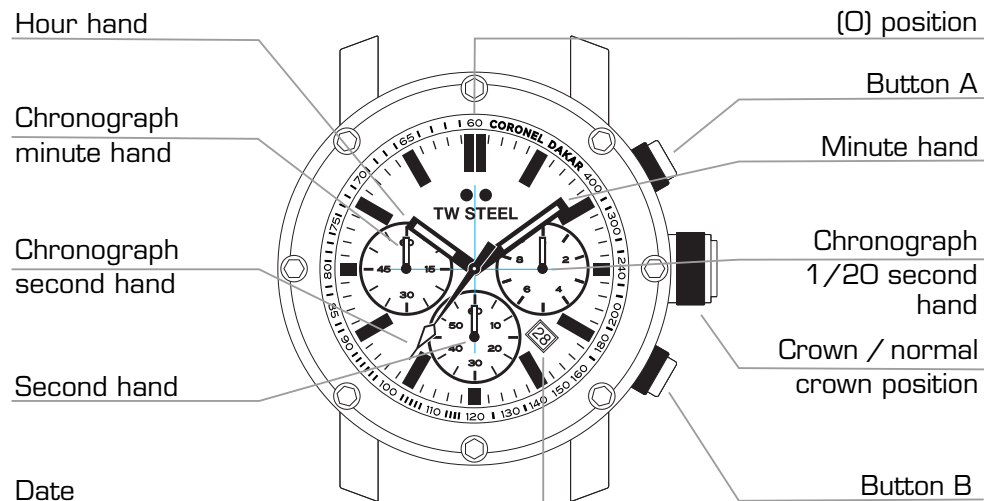

Press button A to set the chronograph second hand to the (0) position. The chronograph second hands can be advanced rapidly by continuously pressing button A. Once the hand has returned to the (0) position, return the crown to its normal position and screw the crown cap clockwise back to the case.

CAUTION : IF THE CROWN IS NOT PRESSED IN PROPERLY, THE WATCH IS NO LONGER WATERPROOF AND THE MOVEMENT CAN BE SERIOUSLY DAMAGED!