

# REFRIGERATED CHEF BASES

With Drip Edge Top, 115V/60HZ



SKRCB38H-RD (SHOWN)

Silver King® is the leader in reliable and energy efficient refrigeration solutions. Our sleek, stainless steel refrigeration equipment is made with the highest quality materials to guarantee everything is kept fresh and meets temperature standards. Our equipment has polyurethane insulation for maximum strength and durability, and minimal energy waste.

## MODELS

<b>SKRCB38H-RD</b>	<b>38" Refrigerated Storage Stand</b>	<b>12" x 20" Pan Capacity—4</b>
<b>SKRCB50H-RD</b>	<b>50" Refrigerated Storage Stand</b>	<b>12" x 20" Pan Capacity—6</b>
<b>SKRCB60H-RD</b>	<b>60" Refrigerated Storage Stand</b>	<b>12" x 20" Pan Capacity—6</b>
<b>SKRCB79H-RD</b>	<b>79" Refrigerated Storage Stand</b>	<b>12" x 20" Pan Capacity—10</b>
<b>SKRCB84H-RD</b>	<b>84" Refrigerated Storage Stand</b>	<b>12" x 20" Pan Capacity—10</b>

---

## Standard Features

- Exterior stainless steel with galvanized back and bottom reduces risk of corrosion.
- Interior aluminum, with coved corners and finished edges for easy cleaning.
- Environmentally friendly polyurethane foamed-in-place insulation for maximum strength and durability.
- Full extension drawers. This premier slide and framework construction promotes lateral stability while offering high dynamic load capacities and a stay-shut feature. All drawers accommodate full size 12" x 20" x 6" deep hotel pans and deep fractional pans. Drawers lift out for cleaning.
- Supplied with 7 foot 3 wire power cord standard.
- Santoprene™ gaskets last four times longer than the industry standard.
- CFC-free refrigerant, hermetically sealed, high efficiency, self contained refrigeration system with automatic defrost and forced air circulation.
- Casters supplied are heavy-duty, secured to a 12 gauge steel base to ensure years of worry free operation.
- Limited Warranty: 1-year labor, 1-year parts, 5-year compressor (part only), 90-days replacement parts. Warranty is determined by the original equipment manufacturing date for general market.\*

## Dimensions

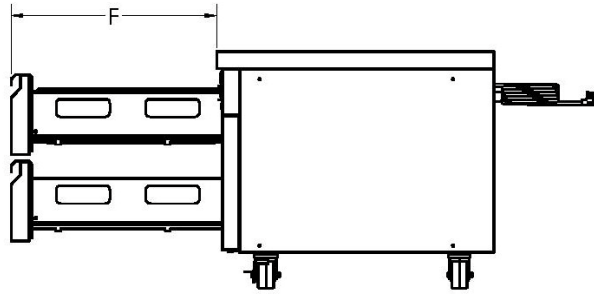
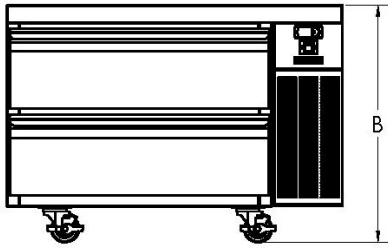
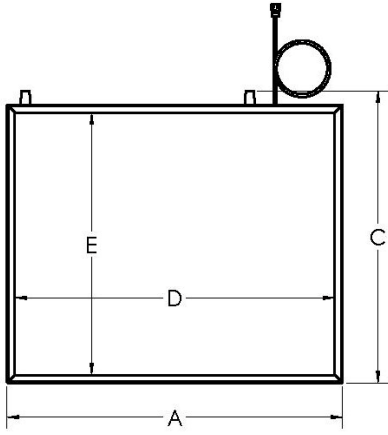

Model Number	Width "A" in (mm)	Height "B" in (mm)	Depth "C" in (mm)	Width "D" in (mm)	Depth "E" in (mm)	Depth "F" in (mm)
SKRCB38H-RD	37.49 (952.35)	26.47 (672.42)	32.58 (827.53)	35.74 (907.87)	29.25 (742.92)	22.97 (583.45)
SKRCB50H-RD	50.25 (1276.35)	26.47 (672.42)	32.58 (827.53)	48.50 (1231.87)	29.25 (742.92)	22.97 (583.45)
SKRCB60H-RD	60.50 (1536.69)	26.47 (672.42)	32.58 (827.53)	58.74 (1492.10)	29.25 (742.92)	22.97 (583.45)
SKRCB79H-RD	79.50 (2019.30)	26.47 (672.42)	32.58 (827.53)	77.74 (1974.51)	29.25 (742.92)	22.97 (583.45)
SKRCB84H-RD	84 (2133.60)	26.47 (672.42)	32.58 (827.53)	82.24 (2088.81)	29.25 (742.92)	22.97 (583.45)

## Specifications

Model Number	Country of Origin	Amps	Voltage	Hz	Plug	Refrigerant	Gross Shipping Weight lb (kg)	Shipping cu ft (cu m)
SKRCB38H-RD	USA	2.5	115 VAC	60	NEMA 5-15P	134a	285 (129.28)	27.77
SKRCB50H-RD	USA	3.0	115 VAC	60	NEMA 5-15P	134a	345 (156.49)	34.38
SKRCB60H-RD	USA	3.0	115 VAC	60	NEMA 5-15P	134a	395 (179.17)	41.25
SKRCB79H-RD	USA	3.1	115 VAC	60	NEMA 5-15P	134a	515 (233.60)	54.90
SKRCB84H-RD	USA	3.1	115 VAC	60	NEMA 5-15P	134a	565 (256.28)	57.48

## Certifications

