

Welcome to the qarbo-nation!

Firstly, thank you for choosing the **qarbo** Sparkling Water Maker and Fruit Infuser by *Twenty 39*.

Twenty 39 was founded on the belief that the choices we make today, directly influence our future-selves and the future of the planet. We believe that healthier and more sustainable alternatives should not compromise on quality.

We're proud of **qarbo** as it fits well with what we believe and value. **qarbo** enables you not only to sparkle just about anything, infusing amazing flavors straight in the bottle, it dramatically reduces single use plastic bottles. We hope you will love it as much as we do!

Before you begin...

qarbo is as simple to operate as it is stylishly gorgeous. However, as with any appliance, particularly one involving high pressure gas, it is important to use the product as it was intended. So please take some time to read these use and care instructions. It won't take long, and you can access some delicious recipes at the end to get your creative juices flowing.



qarbo Sparkling Water Maker & Fruit Infuser User Guide



Twenty-39.com
Twenty39.com.au
Twenty39.co.nz



One more thing...

Unfortunately due to air freight regulations related to air pressure and safety, we are unable to ship a CO² cylinder with this product. The **qarbo** Sparkling Water Maker is compatible with major brands (eg. Sodastream) 60L CO² cylinders which are readily available and most importantly refillable from many local and online retailers. Another important way to reduce impact on the planet.

What's In The Box?



qarbo Main Unit
+ 1 litre Bottle
+ Injection Cap

Second
1 litre Bottle
+ Cap

Attaching the CO² gas cylinder

Step 1

Remove the dust-proof cap from the CO² cylinder and unscrew the **qarbo Injector Head** from the **Main Body**.

Hold the **Injector Head** in one hand, and with the other hand, screw the cylinder clock-wise (righty-tighty) into the thread within the **Injector Head** till 'hand' tightened.

Be careful not to cross-thread the plastic fitting by screwing it in on an angle.

NOTE: If the cylinder isn't screwed in tightly, this may inhibit gas flow so simply come back and tighten further.

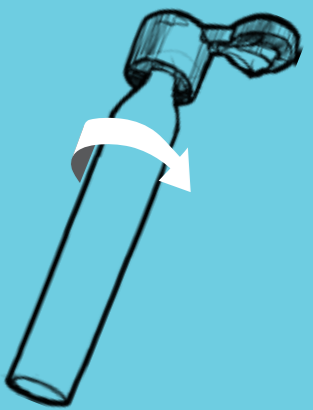

What do all of these pieces do?

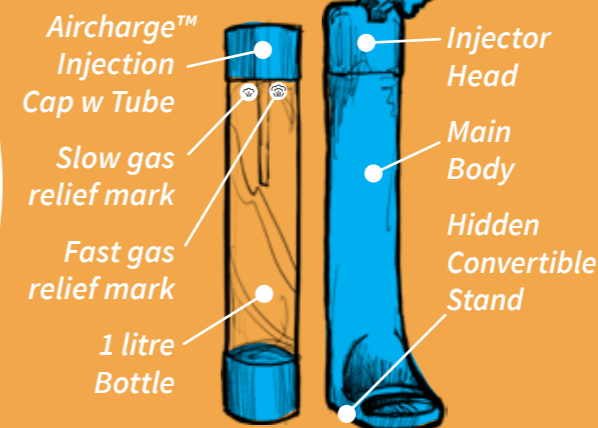

Step 2

Insert the cylinder into the **Main Body** with the **Injector Head** facing to the right. Then turn it clock-wise a few degrees to fasten the **Injector Head** to the main body.

There you go simple, now you're ready to carbonate!

Let's get carbonating!

Step 1

Fill the BPA-free bottle with cold drinking water unto the 800ml mark, then fasten the **Aircharge™ Injector Cap** (the cap with the injector tube) and put the bottle onto the **qarbo** Main Unit.

The colder the water the better it absorbs CO² - trust us it's science! We recommend keeping your bottle full of water in the fridge.



Step 2

If you are planning to add your favorite fruit, syrups or juice to the bottle, now is the time. Use the measurement gradients on the bottle to ensure perfect ratios, every time.

And remember...it is important not to overfill the bottle. Never fill beyond the 800ml mark.

carbonating

Step 3

In order to achieve maximum CO² gas efficiency, press the lever for 1 to 2 seconds to infuse CO² each time for a maximum of 2-3 times in total.

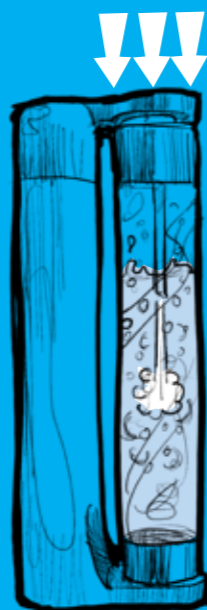

Do it a few times and you'll be able to judge how much carbonation you prefer.

Step 4

When you've carbonated your drink, lift the bottle out of the **qarbo** main body and gently tip upside down 2 to 3 times.

This will allow the CO² to better infuse into the water.

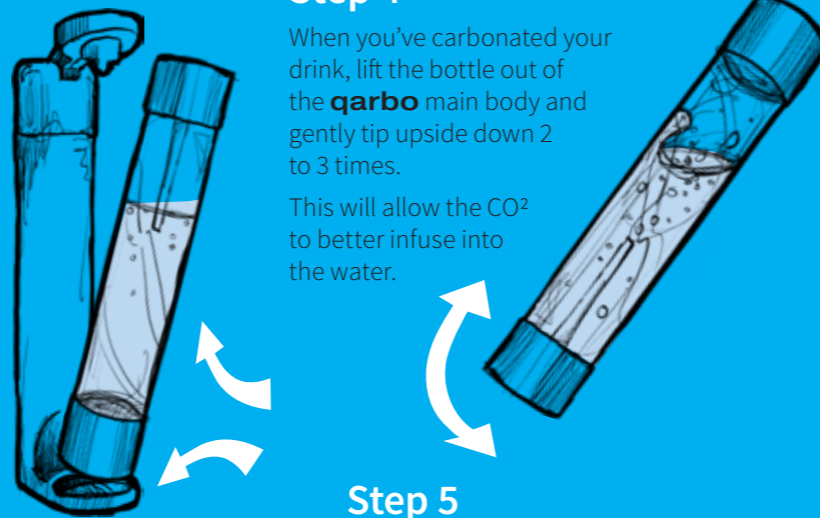

Step 5

To avoid 'soda eruptions', just turn the **Aircharge™ Injector Cap** counter-clockwise until it reaches the **SLOW Gas Relief Mark** or continue on to the **FAST Gas Relief Mark**. Once the gas has been released you are safe to open the bottle.

How long this will take at each mark will depend on the sugar content of your drink and the amount of CO². It won't take you long to get the hang of it.

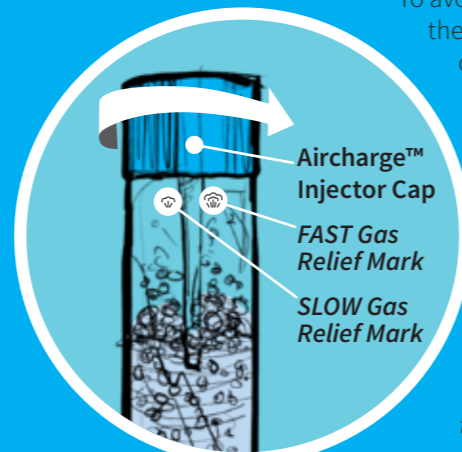

Here are a few tips depending on what you have in the bottle.

Liquid in the bottle	Suggested operation
Water, with or without added fruit	Slowly turn the Cap to the Slow release position, then to the Fast release position.
Alcohol, juice, syrup mixed drinks	After gas injection, wait for the level inside to get down to the 800ml mark, then slowly unscrew the cap by 15°; If the liquid level drops back to the 800ml mark, continue to slowly unscrew the Cap until the gas is fully released; If the liquid level does not go down after turning by 15°, close the Cap until the liquid level drops to the 800ml mark and repeat the above operation.

This all might sound too complicated but it will become second nature in no time. If you get this wrong, you'll simply have some overflow when you open the bottle. So not a complete disaster!

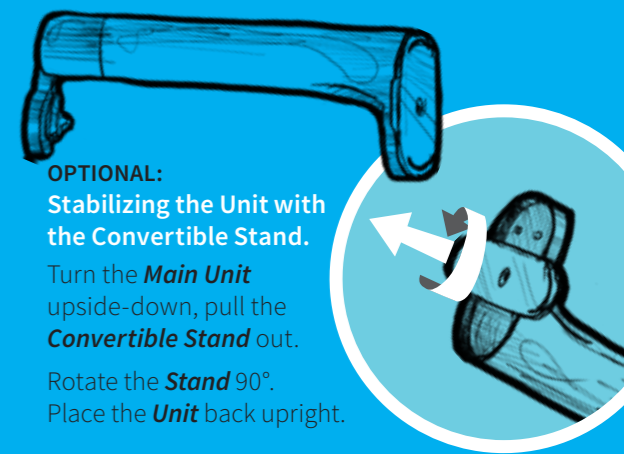

OPTIONAL: Stabilizing the Unit with the Convertible Stand.

Turn the **Main Unit** upside-down, pull the **Convertible Stand** out.

Rotate the **Stand** 90°. Place the **Unit** back upright.

Finally!

Unscrew the **Injector Cap**, and your perfect sparkling drink is ready.



Be creative and have fun with it.

If you're stuck for ideas, there're a few simple starter recipes overleaf.

Please Turn Over

Enjoy!

Healthier Choices

Infused Water Recipes

Subtle fruity goodness.



Detox with these delicious infused water recipes. These delicious fruit and herb combinations will encourage you and your families to drink more water & stay healthy.

For all recipes, add your ingredients to the qarbo bottle and fill with cold water for best results. Don't be tempted to add ice, as this will reduce CO² absorption.

Blackberry, Orange and Ginger
 1/3 cup blackberries
 1/2 orange - sliced
 1 inch piece of ginger - peeled and sliced

Grapefruit, Pomegranate and Mint
 Grapefruit slices
 1/4 cup pomegranate seeds
 Mint leaves

Mango, Raspberry and Ginger
 Mango pieces
 1/2 cup of raspberries
 1 inch piece of ginger - peeled and sliced



Watermelon, Kiwifruit and Lime
 1/3 cup watermelon - cut into cubes
 Kiwifruit diced
 1/2 Lime - sliced

These recipes are only just the beginning. We've got some real flavorful and downright delicious fizzy drink recipes, that you can make at home.

Scan this QR CODE, register your new qarbo Sparkling Water Maker & Fruit Infuser and we'll send them to you.

Customer Service

Please email us at:
qarbosupport@twenty-39.com
qarbosupport@twenty39.com.au

PRODUCT REGISTRATION

for extended warranty, recipes & offers.

Why should you register? For one, you'll receive our best-in-industry, EXTENDED warranty. You'll also get to be part of our New Product Tester program. And a qarbo eBook with some really great soda and drink recipes for the whole family. Yep, even ones just for grown ups.



Register for EXTENDED Warranty & FREE Recipe eBook.



How to get the best results

4°C
40°F

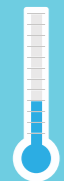

ATTENTION

The colder the water the better it absorbs CO²—trust us it's science! We recommend keeping a bottle full of water in the fridge.



Notes

Water or other liquids used in the qarbo bottle should be around 4°C or 40°F, the colder the better to improve your taste experience. Obviously frozen liquid won't work and don't add ice until after you've carbonated as ice and CO² don't get along!

Syrup or juice can be added into the bottle to make delicious flavored soda drinks.

When you mix syrup, juice or alcohol with solids (e.g. fruit segments) or a liquid with high viscosity and acidity, be prepared for plenty of bubbles when carbonating; the bubbles may overflow when you release the pressure during **Step 5** of the carbonation process. We recommend following the instructions in **Step 5** to minimise the chance of your delicious beverage overflowing onto your benchtop!

If you've filled the bottle with maximum pressure during carbonation, the lever may bounce back; it is normal to have some gas release from the lever when the bottle is full. This is a sign that you need to stop pressing the lever as your drink has reached maximum carbonation.

When you hear a whistling sound coming from the unit, this also means that you have reached maximum carbonation; it's definitely time to stop pressing the lever.

When carbonating, if there is no gas visibly coming out of the tube or if the gas jet doesn't reach the bottom of the bottle, this is likely to mean that the gas cylinder is running out of gas and you need a new one. If the cylinder is new or recently refilled, ensure that the cylinder is firmly tightened onto the Injector Head.

How to care for your sparkling water maker

qarbo Sparkling Water Maker

Wipe with a microfibre cloth and water. Use some mild detergent if necessary. Do not use any solvent or abrasive detergent which may corrode the surface.

qarbo Aircharge™ Injector Cap & Tube

The **Injection Cap and Tube** must be washed after every use to avoid the risk of sugar or impurities blocking or corroding the plastic parts.

Soak the cap into water at ambient temperature between 20°-30°C (68°-86°F) for at least 3 minutes. The cap must be covered completely by water (or pure soda water for a better result). Dry the cap after soaking.

qarbo Bottle and Cap

Wash the bottle with clean water and drip dry each time after use.

HAND WASH ONLY The qarbo bottle must not be put into the dishwasher to wash.

Use water (no more than 40°C or 104°F) and mild detergent.

If you are not going to use the bottle in the short term, please keep the cap open to allow the interior to dry completely. The ambient temperature for the bottle must be no more than 40°C or 104°F.



PRODUCT WARRANTY

The qarbo Sparkling Water Maker is designed to have minimal points of failure, so we are confident you will have years of trouble-free use. However, if the qarbo Sparkling Water Maker malfunctions within 12 months (unless you're signed up to our free EXTENDED warranty or according to specific country laws) from the date of purchase, we will replace the product if it was determined the malfunction was due to faulty workmanship or materials.



PRODUCT DISPOSAL

The packing material is recyclable: please return the packing material to the recycling center for the purpose of environmental protection. If you want to dispose of the device, please choose an environmentally friendly way. Please contact your local authority for more detailed recycling information.

Please dispose of the PET Bottle after two years of use (or after two years from date of manufacture - marked on every Bottle) by sending it to a recycling center or proper classification garbage bin. It is 100% recyclable.

Twenty-39.com (US/Rest of World)
Twenty39.com.au (AU)
Twenty39.co.nz (NZ)



SAFETY INSTRUCTIONS

If you find any damage and defect with your qarbo Sparkling Water Maker and its accessories (e.g. bottle etc.), please contact our customer service. Do not use the product or the related accessories if the damage or defect has not been repaired.

Please do not adjust or repair this product or its accessories on your own. The repair must only be done by service personnel under our full authorization. Only use the original accessories provided or recommended by us, or you'll void your warranty.

Warning: It is strictly prohibited to use and store this product at high temperature. Please note that the operation and storage temperature of this product is between 4°- 40°C (40°-104°F). Only use commercially approved carbon dioxide cylinders, otherwise there is risk of air leakage and cold injury. **Warning:** It is prohibited to transform or disassemble the product by an unauthorized party. If maintenance is needed, please contact our after-sales service, and our professional technicians will be able to help. **Warning:** Inflating the PET Bottle which has no water is strictly prohibited.

Use of CO² Gas Cylinder: Please do not put it near any heat source (such as stove, water heater etc.). Keep out of direct sunlight.

Please do not ship qarbo Sparkling Water Maker with the gas cylinder installed in the machine. They must be shipped separately. If the temperature of the gas cylinder is lower than room temperature, please warm it up to room temperature slowly. Do not accelerate temperature with any heat source. If the temperature of the gas cylinder is higher than room temperature, please cool it down to room temperature slowly. Do not put it in the refrigerator.

If the gas cylinder is frozen, please do not touch or handle it with bare hands. There is the risk of cold injury or worse. *Note: There is pressurized carbon dioxide in the cylinder.*

Use of Bottle: For your safety, only use the BPA-free PET Bottle supplied by us. Not doing so may cause injury, lead to the failure of the product and void your warranty. When the PET Bottle is deformed, scratched, discolored or expired, please do not use it and swap it for a new Bottle.

Disclaimer: This product is limited to the scope of usage specified in this manual only. Failure to operate in accordance with this instruction or loss caused by malicious operation is not covered by our warranty. *Common sense, please.*