



Cafetto® MFC Blue Milk Line Cleaner How to Use Guide

Directions:

1. Ensure the white cap is tightly sealed and slightly loosen the blue cap. Gently squeeze the bottle until reservoir measures 50ml, remove the blue cap and pour from reservoir
2. Add 50ml of MFC Blue to 1 litre of warm water in a cleaning container. Ensure you replace the blue cap and seal tightly after pouring the required dose.
3. Insert milk frother suction tube into solution.
4. Run the entire solution through frother.
5. Repeat the above procedure with 1 litre of clean water to rinse all the components thoroughly.
6. Do not mix with other chemicals.

For Milk Frothers:

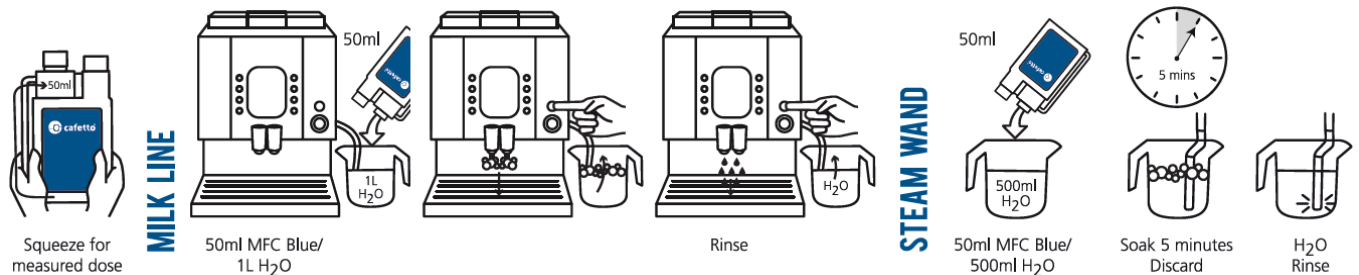

For Jug Rinsers:

