



HOSHIZAKI

Instruction Manual

Bar Equipment

Models

DD24 (S)

DD59 (S)

DD69 (S)

DD80 (S)

DD95 (S)

BB59 (S)

BB69 (S)

BB80 (S)

BB95 (S)

BB59-G (S)

BB69-G (S)

BB80-G (S)

BB95-G (S)

CC50 (S)

CC65 (S)

CC80 (S)

CC95 (S)

WARNING

Only qualified service technicians should install and service the appliance. To obtain the name and phone number of your local Hoshizaki Certified Service Representative, visit www.hoshizaki.com. No installation or service should be undertaken until the technician has thoroughly read this Instruction Manual. Likewise, the owner/manager should not proceed to operate the appliance until the installer has instructed them on its proper operation. Failure to install, operate, and maintain the appliance in accordance with this manual may adversely affect safety, performance, component life, and warranty coverage. Proper installation is the responsibility of the installer. Product failure or property damage due to improper installation is not covered under warranty.

Hoshizaki provides this manual primarily to assist qualified service technicians in the installation, maintenance, and service of the appliance.

Should the reader have any questions or concerns which have not been satisfactorily addressed, please call, send an e-mail message, or write to the Hoshizaki Technical Support Department for assistance.

Phone: 1-800-233-1940; (770) 487-2331

Fax: 1-800-843-1056; (770) 487-3360

E-mail: techsupport@hoshizaki.com

HOSHIZAKI AMERICA, INC.

618 Highway 74 South

Peachtree City, GA 30269

Attn: Hoshizaki Technical Support Department

Web Site: www.hoshizaki.com

NOTE: To expedite assistance, all correspondence/communication **MUST** include the following information:

- Model Number _____
- Serial Number _____
- Complete and detailed explanation of the problem.

IMPORTANT

This manual should be read carefully before the appliance is installed and operated. Read the warnings and guidelines contained in this manual carefully as they provide essential information for the continued safe use, service, and maintenance of the appliance. Retain this manual for any further reference that may be necessary.

CONTENTS

IMPORTANT SAFETY INFORMATION	4
FOR R290 (PROPANE) REFRIGERANT UNITS	4
INSTALLATION INSTRUCTIONS	7
1.1 General information	7
1.2 Transport, handling, unpacking, location	8
1.3 Intended use and restrictions.....	8
1.4 Manufacturer’s identification label description	9
1.5 Installation and assembly	10
1.6 Connections.....	10
1.7 Tapping Instructions	10
1.7.1 How to Tap a Keg of Beer / Sankey Type Barrel	11
1.8 Install the Air Channels and Draft Towers	11
OPERATION	12
2.1 General Information	12
2.2 Control Panel Description	12
2.3 Machine settings and programs.....	13
MAINTENANCE	14
3.1 General safety rules	14
3.2 Machine cleaning and maintenance routine	14
3.2.1 Cleaning the Condenser Coil.....	14
3.2.2 Cleaning the Gasket	15
3.2.2 Draining the Unit.....	15
3.3 Machine disposal.....	16
TROUBLESHOOTING CHART.....	17
4.1 Troubleshooting chart.....	17

IMPORTANT SAFETY INFORMATION

Throughout this manual, notices appear to bring your attention to situations which could result in death, serious injury, damage to the appliance, or damage to property.

⚠ DANGER	Indicates a hazardous situation that, if not avoided, will result in death or serious injury.
⚠ WARNING	Indicates a hazardous situation that, if not avoided, could result in death or serious injury.
NOTICE	Indicates a situation that, if not avoided, could result in damage to the appliance or property.
IMPORTANT	Indicates important information about the use and care of the appliance.

⚠ DANGER

Risk of Fire or Explosion
Flammable Refrigerant Used

- Follow handling instructions carefully in compliance with U.S. government regulations.
- Do not use mechanical devices to defrost.
- Do not puncture refrigerant tubing. Risk of fire or explosion due to puncture of refrigerant tubing; follow handling instructions carefully.
- Component parts shall be replaced with like components.
- Servicing shall be done by factory authorized service personnel to minimize the risk of possible ignition due to incorrect parts or improper service.
- Consult instruction manual/service manual before attempting to install or service this product. All safety precautions must be followed.
- Dispose of properly in accordance with federal or local regulations.
- Do not place any potential ignition sources in or near the appliance.

Risque De Feu Ou D'Explosion
Le Frigorigène Est Inflammable

- Suivre attentivement les instructions de manipulation conformément à la réglementation gouvernementale.
- Ne pas utiliser d'appareils mécaniques pour dégivrer le réfrigérateur.
- Ne pas perforer la tubulure contenant le frigorigène. Risque de feu ou d'explosion si la tubulure contenant le frigorigène est perforée; suivre les instructions de manutention avec soin.
- Les pièces des composants doivent être remplacées par des pièces et accessoires équivalents.
- L'entretien doit être effectué par le personnel de service autorisé par le fabricant afin de minimiser les risques d'inflammation attribuables à l'installation d'une pièce inadéquate ou à la mauvaise exécution du service.
- Consulter le manuel du propriétaire/ guide de réparation avant de tenter une réparation. Toutes les mesures de sécurité doivent être respectées.
- Éliminer conformément aux règlements fédéraux ou locaux.
- Ne placez aucune source d'inflammation potentielle dans ou près de l'appareil.

⚠WARNING

The appliance should be destined only to the use for which it has been expressly conceived. Any other use should be considered improper and therefore dangerous. The manufacturer cannot be held responsible for injury or damage resulting from improper, incorrect, and unreasonable use. Failure to install, operate, and maintain the appliance in accordance with this manual will adversely affect safety, performance, component life, and warranty coverage.

To reduce the risk of death, electric shock, serious injury, or fire, follow basic precautions including the following:

- Only qualified service technicians should install and service the appliance.
- Wear appropriate personal protective equipment (PPE) when servicing the appliance.
- The appliance must be installed in accordance with applicable national, state, and local codes and regulations.
- Appliance is heavy. Use care when lifting or positioning. Work in pairs when needed to prevent injury or damage. Do not lift using the top section or the doors.
- To reduce the risk of electric shock, do not touch the plug with damp hands.
- Unplug the appliance before servicing.
- The appliance requires an independent power supply of proper capacity. See the nameplate for electrical specifications. Failure to use an independent power supply of proper capacity can result in a tripped breaker, blown fuse, damage to existing wiring, or component failure. This could lead to heat generation or fire.
- Children should be properly supervised around the appliance.
- Do not climb, stand, or hang on the appliance or doors or allow children or animals to do so. Do not climb into the appliance or allow children or animals to do so. Death or serious injury could occur or the appliance could be damaged.
- Be careful not to pinch fingers when opening and closing the doors. Be careful when opening and closing the doors or when children are in the area.
- Open and close the doors and with care. Opening the doors too quickly or forcefully may cause injury or damage to the appliance or surrounding equipment.

THE APPLIANCE MUST BE

GROUNDING. The appliance is equipped with a NEMA 5-15 three-prong grounding plug  to reduce the risk of potential shock hazards. It must be plugged into a properly grounded, independent 3-prong wall outlet. If the outlet is a 2-prong outlet, it is your personal responsibility to have a qualified electrician replace it with a properly grounded, independent 3-prong wall outlet. Do not remove the ground prong from the power cord and do not use an adapter plug. Failure to follow these instructions may result in death, electric shock, or fire.

- Do not use an extension cord.
- Do not use an appliance with a damaged power cord. The power cord should not be altered, jerked, bundled, weighed down, pinched, or tangled. Such actions could result in electric shock or fire. To unplug the appliance, be sure to pull the plug, not the cord, and do not jerk the cord.
- The GREEN ground wire in the factory-installed power cord is connected to the appliance. If it becomes necessary to remove or replace the power cord, be sure to connect the power cord's ground wire.
- Do not splash, pour, or spray water directly onto or into the appliance. This might cause short circuit, electric shock, corrosion, or failure.
- Do not make any alterations to the appliance. Alterations could result in electric shock, injury, fire, or damage to the appliance.
- The appliance is not intended for use by persons (including children) with reduced physical, sensory, or mental capabilities, or lack of experience and knowledge, unless they have been given supervision or instruction concerning use of the appliance by a person responsible for their safety.

⚠WARNING, continued

- Children should be properly supervised around the appliance.
- Do not climb, stand, or hang on the appliance or doors or allow children or animals to do so. Do not climb into the appliance or allow children or animals to do so. Death or serious injury could occur or the appliance could be damaged.
- Be careful not to pinch fingers when opening and closing the doors. Be careful when opening and closing the doors or when children are in the area.
- Open and close the doors and with care. Opening the doors too quickly or forcefully may cause injury or damage to the appliance or surrounding equipment.
- Do not use combustible spray or place volatile or flammable substances in or near the appliance. They might catch fire.
- Keep the area around the appliance clean. Dirt, dust, or insects in the appliance could cause harm to individuals or damage to the equipment.
- Do not block air inlets or outlets, otherwise cooling performance may be reduced.
- Do not tightly pack the cabinet. Allow some space between items to ensure good air flow. Also allow space between items and interior surfaces.
- Do not store items near air outlets. Otherwise, items may freeze up and crack or break causing a risk of injury or contamination of other food.

NOTICE

- Protect the floor when moving the appliance to prevent damage to the floor.
- Keep ventilation openings, in the appliance enclosure or in the built-in structure, clear of obstruction. Blockage of airflow could negatively affect performance and damage the appliance.
- Do not allow the appliance to bear any outside weight.
- To prevent deformation or cracks, do not spray insecticide onto the plastic part or let them come into contact with oil.
- To avoid damage to the gasket, use only door handle when opening and closing.
- To avoid damage to the top seal, do not lift the appliance by the top panel or remove the top panel.
- Do not leave the doors open.

INSTALLATION INSTRUCTIONS

- 1.1 General information
- 1.2 Transport, handling, unpacking, location.
- 1.3 Intended use and restrictions.
- 1.4 Manufacturer's identification label description.
- 1.5 Installation and assembly.
- 1.6 Connections (electric, gas, water)
- 1.7 Tapping Instructions
- 1.8 Install the Air Channels and Draft Towers

1.1 General information

You can find the following symbols, or stickers to identify some type of warnings or useful information about your equipment.



1.2 Transport, handling, unpacking, location

Upon receiving your new appliance, check the package and the machine for any damages that may have occurred during transportation. Visually inspect the exterior of the package, if damaged, open and inspect the contents with the carrier. Any damage should be noted and reported on the delivering carrier's receipt.

In the event that the exterior is not damaged, yet upon opening, there is concealed damage to the equipment notify the carrier immediately. Notification should be made verbally as well as in written form. Request an inspection by the shipping company of the damaged equipment.

Retain all crating material until inspection has been made. Contact the dealer through which you purchased the unit.

Check the compressor compartment housing and visually inspect the refrigeration package. Be sure lines are secure and base is still intact.

1.3 Intended use and restrictions



The appliance should be destined only to the use for which it has been expressly conceived. Any other use should be considered improper and therefore dangerous. The manufacturer cannot be held responsible for injury or damage resulting from improper, incorrect, and unreasonable use. Failure to install, operate, and maintain the appliance in accordance with this manual will adversely affect safety, performance, component life, and warranty coverage.

The appliance complies with **UL471** and **NSF-7(DISPLAY II) STANDARDS**.

If you want know more about other restrictions about your equipment see the warranty that is located in the final part of your manual.

1.4 Manufacturer's identification label description

The nameplate is located inside the cabinet, near the top front, left corner. Under no circumstances should the nameplate be removed from the unit. The nameplate is essential to identify the particular features of your appliance and it is of great benefit to installers, operators, and maintenance personnel. It is recommended that, in the event the nameplate is removed, you copy down the essential information in this manual for reference before installation. Removal of nameplate will void the warranty.

		19042435		HOSHIZAKI AMERICA, INC.	
		FIM970306PH5 MADE IN MEXICO			
Model	MOD	DD95	SN	8100734713	2018/03
	115V 50/60Hz		1P	6,5A	
Pot. Frigorífica Refrig. Capacity (BTU/hr / W)		2345/690	Lámpara Lamp	6 W	Descarche Defrost
Calefactor Heater	0	Clase Climat. Climate Class	N	Temp.	-2°C / 5°C
Peso Neto Net Weight (Libras / kg)	50 KG	Agente Expandente Blowing Agent	ECO	Condensación Condensation	VENT
PCA GWP		Refrigerant	R-290	Carga Refrig. Refrig. Weight (Onzas / g)	9.9/280
Refrigerant Type	Presión de diseño lado de baja Low side pressure design (PSI / BAR)	132/9	Compresor Compressor (HP)	1/3	
	Presión de diseño lado de alta High side pressure design (PSI / BAR)	300/20			
	N.			8100734713	
	MOD.	DD95	115V 60Hz	19042435	
	N.			8100734713	
	MOD.	DD95	115V 60Hz	19042435	
*REFERENCE IMAGE					

Code

Serial Number
(8 digits and ends in "M")

Electrical
Information

1.5 Installation and assembly

This appliance is intended for indoor use only. Be sure the location chosen has a floor strong enough to support the total weight of the unit and contents. For the most efficient operation, be sure to provide good air circulation inside and outside of the unit.

INSIDE CABINET

The first cleaning must be made when you unpack the unit and before switching it on. Clean it with water and a mild detergent. When it is clean and dry, insert the accessories in the appropriate places, for the best use of the user.

OUTSIDE CABINET

Be sure the unit has good air circulation around it. Avoid hot corners and locations near stoves and ovens. It is recommended the unit be installed no closer than 2" from any wall. Place in a clean area to avoid clogging the condenser, which can cause low performance and failures.

The unit should not be installed in ambient temperatures higher than 90°F. If the relative humidity is higher than 60 %, condensation may form around the door frame. This is not a malfunctioning of the unit.

1.6 Connections

Refer to the amperage data on data plate and your local code or the National Electrical Code to be sure unit is connected to the proper power source. Verify correct incoming voltage according to the name plate information.

A protected circuit of the correct voltage and amperage must be run for connection of the power cord. Unit must be grounded and connected in accordance with NEC Article 422 Appliances.

1.7 Tapping Instructions

This cooler will accept only the quarter-size keg. The Sankey type is the most modern and easiest of all to tap with the available taps. The type of keg and tap you use will depend on the brand of beer your purchase. Your beer distributor can provide additional instructions and tips on how to maintain the beer to your satisfaction.

Following these tapping instructions, place the keg in front of cabinet for tapping. After all connections are complete and checked for leaks, place the CO2 bottle in the rear (inside) of cabinet with the pressure gage visible for reading, then place the keg in position, allowing the door to be closed completely without interference. Make certain that beer line and keg are not touching the evaporator.

1.7.1 How to Tap a Keg of Beer / Sankey Type Barrel

1. Connect line from pressure source to tap nipple (use clamp).
2. Using coupling washer connect beer line to thread on probe. Holding flats on probe with wrench tighten wing nut or hex nut on beer hose.
3. Align tap with lugs in barrel, insert tap.
4. Turn tap body handle ¼ turn clock wise until tight to secure tap to barrel. Turn on pressure regulator.

Rotate wheel handle ¼ turn clock wise. Be certain handle is turned as far as it will go to stop. This will assure that the beer and gas pots in the keg down tube will be fully opened.



1.8 Install the Air Channels and Draft Towers

This procedure describes how to install the air channel needed to provide cold air directly into the beer towers.

Tools needed: Philips Screwdriver

Step 1

Locate the gaskets and bolts included in with your Tower. Place gasket over the pre-drilled holes and place the 4 screws thru the tower base. Align the tower with screws and gasket to the cabinet top as shown below while dropping the beer line(s) thru the top of the unit.

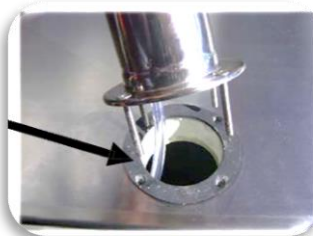

Step 2

Tighten the screws using the nuts found in your tower box.



Step 3
Identify the "WHITE HOSE" which is found inside of the equipment.

Step 4
Introduce the "WHITE HOSE" which is found inside of the equipment into the tower's hole.

Be sure that the hose's hook is correctly attached into the tower hole.

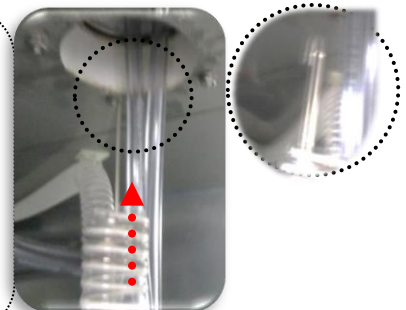

OPERATION

- 2.1 General information.
- 2.2 Control panel description.
- 2.3 Machine settings and programs.

2.1 General Information

Good air flow inside the cabinet is critical. Do not block air outlet and the evaporator fan grill, minimum 2 inches of space along the front, back, and sides is required for proper air flow.

2.2 Control Panel Description

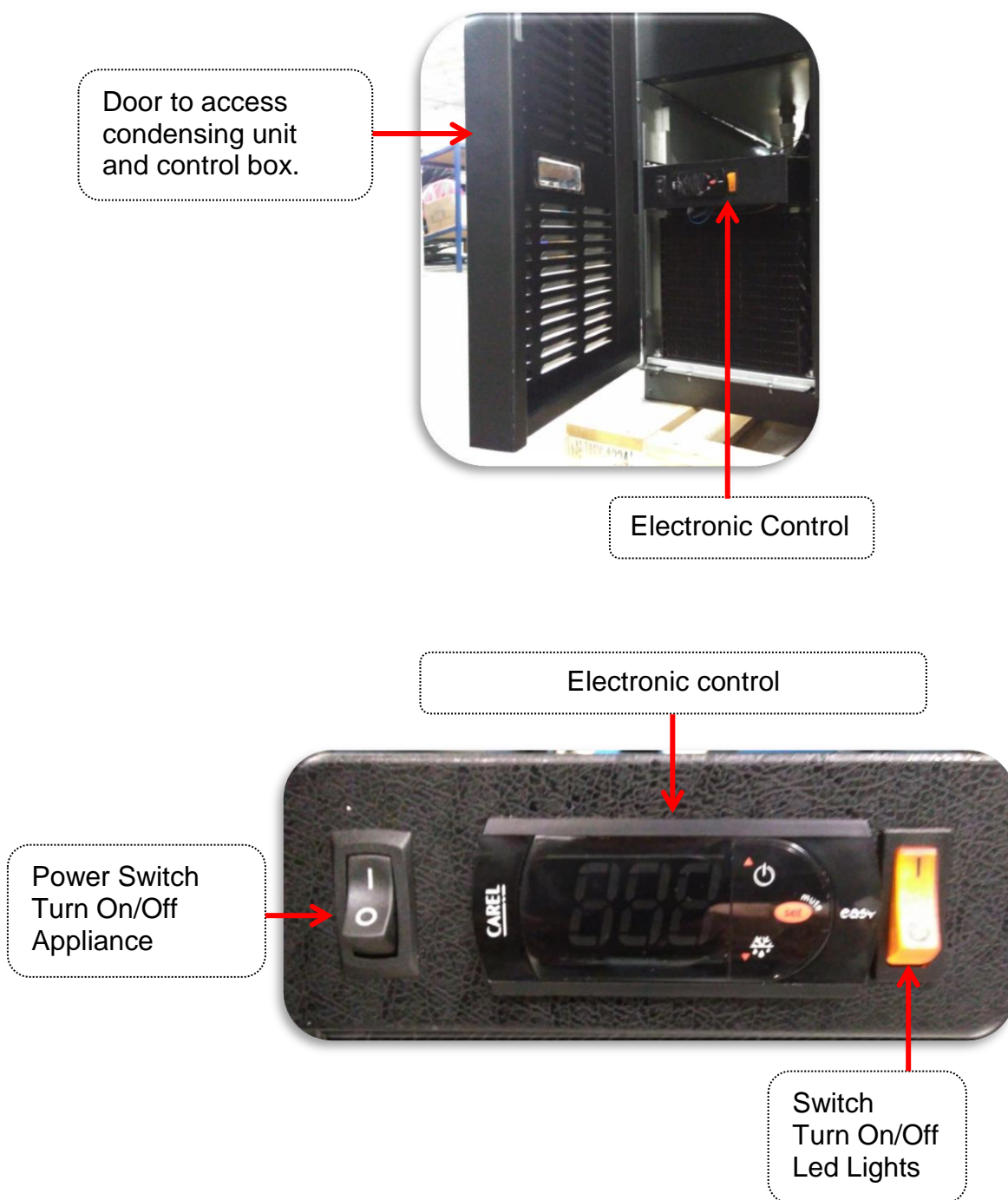

Electronic Control

After connecting your unit, move the power switch located next to the controller to the “ON” position. The display will show the cabinet temperature. Also, the compressor and fan icons will flash for a period of three minutes. After this delay the unit will start cooling.

Verify you don't have any alarms on the controller. If after you turn ON the equipment the controller shows an alarm icon or an error code, please contact your local Hoshizaki certified service representative. They will help you fix the problem.

FIGURE 1

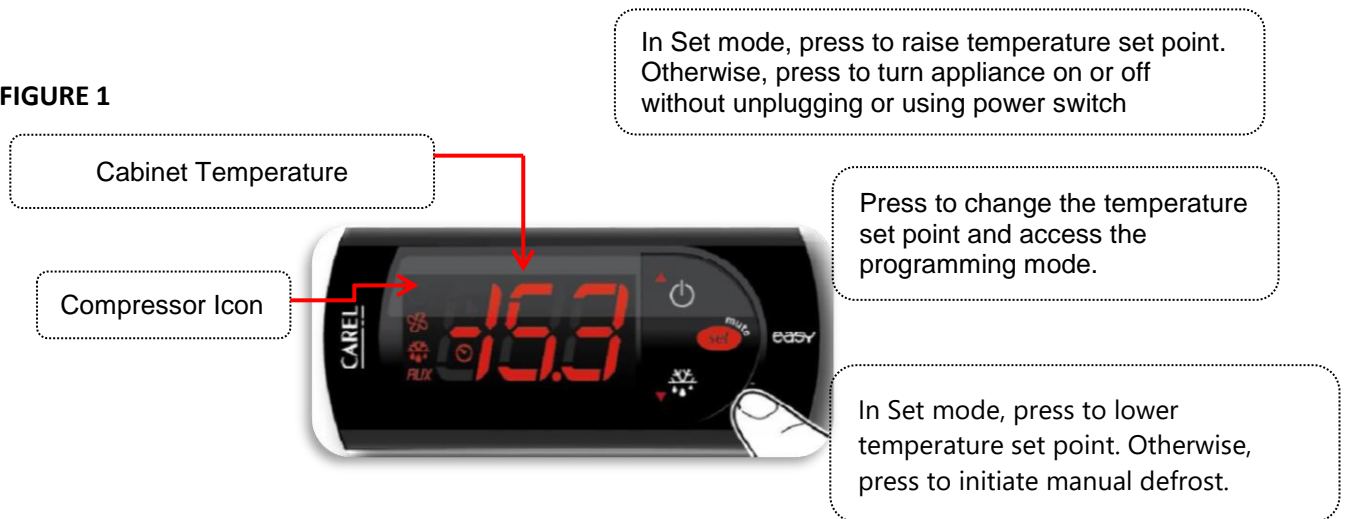

2.3 Machine settings and programs

Changing the temperature set point on the controller.

The unit comes with a factory default setpoint of 32°F. If set point needs to be changed, follow the steps below.

Press and hold the SET button for one second. You should see a flashing number. Release the button.



Press the up and down arrows to increase or decrease the setpoint. Then press the SET button to save the new setpoint.

Note:



The maximum value you can set in the controller is: 36°F

If you wish to decrease the setpoint, press the DOWN arrow button until you reach the desired value. Release the button and then press the SET button to keep, and save, the new value.



Note:

The minimum value you can set in the controller is: 30°F

Manual Defrost

To select manual defrost, press and hold the manual defrost button for 5 seconds. The snowflake icon will appear on the display. When this icon is solid it indicates that the equipment is in Defrost mode.



To exit manual defrost, press and hold the manual defrost button for 5 seconds. The snowflake icon will turn off. Wait 2 minutes for the compressor to start.

MAINTENANCE

3.1 General safety rules.

3.2 Machine cleaning and maintenance routine.

3.3 Machine disposal.

3.1 General safety rules

Warranty does not include parts or labor coverage for component failure or other damage resulting from:

- External electrical power failure or miswiring to Product for any reason.
- Adverse operating conditions as set forth in the owner/user manual for the Product.
- Failure to clean and/or maintain Product as set forth in the owner/user manual for the Product.

To prevent corrosion and damage to stainless steel surfaces, use only products formulated for use on stainless steel appliances. Do not use steel wool, abrasive products, scrapers, or products containing sodium hypochlorite (chlorine bleach). Use a clean, soft cloth for cleaning.

3.2 Machine cleaning and maintenance routine

Cleaning solutions need to be alkaline or non-chloride cleaners. Any cleaner containing chlorides will damage the protective film of the stainless steel. Chlorides are also commonly found in hard water, salts, and household and industrial cleaners.

Routine cleaning of stainless steel can be done with soap and water. Extreme stains or grease should be cleaned with a non-abrasive cleaner and plastic scrub pad. There are also stainless steel cleaners available which can restore and preserve the finish of the steel's protective layer.

Never use an acid based cleaning solution! Many food products have an acidic content which can deteriorate the finish. Be sure to clean ALL food products from any stainless steel surface. Common items include peppers, tomatoes and other vegetables.

3.2.1 Cleaning the Condenser Coil

Move the power switch to the "OFF" position, then unplug appliance, remove front bottom panel and carefully slide out the condensing unit. The condenser coil requires regular cleaning; recommended every 30-60 days, depending of the accumulation of dust and grease. If the buildup on the coil consists of only light dust and debris the condenser coil can be cleaned with a simple brush. Heavier dust build up may require a vacuum or even compressed air to blow through the condenser coil. If heavy grease is present there are de-greasing agents available for refrigeration use and specifically for

the condenser coils. The condenser coil may require a spray with the de-greasing agent and then blown through with compressed air.

Be sure all electrical and mechanical parts are dry before turning on the power. Never use a high pressure water wash for this cleaning procedure as water can damage the electrical components located near or at the condenser coil. Do not place filter material in front of condenser coil. This material blocks air-flow to the coil similar to having a dirty coil!

If you keep the Condenser clean you will minimize your service expense and lower your electrical costs. Failure to maintain a clean condenser coil can initially cause high temperatures and excessive run times. Continuous operation with dirty or clogged condenser coils can result in compressor failures.

To put back the condensing unit in its place, slide in the unit carefully. **BE SURE DRAIN PIPE IS LOCATED OVER THE PAN.** Replace front bottom panel plug the appliance into the electrical outlet and turn the power switch on.

3.2.2 Cleaning the Gasket

Gaskets require regular cleaning to prevent mold and mildew build up and also to keep the elasticity of the gasket. Gasket cleaning can be done with the use of warm soapy water. Avoid full strength cleaning products on gaskets as this can cause them to become brittle and prevent proper seals. Also, never use sharp tools or knives to scrape or clean the gasket which could possibly tear the gasket and rip the bellows.

Gaskets can easily be replaced and do not require the use of tools or authorized service persons.

The gaskets can be pulled out of the groove in the door and new gaskets can be “pressed” back into place.

3.2.2 Draining the Unit

Each unit has a drain located inside the unit which removes the condensation from the evaporator coil and evaporates it at an external condensate evaporator pan. The drain can become loose or disconnected from moving or bumping the drain.

IF YOU NOTICE EXCESSIVE WATER ACCUMULATION ON THE INSIDE OF THE UNIT be sure the drain tube is connected from the evaporator housing to the condensate evaporator drain pan.

IF WATER IS COLLECTING UNDERNEATH THE UNIT you may want to check the condensate evaporator drain tube to be sure it is still located inside the drain pan. The leveling of the unit is important as the units are designed to drain properly when on a level surface, if your floor is not level this can also cause drain problems. Be sure all drain lines are free of obstructions; typically food product is found blocking drain lines causing water to back up and overflow the drain pans.

3.3 Machine disposal

DANGER

Risk of Fire or Explosion Flammable Refrigerant Used

- Follow handling instructions carefully in compliance with U.S. government regulations.
- Do not puncture refrigerant tubing. Risk of fire or explosion due to puncture of refrigerant tubing; follow handling instructions carefully.
- Dispose of properly in accordance with federal or local regulations.

Risque De Feu Ou D'Explosion Le Frigorigène Est Inflammable

- Suivre attentivement les instructions de manipulation conformément à la réglementation gouvernementale.
- Ne pas perforer la tubulure contenant le frigorigène. Risque de feu ou d'explosion si la tubulure contenant le frigorigène est perforée; suivre les instructions de manutention avec soin.
- Éliminer conformément aux règlements fédéraux ou locaux.

WARNING

When preparing the appliance for disposal, remove the doors to reduce the risk of children getting trapped. Leave any shelves in place so that children may not easily climb inside.

The appliance contains refrigerant and must be disposed of in accordance with applicable national, state, and local codes and regulations. Refrigerant must be recovered by properly certified service personnel.

TROUBLESHOOTING CHART

4.1 Troubleshooting chart

Follow the next steps before requesting warranty service. Failure to do so, may result in service charges for you and may void your warranty:

1) Refrigerator doesn't work:

- a. Check power supply on, plugged into electrical outlet, power switch on.
- b. Check that the ON/OFF switch is in the ON position.

2) Refrigerator doesn't reach temperature:

- a. Check that the controller doesn't display any alarm.
- b. Check that the machine is not in the defrost cycle.
- c. Ensure Equipment is placed in a ventilated place and is a minimum of 2 inches from any other appliance and away from any heat source.
- d. The maximum ambient temperature is 90°F
- e. To ensure proper air flow, product must not be placed higher than the maximum level mark located on the internal wall of the unit.
- f. Check that the gasket is in good condition and door is sealed.
- g. Check that the evaporator fan is working.
- h. Allow the appliance to pull down to the set point before loading with product.

3) There is water under the refrigerator:

- a. Check that the drain pipe is over the pan/check condenser compartment.
- b. Check that the cabinet is level.

 WARNING
To ensure proper operation of equipment, it is recommended that the unit is on for 24 hours prior to the introduction of product.

HOSHIZAKI AMERICA, INC.

618 Hwy. 74 South, Peachtree City, GA 30269 USA (P) 770.487.2331 (F) 770.487.3360 hoshizakiamerica.com