

Brewing Coffee

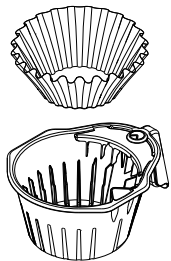

Insert a BUNN filter into a clean brew funnel.



If using pre-ground coffee, simply pour fresh coffee into filter.

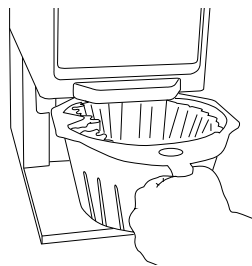

If grinding fresh coffee, place funnel in grinder.

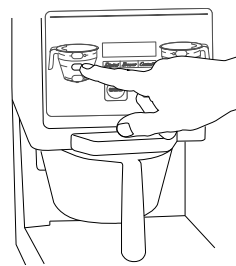

For two hopper grinders, select coffee type by pressing "RIGHT" or "LEFT" hopper.

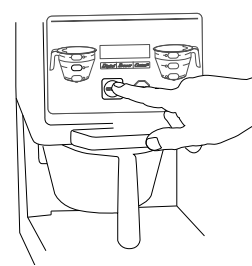

Press the GRIND button to fill the funnel.

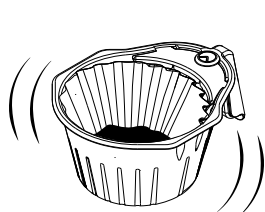

Gently shake funnel to spread the grounds evenly.

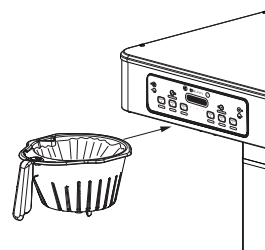

Slide the funnel into the funnel rails of the brewer.

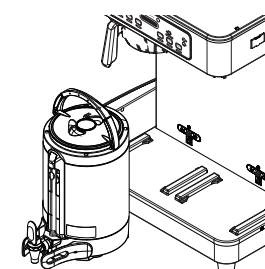

Place an empty server under the funnel. Rotate handle forward to lock the lid.

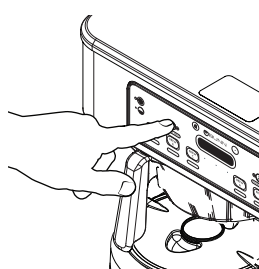

Press and release the "ENABLE BREW" button.

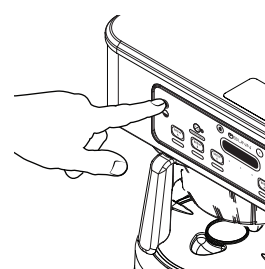

Press the Batch Size button according to the amount of coffee in the filter.

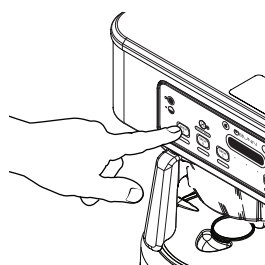

Press the assigned BREW button (A, B, or C).

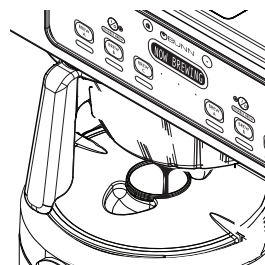

The display will read NOW BREWING with the remaining brew time.

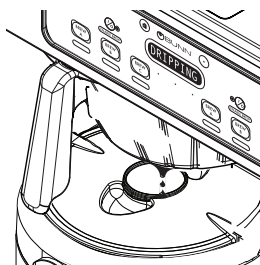

The word DRIPPING will read on the display.

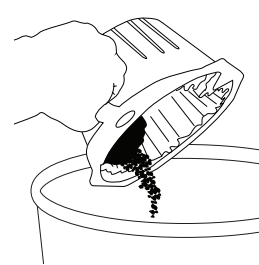

When dripping has stopped, discard the used grounds and filter.

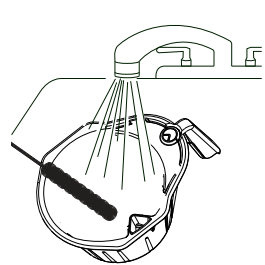

Clean and Sanitize the funnel.

Cleaning the Brewer

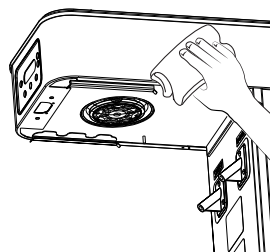

Every Day: Wipe the sprayhead panel and the entire outside surface of the brewer with a clean damp cloth.

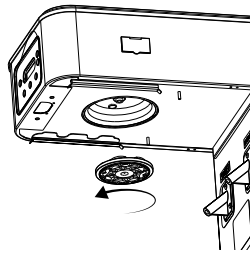

Once a week: Remove the sprayhead by turning in a counter-clockwise direction.

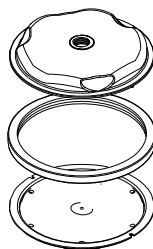

Disassemble and thoroughly rinse the sprayhead. The holes must be open and clear of any mineral deposits.

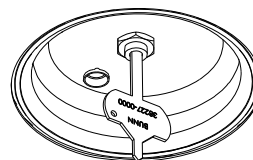

Use the long end of the sprayhead cleaning tool to clean the sprayhead outlet fitting.

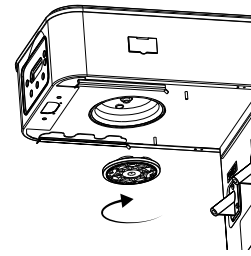

Re-assemble the sprayhead and install it onto the brewer.

Cleaning the Lid Assembly

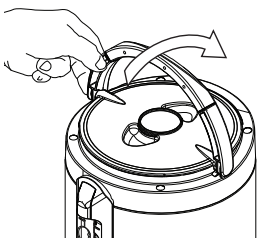

Completely drain the server.
Rotate handle back to release the lid lock.

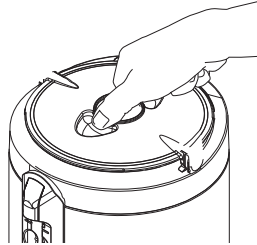

Grasp the lid by the finger holds and lift the lid assembly straight up.



Clean the inlet tube with the supplied brush (00675.0000) using a mild soap solution. Rinse lid assembly thoroughly with clean water.

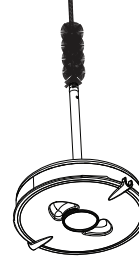

CAUTION:

DO NOT submerge the server in water.

Damage to internal components may result.

Cleaning the Faucet and Sight Tube

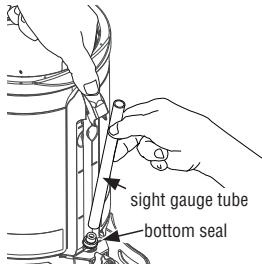

Press down on the sight gauge top to release the sight gauge tube. Remove the sight gauge tube and bottom seal.

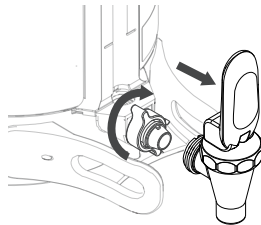

Turn the faucet wingnut clockwise to remove the faucet from the dispenser.



Unscrew the faucet cap and disassemble all the faucet parts.

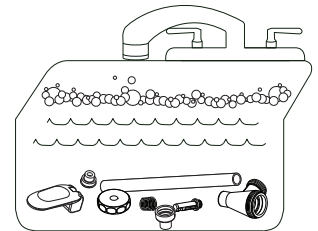

Transfer the sight gauge and faucet parts to a sink with a soap solution using a mild, non-citrus, non-abrasive, liquid detergent.

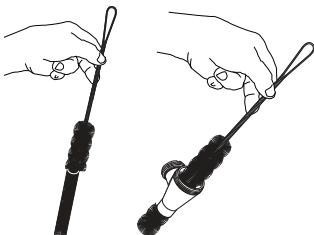

Using supplied brush scrub the faucet body and sight gauge tube.

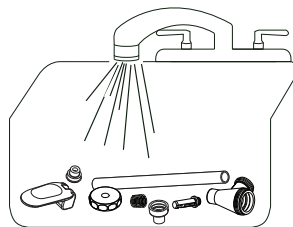

Rinse all parts in the second sink with clean hot water.

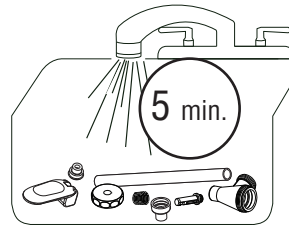

Transfer the parts to a sink filled with non-chlorine sanitizing solution. Allow the parts to soak in the sanitizing solution for a minimum of five (5) minutes.

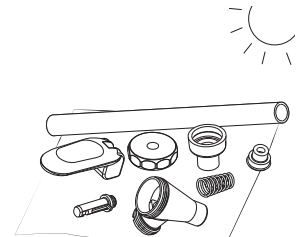

Remove the faucet parts from the sanitizing solution, and allow to air-dry overnight. Reassemble faucet.

Cleaning the Server

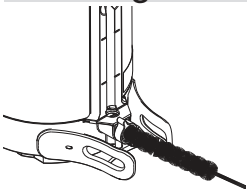

Clean the faucet shank using the supplied brush (00675.0000) and cleaning solution.

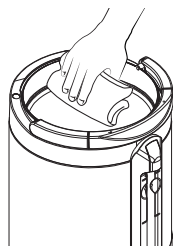

Fill server with a wash solution, and thoroughly clean inside of server using a SOFT, Non-abrasive cloth or brush. Drain and thoroughly rinse using fresh water.

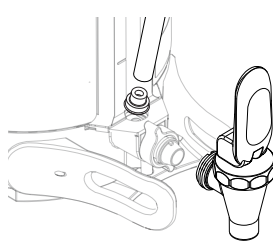

Re-install sight gauge seal and sight gauge tube.
Re-attach faucet to server shank.
USE CAUTION: Do Not over-tighten faucet wing nut - HAND TIGHTEN ONLY.

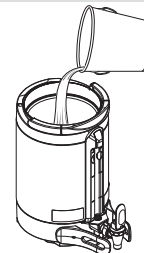

Fill the server with non-chlorine sanitizing solution, and let server sit for five (5) minutes, then drain through fully open faucet.

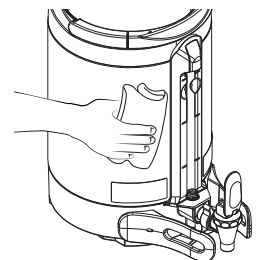

Clean the outside surface of the server using a clean damp cloth.