

BlissHome App

Quick Start Guide

In this guide, you'll discover how to connect your light to the BlissHome app, create your own custom color settings and effects, and take advantage of the all-new smart features.

1.

How to Pair Your Light

1. Download the BlissHome app by scanning the QR code. Make sure your device has WiFi and Bluetooth enabled.
2. Plug in your light. It should turn on immediately. See your light's instruction manual to activate pairing mode. Usually this is done by pressing and holding the power button for a few seconds.
3. In the BlissHome app, press the small plus sign in the upper right corner to add a light. The app should detect your light automatically, or you can manually select it from the list of devices and follow the prompts.
4. The app will ask to connect to your WiFi network. If you have a dual-band router, make sure it is using 2.4GHz connection for your light to connect correctly.
5. Wait a few moments for the light to connect. Congrats, your light is now paired to the app!

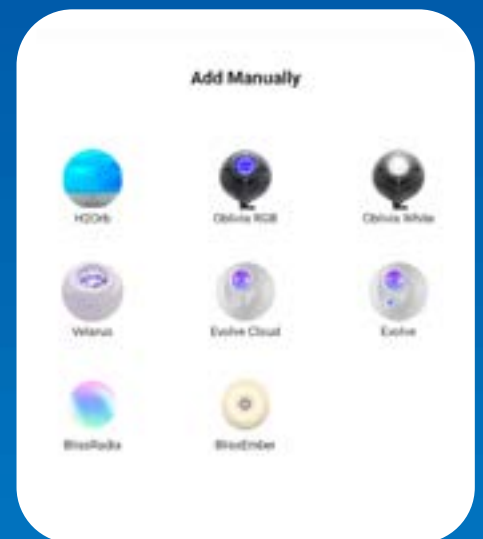

Scan to download the app

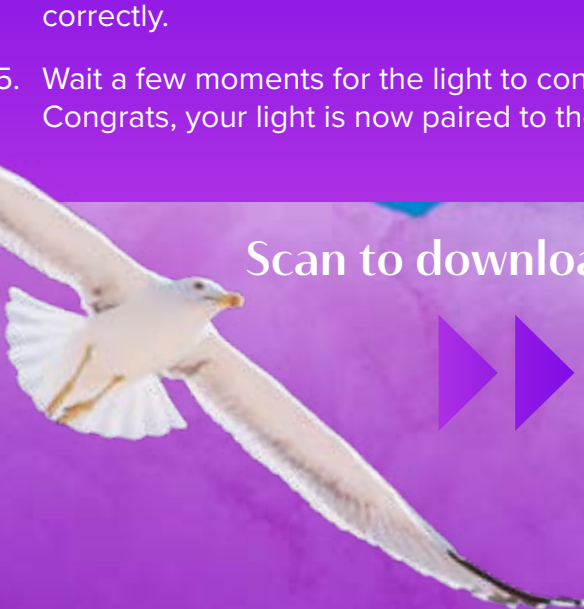

2. App Basics

Most BlissLights have three main sections within the app: Laser, Cloud, and Theme. In the Laser tab, you can control the star brightness and speed. In the Cloud tab, you can quick-select cloud colors using the color wheel and adjust the cloud brightness. The Theme tab contains default presets, and the option to add up to 8 custom themes. Speaking of custom themes...

Creating a Custom Theme

The BlissHome app offers robust customization options! Tap the Add Preset button in the Themes menu to bring up the customization dialog.

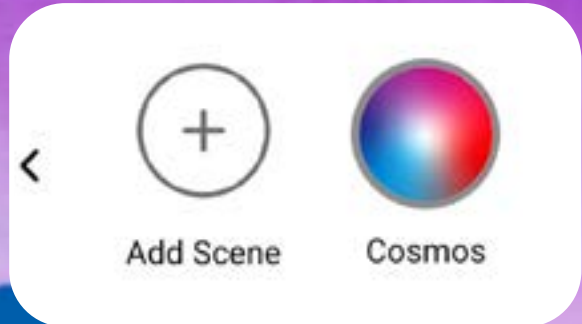

Custom Colors

Tap the Color bubble to fine-tune your color by controlling the brightness of each LED. You can also set the laser brightness, rotation speed, or—our personal favorite—set up a color-changing effect.

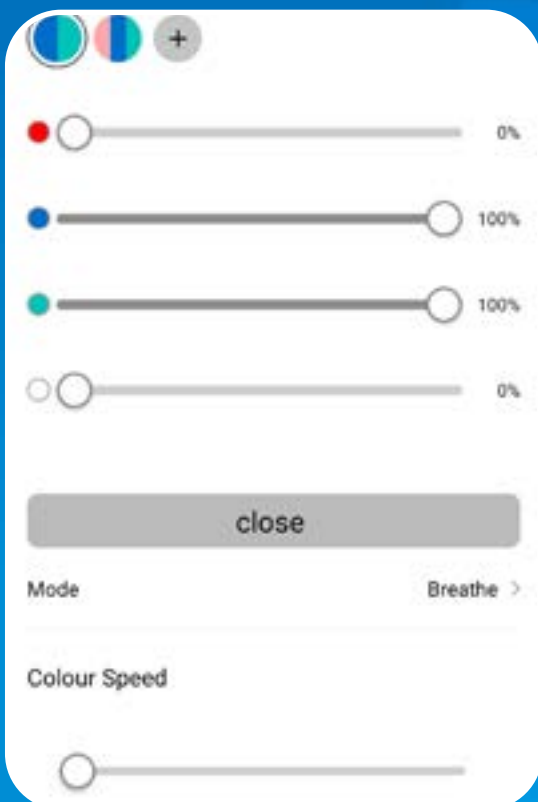
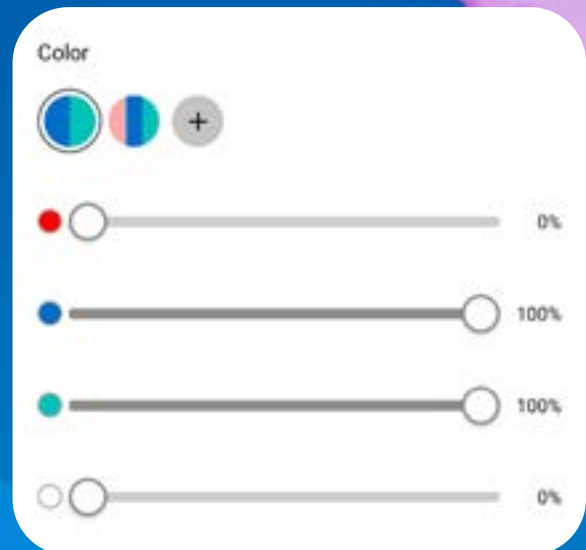

Color-changing Effects

Scroll down past the color options to the Mode selector. Change it from Static to Breathe (soft transition) or Flash (hard transition). Now you can add up to 7 additional color combinations that your custom theme will cycle through. You can control the speed of the transitions with the Cloud Speed slider.

Saving Custom Effects

Once you're satisfied with your custom theme, you can optionally name it and add a picture. Press Submit to save it to your Themes selection page.



3.

Smart Features

Last but not least, here's how to take advantage of BlissHome's smart features, including group control, smart scenes, and voice control with Google Home or Alexa.

Group Control

If you have more than one of the same kind of light, you can create a Group to control them all from one place. Just tap on one of the units from the main menu > tap the pen and paper icon in the upper right corner > select Create Group > chose the lights you'd like to put in the group. Now you can select the group and control it like you would a single light.



Smart Scenes

A Smart Scene lets you control and schedule routines for multiple devices at the same time. For example, you can create a Smart Scene that sets one light to shine purple and another to shine blue at the same time. You can create an **Automation**, which performs routine tasks (based on time of day or local weather, for example), or use **Tap-to-Run** to manually activate a Smart Scene.

Press the + button at the top right of the BlissHome main menu to create a new Smart Scene.

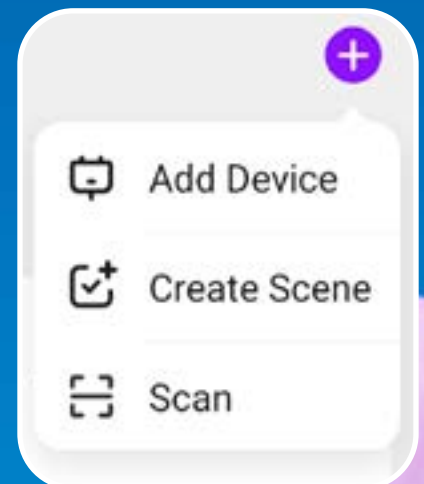

Alexa



Google Assistant

Voice Control

You can connect to voice control with Google Home or Alexa by selecting your light > tapping the pen and paper icon in the upper right corner > choosing Google or Alexa from the Third-Party Control options.