

REFLEX ACTIVE

PLAY HEADPHONES

THANK YOU FOR CHOOSING REFLEX ACTIVE!

We know you want to get straight to the music, but please take a minute to read these instructions, they'll help you get the most from your Reflex Active product.

POWER ON/OFF

1. Press and hold the middle button on the headphones to power on and off.

CONNECTING

1. Power on and automatically enter pairing mode.
*To enter pairing mode again, power off and then hold the POWER button for 5 seconds.
2. Open wireless connections within phone or tablet settings.
3. Search "REF-STUDIO" and select. Your device will now be paired with your headphones.
Your connection will now be automatic, but if you do have any connection issues, please repeat steps 1-3.

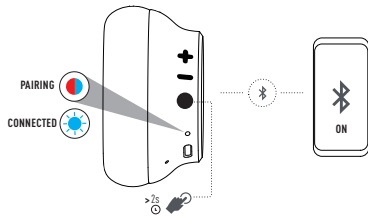

CHARGING

1. Insert charging cable into the charging port at base of case & connect to power supply.
2. The charging indicator light will show red to show charging.
3. Allow to charge for around 2 hours, the charging indicator light will be illuminated continuously once fully charged.
4. Always take care not to exceed 2 hour charge time.

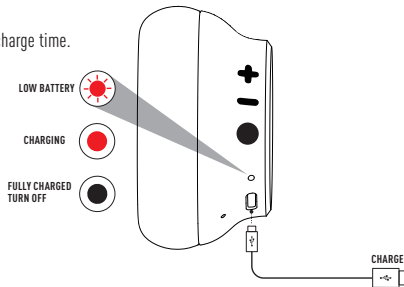

CARING FOR YOUR PRODUCT

Please follow these simple instructions to keep your headphones looking & sounding great!

- Clean product with a dry cloth.
- Not designed to be submerged in water, should this occur product will malfunction.
- Avoid excessive twisting / turning of charging cable as this can cause malfunction.
- Contains no serviceable components. Do not attempt to open the ear pods or their casing as this may cause harm.
- Keep away from strong magnetic fields to avoid interference.

GUARANTEE

Your Reflex Active product is guaranteed against any defective construction or parts for 1 year from date of purchase. Please retain your receipt as proof of purchase. Breakages caused by water damage, accident or mishandling are not covered. This guarantee is in addition to your statutory consumer rights.

In the unlikely event you need to return your Reflex Active product, please contact us and we'll be happy to guide you through the process.

IMPORTANT INFORMATION

Enjoy your music, but please stay safe & ensure you stay aware of your surroundings at all times. We advise against listening to loud music for long periods of time. Do not use this product whilst driving or in other potentially dangerous situations. This product is not a toy, not for use by children. This is a class B product. In a domestic environment, this product may cause radio interference, in which case the user may be required to take adequate measures. Made in China by Peers Hardy UK Ltd. Precision House, Starley Way, Birmingham International Business Park, B37 7GN. EU Address, Peers Hardy UK LTD, C/O Global E-commerce Experts, Rijnlanderweg 766, Unit H, 2132 NM, Hoofddorp, Netherlands.

DISPOSAL OF GOODS

The crossed out wheelite bin symbol is to remind you that waste electrical products, batteries & accumulators should not be disposed of in household waste. If you are unable to reuse or recycle your article it should be disposed of at a civic amenity site or a local authority recycling facility. Do not dispose of your product within household waste. Disposal of the packaging & your product should be done in accordance with local regulations. Batteries are not to be disposed of in municipal waste stream and require separate collection.

EU DECLARATION OF CONFORMITY

The full UK & EU declaration of conformity can be viewed online at the following web page: <https://www.reflex-active.com/pages/audio-docc>

HELP AND CONTACT

If you need any help with your product, then please get in touch, we'll be happy to hear from you! We are available Monday - Friday 9am - 4pm.

✉ Support@Reflex-Active.Com ☎ +44 (0) 121 524 1400

BUTTON FUNCTIONS

- + • Press once to **increase volume**
- Press and hold to **skip forward**
- • Press once to **decrease volume**
- Press and hold to **skip back**
- Press once to **play, pause, or answer, end a phone call**
- Double-press to activate **Siri or other voice control software**
- Triple-press to cycle **low latency ON or OFF**
- 📞 Press and hold 2secs to **reject incoming calls**
- Press and hold to **power ON or OFF**

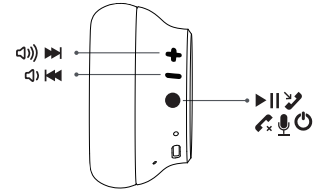

CONNECTING TWO DEVICES

Maximum Two Devices

1. Once the FIRST device is connected, turn off wireless in device settings. Headphones will automatically enter wireless pairing.
2. Enter your SECOND device wireless settings and connect to headphones.
3. Enter your FIRST device settings. Turn on wireless and reconnect to headphones.

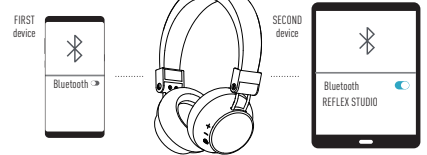

RESET

Please make sure you forget "REFLEX STUDIO" from your Bluetooth device settings before resetting.

1. When power is off, press and hold the power button for 5 seconds until the light flashes BLUE and RED.
2. Keep holding +/- buttons simultaneously for 10 seconds until you see the RED light FLASHING 3 TIMES. The headphones will power OFF automatically.

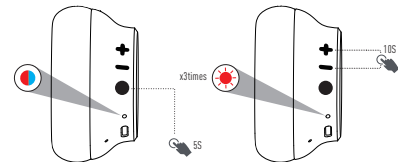

COME JOIN US OVER ON SOCIAL!

REFLEX.ACTIVE

REFLEX.ACTIVE