

L/NT/N4282

Conector VGA

bticino

Código Bticino

L4282, NT4282, N4282

Descripción

Conector VGA de color gris claro.

Línea Bticino

LIVINGLIGHT

Modelos disponibles



L4282



NT4282



N4282



Dimensiones (mm)







Diagrama de instalación

Prepare el cable VGA (no incluido)

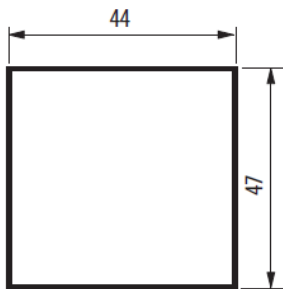
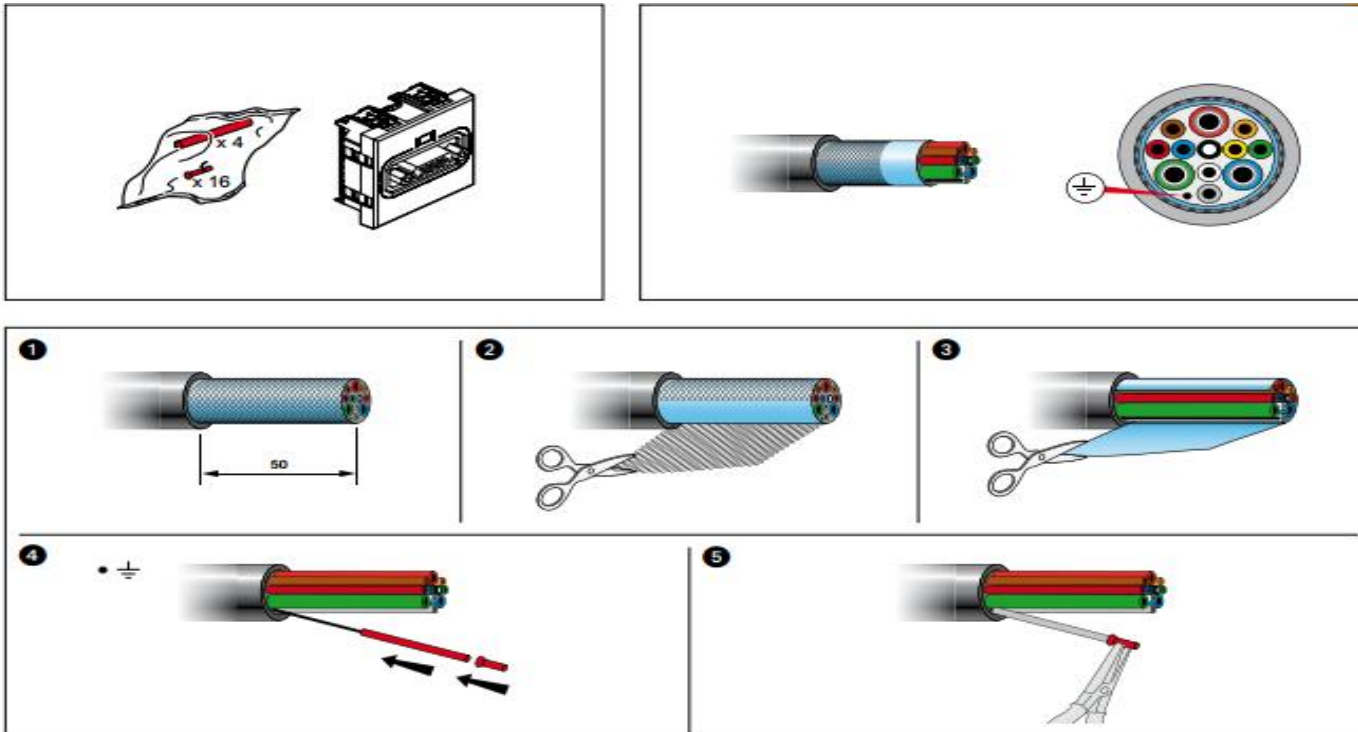
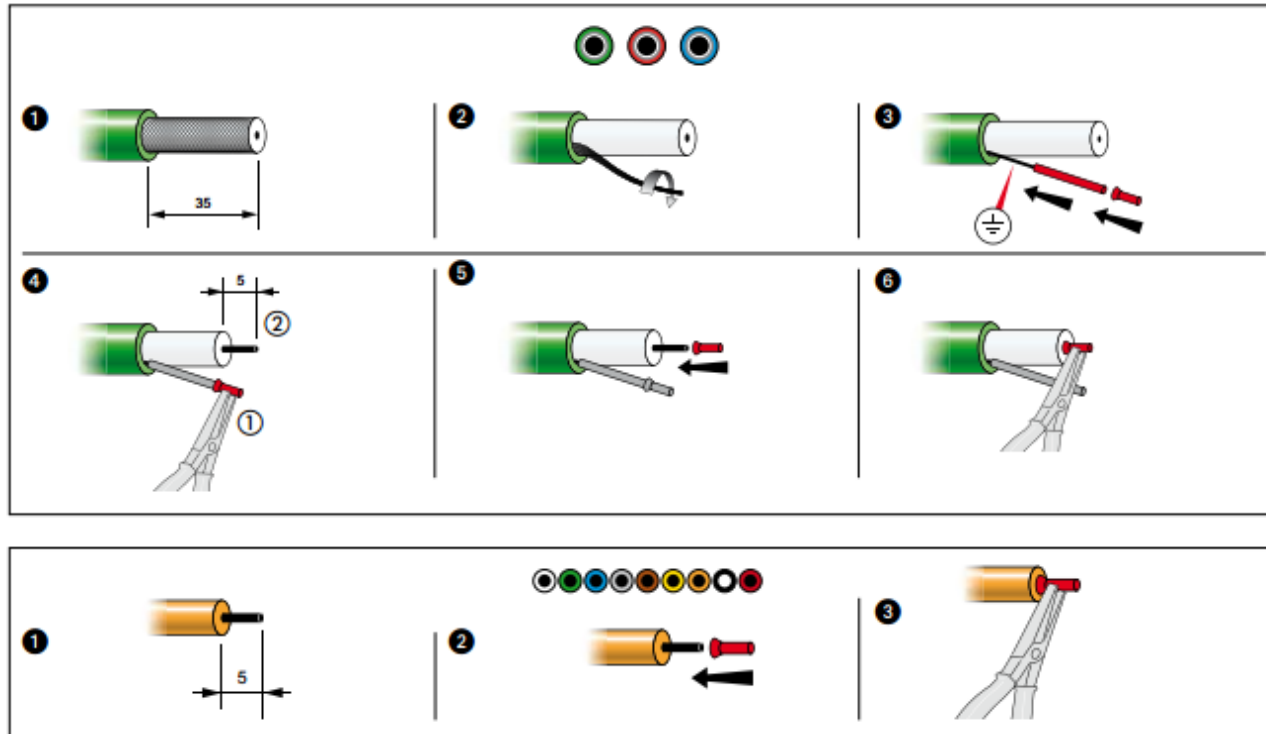

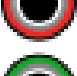

VGA FULL PIN

-  { 1 Coaxial rojo (rojo)
-  { 6 Trenzado rojo (masa rojo)
-  { 2 Coaxial verde (verde)
-  { 7 Trenzado verde (masa verde)
-  { 3 Coaxial azul (azul)
-  { 8 Trenzado azul (masa azul)
-  9 Blanco
-  14 Verde (SV)
-  10 Azul (masa SH-SV)
-  13 Gris (SH)
-  11 Marrón (ID Bit 0)
-  12 Amarillo (ID Bit 1)
-  4 Naranja (ID Bit 2)
-  15 Negro (ID Bit 3)
-  5 Rojo (Gnd)
-  Masa general

