



model MK8A

Freeze-protection Bury Valve

FEATURES & BENEFITS

OPTIONS

To see all options for this model, visit www.hawSCO.com



SPECIFICATIONS

Model MK8A is a special freeze-protected valve that drains water from Model 8300FP combination shower/eyewash after closing to prevent freezing. 3/4" MIPS inlet. Standard sizes are 60" and 78" (152.4 and 198.1 cm) for bury depths of 24" and 42" (61 and 106.7 cm) respectively. Servicing Instructions: For replacement of damaged parts, order the VRKMK8A repair kit which includes packing, stuffing box, stuffing box nut, spring and plunger assembly with four O-rings.

APPLICATIONS



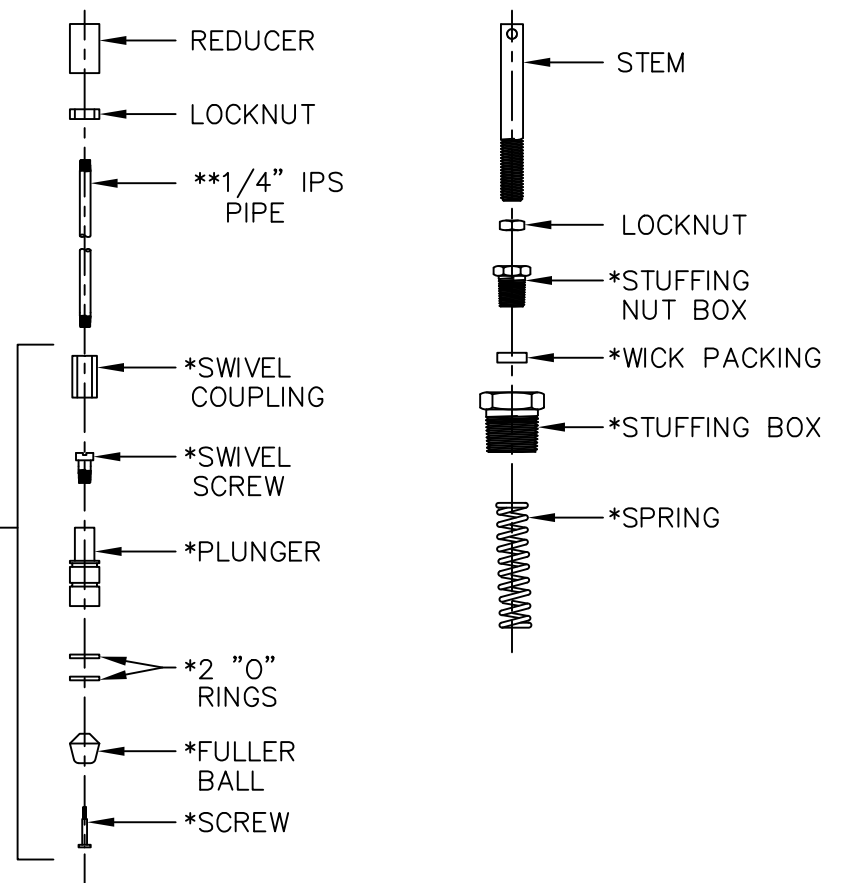
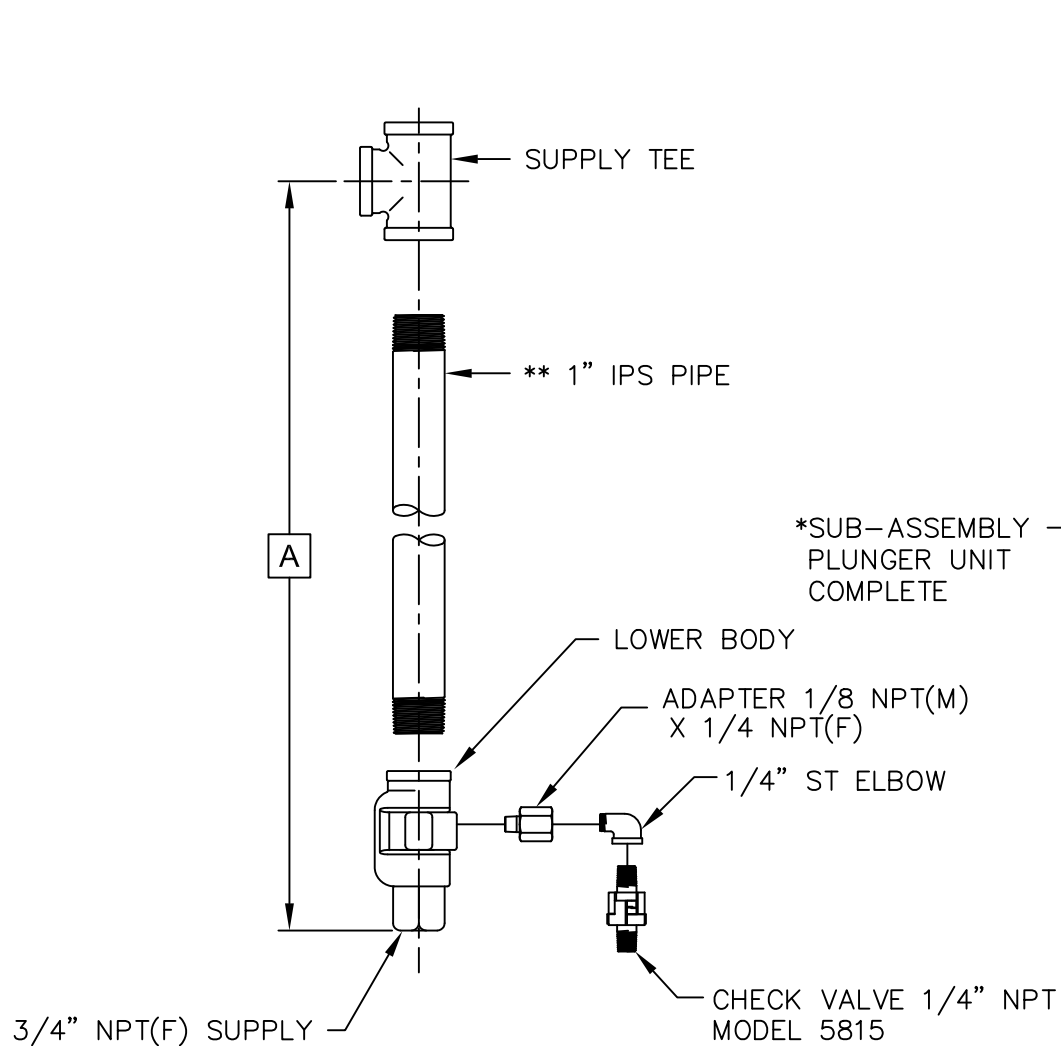

REPLACEMENT PARTS FOR ITEMS MARKED WITH AN ASTERISK (*) ARE INCLUDED IN VALVE REPAIR KIT MODEL VRKMK8A AVAILABLE FROM HAWS.

** SPECIFY BURY DEPTH WHEN ORDERING THESE PARTS

A	FOR BURY DEPTH
60"	24"
78"	42"

1455 KLEPPE LANE
SPARKS, NEVADA 89431
(775) 359-4712 FAX (775) 359-7424
E-MAIL: HAWS@HAWSCO.COM
WEBSITE: WWW.HAWSCO.COM

ECN NO. REVISED PER BY: ECN: 4561 LVWC		MODEL(S)		PART NUMBER:	
DRAWN: DATE: CHKD: 09/90		MK8A FREEZE PROOF VALVE		0002080286.D	
APPROVED: DATE:		SCALE: 1:5 DRAWING TYPE: INSTALLATION		DRAWING NO.: 07895A00 REV. 10	
				SIZE: A SHEET 1 OF 1	