

- Concealed Mounting
- Heavy-Duty **Bradex**<sup>®</sup>

**Product Materials**

**ROBE HOOK:** forged brass with bright chrome finish.  
**CONCEALED MOUNTING PLATE:** 12 gauge plated steel in bright chrome finish.

**Installation**

Verify all rough-in dimensions prior to installation. Secure separate mounting plate to wall with mounting screws (included) at holes provided. Attach robe hook and secure with set screws.

**Optional Features**

Feature	Suffix
<input type="checkbox"/> Satin chrome finish <b>Bradex</b> <sup>®</sup>	-81

**Guide Specification**

Heavy-duty robe hook shall be of chrome plated forged brass with concealed mounting plate.

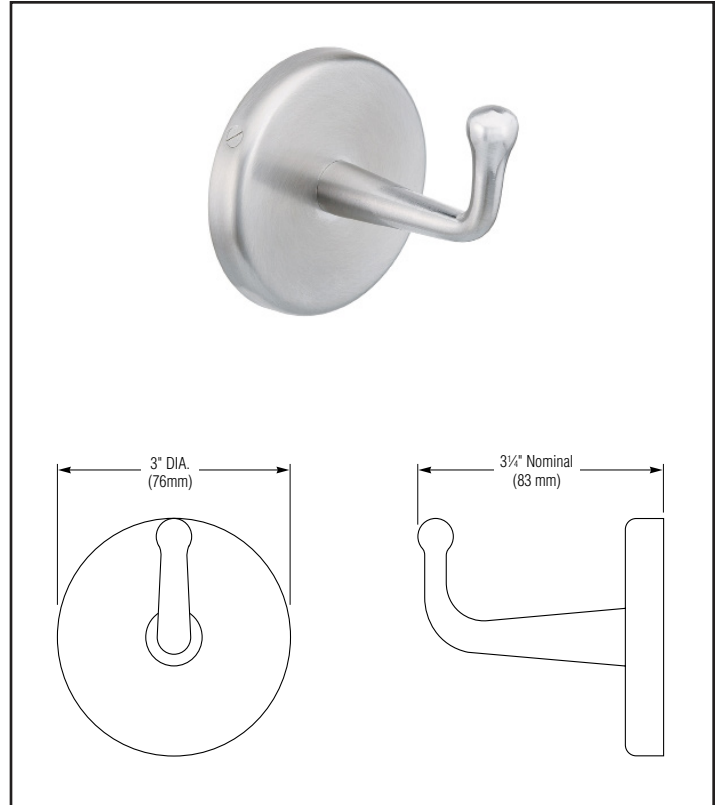

Orders composed of products indicated as **Bradex**<sup>®</sup> will be available to ship in three days after receipt of order at the factory. There is no pricing penalty for this service from Bradley.