

# APPLICATION CATALOG

CALIFORNIA DIESEL MANUFACTURING LLC





[www.california-diesel.com](http://www.california-diesel.com)

# CALIFORNIA DIESEL MANUFACTURING LLC

## LIMITED WARRANTY POLICY

THE FOLLOWING LIMITED WARRANTY APPLIES TO US AND CANADIAN CUSTOMERS ONLY.

CALIFORNIA DIESEL MANUFACTURING LLC WARRANTS OUR PRODUCTS TO BE FREE FROM DEFECTS IN MATERIAL OR WORKMANSHIP IN ACCORDANCE WITH THE FOLLOWING:

THE WARRANTY PERIOD COMMENCES THE DAY THE PRODUCT IS DELIVERED TO THE ORIGINAL CONSUMER PURCHASER. CALIFORNIA DIESEL MANUFACTURING LLC WARRANTS THAT IT WILL CREDIT OR REPLACE, FREE OF CHARGE, ANY PRODUCT WHICH, UNDER NORMAL CONDITIONS OF USE AND SERVICE, PROVES TO BE DEFECTIVE IN MATERIAL OR WORKMANSHIP AND WHICH IS WITHIN THE WARRANTY PERIOD BELOW.

### WARRANTY COVERAGE

THE CALIFORNIA DIESEL MANUFACTURING LLC LIMITED WARRANTY COVERS AND THEREFORE INCLUDES:

- DEFECTIVE PARTS IN MATERIAL AND WORKMANSHIP
- UNLIMITED MILES/KILOMETERS ON INSTALLED PARTS WITHIN THE FIRST 12 MONTHS AFTER COMMENCEMENT OF PART WARRANTY PERIOD

### WARRANTY EXCLUSIONS

THE CALIFORNIA DIESEL MANUFACTURING LLC LIMITED WARRANTY DOES NOT COVER AND THEREFORE EXCLUDES:

- LABOR COSTS INCURRED IN DIAGNOSIS OF DEFECTS OR ANY OTHER CONSEQUENTIAL EXPENSES
- FAILURES CAUSED BY FUEL OR OIL CONTAMINATION, FIRE DAMAGE, MISUSE, NEGLIGENCE, MODIFICATION, ABUSE, IMPROPER APPLICATION, INSTALLATION, OR OPERATION
- FAILURES CAUSED BY UNAUTHORIZED SERVICE OR USE OF UNAUTHORIZED PARTS

THIS WARRANTY IS IN LIEU OF ALL OTHER EXPRESS AND IMPLIED WARRANTIES, INCLUDING THE IMPLIED WARRANTIES OF MERCHANTABILITY AND FITNESS FOR A PARTICULAR PURPOSE. CALIFORNIA DIESEL MANUFACTURING LLC DOES NOT ASSUME ANY RESPONSIBILITY FOR INCIDENTAL OR CONSEQUENTIAL DAMAGES. THIS WARRANTY SETS OUT YOUR EXCLUSIVE REMEDIES WITH RESPECT TO THE PRODUCTS COVERED BY IT. NO ATTEMPT TO ALTER, MODIFY, OR AMEND THIS WARRANTY SHALL BE ALLOWED.

SOME COUNTRIES, STATES, PROVINCES, AND OTHER JURISDICTIONS DO NOT ALLOW LIMITATIONS ON HOW LONG IMPLIED WARRANTIES LAST, OR THE EXCLUSION OR LIMITATION OF INCIDENTAL OR CONSEQUENTIAL DAMAGES, SO THE ABOVE LIMITATIONS OR EXCLUSIONS MAY NOT APPLY TO YOU. THIS WARRANTY GIVES YOU SPECIFIC LEGAL RIGHTS, AND YOU MAY ALSO HAVE OTHER RIGHTS WHICH VARY FROM COUNTRY TO COUNTRY OR STATE TO STATE OR PROVINCE TO PROVINCE OR JURISDICTION TO JURISDICTION.

## CONTENTS

**SOLENOIDS**

**P.06**

**AUTOMOTIVE SENSORS**

**P.20**

FOR SPECIFIC NUMBER CHECK OUR INDEX

**DIESEL INJECTORS**

**P.68**

FORD

P.68

NAVISTAR

P.74

MISCELLANEOUS

P.90

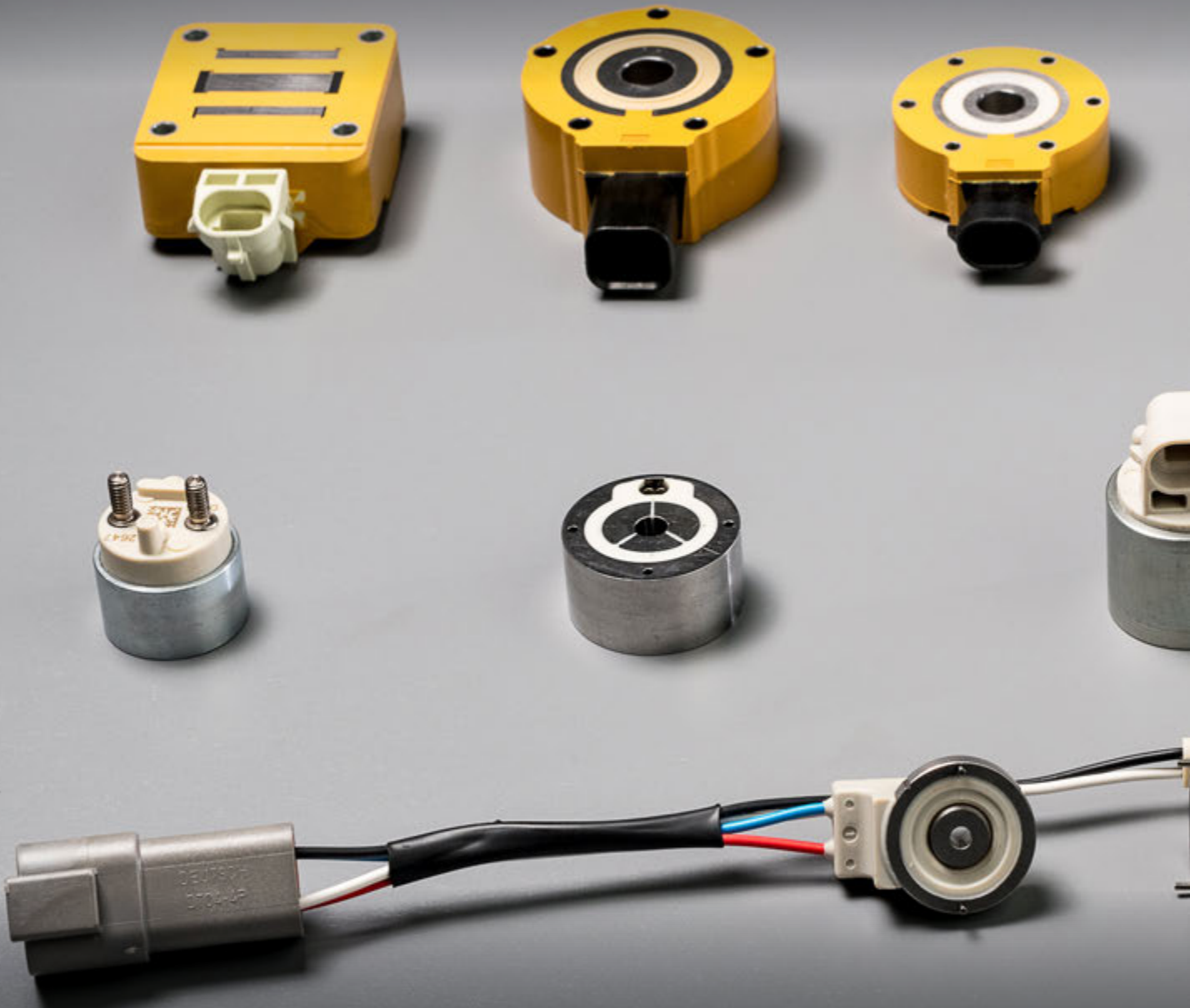

## CALIFORNIA DIESEL MANUFACTURING LLC

43114 BLACKDEER LOOP, SUITE F. TEMECULA, CALIFORNIA.

**OFFICE:** (+1) 951 296 9496 **MOBILE:** (+1) 951 375 6791

**EMAIL:** [contact@california-diesel.com](mailto:contact@california-diesel.com)

SOLENOIDS, SENSORS, DIESEL INJECTORS & MORE

[www.california-diesel.com](http://www.california-diesel.com)

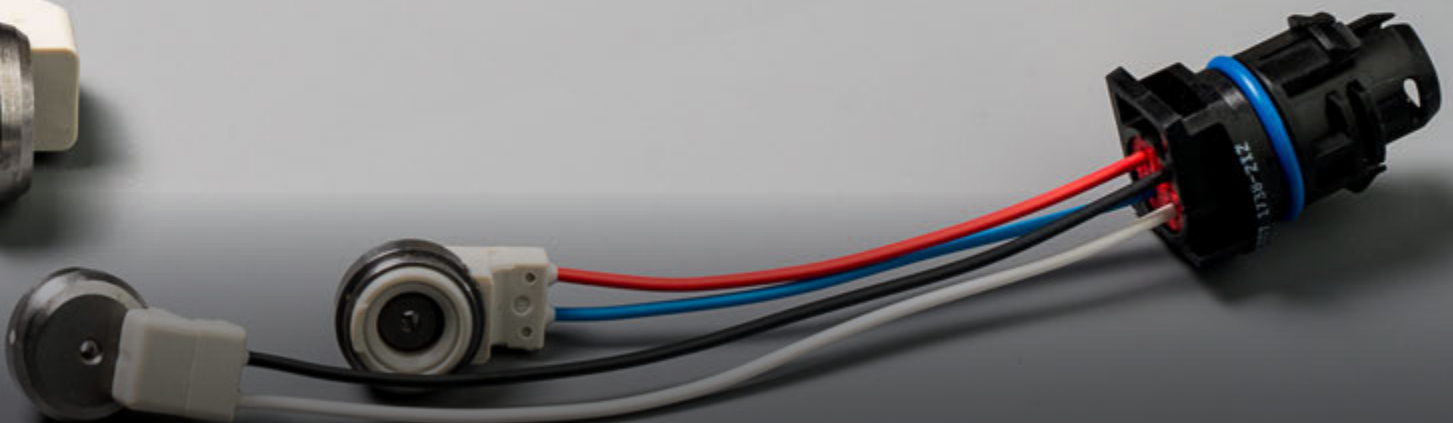

# SOLENOIDS

FOR DIESEL APPLICATIONS



(NOT FOR INFORMATIONAL PURPOSES)

### SOLENOID CAT 3406E (MEUI)

**Sku: So01**

#### DELPHI

GENUINE COIL 3406 FUEL INJECTOR EX630956 / EX630957 / EX630958 - 10R0956 / 10R0957 / 10R0958 - 14.6L/15.8L  
 C10 / C12 FUEL INJECTOR EX630725 / EX630961 / EX630963 / EX630967 / EX630968 - 10R0725 / 10R0961 / 10R0963 / 10R0967 / 10R0968 - 212-3464 - C10/C12/3176C/3196 / 212-3465, 116-5426 - C10/3176C / 212-3465, 137-2500, 147-0373, 160-1090, 160-2303, 194-5083, 212-3463 - C12/3196 / 161-1785, 116-5414, 212-3462 - C10/3176C / 116-5425, 156-1011, 212-3466 - C12/3196 C13 FUEL INJECTOR EX632977 / 10R2977, 249-0708

#### CATERPILLAR

3406E FUEL INJECTOR 10R0956, 10R0957, 10R0958  
 C10, C12 FUEL INJECTOR 10R0725  
 C15, C16 FUEL INJECTOR 10R1000  
 C15, 3406 FUEL INJECTOR 10R1273  
 C15, C16, 3406 FUEL INJECTOR 10R0955, 10R0956

#### PERKINS

CH10948 SERIES 2800 - 2645A749 / 1106C

#### KOMATSU

Komatsu Excavator Fuel Injector, D65EX-17 Injector, D85PX-15, D85EX-15, D85EX-15SL, D155AX-7, D275AX-5, D275AX-5SL, D475A-5, D375A-6, D475A-5SD, D65E-12, D65P-12, WD600-3, D375A-6, D375A-5, D31EX-22, D31PX-22, D37EX-23, D39EX-23

#### DELPHI / VOLVO

Delphi EUI D12 Injectors:  
 EX631002 / 12.1L, X-reference: Volvo 15479098112557  
 EX631004 / 12.1L, X-reference: Volvo 39644048113092  
 EX631006 / 12.1L, X-reference: Volvo 81131808170966  
 EX631007 / 12.1L, X-reference: Volvo 31695218113837



(NOT FOR INFORMATIONAL PURPOSES)

### SOLENOID CAT C7 / C9

**Sku: So02**

#### DELPHI

GENUINE COIL DELPHI C7 INJECTORS:  
 EX634761 / 10R4761 - 222-5959, 222-5961, 233-5636, 236-0973, 241-3238, 243-4502, 295-1408, 328-2583, 387-9430.  
 EX634762 / 10R4762 - 222-5962, 238-9808, 238-9809, 241-3239, 243-4503, 295-1409, 328-2584, 387-9429.  
 EX634763 / 10R4763 - 222-5958, 231-3400, 233-3535, 236-0974, 238-8091, 241-3400, 246-2343, 295-1410, 328-2582, 387-9428.

#### CATERPILLAR

GENUINE COIL CAT INJECTOR 10R4763 - CAT C7 ENGINES  
 CAT INJECTOR 10R4761 - CAT C7 / C9  
 CAT INJECTOR 10R4762 - CAT C7 ENGINES / 10R4762R, 10R-4762R



(NOT FOR INFORMATIONAL PURPOSES)

### SOLENOID CAT 3126

**Sku: So03**

#### FORD

GENUINE COIL POWER STROKE INJECTORS:  
 AP63800AA, AP63801AB

#### PURE POWER TECHNOLOGIES

T444E A-Series. 6999-PP (MY1994-97), 7000-PP9 (MY1996-98.5), 7001-PP (MY1996-98.5), 7002-PP (MY1999.5--03), 7003-PP (MY1999.5-03), 7004-PP (MY1996-99.5).

HEUI A-Series. 6999-PP (MY1994-96), 7000-PP9 (MY1997-98), 7001-PP (MY1997-98), 7002-PPM (MY1999-03), 7003-PP (MY1999-03)\*, 7004-PP (MY1997-98)\*.

HEUI B-Series. 6994-PP (MY1994-96), 6995-PP (MY1997-98), 7005-PP (MY1997-98), 7006-PP (MY1999-03), 7007-PP (MY1999-03), 7008-PP (MY1997-98), 7009-PP (MY1997-98), 7010-PP (MY1999-03), 7012-PP (MY1999-03), 7035-PP (MY1997-03).

\*CYL 8 Only

#### ALLIANT POWER

A-SERIES: AP63800AA, AP63801AB, AP63802AC, AP63803AD, AP63804AE.

B-SERIES: AP63805BA, AP63806BB, AP63807BC, AP63808BD, AP63809BE, AP63810BF, BG, AP63811BI, AP63812BJ, AP63813BN, AP63814BP.

#### NAVISTAR

A-SERIES: T444E  
 B-SERIES: DT466, I530, DT466 / 530, HT530

#### PERKINS

B-SERIES (BA, BD, BF, BI, BJ, BN, BP)

#### DETROIT DIESEL

B-SERIES (BA, BD, BF, BI, BJ, BN, BP)

#### AGCO

B-SERIES (BA, BD, BF, BI, BJ, BN, BP)





**SOLENOID CAT 3126 (BLUE EDITION)**

**Sku: So04**

**DELPHI**

GENUINE COIL 3406 FUEL INJECTOR EX630956 / EX630957 / EX630958 - 10R0956 / 10R0957 / 10R0958 - 14.6L/15.8L

C10 / C12 FUEL INJECTOR EX630725 / EX630961 / EX630963 / EX630967 / EX630968 - 10R0725 / 10R0961 / 10R0963 / 10R0967 / 10R0968 - 212-3464 - C10/C12/3176C/3196 / 212-3465, 116-5426 - C10/3176C / 212-3465, 137-2500, 147-0373, 160-1090, 160-2303, 194-5083, 212-3463 - C12/3196 / 161-1785, 116-5414, 212-3462 - C10/3176C / 116-5425, 156-1011, 212-3466 - C12/3196

C13 FUEL INJECTOR EX632977 / 10R2977, 249-0708

**PERKINS**

CH10948 SERIES 2800 - 2645A749 / 1106C

**KOMATSU**

Komatsu Excavator Fuel Injector:  
D65EX-17 Injector, D85PX-15, D85EX-15, D85EX-15SL, D155AX-7, D155AX-7, D275AX-5, D275AX-5SL, D475A-5, D375A-6, D475A-5SD, D65E-12, D65P-12, WD600-3, D375A-6, D375A-5, D31EX-22, D31PX-22, D37EX-23, D39EX-23

**DELPHI / VOLVO**

Delphi EUI D12 Injectors:  
EX631002 / 12.1L, X-reference: Volvo 15479098112557  
EX631004 / 12.1L, X-reference: Volvo 39644048113092  
EX631006 / 12.1L, X-reference: Volvo 81131808170966  
EX631007 / 12.1L, X-reference: Volvo 31695218113837

TO BE USED WITH AE INJECTORS, COMBINED WITH AD FULL SETS (7)AD INJECTORS & (1) AE INJECTOR (TO BE USED IN CYLINDER #8 ONLY) TO HELP "CLACKLE" ISSUES.

Ford 7.3L Powerstroke: AP63804AE.  
Navistar A-SERIES: T444E: AP63804AE.

**CATERPILLAR**

GENUINE COIL 3406E FUEL INJECTOR 10R0956, 10R0957, 10R0958  
C10, C12 FUEL INJECTOR 10R0725  
C15, C16 FUEL INJECTOR 10R1000  
C15, 3406 FUEL INJECTOR 10R1273  
C15, C16, 3406 FUEL INJECTOR 10R0955, 10R0956

**SOLENOID CAT C9 COMMON RAIL**

**Sku: So05**



**CATERPILLAR C9 ENGINES**

GENUINE COIL CAT: 363-0489 GP-FUEL INJECTOR  
CAT: 339-5599 PUMP GP-FUEL INJECTION

**CATERPILLAR C175 (MINING TRUCK)**

CAT: 340-6996  
CATERPILLAR 331-5895 GP-FUEL INJECTOR  
CAT: 797B, 3524B, C175-16/20

**OTHER MODELS**

CAT: 340-6996 MOTOR GRADER 160M 2 140M 2  
WHEEL-TYPE LOADER 966K 972K  
EXCAVATOR 336E L 336E 336E LN 568 FM 568 FM LL  
WHEEL TRACTOR-SCRAPER 627H  
TRACK-TYPE TRACTOR D6T LGP D6T XL D7E D6T XW D7E LGP

**SOLENOID G2.8 POWERSTROKE & NAVISTAR**

**Sku: So06**



**FORD**

GENUINE COIL POWER STROKE 6.0L & 4.5L  
F-SERIES, E-SERIES, EXCURSION

**PURE POWER TECHNOLOGIES**

NEW INJECTORS:  
FORD F-SERIES, E-SERIES, EXCURSION - 6901-PP (MY:2002.5-03)  
FORD F-SERIES, E-SERIES, EXCURSION - 6902-PP (MY:2004-09)

REMAN:  
FORD F-SERIES, E-SERIES, EXCURSION - 6918-PP (MY:2002.5-03)  
FORD F-SERIES, E-SERIES, EXCURSION - 6919-PP (MY:2004-09)

NEW INJECTORS:  
INTERNATIONAL VT365 - 6901-PP (MY:2002.5-03)  
INTERNATIONAL VT365, MAXXFORCE 5 - 6902-PP (MY:2004-10)

**REMAN:**

INTERNATIONAL VT365 - 6918-PP (MY:2002.5-03)  
INTERNATIONAL VT365, MAXXFORCE 5 - 6919-PP (MY:2004-10)

**ALLIANT POWER**

AP60900, AP60901

**NAVISTAR**

MAXXFORCE 5  
INTERNATIONAL VT365



## SOLENOID CAT C4.2, C6.4, C6.6 COMMON RAIL HP PUMP

**Sku: So07**



(SUPPORTS ARE FOR INFORMATIONAL / REFERENCE USE)

### CATERPILLAR

GENUINE COIL 10R-7660: CR PUMP 317-8021  
PUMP GP FUEL

### PERKINS

1100SERIES, 1106D-E66TA

### OTHER MODELS

WHEEL-TYPE LOADER  
924HZ, 924H, 938H, 930H, 928HZ, 928H

ENGINE - GENERATOR SET C6.6, C6.6 DE150E  
ENGINE - MACHINE C6.6

TRACK-TYPE LOADER 953D, 963D  
ENGINE - INDUSTRIAL C6.6

MOTOR GRADER 120M, 12M  
FOREST PRODUCTS 553C, 2470C, 559  
WHEELED EXCAVATOR  
M322D, M316D, M318D, M318D MH, M322D MH

PAVING COMPACTOR  
CS-78B, CP-56B, CS-74, CS-76, CS-56, CP-74, CP-74B,  
CS-64, CS-56B, CP-76, CP-68B, CP-56, CP-64, CS-68B,  
CS-74B, CS-79B  
ASPHALT PAVER BG655D, BG600D, AP-655D, AP-600D,  
AP-1000E, AP-1055E

INTEGRATED TOOL CARRIER IT38H

EXCAVATOR 320D L, 320D GC, 323D L, 320D

PIPELAYER PL61

WHEEL TRACTOR-SCRAPER 613G

TRACK-TYPE TRACTOR D6N, D6K XL, D5R XL, D5R LGP,  
D6K LGP, D6K

LOAD, HAUL, DUMP R1300G II 0SERIES, 1106D-E66TA

## SOLENOID CAT C13 / C15

**Sku: So08**



(SUPPORTS ARE FOR INFORMATIONAL / REFERENCE USE)

### CATERPILLAR

GENUINE COIL

C13 INJECTORS: 10R6163  
C15 INJECTORS: 10R6163



(SUPPORTS ARE FOR INFORMATIONAL / REFERENCE USE)

## SOLENOID G2.9 MAXXFORCE

**Sku: So09**

### NAVISTAR

GENUINE COIL  
NAVISTAR DT466 / 570, HT570  
MAXXFORCE DT / 9 / 10, N9 / N10

### PURE POWER TECHNOLOGIES

NEW INJECTORS:  
NAVISTAR - 6905-PP DT466 (MY:2004-05.5) LOW  
HP, 6906-PP DT466 (MY:2004-05.5) HIGH HP, 6907-  
PP DT570 (MY:2004-05.5) LOW HP, 6908-PP DT570  
(MY:2004-05.5) HIGH HP, 6909-PP DT466 (MY:2005.5-  
07) ALL HP, 6910-PP DT570 (MY:2005.5-07) LOW HP,  
6911-PP DT466 (MY:2005.5-07) HIGH HP, 6912-PP  
MAXXFORCE DT (MY:2007-10), 6913-PP MAXXFORCE  
9 (MY:2007-10), 6913-PP MAXXFORCE DT (MY:2007-  
10), 6914-PP MAXXFORCE DT (MY:2009-10), 6915-PP  
MAXXFORCE DT (MY:2010-18), 6916-PP MAXXFORCE  
DT (MY:2010-18)

REMAN:  
NAVISTAR -  
6922-PP DT466 (MY:2004-05.5) LOW HP,

6923-PP DT466 (MY:2004-05.5) HIGH HP, 6924-PP DT570  
(MY:2004-05.5) LOW HP, 6925-PP DT570 (MY:2004-  
05.5) HIGH HP, 6926-PP DT466 (MY:2005.5-07) ALL  
HP, 6927-PP DT570 (MY:2005.5-07) LOW HP, 6928-PP  
DT466 (MY:2005.5-07) HIGH HP, 6929-PP MAXXFORCE  
DT (MY:2007-10), 6930-PP MAXXFORCE 9 (MY:2007-  
10), 6931-PP MAXXFORCE DT (MY:2009-10), 6932-PP  
MAXXFORCE DT (MY:2010-18), 6933-PP MAXXFORCE DT  
(MY:2010-18)

### ALLIANT POWER

AP66995, AP66918, AP66921, AP66955, AP66957,  
AP66958, AP66895, AP66818, AP66821, AP66855,  
AP66857, AP66858, AP66976, AP66977, AP66978,  
AP66979, AP669789, AP66992, AP66876, AP66877,  
AP66878, AP66879, AP66889, AP66892





**SOLENOID CAT C9 COMMON RAIL HP PUMP**

**Sku: So10**



(SHAPED AS FOR INFORMATIONAL / REFERENCE USE)

**CATERPILLAR**

GENUINE COIL 3066, 3064, 3306, 3304, 3204, 3208, 3116, 3406, 3408, 3412, D330A, D330C, D343, D348, D399, D353, C9, C10, 3508, 3516, 3114

**KOMATSU**

2D92, 4D92, 4D94, 3D95, 4D95L, S495, 6D95, S6D95, S6D105, 6D105, S6D115, S6D102, 4D130, 4D120, 4D105-1, 4D105-5, 4D106, SD107, S6D108, S6D110, S6D125, S6D140, S6D155, S6D170

**MITSUBISHI DIESEL**

S6KT, S4KT, S4F, S4E, S4S, S6A, S6A2, S6B, S6B3, S12R, S6N, S6R, K4N, K4M

**MITSUBISHI**

6D34T, 6D31T, 4D34T, 4D31T, 4M40, 4M50, 6M60, 6D14T, 6D15T, 6D16T, 6D110, 6D22, 6D24T, 6BD1, 6DS7, 8DC8, 8DC9, 8DC11, 6D20, 6D24

**YANMAR**

3TNV84, 3TNE82, 4TNV84, 4TNE84, 4TNE88, 3TNV75, 3TNV74, 3TNV78, 4TNE94, 4TNV94L, 4TNV106, 4TNV98

**ISUZU**

3KC1, 3KR2, 4JB1, 4JC1, 4BD1T, C240, 6BD1T, 6BG1T, D500, 6WQ1, 6SD1T, 6RB1T, 6HK1T, 6BB1, 6BF1, DA640, DA220, E120, 4LE1, 4LE2, 6BD5.9, 6CT8.3, 4BT, 6BTAA, NH220, NT855, LTA10, KTA19, KTA38.

**DAEWU**

D1146, D2366, DB58, DO846, DB33

**VOLVO**

EC140B, EC210B, EC240B, EC290B, EC360B

**HINO**

HO6CT, HO7CT, EP100, EM100, EL100, EB100, WO6E

**SOLENOID CAT C320D COMMON RAIL**

**Sku: So11**



(SHAPED AS FOR INFORMATIONAL / REFERENCE USE)

**CATERPILLAR C6.4, C6.6**

GENUINE COIL

APPLICATIONS

320-0655, 320-0680, 326-4700, 326-4740, 320-0690, 320-0677, EXCHANGE NUMBER: 10R-7674, 10R-7672, 10R-7675. ENGINE SYSTEM: 315D, 320D, 323D

**SOLENOID CAT 3408 / 3412**

**Sku: So12**



(SHAPED AS FOR INFORMATIONAL / REFERENCE USE)

**CATERPILLAR + PERKINS**

GENUINE COIL

APPLICATIONS 3408, 3412 - 232-1183  
EXCHANGE NUMBER: 10R-1265, 10R-1266, 10R-1267  
ENGINE SYSTEM: 3408, 3408E, 3412





### SOLENOID CAT - ISUZU "TROOPER"

**Sku: So13**

**ISUZU**

GENUINE COIL TROOPER 4JX1, 3.0L ENGINE  
COMMON RAIL INJECTOR: 8-98245753-0, 8971925963



### SOLENOID\* BOSCH F00HN37431

**Sku: So14**

**BOSCH**

PRODUCT DIMENSIONS : 5.3 X 5.9 X 8.4 CM; 0.2 GRAMS  
DATE FIRST AVAILABLE : 5 SEPT. 2014  
MANUFACTURER : BOSCH  
ASIN : B00C7YGFG0  
ITEM MODEL NUMBER : F 00H N37 431



### SOLENOID\* DENSO 701

**Sku: So15**

**DENSO**

OEM NO/MODEL: 09500-534  
INTERCHANGEABLE WITH DENSO:  
095000-6700 095000-6701  
095000-5600 095000-8010  
095000-5471





**SOLENOID\* DENSO 704**

**Sku: So16**

**DENSO**

DENSO 704 COIL FOR COMMON RAIL INJECTOR.



**SOLENOID\* BOSCH F00RJ00395**

**Sku: So17**

**BOSCH**

F00RJ00395 COIL FOR COMMON RAIL INJECTOR  
0445120002 INJECTOR VALVE



**SOLENOID\* BOSCH F00VC30318**

**Sku: So18**

**BOSCH**

F00VC30318 COIL FOR COMMON RAIL INJECTOR  
MORE INFORMATION VISIT OUR WEB SITE.

\*Indicates aftermarket products / 6 months warranty





## CALIFORNIA DIESEL MANUFACTURING LLC

43114 BLACKDEER LOOP, SUITE F. TEMECULA, CALIFORNIA.

**OFFICE:** (+1) 951 296 9496 **MOBILE:** (+1) 951 375 6791

**EMAIL:** [contact@california-diesel.com](mailto:contact@california-diesel.com)

SOLENOIDS, SENSORS, DIESEL INJECTORS & MORE

**[www.california-diesel.com](http://www.california-diesel.com)**



# SOLENOIDS

FOR DIESEL APPLICATIONS



**SOLENOID\* BOSCH F00VC30319**

**Sku: So19**

**BOSCH**

F00VC30319 COIL FOR COMMON RAIL INJECTOR  
 INJECTOR MODEL:  
 0445110165/244/247/248/253/254/257/258/260/269/  
 270/273/276/280/281/307/310/312/328/329/330/356/381  
 /387/388/455/457/463/464/499/507/508



**SOLENOID\* BOSCH F00VC30057**

**Sku: So20**

**CATERPILLAR**

F00VC30057 COIL FOR COMMON RAIL INJECTOR  
 MODEL NUMBER L21B2F00VC30057  
 INJECTOR MODEL:  
 0445110008 0445110028 0445110029 0445110030  
 0445110031 0445110036 0445110044 0445110047  
 0445110048 0445110049 0445110057 0445110062  
 0445110064 0445110076 0445110101 0445110126  
 0445110130 0445110266 0445110290 0445110729



**SOLENOID\* BOSCH F00RJ02703**

**Sku: So21**

**NAVISTAR**

F00RJ02703 COIL FOR COMMON RAIL INJECTOR  
 INJECTOR MODEL:  
 0445120066/0445120067/0445120078/0445120081/0445  
 120083/0445120086/0445120087/0445120102/04451201  
 06/0445120110110/0445120117/0445120127/044512012  
 9/0445120130/0445120149/0445120150/0445120156/04  
 45120160/0445120163/0445120164





**SOLENOID\* DENSO**

**Sku: So22**

**DENSO**  
095000-6240/5471 COIL FOR COMMON RAIL  
INJECTOR



**SOLENOID\* CUMMINS N14 / L10 / M11**

**Sku: So23**

**CUMMINS**  
COIL FOR COMMON RAIL INJECTOR  
MODEL NUMBER K3000000M11N14  
INJECTOR MODEL:  
N14, L10, M11.



**SOLENOID\* F00HN37925**

**Sku: So24**

**BOSCH + SCANIA + IVECO**  
F00HN37925 COIL FOR COMMON RAIL INJECTOR  
SOLENOID VALVE KITS F00HN37925  
VALVE F 00H N37 925

\*Indicates aftermarket products / 6 months warranty



**SOLENOID\* BOSCH F00HN37933**

**Sku: So25**

**BOSCH - VOLVO**

F00HN37933 COIL BOSCH  
 VOLVO FL FH, VOLVO PENTA  
 D12A D12B D12C TAD1240  
 0414701004, 0414701055, 0414702XXX, 0986441006,  
 0 986 441 006, 8113408, 3155044, 8170569, 20381597,  
 20440409, 5238322, 9020440409, PDE100S3006,  
 PDE100S3007

BOSCH 0414700007



**SOLENOID\* DIESEL DETROIT SEREIES 50 & 60**

**Sku: So26**

**DIESEL DETROIT**

DETROIT R5236977 / 7650



**SOLENOID\* CUMMINS F00RJ02697**

**Sku: So27**

**CUMMINS + DODGE + IVECO + RENAULT**

0445120007  
 5.9L 359CU. IN. L6 DIESEL OHV TURBOCHARGED  
 RAM 2500 - 2003 - 07  
 RAM 3500 - 2003 - 07  
 RAM 4000 - 2006







**SOLENOID CUMMINS N14 / L10 / M11**

**Sku: So28**

**CUMMINS**

GENUINE COIL FOR COMMON RAIL INJECTOR  
 MODEL NUMBER K3000000M11N14  
 INJECTOR MODEL:  
 N14, L10, M11.



**SOLENOID\* G2.8 POWERSTROKE & NAVISTAR**

**Sku: So29**

**FORD**

POWER STROKE 6.0L & 4.5L  
 F-SERIES, E-SERIES, EXCURSION

**PURE POWER TECHNOLOGIES**

NEW INJECTORS:  
 FORD F-SERIES, E-SERIES, EXCURSION - 6901-PP  
 (MY:2002.5-03)  
 FORD F-SERIES, E-SERIES, EXCURSION - 6902-PP  
 (MY:2004-09)

REMAN:  
 FORD F-SERIES, E-SERIES, EXCURSION - 6918-PP  
 (MY:2002.5-03)  
 FORD F-SERIES, E-SERIES, EXCURSION - 6919-PP  
 (MY:2004-09)

NEW INJECTORS:  
 INTERNATIONAL VT365 - 6901-PP (MY:2002.5-03)  
 INTERNATIONAL VT365, MAXXFORCE 5 - 6902-PP  
 (MY:2004-10)

REMAN:  
 INTERNATIONAL VT365 - 6918-PP (MY:2002.5-03)  
 INTERNATIONAL VT365, MAXXFORCE 5 - 6919-PP  
 (MY:2004-10)

**ALLIANT POWER**

AP60900, AP60901

**NAVISTAR**

MAXXFORCE 5  
 INTERNATIONAL VT365

*DOES NOT INCLUDE CONNECTOR*

*\*Indicates aftermarket products / 6 months warranty*





## CALIFORNIA DIESEL MANUFACTURING LLC

43114 BLACKDEER LOOP, SUITE F. TEMECULA, CALIFORNIA.

**OFFICE:** (+1) 951 296 9496 **MOBILE:** (+1) 951 375 6791

**EMAIL:** [contact@california-diesel.com](mailto:contact@california-diesel.com)

SOLENOIDS, SENSORS, DIESEL INJECTORS & MORE

[www.california-diesel.com](http://www.california-diesel.com)

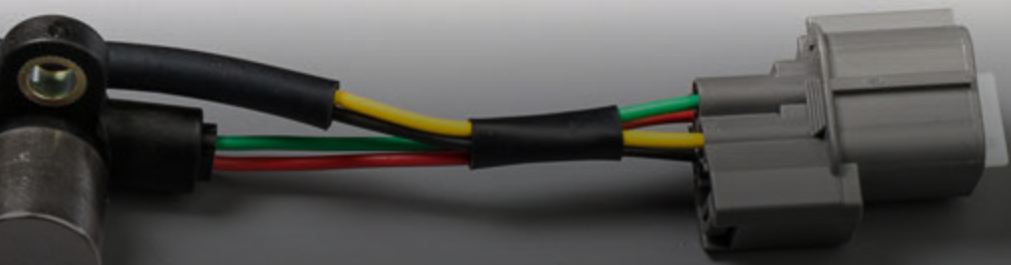

AUTOMOTIVE

# SENSORS

## SENSOR PC467 CAMSHAFT

**Sku: SECAM01**



### APPLICATIONS

JAGUAR (08-02)  
LINCOLN (05-02)

### INFORMATION ABOUT COMPATIBILITY

VISIT OUR WEBSITE OR CONTACT US

## SENSOR PC852 CAMSHAFT

**Sku: SECAM02**



### APPLICATIONS

FORD E-350 SUPER DUTY (19-17)  
FORD F-150 (14-11)  
FORD F-250 SUPER DUTY (19-11)  
FORD F-350 SUPER DUTY (19-11)

### INFORMATION ABOUT COMPATIBILITY

VISIT OUR WEBSITE OR CONTACT US

## SENSOR PC643 CAMSHAFT

**Sku: SECAM03**



### APPLICATIONS

FORD CROWN VICTORIA (11-92)  
FORD E-150 (08-03)  
FORD E-150 CLUB WAGON (05-03)  
FORD E-150 ECONOLINE (02-97)  
FORD E-150 ECONOLINE CLUB WAGON (02-97)  
FORD E-250 (08-03)  
FORD E-250 ECONOLINE (02-98)  
FORD E-350 CLUB WAGON (05-03)  
FORD E-350 ECONOLINE (00-97)  
FORD E-350 ECONOLINE CLUB WAGON (02-97)  
FORD E-350 SUPER DUTY (19-99)  
FORD E-450 ECONOLINE SUPER DUTY (02-00)  
FORD E-450 SUPER DUTY (18-13), (10-03)  
FORD E-550 ECONOLINE SUPER DUTY (02)  
FORD E-550 SUPER DUTY (03)  
FORD ECONOLINE SUPER DUTY (99-97)  
FORD EXCURSION (05-00)  
FORD EXPEDITION (14-97)  
FORD EXPLORER (10-02)  
FORD EXPLORER SPORT TRAC (10-07)  
FORD F-150 (10-97)  
FORD F-150 HERITAGE (04)

FORD F-250 (99-97)  
FORD F-250 SUPER DUTY (10-99)  
FORD F-350 SUPER DUTY (10-99)  
FORD F-450 SUPER DUTY (19-14), (12-11), (08-98)  
FORD F53 (19-99)  
FORD F-550 SUPER DUTY (19-11), (08-99)  
FORD GRAND MARQUIS (04-01)  
FORD MUSTANG (14-96)  
FORD TAURUS (99-96)  
FORD TEMPO (94-90)  
FORD THUNDERBIRD (97-94)  
JAGUAR S-TYPE (01-00)  
LINCOLN AVIATOR (05)  
LINCOLN BLACKWOOD (02) +  
MERCURY COUGAR (97-94)  
MERCURY GRAND MARQUIS (11-92)  
MERCURY MOUNTAINEER (10-02)  
MERCURY TOPAZ (94-90)

### INFORMATION ABOUT COMPATIBILITY

VISIT OUR WEBSITE OR CONTACT US

**SENSOR PC645 CAMSHAFT / AP63415**

**Sku: SECAM04**



**APPLICATIONS**

- FORD E-350 CLUB WAGON (05-04)
- FORD E-350 SUPER DUTY (10-04)
- FORD E-450 SUPER DUTY (10-09), (07-04)
- FORD EXCURSION (05-03)
- FORD F-250 SUPER DUTY (10-03)
- FORD F-350 SUPER DUTY (10-03)
- FORD F-450 SUPER DUTY (10-03)
- FORD F-550 SUPER DUTY (10-03)
- FORD F-650 (07-04)
- FORD F-750 (07-04)
- FORD LCF (09-06)

**INFORMATION ABOUT COMPATIBILITY**

VISIT OUR WEBSITE OR CONTACT US

**SENSOR PC915 CAMSHAFT**

**Sku: SECAM05**



**APPLICATIONS**

- FORD EDGE (18-15)
- FORD EXPLORER (19-13)
- FORD F-150 (18-11)
- FORD FLEX (13)
- FORD POLICE INTERCEPTOR SEDAN (19-13)
- FORD POLICE INTERCEPTOR UTILITY (19-14)
- FORD TAURUS (14-13)
- FORD TRANSIT-150 (15)
- FORD TRANSIT-250 (18-15)
- FORD TRANSIT-350 (15)
- LINCOLN MKS (14-13)
- LINCOLN MKT (14-13)

**INFORMATION ABOUT COMPATIBILITY**

VISIT OUR WEBSITE OR CONTACT US

**SENSOR PC320 CAMSHAFT**

**Sku: SECAM06**



**APPLICATIONS**

- LINCOLN LS (01-00)

**INFORMATION ABOUT COMPATIBILITY**

VISIT OUR WEBSITE OR CONTACT US

**SENSOR PC321 CAMSHAFT**

**Sku: SECAM07**



**APPLICATIONS**

- FORD EXPLORER (01-99)
- FORD FREESTAR (07-04)
- FORD MUSTANG (04-99)
- FORD RANGER (08-99)
- FORD SABLE (01)
- FORD TAURUS (07-98)
- FORD THUNDERBIRD (03-02)
- FORD WINDSTAR (03-98)
- MAZDA B3000 (07-98)
- MERCURY MONTEREY (07-04)
- MERCURY MOUNTAINEER (01-00)
- MERCURY SABLE (05-98)

**INFORMATION ABOUT COMPATIBILITY**

VISIT OUR WEBSITE OR CONTACT US

**SENSOR PC916 CAMSHAFT**

**Sku: SECAM08**



**APPLICATIONS**

- FORD E-350 SUPER DUTY (19-17)
- FORD F-150 (14-11)
- FORD F-250 SUPER DUTY (19-11)
- FORD F-350 SUPER DUTY (19-11)

**INFORMATION ABOUT COMPATIBILITY**

VISIT OUR WEBSITE OR CONTACT US

**SENSOR PC773 CAMSHAFT**

**Sku: SECAM09**



**APPLICATIONS**

- FORD F-150 (17-11)
- FORD MUSTANG (16), (14-11)

**INFORMATION ABOUT COMPATIBILITY**

VISIT OUR WEBSITE OR CONTACT US



**SENSOR PC318 CAMSHAFT**

**Sku: SECAM10**



**APPLICATIONS**  
 FORD RANGER (01-95)  
 MAZDA B2300 (97-94)  
 MAZDA B2500 (01-98)

**INFORMATION ABOUT COMPATIBILITY**  
 VISIT OUR WEBSITE OR CONTACT US

**SENSOR PC380 CAMSHAFT**

**Sku: SECAM11**



**APPLICATIONS**  
 JEEP CHEROKEE (01-00)  
 JEEP GRAND CHEROKEE (04-99)  
 JEEP TJ (04-01)  
 JEEP WRANGLER (04-00)

**INFORMATION ABOUT COMPATIBILITY**  
 VISIT OUR WEBSITE OR CONTACT US

**SENSOR PC380T CAMSHAFT**

**Sku: SECAM12**



**APPLICATIONS**  
 JEEP CHEROKEE (01-00)  
 JEEP GRAND CHEROKEE (04-99)  
 JEEP TJ (04-01)  
 JEEP WRANGLER (04-00)

**INFORMATION ABOUT COMPATIBILITY**  
 VISIT OUR WEBSITE OR CONTACT US



**SENSOR PC622 / DU67 CAMSHAFT**

**Sku: SECAM13**

**APPLICATIONS**

- FORD ESCAPE (08-07)
- FORD FUSION (10-06)
- LINCOLN ZEPHYR (06)
- MAZDA 6 (08-03)
- MERCURY MARINER (08-07)
- MERCURY MILAN (10-06)

**INFORMATION ABOUT COMPATIBILITY**

VISIT OUR WEBSITE OR CONTACT US



**SENSOR PC872 CAMSHAFT**

**Sku: SECAM14**

**APPLICATIONS**

- FORD E-150 (14-09)
- FORD E-250 (14-09)
- FORD E-350 SUPER DUTY (16-09)
- FORD E-450 SUPER DUTY (16-09)
- FORD F-150 (10-06)
- FORD F-250 SUPER DUTY (10)
- FORD F-450 SUPER DUTY (10)
- FORD F-550 SUPER DUTY (10-09)

**INFORMATION ABOUT COMPATIBILITY**

VISIT OUR WEBSITE OR CONTACT US



**SENSOR PC69 / ASY CAMSHAFT**

**Sku: SECAM15**

**APPLICATIONS**

- FORD EXPLORER (04-02)
- FORD GT (06-05)
- LINCOLN AVIATOR (04-03)
- LINCOLN CONTINENTAL (02-91)
- MERCURY MARAUDER (04-03)

**INFORMATION ABOUT COMPATIBILITY**

VISIT OUR WEBSITE OR CONTACT US



**SENSOR PC1048 CAMSHAFT**

**Sku: SECAM16**



**APPLICATIONS**

- FORD TRANSIT (17-15), (13-07)
- FORD TRANSIT-150 (19-15)
- FORD TRANSIT-250 (19-15)
- FORD TRANSIT-350 (19-15)
- FORD TRANSIT-350 HD (19-15)

**INFORMATION ABOUT COMPATIBILITY**

VISIT OUR WEBSITE OR CONTACT US

**SENSOR PC950 CAMSHAFT**

**Sku: SECAM17**



**APPLICATIONS**

- CHRYSLER 200 (17-11)
- CHRYSLER 300 (20-11)
- CHRYSLER TOWN & COUNTRY (16-11)
- DODGE AVENGER (14-11)
- DODGE CHALLENGER (17-11)
- DODGE CHARGER (20-11)
- DODGE DURANGO (20-11)
- DODGE GRAND CARAVAN (20-11)
- DODGE JOURNEY (19-11)
- HYUNDAI TUCSON (17-16)
- JEEP CHEROKEE (20-14)
- JEEP GRAND CHEROKEE (20-11)
- JEEP WRANGLER (20-12)

- RAM 1500 (20-13)
- RAM C/V (15-12)
- RAM PROMASTER 1500 (18-17), (15-14)
- RAM PROMASTER 2500 (18-14)
- RAM PROMASTER 3500 (18-14)

**INFORMATION ABOUT COMPATIBILITY**

VISIT OUR WEBSITE OR CONTACT US

**SENSOR PC980 CAMSHAFT**

**Sku: SECAM18**



**APPLICATIONS**

- CHRYSLER 200 (17-15)
- DODGE DART (16-13)
- JEEP CHEROKEE (20-14)
- JEEP GRAND CHEROKEE (20-16)
- JEEP RENEGADE (19-15)
- RAM 1500 (20-13)
- RAM PROMASTER CITY (20-15)

**INFORMATION ABOUT COMPATIBILITY**

VISIT OUR WEBSITE OR CONTACT US



## **CALIFORNIA DIESEL MANUFACTURING LLC**

43114 BLACKDEER LOOP, SUITE F. TEMECULA, CALIFORNIA.

**OFFICE:** (+1) 951 296 9496 **MOBILE:** (+1) 951 375 6791

**EMAIL:** [contact@california-diesel.com](mailto:contact@california-diesel.com)

SOLENOIDS, SENSORS, DIESEL INJECTORS & MORE

**[www.california-diesel.com](http://www.california-diesel.com)**



AUTOMOTIVE

# SENSORS

**SENSOR FAE 79246 CAMSHAFT**

**Sku: SECAM19**



**APPLICATIONS**

- FORD FOCUS II 1.8 TDCI (2004 - 2012)
- FORD MONDEO MK III 2.0 TDCI (2000 - 2007)
- FORD TRANSIT CONNECT 1.8 TDCI (2002 - )
- FORD FOCUS HATCHBACK 1.8 TDCI (1998 - 2007)
- FORD TRANSIT CONNECT 1.8 DI (2002 - )
- FORD S-MAX MPV 1.8 TDCI (2006 - 2014)
- FORD FOCUS II S. WAGON 1.8 TDCI (2004 - 2012)
- FORD FOCUS H.BACK 1.8 TURBO DI / TDDI (98 -07)
- FORD FOCUS C-MAX 1.6 (2003 - 2007)
- FORD FOCUS HATCHBACK 1.8 TDCI (1998 - 2007)

**INFORMATION ABOUT COMPATIBILITY**

VISIT OUR WEBSITE OR CONTACT US

**SENSOR 2872279 CAMSHAFT**

**Sku: SECAM20**



**APPLICATIONS**

- DODGE (07-16)
- CUMMINS ISX SERIES
- DIESEL ENGINES PRODUCED AFTER 2001*
- CUMMINS 4921686
- CUMMINS 3408531NX
- CUMMINS 3408531

**INFORMATION ABOUT COMPATIBILITY**

VISIT OUR WEBSITE OR CONTACT US

**SENSOR PC325 CAMSHAFT**

**Sku: SECAM21**



**APPLICATIONS**

- FORD BRONCO (96)
- FORD E-150 ECONOLINE (96)
- FORD E-150 ECONOLINE CLUB WAGON (96)
- FORD E-250 ECONOLINE (96)
- FORD E-350 ECONOLINE (96)
- FORD E-350 ECONOLINE CLUB WAGON (96)
- FORD ECONOLINE SUPER DUTY (96)
- FORD EXPLORER (01-96)
- FORD F-150 (96)
- FORD F-250 (97-96)
- FORD F-350 (98-96)
- LAFORZA LAFORZA (01-98)
- MERCURY MOUNTAINEER (01-97)

**INFORMATION ABOUT COMPATIBILITY**

VISIT OUR WEBSITE OR CONTACT US



**SENSOR PC917 / SU14281 CAMSHAFT**

**Sku: SECAM22**



**APPLICATIONS**

- FORD EDGE (17-12)
- FORD ESCAPE (18-13)
- FORD EXPLORER (16-12)
- FORD FOCUS (18-12)
- FORD FUSION (16-13)
- FORD MUSTANG (17-15)
- FORD TAURUS (17-13)
- JAGUAR XE (17)
- JAGUAR XF (15-13)
- LAND ROVER DISCOVERY SPORT (17-15)
- LAND ROVER LR2 (15-13)
- LAND ROVER RANGE ROVER EVOQUE (17-12)
- LINCOLN MKZ (20-13)

**INFORMATION ABOUT COMPATIBILITY**

VISIT OUR WEBSITE OR CONTACT US

**SENSOR PC325T / SU2037 CAMSHAFT**

**Sku: SECAM23**



**APPLICATIONS**

- FORD BRONCO (96)
- FORD E-150 ECONOLINE (96)
- FORD E-150 ECONOLINE CLUB WAGON (96)
- FORD E-250 ECONOLINE (96)
- FORD E-350 ECONOLINE (96)
- FORD E-350 ECONOLINE CLUB WAGON (96)
- FORD ECONOLINE SUPER DUTY (96)
- FORD EXPLORER (01-96)
- FORD F-150 (96)
- FORD F-250 (97-96)
- FORD F-350 (98-96)
- LAFORZA LAFORZA (01-98)
- MERCURY MOUNTAINEER (01-97)

- RAM 1500 (20-13)
- RAM C/V (15-12)
- RAM PROMASTER 1500 (18-17), (15-14)
- RAM PROMASTER 2500 (18-14)
- RAM PROMASTER 3500 (18-14)

**INFORMATION ABOUT COMPATIBILITY**

VISIT OUR WEBSITE OR CONTACT US

**SENSOR PC353 / 22009 CAMSHAFT**

**Sku: SECAM24**



**APPLICATIONS**

- FORD ESCORT (02-91)
- FORD FOCUS (04-00)
- MERCURY TRACER (99-91)

**INFORMATION ABOUT COMPATIBILITY**

VISIT OUR WEBSITE OR CONTACT US



**SENSOR PC483 / SU2017 CAMSHAFT**

**Sku: SECAM25**



**APPLICATIONS**

- FORD E-150 ECONOLINE (96)
- FORD E-150 ECONOLINE CLUB WAGON (96)
- FORD E-250 ECONOLINE (96)
- FORD E-350 ECONOLINE (96)
- FORD E-350 ECONOLINE CLUB WAGON (96)
- FORD F-150 (96)
- FORD F-250 (96)
- FORD F-350 (96)

**INFORMATION ABOUT COMPATIBILITY**

VISIT OUR WEBSITE OR CONTACT US

**SENSOR PC264 / SU4172 CAMSHAFT**

**Sku: SECAM27**



**APPLICATIONS**

- HONDA ACCORD (97-95)

**INFORMATION ABOUT COMPATIBILITY**

VISIT OUR WEBSITE OR CONTACT US

**SENSOR LX260 CAMSHAFT**

**Sku: SECAM28**



**APPLICATIONS**

- FORD AEROSTAR (97-95)
- FORD E-150 (03)
- FORD E-150 CLUB WAGON (03)
- FORD E-150 ECONOLINE (02-97)
- FORD E-150 ECONOLINE CLUB WAGON (02-97)
- FORD E-250 (03)
- FORD E-250 ECONOLINE (02-97)
- FORD EXPLORER (99-95)
- FORD F-150 (08-05), (03-97)
- FORD F-150 HERITAGE (04)
- FORD MUSTANG (98-96)
- FORD RANGER (00-95)
- FORD TAURUS (97-92)
- FORD THUNDERBIRD (97-96)
- FORD WINDSTAR (98-95)
- MAZDA B3000 (97-94)
- MAZDA B4000 (03-97)
- MERCURY COUGAR (97-96)
- MERCURY MOUNTAINEER (99-97)
- MERCURY SABLE (97-92)

**INFORMATION ABOUT COMPATIBILITY**

VISIT OUR WEBSITE OR CONTACT US

**SENSOR PC498 CAMSHAFT / AP63412**

**Sku: SECAM30**



**APPLICATIONS**

- FORD E-350 CLUB WAGON (05-04)
- FORD E-350 SUPER DUTY (10-04)
- FORD E-450 SUPER DUTY (10-04)
- FORD EXCURSION (05)
- FORD F-250 SUPER DUTY (10-03)
- FORD F-350 SUPER DUTY (10-03)
- FORD F-450 SUPER DUTY (10-03)
- FORD F-550 SUPER DUTY (10-03)
- FORD F-650 (08-03)
- FORD F-750 (08-03)

**INFORMATION ABOUT COMPATIBILITY**

VISIT OUR WEBSITE OR CONTACT US

**SENSOR PC140 / DU69 CAMSHAFT**

**Sku: SECAM31**



**APPLICATIONS**

- FORD CONTOUR (00-95)
- FORD ESCAPE (06-01)
- FORD FIVE HUNDRED (07-05)
- FORD GRAND MARQUIS (99-95)
- FORD LOBO (06-01)
- FORD MONDEO (07-01)
- FORD MYSTIQUE (00-95)
- FORD SABLE (00-96)
- FORD TAURUS (05-96)
- MAZDA MPV (06-00)
- MAZDA TRIBUTE (08), (06-01)
- MERCURY COUGAR (02-99)
- MERCURY MYSTIQUE (00-95)
- MERCURY SABLE (05-96)

**INFORMATION ABOUT COMPATIBILITY**

VISIT OUR WEBSITE OR CONTACT US

**SENSOR PC603 / F7TZ-12K07-3A CAMSHAFT**

**Sku: SECAM32**



**APPLICATIONS**

- FORD E-350 CLUB WAGON (03)
- FORD E-350 ECONOLINE (98-97)
- FORD E-350 ECONOLINE CLUB WAGON (02-97)
- FORD E-350 SUPER DUTY (03-99)
- FORD E-450 ECONOLINE SUPER DUTY (02-00)
- FORD E-450 SUPER DUTY (03)
- FORD E-550 ECONOLINE SUPER DUTY (02)
- FORD E-550 SUPER DUTY (03)
- FORD ECONOLINE SUPER DUTY (99-97)
- FORD EXCURSION (03-00)
- FORD F SUPER DUTY (97)
- FORD F-250 (97)
- FORD F-250 HD (97)
- FORD F-250 SUPER DUTY (03-99)
- FORD F-350 (97)
- FORD F-350 SUPER DUTY (03-99)
- FORD F-450 SUPER DUTY (03-99)
- FORD F-550 SUPER DUTY (03-99)
- FORD F59 (97)
- FORD F-650 (03-00)
- FORD F-750 (03-00)

**INFORMATION ABOUT COMPATIBILITY**

VISIT OUR WEBSITE OR CONTACT US

**SENSOR PC139 / F4TZ-12K07-3C CAMSHAFT**

**Sku: SECAM33**



**APPLICATIONS**

- FORD E-350 ECONOLINE (96-95)
- FORD E-350 ECONOLINE CLUB WAGON (96-95)
- FORD ECONOLINE SUPER DUTY (96)
- FORD F SUPER DUTY (96-94)
- FORD F-250 (96-94)
- FORD F-350 (96-94)
- FORD F59 (96-95)
- INTERNATIONAL 1552SC (98-97)
- INTERNATIONAL 1652SC (02-94)
- INTERNATIONAL 1652UPS (97-95)
- INTERNATIONAL 3000 (00-97)
- INTERNATIONAL 3000RE (01)
- INTERNATIONAL 3400 (02-96)
- INTERNATIONAL 3600 (99-94)
- INTERNATIONAL 3700 (94)
- INTERNATIONAL 3800 (03-94)
- INTERNATIONAL 4600 (95)
- INTERNATIONAL 4600LP (94)
- INTERNATIONAL 4700 (02-94)
- INTERNATIONAL 4700LP (02-94)

**INFORMATION ABOUT COMPATIBILITY**

VISIT OUR WEBSITE OR CONTACT US

**SENSOR PC139T / F4TZ-12K07-3C CAMSHAFT**

**Sku: SECAM34**



**APPLICATIONS**

- FORD E-350 ECONOLINE (96-95)
- FORD E-350 ECONOLINE CLUB WAGON (96-95)
- FORD ECONOLINE SUPER DUTY (96)
- FORD F SUPER DUTY (96-94)
- FORD F-250 (96-94)
- FORD F-350 (96-94)
- FORD F59 (96-95)
- INTERNATIONAL 1552SC (98-97)
- INTERNATIONAL 1652SC (02-94)
- INTERNATIONAL 1652UPS (97-95)
- INTERNATIONAL 3000 (00-97)
- INTERNATIONAL 3000RE (01)
- INTERNATIONAL 3400 (02-96)
- INTERNATIONAL 3600 (99-94)
- INTERNATIONAL 3700 (94)
- INTERNATIONAL 3800 (03-94)

- INTERNATIONAL 4600 (95)
- INTERNATIONAL 4600LP (94)
- INTERNATIONAL 4700 (02-94)
- INTERNATIONAL 4700LP (02-94)
- INTERNATIONAL 4700LPX (02-95)
- INTERNATIONAL 4800 (97-95)
- INTERNATIONAL 4900 (97-95)
- INTERNATIONAL 7100 (95-94)
- INTERNATIONAL GENESIS RE (02-96)

**INFORMATION ABOUT COMPATIBILITY**

VISIT OUR WEBSITE OR CONTACT US

**SENSOR 1885812C91 / F7TZ-12K073-B CAMSHAFT**

**Sku: SECAM35**



**APPLICATIONS**

- FORD E-350 CLUB WAGON (03)
- FORD E-350 ECONOLINE (98-97)
- FORD E-350 ECONOLINE CLUB WAGON (02-97)
- FORD E-350 SUPER DUTY (03-99)
- FORD E-450 ECONOLINE SUPER DUTY (02-00)
- FORD E-450 SUPER DUTY (03)
- FORD E-550 ECONOLINE SUPER DUTY (02)
- FORD E-550 SUPER DUTY (03)
- FORD ECONOLINE SUPER DUTY (99-97)
- FORD EXCURSION (03-00)
- FORD F SUPER DUTY (97)
- FORD F-250 (97)
- FORD F-250 HD (97)
- FORD F-250 SUPER DUTY (03-99)
- FORD F-350 (97)
- FORD F-350 SUPER DUTY (03-99)
- FORD F-450 SUPER DUTY (03-99)
- FORD F-550 SUPER DUTY (03-99)
- FORD F59 (97)
- FORD F-650 (03-00)
- FORD F-750 (03-00)

**REPLACES**

- OE-GENUINED REPLACEMENT
- INTERNATIONAL NUMBERS:
- 1807339C92, 1807339C93, 1825899C93, 1885812C91.

- FORD NUMBERS:
- F7TZ-12K073-A, F7TZ 12K073-B

**INFORMATION ABOUT COMPATIBILITY**

VISIT OUR WEBSITE OR CONTACT US





**SENSOR PC867 CRANKSHAFT**

**Sku: SECR01**



**APPLICATIONS**

- FORD F-150 (14-10)
- FORD F-250 SUPER DUTY (20-11)
- FORD F-350 (16-11)
- FORD F-350 SUPER DUTY (20-11)

**INFORMATION ABOUT COMPATIBILITY**

VISIT OUR WEBSITE OR CONTACT US

**SENSOR PC285 CRANKSHAFT**

**Sku: SECR02**



**APPLICATIONS**

- FORD RANGER (01-95)
- MAZDA B2300 (97-95)
- MAZDA B2500 (01-98)

**INFORMATION ABOUT COMPATIBILITY**

VISIT OUR WEBSITE OR CONTACT US

- FORD E-550 SUPER DUTY (03)
- FORD ECONOLINE (06-99)
- FORD ECONOLINE SUPER DUTY (99-97)
- FORD EXCURSION (05-00)
- FORD EXPEDITION (14-97)
- FORD EXPLORER (10-02)
- FORD EXPLORER SPORT TRAC (10-07)

**SENSOR PC319 CRANKSHAFT**

**Sku: SECR03**



**APPLICATIONS**

- AVANTI AVANTI (07-05)
- FORD CROWN VICTORIA (11-92)
- FORD E-150 (14-03)
- FORD E-150 CLUB WAGON (05-03)
- FORD E-150 ECONOLINE (08-07), (02-97)
- FORD E-150 ECONOLINE CLUB WAGON (02-97)
- FORD E-250 (14-03)
- FORD E-250 ECONOLINE (02-97)
- FORD E-350 CLUB WAGON (05-03)
- FORD E-350 ECONOLINE (08-07), (00-97)
- FORD E-350 ECONOLINE CLUB WAGON (02-97)
- FORD E-350 SUPER DUTY (19-99)
- FORD E-450 ECONOLINE SUPER DUTY (02-00)
- FORD E-450 SUPER DUTY (19-03)
- FORD E-550 ECONOLINE SUPER DUTY (02)
- FORD F-150 (10-97)
- FORD F-150 HERITAGE (04)
- FORD F-250 (09-03), (01-97)
- FORD F-250 SUPER DUTY (10-99)
- FORD F-350 (09-00)
- FORD F-350 SUPER DUTY (10-99)
- FORD F-450 SUPER DUTY (19-14), (12-99)
- FORD F53 (19-99)

- FORD F-550 SUPER DUTY (19-99)
- FORD GRAND MARQUIS (04-95)
- FORD GT (06-05)
- FORD LOBO (08-01)
- FORD MUSTANG (14), (12-96)
- FORD THUNDERBIRD (97-94)
- LINCOLN AVIATOR (05-03)
- LINCOLN BLACKWOOD (03-02)
- LINCOLN MARK LT (08-06)
- LINCOLN MARK VIII (98-93)
- LINCOLN NAVIGATOR (14-98)
- LINCOLN TOWN CAR (11-91)
- MERCURY COUGAR (97-94)
- MERCURY GRAND MARQUIS (11-92)
- MERCURY MARAUDER (04-03)
- MERCURY MOUNTAINEER (10-02)
- PANOZ AIV ROADSTER (00-99)
- PANOZ ESPERANTE (07-01)
- QVALE MANGUSTA (02-01)

**INFORMATION ABOUT COMPATIBILITY**

VISIT OUR WEBSITE OR CONTACT US



### SENSOR PC434 CRANKSHAFT

**Sku: SECR04**



**APPLICATIONS**

FORD AEROSTAR (97-96)  
 FORD TAURUS (07-00)  
 MERCURY SABLE (05-00)

**INFORMATION ABOUT COMPATIBILITY**

VISIT OUR WEBSITE OR CONTACT US

### SENSOR PC429 CRANKSHAFT

**Sku: SECR05**



**APPLICATIONS**

FORD ESCORT.  
 2001 SE 2.0L, 2002 SE 2.0L  
 FORD FOCUS.  
 2001 (SUBMODEL: LX, SE) 2.0L, 2002 (SUBMODEL: LX, SE) 2.0L, 2003 (SUBMODEL: LX, SE) 2.0L, 2004 LX 2.0L

**INFORMATION ABOUT COMPATIBILITY**

VISIT OUR WEBSITE OR CONTACT US

### SENSOR PC122 CRANKSHAFT

**Sku: SECR06**



**APPLICATIONS**

CHEVROLET CAVALIER (02-97)  
 CHEVROLET S10 (93-90), (03-96)  
 CHEVROLET VECTRA (03)  
 GMC SONOMA (03-96)  
 ISUZU HOMBRE (00-97)  
 PONTIAC SUNFIRE (02-97)

**INFORMATION ABOUT COMPATIBILITY**

VISIT OUR WEBSITE OR CONTACT US

## SENSOR PC134 CRANKSHAFT

**Sku: SEC07**



### APPLICATIONS

BUICK RAINIER (07-04)  
 BUICK SKYLARK (98-88)  
 CHEVROLET ASTRA (03-01)  
 CHEVROLET BERETTA (94-90)  
 CHEVROLET CAVALIER (05-95)  
 CHEVROLET CLASSIC (05-04)  
 CHEVROLET COBALT (06-05)  
 CHEVROLET HHR (06)  
 CHEVROLET MALIBU (99-97), (06-04)  
 CHEVROLET TRAILBLAZER (07-02)  
 CHEVROLET TRAILBLAZER EXT (06-02)  
 CHEVROLET ZAFIRA (04-02)  
 GMC ENVOY (07-02)  
 GMC ENVOY XL (06-02)  
 GMC ENVOY XUV (05-04)  
 ISUZU ASCENDER (07-03)  
 OLDSMOBILE ACHIEVA (98-92)  
 OLDSMOBILE ALERO (04-99)  
 OLDSMOBILE BRAVADA (04-02)  
 OLDSMOBILE CUTLASS CALAIS (91-89)

OLDSMOBILE CUTLASS SUPREME (91-90)  
 PONTIAC G4 (05)PONTIAC GRAND AM (05-88)  
 PONTIAC GRAND PRIX (91-90)

### INFORMATION ABOUT COMPATIBILITY

VISIT OUR WEBSITE OR CONTACT US

## SENSOR PC753 CRANKSHAFT

**Sku: SEC08**



### APPLICATIONS

FORD EDGE (18-07)  
 FORD EXPLORER (19-11)  
 FORD F-150 (17-11)  
 FORD FLEX (19-14), (12-09)  
 FORD FUSION (12-10)  
 FORD MUSTANG (16-11)  
 FORD POLICE INTERCEPTOR SEDAN (19-18), (16-13)  
 FORD POLICE INTERCEPTOR UTILITY (19-14)  
 FORD TAURUS (19-08)  
 FORD TAURUS X (09-08)  
 FORD TRANSIT-150 (19-18), (16-15)  
 FORD TRANSIT-250 (19-18), (16-15)  
 FORD TRANSIT-350 (19-18), (16-15)  
 FORD TRANSIT-350 HD (19-15)

LINCOLN MKS (16-09)  
 LINCOLN MKT (17), (15-10)  
 LINCOLN MKX (18-07)  
 LINCOLN MKZ (14-07)  
 MAZDA 6 (13-09)  
 MAZDA CX-9 (15-07)  
 MERCURY SABLE (09-08)

### INFORMATION ABOUT COMPATIBILITY

VISIT OUR WEBSITE OR CONTACT US

## SENSOR PC95 CRANKSHAFT

**Sku: SEC09**



### APPLICATIONS

FORD, LINCOLN, MAZDA, MERCURY

EDGE LIMITED, SE, SEL, SPORT, TITANIUM.  
 EXPLORER BASE, LIMITED, XLT  
 F-150 STX, XL, XLT  
 FLEX LIMITED, SE, SEL, TITANIUM  
 FUSION SPORT  
 MUSTANG BASE, V6  
 POLICE INTERCEPTOR SEDAN BASE  
 POLICE INTERCEPTOR UTILITY BASE  
 TAURUS LIMITED, SE, SEL, SHO, X EDDIE BAUER  
 TRANSIT-150 BASE XL, XLT  
 TRANSIT-250 BASE, PTV, HD BASE  
 TRANSIT-350 BASE, PTV, HD BASE  
 MKS BASE, ECOBOOST, BLACK LABEL, PREMIERE  
 CX-9 GRAND TOURING, SPORT, TOURING  
 SABLE BASE, PREMIER



## CALIFORNIA DIESEL MANUFACTURING LLC

43114 BLACKDEER LOOP, SUITE F. TEMECULA, CALIFORNIA.

**OFFICE:** (+1) 951 296 9496 **MOBILE:** (+1) 951 375 6791

**EMAIL:** [contact@california-diesel.com](mailto:contact@california-diesel.com)

SOLENOIDS, SENSORS, DIESEL INJECTORS & MORE

**[www.california-diesel.com](http://www.california-diesel.com)**



AUTOMOTIVE

# SENSORS

**SENSOR PC418 CRANKSHAFT**

**Sku: SECR10**



**APPLICATIONS**

- FORD CONTOUR (00-95)
- FORD ESCAPE (12-01)
- FORD FIVE HUNDRED (07-05)
- FORD FREESTYLE (07-05)
- FORD FUSION (12-06)
- FORD MONDEO (07-01)
- FORD MYSTIQUE (00-95)
- FORD RANGER (02)
- FORD TAURUS (99-96)
- LINCOLN ZEPHYR (06)
- MAZDA 6 (08-03)
- MAZDA MPV (06-00)
- MAZDA TRIBUTE (11-08), (06-01)
- MERCURY COUGAR (02-99)
- MERCURY MARINER (11-05)
- MERCURY MILAN (11-06)
- MERCURY MONTEGO (07-05)
- MERCURY MYSTIQUE (00-95)

**INFORMATION ABOUT COMPATIBILITY**

VISIT OUR WEBSITE OR CONTACT US

**SENSOR PC863 CRANKSHAFT**

**Sku: SECR11**



**APPLICATIONS**

- FORD F-150 (17-11)
- FORD MUSTANG (17-14), (12-11)

**INFORMATION ABOUT COMPATIBILITY**

VISIT OUR WEBSITE OR CONTACT US

**SENSOR PC862 CRANKSHAFT**

**Sku: SECR12**



**APPLICATIONS**

- FORD EXPLORER (17-13)
- FORD F-150 (17-11)
- FORD FLEX (17-13)
- FORD POLICE INTERCEPTOR SEDAN (19-13)
- FORD TAURUS (17-13)
- FORD TRANSIT-150 (16-15)
- FORD TRANSIT-250 (16-15)
- FORD TRANSIT-350 (16-15)
- FORD TRANSIT-350 HD (16-15)
- LINCOLN MKT (14-13)

**INFORMATION ABOUT COMPATIBILITY**

VISIT OUR WEBSITE OR CONTACT US



**SENSOR PC153 CRANKSHAFT**

**Sku: SECR13**



**APPLICATIONS**

HONDA CIVIC (00-96)

**INFORMATION ABOUT COMPATIBILITY**

VISIT OUR WEBSITE OR CONTACT US

**SENSOR PC51 CRANKSHAFT**

**Sku: SECR14**



**APPLICATIONS**

FORD E-150 (03)  
 FORD E-150 CLUB WAGON (03)  
 FORD E-150 ECONOLINE (02-97)  
 FORD E-150 ECONOLINE CLUB WAGON (02-97)  
 FORD E-250 (03)  
 FORD E-250 ECONOLINE (02-97)  
 FORD F-150 (10-97)  
 FORD F-150 HERITAGE (04)  
 FORD FREESTAR (07-04)  
 FORD MUSTANG (04-94)  
 FORD THUNDERBIRD (97-94)  
 FORD WINDSTAR (03-95)  
 MERCURY COUGAR (97-93)  
 MERCURY MONTEREY (07-04)

**INFORMATION ABOUT COMPATIBILITY**

VISIT OUR WEBSITE OR CONTACT US

**SENSOR 587014 CRANKSHAFT**

**Sku: SECR15**



**APPLICATIONS**

ENVIRUDES OUTBOARDS  
 MODEL 40 (2004-09), 50 (2004-09), 55 (2008), 60 (2005-09), 65 (2008-09), 75 (2004-09), 90 (2004-09), 115 (2007-08), 150 (2007-08), 175 (2007-08), 200 (2005-08), 225 (2005-08), 250 (2005-08), 300 (2008).

**INFORMATION ABOUT COMPATIBILITY**

VISIT OUR WEBSITE OR CONTACT US



### SENSOR PC68 CRANKSHAFT

Sku: SECR16



#### APPLICATIONS

FORD SABLE (01-00)  
FORD TAURUS (05-96)  
JAGUAR S-TYPE (00)  
LINCOLN LS (05-00)  
MERCURY SABLE (05-96)

#### INFORMATION ABOUT COMPATIBILITY

VISIT OUR WEBSITE OR CONTACT US

### SENSOR PC1129 CRANKSHAFT

Sku: SECR17



#### APPLICATIONS

JAGUAR XF (18-13)  
JAGUAR XJ (19-13)

#### INFORMATION ABOUT COMPATIBILITY

VISIT OUR WEBSITE OR CONTACT US

### SENSOR PC257 / SU4177 CRANKSHAFT

Sku: SECR18



#### APPLICATIONS

ACURA / HONDA

ACURA CL  
HONDA ACCORD EX  
HONDA ACCORD LX

#### INFORMATION ABOUT COMPATIBILITY

VISIT OUR WEBSITE OR CONTACT US



**SENSOR PC325 CRANKSHAFT**

**Sku: SECR19**



**APPLICATIONS**

- FORD BRONCO (96)
- FORD E-150 ECONOLINE (96)
- FORD E-150 ECONOLINE CLUB WAGON (96)
- FORD E-250 ECONOLINE (96)
- FORD E-350 ECONOLINE (96)
- FORD E-350 ECONOLINE CLUB WAGON (96)
- FORD ECONOLINE SUPER DUTY (96)
- FORD EXPLORER (01-96)
- FORD F-150 (96)
- FORD F-250 (97-96)
- FORD F-350 (98-96)
- LAFORZA LAFORZA (01-98)
- MERCURY MOUNTAINEER (01-97)

**INFORMATION ABOUT COMPATIBILITY**

VISIT OUR WEBSITE OR CONTACT US

**SENSOR RE519144 CRANKSHAFT**

**Sku: SECR20**



**APPLICATIONS**

JOHN DEERE CRANKSHAFT POSITION SENSOR.  
SERIES 5000, 6000, 7000, 8000

LOADER BACKHOE MODELS  
310G, 310J, 310SJ, 310SJ TMC, 310SG, 315SG, 410G,  
410J AND 710G.

LOADER LANDSCAPER MODEL  
210L EP.

CRAWLER DOZER MODELS  
450H, 550H, 650H, 700H, 700J, 750C II, 750J, 850C II,  
850JR AND 950K.

WHEEL LOADER MODELS  
444K, 524K, 544K, 624K, 624KR, 644K, 724K, 824K AND  
844K.

WHEEL EXCAVATOR MODEL 120D.  
ENGINE 6090HFS85, 8.1L 6081AFM01, 12.5L  
6125AFM01, 12.5L 6125HF070, E 4.5L 4045HMK85  
(4045 TIER 3), M 4.5L 4045HMK80 (4045 TIER 3), PVX  
4.5L 4045HFC93, PWX 4.5L 4045HFC/HFG92 AND PWX  
4.5L 4045HFG93.

**INFORMATION ABOUT COMPATIBILITY**

VISIT OUR WEBSITE OR CONTACT US

**SENSOR 7552610 DIRECT GEARBOX**

**Sku: SEDSG01**



**APPLICATIONS**

BMW 5ER TOURING E61 545I TOURING  
2004/2006 - 2010/2012

**INFORMATION ABOUT COMPATIBILITY**

VISIT OUR WEBSITE OR CONTACT US

**SENSOR VP1 / CX-1464 EXHAUST GAS RECIRCULATION**

**Sku: SEEGR01**



**APPLICATIONS**

FORD AEROSTAR (87-86)  
 FORD BRONCO (95-85)  
 FORD BRONCO II (84)  
 FORD COUNTRY SQUIRE (91-87)  
 FORD E-150 ECONOLINE (96-86)  
 FORD E-150 ECONOLINE CLUB WAGON (96-86)  
 FORD E-250 ECONOLINE (96-86)  
 FORD E-250 ECONOLINE CLUB WAGON (91-87)  
 FORD E-350 ECONOLINE (96-87)  
 FORD E-350 ECONOLINE CLUB WAGON (96-87)  
 FORD ECONOLINE SUPER DUTY (96)  
 FORD EXPLORER (97-96)  
 FORD F SUPER DUTY (97-88)  
 FORD F-150 (96-85)  
 FORD F-250 (97-85)  
 FORD F-350 (97-86)  
 FORD F53 (97-95)  
 FORD LTD (86)  
 FORD LTD CROWN VICTORIA (91-87)

FORD MUSTANG (95-85)  
 FORD RANGER (93-83)  
 FORD TAURUS (90-86)  
 FORD TEMPO (87-84)  
 FORD THUNDERBIRD (93-91), (88-86)  
 LINCOLN CONTINENTAL (87-86)  
 LINCOLN MARK VII (92-86)  
 LINCOLN TOWN CAR (90-86)  
 MERCURY CAPRI (86)  
 MERCURY COLONY PARK (91-87)  
 MERCURY COUGAR (93-91), (88-84)  
 MERCURY GRAND MARQUIS (91-86)  
 MERCURY SABLE (86)  
 MERCURY TOPAZ (87-84)

**INFORMATION ABOUT COMPATIBILITY**

VISIT OUR WEBSITE OR CONTACT US

**SENSOR EGV1268 EXHAUST GAS RECIRCULATION**

**Sku: SEEGR02**



**APPLICATIONS**

AUDI A7 QUATTRO (14)  
 AUDI Q7 (15)  
 AUDI A6 QUATTRO (16-14)  
 AUDI A7 QUATTRO (16-14)  
 AUDI A8 QUATTRO (16-15)  
 AUDI Q5 (16-15)  
 VOLKSWAGEN TOUAREG (16-15)

**INFORMATION ABOUT COMPATIBILITY**

VISIT OUR WEBSITE OR CONTACT US

**SENSOR VP1T / CX-1464 EXHAUST GAS RECIRCULATION**

**Sku: SEEGR03**



**APPLICATIONS**

FORD AEROSTAR (87-86)  
 FORD BRONCO (95-85)  
 FORD BRONCO II (84)  
 FORD COUNTRY SQUIRE (91-87)  
 FORD E-150 ECONOLINE (96-86)  
 FORD E-150 ECONOLINE CLUB WAGON (96-86)  
 FORD E-250 ECONOLINE (96-86)  
 FORD E-250 ECONOLINE CLUB WAGON (91-87)  
 FORD E-350 ECONOLINE (96-87)  
 FORD E-350 ECONOLINE CLUB WAGON (96-87)  
 FORD ECONOLINE SUPER DUTY (96)  
 FORD EXPLORER (97-96)  
 FORD F SUPER DUTY (97-88)  
 FORD F-150 (96-85)  
 FORD F-250 (97-85)  
 FORD F-350 (97-86)  
 FORD F53 (97-95)  
 FORD LTD (86)  
 FORD LTD CROWN VICTORIA (91-87)  
 FORD MUSTANG (95-85)  
 FORD RANGER (93-83)  
 FORD TAURUS (90-86)

FORD TEMPO (87-84)  
 FORD THUNDERBIRD (93-91), (88-86)  
 LINCOLN CONTINENTAL (87-86)  
 LINCOLN MARK VII (92-86)  
 LINCOLN TOWN CAR (90-86)  
 MERCURY CAPRI (86)  
 MERCURY COLONY PARK (91-87)  
 MERCURY COUGAR (93-91), (88-84)  
 MERCURY GRAND MARQUIS (91-86)  
 MERCURY SABLE (86)  
 MERCURY TOPAZ (87-84)

**INFORMATION ABOUT COMPATIBILITY**

VISIT OUR WEBSITE OR CONTACT US



**SENSOR RE12179 / RE12181 GROUND SPEED**

**Sku: SEGSS01**

**APPLICATIONS**

JOHN DEERE  
4050, 4250, 4450, 4650, 4850, 4055, 4255, 4455, 4555,  
4755 TRACTOR

**INFORMATION ABOUT COMPATIBILITY**

VISIT OUR WEBSITE OR CONTACT US



**SENSOR LX-222 IGNITION SENSOR**

**Sku: SEIS01**

**APPLICATIONS**

FORD AEROSTAR (90-86)  
FORD BRONCO (92-83)  
FORD BRONCO II (90-84)  
FORD COUNTRY SQUIRE (91-87)  
FORD E-150 ECONOLINE (96-84)  
FORD E-150 ECONOLINE CLUB WAGON (96-84)  
FORD E-250 ECONOLINE (96-84)  
FORD E-250 ECONOLINE CLUB WAGON (91-84)  
FORD E-350 ECONOLINE (96-84)  
FORD E-350 ECONOLINE CLUB WAGON (96-84)  
FORD ESCORT (90-83)  
FORD EXP (88-83)  
FORD F-150 (95-84)  
FORD F-250 (95-84)  
FORD F-350 (95-84)  
FORD LTD (86-84)

**INFORMATION ABOUT COMPATIBILITY**

VISIT OUR WEBSITE OR CONTACT US

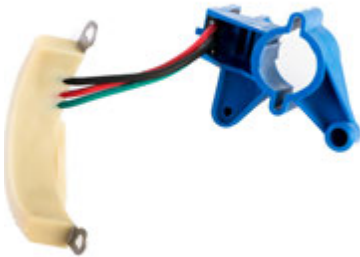

**SENSOR 3085185 ENGINE INTAKE TEMPERATURE**

**Sku: SEITS01**

**APPLICATIONS**

CUMMINS M11 / QSM11 / ISM11

OTHER NO. 3085198 / 050671

**INFORMATION ABOUT COMPATIBILITY**

VISIT OUR WEBSITE OR CONTACT US



**SENSOR MAS0321 MASS AIR FLOW**

**Sku: SEMAF01**



**APPLICATIONS**

BUICK ENCORE (15-13)  
 BUICK VERANO (16-12)  
 CHEVROLET CRUZE (15-12)  
 CHEVROLET SONIC (19-18), (16-12)  
 CHEVROLET TRAX (19-13)

**INFORMATION ABOUT COMPATIBILITY**

VISIT OUR WEBSITE OR CONTACT US

**SENSOR 3528003C1 MAGNETIC SPEED SENSOR**

**Sku: SEMSS01**



**APPLICATIONS**

INTERNATIONAL HARVESTER (05-07)  
 1997-1998 INTERNATIONAL HARVESTER 1552SC  
 1997-2007 INTERNATIONAL HARVESTER 1652SC  
 2006-2007 INTERNATIONAL HARVESTER 4100  
 2006-2007 INTERNATIONAL HARVESTER 4100 SBA  
 2002-2007 INTERNATIONAL HARVESTER 4200  
 2003-2007 INTERNATIONAL HARVESTER 4200LP  
 2002-2007 INTERNATIONAL HARVESTER 4300  
 2002-2007 INTERNATIONAL HARVESTER 4300LP  
 2002-2007 INTERNATIONAL HARVESTER 4400  
 2002-2007 INTERNATIONAL HARVESTER 4400LP  
 1997-2005 INTERNATIONAL HARVESTER 4700  
 1997-2002 INTERNATIONAL HARVESTER 4700LP  
 1997-2002 INTERNATIONAL HARVESTER 4700LPX  
 1997-2005 INTERNATIONAL HARVESTER 4900  
 2000-2007 INTERNATIONAL HARVESTER 5500I  
 2000-2007 INTERNATIONAL HARVESTER 5900I SBA

2002-2007 INTERNATIONAL HARVESTER 7400  
 2003-2007 INTERNATIONAL HARVESTER 7500  
 2003-2007 INTERNATIONAL HARVESTER 7600  
 2005-2007 INTERNATIONAL HARVESTER 7700  
 1997-2003 INTERNATIONAL HARVESTER 8100  
 1997-1998 INTERNATIONAL HARVESTER 8200  
 2004-2007 INTERNATIONAL HARVESTER 8500  
 2003-2007 INTERNATIONAL HARVESTER 8600 SBA  
 1998-1999 INTERNATIONAL HARVESTER 9100 SBA  
 2000-2003 INTERNATIONAL HARVESTER 9100I SBA  
 1997-1999 INTERNATIONAL HARVESTER 9200 SBA  
 2000-2007 INTERNATIONAL HARVESTER 9200I SBA  
 1997-1999 INTERNATIONAL HARVESTER 9300  
 1997-2000 INTERNATIONAL HARVESTER 9400  
 AND MORE

**INFORMATION ABOUT COMPATIBILITY**

VISIT OUR WEBSITE OR CONTACT US

**SENSOR NS691 NEUTRAL SAFETY SWITCH**

**Sku: SENSS01**



**APPLICATIONS**

CHEVROLET SILVERADO 2500 HD (19-07)  
 CHEVROLET SILVERADO 2500 HD CLASSIC (07)  
 CHEVROLET SILVERADO 3500 CLASSIC (07)  
 CHEVROLET SILVERADO 3500 HD (19-07)  
 GMC SIERRA 2500 HD (19-07)  
 GMC SIERRA 2500 HD CLASSIC (07)  
 GMC SIERRA 3500 CLASSIC (07)  
 GMC SIERRA 3500 HD (19-07)

**INFORMATION ABOUT COMPATIBILITY**

VISIT OUR WEBSITE OR CONTACT US

**SENSOR FLS-18 OIL LEVEL**

**Sku: SEOLS01**



**APPLICATIONS**

- BUICK CENTURY (03-97)
- BUICK REGAL (96-94), (01)
- BUICK RENDEZVOUS (04-02)
- BUICK SKYLARK (98-94)
- BUICK TERRAZA (07-06)
- CHEVROLET BERETTA (96-94)
- CHEVROLET CORSICA (96-94)
- CHEVROLET IMPALA (07-06), (03-00)
- CHEVROLET LUMINA (01-95)
- CHEVROLET LUMINA APV (96-95)
- CHEVROLET MALIBU (07-97)
- CHEVROLET MONTE CARLO (07-06), (03-95)
- CHEVROLET UPLANDER (09-05)
- CHEVROLET VENTURE (03-97)
- OLDSMOBILE ACHIEVA (98-94)
- OLDSMOBILE ALERO (03-99)
- OLDSMOBILE CUTLASS (99-97)
- OLDSMOBILE CUTLASS CIERA (96), (94)
- OLDSMOBILE CUTLASS SUPREME (97-93)
- OLDSMOBILE SILHOUETTE (03-96)
- PONTIAC AZTEK (04-01)

**INFORMATION ABOUT COMPATIBILITY**

VISIT OUR WEBSITE OR CONTACT US

**SENSOR 248095 POTENTIOMETER**

**Sku: SEPOT01**



**APPLICATIONS**

- FERRARI:
- 430 CHALLENGE (2006)
- 430 SPIDER
- 430 SCUDERIA
- 430 SCUDERIA SPIDER 16M
- 575 SUPERAMERICA
- 575M MARANELLO
- 430 COUPE

**INFORMATION ABOUT COMPATIBILITY**

VISIT OUR WEBSITE OR CONTACT US

**SENSOR 409705 PEDAL POTENTIOMETER**

**Sku: SEPOT02**



**APPLICATIONS**

FORD, NEW HOLLAND:

- TM SERIES T
- M115, TM120, TM125, TM130, TM135, TM140, TM150,
- TM155, TM165, TM175, TM190

- T6000 SERIES
- T6010, T6020, T6030, T6040, T6050, T6060, T6070

- T7000 SERIES
- T7030, T7040, T7050, T7060

- T4000 SERIES
- T4020, T4030, T4040, T4050

CASE, IHC:

- MAXXUM SERIES
- 100, 110, 115, 120, 130, 140

- MXU SERIES
- 100, 110, 115, 125

- PUMA SERIES
- 115, 125, 140, 155, 165CVT, 195CVT, 210CVT

- QUANTUM SERIES
- 65V, 75V, 85V, 95V

- JXU, JXC, JXN SERIES
- 1070U, 1060C, 1075C, 1085C, 1095C, 1075N, 1095N,
- 1060V, 1070V, 1075V, 1095V

**INFORMATION ABOUT COMPATIBILITY**

VISIT OUR WEBSITE OR CONTACT US





## **CALIFORNIA DIESEL MANUFACTURING LLC**

43114 BLACKDEER LOOP, SUITE F. TEMECULA, CALIFORNIA.

**OFFICE:** (+1) 951 296 9496 **MOBILE:** (+1) 951 375 6791

**EMAIL:** [contact@california-diesel.com](mailto:contact@california-diesel.com)

SOLENOIDS, SENSORS, DIESEL INJECTORS & MORE

**[www.california-diesel.com](http://www.california-diesel.com)**



AUTOMOTIVE

# SENSORS



## SENSOR 9631 PEDAL POSITION

Sku: SEPPS01



### APPLICATIONS

JOHN DEERE 7R SERIES & 8 SERIES

BOLT-ON, DUAL OUTPUT SENSOR THAT CAN BE PROGRAMMED TO MEET CUSTOMER REQUIREMENTS WITHIN ITS 80 DEGREES TRAVEL RANGE. THE NON-CONTACTING 9631 DUAL OUTPUT POSITION SENSOR (DOPS) WAS DESIGNED FOR THE TOUGH REQUIREMENTS OF THE HEAVY VEHICLE AND OFF ROAD MARKET.

THE SENSOR IS ROHS COMPLIANT AND OPERATES WITH REGULATED 5V SUPPLIES. IT FEATURES REVERSE VOLTAGE PROTECTION AND IS AVAILABLE IN CLOCKWISE AND COUNTER- CLOCKWISE ROTATION VERSIONS. THE FULLY SEALED PCB CONSTRUCTION MEETS IP STANDARDS.

### INFORMATION ABOUT COMPATIBILITY

VISIT OUR WEBSITE OR CONTACT US





**SENSOR RE294922 PEDAL POSITION**

**Sku: SEPPS02**

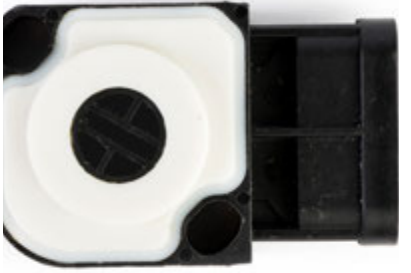

**APPLICATIONS**

JOHN DEERE 7R SERIES & 8 SERIES

NON-CONTACTING, BOLT-ON, DUAL OUTPUT DEVICE FOR SMALL ANGLE PEDAL POSITION SENSING PROGRAMMABLE SENSOR TO MEET REQUIREMENTS FOR SLOPE, PLATEAU OUTPUT WITHIN 80-DEGREE MECHANICAL TRAVEL MEETS IP67 STANDARDS WITHSTANDS TEMPERATURE EXTREMES, HARSH ENVIRONMENTS

**INFORMATION ABOUT COMPATIBILITY**

VISIT OUR WEBSITE OR CONTACT US

**SENSOR 1029L PEDAL POSITION**

**Sku: SEPPS03**



**APPLICATIONS**

VH 10693907 S 1029L PEDAL POSITION SENSOR (PPS) IS DESIGNED FOR USE IN DRIVE-BY-WIRE THROTTLE APPLICATIONS. THE PRIMARY CONFIGURATION CONFORMS TO SAE J1834 STANDARDS

YET MODIFICATIONS CAN BE MADE TO MEET CUSTOMER SPECIFIC DEMANDS. THE 1029 PPS IS IDEAL FOR:

- AGRICULTURAL EQUIPMENT
- CONSTRUCTION EQUIPMENT
- HEAVY TRUCKS
- MARINE APPLICATIONS
- OFF-HIGHWAY VEHICLES

THE TOUGH, RELIABLE 1029 PPS FEATURES WABASH TECHNOLOGIES' PATENTED SILVER-IN GLASS ENCODER SENSING TECHNOLOGY TO PROVIDE EXCEPTIONAL ACCURACY AND EXTENDED LIFE. A TESTED, FIELD PROVEN PRODUCT WITHSTANDS THE HARSHTEST OPERATING ENVIRONMENTS.

**INFORMATION ABOUT COMPATIBILITY**

VISIT OUR WEBSITE OR CONTACT US

**SENSOR 1029S PEDAL POSITION**

**Sku: SEPPS04**



**APPLICATIONS**

1029S PEDAL POSITION SENSOR (PPS) IS DESIGNED FOR USE IN DRIVE-BY-WIRE THROTTLE APPLICATIONS. THE PRIMARY CONFIGURATION CONFORMS TO SAE J1834 STANDARDS

YET MODIFICATIONS CAN BE MADE TO MEET CUSTOMER SPECIFIC DEMANDS. THE 1029 PPS IS IDEAL FOR:

- AGRICULTURAL EQUIPMENT
- CONSTRUCTION EQUIPMENT
- HEAVY TRUCKS
- MARINE APPLICATIONS

THE TOUGH, RELIABLE 1029 PPS FEATURES WABASH TECHNOLOGIES' PATENTED SILVER-IN GLASS ENCODER SENSING TECHNOLOGY TO PROVIDE EXCEPTIONAL ACCURACY AND EXTENDED LIFE. A TESTED, FIELD PROVEN PRODUCT WITHSTANDS THE HARSHTEST OPERATING ENVIRONMENTS.

**INFORMATION ABOUT COMPATIBILITY**

VISIT OUR WEBSITE OR CONTACT US





### SENSOR 1029TA PEDAL POSITION

**Sku: SEPPS05**

**APPLICATIONS**

1029-TA PEDAL POSITION SENSOR (PPS) IS DESIGNED FOR USE IN DRIVE-BY-WIRE THROTTLE APPLICATIONS. THE PRIMARY CONFIGURATION CONFORMS TO SAE J1834 STANDARDS

YET MODIFICATIONS CAN BE MADE TO MEET CUSTOMER SPECIFIC DEMANDS. THE 1029 PPS IS IDEAL FOR:

- AGRICULTURAL EQUIPMENT
- CONSTRUCTION EQUIPMENT
- HEAVY TRUCKS
- MARINE APPLICATIONS
- OFF-HIGHWAY VEHICLES

THE TOUGH, RELIABLE 1029 PPS FEATURES WABASH TECHNOLOGIES' PATENTED SILVER-IN GLASS ENCODER SENSING TECHNOLOGY TO PROVIDE EXCEPTIONAL ACCURACY AND EXTENDED LIFE. A TESTED, FIELD PROVEN PRODUCT WITHSTANDS THE HARSHTEST OPERATING ENVIRONMENTS.

**INFORMATION ABOUT COMPATIBILITY**

VISIT OUR WEBSITE OR CONTACT US



### SENSOR 1029-9 PEDAL POSITION

**Sku: SEPPS06**

**APPLICATIONS**

1029-9 PEDAL POSITION SENSOR (PPS) IS DESIGNED FOR USE IN DRIVE-BY-WIRE THROTTLE APPLICATIONS. THE PRIMARY CONFIGURATION CONFORMS TO SAE J1834 STANDARDS,

YET MODIFICATIONS CAN BE MADE TO MEET CUSTOMER SPECIFIC DEMANDS. THE 1029 PPS IS IDEAL FOR:

- AGRICULTURAL EQUIPMENT
- CONSTRUCTION EQUIPMENT
- HEAVY TRUCKS
- MARINE APPLICATIONS
- OFF-HIGHWAY VEHICLES

THE TOUGH, RELIABLE 1029 PPS FEATURES WABASH TECHNOLOGIES' PATENTED SILVER-IN GLASS ENCODER SENSING TECHNOLOGY TO PROVIDE EXCEPTIONAL ACCURACY AND EXTENDED LIFE. A TESTED, FIELD PROVEN PRODUCT WITHSTANDS THE HARSHTEST OPERATING ENVIRONMENTS.

**INFORMATION ABOUT COMPATIBILITY**

VISIT OUR WEBSITE OR CONTACT US



### SENSOR 1029-0030 PEDAL POSITION

**Sku: SEPPS07**

**APPLICATIONS**

1029-0030 PEDAL POSITION SENSOR (PPS) IS DESIGNED FOR USE IN DRIVE-BY-WIRE THROTTLE APPLICATIONS. THE PRIMARY CONFIGURATION CONFORMS TO SAE J1834 STANDARDS

YET MODIFICATIONS CAN BE MADE TO MEET CUSTOMER SPECIFIC DEMANDS. THE 1029 PPS IS IDEAL FOR:

- AGRICULTURAL EQUIPMENT
- CONSTRUCTION EQUIPMENT
- HEAVY TRUCKS
- MARINE APPLICATIONS
- OFF-HIGHWAY VEHICLES

THE TOUGH, RELIABLE 1029 PPS FEATURES WABASH TECHNOLOGIES' PATENTED SILVER-IN GLASS ENCODER SENSING TECHNOLOGY TO PROVIDE EXCEPTIONAL ACCURACY AND EXTENDED LIFE. A TESTED, FIELD PROVEN PRODUCT WITHSTANDS THE HARSHTEST OPERATING ENVIRONMENTS.

**INFORMATION ABOUT COMPATIBILITY**

VISIT OUR WEBSITE OR CONTACT US

**SENSOR AFH20-8466 ROUND BALER**

**Sku: SERBS01**



**APPLICATIONS**

JOHN DEERE  
IMPROVED OEM AH116104 SENSOR

**INFORMATION ABOUT COMPATIBILITY**

VISIT OUR WEBSITE OR CONTACT US



**SENSOR 970-1036 ROTARY POSITION**

**Sku: SERPS01**

**APPLICATIONS**

EV AND FORKLIFT PARTS

THE WABASH 970-1036 ROTARY POSITION SENSOR (RPS) IS A VERSATILE DEVICE THAT IS FULLY SEALED TO INGRESS PROTECTION IP67. THIS PROVIDES EXCEPTIONAL MECHANICAL DURABILITY AND LONG ELECTRICAL LIFE, MAKING IT IDEAL FOR APPLICATIONS SUCH AS:

- TRANSMISSION POSITION
- STEERING ANGLE
- GEAR LEVER POSITION
- SUSPENSION TRAVEL
- THROTTLE POSITION

THE ROTARY POSITION SENSOR MODEL 1036-0002 IS DESIGNED AS CONTINUOUS ROTATION SENSOR, WIDELY USED AS STEERING ANGLE SENSOR IN FORKLIFTS & PALLET STACKERS. TYPICAL USER BRANDS INCLUDE HANGCHA, HELI, MAXIMAL, TAILIFT AND EP, ETC.

THERE ARE DIFFERENT 1036 RPS MODELS, CORRESPONDING TO DIFFERENT APPLICATIONS.

**INFORMATION ABOUT COMPATIBILITY**

VISIT OUR WEBSITE OR CONTACT US



**SENSOR 971-0002 ROTARY POSITION**

**Sku: SERPS02**

**APPLICATIONS**

SPECTROL MODEL 971 ROTARY POSITION SENSOR IS SUITABLE FOR DEMANDING ENVIRONMENTS WHERE LONG LIFE AND CONSISTENT LINEARITY PERFORMANCE ARE REQUIRED.

TYPICAL APPLICATIONS INCLUDE ELECTRICAL INDUSTRIAL VEHICLES, MEDICAL APPLIANCES, AUTOMOTIVE SYSTEMS AND CONTROLS, AND INDUSTRIAL & COMMERCIAL POSITION SENSING APPLICATIONS.

SPECTROL'S PROVEN HIGH PERFORMANCE CONDUCTIVE PLASTIC RESISTIVE TRACKS AND CONTACT DESIGN ACHIEVES HIGH ACCURACY. THE 971 CAN BE SUPPLIED WITH OPTIONS FOR ELECTRICAL TRACK LENGTH, RESISTANCE, FLYING LEADS, INTEGRAL CONNECTOR AND ACTUATOR DRIVE DIRECTION.

HIGH PERFORMANCE, COMPACT POTENTIOMETRIC SENSOR  
RUGGED CONSTRUCTION SUITABLE FOR CLOSED LOOP FEEDBACK APPLICATIONS  
THROUGH-HOLE ACTUATION CAPABILITY  
INTEGRAL CONNECTOR OR FLYING LEAD VERSIONS  
ACTUATOR AND MOUNTING CONFIGURATION OPTIONS.

**INFORMATION ABOUT COMPATIBILITY**

VISIT OUR WEBSITE OR CONTACT US

**SENSOR AS372 ROTATION POSITION / MAP**

**Sku: SERPS03**



**APPLICATIONS**

BUICK, CADILLAC, CHEVROLET, GMC

- BUICK ENCLAVE (20-08)
- BUICK LACROSSE (19-18), (16-08)
- BUICK LUCERNE (11-09)
- BUICK REGAL (11)
- BUICK VERANO (17-14), (12)
- CADILLAC ATS (16-13)
- CADILLAC CTS (13-09)
- CADILLAC SRX (16-10)
- CADILLAC XTS (19-18), (13)
- CHEVROLET AVEO (11-09)
- CHEVROLET AVEO 5 (11-09)
- CHEVROLET BLAZER (20-19)
- CHEVROLET CAMARO (16-10)
- CHEVROLET CAPRICE (17-11)
- CHEVROLET CAPTIVA SPORT (15-08)
- CHEVROLET COBALT (10-07)
- CHEVROLET COLORADO (20-15)
- CHEVROLET CORVETTE (13-12), (10), (08)

- CHEVROLET IMPALA (20-07)
- CHEVROLET EXPRESS 1500 (14-08)
- CHEVROLET HHR (11-07) CHEVROLET IMPALA (20-07)
- CHEVROLET IMPALA LIMITED (16-14)
- CHEVROLET MALIBU (16-07)
- CHEVROLET MONTE CARLO (07)
- CHEVROLET ORLANDO (14-12)
- CHEVROLET SILVERADO 1500 (13-07)
- CHEVROLET SONIC (18)
- CHEVROLET SPARK (15-13)
- CHEVROLET SS (17-14)
- CHEVROLET TORNAO (12-11)
- CHEVROLET TRAVERSE (20-12)
- CHEVROLET TRAX (18-13)
- CHEVROLET UPLANDER (08)
- CHEVROLET VOLT (15-11)
- AND MORE..

**INFORMATION ABOUT COMPATIBILITY**

VISIT OUR WEBSITE OR CONTACT US

**SENSOR NS753 NEUTRAL SAFETY SWITCH**

**Sku: SERS01**



**APPLICATIONS**

- DODGE DART (16-13)
- FIAT 500L (16-14)
- JEEP RENEGADE (17)

THIS PRODUCT FITS 73 VEHICLE VARIANTS.  
 DODGE: 1 MODELS, 27 VARIANTS 2012 AND 2016.  
 FIAT: 1 MODELS, 22 VARIANTS 2014 AND 2016.  
 JEEP: 1 MODELS, 24 VARIANTS 2015 AND 2021.

**INFORMATION ABOUT COMPATIBILITY**

VISIT OUR WEBSITE OR CONTACT US

**SENSOR AX382 INTAKE AIR TEMPERATURE**

**Sku: SERS02**



**APPLICATIONS**

- AUDI A3 (20-15)
- AUDI A4 (18-17)
- AUDI A4 QUATTRO (20-17)
- AUDI A6 (18-16)
- AUDI A6 QUATTRO (20-16)
- AUDI A7 (17-16)
- AUDI A7 QUATTRO (18-16)
- AUDI A8 (16-15)
- AUDI A8 QUATTRO (18-15)
- AUDI S3 (20-15)
- AUDI TT QUATTRO (20-16)
- VOLKSWAGEN GOLF (18-15)
- VOLKSWAGEN GOLF ALLTRACK (19-17)
- VOLKSWAGEN GOLF R (19-15)
- VOLKSWAGEN GOLF SPORTWAGEN (19-15)
- VOLKSWAGEN GTI (20-15)
- VOLKSWAGEN JETTA (18-14)
- VOLKSWAGEN PASSAT (17-14)

**INFORMATION ABOUT COMPATIBILITY**

VISIT OUR WEBSITE OR CONTACT US



**SENSOR YZ104746**

**Sku: SES01**

**APPLICATIONS**

JOHN DEERE-670D  
 JOHN DEERE-DF180  
 JOHN DEERE-770C  
 JOHN DEERE-RE151971  
 JOHN DEERE-1400  
 JOHN DEERE-770D  
 JOHN DEERE-670C  
 JOHN DEERE-1200  
 JOHN DEERE-DF150  
 JOHN DEERE-RE68144  
 JOHN DEERE-DD

**INFORMATION ABOUT COMPATIBILITY**

VISIT OUR WEBSITE OR CONTACT US



**SENSOR CNH 82019691**

**Sku: SES02**

**APPLICATIONS**

FORD - NEW HOLLAND

**CASE TRACTORS :**

MXU110 / MXU130 / MXU135 / MXM140 / MXM155 /  
 MXU115 / MXM175 / MXM190 / MXU125 / MXU100 /  
 MXM120.

**NEW HOLLAND TRACTORS :**

TM120 / TM140 / 8360 / TM115 / TM155 / 8560 / TS100A  
 / TM190 / TM165 / TS135A / TM175 / TS125A / TS115A /  
 TM130 / TM125

**INFORMATION ABOUT COMPATIBILITY**

VISIT OUR WEBSITE OR CONTACT US



**SENSOR SC168 SPEED**

**Sku: SESS01**

**APPLICATIONS**

CADILLAC ESCALADE (99), (17-15)  
 CADILLAC ESCALADE ESV (17-03)  
 CHEVROLET ASTRO (05-99)  
 CHEVROLET AVALANCHE (13-07)  
 CHEVROLET AVALANCHE 1500 (06-02)  
 CHEVROLET AVALANCHE 2500 (06-02)  
 CHEVROLET BLAZER (04-03), (01-99)  
 CHEVROLET C2500 (00-99)  
 CHEVROLET C3500 (00-99)  
 CHEVROLET C3500HD (00-99)  
 CHEVROLET COLORADO (12-04)  
 CHEVROLET EXPRESS 1500 (14-03)  
 CHEVROLET K1500 SUBURBAN (99)  
 CHEVROLET K2500 (00-99)  
 CHEVROLET K2500 SUBURBAN (99)  
 CHEVROLET S10 (03-99)  
 CHEVROLET SILVERADO 1500 (18), (16-99)  
 CHEVROLET SILVERADO 1500 HD (06-05), (03-01)  
 CHEVROLET SILVERADO 1500 HD CLASSIC (07)  
 CHEVROLET SILVERADO 2500 (04-99)  
 AND MORE..

GMC SIERRA 1500 HD CLASSIC (07)  
 GMC SIERRA 2500 (04-99)  
 GMC SIERRA 2500 HD (19-01)  
 GMC SIERRA 3500 (06-01)  
 GMC SIERRA 3500 CLASSIC (07)  
 GMC SIERRA 3500 HD (19-07)  
 GMC SONOMA (03-98)  
 GMC YUKON (19-99)  
 GMC YUKON XL (19-15)  
 GMC YUKON XL 1500 (14-00)  
 GMC YUKON XL 2500 (13-00), AND MORE.  
 HUMMER H1 (03)  
 HUMMER H2 (07-03)  
 HUMMER H3 (07-06)  
 ISUZU ASCENDER (04-03)  
 OLDSMOBILE BRAVADA (04-98)  
 PONTIAC SOLSTICE (09)  
 SAAB 9-7X (09-05)  
 SATURN SKY (09)

**INFORMATION ABOUT COMPATIBILITY**

VISIT OUR WEBSITE OR CONTACT US



**SENSOR KWB-60-0824-01 SS SPEED**

**SKU: SESS02**



**APPLICATIONS**

FREIGHTLINER

DESIGNED FOR RUGGED, RELIABLE SPEED SENSING REQUIREMENTS WHERE DURABILITY AND DEPENDABILITY ARE REQUIRED, ITS PROVEN, FIELD TESTED DESIGN CONFORMS TO SAE STANDARDS, WHILE OFFERING CUSTOMERS FLEXIBILITY IN VARIATIONS AND FEATURES.

PROVEN ROBUST DESIGN DEPENDABLE PERFORMANCE  
SINGLE AND DUAL OUTPUTS AVAILABLE

**INFORMATION ABOUT COMPATIBILITY**

VISIT OUR WEBSITE OR CONTACT US

**SENSOR KWB-60-0823-01 SS SPEED**

**SKU: SESS03**



**APPLICATIONS**

FREIGHTLINER

DESIGNED FOR RUGGED, RELIABLE SPEED SENSING REQUIREMENTS WHERE DURABILITY AND DEPENDABILITY ARE REQUIRED, ITS PROVEN, FIELD TESTED DESIGN CONFORMS TO SAE STANDARDS, WHILE OFFERING CUSTOMERS FLEXIBILITY IN VARIATIONS AND FEATURES.

PROVEN ROBUST DESIGN DEPENDABLE PERFORMANCE  
SINGLE AND DUAL OUTPUTS AVAILABLE

**INFORMATION ABOUT COMPATIBILITY**

VISIT OUR WEBSITE OR CONTACT US

**SENSOR SAA85920008 SPEED**

**SKU: SESS04**



**APPLICATIONS**

1997 - 2006 FREIGHTLINER  
1999 - 2001 FREIGHTLINER  
2004 - 2009 FREIGHTLINER  
2008 - 2009 FREIGHTLINER  
1996 FREIGHTLINER  
2003 - 2010 FREIGHTLINER  
2003 - 2010 FREIGHTLINER  
2003 - 2009 FREIGHTLINER  
2003 - 2010 FREIGHTLINER  
2003 - 2005 FREIGHTLINER  
2003 - 2010 FREIGHTLINER  
1999 - 2004 FREIGHTLINER  
1999 - 2003 FREIGHTLINER  
1994 - 1996 FREIGHTLINER  
1995 - 2004 FREIGHTLINER  
1992 - 2004 FREIGHTLINER  
1992 - 2005 FREIGHTLINER  
1991 - 2003 FREIGHTLINER

ARGOSY  
CARGO  
CARGO  
CASCADIA  
CENTURY CLASS  
CENTURY CLASS  
CLASSIC  
COLUMBIA  
CONDOR  
CORONADO  
FC70  
FC80  
FL106  
FL50  
FL60  
FL70  
FL80

1989 - 1990 FREIGHTLINER  
1990 - 1996 FREIGHTLINER  
1996 FREIGHTLINER  
2003 - 2009 FREIGHTLINER  
1996 - 2006 FREIGHTLINER  
2004 - 2009 FREIGHTLINER  
2003 - 2011 FREIGHTLINER  
2009 - 2011 FREIGHTLINER  
1991 - 1996 FREIGHTLINER  
1992 - 1994 FREIGHTLINER  
1992 - 1994 FREIGHTLINER  
2000 - 2005 FREIGHTLINER  
2000 - 2005 FREIGHTLINER  
2003 - 2009 FREIGHTLINER

FLC 112  
FLD120  
FLD120 SD  
FLD120 SD  
FS65  
M2  
M2 106  
M2 112  
MB 80  
MB60  
MB70  
MT35  
MT45  
SEVERE-DUTY FLD

**INFORMATION ABOUT COMPATIBILITY**

VISIT OUR WEBSITE OR CONTACT US

**SENSOR Q216005 GTSS SPEED**

**Sku: SESS05**



**APPLICATIONS**

PACCAR KENWORTH PETERBILT SPEEDOMETER / TACHOMETER SENSOR

PETERBILT TAILSHAFT, INTERNAL TONE RING, MODELS C, T, W, K-SERIES 1995-2010

KENWORTH 2011-95 ALL MODELS. EATON TRANS WITH INTERNAL TONE RING, MOUNTS IN TAILSHAFT

**INFORMATION ABOUT COMPATIBILITY**

VISIT OUR WEBSITE OR CONTACT US

**SENSOR 87548197 GTSS SPEED**

**Sku: SESS06**



**APPLICATIONS**

FORD - NEW HOLLAND T8.380 PST ENGINE TIER 4B. S550, S660, S670, S680, S690

**INFORMATION ABOUT COMPATIBILITY**

VISIT OUR WEBSITE OR CONTACT US

**SENSOR RE537634 SPEED**

**Sku: SESS07**



**APPLICATIONS**

JOHN DEERE:

- 5085E TRACTOR -PC11933
- 5085M TRACTOR CAB -PC11015
- 5100E TRACTOR -PC11934
- 5100M TRACTOR OPEN OPERATOR STATION -PC11016
- 5100MH TRACTOR DELUXE OPEN OPERATORS STATION -PC11017
- 5100ML TRACTOR OPEN OPERATORS STATION -PC12180
- 5115M TRACTOR CAB -PC11018 5115ML TRACTOR OPEN OPERATORS STATION -PC11019

**INFORMATION ABOUT COMPATIBILITY**

VISIT OUR WEBSITE OR CONTACT US

A nighttime photograph of a cityscape viewed from an elevated position. The city lights are visible in the distance, and a road in the foreground is illuminated with light trails from moving vehicles. The sky is dark blue.

## CALIFORNIA DIESEL MANUFACTURING LLC

43114 BLACKDEER LOOP, SUITE F. TEMECULA, CALIFORNIA.

**OFFICE:** (+1) 951 296 9496 **MOBILE:** (+1) 951 375 6791

**EMAIL:** [contact@california-diesel.com](mailto:contact@california-diesel.com)

SOLENOIDS, SENSORS, DIESEL INJECTORS & MORE

**[www.california-diesel.com](http://www.california-diesel.com)**





AUTOMOTIVE

# SENSORS

**SENSOR 24279772 SPEED**

**Sku: SESS08**



**APPLICATIONS**

CHEVROLET CRUZE 2017  
CHEVROLET MALIBU 2017

**INFORMATION ABOUT COMPATIBILITY**

VISIT OUR WEBSITE OR CONTACT US

**SENSOR 87548200 SPEED**

**Sku: SESS09**



**APPLICATIONS**

CASE:  
MAGNUM 245, MX230, MX245, MAGNUM 275,  
MAGNUM 335, MX285, MAGNUM 235, MX210, MX305,  
MAGNUM 255, MX215, MAGNUM 215, MX255, MX275,  
MAGNUM 305

THIS PART REPLACES: CAS-87422106, CAS-87548198,  
CAS-A186005

**INFORMATION ABOUT COMPATIBILITY**

VISIT OUR WEBSITE OR CONTACT US

**SENSOR 600019 THROTTLE POSITION**

**Sku: SETPS01**



**APPLICATIONS**

E-Z-GO GOLF CART 2008-UP ELECTRIC RXV

THE E-Z-GO THROTTLE POSITION SENSOR (ANGLE SENSOR, OEM PART NUMBER 600019) IS A VERSATILE DEVICE THAT IS FULLY SEALED TO INGRESS PROTECTION IP67. THIS PROVIDES EXCEPTIONAL MECHANICAL DURABILITY AND LONG ELECTRICAL LIFE, MAKING IT IDEAL FOR APPLICATIONS SUCH AS THROTTLE / ACCELERATOR ANGLE (POSITION) SENSOR.

THE THROTTLE POSITION SENSOR PART NUMBER 600019 IS DESIGNED AS CONTINUOUS ROTATION ANGLE SENSOR, FITS TO E-Z-GO RXV GOLF CARTS.

**INFORMATION ABOUT COMPATIBILITY**

VISIT OUR WEBSITE OR CONTACT US



**SENSOR 810007726501 THROTTLE POSITION**

**Sku: SETPS02**



**APPLICATIONS**

PEUGEOT / CITROËN (96-2003)

206 HATCHBACK  
206 SW  
BERLINGO  
BERLINGO I BOX  
SAXO  
AND MORE.

**INFORMATION ABOUT COMPATIBILITY**

MAGNETIC MARELLI  
VISIT OUR WEBSITE OR CONTACT US

**SENSOR 810007726502 THROTTLE POSITION**

**Sku: SETPS03**



**APPLICATIONS**

PEUGEOT / CITROËN (96-2011)

106 II  
206 FASTBACK  
206 SW  
307 SW  
406 BREAK  
PARTNER COMBISPACE  
SAXO  
XSARA  
XSARA PICASSO  
AND MORE.

**INFORMATION ABOUT COMPATIBILITY**

VISIT OUR WEBSITE OR CONTACT US

**SENSOR 5010314772 THROTTLE POSITION**

**Sku: SETPS04**



**APPLICATIONS**

RENAULT TRUCKS MAGNUM E.TECH  
RENAULT B70 DCI  
RENAULT PREMIUM DCI

OEM: 7484557550 / 5010563341 / 7421111159  
MF# 7421111159  
WB: 1029-0003

**INFORMATION ABOUT COMPATIBILITY**

VISIT OUR WEBSITE OR CONTACT US

**SENSOR 21560199 THROTTLE POSITION**

**Sku: SETPS05**



**APPLICATIONS**

VOLVO PENTA  
 4.3 GXI-225-R  
 4.3 GI-200-R  
 4.3 GXI-P  
 4.3 GXI-Q  
 5.0 GXI-270-R  
 5.0 GXI-P  
 5.0 GXIC-270-R  
 5.0 GIC-225-S  
 5.0 GXIC-P  
 5.7 GI-300-P  
 5.7 GXI-P  
 5.7 GI-300-R  
 5.7 GXI-320-R  
 5.7 GIC-300-P  
 5.7 GXIC-P  
 5.7 GIC-300-R  
 5.7 GXIC-320-R  
 V6-200-A  
 V6-225-E-A

V8-225-C-A  
 V8-300-C-A  
 V8-320-C-A  
 V8-225-C-B  
 V8-300-C-B  
 V8-320-C-B  
 V8-270-A  
 V8-270-B  
 V8-270-C-A  
 V8-270-C-B  
 V8-300-A  
 V8-320-A  
 V8-300-B  
 V8-320-B  
 V8-350-C-D  
 V8-380-C-D  
 V8-380-C-A  
 V8-380-C-B

**INFORMATION ABOUT COMPATIBILITY**  
 VISIT OUR WEBSITE OR CONTACT US

**SENSOR JW2-H5885-00 THROTTLE POSITION**

**Sku: SETPS06**



**APPLICATIONS**

YAMAHA DRIVE G29 GOLF CART  
 OEM: JW2-H5885-00-00

**INFORMATION ABOUT COMPATIBILITY**  
 VISIT OUR WEBSITE OR CONTACT US

**SENSOR 98500112-D THROTTLE POSITION**

**Sku: SETPS07**



**APPLICATIONS**

CHEVROLET CORSA  
 CHEVROLET TORNADO (2006-2011)  
 CHEVROLET MERIVA (2004-2006).

**INFORMATION ABOUT COMPATIBILITY**  
 VISIT OUR WEBSITE OR CONTACT US



**SENSOR 266-1471 THROTTLE POSITION**

**Sku: SETPS08**

**APPLICATIONS**

CATERPILLAR:  
CAT 3408  
CAT 3412

**INFORMATION ABOUT COMPATIBILITY**

VISIT OUR WEBSITE OR CONTACT US



**SENSOR 266-1466 THROTTLE POSITION**

**Sku: SETPS09**

**APPLICATIONS**

CATERPILLAR:  
CAT ENGINES C7, C10, C12, C13, C15  
CAT 725, 730, 735, 740

**INFORMATION ABOUT COMPATIBILITY**

VISIT OUR WEBSITE OR CONTACT US



**SENSOR RE12180 TACHOMETER**

**Sku: SETS01**

**APPLICATIONS**

JOHN DEERE:  
JD 644G  
JD 644E  
JD 992D  
JD 744E  
TRACTORS 4000 SERIES  
TRACTORS 6800 SERIES  
TRACTORS 6810 SERIES  
TRACTORS 6820 SERIES  
TRACTORS 7000 SERIES  
TRACTORS 8000 SERIES  
TRACTORS SE6920 SERIES

**INFORMATION ABOUT COMPATIBILITY**

VISIT OUR WEBSITE OR CONTACT US



### SENSOR 4032173 TURBOCHARGER SPEED

**Sku: SETSS01**

#### APPLICATIONS

CUMMINS ISX EQUIPPED TRUCKS  
FREIGHTLINER 2011-10  
CASCADIA, CORONADO, FLD.

INTERNATIONAL 2011-10  
PROSTAR

KENWORTH 2011-10  
C500, T2000, T660, T700, T800, W900.

OSHKOSH 2011-10  
MODEL H, MODEL S.

PETERBILT 2011-10  
VOLVO 2011-10  
WESTERN STAR 2011-10

PETERBILT 2011-10  
320, 365, 367, 384, 386, 387, 388, 389, 567, 587.

VOLVO 2011-10  
VNL, VT.

WESTERN STAR 2011-10  
4900

**INFORMATION ABOUT COMPATIBILITY**  
VISIT OUR WEBSITE OR CONTACT US

**INFORMATION ABOUT COMPATIBILITY**  
VISIT OUR WEBSITE OR CONTACT US

### SENSOR 24279771 TRANSMISSION SPEED

**Sku: SETSS02**



#### APPLICATIONS

BUICK, CHEVROLET & GMC:

BUICK ENCLAVE 2018  
CHEVROLET CRUZE 2017-18  
CHEVROLET EQUINOX 2018  
CHEVROLET MALIBU 2017-18  
CHEVROLET TRAVERSE 2018  
GMC TERRAIN 2018

**INFORMATION ABOUT COMPATIBILITY**  
VISIT OUR WEBSITE OR CONTACT US

### SENSOR AH116104 TRANSMISSION SPEED

**Sku: SETSS03**



#### APPLICATIONS

JOHN DEERE:  
300 SERIES CUTTING PLATFORMS  
600 SERIES (RIGID AND FLEX) CUTTING PLATFORMS  
6100 SELF-PROPELLED SPRAYER  
614R (600 SERIES) CUTTING PLATFORM (S.N.052999)  
615R (600 SERIES) CUTTING PLATFORM (S.N.052999)  
618R (600 SERIES) CUTTING PLATFORM (S.N.052999)  
620R (600 SERIES) CUTTING PLATFORM (S.N.052999)  
622X (600 SERIES) CUTTING PLATFORM (S.N.049999)  
625R (600 SERIES) CUTTING PLATFORM (S.N.052999)  
630R (600 SERIES) CUTTING PLATFORM (S.N.052999)  
635R (600 SERIES) CUTTING PLATFORM (S.N.052999)  
640X (600 SERIES) CUTTING PLATFORM (S.N.049999)  
6500 SELF-PROPELLED SPRAYER  
6600 SELF-PROPELLED SPRAYER  
6700 SELF-PROPELLED SPRAYER  
900 SERIES CUTTING PLATFORM (S.N.625301-685400)

**INFORMATION ABOUT COMPATIBILITY**  
VISIT OUR WEBSITE OR CONTACT US



**SENSOR 87627614 WHEEL ANGLE**

**Sku: SEWAS01**



**APPLICATIONS**

CASE / NEW HOLLAND / STEYR  
AGRICULTURE ENGINE AND CONSTRUCTION  
EQUIPMENT.

**CASE:**

- IH MAXXUM CVT 110
- IH MAXXUM CVX 110
- IH MAXXUM 110 EP EFFICIENT POWER
- IH MAXXUM 115
- IH MAXXUM CVT 115
- IH MAXXUM CVX 115
- IH MAXXUM 115 EP EFFICIENT POWER
- IH MAXXUM CVT 120
- IH MAXXUM CVX 120
- IH MAXXUM 120 EP EFFICIENT POWER
- IH MAXXUM 125
- IH MAXXUM CVT 125
- IH PUMA 150
- IH PUMA 150 CVT
- IH PUMA 150 CVX
- AND MORE.

NEW HOLLAND:  
T6.120 - 180

- STEYR:**
- 4110, 4120, 4130, 6185, 6205, 6215.
  - CVT 6150 - 6240
  - ET PROFI 4115 - 4145, 6145.
  - PROFI 4110 CLASSIC
  - PROFI 6125 CLASSIC
  - PROFI 6140 CLASSIC
  - PROFI 4110 CLASSIC
  - PROFI 4120 CLASSIC
  - PROFI 4130 CLASSIC
  - PROFI 6125 CLASSIC
  - PROFI 6140 CLASSIC

**INFORMATION ABOUT COMPATIBILITY**

VISIT OUR WEBSITE OR CONTACT US

**SENSOR ALS1791 WHEEL SPEED**

**Sku: SEWSS01**



**APPLICATIONS**

- TOYOTA SEQUOIA (17-08)
- TOYOTA TUNDRA (17-07)

**INFORMATION ABOUT COMPATIBILITY**

VISIT OUR WEBSITE OR CONTACT US

**JOIN US ON OUR SOCIAL NETWORKS:**



### BENDIX WS-24 WHEEL SPEED SENSORS



90 DEGREES



0 STRAIGHT

SERVICE HARNESS PC NO. LENGHT	APPLICATION	BODY STYLE	CONNECTOR
801538 75" / 1919MM	PETERBILT, KENWORTH	90°	DIN
801542 78" / 1987MM	KENWORTH, MACK PETERBILT, KENWORTH, VOLVO TRAILERS MARKET ONLY	0° STRAIGHT	DIN
801543 66" / 1687MM		0° STRAIGHT	DIN
801544 12" / 319MM		90°	DIN
801546 60" / 1524MM		90°	DTM06-2S
801548 48" / 1219MM		90°	DTM06-2S
801549 60" / 1524MM	INTERNATIONAL INTERNATIONAL INTERNATIONAL INTERNATIONAL INTERNATIONAL	90°	DEUTSCH DT04-2P
801550 75" / 1905MM		90°	DEUTSCH DT04-2P
801551 40" / 1016MM		90°	DEUTSCH DT04-2P
801552 75" / 1905MM		0° STRAIGHT	DEUTSCH DT04-2P
801553 40" / 1016MM		0° STRAIGHT	DEUTSCH DT04-2P
801556 60" / 1092MM		0° STRAIGHT	GT 150 SERIES
801558 37" / 949MM		90°	GT 150 SERIES
801563 60" / 1524MM		0° STRAIGHT	DTM06-2S
801565 75" / 2617MM		0° STRAIGHT	DEUTSCH DT04-2P
801566 75" / 1905MM		90°	DELPHI MP-P
801567 63" / 1600MM	0° STRAIGHT	DELPHI MP-P	
801836 75" / 2617MM		90°	DEUTSCH DT04-2P



STANDARD 2-PIN DIN



DEUTSCH DT04-2P



DELPHI C150



DELPHI GT150



DTM06-2S

### HALDEX WHEEL SPEED SENSORS REPLACEMENTS



90 DEGREES



0 STRAIGHT

OEM PART.	HARNESS LENGHT	PRODUCT DESCRIPTION	BODY STYLE
364094011	0.5M	ABS 90° SENSOR BODY	90°
364094041	1.5M	ABS 90° SENSOR BODY	90°
364094051	1.75M	ABS 90° SENSOR BODY	90°
364094081	2.5M	ABS 90° SENSOR BODY	90°
364094091	3M	ABS 90° SENSOR BODY	90°
364528001	0.5M	ABS 90° SENSOR BODY	0° STRAIGHT









## CALIFORNIA DIESEL MANUFACTURING LLC

43114 BLACKDEER LOOP, SUITE F. TEMECULA, CALIFORNIA.

**OFFICE:** (+1) 951 296 9496 **MOBILE:** (+1) 951 375 6791

**EMAIL:** [contact@california-diesel.com](mailto:contact@california-diesel.com)

SOLENOIDS, SENSORS, DIESEL INJECTORS & MORE

[www.california-diesel.com](http://www.california-diesel.com)



# DIESEL INJECTORS

**7.3L POWER STROKE**



**HEUI INJECTOR\***

**AP63800AA**

**YEAR RANGE:**

1994-1998  
1994-1996  
1994-1996

**APPLICATION:**

F-SERIES  
F-SERIES (CALIFORNIA)  
E-SERIES

**OEM PART NUMBERS:** F81Z9E527DRM, F4TZ9VE527AARM, F7TZ9E527ARM

**HEUI INJECTOR\***

**AP63801AB**

**YEAR RANGE:**

1999  
1997-1999  
1997-1998

**APPLICATION:**

F-SERIES  
F-SERIES (CALIFORNIA)  
E-SERIES

**OEM PART NUMBERS:** F81Z9E527BRM, F7TZ9E527BRM, F61Z9VE527BRM, F61Z9VE527ERM

**NOTES:** PRIME (SPLIT SHOT) INJECTOR ENGINES BUILT BEFORE 12/07/1998



**HEUI INJECTOR\***

**AP63803AD**

**YEAR RANGE:**

1999-2003

**APPLICATION:**

F-SERIES, E-SERIES

**OEM PART NUMBERS:** F81Z9E527CRM, 5C3Z9VE527BRM

**NOTES:** PRIME (SPLIT SHOT) INJECTOR ENGINES BUILT BEFORE 12/07/1998

**HEUI INJECTOR\***

**AP63804AE**

**YEAR RANGE:**

1999-2003  
1999-2003

**APPLICATION:**

F-SERIES  
F-SERIES (CALIFORNIA)

**OEM PART NUMBERS:** F81Z9E527EARM, XC3Z9E527AARM, 5C3Z9VE527ARM

**NOTES:** LONG LEAD (LL OR BLUE HARNESS CONNECTOR) INJECTOR. ENGINES BUILT AFTER 12/07/1998. USED IN #8 CYLINDER TO ELIMINATE "CACKLE" (PER FORD BULLETINS 00-10-1, 00-22-1, AND 01-14-6).



## 7.3L POWER STROKE

**HEUI REFURBISHED INJECTOR\***  
**HEUI REBUILT INJECTOR\***

**CDM-01AA**  
**CDM-02AA**

**YEAR RANGE:**

1994-1998  
 1994-1996  
 1994-1996

**APPLICATION:**

F-SERIES  
 F-SERIES (CALIFORNIA)  
 E-SERIES



**OEM PART NUMBERS:** F81Z9E527DRM, F4TZ9VE527AARM, F7TZ9E527ARM



**HEUI REFURBISHED INJECTOR\***  
**HEUI REBUILT INJECTOR\***

**CDM-01AB**  
**CDM-02AB**

**YEAR RANGE:**

1999  
 1997-1999  
 1997-1998

**APPLICATION:**

F-SERIES  
 F-SERIES (CALIFORNIA)  
 E-SERIES



**OEM PART NUMBERS:** F81Z9E527BRM, F7TZ9E527BRM, F61Z9VE527BRM, F61Z9VE527ERM

**NOTES:** PRIME (SPLIT SHOT) INJECTOR ENGINES BUILT BEFORE 12/07/1998

**HEUI REFURBISHED INJECTOR\***  
**HEUI REBUILT INJECTOR\***

**CDM-01AD**  
**CDM-02AD**

**YEAR RANGE:**

1999-2003

**APPLICATION:**

F-SERIES, E-SERIES



**OEM PART NUMBERS:** F81Z9E527CRM, 5C3Z9VE527BRM

**NOTES:** PRIME (SPLIT SHOT) INJECTOR ENGINES BUILT BEFORE 12/07/1998



**HEUI REFURBISHED INJECTOR\***  
**HEUI REBUILT INJECTOR\***

**CDM-01AE**  
**CDM-02AE**

**YEAR RANGE:**

1999-2003  
 1999-2003

**APPLICATION:**

F-SERIES  
 F-SERIES (CALIFORNIA)



**OEM PART NUMBERS:** F81Z9E527EARM, XC3Z9E527AARM, 5C3Z9VE527ARM

**NOTES:** LONG LEAD (LL OR BLUE HARNESS CONNECTOR) INJECTOR. ENGINES BUILT AFTER 12/07/1998. USED IN #8 CYLINDER TO ELIMINATE "CACKLE" (PER FORD BULLETINS 00-10-1, 00-22-1, AND 01-14-6).

ALL OUR DIESEL INJECTORS ARE REBUILT, REFURBISHED AND / OR REMANUFACTURED WITH NEW OE QUALITY COILS  
 \*Indicates products with a core charge.





**6.0L and 4.5L POWER STROKE**

**PPT REMANUFACTURED G2.8 INJECTOR\***  
**PPT NEW G2.8 INJECTOR\***

**AP60900**  
**AP60800**

**YEAR RANGE:**  
 2003-09/21/2003  
 2003-09/21/2003  
 2003-09/21/2003

**APPLICATION:**  
 F-250 / F-550, EXCURSION  
 F-250 / F-550, EXCURSION  
 F-650 / F-750

**OEM PART NUMBERS:** 3C3Z9E527EBRM / EARM / AE / ABRM / ECRM, 6918-PP  
**NOTES:** ENGINES BUILT BEFORE 09/22/2003

**PPT REMANUFACTURED G2.8 INJECTOR\***  
**PPT NEW G2.8 INJECTOR\***

**AP60901**  
**AP60801**

**YEAR RANGE:**  
 09/22/2003-2007  
 2005-2007  
 2004-2010  
 2006-2010

**APPLICATION:**  
 F-250 / F-550, EXCURSION  
 F-650 / F-750, EXCURSION  
 E-SERIES  
 4.5L LCF

**OEM PART NUMBERS:** 4C3Z9E527AA / BRM, 7E7Z9E527AA , 6919-PP  
**NOTES:** ENGINES BUILT ON OR AFTER 09/22/2003



Ford F-150 Raptor - Most Extreme Production Truck On The Planet standing on a sand dune by the ocean



**6.0L and 4.5L POWER STROKE**

**CDM REFURBISHED G2.8 INJECTOR\***

**CDM60901**

Refurbished & tested 6.0 injectors, that were removed from a running engine. They are cleaned externally in an ultrasonic tank, flushed internally, and the nozzles are reconditioned. Each injector is Individually tested on a state of the art test stand to ensure that they meet OEM specifications. Each test includes system leak test, purge, idle speed test, mid load test, and full load test. Guaranteed to be within factory specification. Each injector includes all hardware necessary for installation (O-rings, copper crush washers).



**CDM REBUILT G2.8 INJECTOR\***

**CDM60902**

These injectors are Rebuilt using brand new components. Each injector includes all hardware necessary for installation (O-rings, copper crush washers.)



**CDM REMANUFACTURE G2.8 INJECTOR\***

**CDM60903**

These injectors are Rebuilt using brand new components (including nozzle, slotted coil, control/spool valve & plunger) These are the most up to date version of the 6.0 Powerstroke injector. Each injector is sealed and individually packaged including O-rings and copper crush washers necessary for installation.



**YEAR RANGE:**

2003-09/21/2003  
 2003-09/21/ 2003  
 09/22/2003-2007  
 2005-2007  
 2004-2010  
 2006-2010

**APPLICATION:**

F-250 / F-550, EXCURSION  
 F-650 / F-750  
 F-250 / F-550, EXCURSION  
 F-650 / F-750, EXCURSION  
 E-SERIES  
 4.5L LCF

**OEM PART NUMBERS:** 3C3Z9E527EBRM / EARM / AE / ABRM / ECRM, 6901-PP, 6918-PP, 4C3Z9E527AA / BRM, 7E7Z9E527AA , 6902-PP, 6919-PP

ALL OUR DIESEL INJECTORS ARE REBUILT, REFURBISHED AND / OR REMANUFACTURED WITH NEW OE QUALITY COILS  
 \*Indicates products with a core charge.





# WE BUY CORES

## CALIFORNIA DIESEL MANUFACTURING LLC

43114 BLACKDEER LOOP, SUITE F. TEMECULA, CALIFORNIA.

**OFFICE:** (+1) 951 296 9496 **MOBILE:** (+1) 951 375 6791

**EMAIL:** [contact@california-diesel.com](mailto:contact@california-diesel.com)

SOLENOIDS, SENSORS, DIESEL INJECTORS & MORE

[www.california-diesel.com](http://www.california-diesel.com)





DIESEL SHOP, DIESEL COILS SPECIALIST, DIESEL INJECTORS REMANUFACTURE & PARTS SUPPLIER

**951.296.9496**



### T444E

**HEUI INJECTOR\***

**AP63800AA**

**YEAR RANGE:**  
1994-1996

**APPLICATION:**  
T444E

**OEM PART NUMBERS:** 1816187C3, 1818259C2, 1821752C1, 1821836C3, 1822800C95, 1822801C91

**HEUI INJECTOR\***

**AP63801AB**

**YEAR RANGE:**  
1997-1999

**APPLICATION:**  
T444E

**OEM PART NUMBERS:** 1822803C1, 1823561C1, 1824582C94, 1824583C97, 1825125C1, 1825126C1

**NOTES:** PRIME (SPLIT SHOT) INJECTOR ENGINES BUILT BEFORE 12/07/1998

**HEUI INJECTOR\***

**AP63803AC**

**YEAR RANGE:**  
1994-1996

**APPLICATION:**  
T444E

**OEM PART NUMBERS:** 1824474C2, 1822890C1, 1824472C1, 1824473C2, 1824455C94, 1824456C96

**NOTES:** PRIME (SPLIT SHOT) INJECTOR ENGINES BUILT BEFORE 12/07/1998



**HEUI INJECTOR\***

**AP63804AD**

**YEAR RANGE:**  
1999-2003

**APPLICATION:**  
T444E

**OEM PART NUMBERS:** 1823751C91, 1831487C92, 1831488C1, 1831489C12, 1831550C14, 1831551C13

**NOTES:** Prime (split shot) injector. recommend replacing ad injector in #8 cylinder location with AE injector to eliminate "cackle".

**HEUI INJECTOR\***

**AP63804AE**

**YEAR RANGE:**  
2002-2003

**APPLICATION:**  
T444E

**OEM PART NUMBERS:** 1833639C1, 1833640C1, 1833644C1, 1833645C1, 1833646C92, 1833647C91

**NOTES:** LONG LEAD (LL OR BLUE HARNESS CONNECTOR) INJECTOR. USED IN #8 CYLINDER TO ELIMINATE "CACKLE".



**T444E**

**HEUI REFURBISHED INJECTOR\***  
**HEUI REBUILT INJECTOR\***

**CDM-01AA**  
**CDM-02AA**

**YEAR RANGE:** 1994-1996  
**APPLICATION:** T444E

**OEM PART NUMBERS:** 1816187C3, 1818259C2, 1821752C1, 1821836C3, 1822800C95, 1822801C91



**HEUI REFURBISHED INJECTOR\***  
**HEUI REBUILT INJECTOR\***

**CDM-01AB**  
**CDM-02AB**

**YEAR RANGE:** 1997-1999  
**APPLICATION:** T444E

**OEM PART NUMBERS:** 1822803C1, 1823561C1, 1824582C94, 1824583C97, 1825125C1, 1825126C1  
**NOTES:** PRIME (SPLIT SHOT) INJECTOR ENGINES BUILT BEFORE 12/07/1998



**HEUI REFURBISHED INJECTOR\***  
**HEUI REBUILT INJECTOR\***

**CDM-01AC**  
**CDM-02AC**

**YEAR RANGE:** 1994-1996  
**APPLICATION:** T444E HIGH OUPUT 210HP (HT) TO 230 HP

**OEM PART NUMBERS:** 1824474C2, 1822890C1, 1824472C1, 1824473C2, 1824455C94, 1824456C96  
**NOTES:** PRIME (SPLIT SHOT) INJECTOR ENGINES BUILT BEFORE 12/07/1998



**HEUI REFURBISHED INJECTOR\***  
**HEUI REBUILT INJECTOR\***

**CDM-01AD**  
**CDM-02AD**

**YEAR RANGE:** 1999-2003  
**APPLICATION:** T444E

**OEM PART NUMBERS:** 1823751C91, 1831487C92, 1831488C1, 1831489C12, 1831550C14, 1831551C13  
**NOTES:** Prime (split shot) injector. recommend replacing ad injector in #8 cylinder location with AE injector to eliminate "cacke".



**HEUI REFURBISHED INJECTOR\***  
**HEUI REBUILT INJECTOR\***

**CDM-01AE**  
**CDM-02AE**

**YEAR RANGE:** 2002-2003  
**APPLICATION:** T444E

**OEM PART NUMBERS:** 1833639C1, 1833640C1, 1833644C1, 1833645C1, 1833646C92, 1833647C91  
**NOTES:** LONG LEAD (LL OR BLUE HARNESS CONNECTOR) INJECTOR. USED IN #8 CYLINDER TO ELIMINATE "CAKLE" .



ALL OUR DIESEL INJECTORS ARE REBUILT, REFURBISHED AND / OR REMANUFACTURED WITH NEW OE QUALITY COILS  
 \*Indicates products with a core charge.





### VT365, VT275, MAXXFORCE 5

**PPT REMANUFACTURED G2.8 INJECTOR\***  
**PPT NEW G2.8 INJECTOR\***

**AP60900**  
**AP60800**

**YEAR RANGE:**  
2002.5 - 2003

**APPLICATION:**  
VT365

**OEM PART NUMBERS:** 1843089C91, 1843481C95, 1845879C91, 1878282C91

**PPT REMANUFACTURED G2.8 INJECTOR\***  
**PPT NEW G2.8 INJECTOR\***

**AP60901**  
**AP60801**

**YEAR RANGE:**  
2004 - 2006  
2006  
2007 - 2010

**APPLICATION:**  
VT365  
VT365  
VT365

**OEM PART NUMBERS:** 1844751C2, 1845150C92, 1846692C92, 1877748C1, 1878284C91, 1878285C91, 1879998C91

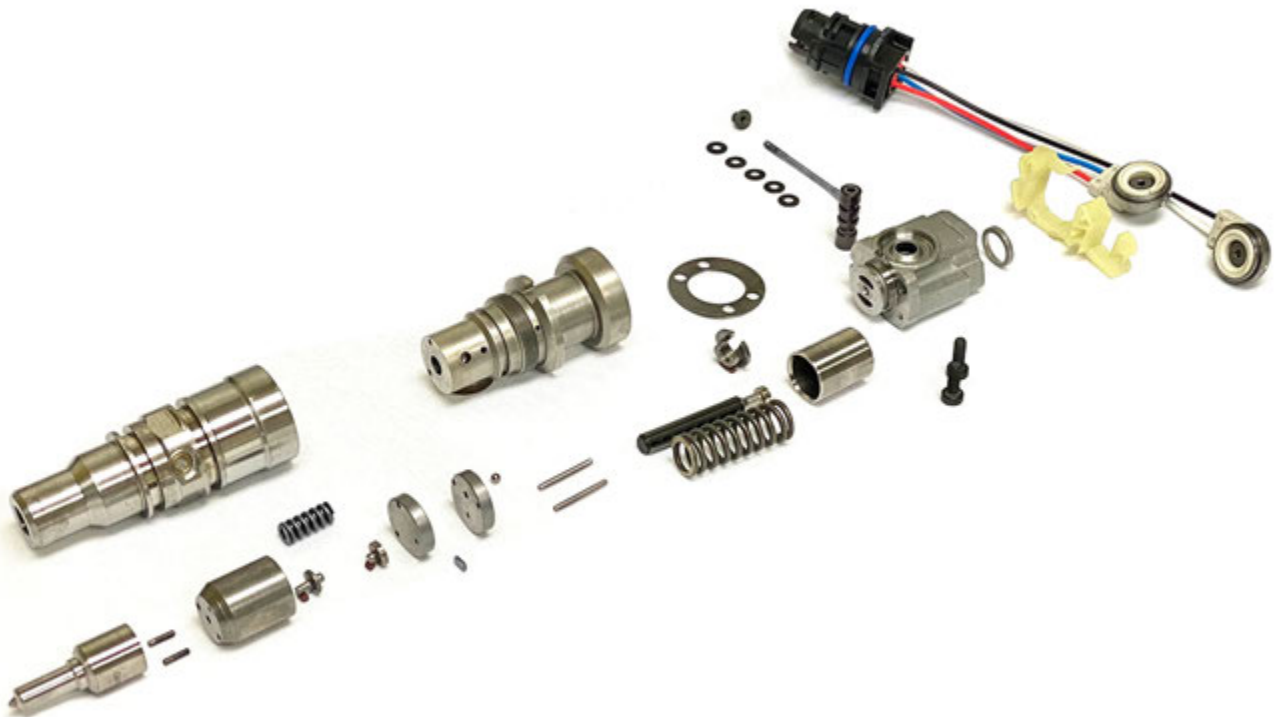

**G2.8 INJECTOR PARTS EXPLODED VIEW**



**VT365, VT275, MAXXFORCE 5**

**CDM REFURBISHED G2.8 INJECTOR\***

**CDM-60901**

Refurbished & tested 6.0 injectors, that were removed from a running engine. They are cleaned externally in an ultrasonic tank, flushed internally, and the nozzles are reconditioned. Each injector is Individually tested on a state of the art test stand to ensure that they meet OEM specifications. Each test includes system leak test, purge, idle speed test, mid load test, and full load test. Guaranteed to be within factory specification. Each injector includes all hardware necessary for installation (O-rings, copper crush washers).



**CDM REBUILT G2.8 INJECTOR\***

These injectors are Rebuilt using brand new components. Each injector includes all hardware necessary for installation (O-rings, copper crush washers.)



**CDM REMANUFACTURE G2.8 INJECTOR\***

**CDM-60903**

These injectors are Rebuilt using brand new components (including nozzle, slotted coil, control/spool valve & plunger) These are the most up to date version of the 6.0 Powerstroke injector. Each injector is sealed and individually packaged including O-rings and copper crush washers necessary for installation.



**YEAR RANGE:**

**APPLICATION:**

2002.5 - 2003  
2004 - 2006  
2006  
2007 - 2010

VT365  
VT365  
VT365  
VT365

**OEM PART NUMBERS:** 1843089C91, 1843481C95, 1845879C91, 1878282C91, 1844751C2, 1845150C92, 1846692C92, 1877748C1, 1878284C91, 1878285C91, 1879998C91



ALL OUR DIESEL INJECTORS ARE REBUILT, REFURBISHED AND / OR REMANUFACTURED WITH NEW OE QUALITY COILS  
\*Indicates products with a core charge.





### DT466E, I530, DT466 / 530, HT530

**HEUI INJECTOR\*** **AP63805BA**

**YEAR RANGE:** 1995-1997  
**APPLICATION:** DT466E: 230 HP

**OEM PART NUMBERS:** 181934C1, 1819834C1, 1823736C94, 1824917C2, 1824928C94, 2593588C91

**HEUI INJECTOR\*** **AP63806BB**

**YEAR RANGE:** 1995-1997  
**APPLICATION:** DT466E: 175 HP - 190 HP

**OEM PART NUMBERS:** 1824739C1, 1824742C91, 1824918C2, 1824929C94, 2593589C91

**HEUI INJECTOR\*** **AP63807BC**

**YEAR RANGE:** 1995-1997  
**APPLICATION:** DT466E: 195 HP - 230 HP

**OEM PART NUMBERS:** 1824740C1, 1824743C91, 1824919C2, 1824930C94, 2593590C91

**HEUI INJECTOR\*** **AP63808BD**

**YEAR RANGE:** 1995-1997  
**APPLICATION:** I530E: 250 HP - 300 HP

**OEM PART NUMBERS:** 1824741C2, 1824744C94, 1824920C2, 1824931C94, 2593591C91

**HEUI INJECTOR\*** **AP63809BE**

**YEAR RANGE:** 1997-1999  
**APPLICATION:** DT466E: 175 HP - 190 HP

**OEM PART NUMBERS:** 1824839C94, 1829336C1, 1829837C2, 1829838C94, 1829839C93, 1829926C2, 2593592C91

**HEUI INJECTOR\*** **AP63810BF**

**YEAR RANGE:** 1998-1999  
**APPLICATION:** I530E: 250 HP - 300 HP

**OEM PART NUMBERS:** 1830145C91, 1830146C94, 1830147C2, 1830148C2, 2593593C91



**DT466E, I530, DT466 / 530, HT530**

**HEUI REFURBISHED INJECTOR\***  
**HEUI REBUILT INJECTOR\***

**CDM-01BA**  
**CDM-02BA**

**YEAR RANGE:**  
 1995-1997

**APPLICATION:**  
 DT466E: 230 HP

**OEM PART NUMBERS:** 181934C1, 1819834C1, 1823736C94, 1824917C2, 1824928C94, 2593588C91



**HEUI REFURBISHED INJECTOR\***  
**HEUI REBUILT INJECTOR\***

**CDM-01BB**  
**CDM-02BB**

**YEAR RANGE:**  
 1995-1997

**APPLICATION:**  
 DT466E: 175 HP - 190 HP

**OEM PART NUMBERS:** 1824739C1, 1824742C91, 1824918C2, 1824929C94, 2593589C91



**HEUI REFURBISHED INJECTOR\***  
**HEUI REBUILT INJECTOR\***

**CDM-01BC**  
**CDM-02BC**

**YEAR RANGE:**  
 1995-1997

**APPLICATION:**  
 DT466E: 195 HP - 230 HP

**OEM PART NUMBERS:** 1824740C1, 1824743C91, 1824919C2, 1824930C94, 2593590C91



**HEUI REFURBISHED INJECTOR\***  
**HEUI REBUILT INJECTOR\***

**CDM-01BD**  
**CDM-02BD**

**YEAR RANGE:**  
 1995-1997

**APPLICATION:**  
 I530E: 250 HP - 300 HP

**OEM PART NUMBERS:** 1824741C2, 1824744C94, 1824920C2, 1824931C94, 2593591C91



**HEUI REFURBISHED INJECTOR\***  
**HEUI REBUILT INJECTOR\***

**CDM-01BE**  
**CDM-02BE**

**YEAR RANGE:**  
 1997-1999

**APPLICATION:**  
 DT466E: 175 HP - 190 HP

**OEM PART NUMBERS:** 1824839C94, 1829336C1, 1829837C2, 1829838C94, 1829839C93, 1829926C2, 2593592C91



**HEUI REFURBISHED INJECTOR\***  
**HEUI REBUILT INJECTOR\***

**CDM-01BF**  
**CDM-02BF**

**YEAR RANGE:**  
 1997-1999

**APPLICATION:**  
 DT466E: 175 HP - 190 HP

**OEM PART NUMBERS:** 1824839C94, 1829336C1, 1829837C2, 1829838C94, 1829839C93, 1829926C2, 2593592C91



ALL OUR DIESEL INJECTORS ARE REBUILT, REFURBISHED AND / OR REMANUFACTURED WITH NEW OE QUALITY COILS

\*Indicates products with a core charge.





### DT466E, I530, DT466 / 530, HT530

#### HEUI INJECTOR\*

**AP63811BI**

#### YEAR RANGE:

1999  
2000-2003

#### APPLICATION:

DT466E: 175 HP A 250 HP (HT)  
DT466E: 175 HP A 250 HP (HT)

**OEM PART NUMBERS:** 1830559C91, 1830560C2, 1830561C92, 1830562C2, 1830740C92, 1830741C92, 2593594C91, 2593595C91

#### HEUI INJECTOR\*

**BG**

#### YEAR RANGE:

1997-1999

#### APPLICATION:

DT466E: 230 HP (HT) A 250 HP (HT)

**OEM PART NUMBERS:** 1830155C91, 1830156C91, 1830157C1, 1830158C1, 1830570C91, 1830573C2, 2593596C91

**NOTE:** DISCONTINUED, SUPERSEDES TO AP63812BJ

#### HEUI INJECTOR\*

**AP63812BJ**

#### YEAR RANGE:

1999

#### APPLICATION:

I530E: 230 (HT) HP - 300 HP (HT)

**OEM PART NUMBERS:** 1830094C92, 1830570C92, 1830571C2, 1830572C93, 1830573C2, 2593596C91

#### HEUI INJECTOR\*

**AP63813BN**

#### YEAR RANGE:

2000-2003

#### APPLICATION:

DT530, HT530: 250 HP - 340 HP (HT)

**OEM PART NUMBERS:** 1830691C1, 1830692C91, 1830693C1, 1830694C93, 2593597C91

#### HEUI INJECTOR\*

**AP63814BP**

#### YEAR RANGE:

2000 & RECENT

#### APPLICATION:

DT466 TRANSIT

**OEM PART NUMBERS:** 1836250C1, 1836251C91, 1836252C91, 1836253C1





**DT466E, I530, DT466 / 530, HT530**

**HEUI REFURBISHED INJECTOR\***  
**HEUI REBUILT INJECTOR\***

**CDM-01BI**  
**CDM-02BI**

**YEAR RANGE:**

1999  
2000-2003

**APPLICATION:**

DT466E: 175 HP A 250 HP (HT)  
DT466E: 175 HP A 250 HP (HT)

**OEM PART NUMBERS:** 1830559C91, 1830560C2, 1830561C92, 1830562C2, 1830740C92, 1830741C92, 2593594C91, 2593595C91



**HEUI REFURBISHED INJECTOR\***  
**HEUI REBUILT INJECTOR\***

**CDM-01BG**  
**CDM-02BG**

**YEAR RANGE:**

1997-1999

**APPLICATION:**

DT466E: 230 HP (HT) A 250 HP (HT)

**OEM PART NUMBERS:** 1830155C91, 1830156C91, 1830157C1, 1830158C1, 1830570C91, 1830573C2, 2593596C91



**NOTE:** DISCONTINUED, SUPERSEDES TO BJ

**HEUI REFURBISHED INJECTOR\***  
**HEUI REBUILT INJECTOR\***

**CDM-01BJ**  
**CDM-02BJ**

**YEAR RANGE:**

1999

**APPLICATION:**

I530E: 230 (HT) HP - 300 HP (HT)

**OEM PART NUMBERS:** 1830094C92, 1830570C92, 1830571C2, 1830572C93, 1830573C2, 2593596C91



**HEUI REFURBISHED INJECTOR\***  
**HEUI REBUILT INJECTOR\***

**CDM-01BN**  
**CDM-02BN**

**YEAR RANGE:**

2000-2003

**APPLICATION:**

DT530, HT530: 250 HP - 340 HP (HT)

**OEM PART NUMBERS:** 1830691C1, 1830692C91, 1830693C1, 1830694C93, 2593597C91



**HEUI REFURBISHED INJECTOR\***  
**HEUI REBUILT INJECTOR\***

**CDM-01BP**  
**CDM-02BP**

**YEAR RANGE:**

2000 & RECENT

**APPLICATION:**

DT466 TRANSIT

**OEM PART NUMBERS:** 1836250C1, 1836251C91, 1836252C91, 1836253C1



ALL OUR DIESEL INJECTORS ARE REBUILT, REFURBISHED AND / OR REMANUFACTURED WITH NEW OE QUALITY COILS

\*Indicates products with a core charge.





### PERKINS, DETROIT DIESEL, AGCO

#### HEUI INJECTOR\*

**AP63805BA**

**YEAR RANGE:**

1995-1997

**APPLICATION:**

EDI SERIE 1300 7.6 L PERKINS

**OEM PART NUMBERS:** 181934C1, 1819834C1, 1823736C94, 1824917C2, 1824928C94, 2593588C91

#### HEUI INJECTOR\*

**AP63808BD**

**YEAR RANGE:**

1995-1997

**APPLICATION:**

EDI SERIE 1300 8.7 L PERKINS

**OEM PART NUMBERS:** 1824741C2, 1824744C94, 1824920C2, 1824931C94, 2593591C91

#### HEUI INJECTOR\*

**AP63810BF**

**YEAR RANGE:**

1998-1999

**APPLICATION:**

EDI SERIE 1300 8.7 L PERKINS

1998-1999

SERIE 40E 8. 7 L DETROIT DIESEL

1998-1999

8.7 L AGCO 9675

**OEM PART NUMBERS:** 1830145C91, 1830146C94, 1830147C2, 1830148C2, 2593593C91

#### HEUI INJECTOR\*

**AP63811BI**

**YEAR RANGE:**

1999-2003

**APPLICATION:**

EDI SERIE 1300 7.6 L PERKINS

**OEM PART NUMBERS:** 1830559C91, 1830560C2, 1830561C92, 1830562C2, 1830740C92, 1830741C92, 2593594C91, 2593595C91

#### HEUI INJECTOR\*

**AP63812BJ**

**YEAR RANGE:**

1999

**APPLICATION:**

EDI SERIE 1300 8.7 L PERKINS

1999

SERIE 40E 8.7 L DETROIT DIESEL

**OEM PART NUMBERS:** 1830094C92, 1830570C92, 1830571C2, 1830572C93, 1830573C2, 2593596C91



**PERKINS, DETROIT DIESEL, AGCO**

**HEUI REFURBISHED INJECTOR\***  
**HEUI REBUILT INJECTOR\***

**CDM-01BA**  
**CDM-02BA**

**YEAR RANGE:** 1995-1997  
**APPLICATION:** EDI SERIE 1300 7.6 L PERKINS

**OEM PART NUMBERS:** 181934C1, 1819834C1, 1823736C94, 1824917C2, 1824928C94, 2593588C91



**HEUI REFURBISHED INJECTOR\***  
**HEUI REBUILT INJECTOR\***

**CDM-01BD**  
**CDM-02BD**

**YEAR RANGE:** 1995-1997  
**APPLICATION:** EDI SERIE 1300 8.7 L PERKINS

**OEM PART NUMBERS:** 1824741C2, 1824744C94, 1824920C2, 1824931C94, 2593591C91



**HEUI REFURBISHED INJECTOR\***  
**HEUI REBUILT INJECTOR\***

**CDM-01BF**  
**CDM-02BF**

**YEAR RANGE:** 1998-1999  
**APPLICATION:** EDI SERIE 1300 8.7 L PERKINS  
 1998-1999 SERIE 40E 8.7 L DETROIT DIESEL  
 1998-1999 8.7 L AGCO 9675

**OEM PART NUMBERS:** 1830145C91, 1830146C94, 1830147C2, 1830148C2, 2593593C91



**HEUI REFURBISHED INJECTOR\***  
**HEUI REBUILT INJECTOR\***

**CDM-01BI**  
**CDM-02BI**

**YEAR RANGE:** 1999-2003  
**APPLICATION:** EDI SERIE 1300 7.6 L PERKINS

**OEM PART NUMBERS:** 1830559C91, 1830560C2, 1830561C92, 1830562C2, 1830740C92, 1830741C92, 2593594C91, 2593595C91



**HEUI REFURBISHED INJECTOR\***  
**HEUI REBUILT INJECTOR\***

**CDM-01BJ**  
**CDM-02BJ**

**YEAR RANGE:** 1999  
**APPLICATION:** EDI SERIE 1300 8.7 L PERKINS  
 1999 SERIE 40E 8.7 L DETROIT DIESEL

**OEM PART NUMBERS:** 1830094C92, 1830570C92, 1830571C2, 1830572C93, 1830573C2, 2593596C91



ALL OUR DIESEL INJECTORS ARE REBUILT, REFURBISHED AND / OR REMANUFACTURED WITH NEW OE QUALITY COILS

\*Indicates products with a core charge.





**PERKINS, DETROIT DIESEL, AGCO**

**HEUI REFURBISHED INJECTOR\***  
**HEUI REBUILT INJECTOR\***

**CDM-01BN**  
**CDM-02BN**

**YEAR RANGE:**

2000-2003  
 2000-2003

**APPLICATION:**

EDI SERIE 1300 8.7 L PERKINS  
 SERIE 40E 8.7 L DETROIT DIESEL

**OEM PART NUMBERS:** 1830691C1, 1830692C91, 1830693C1, 1830694C93,  
 2593597C91 **HEUI REFURBISHED INJECTOR\***  
**CDM-01BP**



**HEUI REFURBISHED INJECTOR\***  
**HEUI REBUILT INJECTOR\***

**CDM-01BP**  
**CDM-02BP**

**YEAR RANGE:**

2000-RECENT

**APPLICATION:**

SERIE 40E 7.6 L DETROIT DIESEL

**OEM PART NUMBERS:** 1836250C1, 1836251C91, 1836252C91, 1836253C12593597C91



ALL OUR DIESEL INJECTORS ARE REBUILT, REFURBISHED AND / OR REMANUFACTURED WITH NEW OE QUALITY COILS  
 \*Indicates products with a core charge.



## DT466 / 570, HT570, MAXXFORCE DT / 9 / 10, N9 / N10



**PPT REMANUFACTURED G2.9 INJECTOR\*** **AP66976**  
**PPT NEW G2.9 INJECTOR\*** **AP66876**

**YEAR RANGE:** 2004  
**APPLICATION:** DT466: 210 HP A 225 HP

**OEM PART NUMBERS:** 1842576C93, 5010656R92, 1841491C91, 1842223C91, 6905-PP, 6922-PP

**PPT REMANUFACTURED G2.9 INJECTOR\*** **AP66977**  
**PPT NEW G2.9 INJECTOR\*** **AP66877**

**YEAR RANGE:** 2004, 2005  
**APPLICATION:** DT466: 245 HP A 285 HP (HT), DT466: 210 HP A 285 HP

**OEM PART NUMBERS:** 842577C93, 5010657R92, 1842224C91, 6906-PP, 6923-PP

**PPT REMANUFACTURED G2.9 INJECTOR\*** **AP66978**  
**PPT NEW G2.9 INJECTOR\*** **AP66878**

**YEAR RANGE:** 2004-2005  
**APPLICATION:** DT570: 285 HP A 330 HP

**OEM PART NUMBERS:** 1842578C94, 5010658R92, 1842225C91, 6907-PP, 6924-PP

**PPT REMANUFACTURED G2.9 INJECTOR\*** **AP66979**  
**PPT NEW G2.9 INJECTOR\*** **AP66879**

**YEAR RANGE:** 2004-2005  
**APPLICATION:** HT570: 295 HP A 340 HP (HT)

**OEM PART NUMBERS:** 1842579C94, 5010659R92, 1842226C91, 6908-PP, 6925-PP

**PPT REMANUFACTURED G2.9 INJECTOR\*** **AP66989**  
**PPT NEW G2.9 INJECTOR\*** **AP66889**

**YEAR RANGE:** 2006  
**APPLICATION:** DT466: 210 HP A 285 HP

**OEM PART NUMBERS:** 1848489C91, 6909-PP, 6926-PP

**PPT REMANUFACTURED G2.9 INJECTOR\*** **AP66992**  
**PPT NEW G2.9 INJECTOR\*** **AP66892**

**YEAR RANGE:** 2006  
**APPLICATION:** DT570: 285 HP A 330 HP

**OEM PART NUMBERS:** 1848492C91, 6910-PP, 6927-PP



**DT466 / 570, HT570, MAXXFORCE DT / 9 / 10, N9 / N10**

**REFURBISHED G2.9 INJECTOR\***  
**REBUILT G2.9 INJECTOR\***

**CDM-0176**  
**CDM-0276**

**YEAR RANGE:**  
 2004

**APPLICATION:**  
 DT466: 210 HP A 225 HP

**OEM PART NUMBERS:** 1842576C93, 5010656R92, 1841491C91, 1842223C91, 6905-PP, 6922-PP

**REFURBISHED G2.9 INJECTOR\***  
**REBUILT G2.9 INJECTOR\***

**CDM-0177**  
**CDM-0277**

**YEAR RANGE:**  
 2004  
 2005

**APPLICATION:**  
 DT466: 245 HP A 285 HP (HT)  
 DT466: 210 HP A 285 HP

**OEM PART NUMBERS:** 842577C93, 5010657R92, 1842224C91, 6906-PP, 6923-PP

**REFURBISHED G2.9 INJECTOR\***  
**REBUILT G2.9 INJECTOR\***

**CDM-0178**  
**CDM-0278**

**YEAR RANGE:**  
 2004-2005

**APPLICATION:**  
 DT570: 285 HP A 330 HP

**OEM PART NUMBERS:** 1842578C94, 5010658R92, 1842225C91, 6907-PP, 6924-PP

**REFURBISHED G2.9 INJECTOR\***  
**REBUILT G2.9 INJECTOR\***

**CDM-0179**  
**CDM-0279**

**YEAR RANGE:**  
 2004-2005

**APPLICATION:**  
 HT570: 295 HP A 340 HP (HT)

**OEM PART NUMBERS:** 1842579C94, 5010659R92, 1842226C91, 6908-PP, 6925-PP

**REFURBISHED G2.9 INJECTOR\***  
**REBUILT G2.9 INJECTOR\***

**CDM-0189**  
**CDM-0289**

**YEAR RANGE:**  
 2006

**APPLICATION:**  
 DT466: 210 HP A 285 HP

**OEM PART NUMBERS:** 1848489C91, 6909-PP, 6926-PP

**REFURBISHED G2.9 INJECTOR\***  
**REBUILT G2.9 INJECTOR\***

**CDM-0192**  
**CDM-0292**

**YEAR RANGE:**  
 2006

**APPLICATION:**  
 DT570: 285 HP A 330 HP

**OEM PART NUMBERS:** 1848492C91, 6910-PP, 6927-PP



**ALL OUR DIESEL INJECTORS ARE REBUILT, REFURBISHED AND / OR REMANUFACTURED WITH NEW OE QUALITY COILS**  
 \*Indicates products with a core charge.





## DT466 / 570, HT570, MAXXFORCE DT / 9 / 10, N9 / N10

**PPT REMANUFACTURED G2.9 INJECTOR\*** AP66995  
**PPT NEW G2.9 INJECTOR\*** AP66895

**YEAR RANGE:** 2006  
**APPLICATION:** HT570: 295 HP TO 340 HP (HT)

**OEM PART NUMBERS:** 1848495C91

**PPT REMANUFACTURED G2.9 INJECTOR\*** AP66918  
**PPT NEW G2.9 INJECTOR\*** AP66818

**YEAR RANGE:** 2007-2010  
**APPLICATION:** MAXXFORCE DT: 210 HP TO 300 HP

**OEM PART NUMBERS:** 1848718C92, 5010561R91

**PPT REMANUFACTURED G2.9 INJECTOR\*** AP66921  
**PPT NEW G2.9 INJECTOR\*** AP66821

**YEAR RANGE:** 2007-2010  
**APPLICATION:** MAXXFORCE 9: 300 HP TO 330 HP  
 2007-2010 MAXXFORCE 10: 310 HP TO 350 HP

**OEM PART NUMBERS:** 1848721C92, 4307212R91

**PPT REMANUFACTURED G2.9 INJECTOR\*** AP66955  
**PPT NEW G2.9 INJECTOR\*** AP66855

**YEAR RANGE:** 2010-2014  
**APPLICATION:** MAXXFORCE DT: 215 HP TO 300 HP

**OEM PART NUMBERS:** 1890055C92, 1890056C2, 5010715R91, 6932-PP

**PPT REMANUFACTURED G2.9 INJECTOR\*** AP66957  
**PPT NEW G2.9 INJECTOR\*** AP66857

**YEAR RANGE:** 2010-2014  
**APPLICATION:** MAXXFORCE DT: 210 HP TO 225 HP

**OEM PART NUMBERS:** 1884057C92, 1884058C2, 5010986R91, 6931-PP

**PPT REMANUFACTURED G2.9 INJECTOR\*** AP66958  
**PPT NEW G2.9 INJECTOR\*** AP66858

**YEAR RANGE:** 2010-2014  
**APPLICATION:** MAXXFORCE 9: 300 HP TO 330 HP  
 2010-2014 MAXXFORCE 10: 310 HP TO 350 HP  
 2015-2017 N9  
 2015-2017 N10

**OEM PART NUMBERS:** 1890057C92, 1890058C2, 5010717R91, 6933-PP





**DT466 / 570, HT570, MAXXFORCE DT / 9 / 10, N9 / N10**

**REFURBISHED G2.9 INJECTOR\***  
**REBUILT G2.9 INJECTOR\***

**CDM-0195**  
**CDM-0295**

**YEAR RANGE:** 2006  
**APPLICATION:** HT570: 295 HP TO 340 HP (HT)

**OEM PART NUMBERS:** 1848495C91

**PPT REMANUFACTURED G2.9 INJECTOR\***  
**PPT NEW G2.9 INJECTOR\***

**CDM-0118**  
**CDM-0218**

**YEAR RANGE:** 2007-2010  
**APPLICATION:** MAXXFORCE DT: 210 HP TO 300 HP

**OEM PART NUMBERS:** 1848718C92, 5010561R91

**PPT REMANUFACTURED G2.9 INJECTOR\***  
**PPT NEW G2.9 INJECTOR\***

**CDM-0121**  
**CDM-0221**

**YEAR RANGE:** 2007-2010  
**APPLICATION:** MAXXFORCE 9: 300 HP TO 330 HP  
 2007-2010 MAXXFORCE 10: 310 HP TO 350 HP

**OEM PART NUMBERS:** 1848721C92, 4307212R91

**PPT REMANUFACTURED G2.9 INJECTOR\***  
**PPT NEW G2.9 INJECTOR\***

**CDM-0155**  
**CDM-0255**

**YEAR RANGE:** 2010-2014  
**APPLICATION:** MAXXFORCE DT: 215 HP TO 300 HP

**OEM PART NUMBERS:** 1890055C92, 1890056C2, 5010715R91, 6932-PP

**PPT REMANUFACTURED G2.9 INJECTOR\***  
**PPT NEW G2.9 INJECTOR\***

**CDM-0157**  
**CDM-0257**

**YEAR RANGE:** 2010-2014  
**APPLICATION:** MAXXFORCE DT: 210 HP TO 225 HP

**OEM PART NUMBERS:** 1884057C92, 1884058C2, 5010986R91, 6931-PP

**PPT REMANUFACTURED G2.9 INJECTOR\***  
**PPT NEW G2.9 INJECTOR\***

**CDM-0158**  
**CDM-0258**

**YEAR RANGE:** 2010-2014  
 2010-2014  
 2015-2017  
 2015-2017  
**APPLICATION:** MAXXFORCE 9: 300 HP TO 330 HP  
 MAXXFORCE 10: 310 HP TO 350 HP  
 N9  
 N10

**OEM PART NUMBERS:** 1890057C92, 1890058C2, 5010717R91, 6933-PP



**ALL OUR DIESEL INJECTORS ARE REBUILT, REFURBISHED AND / OR REMANUFACTURED WITH NEW OE QUALITY COILS**  
 \*Indicates products with a core charge.



# INDEX

## Symbols

6.0L and 4.5L POWER STROKE 70, 71  
7.3L POWER STROKE 68, 69

## A

AGCO 6, 82, 83, 84, 85  
ALLIANT POWER 6, 7, 8, 17  
A-SERIES 6  
AUDI 42, 52  
AVIATOR 20, 24, 33

## B

BA 6  
BD 6  
BENDIX 64  
BERLINGO 59  
BF 6  
BI 6  
BJ 6, 81  
BN 6  
BOSCH 10  
BP 6  
B-SERIES 6  
BUICK 35, 44, 45, 52

## C

C4.2 8  
C6.4 8, 9  
C6.6 8, 9  
C7 6  
C9 6, 7, 9  
C10 6, 7, 9  
C12 6, 7  
C15 6, 7, 8  
C16 6, 7  
C175 7  
CAMSHAFT 20, 21, 22, 23, 24, 25, 28, 29, 30, 31, 32  
CASCADIA 62  
CASE 45, 63  
CASE TRACTORS 53  
CAT 6, 7, 8, 9, 10  
CAT 725 61  
CAT 3126 6, 7  
CAT 3406E 6  
CAT 3408 61  
CAT 3412 61  
CAT C7 6  
CAT C9 7, 9  
CATERPILLAR 6, 7, 8, 9, 14, 61  
CATERPILLAR C9 7  
CATERPILLAR C175 7  
CENTURY 54  
CHEVROLET 62  
CHRYSLER 25  
CITROËN 59  
COMMON RAIL 7, 8, 9  
CONTINENTAL 24, 42  
CORONADO 62  
CRANKSHAFT 34, 35, 39, 40  
CR PUMP 8

CUMMINS 28, 43, 62

D

DAEWU 9

DELPHI 6, 7, 64

DETROIT DIESEL 6, 82, 83, 84, 85

DEUTSCH 64

DIRECT GEARBOX 41

DODGE 25, 52

DT466 6, 8, 78, 79, 80, 81, 86, 87, 88, 89

DT466E 78, 79, 80, 81

DT570 8, 86, 87

E

EATON 55

ECONOLINE 20, 28, 29, 30, 31, 32, 33, 39, 41, 42, 43

EGV1268 EXHAUST GAS RECIRCULATION 42

ENGINE INTAKE TEMPERATURE 43

E-Series 68, 69, 70, 71

E-SERIES 7, 17

EV 51

EXCURSION 7, 17, 20, 21, 31, 32, 33

EXHAUST GAS RECIRCULATION 42

EXPEDITION 20, 33

EXPLORER 20, 21, 22, 24, 28, 29, 30, 33, 35, 38, 41, 42

E-Z-GO 58

F

F-250 70, 71

FERRARI 45

FIAT 52

FORD 7, 17, 20, 21, 22, 23, 24, 25, 28, 29, 30, 31, 32, 33, 34, 35, 38, 39, 40, 41, 42, 43, 45

Ford Aerostar 30, 34, 42, 43

Ford E-150 20, 24, 28, 29, 30, 33, 39, 41, 42, 43

Ford E-150 Econoline 20, 28, 29, 30, 33, 39, 41, 42, 43

Ford E-250 20, 24, 28, 29, 30, 33, 39, 41, 42, 43

Ford E-250 Econoline 20, 28, 29, 30, 33, 39, 41, 42, 43

Ford E-350 20, 21, 22, 24, 28, 29, 30, 31, 32, 33, 41, 42, 43

Ford E-350 Econoline 20, 28, 29, 30, 31, 32, 33, 41, 42, 43

Ford E-450 20, 21, 24, 31, 32, 33

Ford E-550 20, 31, 32, 33

Ford Econoline 20, 28, 29, 31, 32, 33, 41, 42

Ford Econoline Super Duty 20, 28, 29, 31, 32, 33, 41, 42

Ford Excursion 20, 21, 31, 32, 33

Ford Expedition 20, 33

Ford Explorer 20, 21, 22, 24, 28, 29, 30, 33, 35, 38, 41, 42

Ford F53 20, 33, 42

Ford F-150 20, 21, 22, 24, 28, 29, 30, 33, 35, 38, 39, 41, 42, 43

Ford F-250 20, 21, 22, 24, 28, 29, 30, 31, 32, 33, 41, 42, 43

Ford F-350 20, 21, 22, 28, 29, 30, 31, 32, 33, 41, 42, 43

Ford F-450 20, 21, 24, 31, 32, 33

Ford F-550 20, 21, 24, 31, 32, 33

Ford F-650 21

Ford F650 21, 31, 32

Ford F-750 21

Ford F750 21, 31, 32

Ford Five Hundred 31, 38

Ford Flex 21, 35, 38

Ford Focus 28, 29, 34

Ford Freestar 22, 39

Ford Freestyle 38

Ford Fusion 24, 29, 35, 38

Ford Grand Marquis 20, 31, 33

Ford GT 24, 33

Ford LCF 21

Ford Lobo 31, 33  
Ford LTD 42, 43  
Ford Mondeo 28, 31, 38  
Ford Mustang 20, 22, 29, 30, 33, 35, 38, 39, 42  
Ford Police 21, 35, 38  
Ford Police Interceptor 21, 35, 38  
Ford Sable 22, 31, 40  
Ford S-MAX 28  
Ford Taurus 20, 21, 22, 29, 30, 31, 34, 35, 38, 40, 42  
Ford Tempo 20, 42  
Ford Thunderbird 20, 22, 30, 33, 39, 42  
Ford Transit 21, 25, 28, 35, 38  
Ford Windstar 22, 30, 39  
FREIGHTLINER 54, 62  
F-250 70, 71  
F-350 70, 71  
F-SERIES 7, 17, 68, 69

## G

G2.8 7, 17  
G2.8 INJECTOR 70, 71, 76, 77  
G2.9 INJECTOR 86, 87, 88, 89  
GEAR LEVER POSITION 51  
GMC 44, 53  
GOLF CART 58, 60  
GRAND CHEROKEE 23, 25  
GROUND SPEED 43  
GTSS SPEED 55

## H

HALDEX 64  
HEUI 6, 68, 69, 74, 75, 78, 79, 80, 81, 82, 83, 85  
HEUI INJECTOR 68, 74, 78, 80, 82  
HINO 9  
HONDA 39  
HT530 6, 78, 79, 80, 81  
HT570 8, 86, 87, 88, 89  
HUMMER 53  
HYUNDAI 25

## I

I530 6, 78, 79, 80, 81  
IGNITION SENSOR 43  
IHC 45  
INTAKE AIR TEMPERATURE 52  
INTERNATIONAL 44, 62  
ISUZU 9, 10

## J

JAGUAR 20, 29, 40  
JEEP 23, 25, 52  
JOHN DEERE 41, 53, 61, 62

## K

KENWORTH 55, 62, 64  
KOMATSU 6, 7, 9

## L

LAFORZA 28, 29, 41  
LAND ROVER 29  
LINCOLN 20, 21, 24, 29, 33, 35, 38, 40, 42

## M

MACK 64

MAGNETIC SPEED SENSOR 44  
MAGNUM 58  
MANGUSTA 33  
MARAUDER 24, 33  
MASS AIR FLOW 44  
MAXXFORCE 5 7, 17  
MAXXFORCE 9 8, 88, 89  
MAXXFORCE 10 88, 89  
MAXXFORCE DT 86, 87, 88, 89  
MAZDA 23, 33  
MERCURY 20, 22, 24, 28, 29, 30, 31, 33, 34, 35, 38, 39, 40, 41, 42  
MITSUBISHI 9  
MONTE CARLO 45, 52  
MUSTANG 20, 22, 29, 30, 33, 35, 38, 39, 42

## N

NAVISTAR 6, 7, 8, 14, 17, 74, 76, 78, 80, 82, 84, 86, 88  
NEUTRAL SAFETY SWITCH 44  
NEW HOLLAND 45, 53, 63

## O

OIL LEVEL 45  
OLDSMOBILE 35, 45, 53  
OSHKOSH 62

## P

PACCAR 55  
PANOZ 33  
PEDAL POSITION 48, 49, 50  
PEDAL POSITION SENSOR 49, 50  
PEDAL POTENTIOMETER 45  
PERKINS 6, 7, 8, 9, 15, 82, 83, 84, 85  
PETERBILT 55, 62, 64  
PEUGEOT 59  
PONTIAC 34, 35, 45, 53  
POWER STROKE 6, 7, 68, 69, 70, 71  
PROMASTER 25  
PROSTAR 62  
PURE POWER TECHNOLOGIES 6, 7, 8, 17

## R

RAM 25, 29  
RANGE ROVER 29  
rebuilt 69, 87, 89  
REFURBISHED 69, 71, 75, 77, 79, 81, 83, 85, 87, 89  
REMAN 7, 8, 17  
RENAULT 59  
ROTARY POSITION 51  
ROTATION POSITION 52  
ROUND BALER 51

## S

SAAB 53  
SATURN 53  
SAXO 59  
SENSOR 20, 21, 22, 23, 24, 25, 28, 29, 30, 31, 32, 33, 34, 35, 38, 39, 40, 41, 42, 43, 44, 45, 48, 49, 50, 51, 52, 53, 54, 55, 58, 59, 60, 61, 62, 63, 64  
SENSOR BODY 64  
SILVERADO 44, 52, 53  
SOLENOID 6, 7, 8, 9, 10, 11, 17  
SOLENOID CAT 3126 6, 7  
SOLENOID CAT 3126 (BLUE EDITION) 7  
SOLENOID CAT 3406E 6  
SOLENOID CAT 3408 / 3412 9  
SOLENOID CAT C4.2 8

SOLENOID CAT C4.2, C6.4, C6.6 COMMON RAIL HP PUMP 8  
SOLENOID CAT C7 / C9 6  
SOLENOID CAT C9 COMMON RAIL 7, 9, 17  
SOLENOID CAT C9 COMMON RAIL HP PUMP 9, 17  
SOLENOID CAT C13 8  
SOLENOID CAT C13 / C15 8  
SOLENOID CAT C320D 9  
SOLENOID CAT C320D COMMON RAIL 9  
SOLENOID CAT - ISUZU "TROOPER" 10  
SOLENOID DENSO 11  
SOLENOID DENSO 704 11  
SOLENOID G2.8 POWERSTROKE 7, 17  
SOLENOID G2.9 MAXXFORCE 8  
SPECTROL 51  
SPEED 58  
SS SPEED 54  
STEYR 63  
SUPER DUTY 20, 21, 22, 24, 28, 29, 31, 32, 33, 41, 42

## T

T444E 6, 7, 74, 75  
TACHOMETER 61  
TACHOMETER SENSOR 55  
THROTTLE POSITION 60, 61  
TOYOTA 63  
TRACTOR 8, 43, 55  
TRANSMISSION POSITION 51  
TRANSMISSION SPEED 62

## V

VOLKSWAGEN 42, 52  
VOLVO 6, 7, 9, 60, 62, 64  
VOLVO PENTA 60  
VT275 76, 77  
VT365 7, 17, 76, 77

## W

WESTERN STAR 62  
WHEEL ANGLE 63  
WHEEL SPEED 63  
WHEEL SPEED SENSORS 64  
WRANGLER 23, 25  
WS-24 64

## X

XSARA 59

## Y

YAMAHA 77  
YAMAHA DRIVE G29 60  
YANMAR 9

AGCO® is a registered trademark of AGCO Corporation.

Bosch® is a registered trademark of Robert Bosch GmbH, Germany.

Cummins®, ISB® & B-Series® are a registered trademarks of Cummins Engine Company, Inc.

Detroit Diesel® & Series 50/60® are a registered trademarks of Detroit Diesel Corporation.

Dodge® & Ram® are a registered trademarks of Chrysler Group, LLC.

DMAX® is a registered trademark of DMAX Ltd.

Ford®, Motorcraft® & Power Stroke® are a registered trademarks of Ford Motor Company.

Freightliner® is a registered trademark of Daimler AG.

F Series®, F-250®, F-350®, F-450®, F-550®, F-650®, F-750®, E Series®, Econoline® & Excursion® are a registered trademarks of Ford Motor Company.

GM®, GMC®, Chevrolet®, Chevy®, Duramax®, Express®, Savana®, Sierra® & Silverado® are a registered trademarks of General Motors, LLC.

HEUI® is a registered trademark of Caterpillar, Inc.

IH® is a registered trademark of CNH America, LLC.

International® & MaxxForce® are a registered trademarks of International Truck Intellectual Property Company, LLC.

Jeep®, Jeep Liberty® & Jeep Grand Cherokee® are a registered trademarks of Chrysler Group, LLC.

Mack® & Mack Trucks® are a registered trademarks of Volvo AB.

M-B®, OM® & Mercedes-Benz® are a registered trademarks of Daimler AG.

Navistar® is a registered trademark of Navistar International Corporation.

Perkins® & 1300 Series EDi® are a registered trademarks of Perkins Engines Company Limited, a subsidiary of Caterpillar, Inc.

Siemens® is a registered trademark of Siemens AG.

Sprinter® &/or Mercedes-Benz® Sprinter® are a registered trademarks of Daimler AG.

Stanadyne® is a registered trademark of Stanadyne Corporation.

Hitachi® is a registered trademark of Hitachi LTD.

Isuzu® is a registered trademark of Isuzu Motors.

Volvo® is a registered trademark of Volvo Trademark Holding AB.

All other names of these and other brands, models, part numbers and images of used products are for reference purposes only.

43114 BLACKDEER LOOP, SUITE F. TEMECULA, CALIFORNIA. +1 951 296 9460 [www.california-diesel.com](http://www.california-diesel.com)



DIESEL SHOP, DIESEL COILS SPECIALIST, DIESEL INJECTORS REMANUFACTURE & PARTS SUPPLIER

**951.296.9496**