



Model: SUNDAY Compact

# DIGITAL VIDEO INSPECTION BORESCOPE CAMERA INSTRUCTION MANUAL



THIS MANUAL CONTAINS IMPORTANT INFORMATION REGARDING SAFETY, OPERATION, MAINTENANCE AND STORAGE OF THIS PRODUCT. BEFORE USE, READ CAREFULLY AND UNDERSTAND ALL CAUTIONS, WARNINGS, INSTRUCTIONS AND PRODUCT LABELS. FAILURE TO DO SO COULD RESULT IN SERIOUS PERSONAL INJURY AND/OR PROPERTY DAMAGE.

IF YOU SHOULD HAVE ANY QUESTIONS OR EXPERIENCE A PROBLEM WITH YOUR SUNDAY PRODUCT, PLEASE EMAIL OUR CUSTOMER SERVICE DEPARTMENT AT [SUPPROT@OFFICIALSUNDAY.COM](mailto:SUPPROT@OFFICIALSUNDAY.COM) FIRST. YOU COULD ALSO MAKE A SUGGESTION OR COMMENT TO THE SAME EMAIL ADDRESS, YOUR FEEDBACK IS VITAL TO US.

## TABLE OF CONTENTS

INTENDED USE .....	1
GENERAL SAFETY RULES .....	1
RECOGNIZE SAFETY SYMBOLS, WORDS AND LABELS .....	1
TOOL USE AND CARE .....	2
FUNCTIONAL DESCRIPTION .....	2
LCD INDICATIONS AND SYMBOLS .....	3
BATTERY INSTALLATION/REPLACEMENT .....	3
OPERATING INSTRUCTIONS .....	4
CAMERA PROBE SETUP / STORAGE .....	4
LIVE MODE (CAMERA / RECORDING) .....	4
PLAYBACK MODE .....	4
ACCESSORIES .....	5
EXPANSION INTERFACE PORT .....	5
CLEANING AND STORAGE .....	5
SPECIFICATIONS .....	6
FCC INFORMATION .....	6
1 YEAR LIMITED WARRANTY .....	7

## INTENDED USE

This product is intended for consumer use only.

## GENERAL SAFETY RULES

**⚠ WARNING** READ AND UNDERSTAND ALL INSTRUCTIONS. Failure to follow all instructions in this manual may result in severe personal injury or death. Keep this manual and refer to it for Safety Instructions, Operating Procedures and Warranty.

## SAVE THESE INSTRUCTIONS FOR FUTURE REFERENCE.

### RECOGNIZE SAFETY SYMBOLS, WORDS AND LABELS

#### **⚠ WARNING**

**WARNING** indicates a potentially hazardous situation which, if not avoided, could result in death or serious injury.

#### **⚠ CAUTION**

**CAUTION** not avoided, may result in minor or moderate injury.

**⚠ CAUTION**

Before first use please familiarize yourself with the proper usage of the device. Keep these operating instructions for future reference. These operating instructions contain important details for handling the device.

Please read the safety instructions carefully!

These instructions will make it easier for you to handle the device appropriately and help prevent mishaps and possible damage to the device.

Please note the following safety advice to avoid malfunctions, damage or physical injury:

Prevent object and liquid entry. Never spill liquid of any kind on the video display and the main body of the unit.

The unit is not shock-resistant. Do not use it as a hammer or drop it.

Do not immerse the camera and monitor in water. Store it in a dry place. Such measures reduce the risk of electric shock and damage. The image head and the cable are water resistant when the unit is fully assembled, but the monitor and camera are not.

Do not use the camera if condensation forms inside the lens. Let the water evaporate before using again.

**FUNCTIONAL DESCRIPTION**

**BASIC FUNCTIONS**



## ON THE SCREEN DISPLAY

LCD Brightness

Rotate View



LED Brightness

Rotate View



Date

Time

SD Card

Modes

Zoom

Battery

## BATTERY INSTALLATION/REPLACEMENT

Please install the batteries before using the product.

1. Remove battery cover and insert 4 new AA (1.5V) batteries.
2. Place Batteries into the proper slots in the battery compartment in proper battery orientation as indicated on the battery cover.
3. Reinstall battery cover.
4. Clean the battery contacts and also those of the device prior to battery installation.
5. Remove batteries from equipment which is not to be used for an extended period of time.
6. Remove batteries if dead or if product is to be left unused for a long time.

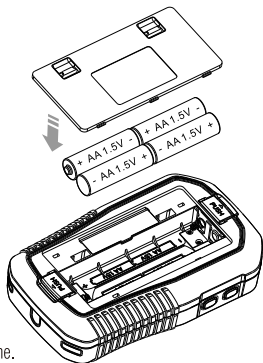

### **CAUTION**

The Borescope should not be exposed to dripping or splashing and that no objects filled with liquids, such as vases, shall be placed on the apparatus.

Turn off the unit if not in use.

Attention should be drawn to the environment aspects of the battery disposal.

Remove the batteries when cleaning the unit.

Remove the batteries before storing the unit for a long time.

When necessary, REPLACE ALL FOUR BATTERIES in the unit with new ones.

Use only the size and type of battery specified.

Be sure to install the battery with the correct polarity as indicated in the battery compartment.

Properly dispose of the battery. Exposure to high temperatures can cause the batteries to explode. Do not dispose in a fire. Tape over the terminals to prevent direct disposal. Please follow all applicable regulations

## CAMERA PROBE SETUP / STORAGE

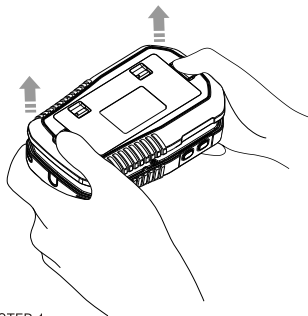

STEP 1.  
Push both buttons to open the camera probe storage compartment.

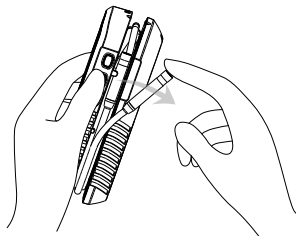

STEP 2.  
Take out the camera probe, unwrap it to its full length and close the compartment.

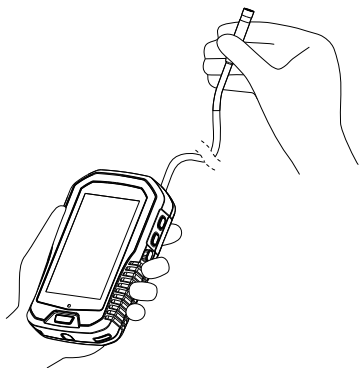

STEP 3.  
Turn on the power and ready to inspect!

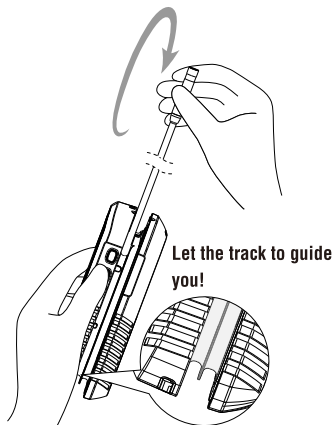

\*\*\*FOR STORAGE AFTER USE\*\*\*

1. Open the probe storage compartment, follow the track and wrap the probe tidy and neat.
2. Close the compartment.

The product is designed as a remote inspection device. It can be used to look into tight spots and show real-time video. Typical applications might include HVAC, termite and other insect or building inspections, cable routing, automotive/boat/aircraft inspections etc.

## LIVE MODE (CAMERA/RECORDING)

1. Pull backwards on back cover, exposing optical camera cable.

Unwind optical camera cable from apparatus.

2. Long press power button to turn on/off Borescope.
3. To enlarge image long press zoom button repeatedly.
4. Press LED Brightness button to adjust LED light.
5. Press LCD Brightness button to adjust LCD light.
6. To take photo depress snapshot button.
7. Long press Monochrome button to change mode.
8. Long press Compare Mode button to change mode.
9. Press Rotate button to rotate image.

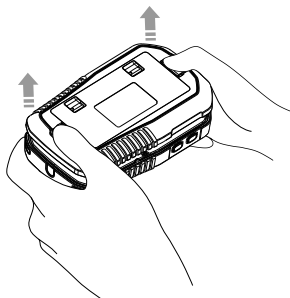
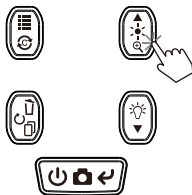

	<b>Power</b> long press 2 seconds
	<b>Snapshot / Recording</b>
	<b>LED Light</b>
	<b>Back Light</b>
	<b>Zoom</b> 1.5x, 2.0x Zoom
	<b>Monochrome</b> long press 2 seconds
	<b>Compare Mode</b> long press 2 seconds
	<b>Rotate</b>

## PLAYBACK MODE

1. Press menu button to enter playback model
2. Select PICTURE or VIDEO folder to view
3. Scroll through pictures/videos using the previous or next arrow buttons, respectively
3. To delete picture press menu button followed by the trash can button (Caution: images cannot be undeleted)
4. To delete all pictures select the "ALL" option
5. To delete a single picture select "CURRENT" option



	<b>Enter</b>
	<b>Menu</b>
	<b>Previous</b>
	<b>Next</b>
	<b>Delete</b>

## ACCESSORIES

### To attach accessory:

1. Position the attachment accessory over the camera head.
2. GENTLY screw the attachment accessory clock-wise to lock the accessory on the camera head.

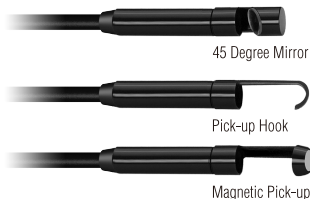

### To detach accessory:

- GENTLY screw the attachment accessory counter clock-wise to remove the attachment accessory and store them for future use.

## EXPANSION INTERFACE PORTS

### Micro USB output for data transfer

This product is equipped with Micro USB port (at its top side) so that you can display or save images/videos to a computer.

1. Turn the product off
2. Lift up the cover of the USB port and connect the Micro-USB cable to the USB port.
3. Connect the other side of the USB cable to your computer, the product turns on automatically when the computer is on.

### HDMI output for display

This product is equipped with Mini HDMI port so that you can display live view on bigger display screen.

1. Connect the Mini HDMI to the product and connect the other side of HDMI cable to your display screen.

### Support external Class 10 Mini SD card

This product equipped with Mini SD card slot to support external memory, support Class 10 SD card up to 32G.

## CLEANING AND STORAGE

Clean the videoscope housing and the display using only a soft cloth or cotton swab with water or medical alcohol. Do not let any liquid enter the case or sensor area. Allow the lens to fully dry before using the videoscope. Avoid storing the unit in extreme temperature conditions. Do not store below  $-20^{\circ}\text{C}$  ( $-4^{\circ}\text{F}$ ), or where the radiant temperature may exceed  $60^{\circ}\text{C}$  ( $140^{\circ}\text{F}$ ).

## SPECIFICATIONS

4.3 in. TFT Resolution	480 (W) x 272 (H) Pixels
Lens Sensor Resolution	1920 x 1080 Pixels
White Comparison	Automatic
Exposure to Light	Automatic
Powered By	4x 1.5 v AA Batteries
Ambient / Operation Temperature	0° to 45°C / 32° to 113°F
Total Length of Device	117 cm ± 2 cm / 46.06 in. ± 0.78 in.
Flexible Metal Tube Length	102 cm ± 2 cm / 40.15 in. ± 0.78 in.
Minimum Bending Radius	3.5 cm / 1.38 in.
Diameter of Camera Head	8 mm ± 0.5 mm / 0.31 in. ± 0.019 in.
Filed of View	54°
Depth of View	3~8 cm / 1.18~3.15 in.
Weight Without Accessories	Approx. 335 g / 11.8 oz.
Zoom	2X Max

## FCC INFORMATION

**Warning: Changes or modifications to this unit not expressly approved by the party responsible for compliance could void the user's authority to operate the equipment.**

**NOTE:** This equipment has been tested and found to comply with the limits for Class B digital device, pursuant to part 15 of the FCC Rules. These limits are designed to provide reasonable protection against harmful interference in a residential installation. This equipment generates, uses and can radiate radio frequency energy and, if not installed and used in accordance with the instructions, may cause harmful interference to radio or television reception, which can be determined by turning the equipment off and on, the user is encouraged to try to correct the interference by one or more of the following measures:

- Reorient or relocate the receiving antenna.
- Increase the separation between the equipment and the receiver.
- Connect the equipment into an outlet on a circuit different from that to which the receiver is connected.
- Consult the dealer or an experienced radio/TV technician for help.



**Express and Exclusive Limited Warranty to Original Buyer**

Every SUNDAY product is inspected before leaving the factory. This product is warranted to be free of defects in material and workmanship for a period of 12 months from the date of original purchase. If a defect appears within 12 months after the date of purchase, the purchaser may return the item, together with a purchase receipt or other appropriate proof of purchase to the place of purchase. Upon receipt of the item(s), the place of purchase will, at its option, replace the defective item or refund your money. This warranty shall not apply when the product has been used for commercial or rental purposes, has been tampered with, when repairs or attempted repairs have been made by unauthorized persons, or where the item has been subjected to misuse, abuse, accident or damage in transit. No charges will be accepted for unauthorized parts, repairs or services.

1. SUNDAY will, at its sole option, either repair or replace free of charge any new product (including parts) that develops a fault within a period of 12 months starting from the date of shipping with a similar and contemporary product. Wear parts (such as batteries) are covered for a period of 6 months starting from the date of shipping. When returning a faulty item, please enclose a precise description of the defect. Also make sure to enclose items tracking S/N series number and belong purchase recipe when making a claim.
2. This warranty does not cover damages to the product resulting from inappropriate use, improper fitting, unauthorized disassembly, repair or modification, or failure to follow the manufacturer's instructions. In this case, SUNDAY will charge related cost to customer when finished repair or replacement.
3. This warranty does not cover any loss of data, or any kind of damages resulting from loss of data.
4. If replacing or repairing an item is not an option (for economical or other reasons) we will reimburse the purchase price of the item. The decision whether to repair or replace an item, or to reimburse the customer is entirely left to SUNDAY's discretion. Refunding the purchase price of an item also constitutes that Teamforce has met its contractual obligations in full.
5. Replacement or repair of a product under the present warranty does not extend or restart the warranty period. If SUNDAY replaces or refunds goods under the present warranty, a) any replacement item/refund will remain the property of SUNDAY until the customer receives the replacement item/refund, b) the faulty item will remain the property of the customer until SUNDAY receives the returned faulty item.





 **SUNDAY**<sup>®</sup>

FOR CUSTOMER SERVICE

[www.OFFICIALSUNDAY.com](http://www.OFFICIALSUNDAY.com)

MADE IN CHINA