

The logo for INEARZ AUDIO features a stylized blue 'G' with a red horizontal bar at the top. Below it, the word 'INEARZ' is written in a large, blue, 3D-style font with a white outline and a slight glow. Underneath 'INEARZ', the word 'AUDIO' is written in a smaller, red, outlined font. The entire logo is set against a dark blue background with a grid of small, light blue dots.

INEARZ™
AUDIO

USER GUIDE AND WARRANTY



Artwork provided by:
Machine Gun Kelly

WE CUSTOMIZE PERFECTION™

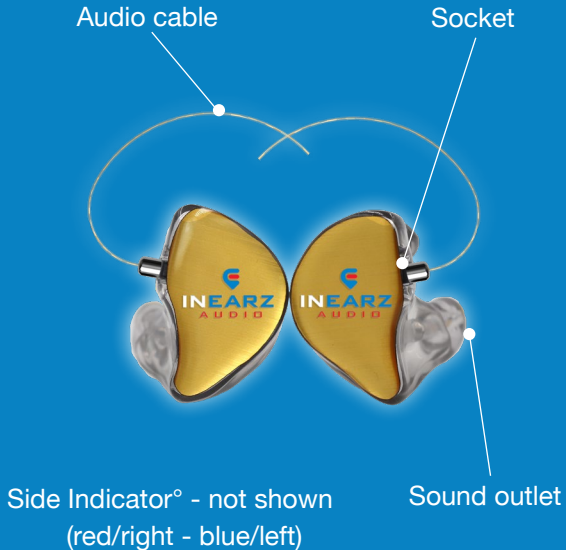

Most Inearz Audio custom products have replaceable cables. All cables are not interchangeable. Use of alternative cables may cause damage and void your warranty. Use only original Inearz Audio cables.

Custom In Ear Monitors are manufactured using your personal impressions that are laser scanned and digitally stored as a 3D image at our laboratory for a minimum of five years.

°Red lettering or red color dot identifies the right side; blue color coding identifies the left side. The color dot may also be on the tip of the audio cable or cord. The lettering is typically on the back side of the monitor - the curvy custom shaped side.

WWW.INEARZ.COM

Inserting - Before wearing your Inearz, make sure ear canals are clean and free of earwax.

1. Place the canal tip just inside your ear canal. Rotate the Inearz from the top position into the backside bowl of your ear (Concha). Gently push the instrument into your ear until it sits comfortably.
2. Place the cable over top of your ear.
3. Make sure the top of the Inearz seats underneath the top flap of the ear (red arrow). You may need to pull your ear up with your other hand as you push the unit into your ear.
4. Remove by pushing in back of your ear and unseating the top flap of the ear (red arrow). Rotate forward. Do not pull on the cable or cord!

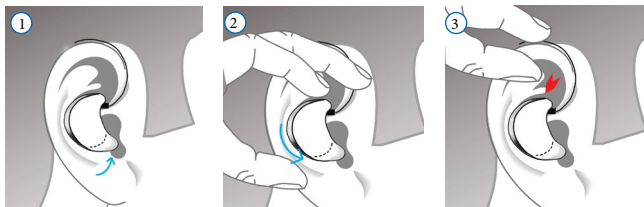

Volume - To avoid excessive initial volume when turning on, lower the volume on your music/sound source! Use of Inearz must be carefully managed (see **WARNINGS** section).

Off - To turn your Inearz off, simply unplug from the source.

Cleaning - Wipe your device with a soft cloth after each use. Do not use alcohol or any chemicals for cleaning. Specially formulated wipes are available through our website.

Use the cleaning tool to remove earwax from the tip of the sound outlet. Check and replace wax guards (optional) if product sounds weak or if you see earwax inside the tip. Tips and wax guards are considered consumable items and are excluded from the warranty. To allow earwax/debris to fall out, hold upside down when brushing the tip of the canal.



Cleaning Tools

Cleaning (continued)

If you notice regular earwax on your Inearz, try our EarCleanse spray! Regular use of earplugs or in ear monitors may reduce or impede the natural migration of earwax from of your ear canal. Just a few sprays each week, and EarCleanse helps dissolve earwax and facilitates the earwax to exit your ear canal by reducing the binding effect of earwax to your ear canal. Some ear canals have dramatic bends and turns or are very narrow which may also restrict earwax migration.

EarCleanse is safety formulated to help dissolve earwax especially when used 15 minutes before showering. Yes, earwax is natural, but it also must be allowed to migrate out of your ear canal, or you risk earwax impaction and/or ear infections. We find this method to be the most practical and preventative to keep both your ears and your Inearz in good working order.

Visit:

www.EarCleanse.com

for more information and other ear care accessories.



Moisture Guard:
UV sterilization
and gentle heat
provides evaporation

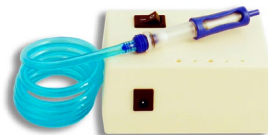

Jodi-Vac Pro
Vacuum Cleaning System

In-Ear Monitor Limited Warranty

Persona Medical warrants the product for one year on parts and labor. We warrant your Inearz product (external shell and internal components) shall be free from defects in material and workmanship for one (1) year from the date of purchase or shipping date (whichever is more recent) validated with a copy of the sales receipt or dated itemized receipt. Service can be obtained by bringing the instrument to the nearest Inearz dealer, or by mailing it directly to us securely packaged, shipping prepaid and insured.

This warranty is void when damage incurred is beyond Inearz Audio's reasonable control (i.e., exposure to water or heat, stepped on or crushed, dog bites, negligence, physical abuse, accidental damage, etc.). Repeat earwax related repairs are not due to manufacturing defect and are considered out of warranty due to poor maintenance / customer neglect.

This warranty does not cover damage resulting from (1) accident, abuse, misapplication, or any unauthorized repair, modification or disassembly; (2) improper operation or maintenance, usage not in accordance with product instructions or damage resulting from connection to an improper voltage supply; or (3) use of consumable items, such as tips, wax guards and cables or audio cords. All service and/or replacement is at our discretion.

Custom Earmold/Shell Fit Warranty: The external shell will have a one year warranty from the original date of purchase. This warranty period can not be extended. Factors such as weight loss, etc. can affect the fit. In order for us to make good decisions, it is best to send the original impressions back for comparison. In rare instances, a new impression may be required and are the sole responsibility of the purchaser. All service or replacement is at our discretion.

In-Ear Monitor Limited Warranty (cont'd)

The cable is a wear component and is covered for one (1) year under our limited warranty. Products are durable, not represented as indestructible. CUSTOM FIT NON-ELECTRONIC PRODUCTS: To fit, be free from defects in manufacturers materials and workmanship for one (1) year from date of delivery. ADAPTER PRODUCTS: To be free from manufacturers defect for a period of one (1) year from date of delivery. EAR PLUGS: To fit and be free from manufacturing defects for a period of one (1) year from date of delivery. Any replacement product will be warranted for the remainder of the original warranty period or thirty (30) days, whichever is longer.

Warranty is not assignable or transferable and is given in lieu of all other express warranties. It may not be extended or modified. Any action against Persona Medical (DBA Inearz Audio) for breach of warranty must be commenced within three months of the expiration of the warranty.

NATIONAL STATUTORY RIGHTS: Consumers have legal rights under applicable national legislation governing the sale of consumer goods. Such rights are not affected by the warranties in this Limited Warranty.

Please note that in the European Union, any warranty period less than two years shall be increased to two years.

NO OTHER WARRANTIES: No Inearz Audio dealer, agent, or employee is authorized to make any modification, extension, or addition to this warranty.

UNAUTHORIZED SERVICE: WARRANTY IS VOID IF SERVICE IS PERFORMED BY ANYONE OTHER THAN INEARZ AUDIO.

LIMITATION OF LIABILITY

Persona Medical shall not be liable for any special, indirect, incidental or consequential damages whatsoever, including but not limited to loss of profits, revenue or data (whether direct or indirect) or commercial loss for breach of any express or implied warranty on your product even if persona medical has been advised of the possibility of such damages.

Persona Medical's entire liability and your exclusive remedy for any breach of warranty shall be, at Persona Medical's option, (1) to repair or replace the Custom Product, or (2) to refund the price paid, provided that the Custom Product is returned to the point of purchase, or such other place as Persona Medical may direct.

DURATION OF IMPLIED WARRANTIES:

Except to the extent prohibited by applicable law, any implied warranty or condition of merchantability or fitness for a particular purpose of this custom product is limited in duration to the duration of the applicable limited warranty period for your custom product.

ADDITIONAL RIGHTS:

Some states do not allow limitations on how long an implied warranty lasts, or allow the exclusion or limitation of incidental or consequential damages, so the above limitations or exclusion may not apply to you. This warranty gives you specific legal rights, and you may also have other rights that vary from State to State or by country or other jurisdiction.

TERMS AND CONDITIONS:

Purchaser agrees to hold harmless Persona Medical, (Earasers, Inearz Audio, Inearz Sport) and any of its employees, affiliates, associates, technicians, volunteers, promoters and vendors for any possible damages that could occur from making or use of any Persona Medical products. Purchaser agrees the product is purchased with "NO SIGNATURE REQUIRED" and assume all responsibility and accept these terms and conditions prior to use. Any modification to the product will void the warranty. Purchaser agrees product is only for their own, personal use, and not for any third party. Custom made products are non-cancelable and not eligible for refund or a charge back on credit card. All product repairs must be insured for shipping loss. Any unauthorized repairs or items lost in transit, missing parts, with or without confirmed delivery, to or from Persona Medical, is the buyers responsibility. Unless notifying us by email or in writing, electronic orders will automatically be "opted in" to our email distribution list. If purchaser disagrees with any part of this TERMS AND CONDITIONS, they must make Persona Medical aware prior to the start of any work to be done and use of the product. Purchaser agrees to only communicate with Persona Medical via telephone, email, or in writing to the address on the USER GUIDE AND WARRANTY.

WARNINGS

Consult a physician or audiologist if you notice problems with earwax build-up, discomfort, hearing loss, ringing, or stuffy feeling after use. Exposure of more than 85dB SPL for an eight hour period can be dangerous. Allow 16 hours between use to rest your ears.

Do not submerge or expose Inearz to liquid. Do not place in the oven or in the presence of any heated appliance or high temperature. Use a sturdy case and store in a safe and dry place away from direct sunlight or heat.

Choking hazard! Keep away from children or pets.

Risk of hearing loss and/or hearing damage occurs while wearing any sound protecting or sound generating product. This risk increases if the product is used at loud volumes or in a way not described in this manual.

Legal Safety Notice - Some states have laws that prohibit use of in-ear products while using any motor vehicle or in any situation requiring safety awareness. Purchaser accepts full responsibility to abide to these laws and if not, the liabilities and repercussions thereof. Use of Inearz products may effect safety awareness while operating any machinery. Purchaser accepts all risk of product use and will indemnify Persona Medical of all liability when using Inearz product.

A belief that in order to succeed, you must have a certain passion and desire to give your every endeavor your very best.

For over 55 years, Persona Medical forges this commitment to excellence into every audio instrument we design.

Currently, our products are distributed all over the world. We thank you for including us in your choice of the finest audio components available today.



Tel. (407) 339-2422
170 N. Cypress Way
Casselberry, FL 32707
info@inearz.com