

# ASSEMBLY INSTRUCTIONS

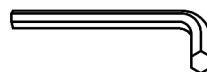

## TOOLS REQUIRED



Allen Wrench

(Included)

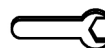

Wrench

(Included)



2 - People  
Recommended

## ASSEMBLY RATING



EASY —————> DIFFICULT

The Assembly Rating is a 5-point system showing the level of effort needed to assemble a specific product.



## CHECK BEFORE STARTING

### Are you missing anything?

Double-check all parts, hardware and accessories listed on Page 6 are accounted for.

### Check out our Quick Tips!

We recommend reviewing the pre-assembly handouts. Even experts need a refresher now and then!

### Should we send any replacements?

Are there any irregularities or flaws in the parts? We can send replacements!

### Prep Time!

Please review the assembly instructions and all diagrams prior to assembling. Arrange parts as recommended on Page 7 and group identical hardware together to make assembling easier.

# PRE ASSEMBLY INTRODUCTION

We understand building ready-to-assemble furniture can be a challenging experience for some. To help avoid confusion, we have provided some helpful tips that may speed up the process.

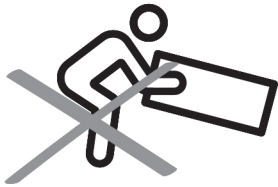

## Teamwork

ALWAYS have at least two people to help with transporting and assembling the product to avoid potential injury and/or damage.

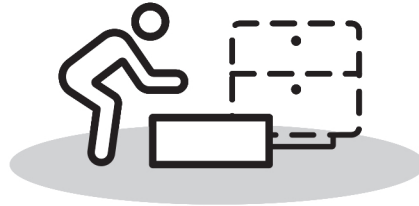
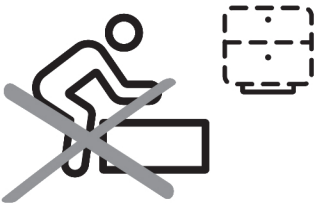

## Suitable Location

Assembling near the area of the intended location is highly recommended.



## Sufficient Space

Make sure you have enough space to move around during the assembly.



## Avoid Scratches

Use cardboard, blankets or a carpeted area while assembling furniture to prevent scratches.

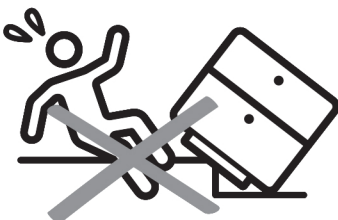

## Flat Surface

Make sure the furniture rests on a flat and level surface with each leg evenly touching the floor.

# ASSEMBLY AND CARE ADVICE



**FAILURE TO FOLLOW THE GUIDELINES BELOW MAY RESULT IN INJURY AND/OR PROPERTY DAMAGE.**



Position each part correctly and insert screws or bolts into their respective holes.

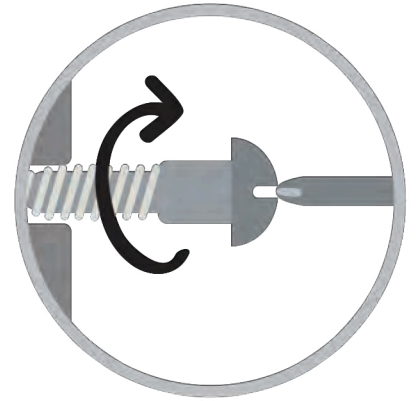

Turn clockwise to tighten and only tighten when step is completed or when instructed to do so.



Use the appropriate hand tools or power tools for assembly. Select steps, such as tightening screws and/or bolts, may require hand tools to avoid causing damage during assembly.



Save the instructions and store any supplied tools for later maintenance.



After two weeks, check and tighten any loose hardware and repeat again every six months thereafter.

**IT IS THE USER'S RESPONSIBILITY TO MAINTAIN THE FURNITURE. THE HARDWARE MAY LOOSEN OVER TIME AND MAY CAUSE THE FURNITURE TO BE WOBBLY AND UNABLE TO SUPPORT ITS INTENDED WEIGHT CAPACITY. THIS MAY LEAD TO COLLAPSE AND MAY CAUSE SERIOUS INJURY.**

# ROCKING CHAIR



- Please keep instructions for future reference.
- Check the quantity and irregularity of parts and hardware before you start.



## PARTS

#1 2pcs



Backrest

#2 2pcs



Seat

#3 2pcs



Right Armrest

#4 2pcs



Left Armrest

#5 4pcs



Leg

#6 2pcs



Crossbar A

#7 1pc



Table Top

#8 1pc



Crossbar B

#9 8pcs



Suspender

# ROCKING CHAIR



- Please keep instructions for future reference.
- Check the quantity and irregularity of parts and hardware before you start.



## HARDWARE

#A 8pcs



Bolt 5/16" x 3-1/8"

#B 8pcs



Bolt 1/4" x 2-3/4"

#C 8pcs



Bolt 1/4" x 2"

#D 4pcs



Bolt 1/4" x 1-7/8"

#E 4pcs



Bolt 1/4" x 1-5/8"

#F 12pcs



Bolt 1/4" x 1/2"

#G 8pcs



Hex Nut M8

#H 8pcs



Flat Washer M8

#I 24pcs



Hex Nut M6

#J 40pcs



Flat Washer M6

#K 1pc

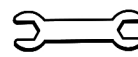

Wrench

#L 1pc



Allen Wrench

# Exploded View

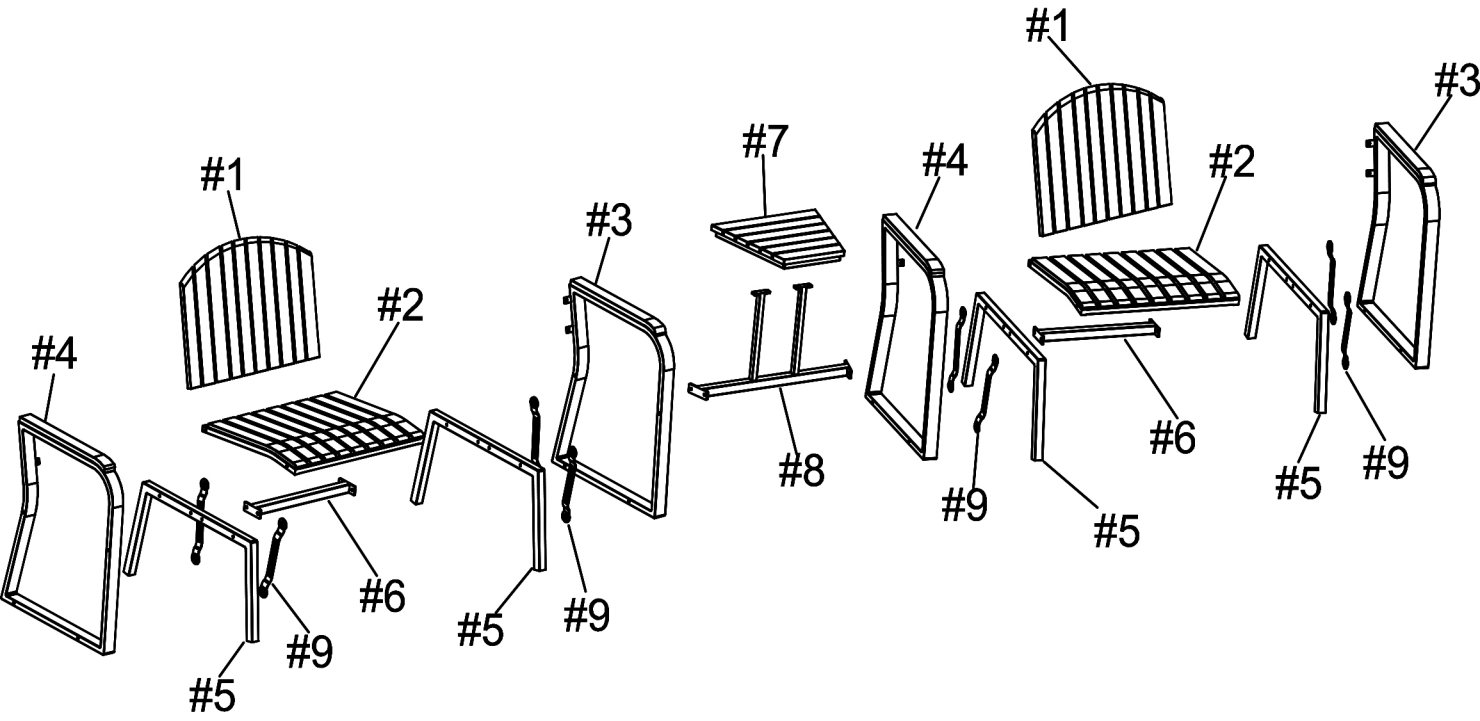

# ASSEMBLY INSTRUCTIONS

Part #5 x2pcs

Part #6 x2pcs

Hardware #E x4pcs

Hardware #I x4pcs

Hardware #J x8pcs

1

1. Align one end of the crossbar A (#6) to the holes along the leg (#5).

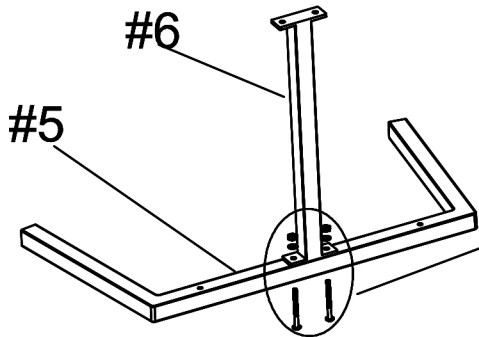

X2

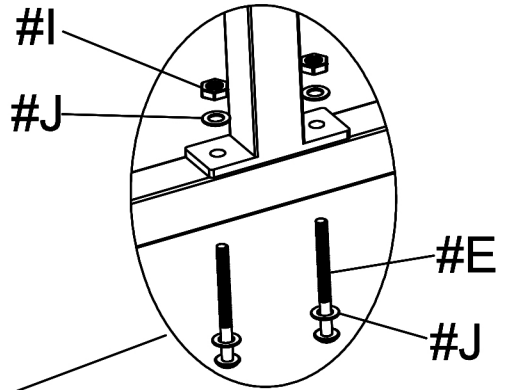

2. Insert a bolt (#E) with flat washer (#J) into the leg from beneath, then apply a flat washer (#J) and hex nut (#I) onto the other ends of the bolts. Secure using the Allen wrench (#L).

2

Part #9 x2pcs

Hardware #C x4pcs

Hardware #I x4pcs

Hardware #J x4pcs

1. Align one end of the suspenders (#9) to the holes along the legs (#5) that are connected to the crossbars (#6).

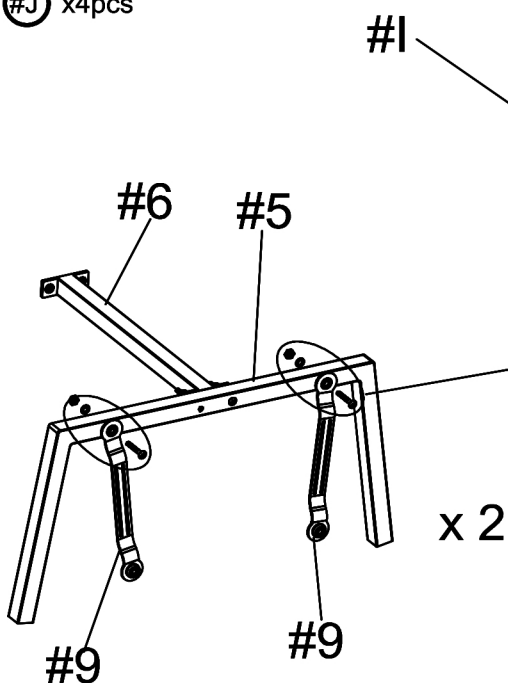

x 2

2. Insert a bolt (#C) into the hole along the suspender, once inserted apply a flat washer (#J) and a hex nut (#I) onto the end of the bolt (#C). Secure using the Allen wrench (#L).



# ASSEMBLY INSTRUCTIONS

- 3 Part #5 x2pcs  
Part #9 x2pcs  
Hardware #C x4pcs  
Hardware #I x4pcs  
Hardware #J x4pcs

1. Align one end of the suspenders (#9) to the holes along the legs (#5).

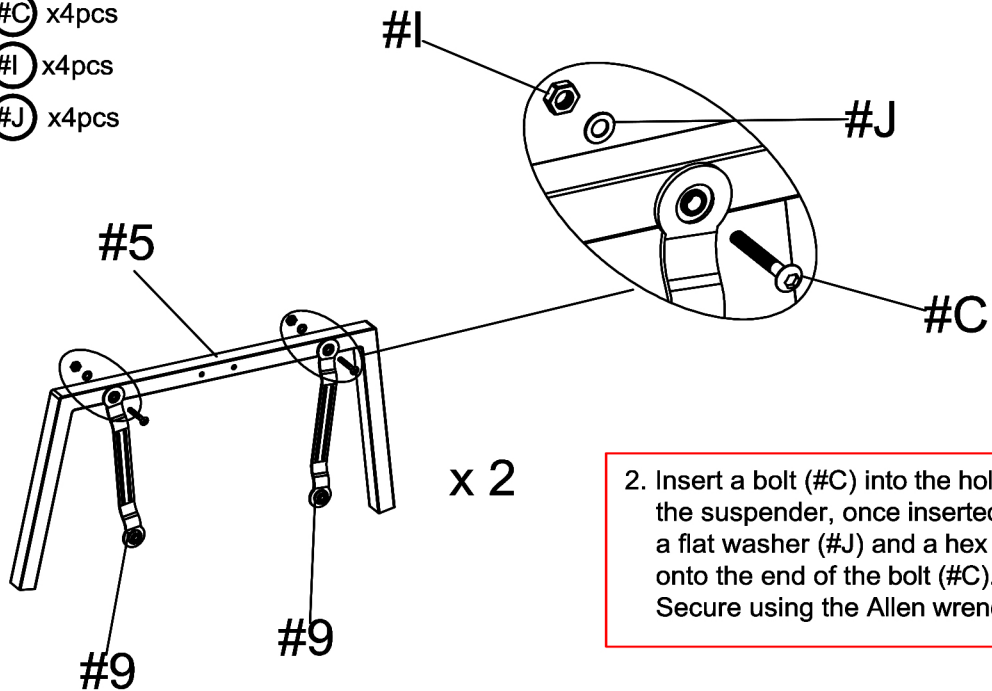

2. Insert a bolt (#C) into the hole along the suspender, once inserted apply a flat washer (#J) and a hex nut (#I) onto the end of the bolt (#C). Secure using the Allen wrench (#L).

- 4 Part #2 x2pcs  
Part #3 x2pcs  
Part #4 x2pcs  
Hardware #A x8pcs  
Hardware #G x8pcs  
Hardware #H x8pcs

1. Align the left and right armrests (#3,4) to the holes along each end of the seat (#2).

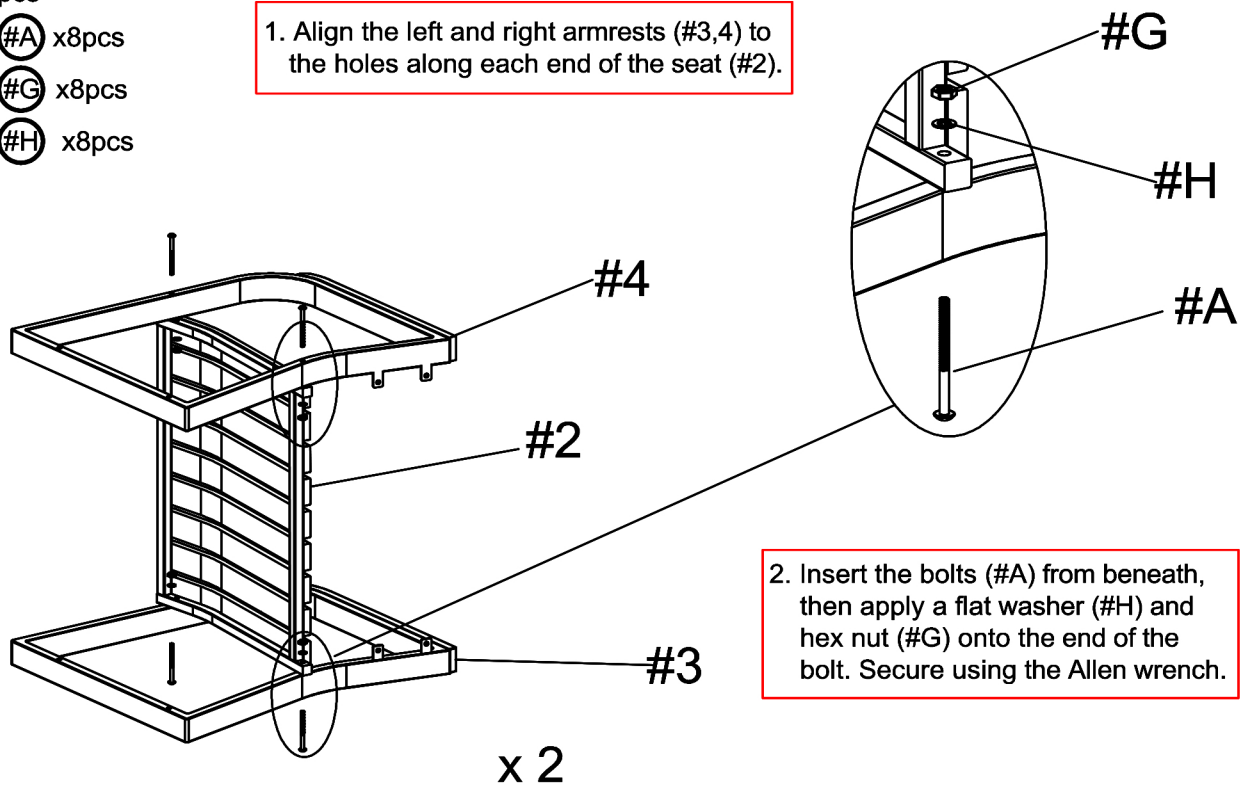

2. Insert the bolts (#A) from beneath, then apply a flat washer (#H) and hex nut (#G) onto the end of the bolt. Secure using the Allen wrench.

# ASSEMBLY INSTRUCTIONS

5

Part #1 x2pcs

Hardware #F x8pcs

Align the backrest (#1) to the holes along the back of the armrests (#3,4), then insert a bolt (#F) into each hole and secure using the Allen wrench (#L).

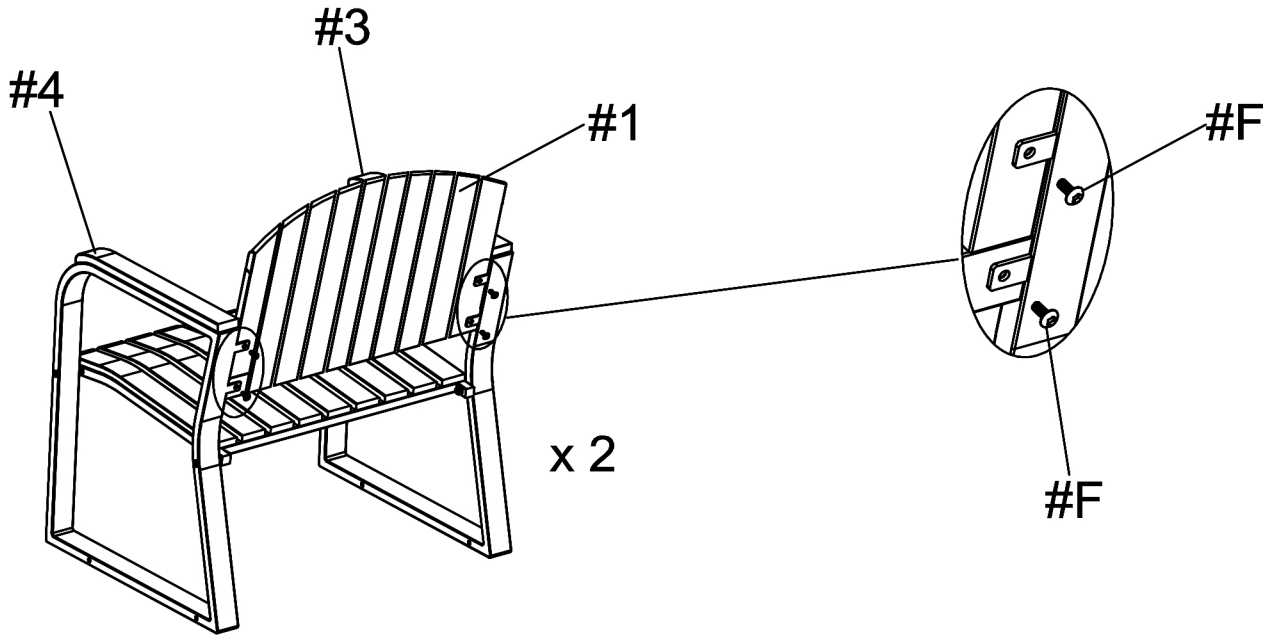

6

Part #7 x1pc

Part #8 x1pc

Hardware #F x 4pcs

Align the crossbar B (#8) to the holes along the table top (#7), then insert the bolts (#F) into each hole and secure.

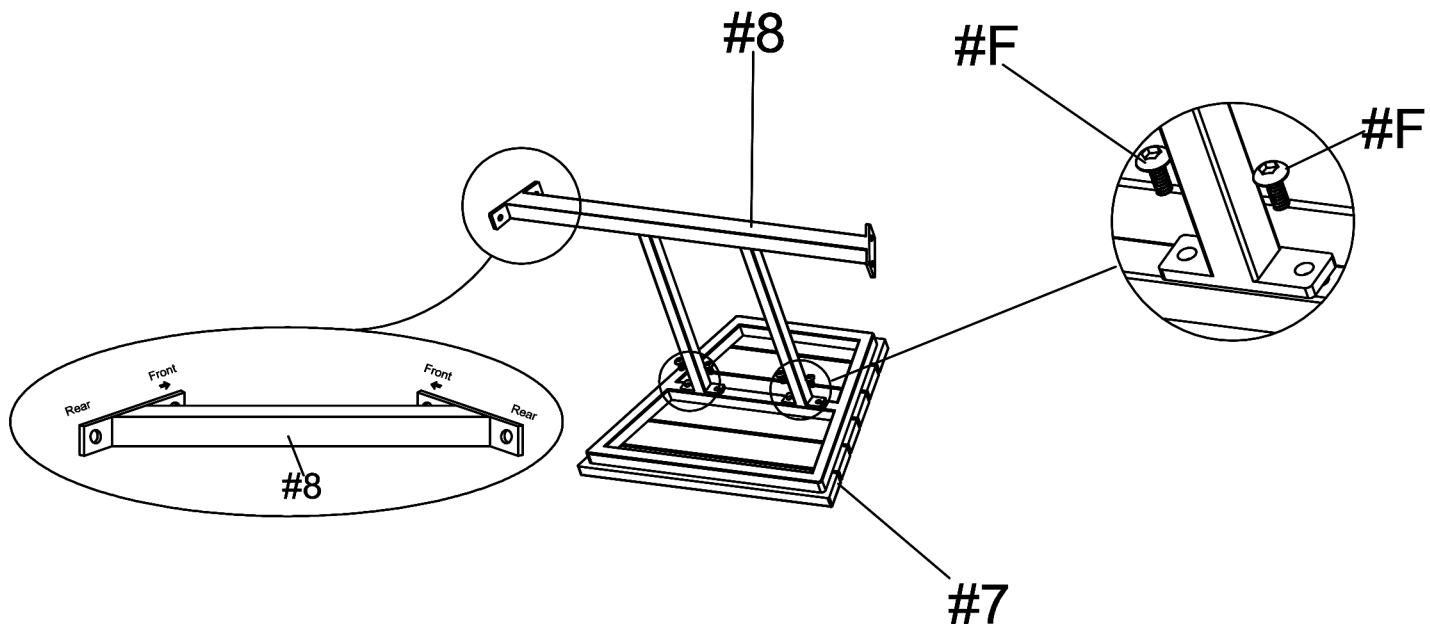

# ASSEMBLY INSTRUCTIONS

- 7 Hardware **#B** x8pcs  
Hardware **#I** x8pcs  
Hardware **#J** x16pcs

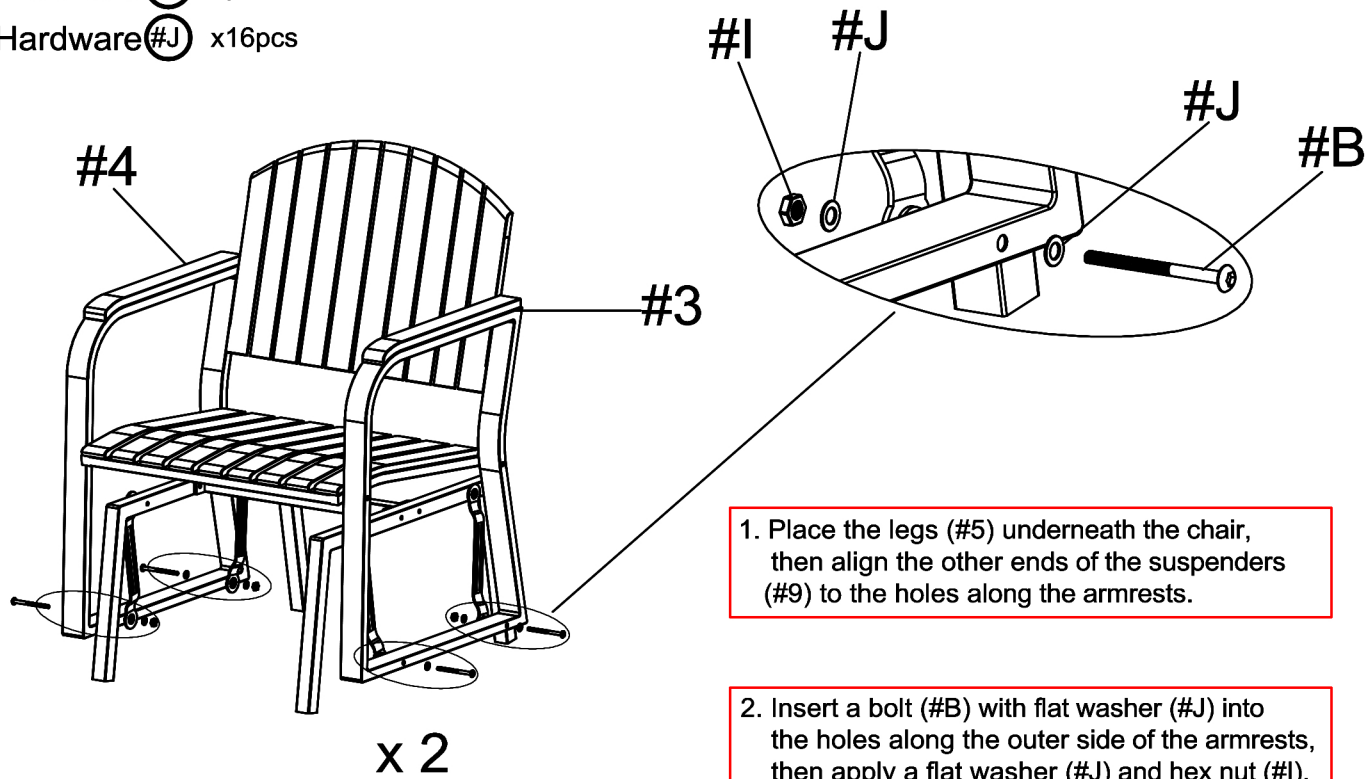

- 8 Hardware **#D** x2pcs  
Hardware **#I** x2pcs  
Hardware **#J** x4pcs

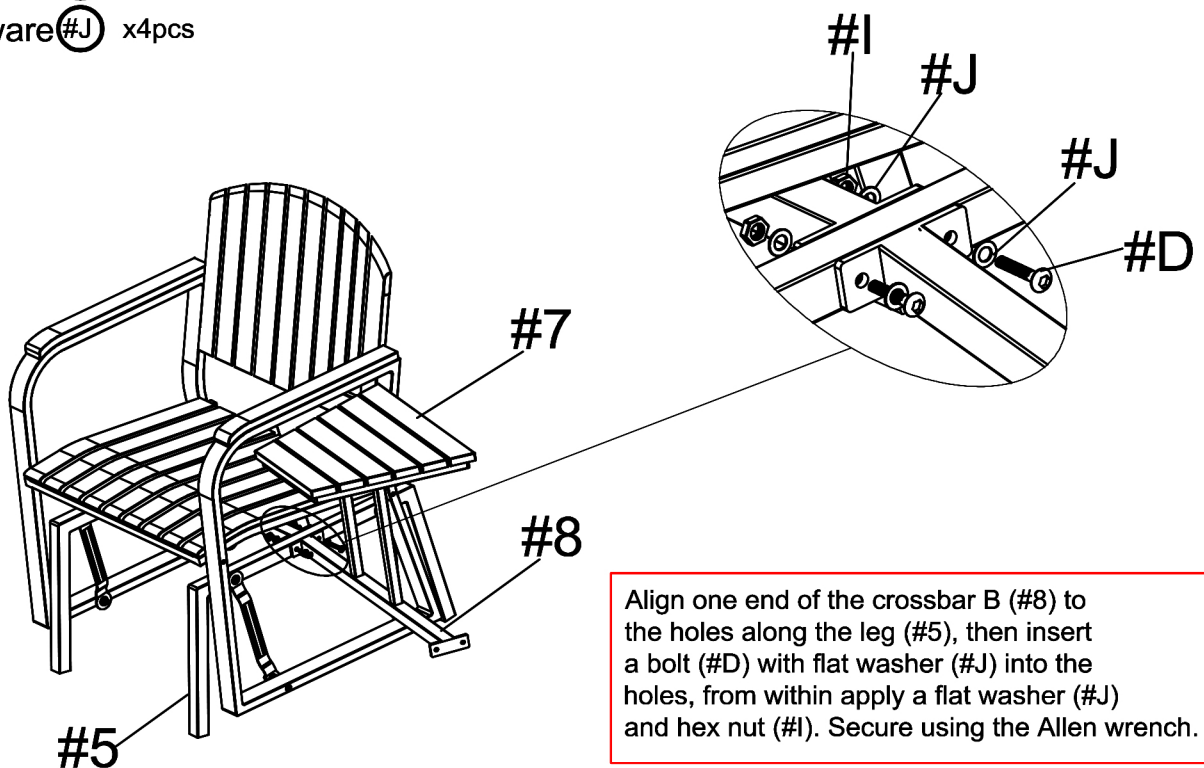

# ASSEMBLY INSTRUCTIONS

- 9 Hardware (#D) x2pcs  
Hardware (#I) x2pcs  
Hardware (#J) x4pcs



Align the other end of the crossbar B (#8) to the holes along the leg (#5), then insert a bolt (#D) with flat washer (#J) into the holes, from within apply a flat washer (#J) and hex nut (#I). Secure using the Allen wrench.

10

Make sure all parts are firmly secured.



## ASSEMBLY COMPLETED



Please ensure the furniture rests on an even and flat surface. If the product wobbles or feels loose, double-check all bolts and/or screws are properly tightened and secured.



### Keep this handy!

Please retain this instruction manual and any order-related information for future reference.



### Lift, don't drag!

To avoid damage to product please always LIFT the product when transporting or adjusting the placement.