

Assembly Instructions

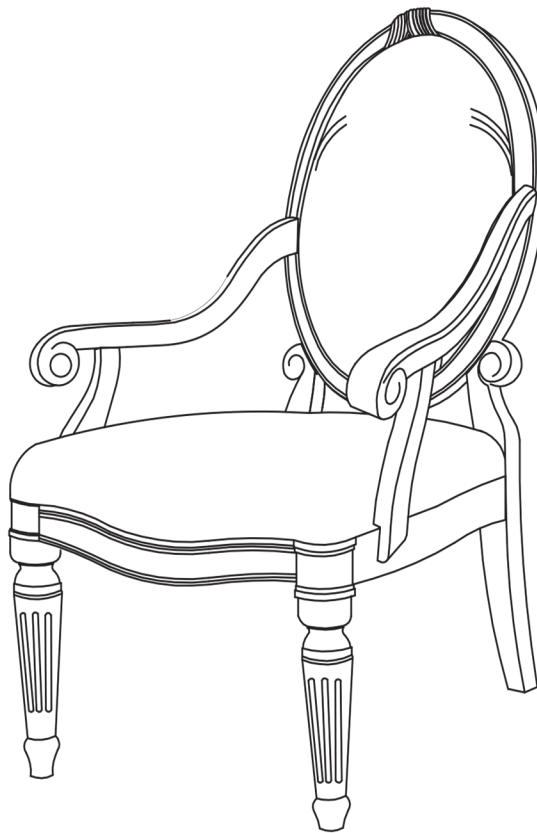

ASSEMBLY RATING

The Assembly Rating is a 5-point system that shows the degree of effort needed in assembling a specific product (with 1 being easy and 5 being difficult). For some products, two persons are recommended.

Tools Required For Assembly:

Allen Wrench



(Included)

Phillips Screwdriver



(Not Included)

EASY



DIFFICULT

ASSEMBLY & CARE ADVICE

FOR YOUR FURNITURE TO LAST, CORRECT ASSEMBLY AND PROPER MAINTENANCE ARE NECESSARY. PLEASE FOLLOW THE INFORMATION PROVIDED BELOW TO FULLY ENJOY YOUR FURNITURE.

BASIC ASSEMBLY TECHNIQUES

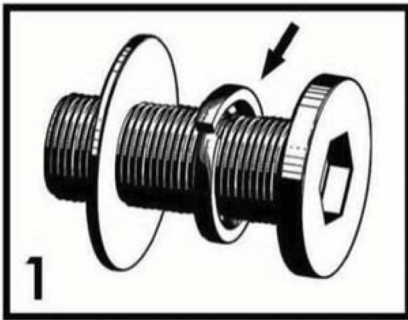

When lock or spring washer is used in an assembly, please make sure the lock or spring washer is placed between the larger flat washer and the head of the screw or bolt.

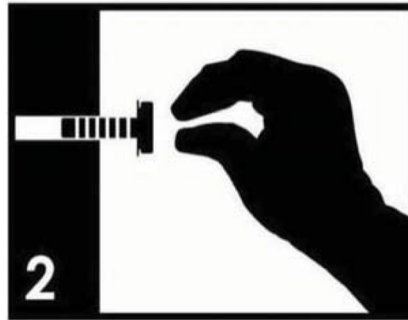

Position each part correctly and insert screws or bolts into their respective holes by hand tighten or using the proper hand tool. Only tighten when step is completed or when instructed to do so.

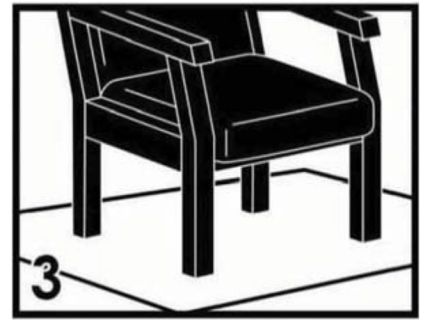

Use cardboard or carpet area when assembling furniture to prevent scratches. Make sure the furniture rests on a flat and level surface with each leg evenly touching the floor.

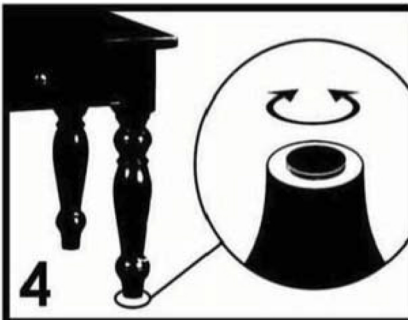

Some furniture comes with height adjustment knobs underneath each leg. To lower or to raise each leg, you need to turn clockwise or counterclockwise, respectively.

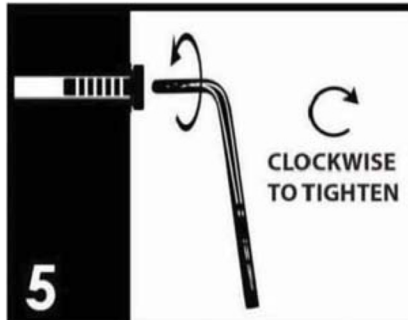

Make sure all parts are properly aligned, then use the appropriate hand tool to completely tighten the bolts or screws. Do not use power tools and do not overtighten.

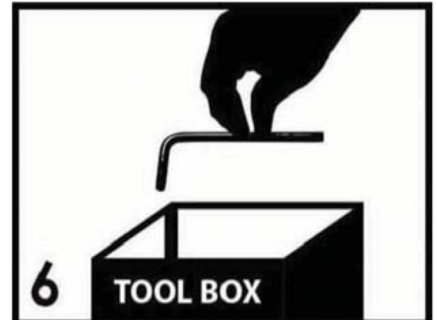

Save the instructions and store the Allen wrench or any supplied tool for later maintenance. After two weeks, check and tighten any loose hardware and repeat again every six months thereafter.

IT IS THE USER'S RESPONSIBILITY TO MAINTAIN THE FURNITURE. THE HARDWARE MAY LOOSEN OVER TIME AND MAY CAUSE THE FURNITURE TO BE WOBBLY AND UNABLE TO SUPPORT ITS INTENDED WEIGHT CAPACITY. THIS MAY LEAD TO COLLAPSE AND MAY CAUSE SERIOUS INJURY.



FAILURE TO FOLLOW THE GUIDELINES ABOVE MAY RESULT IN INJURY AND/OR PROPERTY DAMAGE.

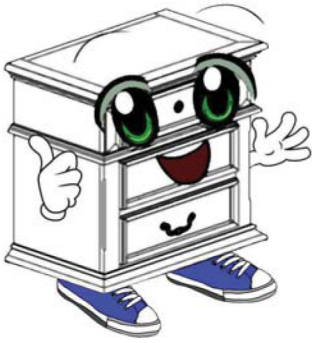

Before you begin, please read Page 2 of "Assembly and Care Advice".

And remember, do not tighten until each step is completed or instructed.

Parts List

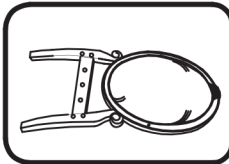

#1 x 1pc
Backrest w/Legs

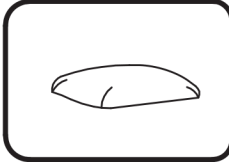

#2 x 1pc
Cushion

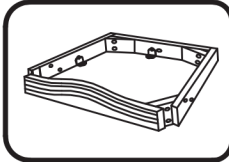

#3 x 1pc
Seat Frame

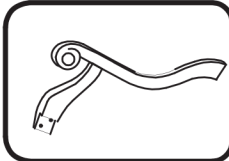

#4 x 1pc
Left Arm

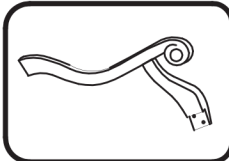

#5 x 1pc
Right Arm

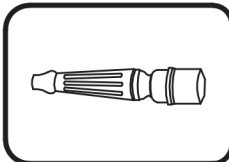

#6 x 2pcs
Front Leg

Hardware List

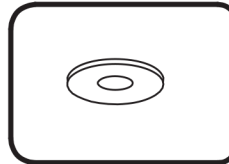

#A x 9pcs
Flat Washer 5/16"X 3/4"



#B x 9pcs
Lock Washer 5/16"

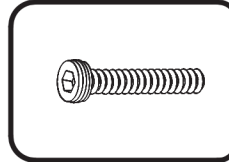

#C x 4pcs
Bolt Ø5/16"X3"

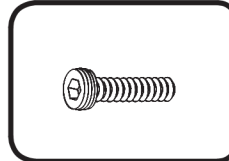

#D x 4pcs
Bolt Ø5/16"X 2-1/2"

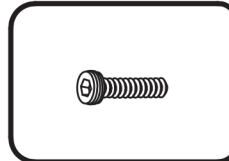

#E x 1pc
Bolt Ø5/16"X 1-1/2"

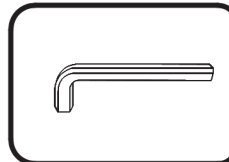

#F x 1pc
Allen Wrench 5/16"

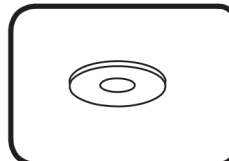

#G x 6pcs
Flat Washer 1/4"X 5/8"

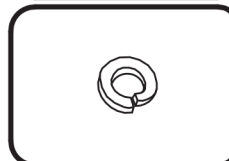

#H x 6pcs
Lock Washer 1/4"

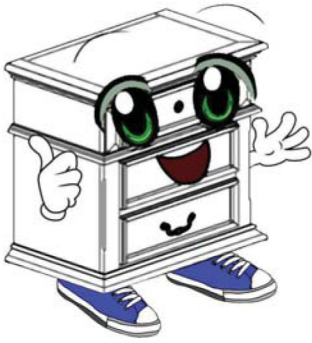

Before you begin, please read Page 2 of "Assembly and Care Advice".

And remember, do not tighten until each step is completed or instructed.

Hardware List



#I x 2pcs
Bolt Ø1/4"X1-1/2"



#Jx 4pcs
Bolt Ø1/4"X1-1/4"

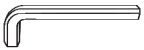

#K x 1pc
Allen Wrench 1/4"



#Lx 5pcs
Wood Screw



#M x 2pcs
Plug



#1

1. Place the backrest w/legs (#1) onto a protected surface.

2. Align the back of the seat frame (#3) to the center and corner pre-drilled holes along the backrest w/legs.

#A x 5pcs
#B x 5pcs
#C x 4pcs
#E x 1pc

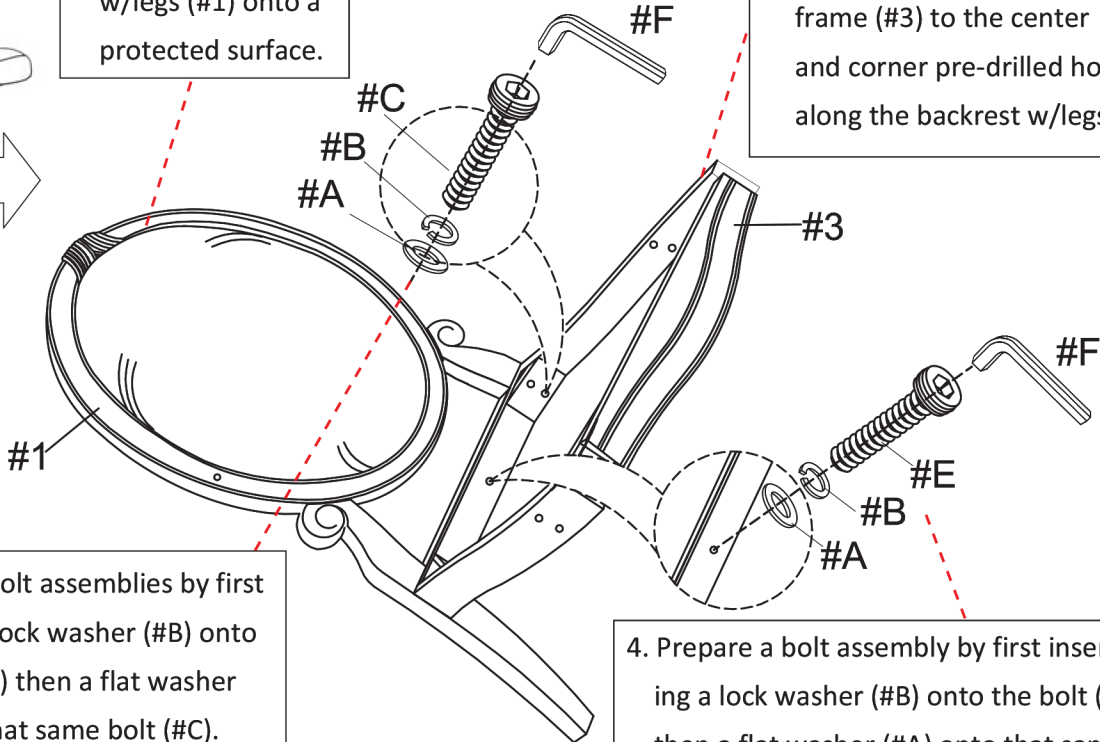

3. Prepare 4 bolt assemblies by first inserting a lock washer (#B) onto the bolt (#C) then a flat washer (#A) onto that same bolt (#C). Insert the bolts into the corners. Secure using the Allen wrench.

4. Prepare a bolt assembly by first inserting a lock washer (#B) onto the bolt (#E) then a flat washer (#A) onto that same bolt (#E). Insert the bolt into the center. Secure using the Allen wrench (#F).



#2

1. Prepare 4 bolt assemblies by first inserting a lock washer (#B) onto the bolt (#D) then a flat washer (#A) onto that same bolt (#D), in that order.

#A x 4pcs
#B x 4pcs
#D x 4pcs

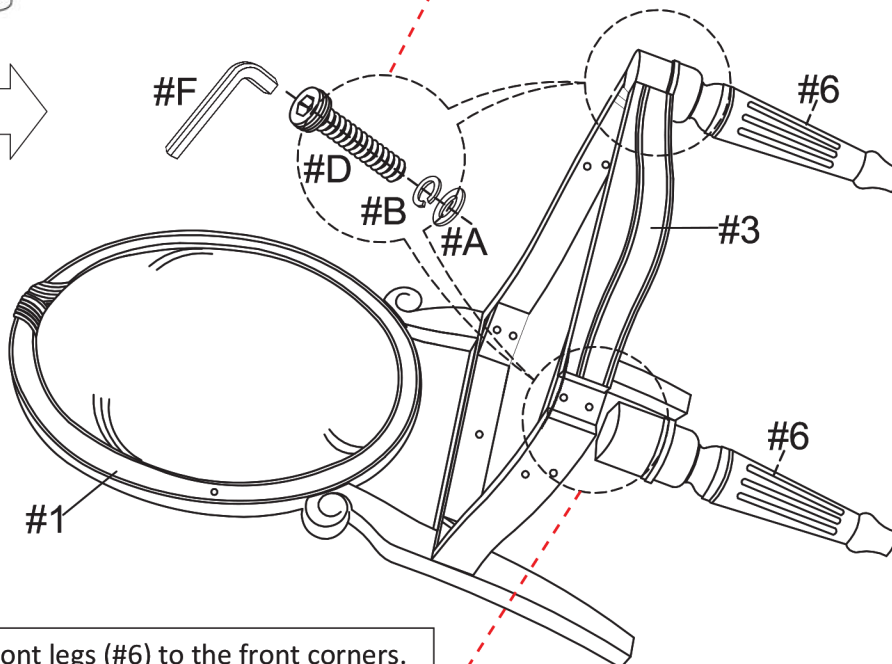

2. Align the front legs (#6) to the front corners. Then insert the prepared bolt assemblies from within. Secure using the Allen wrench.



- #G x 6pcs
- #H x 6pcs
- #I x 2pcs
- #J x 4pcs
- #L x 5pcs
- #M x 2pcs

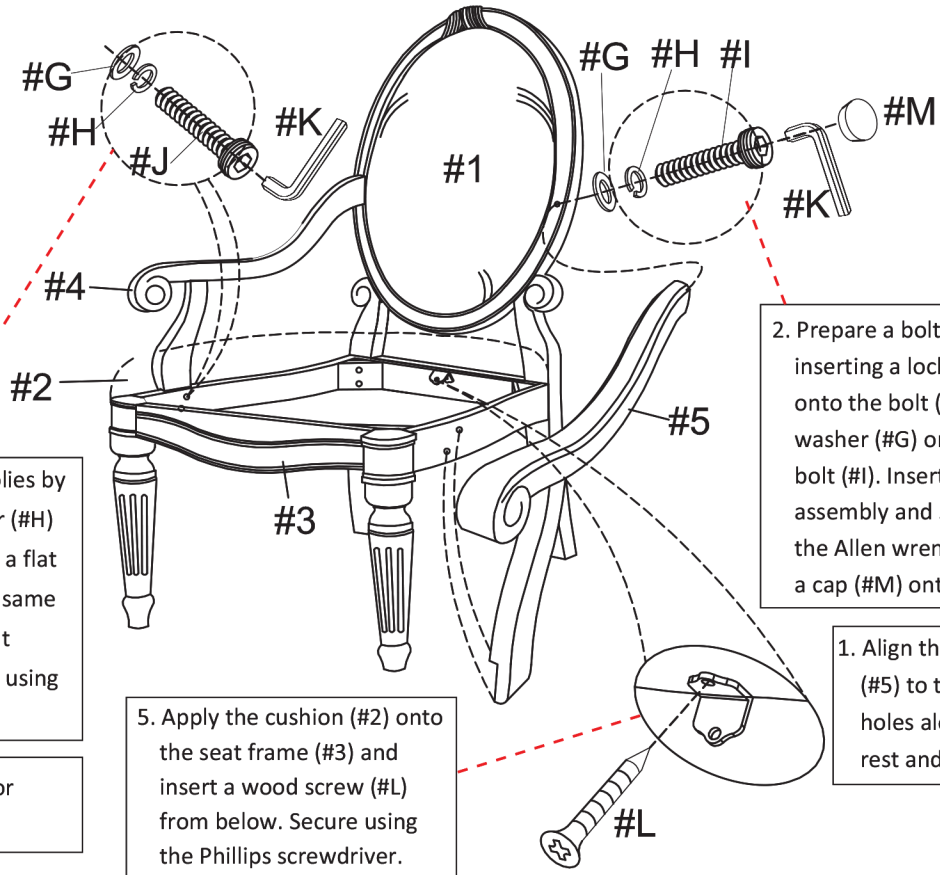

3. Prepare 2 bolt assemblies by inserting a lock washer (#H) onto the bolt (#J) then a flat washer (#G) onto that same bolt (#J). Insert the bolt assemblies and secure using the Allen wrench (#K).

4. Repeat the process for the left arm (#4).

5. Apply the cushion (#2) onto the seat frame (#3) and insert a wood screw (#L) from below. Secure using the Phillips screwdriver.

2. Prepare a bolt assembly by inserting a lock washer (#H) onto the bolt (#I) then a flat washer (#G) onto that same bolt (#I). Insert the bolt assembly and secure using the Allen wrench (#K). Apply a cap (#M) onto the bolt.

1. Align the right arm (#5) to the pre-drilled holes along the backrest and seat frame.



Carefully turn the completed chair upright. Make sure the chair is rested on a flat surface and does not feel loose or wobbly. If it does, double check that the bolts are secured and properly tightened.

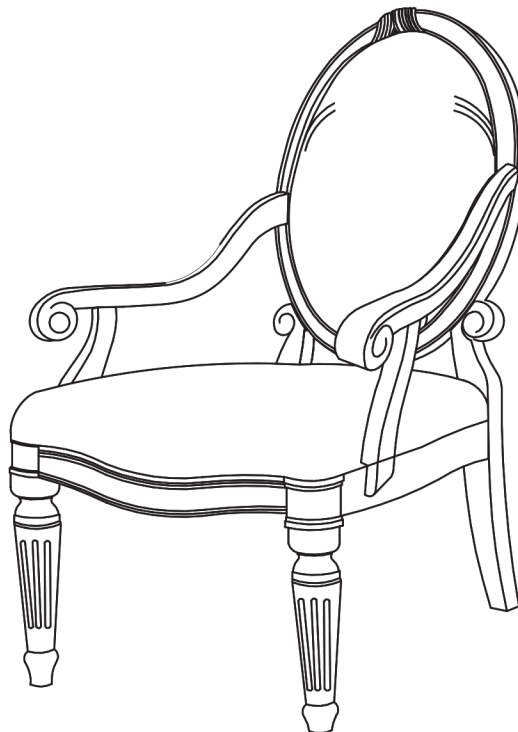

ASSEMBLY IS COMPLETED