

# Assembly Instructions

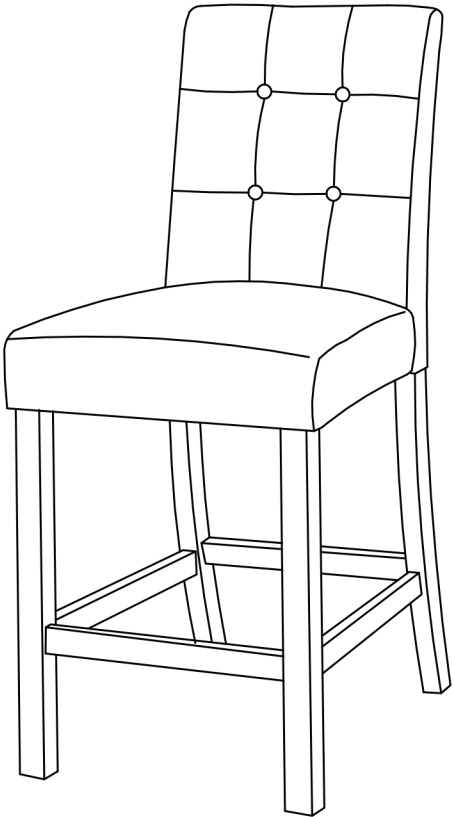

## ASSEMBLY RATING

The Assembly Rating is a 5-point system that shows the degree of effort needed in assembling a specific product (with 1 being easy and 5 being difficult). For some products, two persons are recommended.

## Tools Required For Assembly:

Allen Wrench

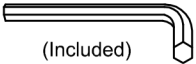

(Included)

EASY



DIFFICULT

# ASSEMBLY & CARE ADVICE

FOR YOUR FURNITURE TO LAST, CORRECT ASSEMBLY AND PROPER MAINTENANCE ARE NECESSARY. PLEASE FOLLOW THE INFORMATION PROVIDED BELOW TO FULLY ENJOY YOUR FURNITURE.

## BASIC ASSEMBLY TECHNIQUES

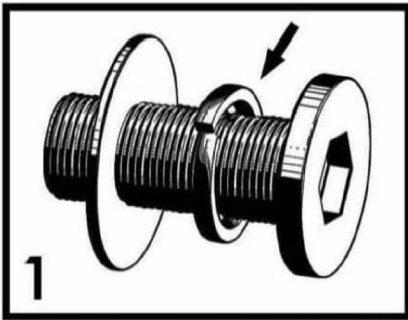

When lock or spring washer is used in an assembly, please make sure the lock or spring washer is placed between the larger flat washer and the head of the screw or bolt.

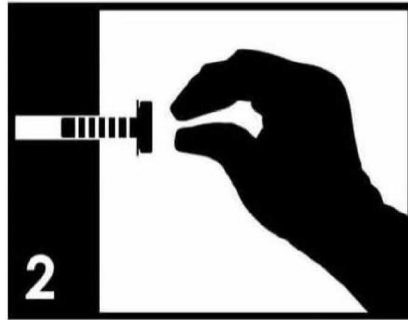

Position each part correctly and insert screws or bolts into their respective holes by hand tighten or using the proper hand tool. Only tighten when step is completed or when instructed to do so.

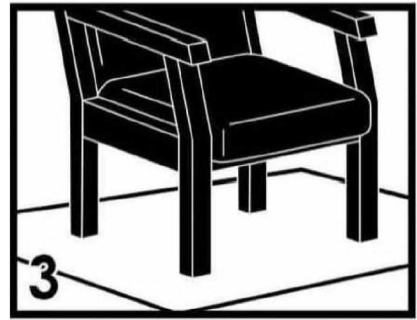

Use cardboard or carpet area when assembling furniture to prevent scratches. Make sure the furniture rests on a flat and level surface with each leg evenly touching the floor.

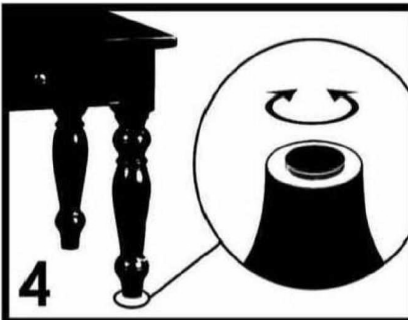

Some furniture comes with height adjustment knobs underneath each leg. To lower or to raise each leg, you need to turn clockwise or counterclockwise, respectively.

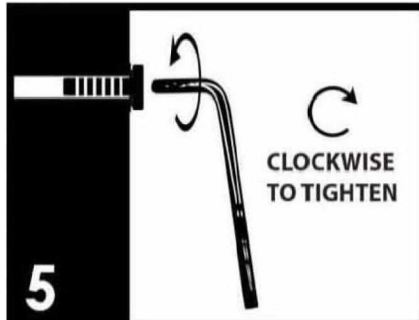

Make sure all parts are properly aligned, then use the appropriate hand tool to completely tighten the bolts or screws. Do not use power tools and do not overtighten.

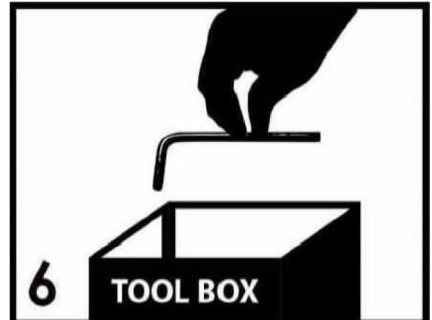

Save the instructions and store the Allen wrench or any supplied tool for later maintenance. After two weeks, check and tighten any loose hardware and repeat again every six months thereafter.

IT IS THE USER'S RESPONSIBILITY TO MAINTAIN THE FURNITURE. THE HARDWARE MAY LOOSEN OVER TIME AND MAY CAUSE THE FURNITURE TO BE WOBBLY AND UNABLE TO SUPPORT ITS INTENDED WEIGHT CAPACITY. THIS MAY LEAD TO COLLAPSE AND MAY CAUSE SERIOUS INJURY.



**FAILURE TO FOLLOW THE GUIDELINES ABOVE MAY RESULT IN INJURY AND/OR PROPERTY DAMAGE.**

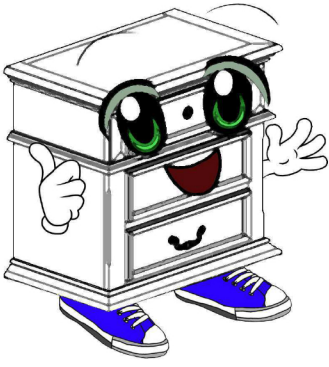

Before you begin, please read Page 2 of "Assembly and Care Advice".

And remember, do not tighten until each step is completed or instructed.

### Parts List

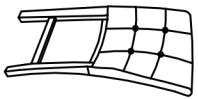

#1 x 1pc x 2  
Backrest w/Legs

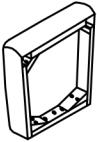

#2 x 1pc x 2  
Seat

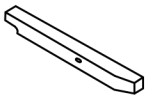

#3 x 1pc x 2  
Right Front Leg

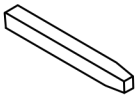

#4 x 1pc x 2  
Left Front Leg



#5 x 1pc x 2  
Right Side Stretcher

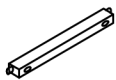

#6 x 1pc x 2  
Left Side Stretcher

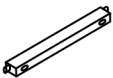

#7 x 1pc x 2  
Front Stretcher



x 2

### Hardware List



#A x 4pcs x 2  
Bolt 5/16"X3-1/2"



#B x 4pcs x 2  
Bolt 5/16"X2-1/4"



#C x 2pcs x 2  
Bolt 5/16"X1-3/4"



#D x 10pcs x 2  
Lock Washer Ø5/16"



#E x 10pcs x 2  
Flat Washer Ø5/16"



#F x 1pc x 2  
Allen Wrench 5mm



#G x 1pc  
Wood Dowel Ø10\*40MM



#H x 6pcs  
Wood Screw 1-1/2" L



1. Prepare 2 bolt assemblies by first inserting a lock washer (#D) onto the bolt (#C) then a flat washer (#E) onto that same bolt (#C).

- #C x 2pcs
- #D x 2pcs
- #E x 2pcs
- #G x 1pc

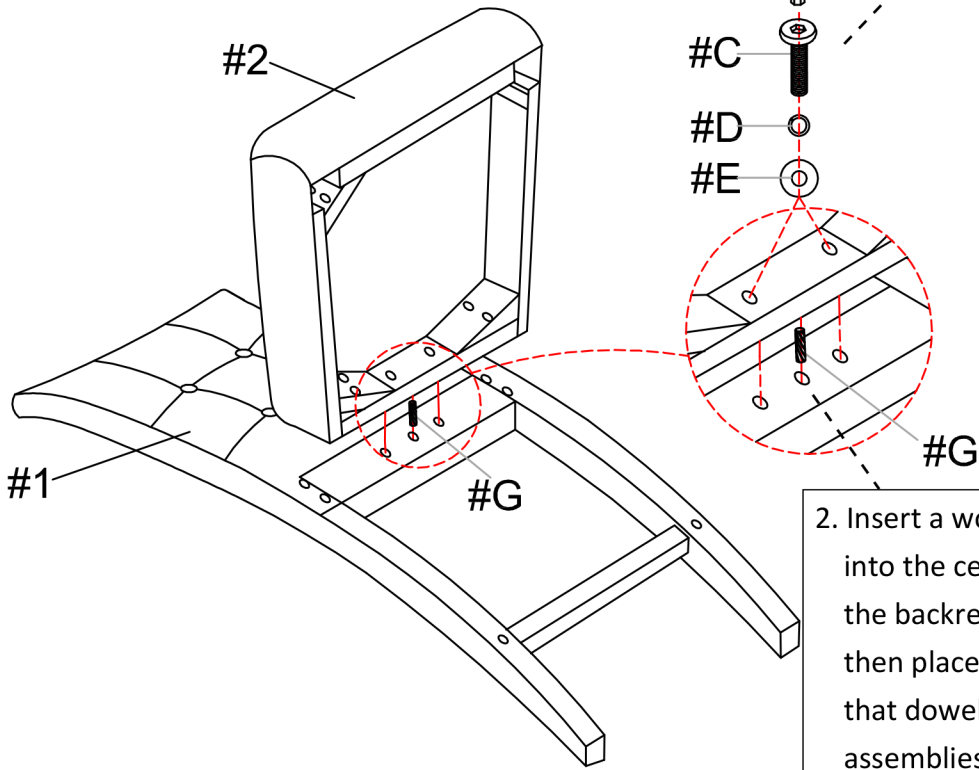

2. Insert a wood dowel (#G) into the center hole along the backrest w/legs (#1), then place the seat (#2) onto that dowel. Insert the bolt assemblies into the remaining holes and secure.



1. Prepare 4 bolt assemblies by first inserting a lock washer (#D) onto the bolt (#A) then a flat washer (#E) onto that same bolt (#A).

- #A x 4pcs
- #D x 4pcs
- #E x 4pcs

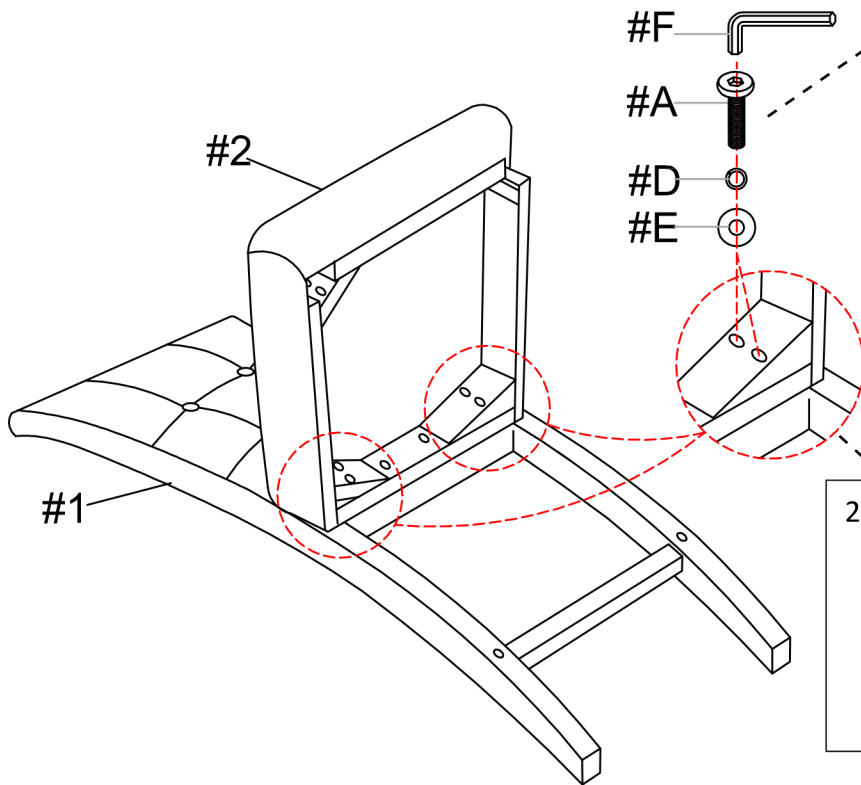

2. Insert the bolt assemblies into the rear corners and secure using the Allen wrench (#F).



1. Prepare 4 bolt assemblies by first inserting a lock washer (#D) onto the bolt (#B) then a flat washer (#E) onto that same bolt (#B).

#B x 4pcs  
#D x 4pcs  
#E x 4pcs

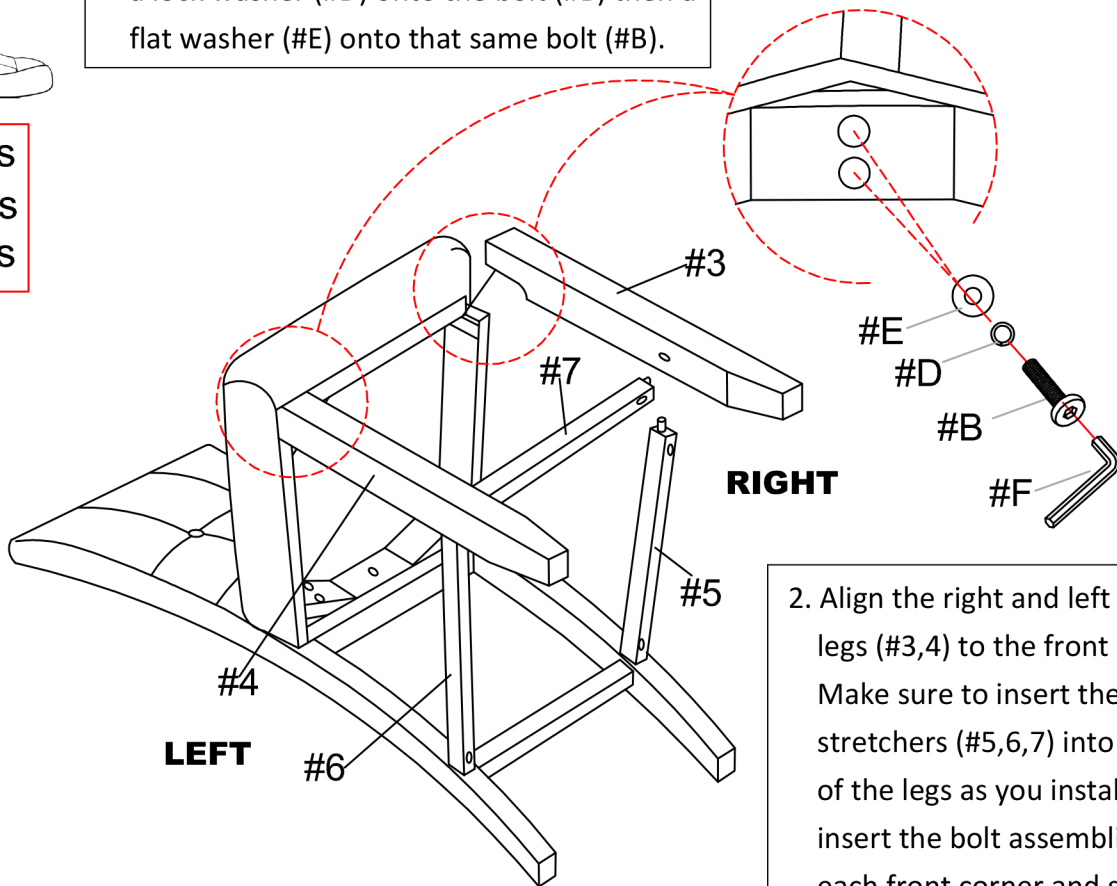

2. Align the right and left front legs (#3,4) to the front corners. Make sure to insert the stretchers (#5,6,7) into the side of the legs as you install. Then insert the bolt assemblies into each front corner and secure.



Insert the screws (#H) into each end of the stretchers at a diagonal, then secure using a screwdriver.

#H x 6pcs

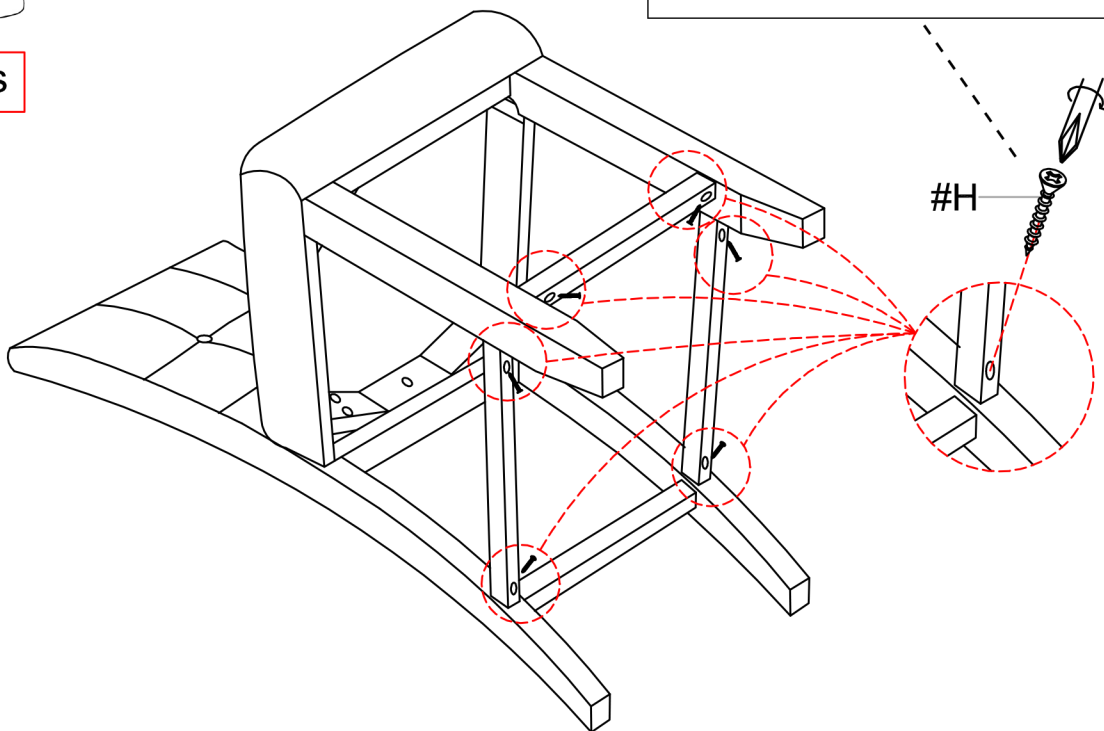

If wobbly, please ensure to level the chair with the flooring, and adjust the bolts gradually until the chair does not wobble anymore.