



Advanced Innovative Machinery

Installation Instructions

AIM PERFORMANCE PRODUCTS

Parts#MB002-006

•Reverse Gear MAMBA (Monoblock for Cable operated)

For '07 and later Big Twin models (including '06 Dyna)

Read and become familiar with these installation instructions before start.

Two Piece for H-D 6 Speed Trans., Cable operated (Parts#MB002-006)

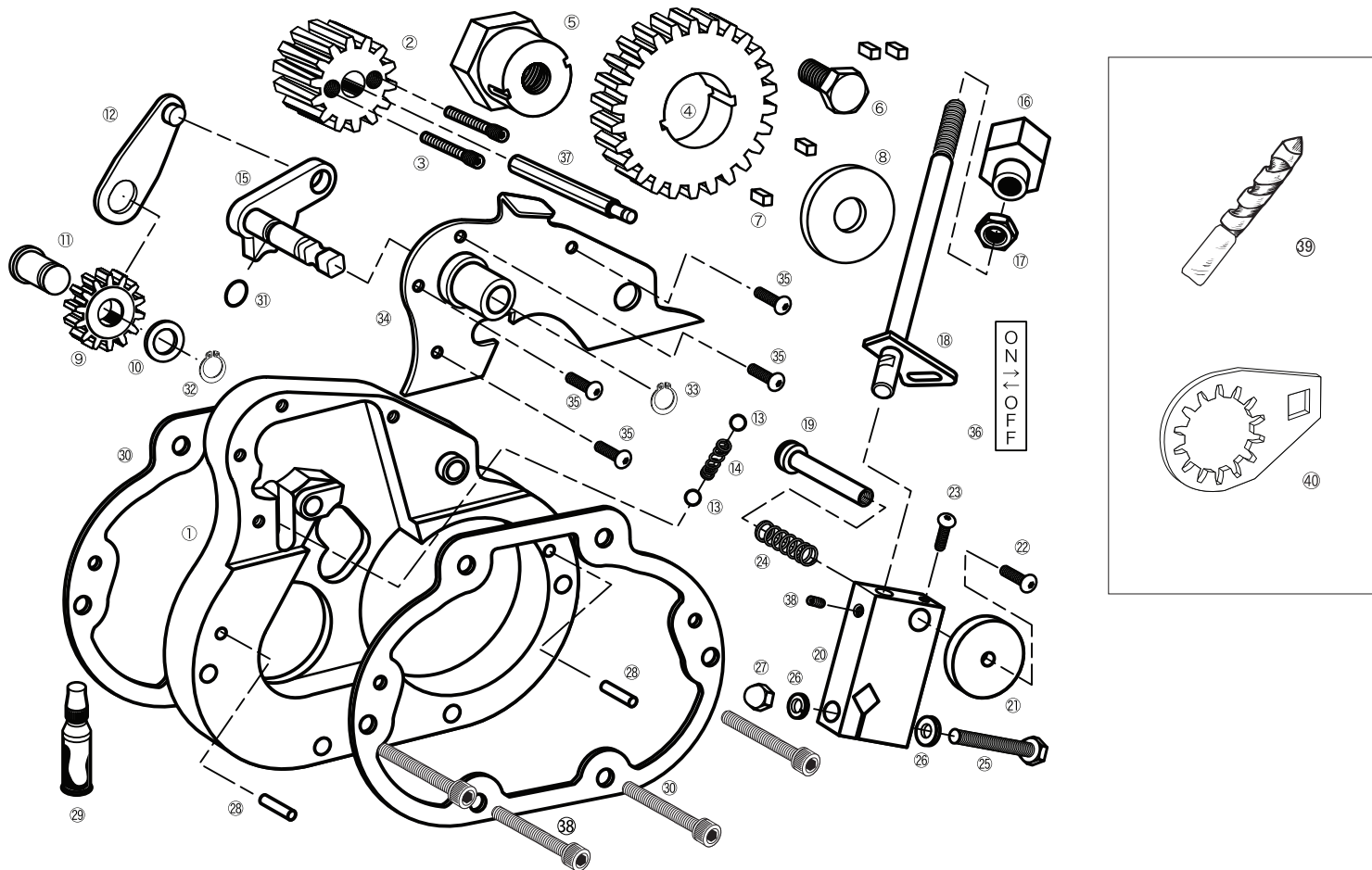

Parts#	Name	Q
①	PMB001-080 Gear Housing	1
②	PMB001-002 Main Gear	1
③	PMB001-003 Lock pin screws(2)	2
④	PMB001-004 Counter Gear	1
⑤	PMB001-005 Counter Nut	1
⑥	PMB001-006 Bolt M10 x 10	1
⑦	PMB001-007 Break off keys (4)	4
⑧	PMB001-008 Washer 10mm x 32mm	1
⑨	PMB001-009 Idler Gear	1
⑩	PMB001-081 Thrust washer	1
⑪	PMB001-082 Idler pin	1
⑫	PMB001-083 Shifter linkage	1
⑬	PMB001-013 Ball Bearing 8mm	2
⑭	PMB001-014 Spring 8mm x 12mm	1
⑮	PMB001-084 Reverse shifter	1
⑯	PMB001-016 Shifter knob	1
⑰	PMB001-017 Nut M10	1
⑱	PMB001-018 Shift Lever	1
⑲	PMB001-019 Shift Lock Pin	1
⑳	PMB001-020 Shift body	1

Parts#	Name	Q
㉑	PMB001-021 Shift disc	1
㉒	PMB001-022 Screw 6mm x 10mm	1
㉓	PMB001-023 Screw 5mm x 10mm	1
㉔	PMB001-024 Spring 10mm x 20mm	1
㉕	PMB001-025 Bolt 8mm x 40mm	1
㉖	PMB001-026 Lock Washer (2)	1
㉗	PMB001-027 Nut M8	1
㉘	PMB001-085 Dowel pin	2
㉙	PMB001-029 LockTite #620(Green)	1
㉚	PMB001-030 Gasket (2)	2
㉛	PMB001-031 O r ring	1
㉜	PMB001-032 Snap Ring, Steel	2
㉝	PMB001-033 Snap Ring, SS	1
㉞	PMB001-086 Side plate	1
㉟	PMB001-087 Screw 5mm x 12mm (4)	4
㊱	Sticker	
㊲	PMB001-077 79mm Extension rod	1
㊳	PMB001-088 Bolt, 1/4"-20 x 1 3/4"	4
㊴	PMB001-078 5mm Drill Bit or Bur	2
㊵	PMB001-089 Plate wrench adaptor	1



Advanced Innovative Machinery

AIM PERFORMANCE PRODUCTS

Parts#MB002-006

•Reverse Gear MAMBA (Two Piece for Cable operated)

For '07 and later Big Twin models (including '06 Dyna)

Installation Instructions 1/3

Read and become familiar with these installation instructions before start.

⚠ WARNING!!

To prevent accidental vehicle start-up, which could cause serious injury, disconnect negative(-) battery cable before proceeding.

Note

Touring models: '09, '10 model is not required pipe modifications. Other years require the True dual pipe (Parts#FS001-001) or changing full exhaust system due to clearance issue.

Softail, Dyna models and some aftermarket exhaust pipes: May require pipe modifications or changing exhaust pipe due to clearance issue.

1. Drain the transmission oil. Remove exhaust pipe if it is necessary.
2. Remove the Rightside transmission side cover and oil slinger assembly.
3. Remove two nuts from the mainshaft and countershaft.
4. Clean threads of mainshaft and countershaft using a parts cleaner to remove oil. Apply plenty of supplied LockTite# 620 (Green) 29 to thread of mainshaft.

5. **Caution**
Do not use impact wrench (Power tool) to tighten the main gear 2 which causes breaking mainshaft.

Note
To prevent rotating mainshaft during tightening main gear. Shift into 1st gear and apply rear brake.

See Figure 1. Tighten the main gear 2 to 80ft-lbs (109Nm) using the supplied plate wrench 36.

6. **Caution**
Use Regular Drill which is less than 3000rpm. Do not use high speed air grinder and push the supplied 5mm bur very hard which causes breaking the bur.

Caution
Do not grind more than 0.945" (24mm) depth which causes damaging bearing inner race and bur.

See Figure 2. Using the supplied 5mm drill bit, drill the mainshaft straight (This is for Lock pin) to the depth of 0.905"(23mm) from the main gear surface through two holes of the main gear.

7. Completely clean the drilled holes. Use care to ensure debris does not enter transmission.
8. See Figure 3. Do not apply any LockTite to lock pin screw 3. Install Lock pin screws into the main gear. Tighten the lock pin screw to 8 ft-lbs.
9. Clean thread of the counter nut 5 using parts cleaner to remove oil. Apply plenty of the supplied LockTite#620 (Green) 29 to thread of countershaft.

10. **Caution**
Do not use impact wrench (Power tool) to tighten the counter nut which causes breaking countershaft.

Note
To prevent rotating countershaft during tightening main gear. Shift into 1st gear and apply rear brake.

See Figure 4. Tighten the counter nut 5 to 80ft-lbs (109Nm) using the 32mm socket.

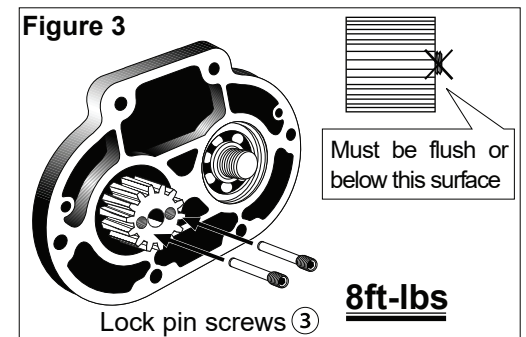
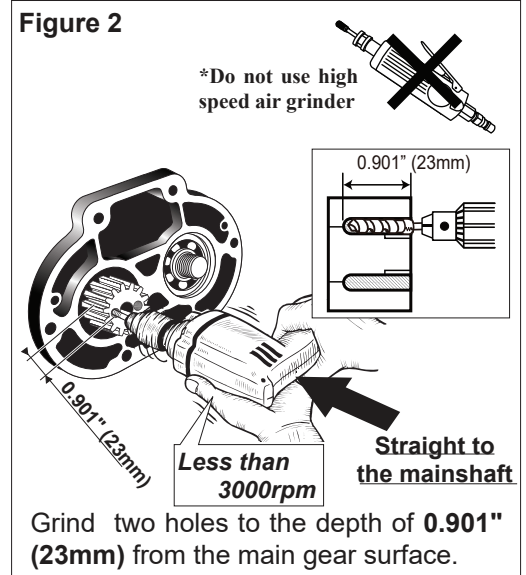
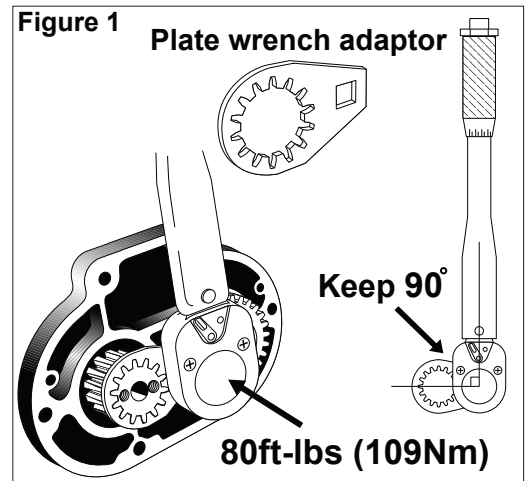



Advanced Innovational Machinery

AIM PERFORMANCE PRODUCTS

Parts#MB002-006

• Reverse Gear MAMBA (Two Piece for Cable operated)
For 6 speed Trans., '07 and later Big Twin models (including '06 Dyna)

Installation Instructions 2/3

11. Apply grease between the counter nut and counter gear. Install the counter gear④ on to the counter nut.
12. **See Figure 5.** Apply grease between the counter nut and counter gear. Install the counter gear④ on to the counter nut.
13. Align key grooves on the counter nut and counter gear. Install two break-off keys⑦ into the grooves.
14. **Note**
To prevent rotating countershaft during tightening main gear. Shift into 1st gear and apply rear brake.
See Figure 6. Apply LockTite#271 (Red) to the thread of bolt⑥. Install bolt with the washer to the counter nut. Tighten the bolt⑥ to **56ft-lbs (75Nm)**.
15. **See Figure 7.** Install the side cover gasket (Inner), Reverse gear housing, Two supplied dowel pins, side cover gasket (Outer).
16. **See Figure 8.** Remove the thrust bearing from oil slinger rod. Install thrust bearing to 12mm Extension rod ⑳.
17. Install 20mm Extension rod assembly into the mainshaft.
18. Modification to the cover

Figure 4

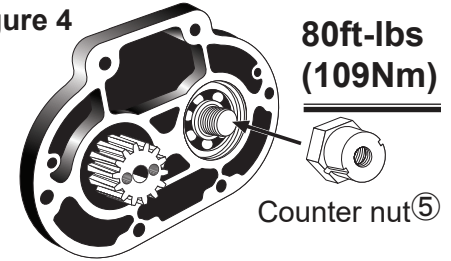

Figure 5

Apply grease between the counter boss and counter gear.

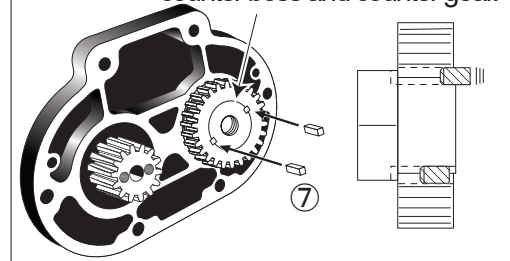

Figure 6

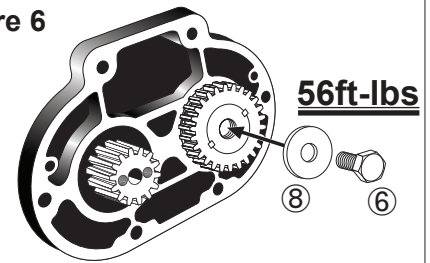

Figure 7

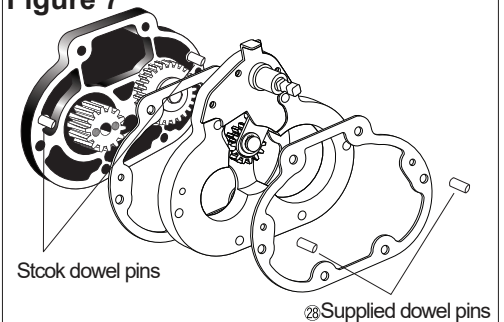
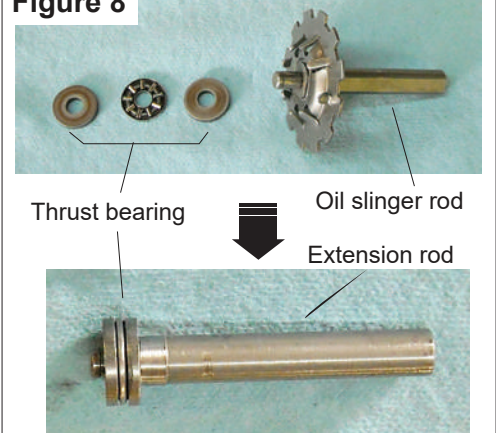
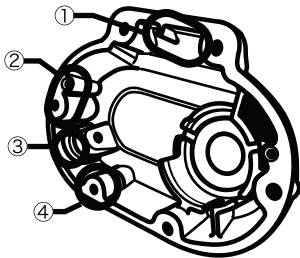

Figure 8



Modification needed

Need to grind about
6~7mm depth.



Need to grind about
6~7mm depth.

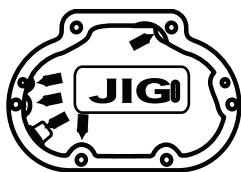

Use the Gasket as a guide.

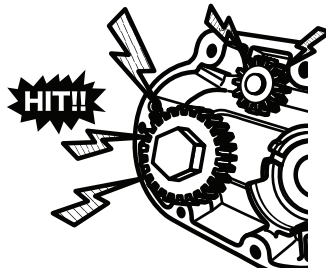
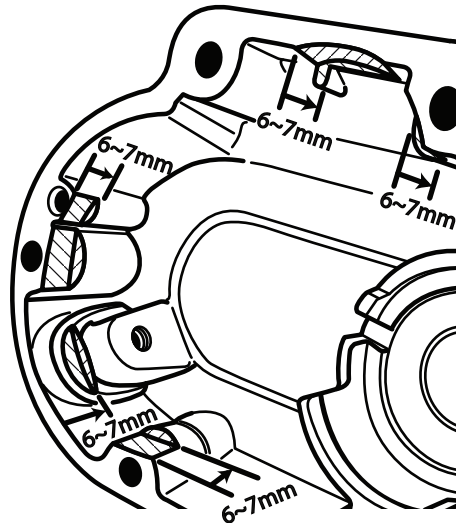

When grinding the cover, please apply cutting lube.



Advanced Innovative Machinery

AIM PERFORMANCE PRODUCTS

Parts#MB002-006

• Reverse Gear MAMBA (Two Piece for Cable operated)

For 6 speed Trans., '07 and later Big Twin models (including '06 Dyna)

Installation Instructions 3/3

- 19.** Install the side cover using 4 of supplied bolts and 2 of longer stock bolts. Tighten the bolts to **9ft-lbs (12Nm)**.

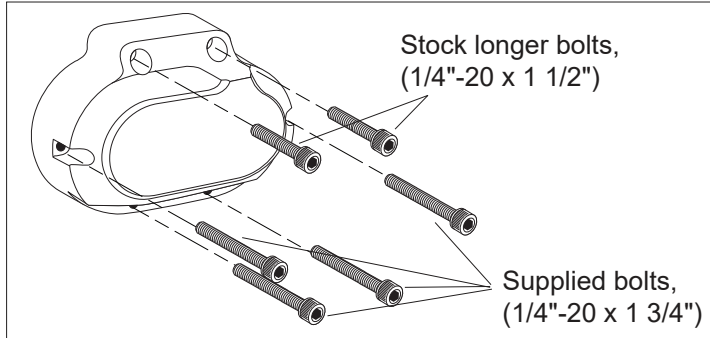

- 20.** Install the Reverse shift lever to the Reverse housing. Tighten the bolt to **27ft-lbs (37Nm)**.
- 21.** Fill the transmission with transmission lubricant. See Harley-Davidson service manual.
- 22.** Install the exhaust pipe if it is necessary.
- 23.** Adjust clutch. Turn clutch cable adjuster until there is a large amount of free play at clutch lever. Loosen locknut on clutch adjuster screw. To take up all free play, turn screw inward (clockwise) until lightly seated. Activate the clutch lever to verify the ball and ramp are completely seated. Back out adjusting screw 1/4 to 1/2 turn. Tighten locknut while holding adjusting screw with an Allen wrench. Adjust the clutch cable. Ensure free play of 1/8in or more at the clutch lever pivot between the clutch holder and lever without pulling the cable.
- 24.** Connect the battery.

Warranty

One year warranty on Reverse Gear parts only.



Advanced Innovational Machinery

Reverse gear operation

AIM PERFORMANCE PRODUCTS

Parts#MB001-001, MB001-002, MB002-003, MB003-003

• Reverse Gear MAMBA (Monoblock for cable)

For '07 and later Big Twin models (including '06 Dyna)

Reverse gear operation

To engage reverse gear:

⚠ WARNING

- Do not shift into the reverse gear before shift into 1st gear to stop spinning all gears in the transmission.
- Use reverse gear in Neutral. Transmission must be in Neutral when engaging or using reverse gear.
- Reverse gear is intended for light duty use only.

Failure to do so may result in breaking brake-off keys, damaged transmission or serious injury.

Note

No throttle, just release (engine idle speed) the clutch lever until you are accustomed with motorcycle going reverse.



Disengage the clutch. Shift into the 1st gear to stop spinning all gears in the transmission to prevent damaged transmission when put into the reverse gear.

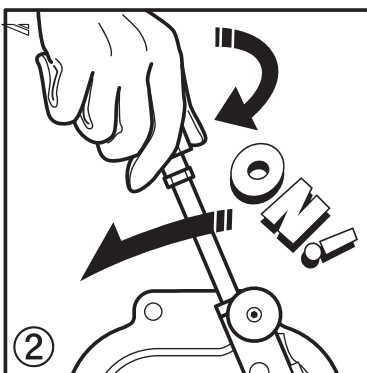

Twist the reverse handle (clockwise) and pull it back to shift into reverse gear. **Do not engage the clutch at this time.**

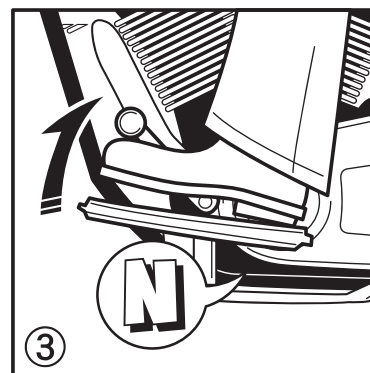

Shift transmission into Neutral. Engage the clutch to reverse motorcycle.

To disengage reverse gear:

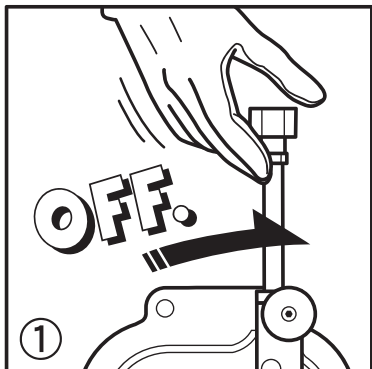

⚠ WARNING

Disengage the reverse gear before engaging any forward gears. Failure to do so may result in breaking brake-off keys, damaged transmission or serious injury.

Shift the reverse lever twist and forward to disengage reverse gear.



Advanced Innovative Machinery

Read and become familiar with these installation instructions before start.

Break-off key replacement

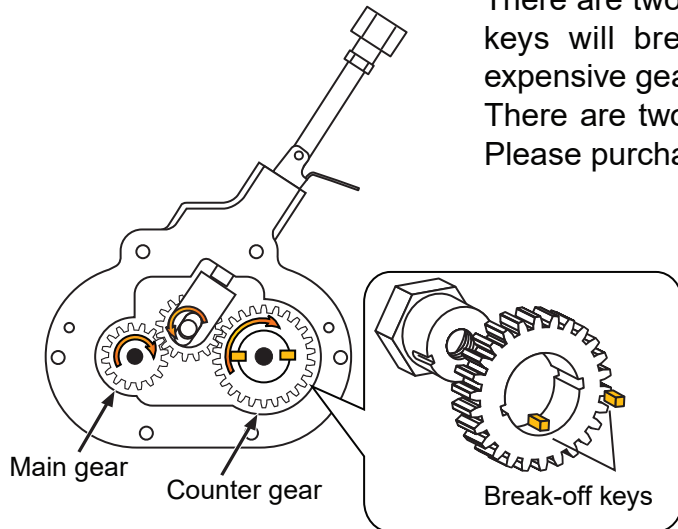

There are two break-off keys between the counter nut and gear. These keys will break when excessive load was applied to save more expensive gears than break-off keys.

There are two of extra keys in the kit. If you break all keys in the kit. Please purchase new Break-off keys (Parts#PMB001-007).

Excessive load!!

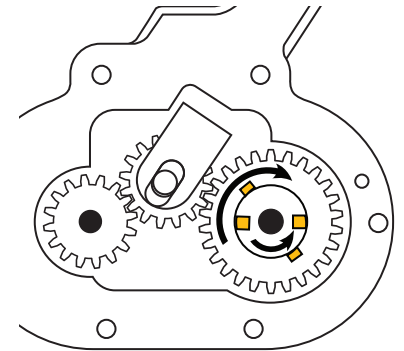

True Dual Pipe

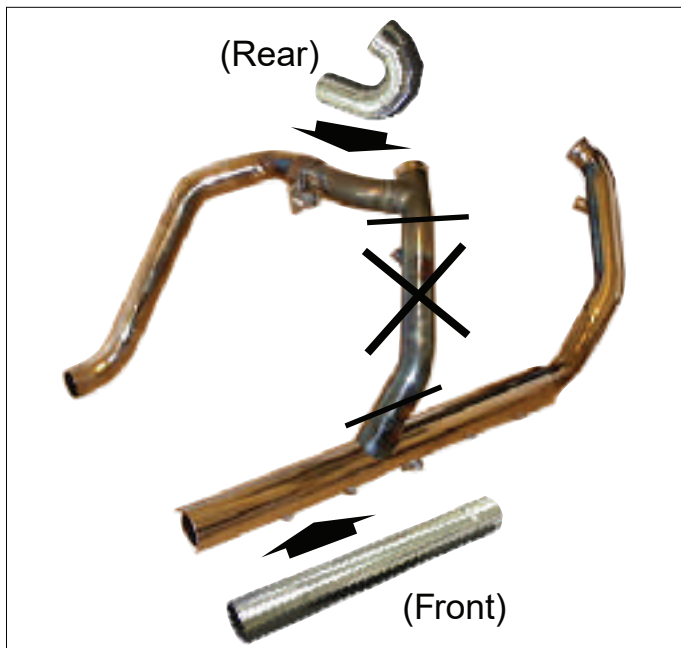

True Dual Pipe

For '87-'08 Touring model's stock exhaust pipe

- Eliminate cross over pipe to clear our Reverse gear kit for Touring models
- O2 sensor fitting for '07-'08 models
- Kit comes with O2 sensor plug for '87-'06 models

Parts#FS001-001 \$225.00



Advanced Innovative Machinery

AIM Corp.
 16631 Gemini Lane
 Huntington Beach, CA 92647
 Phone: 714-848-3030 Fax: 714-848-3031

E-mail: info@aim-tamachi.com

www.aim-tamachi.com