

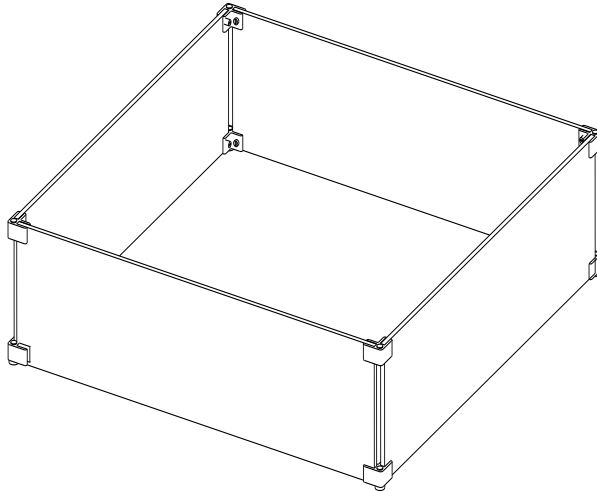

Square Glass Fire Pit Wind Guard



ATTACH YOUR RECEIPT HERE

Keep a copy of your proof of purchase or order confirmation which will be needed if you need to contact us about warranty coverage.

Purchase Date: _____



SAVE THESE INSTRUCTIONS FOR FUTURE REFERENCE.





BEFORE YOU BEGIN

Before beginning assembly, make sure all parts are present. Compare parts received with the “Parts List.” If any part is missing or damaged, do NOT attempt to assemble the product. Please read and understand this entire manual before attempting to assemble, operate or install this product.



SAFETY INFORMATION

WARNING

DO NOT stand or allow children to stand on the assembled product. DO NOT tighten bolts completely until instructed to do so. After final alignment, make sure all hardware is securely fastened. NEVER use a power tool to assemble or tighten your item. Perform periodic checks to make sure the hardware is secure and tighten if needed.

CAUTION

READ all instruction before beginning assembly. Failure to do so may result in faulty assembly and potential injury. Assemble the item on a soft, non-abrasive surface such as a carpet or cardboard to avoid damaging the item.

PACKAGE CONTENTS



PART	DESCRIPTION	QUANTITY
A	Glass panel	4



HARDWARE CONTENTS



B
Bottom Bracket
Qty: 5
(4 for assembly + 1 extra)



C
Top Bracket
Qty: 5
(4 for assembly + 1 extra)

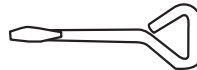

D
Screwdriver
Qty: 1

ASSEMBLY



PREPARATION

Before beginning assembly, be sure to empty contents of carton and make sure all parts are present.

Carefully remove the wind guard from the packaging and inspect for any damage such as chips or cracks. Place glass panels on a soft, flat surface to prevent any damage. Before assembly, ensure that each bracket has 2 set screws, with silicon inserts attached at the tip. Estimated Assembly Time: 30 Minutes | DO NOT over tighten hardware!

- 1** You will assemble the wind guard upside-down.

Loosen the set-screws in one **Top Bracket** **D**, then slide a short and long panel of glass into the bracket as shown.

Align bracket with lower edges of each glass panel. Ensure small silicone pad is in place at tip of each set-screw - **do NOT tighten metal screw directly to the glass. Over-tightening may break glass!** Tighten set-screws until snug.

Hardware Used: **D** Top Bracket x1

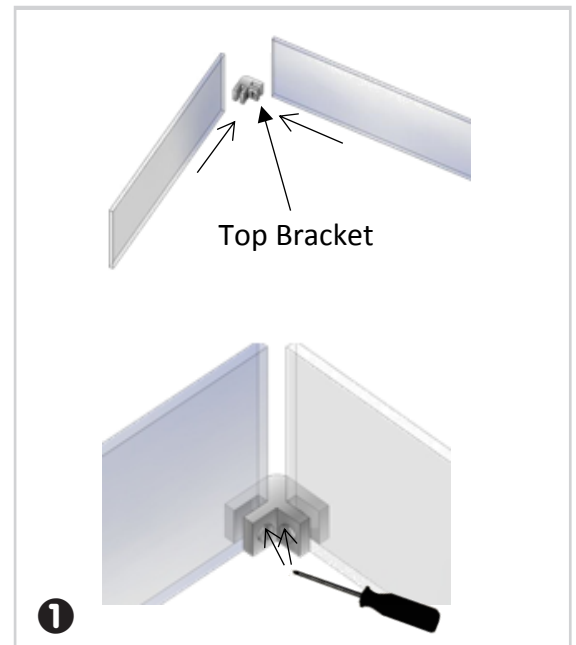

- 2** Repeat step 1 for remaining three corners.

Hardware Used: **D** Top Bracket x3



ASSEMBLY

- 3** Loosen set-screws and carefully slide **Bottom Bracket** % onto glass with rubber foot pointed up. Position edge of glass panel flush with bracket edge. Check that silicone guards are in place, then secure all set-screws, making sure to not over-tighten. Secure remaining three bottom brackets using the same procedure.

Hardware Used: % **Bottom Bracket** x4

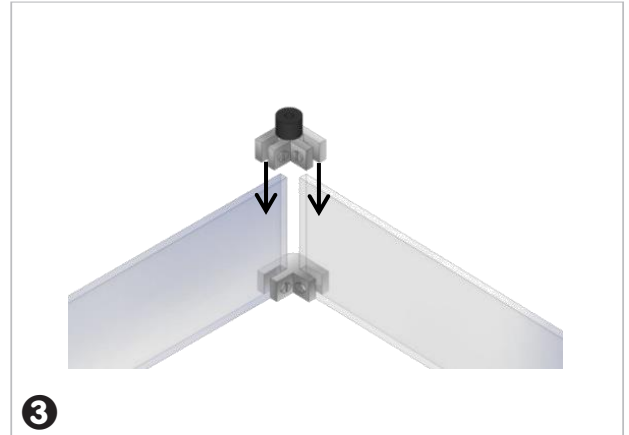

- 4** Carefully, using two people, turn the assembled wind guard upright. Gently set the glass guard onto fire pit, positioning the feet flat and level at the corners of the burner.

Be aware that the glass and hardware may become warm or hot after prolonged burning of the fire pit and take reasonable precautions to avoid burns.

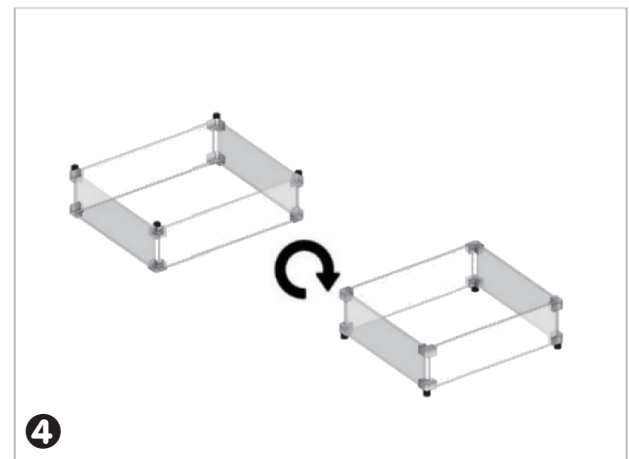

CARE: When wind guard is completely cool, it may be cleaned with a soft cloth or paper towel and standard glass cleaner. Never spray cleaner or water on a hot wind guard, as it could crack or shatter.