

# GHOST

## FREESTANDING DESIGNER FIREPLACE



Made entirely of glass and steel, the Ghost is a slim framed fireplace that works equally well in residential and commercial spaces. Though its crisp lines and glass body give it a strong modern feel, its transparency allows it to fit into design schemes of any fashion and colour.

**Global Compliance**

This model complies with existing standards in the USA, Europe, UK and Australia. UL Listed, EN 16647 BSI Certified and ACCC Safety Mandate compliant.

**No Flue, No Chimney,  
No Electricity Connection**

Our freestanding fireplaces offer an easy and immediate, environmentally friendly solution to adding warmth and ambience to any location.

**Portable Fireplace**

You'll have the ability to move these contemporary, stylish pieces of portable furniture from room to room. Or, relocate your bioethanol fireplace from inside your residence to the outside during parties or festivities and store away through the warmer months if space is an issue. And take it with you if you move house!



**Glass Surround**

Made with Toughened Glass.

**Stainless Steel**

Burner Shelf and Burners come in Stainless Steel.

**Quick and Easy**

With no installation or building works required, simply unpack, put into position, and off you go.

**Included Accessories**

**Optional Accessories**



Jerry Can



Lighting Rod + Lighter



AB3 Extension Spout



Ghost Attachable Screen



Decorative Steel Logs

Disclaimer: All product specifications and data are subject to change without notice and believed to be correct at the time of publication. MAD Design Group (MDG), its affiliates, agents, and employees, and all persons acting on its or their behalf (collectively, "MAD Design Group"), disclaim any and all liability for any errors, inaccuracies or incompleteness contained herein or in any other disclosure relating to any product. MDG disclaims any and all liability arising out of the use or application of any product described herein or of any information provided herein to the maximum extent permitted by law. The product specifications do not expand or otherwise modify MDG's terms and conditions of purchase, including but not limited to the warranty expressed therein, which apply to these products. No license, express or implied, by estoppel or otherwise, to any intellectual property rights is granted by this document or by any conduct of MDG. Customers using or selling MDG products not expressly indicated for use in such applications do so entirely at their own risk and agree to fully indemnify MDG for any damages arising or resulting from such use or sale. Please contact authorised personnel from MDG to obtain written terms and conditions regarding products designed for such applications. Images are indicative only.

# Ghost



FRONT VIEW

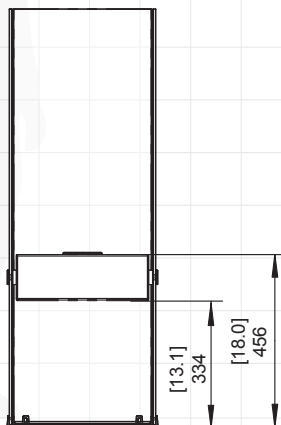

TOP VIEW

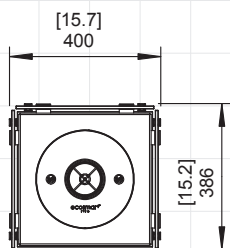

SIDE VIEW

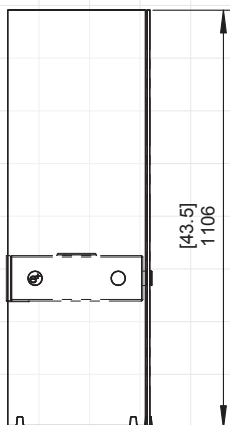

<b>Application</b>	Indoor & Outdoor
<b>Materials</b>	Grade 304 Stainless Steel, Toughened Glass
<b>Weight</b>	33.1kg [72.9lbs] Weight includes burner.
<b>Colour &amp; SKU</b>	■ Stainless Steel ESF.1.D.GST

## BURNER INFORMATION\*

<b>Burner</b>	AB3
<b>Fuel Type</b>	e-NRG Bioethanol
<b>Fuel Capacity</b>	2.5 Litres [0.7 Gallons]
<b>Heats on Average (when used indoors)</b>	Over 20 square metres [215 square feet]
<b>Burn Time</b>	8 - 11 hours (approx)
<b>Minimum Room Size</b>	40 cubic metres [1413 cubic feet] per fireplace.

\*These values are indicative only and may vary depending on the model purchased, installation, and the seasonal resource used to manufacture e-NRG.

\*\*Decorative logs must NOT be placed directly over an open flame. They are designed to sit near heat but not over flames.

This model comes with fixing brackets for permanently locating into a fixed position.

## Global Compliance

This model complies with existing standards in the USA, Europe, UK and Australia. UL Listed, EN 16647 BSI Certified and ACCC Safety Mandate compliant.

Logs not included.

**FOR MORE INFORMATION PLEASE REFERENCE THE CLEARANCE & INSTALLATION MANUAL**

Disclaimer. All product specifications and data are subject to change without notice and believed to be correct at the time of publication. MAD Design Group (MDG), its affiliates, agents, and employees, and all persons acting on its or their behalf (collectively, "MAD Design Group"), disclaim any and all liability for any errors, inaccuracies or incompleteness contained herein or in any other disclosure relating to any product. MDG disclaims any and all liability arising out of the use or application of any product described herein or of any information provided herein to the maximum extent permitted by law. The product specifications do not expand or otherwise modify MDG's terms and conditions of purchase, including but not limited to the warranty expressed therein, which apply to these products. No license, express or implied, by estoppel or otherwise, to any intellectual property rights is granted by this document or by any conduct of MDG. Customers using or selling MDG products not expressly indicated for use in such applications do so entirely at their own risk and agree to fully indemnify MDG for any damages arising or resulting from such use or sale. Please contact authorised personnel from MDG to obtain written terms and conditions regarding products designed for such applications. Images are indicative only.