

Versatile™ 4C Surface Mount Collar, SM16S

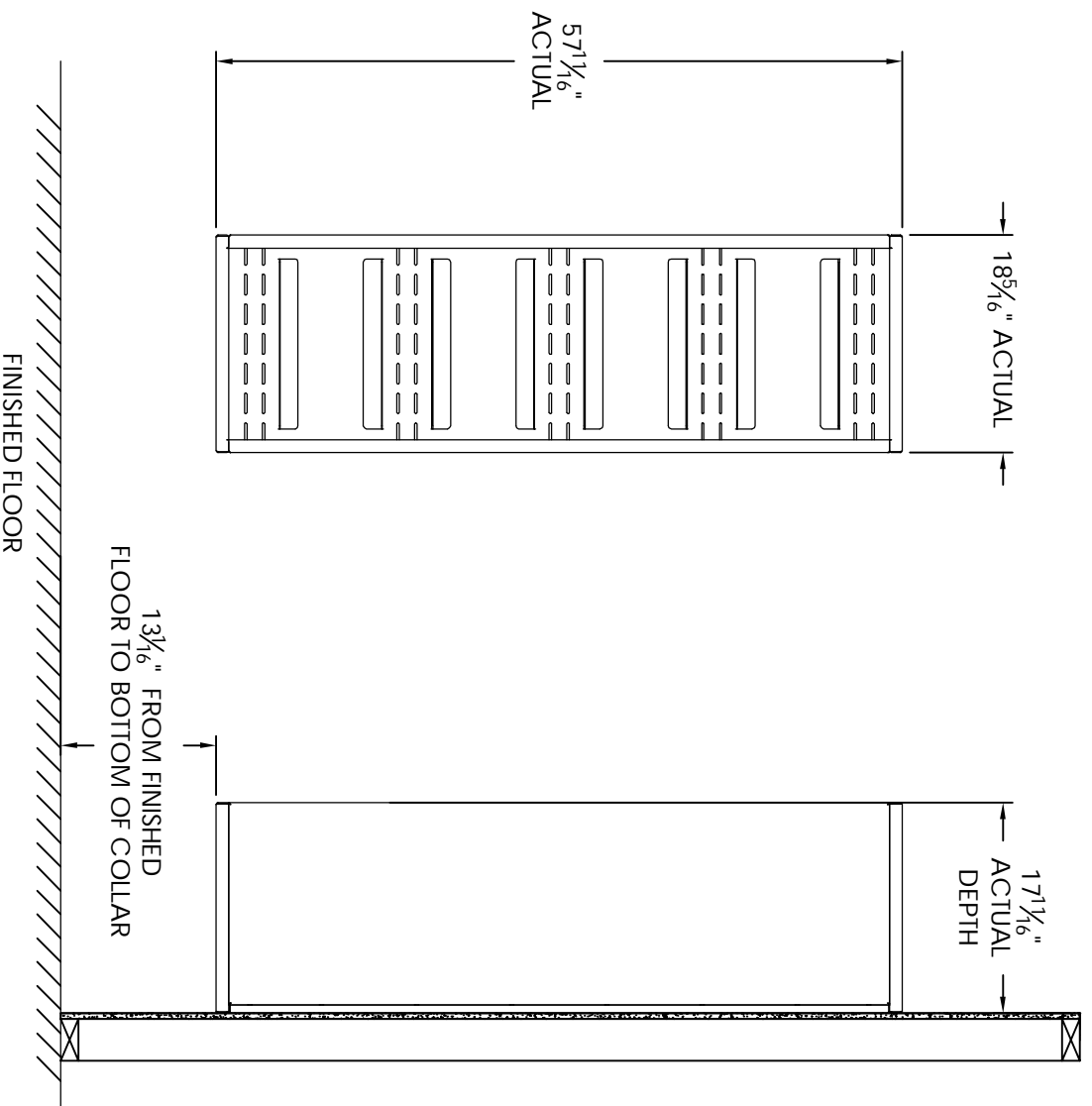

- Notes:
1. Designed to mount Florence Versatile™ 4C mailbox single column Max Height Suite modules (sold separately).
 2. For use with front loading modules only.

PRODUCT SERIES: VERSATILE™ 4C SURFACE MOUNT COLLAR

AF FLORENCE
manufacturing company
 5935 Corporate Drive • Manhattan, KS 66503
 www.florencemailboxes.com • (800) 275-1747
 A GIBRALTAR INDUSTRIES COMPANY

MODEL	SM16S	REV	C
SCALE	NONE	LAST REV. DATE	7/03/2014
DRAWING NUMBER	SM16SCS	DRAWN BY	TNS