

# Versatile™ 4C Mailbox, 4C13D-14-P

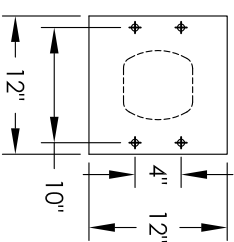
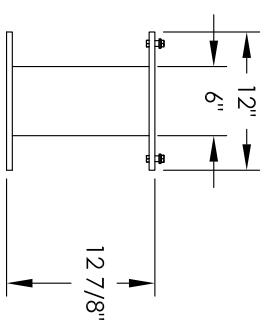
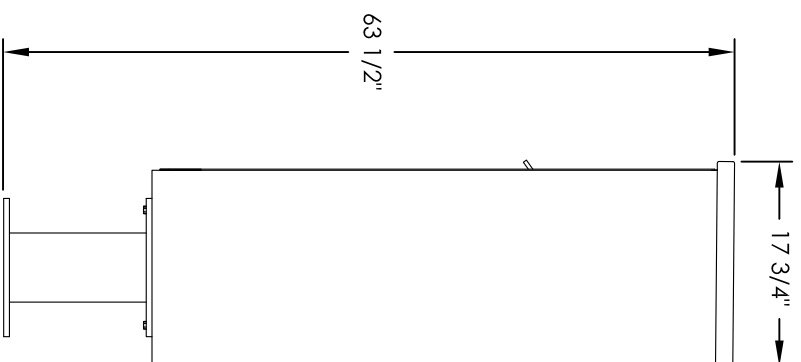
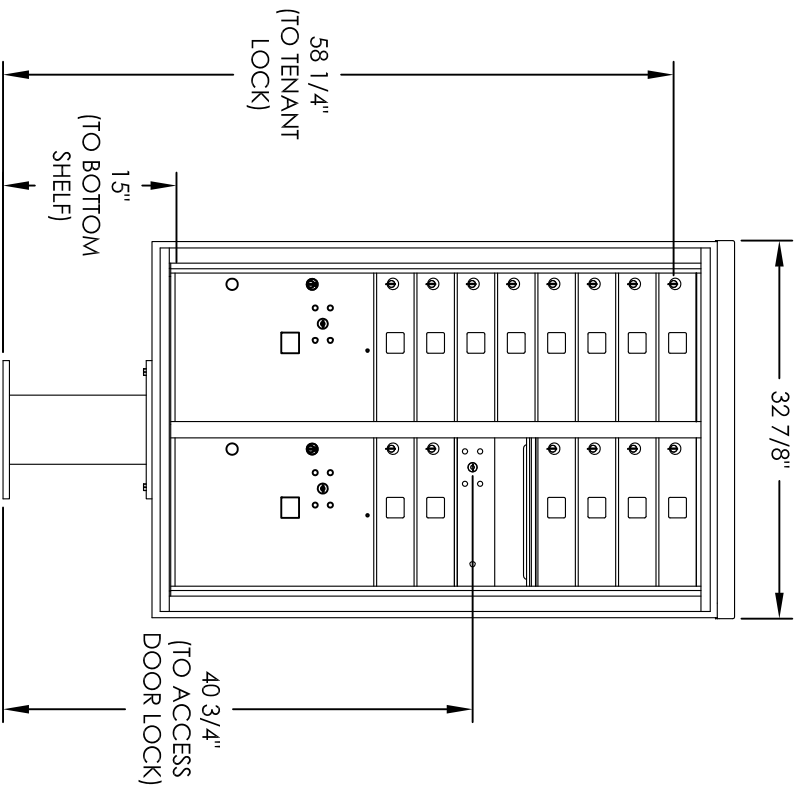

PEDESTAL DETAIL

## COMPARTMENT CHART

DESCRIPTION	COMPARTMENT	COMPARTMENT SIZE	QTY.
MAILBOX	MB1	3" H x 12" W x 15" D	14
OUTGOING MAIL	OM2	6-1/2" H x 12" W x 15" D	1
PARCEL	PL5	17" H x 12" W x 15" D	2

PRODUCT SERIES: VERSATILE™ 4C PEDESTAL MOUNT MAILBOX

- NOTES:
1. 4C pedestal units are for private applications only / not USPS Approved.
  2. May be installed outside or inside - see foundation specification details within the 4C Installation Manual.



5935 Corporate Drive • Manhattan, KS 66503  
www.fiorencemailboxes.com • (800) 275-1747  
A GIBRALTAR INDUSTRIES COMPANY

MODEL	4C13D-14-P	REV	A
SCALE	NONE	LAST REV DATE	5/14/2014
DRAWING NUMBER	4C13D-14-PCS	DRAWN BY	AFD