

Questions?
Click to Live Chat

Jabra Evolve 75e



User manual

Questions?
Click to Live Chat

Headset
Advisor

© 2017 GN Audio A/S. All rights reserved. Jabra® is a trademark of GN Audio A/S. The Bluetooth® word mark and logos are registered trademarks owned by the Bluetooth SIG, Inc. and any use of such marks by GN Audio A/S is under license.

Made in China
MODEL: HSC070W/END040W



 **Bluetooth®**

Declaration of Conformity can be found on
www.jabra.com/CP/US/doc

1. Welcome..... 5
2. Jabra Evolve 75e overview 6
 - 2.1 Included accessories
3. How to wear 7
 - 3.1 Getting the correct fit
 - 3.2 Attaching the EarWings
 - 3.3 Using the magnetic earbuds
4. How to charge 11
 - 4.1 What the LEDs mean
5. How to connect..... 13
 - 5.1 Power on/off
 - 5.2 Connecting to a computer (Bluetooth adapter)
 - 5.3 Connecting to a computer (USB cable)
 - 5.4 Pairing with a smartphone
6. How to use 16
 - 6.1 Calls & music
 - 6.2 Active Noise Cancellation (ANC)
 - 6.3 HearThrough
 - 6.4 Listen-in
 - 6.5 Voice guidance
 - 6.6 Siri or Google Now
 - 6.7 Multiple call handling
 - 6.8 Busylight

- 6.9 Vibrate alert
- 6.10 How to reset
- 6.11 Firmware update

7. Support 28

- 7.1 FAQ
- 7.2 How to care for your earbuds



1. Welcome

Thank you for using the Jabra Evolve 75e. We hope you will enjoy it!

Jabra Evolve 75e features

- UC certified microphone technology
- Active Noise Cancellation (ANC) to eliminate disturbances
- Integrated Busylight to prevent interruptions
- Power battery to fuel all-day use (up to 12 hours on a 2 hour charge)
- Dual-connectivity to two Bluetooth devices, enabling you to take calls and listen to music from the same earbuds
- Up to 30 meters / 100 feet of wireless range for true mobility
- Vibrating call alert to ensure you never miss a call
- Listen-in feature: Hear the conversations around you, at the touch of a button

2. Jabra Evolve 75e overview

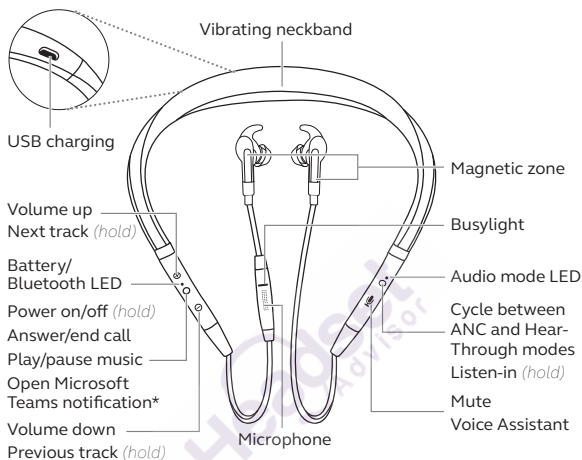

2.1 Included accessories

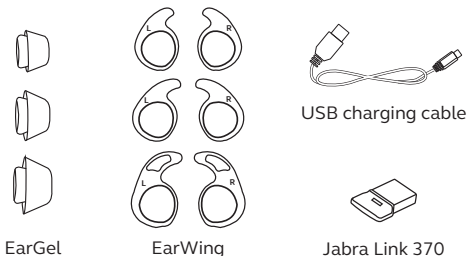

*Requires Microsoft Teams headset variant

3. How to wear

Jabra Evolve 75e is designed to be worn around the neck.

For the optimal call experience, position the microphone as close to your mouth as possible.



3.1 Getting the correct fit

The earbuds are supplied with three EarGel and EarWing sizes: large, medium and small.

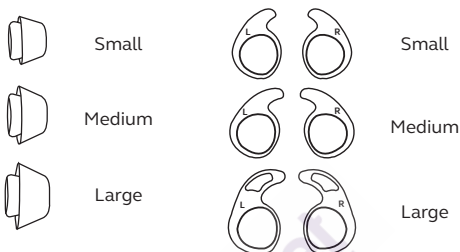

It is highly recommended to mix and match the different EarGel and EarWing sizes to find the best combination for your ear. The correct fit will feel tight and will seal out background noises.

3.2 Attaching the EarWings

To properly attach the EarWing, align the indent on the EarWing (as illustrated) with the ridge on the earbud, and stretch the EarWing over the earbud. It will fit perfectly in the groove when properly attached.

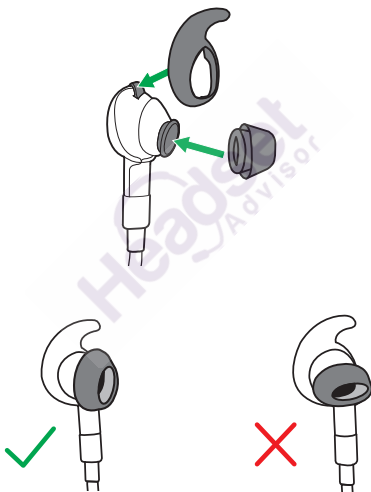

3.3 Using the magnetic earbuds

The earbuds are magnetic, and connect together for convenient cable and power management. When the earbuds are connected, your music will be paused or your call will be ended. Go to section 6.1. for more information.



4. How to charge

To charge the earbuds, connect a USB charging cable to the USB charging port on the neckband. It is recommended to charge the earbuds using the supplied Jabra charging cable, however it is possible to charge the earbuds using your smartphone charger.

It takes approx. 2 hours to fully charge the earbuds.

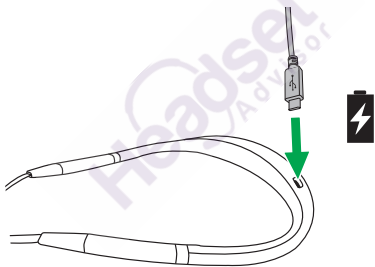

Note: Always clean and dry the USB charging port before charging the earbuds. It is recommended to recharge the earbuds at least once a month.

4.1 What the LEDs mean

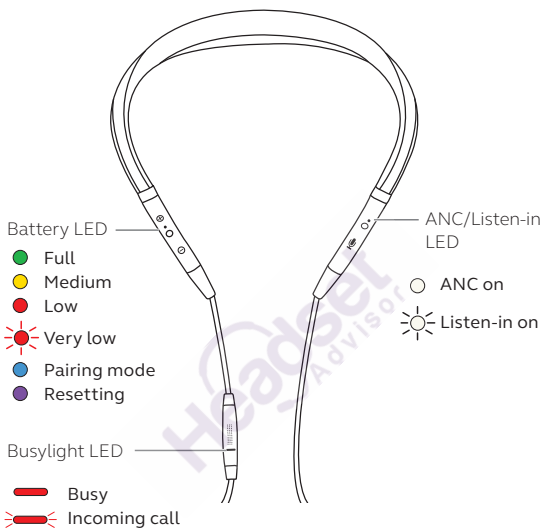

5. How to connect

5.1 Power on/off

On: Hold the **Multi-function** button for 1 second. The LED will flash green, and the neckband will vibrate.

Off: Hold the **Multi-function** button for 3 seconds. The LED will flash red, and the neckband will vibrate.

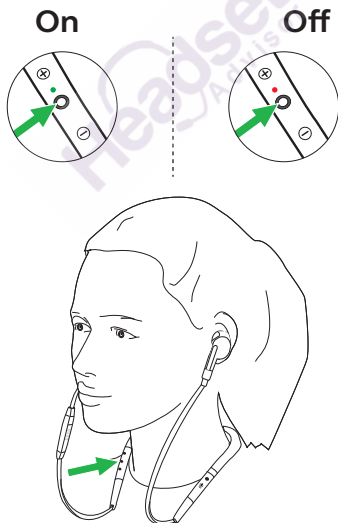

5.2 Connecting to a computer (Bluetooth adapter)

1. Insert the Bluetooth adapter (Jabra Link 370) into your computer.

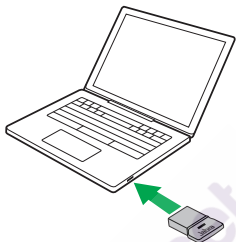

2. Hold (1 sec) the **Multi-function** button on the earbuds to power them on. The earbuds and the Bluetooth adapter are pre-paired and will automatically connect.

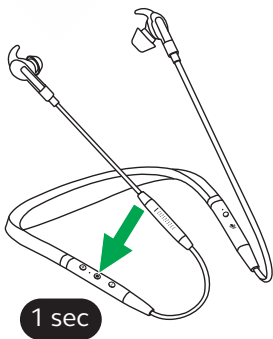

5.3 Connecting to a computer (USB cable)

1. Ensure the earbuds are powered on.
2. Plug the earbuds into a USB port on your computer using the supplied USB cable.

5.4 Pairing with a smartphone

1. Ensure the earbuds are powered off, and then hold (3 secs) the **Multi-function** button until the LED flashes blue and you hear an announcement in the earbuds.

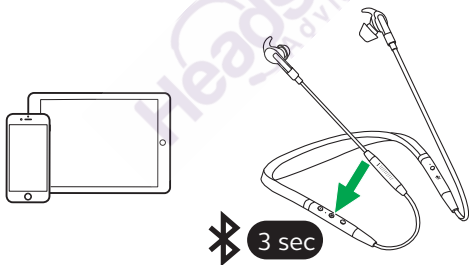

2. Wear the earbuds and follow the voice-guided pairing instructions.

6. How to use

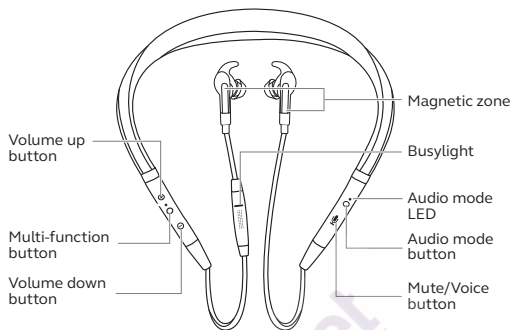

6.1 Calls & music

Calls & music

Power on

Hold (1 sec) the **Multi-function** button

Power off

Hold (3 sec) the **Multi-function** button

Play/pause music

Hold (1 sec) the **Multi-function** button

Answer/end call

Press the **Multi-function** button when not on a call

Reject call

Double-tap the **Multi-function** button

Open Microsoft Teams notification*

Press the **Multi-function** button

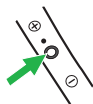



Answer/end call or
play/pause music

Detach/attach the
magnetic earbuds

Adjust volume

Press the **Volume up** or
Volume down button,
when listening to music
or on a call

Next track

Hold (1 sec) the
Volume up button

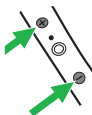

Previous track

Hold (1 sec) the
Volume down button

Battery status

Press the **Volume up** or
Volume down button,
when not listening to
music or on a call

Busylight on/off

Press both the **Volume
up** and **Volume down**
buttons simultaneously



Siri or Google Now

Press the **Mute/Voice**
button, when not on
a call

Mute/un-mute
microphone

Press the **Mute/Voice**
button, when on a call



Cycle between ANC
and HearThrough
modes

Press the **Audio mode**
button

Listen-in on/off

Hold (2 secs) the
Audio mode button

6.2 Active Noise Cancellation (ANC)

The earbuds use Active Noise Cancellation (ANC) to eliminate outside disturbance, allowing you to fully focus.

Press the **Audio mode** button to cycle through the available options.

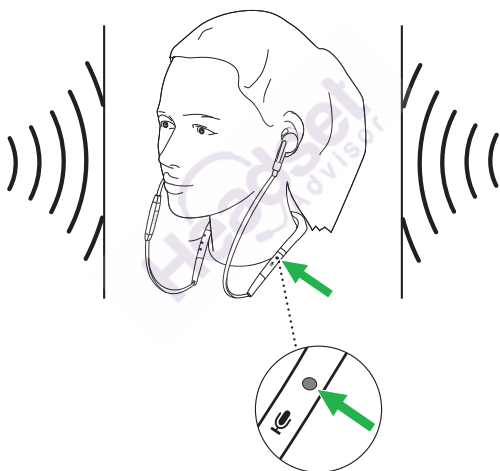

6.3 HearThrough

HearThrough enables you to hear your surroundings without needing to remove the earbuds. Your music will not be muted.

Press the **Audio mode** button to cycle through the available options.

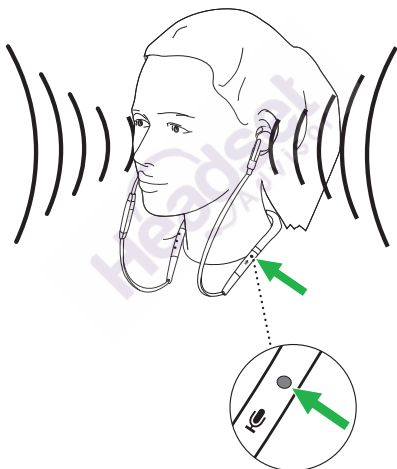

6.4 Listen-in

Listen-in enables you to engage in conversations without needing to remove the earbuds. Your music will be muted.

Hold (2 secs) the **Audio mode** button to activate Listen-in.

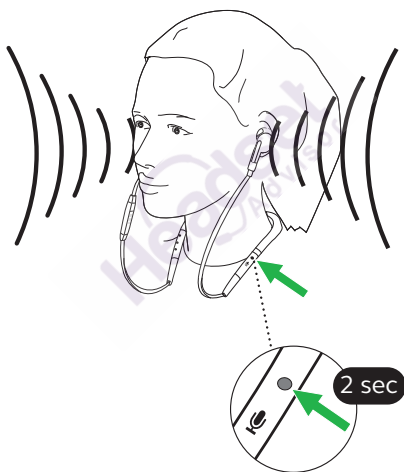

6.5 Voice guidance

Voice guidance are announcements intended to guide you or give earbud status updates (e.g. connection and battery status).

How to turn voice guidance On/Off

Voice guidance is enabled by default.

Voice Guidance On:

Ensure the earbuds are powered on, and then hold the **Mute/Voice** button for 5 seconds.

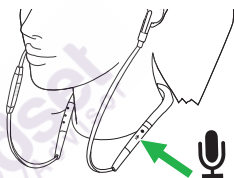

Voice Guidance Off:

Ensure the earbuds are powered on, and then hold the **Mute/Voice** button for 5 seconds.

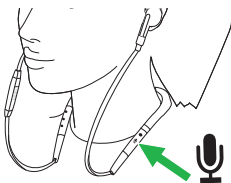

6.6 Siri or Google Now

Phone voice commands enable you to speak to Siri or Google Now on your smartphone using your earbuds. For more information on using Siri or Google Now, please refer to your smartphone's user manual.

Phone voice commands

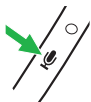

Activate Siri or Google Now (phone dependent)

Press the **Mute/Voice** button, when not on a call

6.7 Multiple call handling

The earbuds can answer or reject calls when you are already on a call.

Multiple call handling

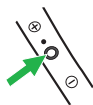

End current call and answer incoming call

Press the **Multi-function** button

Put current call on hold and answer incoming call

Hold (1 secs) the **Multi-function** button

Switch between held call and active call

Hold (1 secs) the **Multi-function** button

Reject incoming call, when on a call

Double-tap the **Multi-function** button

6.8 Busylight

The Busylight lets others know when you are busy or on a call.

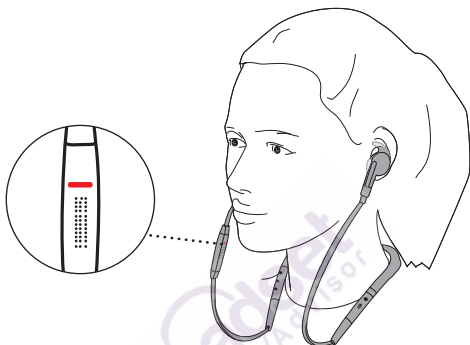

Busylight

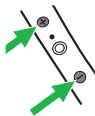

Busylight
on/off

Press both the **Volume up** and **Volume down** buttons simultaneously to turn the Busylight on/off

To disable (or re-enable) the Busylight function, hold both the **Volume up** and **Volume down** buttons simultaneously for 3 seconds.

6.9 Vibrate alert

The earbuds will vibrate whenever they are powered on/off, connected to your smartphone or computer, or whenever there is an incoming call.

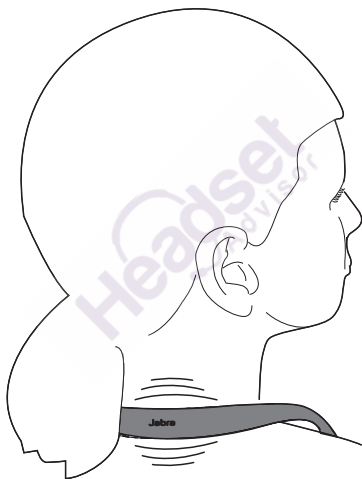

6.10 How to reset

Resetting the earbuds clears the list of paired devices and all earbud settings.

After resetting, it is necessary to re-pair the earbuds to your smartphone or to your Bluetooth adapter (Jabra Link 370). Please note that Jabra Direct is required to re-pair the earbuds to the Bluetooth adapter.

Reset



Reset the pairing list

Ensure the earbuds are powered on and you are not on a call. Then simultaneously hold the **Volume up** button and the **Multi-function** button for 5 seconds. You will then need to re-pair the earbuds.

6.11 Firmware update

Firmware updates improve performance, or add new functionality to Jabra devices.

1. Connect the Jabra Evolve 75e to a computer using the USB cable or Jabra Link 370.
2. Install Jabra Direct on your computer, or Suite for Mac on your Mac.
3. Use Jabra Direct or Suite for Mac to check for the latest firmware updates.

Headset
Advisor

7. Support

7.1 FAQ

View the FAQs on [Jabra.com/Evolve75e](https://www.jabra.com/evolve75e)

7.2 How to care for your earbuds

- Always store the earbuds with the power off and safely protected.
- Avoid storage at extreme temperatures (above 50°C/122°F or below -10°C/14°F). This can shorten battery life and may affect the earbuds.
- Regularly clean the metal mesh on each earbud to avoid them becoming blocked.

**Questions?
Click to Live Chat**

Headset
Advisor

jabra.com/evolve75e

REV E