

Jabra GN

**Questions?
Click to Live Chat**

EVOLVE 65

Engineered for multi-tasking.

Professional wireless headset with dual connectivity.

UC-certified means UC-satisfied

Jabra Evolve 65 is a professional Unified Communications (UC)-certified headset that's fully compatible with Microsoft Teams, or your UC platform of choice, for a truly seamless experience. Because when communication flows easily, work does too.

Nothing holding you back

Get up, take a call, or take a break, all while staying connected to your device. With a wireless Bluetooth connectivity range of up to 30m/100ft, plus 14 hours battery life, there's nothing tying you down.

Get in the zone. Stay in the zone.

Show those around you when you're on a roll and not to be disturbed, by activating the busylight. The handy little light automatically turns red when you're on a call to keep you from being interrupted, or you can enable it manually.

One headset. Two devices.

Stay wirelessly connected to two devices at the same time with dual Bluetooth connectivity. Answer calls from your phone, listen to focus enhancing music on your computer, work however you need to work — all using the same headset.

Use. Store. Charge. Repeat.

Once you're done using your headset, dock it on the handy charging stand* to charge and store it in one go, so it's always ready when you are.

Connects to:



*Available as an accessory



HOW TO START AND PAIR



HOW TO CHARGE

**Questions?
Click to Live Chat**

Charge with either the optional charging stand accessory or the supplied USB charging cable.

Full charge time **120** mins.
Up to 14 hours of battery.



HOW TO USE

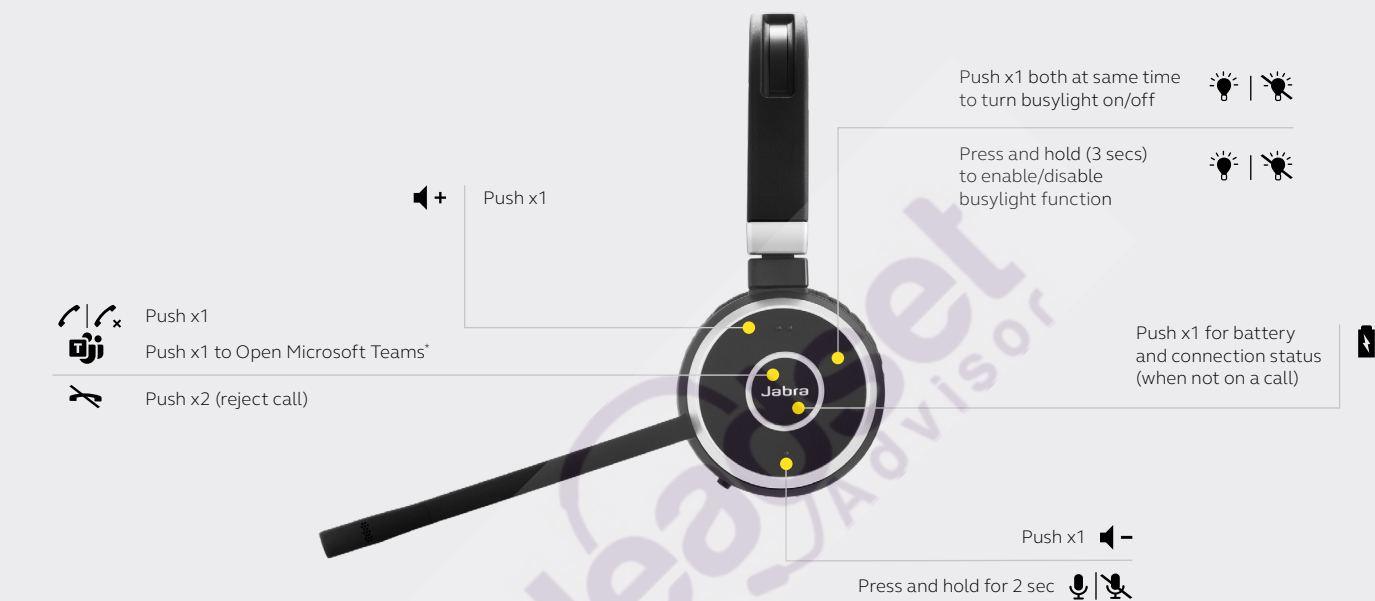

| | FEATURES | BENEFITS | |
|-------------------------|-----------------------------|---|--|
| Connectivity | Computer | Jabra Link 370 Bluetooth USB-A adapter. Up to 30m/100ft wireless range to your computer. | |
| | USB cable | Plug-and-play connectivity to computer | |
| | Dual Bluetooth connectivity | Connect two Bluetooth enabled devices at the same time, including mobile device and computer | |
| | Certifications | Certified for Microsoft Teams*, Cisco and more | |
| | Multiple device pairing | Pair up to 8 devices, one at a time | |
| Audio | Microphone | State-of-the-art noise-cancelling microphone eliminates background noise | |
| | HiFi Audio | HiFi audio streaming | |
| | Software integration | Additional features available via Jabra Xpress and Jabra Direct | |
| | Ease of use | Rechargeable battery | Up to 14 hours battery life |
| | | Busylight | Integrated busylight acting as a 'do not disturb' sign and protecting your focus |
| All day comfort | | Leather feel ear cushions and an on-ear wearing style for all-day comfort | |
| Optional charging stand | | Easy charging and docking comes with an optional charging stand to eliminate battery concerns | |
| Discreet boomarm | | Boom arm can be clipped into the headband when not on calls | |
| Variants | Music controls | Speaker volume up/down on headset | |
| | Call management | Answer/reject calls; increase/decrease speaker volume; mute | |
| | UC and MS variants | Choose from UC or MS Teams variants | |
| | Compatibility | Leading UC vendors and Microsoft Teams* | |

*Microsoft Teams headset variant only