

super 20 slings inc. YEARS of

Secure Solutions

RIGGING BLOCKS



Super Slings Inc.

www.superslings.ca

sales@superslings.ca

866-787-7544

Rigging
Blocks

Lifting
Devices

Pipe &
Hose
Restraints

Tie Down
Assemblies

Tie Down
Accessories

Towing &
Recovery

Rope &
Cordage

Sling
Protection

Web
Slings

Round
Slings

Synthetic
Chain Slings

Wire Rope
Slings

Chain
Slings

Shackles &
Turnbuckles

Hooks &
Links

Lifting
Points



WARNING!

This document contains warnings and use limitation information applicable to Snatch Blocks provided by Super Slings and is supplied with all Super Slings shipments. It is the responsibility of the purchasing agent, employer and/or end user to pass on this information in their warnings and use limitation literature. All users and personnel involved should fully understand all warnings, cautions and hazards involved with snatch block operation. **NEVER USE A SNATCH BLOCK WITHOUT TRAINING**

Protect Yourself and Others

- **NEVER** use a Snatch Block without training.
- **ALWAYS** inform yourself ... Ask your employer for the Snatch Block safe use instructions.
- **ALWAYS** comply with applicable Federal and local regulations.
- **ALWAYS** know applied lift system load.
- **NEVER** use a Snatch Block without a legible product identifier.
- **NEVER** overload a Snatch Block.
- **NEVER** ride on a Snatch Block or load.
- **NEVER** rig a Snatch Block improperly.
- **NEVER** use a worn – out or damaged Snatch Block.
- **NEVER** use a Snatch Block in extreme temperatures.
- **NEVER** use a Snatch Block in alkaline acidic conditions.



Maximum LSL applied to snatch block fitting must be known for proper snatch block selection.

LSL is calculated by the following formula: $LSL = (LP) * (LF)LA$
See illustration and table in Figure No. 1. LSL must be calculated for each snatch block in the lift system.

Snatch Block Working Load Limit (WLL) with appropriate design factor shall be equal to or greater than the corresponding maximum LSL.

Working Angle	Angle Factor	Working Angle	Angle Factor	Working Angle	Angle Factor	Working Angle	Angle Factor
0°	2.00	45°	1.84	90°	1.41	140°	0.68
10°	1.99	50°	1.81	100°	1.29	150°	0.52
20°	1.97	60°	1.73	110°	1.15	160°	0.35
30°	1.93	70°	1.64	120°	1.00	170°	0.17
40°	1.87	80°	1.53	130°	0.84	180°	0.00

• **Never use a Snatch Block without training.** OSHA regulation requires responsible work practice.

“The employer shall permit only those employees qualified by training or experience to operate equipment or machinery” – OSHA 1926.20 (b) (4).

Employee training should include information given in OH&S training literature, ASME B30.26 - 2010 “Rigging Hardware” standard, lift system manufacturer’s literature, Gunnebo Industries DVD of “Recommended Inspection Practices for Johnson Lifting Accessories”, and this document.

• **Always inform yourself.** Ask your employer for Snatch Block safe use instruction.

The employer shall instruct each employee in the recognition and avoidance of unsafe conditions and the regulations applicable to his work environment to control or eliminate any hazards or other exposure to illness or injury” – OSHA 1926.21 (b) (2).

• **Always comply with applicable Federal and local regulations.** Federal and local regulations govern worksite activity.

Understand all governing laws and safety standards before use of Snatch Blocks in lift systems. Contact your local authority or ASME at (800) 843-2763, or www.ASME.org for reference assistance.

• **Always know applied lift system load.** Avoid improper Snatch Block selection.

Lift system load (LSL) applied to the snatch block fitting is based upon line pull (LP) and load factor (LF) for a given lift angle (LA).

LIFT SYSTEM LOAD(LSL)

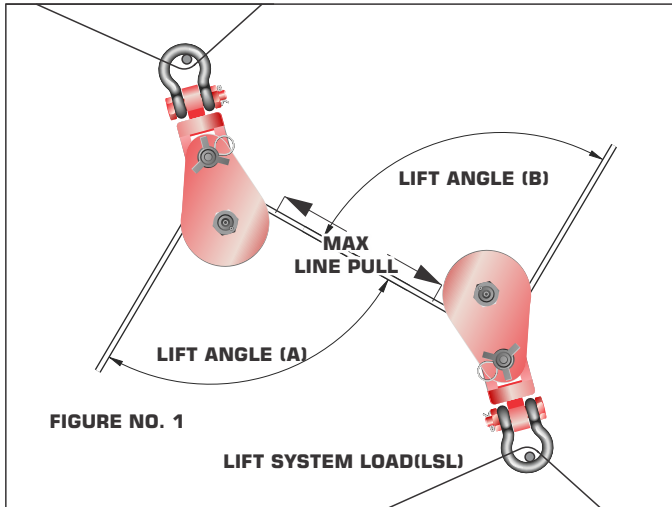

• **Never use a Snatch Block without a legible product identifier.** Product Identification is required to insure proper application. Snatch Blocks have a product identifier giving WLL, designfactor, wire rope range, and important user warnings. The information is required for confirmation of proper application prior to use.

Example of Product Identifier



Johnson Snatch Blocks

Wire Rope Snatch Blocks

Product details

Johnson Snatch Blocks have the convenient side opening feature. This is true even of our heavy duty top dead-end models, and makes it easy to reeve the block without removing any fitting from the end of the wire rope. Other features include choice of swivel hook, shackle, eye fittings or Tailboard Blocks which have no fittings at all.

Standard Features

- Rugged and reliable
- 4:1 design factor
- Easy-open side plates
- Metric rated
- Large hand nuts
- Retainer on latch pin
- Bow shackle with retainer pin
- Bronze bushing

Wide Range

We offer over 250 models and sizes, from 2 to 30 metric tonnes. Sheave sizes from 3 to 24 inches in diameter. Multiple rope sizes and end fittings available.

Rugged

Johnson's famous durability is well established in the industry. These blocks stand up to the toughest applications, whether in blistering sun or under icy blizzard conditions.

Reliable

From built-in strength comes the reliability long associated with the Johnson name. These blocks are performers, day after day and year after year.

J-Latch Replacement Kit

Johnson's exclusive J-Latch is a uniquely engineered hook latch system providing outstanding flexibility and durability. Its heavy-duty design incorporates a steel beam that positively engages a special recessed area in the hook tip. The removable two position pin allows the J-Latch to function either as a locked bar or as an automatic spring latch.

The J-Latch meets OSHA requirements and is standard equipment on Johnson crane blocks through 330 short tons, all Johnson overhaul balls, and all swivels and snatch blocks with hooks.

Optional Features

- Proof load
- Roller bearings
- Marine epoxy paint
- Heavy duty J-latch
- Larger sizes
- Customized blocks
- CE compliant upon request

Many Choices

Singles, doubles, top dead end, towing, oilfield, pipe laying and general construction. Sizes and specific models for all.

Convenient

Large, easy to grip hand nuts on all models, especially on the smallest models. Makes it easier to open and close under all conditions without removing gloves, and easy to tap with a hammer to loosen or lock down.

Secondary Securement

All hand nuts and shackles are fitted with "R" pins as a secondary securement device, for example where inspection is limited or infrequent due to location or other factors.

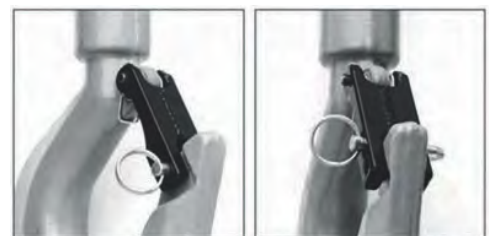

Item No.	J-Latch Kit No.	Crane Block WLL	Weight	Weight	Hook Part Number
	(short tons)	lbs	kgs		
471782	JL3-5	3-5	0.2	0.09	2590/10390/10153
471784	JL10-15	10-15	0.4	0.18	2217/10392
471786	JL30	30	1.5	0.68	2635
471787	JL35-45	35-45	2.1	0.95	2633
471788	JL50-70	50-70	5.0	2.3	2636/2637
471789	JL75-110	75-110	7.3	3.3	2638/2639
471790	JL115-175	115-175	8.5	3.9	2600/2630
474206	JL200-300	200-330	35	15.9	1096/4012/11363

- Sling Protection
- Web Slings
- Round Slings
- Synthetic Chain Slings
- Wire Rope Slings
- Chain Slings
- Shackles & Turnbuckles
- Hooks & Links
- Lifting Points
- Rigging Blocks**
- Lifting Devices
- Pipe & Hose Restraints
- Tie Down Assemblies
- Tie Down Accessories
- Towing & Recovery
- Rope & Carriage

Johnson Standard Snatch Blocks

Wire Rope Snatch Blocks

Design Factor 4:1, CE Marked

Sling Protection
Web Slings
Round Slings
Synthetic Chain Slings
Wire Rope Slings
Chain Slings
Shackles & Turnbuckles
Hooks & Links
Lifting Points
Rigging Blocks
Lifting Devices
Pipe & Hose Restraints
The Down Assemblies
The Down Accessories
Towing & Recovery
Rope & Cords



Item No.	Type	Model No.	WLL	Sheave Dia	Wire Rope Size		Weight
					in	mm	
			tonne	in	in	mm	lbs
Snatch Block – Tailboard, Single Sheave							
474572012QR3	Tailboard	SB2S3BT	2	3"	5/16"-3/8"	(8-10mm)	3
474562016QR3	Tailboard	SB4S4BT	4	4"	3/8"-1/2"	(10-13mm)	10
474621016QR3	Tailboard	SB4S6BT	4	6"	3/8"-1/2"	(10-13mm)	13
474624016QR3	Tailboard	SB4S8BT	4	8"	3/8"-1/2"	(10-13mm)	17
474542024QR3	Tailboard	SB8S6BT	8	6"	5/8"-3/4"	(16-19mm)	16
474369024QR3	Tailboard	SB8S8BT	8	8"	5/8"-3/4"	(16-19mm)	25
474375024QR3	Tailboard	SB8S10BT	8	10"	5/8"-3/4"	(16-19mm)	31
474381024QR3	Tailboard	SB8S12BT	8	12"	5/8"-3/4"	(16-19mm)	34
474410028QR3	Tailboard	SB12S6BT	12	6"	3/4"-7/8"	(20-22mm)	28
474416028QR3	Tailboard	SB12S8BT	12	8"	3/4"-7/8"	(20-22mm)	42
474422028QR3	Tailboard	SB12S10BT	12	10"	3/4"-7/8"	(20-22mm)	54
474733036QR3	Tailboard	SB20S8BT	20	8"	1"-1-1/8"	(26-29mm)	46
474734036QR3	Tailboard	SB20S10BT	20	10"	1"-1-1/8"	(26-29mm)	65
Snatch Block w/ Shackle, Single Sheave							
474602012QR3	Shackle	SB2S3BS	2	3"	5/16"-3/8"	(8-10mm)	5
474603016QR3	Shackle	SB4S4BS	4	4"	3/8"-1/2"	(10-13mm)	17
474620016QR3	Shackle	SB4S6BS	4	6"	3/8"-1/2"	(10-13mm)	20
474623016QR3	Shackle	SB4S8BS	4	8"	3/8"-1/2"	(10-13mm)	24
474644016QR3	Shackle	SB4S10BS	4	10"	3/8"-1/2"	(10-13mm)	33
474365024QR3	Shackle	SB8S6BS	8	6"	5/8"-3/4"	(16-19mm)	28
474371024QR3	Shackle	SB8S8BS	8	8"	5/8"-3/4"	(16-19mm)	37
474377024QR3	Shackle	SB8S10BS	8	10"	5/8"-3/4"	(16-19mm)	43
474587024QR3	Shackle	SB8S12BS	8	12"	5/8"-3/4"	(16-19mm)	54
474412028QR3	Shackle	SB12S6BS	12	6"	3/4"-7/8"	(20-22mm)	50
474418028QR3	Shackle	SB12S8BS	12	8"	3/4"-7/8"	(20-22mm)	64
474424028QR3	Shackle	SB12S10BS	12	10"	3/4"-7/8"	(20-22mm)	76
474582028QR3	Shackle	SB12S12BS	12	12"	3/4"-7/8"	(20-22mm)	92
474436028QR3	Shackle	SB12S14BS	12	14"	3/4"-7/8"	(20-22mm)	110
474455028QR3	Shackle	SB15S8BS	15	8"	3/4"-7/8"	(20-22mm)	64
474461028QR3	Shackle	SB1510BS	15	10"	3/4"-7/8"	(20-22mm)	78
474647036QR3	Shackle	SB20S8BS	20	8"	1"-1-1/8"	(26-29mm)	95
474728036QR3	Shackle	SB20S10BS	20	10"	1"-1-1/8"	(26-29mm)	114
474729036QR3	Shackle	SB20S12BS	20	12"	1"-1-1/8"	(26-29mm)	117
474730036QR3	Shackle	SB20S14BS	20	14"	1"-1-1/8"	(26-29mm)	128
474731036QR3	Shackle	SB20S16BS	20	16"	1"-1-1/8"	(26-29mm)	161
Snatch Block w/ Hook & Latch, Single Sheave							
475092012QR3	Hook	SB2S3BH	2	3"	5/16"-3/8"	(8-10mm)	5
474655016QR3	Hook	SB4S4BH	4	4"	3/8"-1/2"	(10-13mm)	16
475090016QR3	Hook	SB4S6BH	4	6"	3/8"-1/2"	(10-13mm)	19
475093016QR3	Hook	SB4S8BH	4	8"	3/8"-1/2"	(10-13mm)	22
474601024QR3	Hook	SB8S8BH	8	8"	5/8"-3/4"	(16-19mm)	35
475104024QR3	Hook	SB8S10BH	8	10"	5/8"-3/4"	(16-19mm)	42
474583024QR3	Hook	SB8S12BH	8	12"	5/8"-3/4"	(16-19mm)	53
475109028QR3	Hook	SB12S6BH	12	6"	3/4"-7/8"	(20-22mm)	46
474577028QR3	Hook	SB12S8BH	12	8"	3/4"-7/8"	(20-22mm)	60
474594028QR3	Hook	SB12S10BH	12	10"	3/4"-7/8"	(20-22mm)	72
474581028QR3	Hook	SB12S12BH	12	12"	3/4"-7/8"	(20-22mm)	88
475119028QR3	Hook	SB15S8BH	15	8"	3/4"-7/8"	(20-22mm)	66
475121028QR3	Hook	SB15S10BH	15	10"	3/4"-7/8"	(20-22mm)	80
475123028QR3	Hook	SB15S12BH	15	12"	3/4"-7/8"	(20-22mm)	97
475129036QR3	Hook	SB20S8BH	20	8"	1"-1-1/8"	(26-29mm)	81
475131036QR3	Hook	SB20S10BH	20	10"	1"-1-1/8"	(26-29mm)	100
475133036QR3	Hook	SB20S12BH	20	12"	1"-1-1/8"	(26-29mm)	103

WARNING: NEVER EXCEED WORKING LOAD LIMIT!

Failure to follow instructions can result in serious property damage, injury or death!

For full user manual please visit www.superslings.ca

Lift it up, Tie it down, Pull it around
Other Johnson Snatch Blocks



**Double-Sheave
w/ Hook**



**Double-Sheave
w/ Shackle**



**Top Dead-End
w/ Hook**



**Top Dead-End
w/ Shackle**



**Hayfork
Pulley**



**Guyline
Block**



**Tong Line
Blocks**



**Laydown
Blocks**



**Manhandler™
Derrick blocks**



**Oilfield
Tubing Blocks**



**Oilfield
Tubing Blocks**

Sling Protection
Web Slings
Round Slings
Synthetic Chain Slings
Wire Rope Slings
Chain Slings
Shackles & Turnbuckles
Hooks & Links
Lifting Points
Rigging Blocks
Lifting Devices
Pipe & Hose Restraints
Tie Down Assemblies
Tie Down Accessories
Towing & Recovery
Rope & Carriage



Snatch blocks are a pulley block with a side plate that can be opened so that you don't have to thread the rope through the pulley. Generally, Snatch blocks are used in applications to move

loads intermittently over short distances, as opposed to continuous service with long lifts. They are often used in conjunction with a winch in a recovery application where secure points may be offset from pulling direction.

These snatch blocks are furnished with a bronze bushing which is a friction bearing needing lubrication to provide best service life.

- Forged alloy hooks – heat treated – with latch
- Shackle/Hook forged steel – heat treated
- Forged steel swivel tees, yokes and shafts
- Bronze bush with grease nipple
- Fittings are painted yellow for quick recognition
- Designed for intermittent use with low line speed
- Ultimate load 4 x Working Load Limit (WLL)

MAINTENANCE:

To ensure peak efficiency and see an extended service life, it is necessary that blocks be inspected and maintained at frequent intervals:

Inspection procedures for any sign of wear or damage, such as: Worn or damaged shafts, bushings, slide plates and pins hooks or shackles: replace any part showing signs of wear or damage! Hook latch for proper fit and operation. Replace deformed latches! These particular blocks feature bronze bushings, which are not self-lubricating. They are designed for infrequent or intermediate use with low line speed. Observe the following lubrication schedule.

Assuming normal usage conditions moderate

– Lubricate every 6 – 8 hours of continuous use.

Assuming normal usage conditions Intermittent

– Lubricate once weekly

FAILURE TO OBSERVE THESE WARNINGS MAY RESULT IN SERIOUS INJURY OR DEATH!

All inspections, maintenance, block lifting design and rigging of blocks should be performed by a qualified/competent person (as defined by ANSI/ASME B.30)

- ALWAYS inspect snatch blocks before use. If during the inspection the unit is found to be damaged, cracked or deformed it must be removed from service immediately for repair.
- ALWAYS design and rig snatch block systems so that the load will not slip or fall.
- ALWAYS design lifting systems with the appropriate number of sheave assemblies to prevent premature sheave, bearing or wire rope wear and failure.
- ALWAYS make sure that all workers keep their hands, bodies and clothing away from the block sheaves, and pinch points where the wire rope makes contact with any part of the block or load.
- ALWAYS make sure that the hook NOT that latch supports the load.
- ALWAYS make sure that snatch blocks are regularly inspected, lubricated and maintained (see lubrication section).
- NEVER exceed the working load limit (WLL).
- NEVER sideload a snatch block.
- NEVER weld snatch blocks or load supporting parts.
- NEVER lift or transport loads over or near people.



Snatch Blocks

Wire Rope Snatch Blocks

Product details

Application

- Forged alloy hooks – heat treated – with latch
- Shackle/Hook forged steel – heat treated
- Forged steel swivel tees, yokes and shafts
- Bronze bush with grease nipple
- Fittings are painted yellow for quick recognition
- Designed for intermittent use with low line speed
- Ultimate load 4 x Working Load Limit (WLL)

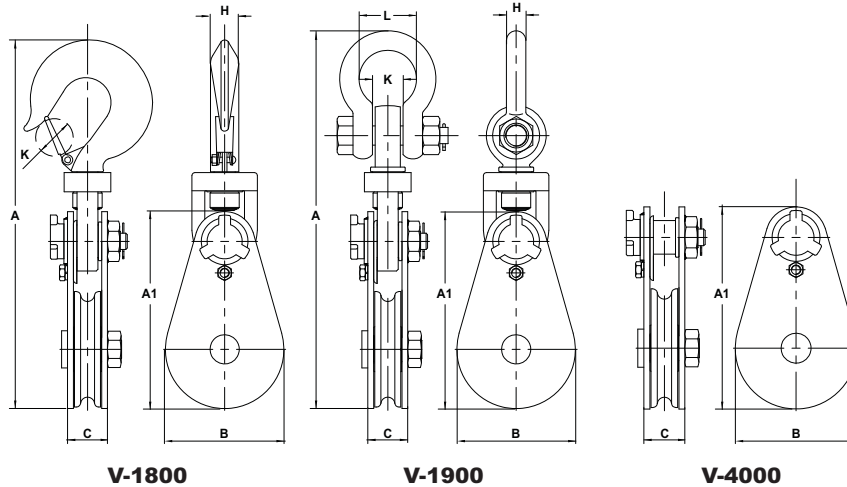

Item Code	Sheave Diameter	Rope Diameter	WLL	Dimensions [in]							Weight ea.
	[in]	[in]		[tons]	A	A1	B	C	H	K	L
V-1800 SNATCH BLOCK WITH HOOK AND LATCH											
39-B109037	3	3/8	2	9.65	4.88	2.99	1.50	0.79	0.91		3
39-B109064	4-1/2	1/2	4	14.09	7.46	4.25	1.99	1.18	1.50		12
39-B109126	6	3/4	8	17.91	9.65	5.98	2.30	1.42	1.81		27
39-B109224	8	3/4	8	19.88	11.78	7.99	2.30	1.42	1.81		35
39-B109322	10	3/4	8	21.89	13.90	10.00	2.30	1.42	1.81		50
39-B10928	8	1-1/8	15	24.72	13.29	7.99	2.72	1.69	2.09		58
39-B121022	8	1-1/8	20	28.15	14.80	7.99	3.35	2.28	2.60		103
V-1900 SNATCH BLOCK WITH SWIVEL SHACKLE											
39-B108038	3	3/8	2	9.65	4.88	2.99	1.50	0.79	1.28	0.50	3
39-B108065	4-1/2	1/2	4	13.94	7.46	4.25	1.99	1.22	1.91	0.75	13
39-B108127	6	3/4	8	18.31	9.65	5.98	2.30	1.69	2.68	1.00	29
39-B108225	8	3/4	8	20.28	11.75	7.99	2.30	1.69	2.68	1.00	36
39-B108323	10	3/4	8	22.24	13.90	10.00	2.30	1.69	2.68	1.00	53
39-B169418	8	1-1/8	15	24.88	13.29	7.99	2.72	2.09	3.46	1.44	65
39-B120023	8	1-1/8	20	29.09	14.80	7.99	3.35	2.36	3.80	1.54	117
V-4000 TAILBOARD WITH PIN ONLY											
39-B102016	3	3/8	2		4.88	2.99	1.50				3
39-B102025	4-1/2	1/2	4		7.46	4.25	1.99				8
39-B102098	6	3/4	8		9.65	5.98	2.30				15
39-B102169	8	3/4	8		11.75	7.99	2.30				25
39-B103523	8	1-1/8	20		14.80	7.99	3.35				70



WARNING: NEVER EXCEED WORKING LOAD LIMIT!

Failure to follow instructions can result in serious property damage, injury or death!

For full user manual please visit www.superslings.ca

- Sling Protection
- Web Slings
- Round Slings
- Synthetic Chain Slings
- Wire Rope Slings
- Chain Slings
- Shackles & Turnbuckles
- Hooks & Links
- Lifting Points
- Rigging Blocks**
- Lifting Devices
- Pipe & Hose Restraints
- Tie Down Assemblies
- Tie Down Accessories
- Towing & Recovery
- Rope & Carriage

Sling Protection
Web Slings
Round Slings
Synthetic Chain Slings
Wire Rope Slings
Chain Slings
Shackles & Turnbuckles
Hooks & Links
Lifting Points
Rigging Blocks
Lifting Devices
Pipe & Hose Restraints
Tie Down Assemblies
Tie Down Accessories
Towing & Recovery
Rope & Cordage

Yarding Blocks

Wire Rope Yarding Blocks

Product details

Application

Yarding blocks are constructed with high quality cast steel sheaves that possess machined grooves. One side of the pulley block is hinged and can be opened for quick and easy positioning of rope. Hooks possess safety latches. Yarding blocks meet CE safety standards



Item Code	WLL	Sheave Diameter	Dimensions (in)					Weight ea.
			A	B	C	C-1	d-1	
	Tons	[in]						[lbs]
39-131103	1-1/2	3	6.93	3.35	1.02	3.15	0.47	3
39-131104	3	4	9.25	4.76	1.34	3.39	0.63	5
39-131105	4-1/2	5	12.01	5.71	1.50	4.06	0.71	9
39-131106	6	6	13.78	7.09	1.61	4.33	0.87	17
39-131108	8	8	16.73	8.86	1.81	6.50	1.10	35

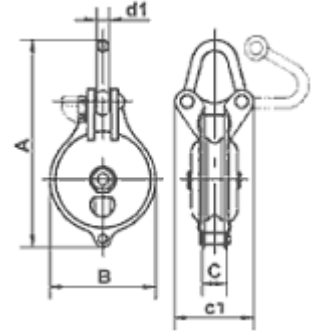

Cast Iron Snatch Blocks

Wire Rope Snatch Blocks

Product details

Application

- Supplied with smooth long lasting needle bearing sheave.
- Spring loaded safety latch on swivel hook
- Moveable side plate allows easy installation of wire rope

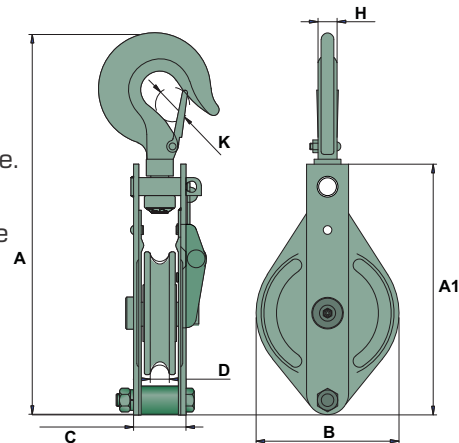

Item Code	WLL	Sheave Diameter	Rope Size	Dimensions (in)						Weight ea.
				A	A1	B	C	H	K	
	Tons	[in]	[in]							[lbs]
39-130103	1/2	3	3/8	11.73	6.73	3.46	1.38	0.57	0.79	3.15
39-130104	1	4	7/16	13.74	7.98	4.41	1.61	0.59	0.87	5.54
39-130105	1-1/2	5	1/2	15.91	9.43	5.51	1.77	0.79	0.91	8.30
39-130106	2	6	5/8	18.98	10.83	6.46	2.05	1.10	1.30	15.50



WARNING: NEVER EXCEED WORKING LOAD LIMIT!

Failure to follow instructions can result in serious property damage, injury or death!

For full user manual please visit www.superslings.ca

Cast Iron Sheaves

Sheaves

Product details

Application

- Made of cast iron
- Durable bronze bushings
- Ball type oiler
- Factory tested to 150% of rated capacity
- NOTE: Not a replacement for snatch block or yarding block sheaves

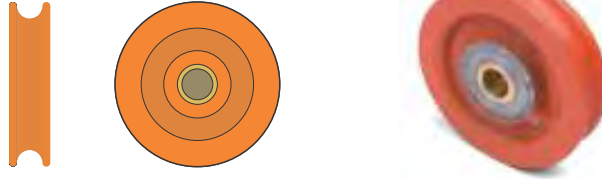

Item Code	Sheave Diameter	Bore Size	Rope Diameter	WLL	Width	Weight ea.
	[in]	[in]	[in]	(tons)	[lbs]	
133103	3"	1/2	5/16	1/2	3/4	1
133104	4"	5/8	3/8	1	15/16	1.9
133105	5"	3/4	1/2	1-1/2	1-1/16	3.6
133106	6"	1-1/8	5/8	2	1-5/16	5.9
133108	8"	1-1/4	7/8	4	1-7/8	14.7

Hand Line Utility Blocks

Utility Blocks

Product details

Application

- Model CHB300 / CHB303
- For Stringing Conductor Cable or Fiber Rope Applications
- Side Opening Block with Zinc Plated Swivel Hook with Safety Latch
- CHB300 features Ultra-lightweight Block and Sheave Molded From Rugged Reinforced Nylon Fiberglass High Di-Electric Material and 1,000 lb. Safe Working Load Limit
- CHB303 features Lightweight Aluminum Alloy Block and Sheave Construction with Permanently Lubricated Sheave and Safety-tethered Locking Pin and Strongest in Class 1,500 lb. Safe Working Load Limit
- 3" Sheaves - Blocks Can Accommodate Rope Through 5/8" Diameter
- Design Factor: 3 to 1

Item Code	Weight Each (lbs.)	Working Load Limit	Rope Size	Block Size	Fitting Type
CHB303	2.50 lb	1500 lb	5/8 in	3 in	Hook w/Latch
CHB300	1.90 lb	1000 lb	5/8 in	3 in	Hook w/Latch



CHB300

CHB303

Special Order

WARNING: NEVER EXCEED WORKING LOAD LIMIT!

Failure to follow instructions can result in serious property damage, injury or death!

For full user manual please visit www.superslings.ca

Angular Contact Bearing Swivels

Swivels

Product details

Application

- YOKE Swivels are manufactured using the highest grade of material available.
 - YOKE Swivels are designed with a safety factor of 5:1.
 - YOKE Swivels are available in sizes from 3/4 tonnes to 35 tonnes.
 - YOKE Swivels are available for wire lines 1/4" to 1-1/2".
 - YOKE Swivels are zinc plated for corrosion resistance and longer life.
 - YOKE Swivels are manufactured with grease fittings for superior performance.
- YOKE Swivels are designed for low starting torque and high rotation speed.
 - All Swivels parts are 100% magnaflux crack detected.
 - 20,000 cycle fatigue rate to 1.5 times working load limit.
 - All parts with batch number for quality certified and traceability.
 - ★ Min Ultimate Load is 5 times the Working Load Limit.
 - ★ Max Proof Load is 2 times the Working Load Limit.



8-301 Bullet Style - Angular Contact Bearing Swivel

Item No.	Wire Line Size	WLL.	Dimensions (inch)							Net Weight
	inch		tons*	A	B	C	D	H	K	
8-301-0075	1/4	0.75	0.60	1.30	0.50	0.40	0.90	4.00	5.00	1.1
8-301-015	3/8	1.5	0.70	1.60	0.60	0.50	1.00	4.40	5.70	1.7
8-301-03	1/2	3	0.90	2.00	0.90	0.60	1.20	6.30	8.00	4.4
8-301-05	5/8	5	1.30	2.50	1.20	0.90	1.50	8.00	10.30	8.7
8-301-085	3/4	8.5	1.50	3.00	1.40	1.00	2.00	9.50	12.30	14.8
8-301-10	7/8	10	1.70	4.00	1.80	1.50	2.10	12.50	16.00	40.0
8-301-15	1	15	2.00	4.30	1.80	1.50	2.20	12.50	16.00	46.2
8-301-25	1 1/2	25	2.50	5.20	2.40	2.00	2.70	14.70	19.50	80.5

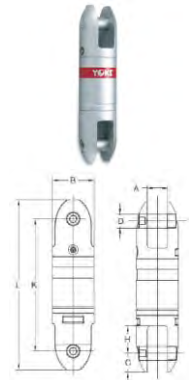

8-303 Jaw-Jaw Style - Angular Contact Bearing Swivel

Item No.	Wire Line Size	WLL.	Dimensions (inch)								Net Weight
	inch		tons*	A	B	C	D	G	H	K	
8-303-0075	1/4	0.75	0.60	1.30	0.50	0.40	0.20	0.90	4.10	5.00	1.1
8-303-015	3/8	1.5	0.70	1.60	0.80	0.50	0.30	1.00	4.40	6.00	2.0
8-303-03	1/2	3	0.90	2.00	1.00	0.80	0.40	1.30	6.20	8.20	5.1
8-303-05	5/8	5	1.30	2.50	1.20	0.90	0.60	0.50	8.00	10.30	9.7
8-303-085	3/4	8.5	1.60	3.00	1.30	1.20	0.60	2.10	10.00	12.60	16.8
8-303-10	7/8	10	1.70	4.00	1.90	1.50	1.00	2.10	12.40	16.20	43.0
8-303-15	1	15	1.90	4.30	2.00	1.50	1.00	2.20	12.40	16.50	47.8
8-303-25	1 1/4	25	2.40	5.20	2.60	2.00	1.20	2.80	14.70	20.00	87.0

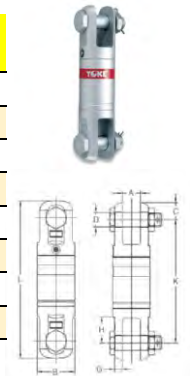

8-306 Eye-Eye Style - Angular Contact Bearing Swivel

Item No.	Wire Line Size	WLL.	Dimensions (inch)							Net Weight
	inch		tons*	B	I	J	K	L	T	
8-306-0075	1/4	0.75	1.30	0.70	0.70	4.10	5.50	0.50	1.50	1.1
8-306-015	3/8	1.50	1.60	0.90	0.90	4.60	6.30	0.60	1.70	2.0
8-306-03	1/2	3	2.00	1.10	1.10	6.20	8.40	0.80	2.00	4.6
8-306-05	5/8	5	2.50	1.30	1.30	8.30	10.90	1.00	2.30	9.7
8-306-085	3/4	8.50	3.00	1.50	1.50	9.80	12.80	1.30	3.20	16.1
8-306-10	7/8	10	4.00	2.10	2.00	12.20	16.30	1.70	3.50	37.4
8-306-15	1	15	4.30	2.50	2.50	12.40	17.40	1.90	4.30	46.3
8-306-25	1 1/4	25	5.20	2.80	2.80	16.00	21.50	2.40	5.10	86.0

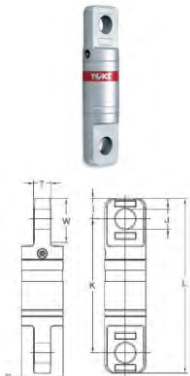

Sling Protection
Web Slings
Round Slings
Synthetic Chain Slings
Wire Rope Slings
Chain Slings
Shackles & Turnbuckles
Hooks & Links
Lifting Points
Rigging Blocks
Lifting Devices
Pipe & Hose Restraints
Tie Down Assemblies
Tie Down Accessories
Towing & Recovery
Rope & Cordage