

SNAP FIT & EAR CLAMPS

Double Ear Hose Clamp



The Double Ear Hose Clamp or Crimp clip is manufactured from Zinc Plated or 304 Stainless Steel and is an economical solution for many simple hose assemblies. The two ears give the clip extra grip and help maintain constant pressure around the hose. Fitting is more flexible and exact. The practical design of the double ear hose clamps means that they clamp firmly onto the assemble and cannot be removed once mounted. The edges are rounded to avoid damage to the hose.

Double Ear Hose Clamp 304 Stainless Steel

Due to the AISI-304 Steel used in the manufacture of these clips, their corrosion resistance is outstanding making them suitable for outdoor and marine applications.

Applications

- Automotive
- Vending
- White Goods
- Marine
- General Industry

Materials – see section 7.2

- **W1** Zinc Plated Steel
- **W4** 304 SS

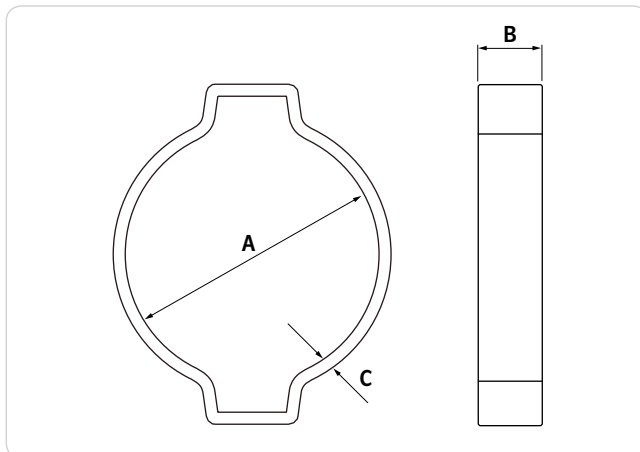

Installation Tools



MT-EC-VHT-01

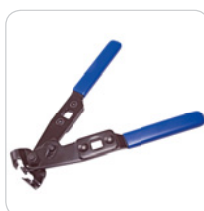

MT-EC-VT-01

HCL Part No	Diameter Range (A) mm	Band Width (B) mm	Band Thickness (C) mm	Box Quantity
DEC-5	5 - 7	6.0	0.6	100
DEC-7	7 - 9		0.8	
DEC-9	9 - 11	6.5	0.9	
DEC-11	11 - 13		1.0	
DEC-13	13 - 15	7.0	1.2	
DEC-14*	14 - 17			
DEC-15	15 - 18	7.5	1.3	
DEC-17	17 - 20			
DEC-18	18 - 21	8.0	1.4	
DEC-20	20 - 23			
DEC-22	22 - 25	8.5	1.6	
DEC-23*	23 - 27			
DEC-25*	25 - 28	9.0	1.6	
DEC-28*	28 - 31			
DEC-31*	31 - 34	9.5	1.6	
DEC-34*	34 - 37			
DEC-37*	37 - 40	10.0	1.6	
DEC-40*	40 - 43			
DEC-43*	43 - 45	10.5		

Part numbers marked with * are only available in W1 Material
 All weights, dimensions & quantities are subject to a 2.5% tolerance.
 To add material selection to the HCL Part No: for W4, add "W4".